

## Radiological Survey Sheet

Job Location Pfizer Inc Greston, CT 118/W108 Page 1 of 13

Survey Purpose Radiological assessment Date 11/28/00

Performed By John Purcell (Print) John Purcell (Sign)

Inst.(1) Beckman LS 6500 (Model/SN) #7069448	Inst.(2) Ludlum 2241-2 (Model/SN) # 137757	Inst.(3) (Model/SN)
Det. Internal (Model/SN)	Det. Ludlum 43-68 (Model/SN) # 440089 140899	Det. (Model/SN)
Eff. See LSC Printout	Eff. $C14 = 890$	Eff.
Type rad. $\beta$	Type rad. $\beta$	Type rad.
Bkgd. See LSC Printout	Bkgd. $\#163cpm^{250}$	Bkgd.
Cal. Due: 12/00	Cal. Due 4/00	Cal. due

No.	Time	Location	Inst. Used	Total Activity (dpm/100 cm <sup>2</sup> )
1.	1100	DOOR Knob	1	See attached LSC Printout
2.		Light switch	1	
3.		DOOR	1	
4.		FLOOR	1	
5.		Hood Cabinet TOP	1	
6.		Hood Walls	1	
7.		Hood Lip	1	
8.		Hood Vents	1	
9.		Hood Knobs	1	
10.		(D) Cabinet	1	
11.		(R) Cabinet	1	
12.		FLOOR	1	
13.		shelf	1	
14.		Sink Knobs	1	
15.		SINK DRAIN	1	
16.		cabinet TOP	1	
17.		Cabinet outer	1	
18.		cabinet inner	1	

Radiological Survey Continuation Sheet

Page 2 of 13

Date 1/28/00

No.	Time	Location	Inst. Used	Total Activity (dpm/100 cm <sup>2</sup> )	Comments
19		Top shelf	1		
20		shelf	1		
21		shelf	1		
22		shelf	1		
23		cabinet doors	1		
24		counter Top	1		
25		Top DRAWER	1		
26		DRAWER	1		
27		DRAWER	1		
28		DRAWER	1		
29		FLOOR	1		
30		Wall	1		
31		Top shelf	1		
32		shelf	1		
33		shelf	1		
34		DOOR	1		
35		FLOOR	1		
36		off-Wall	1		
37		Shelfs	1		
38		Door Handle	1		
39		desk drawers	1		
40		desk Top	1		
41		FLOOR	1		
42		FLOOR	1		
43		Shelf	1		
44		desk Top	1		
45		FLOOR	1		
46	✓	Door Handle	1		

## Radiological Survey Continuation Sheet

Page 3 of 13Date 1/28/00

No.	Time	Location	Inst. Used	Total Activity (dpm/100 cm <sup>2</sup> )	Comments
47		Floor	1		
48		Floor	1		
49		Door	1		
50		Floor	1		
51		Shelf	1		
52		Top shelf	1		
53		shelf	1		
54		Shelf	1		
55		shelf	1		
56		Cabinet door	1		
57		top shelf	1		
58		shelf	1		
59		shelf	1		
60		desk Top	1		
61		drawer	1		
62		Top drawer	1		
63		drawer	1		
64		drawer	1		
65		Top shelf	1		
66		shelf	1		
67		shelf	1		
68		Counter	1		
69		Cup Sink	1		
70		Top Drawer	1		
71		Drawer	1		
72		Drawer	1		
73		Drawer	1		
74	✓	Top shelf	1		

Radiological Survey Continuation Sheet

Page 4 of 13

Date 1/28/00

No.	Time	Location	Inst. Used	Total Activity (dpm/100 cm <sup>2</sup> )	Comments
75		Shelf	1		
76		Shelf	1		
77		Counter Top	1		
78		Floor	1		
79		ⓐ Top Drawer	1		
80		ⓑ Top Drawer	1		
81		ⓒ Drawer	1		
82		ⓓ Drawer	1		
83		Drawer	1		
84		Drawer	1		
85		Chair #1	1		
86		Chair #2	1		
87		Chair #3	1		
88		Chair #4	1		
89		Chair #5	1		
90		Counter	1		
91		Sink Knobs	1		
92		Plexiglass	1		
93		Sink Drain	1		
94		Cabinet Outer	1		
95		" inner	1		
96		Counter Top	1		
97		ⓐ Top Drawer	1		
98		ⓑ Top Drawer	1		
99		ⓒ Drawer	1		
100		ⓓ Drawer	1		
101		Drawer	1		
102	✓	Drawer	1		

Radiological Survey Continuation Sheet

Page 5 of 13

Date 1/28/00

No.	Time	Location	Inst. Used	Total Activity (dpm/100 cm <sup>2</sup> )	Comments
103		FLOOR	1		
104		Counter	1		
105		(M) Drawer	1		
106		Top Drawer	1		
107		DRAWER	1		
108		Cabinet outer	1		
109		Cabinet inner	1		
110		Chair #6	1		
111		Chair #7	1		
112		Top Shelf	1		
113		Shelf	1		
114		Shelf	1		
115		desk top	1		
116		desk drawer	1		
117		Shelf	1		
118		Top Shelf	1		
119		Shelf	1		
120		Shelf	1		
121		Shelf	1		
122		Cabinet Door	1		
123		Top Shelf	1		
124		Shelf	1		
125		Shelf	1		
126		Shelf	1		
127		Cabinet door	1		
128		Top Shelf	1		
129		Shelf	1		
130	✓	Shelf	1		

Radiological Survey Continuation Sheet

Page 6 of 13

Date 1/28/00

No.	Time	Location	Inst. Used	Total Activity (dpm/100 cm <sup>2</sup> )	Comments
131		shelf	1		
132		Cabinet door	1		
133		Top Shelf	1		
134		shelf	1		
135		shelf	1		
136		desk Top	1		
137		desk drawer	1		
138		Floor	1		
139		Top Shelf	1		
140		shelf	1		
141		shelf	1		
142		Counter	1		
143		Top Drawer	1		
144		Drawer	1		
145		Drawer	1		
146		Drawer	1		
147		Cabinet	1		
148		drawer	1		
149		Floor	1		
150		Top Shelf	1		
151		shelf	1		
152		shelf	1		
153		Counter	1		
154		Top Drawer	1		
155		Drawer	1		
156		Drawer	1		
157		Drawer	1		
158	✓	Drawer	1		

Radiological Survey Continuation Sheet

Page 7 of 13

Date 1/28/00

No.	Time	Location	Inst. Used	Total Activity (dpm/100 cm <sup>2</sup> )	Comments
159		Cabinet	1		
160		Counter	1		
161		Sink cup	1		
162		Ⓐ cabinet outer	1		
163		Ⓑ cabinet outer	1		
164		Top Cabinet shelf	1		
165		cabinet shelf	1		
166		counter Top	1		
167		Cup sink	1		
168		Drawer	1		
169		TOP DRAWER	1		
170		Drawer	1		
171		Drawer	1		
172		Drawer	1		
173		cabinet outer	1		
174		cabinet inner	1		
175		Chair #8	1		
176		Chair #9	1		
177		Top shelf	1		
178		shelf	1		
179		shelf	1		
180		shelf	1		
181		shelf <sup>top</sup> cabinet door	1		
182		Top Shelf	1		
183		shelf	1		
184		shelf	1		
185		shelf	1		
186	✓	cabinet door	1		





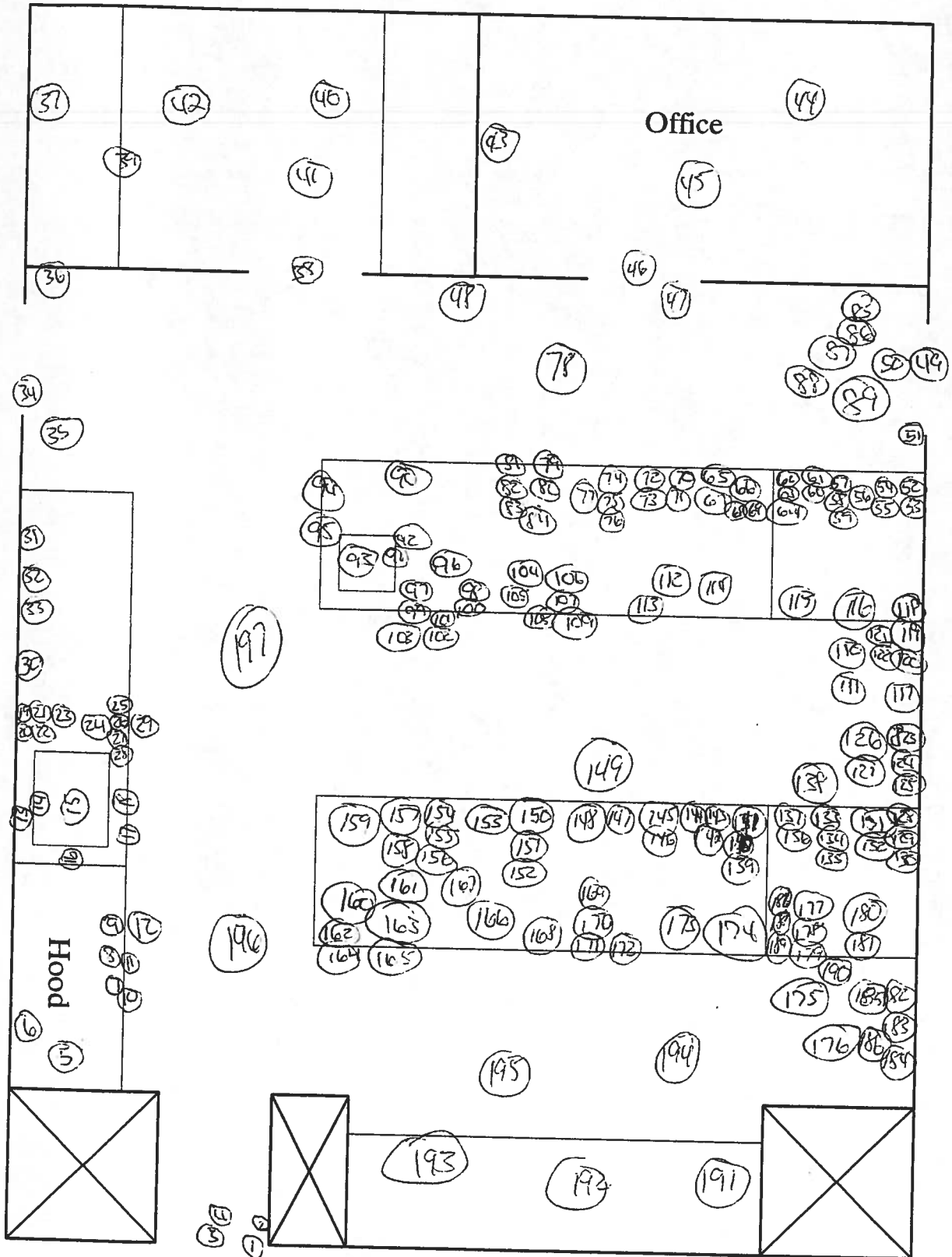

Surveyed 100% of lower surfaces using 43-68. NO READINGS IN EXCESS OF NORMAL BACKGROUND WERE NOTED.

O = WIPE LOCATION

## ID: MONTHLY WIPES

28 JAN 2000 14:22

USER: 5

COMMENT:

PRESET TIME : 1.00  
 DATA CALC : DL DPM H# : YES SAMPLE REPEATS: 1 PRINTER : EDIT  
 COUNT BLANK : YES IC# : NO REPLICATES : 1 RS232 : EDIT  
 TWO PHASE : NO AQC : YES CYCLE REPEATS : 1  
 SCINTILLATOR: LIQUID LUMEX: YES LOW SAMPLE REJ: 0  
 LOW LEVEL : NO HALF LIFE CORRECTION DATE: none

ISOTOPE 1: 3H %ERROR: 2.00 FACTOR: 1.000000 BKG. SUB: 0  
 ISOTOPE 2: 14C %ERROR: 2.00 FACTOR: 1.000000 BKG. SUB: 0  
 WIDE OPEN WINDOW %ERROR: 2.00 FACTOR: 1.000000 BKG. SUB: 0

BACKGROUND QUENCH CURVE: Off COLOR QUENCH CORRECTION: Off

Quench Limits Low: 2.756 High: 314.54

SAM NO	H#	3H CPM	14C CPM	WIDE CPM	3H DPM	14C DPM	LUMEX %
B1	44.2	17.00	13.00	47.00	23.46	17.01	14.94
1	44.8	20.00	11.00	41.00	5.99	-2.67	4.57
2	40.8	19.00	15.00	43.00	2.27	2.59	6.17
3	44.1	12.00	14.00	34.00	-8.91	1.38	11.76
4	53.4	16.00	8.00	36.00	1.18	-6.55	3.83
5	55.7	21.00	8.00	33.00	10.26	-6.60	4.31
6	45.8	20.00	13.00	38.00	5.25	-0.02	6.52
7	44.2	20.00	10.00	36.00	6.33	-4.00	13.40
8	43.2	24.00	13.00	43.00	11.75	-0.08	5.31
9	48.4	21.00	8.00	40.00	9.35	-6.63	7.13
10	51.5	15.00	7.00	32.00	-0.30	-7.88	4.47
11	51.1	12.00	10.00	43.00	-6.85	-3.87	2.57
12	50.0	22.00	8.00	41.00	11.27	-6.64	6.56
13	48.0	20.00	12.00	44.00	5.89	-1.33	6.90
14	43.8	16.00	5.00	28.00	1.58	-10.57	17.22
15	39.8	30.00	10.00	56.00	22.60	-4.14	6.82
16	45.8	16.00	10.00	39.00	-0.33	-3.95	5.38
17	42.1	19.00	12.00	50.00	3.62	-1.36	9.87
18	60.7	14.00	9.00	30.00	-2.18	-5.16	5.56
19	45.3	22.00	6.00	36.00	11.53	-9.31	6.06
20	44.5	21.00	12.00	39.00	7.24	-1.36	5.58
21	43.7	25.00	13.00	52.00	13.51	-0.09	6.39
22	47.3	14.00	7.00	32.00	-2.37	-7.89	9.36
23	45.0	21.00	8.00	38.00	8.95	-6.65	8.00
24	49.5	27.00	17.00	57.00	16.04	5.24	2.25
25	44.6	12.00	8.00	28.00	-6.39	-6.56	8.10
26	48.1	18.00	7.00	34.00	4.58	-7.93	10.08
27	53.0	19.00	7.00	35.00	6.84	-7.92	3.83
28	51.1	18.00	11.00	37.00	3.17	-2.61	15.01
29	47.7	22.00	9.00	41.00	10.56	-5.32	13.80
30	49.6	15.00	9.00	28.00	-1.32	-5.24	8.12
31	48.9	25.00	10.00	45.00	15.46	-4.02	4.52
32	47.7	16.00	6.00	39.00	1.52	-9.23	5.58
33	51.6	12.00	16.00	42.00	-9.40	4.10	3.12
34	44.1	17.00	16.00	37.00	-1.26	3.97	13.01
35	47.1	23.00	11.00	44.00	11.36	-2.69	7.77
36	49.5	17.00	8.00	31.00	2.56	-6.58	4.22
37	43.6	17.00	6.00	35.00	2.85	-9.26	7.65
38	47.2	16.00	6.00	34.00	1.47	-9.23	5.91

SAM	H#	3H	14C	WIDE	3H	14C	LUMEX
NQ		CFM	CFM	CFM	DPM	DPM	%
39	45.4	18.00	14.00	47.00	1.38	1.32	3.93
40	49.6	15.00	10.00	33.00	-1.74	-3.91	18.45
41	46.1	23.00	12.00	45.00	10.82	-1.37	6.48
42	53.9	21.00	9.00	41.00	9.59	-5.28	4.66
43	45.6	32.00	6.00	44.00	28.63	-9.41	10.71
44	46.3	21.00	10.00	43.00	8.27	-4.00	2.36
45	47.9	21.00	9.00	44.00	8.87	-5.31	6.51
46	43.7	23.00	9.00	47.00	11.78	-5.36	2.98
47	50.4	21.00	13.00	46.00	7.45	0.01	4.50
48	47.2	25.00	14.00	46.00	13.55	1.26	9.75
49	47.2	19.00	7.00	35.00	6.20	-7.94	7.38
50	51.1	19.00	3.00	30.00	8.34	-13.23	3.68
51	46.1	18.00	6.00	40.00	4.80	-9.26	10.35
52	47.6	17.00	10.00	33.00	1.54	-3.94	9.20
53	45.8	19.00	7.00	37.00	6.05	-7.95	6.60
54	42.9	15.00	7.00	26.00	-1.00	-7.92	7.35
55	43.1	24.00	15.00	53.00	10.92	2.56	3.23
56	48.2	17.00	12.00	47.00	0.75	-1.29	1.50
57	53.5	21.00	14.00	46.00	7.38	1.37	3.87
58	47.0	24.00	12.00	49.00	12.64	-1.38	5.16
59	49.4	11.00	11.00	28.00	-9.11	-2.54	2.48
60	45.8	16.00	9.00	37.00	0.09	-5.27	6.08
61	46.0	17.00	13.00	41.00	0.15	0.02	1.95
62	45.2	31.00	15.00	58.00	23.10	2.50	4.38
63	47.3	16.00	3.00	32.00	2.75	-13.21	4.53
64	44.6	15.00	6.00	27.00	-0.46	-9.23	7.45
65	55.3	14.00	9.00	32.00	-2.62	-5.19	5.52
66	52.7	17.00	8.00	31.00	2.87	-6.57	7.89
67	52.7	18.00	13.00	41.00	2.46	0.06	7.52
68	50.8	10.00	13.00	30.00	-11.63	0.13	14.17
69	48.3	22.00	5.00	36.00	12.34	-10.62	9.37
70	45.9	23.00	9.00	39.00	12.05	-5.34	9.84
71	49.8	14.00	6.00	29.00	-1.76	-9.20	9.08
72	56.4	13.00	14.00	42.00	-6.51	1.48	7.95
73	51.0	15.00	5.00	28.00	0.51	-10.54	4.77
74	54.9	18.00	18.00	45.00	0.49	6.73	3.15
75	52.3	19.00	9.00	35.00	5.90	-5.26	13.64
76	50.4	18.00	7.00	32.00	4.81	-7.92	10.94
77	50.8	16.00	15.00	43.00	-2.05	2.72	20.22
78	53.5	18.00	9.00	33.00	4.27	-5.25	5.38
79	48.0	22.00	7.00	42.00	11.45	-7.97	9.00
80	46.5	13.00	8.00	33.00	-4.56	-6.56	10.44
81	51.2	22.00	14.00	53.00	8.86	1.33	0.75
82	46.4	21.00	11.00	43.00	7.86	-2.67	6.52
83	66.9	16.00	13.00	38.00	0.20	0.20	5.44
84	52.5	13.00	13.00	36.00	-6.31	0.12	6.43
85	50.5	12.00	6.00	23.00	-5.18	-9.18	11.27
86	51.9	15.00	7.00	25.00	-0.27	-7.88	1.80
87	55.8	20.00	11.00	36.00	7.18	-2.59	3.22
88	56.8	14.00	10.00	37.00	-2.94	-3.85	2.12
89	51.5	20.00	16.00	50.00	4.54	4.01	4.65
90	50.3	13.00	17.00	45.00	-8.15	5.40	6.16
91	50.4	22.00	6.00	37.00	12.18	-9.29	5.83
92	48.4	23.00	8.00	47.00	12.80	-6.66	6.10
93	51.5	19.00	10.00	35.00	5.38	-3.94	23.31
94	48.4	24.00	12.00	48.00	12.83	-1.36	4.57
95	61.3	14.00	6.00	36.00	-0.78	-9.16	13.84
96	55.0	25.00	11.00	46.00	15.92	-2.65	1.77

SAM NO	H#	3H CPM	14C CPM	WIDE CPM	3H DPM	14C DPM	LUMEX %
97	46.0	14.00	12.00	36.00	-4.57	-1.28	6.69
98	50.8	18.00	14.00	40.00	1.85	1.37	1.28
99	51.5	14.00	6.00	28.00	-1.62	-9.20	2.03
100	51.6	17.00	11.00	40.00	1.47	-2.59	7.28
101	59.4	18.00	15.00	44.00	2.23	2.79	5.99
102	53.0	18.00	9.00	47.00	4.22	-5.25	4.98
103	56.3	13.00	12.00	33.00	-5.63	-1.18	15.56
104	61.2	19.00	14.00	43.00	4.67	1.46	6.85
105	47.8	26.00	12.00	44.00	16.19	-1.39	5.45
106	48.1	16.00	6.00	31.00	1.55	-9.23	8.97
107	54.5	15.00	16.00	42.00	-3.96	4.10	4.18
108	52.2	16.00	15.00	41.00	-1.94	2.74	4.45
109	52.6	13.00	12.00	37.00	-5.87	-1.21	9.74
110	51.1	15.00	13.00	40.00	-2.91	0.08	3.23
111	49.1	15.00	10.00	34.00	-1.78	-3.91	9.67
112	51.6	14.00	13.00	34.00	-4.62	0.10	3.85
113	52.6	18.00	13.00	42.00	2.45	0.06	6.35
114	50.6	15.00	7.00	31.00	-0.38	-7.88	9.16
115	51.6	13.00	9.00	39.00	-4.65	-5.20	4.09
116	54.9	17.00	11.00	37.00	1.78	-2.57	5.81
117	50.8	19.00	10.00	35.00	5.30	-3.95	8.43
118	50.3	28.00	11.00	50.00	20.45	-2.72	5.38
119	50.4	24.00	10.00	45.00	13.94	-4.00	7.66
120	52.2	14.00	8.00	33.00	-2.42	-6.54	6.86
121	51.4	15.00	8.00	32.00	-0.74	-6.55	5.00
122	49.7	22.00	10.00	40.00	10.39	-3.99	4.56
123	49.9	21.00	9.00	40.00	9.11	-5.30	11.29
124	50.1	25.00	8.00	42.00	16.49	-6.67	5.69
125	50.9	16.00	12.00	39.00	-0.76	-1.26	9.33
126	50.1	20.00	14.00	45.00	5.26	1.34	4.78
127	51.8	19.00	9.00	38.00	5.85	-5.27	3.60
128	53.8	18.00	11.00	37.00	3.43	-2.59	19.33
129	53.7	24.00	10.00	39.00	14.42	-3.98	5.29
130	49.8	20.00	12.00	35.00	6.08	-1.31	7.53
131	52.9	13.00	11.00	33.00	-5.42	-2.54	16.67
132	50.1	22.00	13.00	45.00	9.16	-0.00	3.87
133	52.2	18.00	10.00	37.00	3.71	-3.93	5.73
134	54.2	22.00	9.00	41.00	11.39	-5.29	4.77
135	55.3	16.00	11.00	37.00	0.05	-2.55	3.82
136	55.4	26.00	16.00	52.00	15.56	3.99	4.22
137	54.6	14.00	10.00	35.00	-3.11	-3.87	2.75
138	63.3	17.00	8.00	36.00	3.97	-6.51	13.29
139	54.6	17.00	6.00	34.00	3.93	-9.22	6.80
140	62.3	19.00	13.00	39.00	5.25	0.13	5.11
141	63.7	10.00	8.00	27.00	-8.80	-6.43	3.13
142	62.1	14.00	7.00	35.00	-1.16	-7.82	4.35
143	54.0	16.00	11.00	37.00	-0.07	-2.56	2.07
144	53.1	15.00	11.00	37.00	-1.90	-2.56	4.65
145	51.3	20.00	10.00	38.00	7.10	-3.95	5.39
146	50.6	14.00	13.00	41.00	-4.68	0.09	7.05
147	57.1	11.00	11.00	29.00	-8.71	-2.49	2.56
148	52.7	24.00	8.00	44.00	15.14	-6.64	4.44
149	61.4	17.00	7.00	32.00	4.22	-7.86	15.17
150	57.5	11.00	9.00	34.00	-7.80	-5.15	13.99
151	56.5	13.00	11.00	35.00	-5.18	-2.51	6.60
152	63.3	17.00	8.00	35.00	3.98	-6.51	5.71
153	58.6	13.00	11.00	35.00	-5.04	-2.50	7.01
154	55.7	20.00	13.00	42.00	6.30	0.07	0.83

SAM NO	H#	3H CFM	14C CFM	WIDE CFM	3H DFM	14C DFM	LUMEX %
155	51.3	14.00	10.00	37.00	-3.35	-3.89	7.56
156	59.2	19.00	12.00	38.00	5.34	-1.23	3.99
157	55.4	17.00	16.00	40.00	-0.36	4.09	1.81
158	52.8	15.00	14.00	36.00	-3.22	1.42	10.38
159	56.3	18.00	15.00	44.00	1.93	2.75	7.44
160	52.5	18.00	11.00	39.00	3.30	-2.60	6.33
161	61.1	18.00	13.00	37.00	3.30	0.13	5.05
162	55.5	20.00	11.00	39.00	7.15	-2.60	2.68
163	54.9	22.00	12.00	41.00	10.18	-1.29	5.35
164	55.0	14.00	8.00	34.00	-2.20	-6.52	4.03
165	56.9	17.00	12.00	32.00	1.52	-1.22	11.58
166	54.4	12.00	9.00	29.00	-6.22	-5.18	8.80
167	59.9	18.00	8.00	35.00	5.41	-6.54	4.93
168	54.3	21.00	9.00	41.00	9.65	-5.27	8.73
169	52.6	19.00	11.00	38.00	5.06	-2.61	4.77
170	54.9	12.00	13.00	36.00	-7.93	0.15	2.86
171	57.1	26.00	11.00	49.00	18.04	-2.65	6.53
172	55.9	19.00	14.00	47.00	4.11	1.41	1.21
173	53.0	19.00	9.00	34.00	5.97	-5.26	6.30
174	58.9	25.00	13.00	46.00	15.64	0.04	6.19
175	52.4	15.00	12.00	36.00	-2.38	-1.24	7.96
176	55.0	24.00	12.00	47.00	13.72	-1.31	7.64
177	59.0	16.00	13.00	36.00	-0.51	0.14	1.26
178	54.2	17.00	13.00	41.00	0.84	0.09	8.94
179	55.2	17.00	10.00	39.00	2.25	-3.90	1.67
180	49.8	26.00	11.00	51.00	16.90	-2.70	6.79
181	56.0	19.00	9.00	38.00	6.32	-5.24	3.31
182	60.0	12.00	12.00	34.00	-7.19	-1.14	6.41
183	63.8	14.00	7.00	28.00	-1.01	-7.81	6.22
184	57.0	15.00	14.00	38.00	-2.91	1.46	8.97
185	57.4	31.00	4.00	42.00	30.10	-12.02	3.69
186	49.9	16.00	9.00	33.00	0.44	-5.25	12.01
187	53.0	15.00	10.00	41.00	-1.48	-3.89	3.33
188	53.1	18.00	13.00	37.00	2.50	0.07	3.05
189	53.1	21.00	6.00	35.00	10.80	-9.27	5.78
190	55.2	26.00	8.00	41.00	19.04	-6.65	5.11
191	60.8	15.00	5.00	30.00	1.44	-10.51	5.30
192	50.6	13.00	9.00	35.00	-4.71	-5.21	3.33
193	62.0	23.00	11.00	44.00	13.39	-2.58	1.64
194	49.5	19.00	7.00	38.00	6.45	-7.93	1.20
195	49.9	12.00	17.00	44.00	-9.90	5.41	4.96
196	68.0	18.00	9.00	35.00	5.91	-5.16	9.96
197	64.2	21.00	11.00	49.00	10.05	-2.55	3.01