

Radiological Survey Sheet

Job Location Pfizer, Inc. Groton, Ct. 06340 48W/4105 Page 1 15
 Survey Purpose ^{RA} Radiologic Survey of Equipment LAB DECOMM. Date 9-27-12
 Performed by E. SAILOR E. Sailor
 (Print) (Sign)

Instrument (Model/S/N)	Packard Tri-Carb S/N 431521	Packard Tri-Carb S/N 431520	Ludlum 2241-2 163603	Wallac Model 1409 S/N 4061042
Det. (Model/SN)	Internal	Internal	Ludlum 43-68 PR 149613	Internal
Type Rad.	β	β	β	β
Cal. Due:	03/05/2013	03/05/2013	04/17/2013	09/15/2012
Check Instruments Used	✓	.	✓	

No.	Time	Locations	See attached LSC printout for Total Activity (cpm/100 cm ²)
1.	0930	BACKGROUND	
2.		door	
3.		FLOOR	
4.		UPPER WALL	
5.		LOWER "	
6.		UPPER "	
7.		LOWER "	
8.		UPPER "	
9.		LOWER "	
10.		TOP SHELF	
11.		BOTTOM "	
12.		FLOOR	
13.		FLOOR	
14.		WALL	
15.		"	
16.		TOP SHELF	
17.		2ND "	
18.	✓	3RD "	

Radiological Survey Continuation Sheet

Page 2 of 15

Date 9-27-12

No.	Time	Locations	See attached LSC printout for Total Activity (cpm/100 cm ²)
19	0730	4TH SHELF	
20		TOP "	
21		2ND "	
22		BOTTOM "	
23		CAB DOORS	
25		" TOP SHELF	
25		" 2ND "	
26		" 3RD "	
27		" BOTTOM "	
28		" DOORS	
29		" TOP SHELF	
30		" 2ND "	
31		" 3RD "	
32		" 4TH "	
33		TOP SHELF	
34		2ND "	
35		3RD "	
36		4TH "	
37		TOP "	
38		2ND "	
39		3RD "	
40		TOP "	
41		2ND "	
42		3RD "	
43		DRAWER	
44		"	
45	✓	"	

Radiological Survey Continuation Sheet

Page 3 of 15

Date 9-27-12

No.	Time	Locations	See attached LSC printout for Total Activity (cpm/100 cm ²)
46	0930	Drawer	
47		TOP dWR	
48		2nd "	
49		3rd "	
50		4TH "	
51		5TH "	
52		6TH "	
53		7TH "	
54		8TH "	
55		dWR	
56		"	
57		TOP LEFT 2 dWRS	
58		" RIGHT " "	
59		1ST LARGE "	
60		2nd " "	
61		3rd " "	
62		TOP 3 dWRS	
63		1ST LARGE dWR	
64		2nd " "	
65		3rd " "	
66		dWR	
67		"	
68		"	
69		"	
70		CAB.	
71		BENCH	
72	✓	BENCH	

Radiological Survey Continuation Sheet

Page 4 of 15

Date 9-27-12

No.	Time	Locations	See attached LSC printout for Total Activity (cpm/100 cm ²)
24	0930	BENCH	
25		"	
26		"	
27		"	
28		"	
29		TOP SHELF	
80		2ND "	
81		3RD "	
82		TOP "	
83		2ND "	
84		3RD "	
85		dwr	
86		"	
87		"	
88		"	
89		TOP RLEFT dwr	
90		" RIGHT "	
91		2ND LEFT "	
92		" RIGHT "	
93		1ST LARGE "	
94		2ND " "	
95		BENCH	
96		"	
97		"	
98		FLOOR	
99		"	
100	✓	"	

Radiological Survey Continuation Sheet

Page 5 of 15

Date 9-27-12

No.	Time	Locations	See attached LSC printout for Total Activity (cpm/100 cm ²)
101	0930	FLOOR	
102		"	
103		TOP SHELF	
104		2ND "	
105		3RD "	
106		TOP "	
107		2ND "	
108		3RD "	
109		BENCH	
110		"	
111		"	
112		CAB	
113		TOP dWR	
114		2ND "	
115		3RD "	
116		4TH "	
117		TOP SHELF	
118		2ND "	
119		3RD "	
120		TOP "	
121		2ND "	
122		BENCH	
123		"	
124		"	
125		dWR	
126		"	
127		"	

Radiological Survey Continuation Sheet

Page 6 of 15

Date 9-27-12

No.	Time	Locations	See attached LSC printout for Total Activity (cpm/100 cm ²)
128	0930	dwr	
129		"	
130		CAB	
131		dwr	
132		CAB	
133		dwr	
134		"	
135		"	
136		"	
137		FLOOR	
138		"	
139		"	
140		"	
141		"	
142		SHELF	
143		"	
144		BENCH	
145		"	
146		"	
147		dwr	
148		"	
149		"	
150		"	
151		"	
152		"	
153		"	
154	✓	"	

Radiological Survey Continuation Sheet

Page 7 of 15

Date 9-27-12

No.	Time	Locations	See attached LSC printout for Total Activity (cpm/100 cm ²)
155	0930	DWR	
156		FLOOR	
157		"	
158		"	
159		"	
160		"	
161		DESK	
162		"	
163		FLOOR	
164		CAD	
165		UPPER WALL	
166		LOWER "	
167		DESK	
168		DESK	
169		FLOOR	
170		door	
171		"	
172		TOP SHELF	
173		2ND "	
174		3RD "	
175		UPPER WALL	
176		LOWER "	
177		FLOOR "	
178		"	
179		SHELF	
180		"	
181	✓	CAD doors	

Radiological Survey Continuation Sheet

Page 8 of 15

Date 9-27-12

No.	Time	Locations	See attached LSC printout for Total Activity (cpm/100 cm ²)
182	0930	CAB TOP SHELF	
183		" 2ND "	
184		" 3RD "	
185		" 4TH "	
186		SHELF	
187		BENCH	
188		"	
189		SINK AREA	
190		DRW	
191		"	
192		"	
193		"	
194		"	
195		CAB LEFT door	
196		" " INSIDE	
197		" RIGHT door	
198		" " INSIDE	
199		HOOD LEFT side	
200		" " BACK	
201		" middle "	
202		" RIGHT "	
203		" " SIDE	
204		" " BOTTOM	
205		" middle "	
206		" LEFT "	
207		" SASH	
208		" LIP	

Bld. 118W Room W105

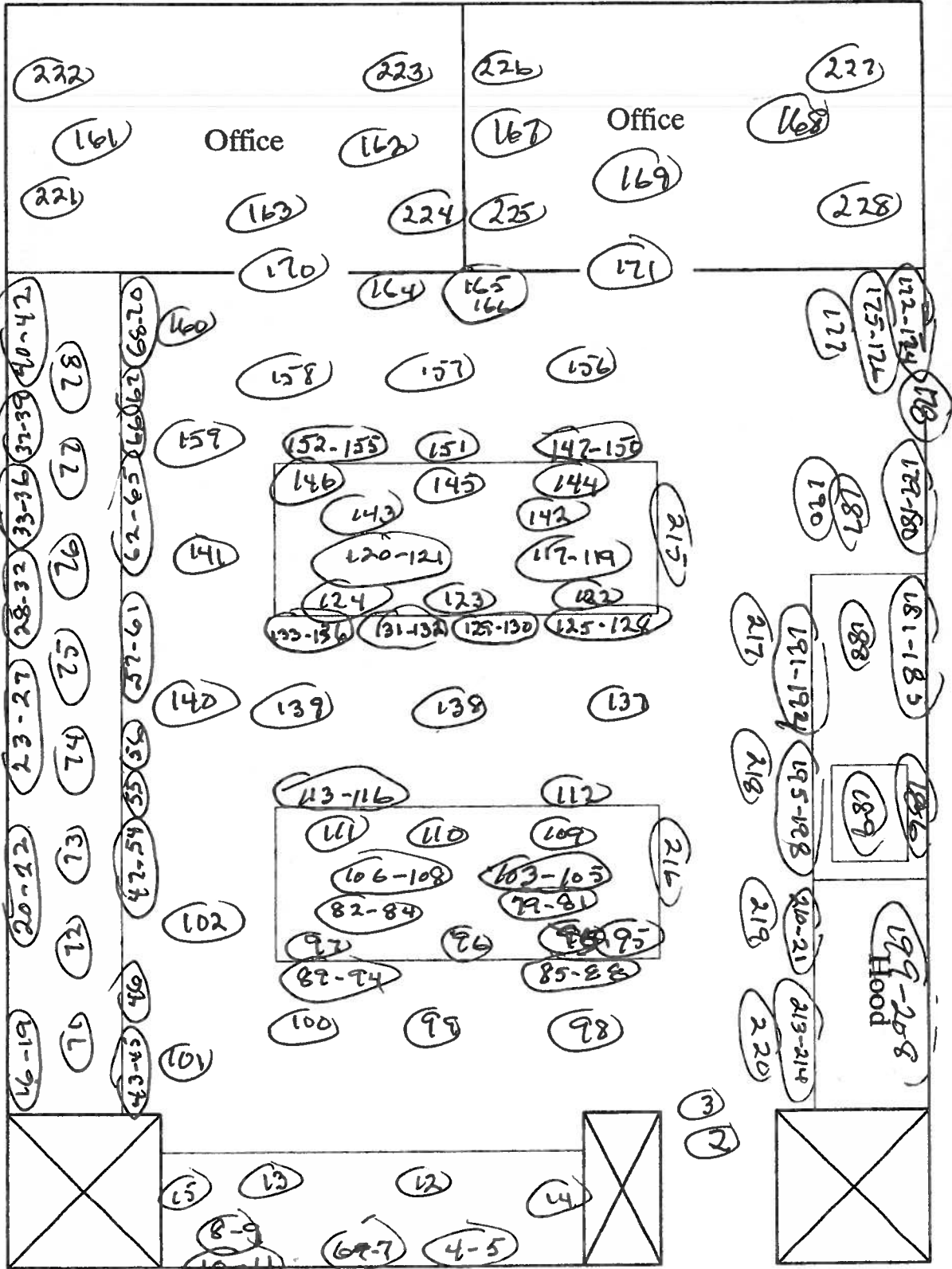

- Sampled no. of loose surfaces using 43-68. no readings observed over normal background levels.

○ = wipe location

Assay Definition-

Assay Description:
 Equipment Swipes

Assay Type: CPM

Report Name: Report1

Output Data Path: C:\Packard\Tricarb\Results\Ed Gailor\Eds Monthly Swipes

Raw Results Path: C:\Packard\Tricarb\Results\Ed Gailor\Eds Monthly Swipes\20120927_1200
 \20120927_1200.results

RTF File Name: C:\Packard\Tricarb\Results\Ed Gailor\Eds Monthly Swipes\Ed's Monthly Swipes.rtf

Assay File Name: C:\Packard\TriCarb\Assays\Eds Monthly Swipes.lsa

Count Conditions-

Nuclide: Triple

Quench Indicator: tSIE/AEC

External Std Terminator (sec): 5 sec

Pre-Count Delay (min): 0.00

Quench Set: n/a

Count Time (min): 1.00

Count Mode: Normal

Assay Count Cycles: 1

Repeat Sample Count: 1

#Vials/Sample: 1

Calculate % Reference: Off

Background Subtract: On - Manual

Low CPM Threshold: Off

2 Sigma % Terminator: Off

Regions	LL	UL	Bkg Subtract
A	0.0	18.6	0.00
B	18.6	156.0	0.00
C	0.0	2000.0	0.00

Count Corrections-

Static Controller: On

Luminescence Correction: On

Colored Samples: n/a

Heterogeneity Monitor: n/a

Coincidence Time (nsec): 18

Delay Before Burst (nsec): 75

Half Life-

Half Life Correction: Off

Regions	Half Life	Units	Reference Date	Reference Time
A				
B				
C				

Cycle 1 Results

S#	CPMA	CPMB	CPMC	MESSAGES
1	12	11	33	
2	8	9	23	
3	8	13	26	
4	14	8	24	
5	16	3	23	
6	4	3	9	
7	6	5	17	
8	5	8	15	
9	6	5	15	
10	8	6	20	

11	15	7	28
12	8	5	18
13	5	8	17
14	2	3	11
15	6	6	19
16	2	4	9
17	1	9	13
18	1	9	12
19	6	9	16
20	8	4	17
21	15	12	35
22	0	7	13
23	5	7	16
24	10	10	23
25	7	7	18
26	8	7	22
27	11	7	22
28	4	7	13
29	5	12	18
30	7	6	18
31	7	7	15
32	11	10	24
33	5	7	19
34	9	12	27
35	6	10	18
36	11	3	20
37	14	3	26
38	6	7	17
39	2	12	25
40	5	9	20
41	8	11	25
42	3	4	12
43	8	9	24
44	16	11	31
45	10	6	20
46	9	6	18
47	7	7	16
48	7	6	18
49	11	7	27
50	10	6	18
51	0	2	10
52	10	9	26
53	14	9	28
54	9	8	23
55	6	7	20
56	5	13	23
57	6	5	15
58	10	6	20
59	5	7	19
60	8	5	18
61	13	10	28
62	16	8	29
63	11	6	25
64	12	5	19
65	5	4	15
66	15	8	27
67	5	9	16
68	5	7	13
69	4	7	22
70	9	4	19
71	8	12	22
72	7	7	20
73	9	12	25

Protocol# 4 - Eds Monthly Swipes.lsa

User: Ed Gallor

74	7	8	19
75	10	8	20
76	6	10	20
77	11	9	20
78	12	5	22
79	8	7	20
80	7	4	16
81	9	5	26
82	5	6	15
83	10	11	26
84	4	15	24
85	9	5	16
86	6	7	22
87	19	8	35
88	2	5	8
89	6	8	18
90	8	8	26
91	6	8	18
92	10	10	24
93	12	9	24
94	10	9	25
95	9	5	16
96	14	11	35
97	10	10	26
98	7	11	22
99	3	5	13
100	6	7	17
101	16	6	25
102	6	7	17
103	12	13	29
104	4	9	14
105	9	4	18
106	6	8	19
107	10	7	20
108	6	5	14
109	14	6	23
110	7	5	18
111	15	6	25
112	12	9	26
113	2	4	11
114	4	11	21
115	7	9	23
116	5	11	22
117	14	8	25
118	13	6	24
119	14	5	23
120	13	6	24
121	4	10	21
122	5	12	22
123	11	7	25
124	0	12	16
125	19	3	27
126	3	10	17
127	11	11	28
128	4	9	21
129	4	13	23
130	1	8	14
131	11	6	22
132	0	8	13
133	9	6	20
134	5	4	14
135	4	8	21
136	11	6	21

137	2	3	10
138	5	6	17
139	3	8	13
140	5	11	23
141	11	12	31
142	9	13	28
143	3	6	11
144	10	12	28
145	8	12	27
146	11	10	25
147	6	7	18
148	13	9	23
149	8	12	24
150	1	7	9
151	12	7	27
152	8	5	19
153	8	13	25
154	5	10	21
155	19	13	38
156	2	11	17
157	3	9	18
158	10	15	29
159	8	10	26
160	8	5	23
161	4	11	26
162	1	4	10
163	9	6	17
164	1	4	8
165	13	5	22
166	9	7	21
167	8	7	19
168	8	4	17
169	14	9	30
170	5	3	11
171	6	10	23
172	8	6	19
173	11	7	24
174	10	9	22
175	3	8	14
176	5	7	17
177	14	8	25
178	10	4	20
179	11	11	24
180	8	10	20
181	13	13	31
182	4	15	24
183	7	9	24
184	6	8	19
185	5	11	20
186	15	11	34
187	1	7	11
188	15	7	28
189	7	9	19
190	6	5	16
191	6	6	17
192	4	9	18
193	2	9	19
194	7	11	22
195	8	12	26
196	0	7	10
197	4	10	21
198	5	5	14
199	8	20	33

200	2	13	29
201	8	10	23
202	10	10	25
203	13	12	31
204	13	13	28
205	10	9	24
206	0	7	10
207	4	14	21
208	5	8	16
209	13	7	25
210	7	17	29
211	2	11	19
212	3	10	18
213	9	11	26
214	14	8	29
215	6	9	18
216	13	8	29
217	7	14	28
218	2	14	23
219	10	7	24
220	0	8	13
221	5	11	23
222	8	9	25
223	15	11	34
224	11	6	23
225	5	8	20
226	16	5	24
227	6	10	19
228	0	12	20