

## Radiological Survey Sheet

Job Location Pfizer, Inc. Groton, Ct. 06340

PAGE 1 of 5

Survey Purpose DECOMMISSIONING BASEMENT 118W

Date 6/21/13

Performed by DAVID DALLICE  
(Print)

  
(Sign)

<b>Instrument (Model/S/N)</b>	Packard Tri-Carb S/N 431521	Packard Tri-Carb S/N 431520	Ludlum 2241-2 163603	
<b>Det. (Model/SN)</b>	Internal	Internal	Ludlum 43-68 PR 149613	
<b>Type Rad.</b>	β	β	β	
<b>Cal. Due:</b>	03/05/2013	03/05/2013	04/17/2013	
<b>Check Instruments Used</b>		✓	✓	

No.	Time	Locations	See attached LSC printout for Total Activity (cpm/100 cm <sup>2</sup> )	
1.	1255	BACKGROUND		
2.		Floor		
3.		Floor		
4.		Floor		
5.		Floor		
6.		Floor		
7.		Floor		
8.		Floor		
9.		Floor		
10.		Floor		
11.		Floor		
12.		Floor		
13.		Floor		
14.		Floor		
15.		Floor		
16.		Floor		
17.		Floor		
18.		↓	Floor	



BREMONT 118W  
 OLD FACIAL STORAGE AREA FLOOR

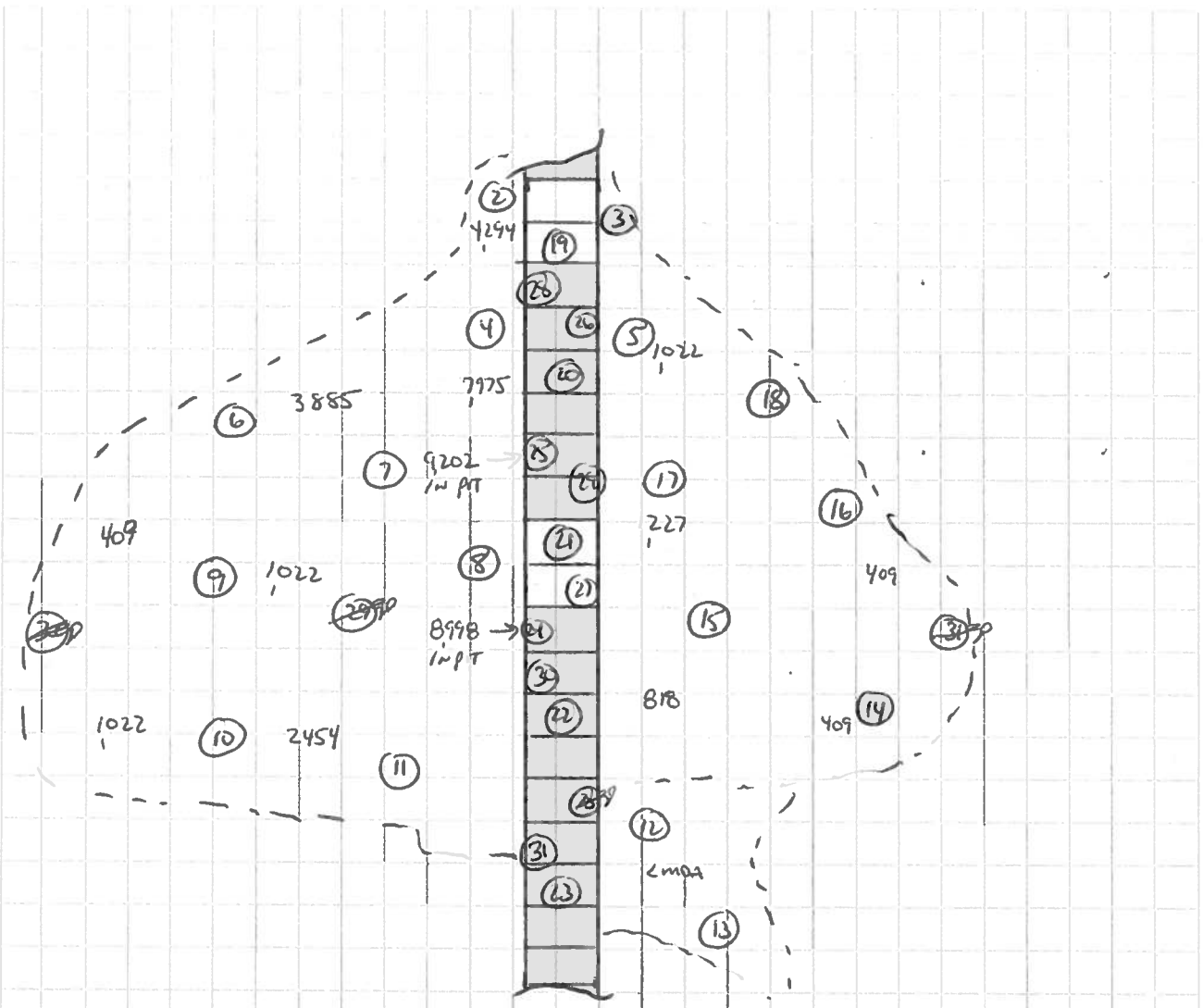

DECONTAMINATED FLOOR BY SCRUBBLING (CARBURA SERVICES). SURFACES SURVEYED USING 4368. READINGS IN UNITS OF DPM/100CM<sup>2</sup>.

○ - wipe locations

Assay Definition-

Assay Description:  
Background check for PM Lab (Mikey)

Assay Type: CPM  
Report Name: Report1  
Output Data Path: C:\Packard\Tricarb\Results\bill\bills swipes  
Raw Results Path: C:\Packard\Tricarb\Results\bill\bills swipes\20130621\_1212\20130621\_1212.results  
RTF File Name: C:\Packard\Tricarb\Results\bill\bills swipes\Report1.rtf  
Assay File Name: C:\Packard\TriCarb\Assays\bills swipes.lsa

Count Conditions-

Nuclide: TRIPLE  
Quench Indicator: tSIE/AEC  
External Std Terminator (sec): 0.5 2s%  
Pre-Count Delay (min): 0.00  
Quench Set: n/a  
Count Time (min): 1.00  
Count Mode: Normal  
Assay Count Cycles: 1 Repeat Sample Count: 1  
#Vials/Sample: 1 Calculate % Reference: Off

Background Subtract: Off  
Low CPM Threshold: Off  
2 Sigma % Terminator: Off

Regions	LL	UL
A	0.0	18.6
B	18.6	156.0
C	0.0	2000.0

Count Corrections-

Static Controller: On Luminescence Correction: On  
Colored Samples: n/a Heterogeneity Monitor: n/a  
Coincidence Time (nsec): 18 Delay Before Burst (nsec): 75

Half Life-

Half Life Correction: Off

Regions	Half Life	Units	Reference Date	Reference Time
A				
B				
C				

Cycle 1 Results

S#	CPMA	CPMB	CPMC	MESSAGES	PID	Custom1
1	11	4	20		1	
2	8	5	19		1	
3	11	7	23		1	
4	14	9	28		1	
5	17	7	29		1	
6	12	10	30		1	
7	16	5	22		1	
8	9	4	16		1	
9	11	4	18		1	
10	16	3	23		1	
11	12	10	25		1	

12	16	13	33	1
13	11	10	27	1
14	10	8	21	1
15	13	8	27	1
16	5	8	18	1
17	8	8	19	1
18	7	5	15	1
19	13	14	29	29
20	9	6	18	29
21	23	15	39	29
22	16	11	37	29
23	5	5	10	29
24	13	7	23	29
25	10	5	20	29
26	9	10	21	29
27	11	9	21	29
28	14	9	29	29
29	10	7	20	29
30	9	6	20	29
31	12	4	21	29
<del>Missing vial 32.</del>				
<del>32</del>	<del>16</del>	<del>8</del>	<del>26</del>	<del>29</del>
<del>33</del>	<del>8</del>	<del>6</del>	<del>18</del>	<del>29</del>
<del>34</del>	<del>13</del>	<del>7</del>	<del>26</del>	<del>29</del>
<del>Missing vial 36.</del>				
<del>37</del>	<del>8</del>	<del>6</del>	<del>19</del>	<del>9</del>
<del>38</del>	<del>10</del>	<del>6</del>	<del>20</del>	<del>9</del>
<del>39</del>	<del>12</del>	<del>4</del>	<del>19</del>	<del>9</del>
<del>40</del>	<del>9</del>	<del>4</del>	<del>17</del>	<del>9</del>
<del>41</del>	<del>11</del>	<del>3</del>	<del>18</del>	<del>9</del>
<del>42</del>	<del>9</del>	<del>3</del>	<del>13</del>	<del>9</del>
<del>43</del>	<del>9</del>	<del>5</del>	<del>19</del>	<del>9</del>
<del>44</del>	<del>10</del>	<del>1</del>	<del>14</del>	<del>9</del>
<del>45</del>	<del>11</del>	<del>8</del>	<del>25</del>	<del>9</del>
<del>46</del>	<del>8</del>	<del>9</del>	<del>21</del>	<del>9</del>
<del>47</del>	<del>11</del>	<del>3</del>	<del>18</del>	<del>9</del>
<del>48</del>	<del>10</del>	<del>6</del>	<del>21</del>	<del>9</del>
<del>49</del>	<del>7</del>	<del>9</del>	<del>24</del>	<del>9</del>
<del>50</del>	<del>14</del>	<del>9</del>	<del>32</del>	<del>9</del>
<del>51</del>	<del>7</del>	<del>4</del>	<del>14</del>	<del>9</del>
<del>52</del>	<del>18</del>	<del>6</del>	<del>30</del>	<del>9</del>
<del>53</del>	<del>14</del>	<del>5</del>	<del>26</del>	<del>9</del>
<del>Missing vial 54.</del>				
<del>55</del>	<del>7</del>	<del>5</del>	<del>18</del>	<del>28</del>
<del>56</del>	<del>19</del>	<del>7</del>	<del>29</del>	<del>28</del>
<del>57</del>	<del>15</del>	<del>6</del>	<del>24</del>	<del>28</del>
<del>58</del>	<del>16</del>	<del>8</del>	<del>29</del>	<del>28</del>
<del>59</del>	<del>20</del>	<del>7</del>	<del>31</del>	<del>28</del>
<del>60</del>	<del>18</del>	<del>1</del>	<del>20</del>	<del>28</del>
<del>61</del>	<del>44</del>	<del>24</del>	<del>72</del>	<del>28</del>
<del>62</del>	<del>19</del>	<del>9</del>	<del>29</del>	<del>28</del>
<del>63</del>	<del>10</del>	<del>3</del>	<del>18</del>	<del>28</del>