

Radiological Survey Sheet

Job Location PIKER GROTON CT 06340 Page 1 of 21
 Survey Purpose LAB DECON 118N NZIS Date 11/17/06
 Performed by PIKERFE (Print) [Signature] (Sign)

Instrument (Model/S/N)	Packard Tri-Carb S/N 431521	Packard Tri-Carb S/N 431520	Ludlum 2241-2 163603	Wallac Model 1409 S/N 4061042
Det. (Model/SN)	Internal	Internal	Ludlum 43-68 PR 149613	Internal
Type Rad.	β	β	β	β
Cal. Due:	09/17/2007	09/17/2007	04/14/2007	09/17/2007
Check Instruments Used			X	X

No.	Time	Locations	See attached LSC printout for Total Activity (cpm/100 cm ²)	
1.	1100	BACKGROUND		
2.		ENTRANCE DOOR - OUT		
3.		- IN		
4.		WALL SWIPE		
5.		SHOWER HANDLE		
6.		WALL SWIPES - UPPER		
7.		- LOWER		
8.		WALL SWIPES - UPPER		
9.		- LOWER		
10.		WALL SWIPES - UPPER		
11.		- LOWER		
12.		OVERHEAD CABINET # 1 - OUTSIDE - DOORS		
13.		- BOTTOM		
14.		- INSIDE - LEFT / RIGHT		
15.		- REAR / BOT		
16.		- shelves		
17.		▽	BENCHTOP UNDER CABINET	
18.		1120	CABINET - OUTSIDE - DOORS	

Radiological Survey Continuation Sheet

Page 2 of 21

Date 11/17/06

LAB DECON 118N NZ15

No.	Time	Locations	See attached LSC printout for Total Activity (cpm/100 cm ²)
19	1120	CABINET - INSIDE - LEFT / RIGHT	
20		- REAR / BOT	
21		- Shelf	
22		OVERHEAD CABINET #2 - OUTSIDE - DOORS	
23		- Bottom	
24		- INSIDE - LEFT / RIGHT	
25		- REAR / BOTTOM	
26		- Shelf	
27		BENCHTOP UNDER CABINET	
28		DRAW - OUT	
29		- IN	
30		CABINET - OUTSIDE - DOOR	
31		- RIGHT	
32		- INSIDE - LEFT / RIGHT	
33		- REAR / BOTTOM	
34		- Shelf	
35		ALCOVE - LEFT / RIGHT	
36		- REAR / BOTTOM	
37		OVERHEAD CABINET #3 - OUTSIDE - DOOR	
38		- Bottom	
39		- INSIDE - LEFT / RIGHT	
40		- Bottom / REAR	
41		- Shelf	
42		BENCHTOP UNDER CABINET	
43		CABINET - OUTSIDE - DOOR	
44	▽	- RIGHT	
45	1135	- INSIDE - LEFT / RIGHT	

Radiological Survey Continuation Sheet

Page 3 of 21Date 11/17/06

LAB DECON 118N NZLS

No.	Time	Locations	See attached LSC printout for Total Activity (cpm/100 cm ²)
46	1135	CABINET - INSIDE - REAR	BOTTOM
47			- Shelf
48		LAB DOOR	- OUT
49			- IN
50		Wall SWIPE	- UPPER
51			- LOWER
52		DESKTOP	- LEFT
53			- RIGHT
54		overhead shelves	- TOP
55			- MID
56			- BOTTOM
57		Window	- LEFT
58			- RIGHT
59		CABINETS	- LEFT - OUT
60			- IN
61			- RIGHT - OUT
62			- IN
63		Door	- OUT
64			- IN
65		Shelves	- TOP
66			- BOTTOM
67		BENCHTOP	
68		DRAW	- OUT
69			- IN
70		CABINET	- OUT - DOOR
71			- LEFT
72	1150		- INSIDE - LEFT / REAR

Radiological Survey Continuation Sheet

Page 4 of 21

Date 11/17/06

LAB DeCON 118N NZ15

No.	Time	Locations	See attached LSC printout for Total Activity (cpm/100 cm ²)
73	1300	CABINET - INSIDE - REAR / BOTTOM	
74		- shelf	
75		Wall SWIPES - UPPER	
76		- LOWER	
77		DESKTOP - LEFT / RIGHT	
78		- DRAWS - LEFT - OUT	
79		- IN	
80		FILE CABINET - OUT	
81		- IN	
82		Window	
83		Desktop	
84		shelves	
85		DRAW - RIGHT - OUT	
86		- IN	
87		Desktop	
88		DRAWS - LEFT - OUT	
89		- IN	
90		shelves	
91		Window	
92		CABINET - OUT	
93		- IN	
94		Sliding GLASS DOOR - OUT	
95		- IN	
96		Wall SWIPES - UPPER	
97		- LOWER	
98		Wall SWIPES - LEFT	
99	1320	- RIGHT	

Radiological Survey Continuation Sheet

Page 5 of 21

Date 11/17/06

LAB DECON 118N N215

No.	Time	Locations	See attached LSC printout for Total Activity (cpm/100 cm ²)
100	1320	FUME HOOD -031 - OUTSIDE - UPPER	
101		- CENTER AREA	
102		- GLASS SASH	
103		- CONTROLS - LEFT	
104		- RIGHT	
105		- SPLASH GUARD	
106		- INSIDE - LEFT	
107		- RIGHT	
108		- REAR	
109		- COUNTERTOP	
110		CABINET under Hood - LEFT - OUT	
111		- IN	
112		- CENTER - OUT	
113		- IN	
114		- RIGHT - OUT	
115		- IN	
116		Wall Swipe - Upper	
117		- Lower	
118		OVERHEAD CABINET #4 - OUT - DOORS	
119		- BOTTOM	
120		- INSIDE - LEFT / RIGHT	
121		- REAR / BOTTOM	
122		- shelf	
123		GLASS RACK	
124		FAUCET	
125		BASIN	
126	1340	CABINET under BASIN - OUT - DOORS	

Radiological Survey Continuation Sheet

Page 6 of 21

Date 11/17/06

LAB DECON 118W N215

No.	Time	Locations	See attached LSC printout for Total Activity (cpm/100 cm ²)
127	1340	CABINET - INSIDE - LEFT / RIGHT	
128		- REAR / BOTTOM	
129		Overhead CABINET # 5 - OUT - DOOR	
130		- Bottom	
131		BE - INSIDE - LEFT / RIGHT	
132		- REAR / BOTTOM	
133		- shelf	
134		WALL SWIPES - upper	
135		- Lower	
136		Overhead CABINET # 6 - OUTSIDE - DOORS	
137		- Bottom	
138		- INSIDE - LEFT / RIGHT	
139		- REAR / BOTTOM	
140		- shelf	
141		Overhead CABINET # 7 - OUTSIDE - DOORS	
142		- Bottom	
143		- INSIDE - LEFT / RIGHT	
144		- REAR / BOTTOM	
145		- shelf	
146		Overhead CABINET # 8 - OUTSIDE - DOORS	
147		- Bottom	
148		- INSIDE - LEFT / RIGHT	
149		- REAR / BOTTOM	
150		- shelf	
151		Overhead CABINET # 9 - OUTSIDE - DOORS	
152	▽	- Bottom	
153	1355	- INSIDE - LEFT / RIGHT	

Radiological Survey Continuation Sheet

Page 7 of 21

Date 11/17/06

LAB DECON 118N WZ15

No.	Time	Locations	See attached LSC printout for Total Activity (cpm/100 cm ²)
154	1355	Overhead CABINET #9	- INSIDE - REAR / BOTTOM
155			- Shelves
156		Overhead CABINET # 10	- OUTSIDE - DOORS
157			- BOTTOM
158			- INSIDE - LEFT / RIGHT
159			- REAR / BOTTOM
160			- Shelves
161		Overhead CABINET # 11	- OUTSIDE - DOORS
162			- BOTTOM
163			- INSIDE - LEFT / RIGHT
164			- REAR / BOTTOM
165			- Shelves
166		BENCHTOP	
167		CABINET - OUTSIDE	- DOOR
168			- LEFT
169			- INSIDE - LEFT / RIGHT
170			- REAR / BOTTOM
171			- shelf
172		DRAWNS - TOP	- OUT / IN
173			- UPPER MID ↓ ↓
174			- LOWER MID ↓ ↓
175			- BOTTOM - OUT / IN
176		BENCHTOP	
177		ACCORE	- LEFT / RIGHT
178			- REAR / BOTTOM
179	▽	CABINET	- OUT
180	1410		- IN

Radiological Survey Continuation Sheet

Page 8 of 21

Date 11/17/06

CAB DECON 118N NZ15

No.	Time	Locations	See attached LSC printout for Total Activity (cpm/100 cm ²)
181	1410	BENCHTOP	
182		ALCOVE - LEFT / RIGHT	
183		- REAR / BOTTOM	
184		DRAWS - TOP - OUT / IN	
185		- UPPER MID ↓ ↓	
186		- LOWER MID ↓ ↓	
187		- BOTTOM - OUT / IN	
188		BENCHTOP	
189		DRAWS - TOP - OUT / IN	
190		- UPPER MID ↓ ↓	
191		- LOWER MID ↓ ↓	
192		- BOTTOM - OUT / IN	
193		ALCOVE - LEFT / RIGHT	
194		- REAR / BOTTOM	
195		BENCHTOP	
196		DRAW - OUT / IN	
197		CABINET - OUT	
198		- IN - LEFT / RIGHT	
199		- REAR / BOTTOM	
200		- Shelf	
201		BENCHTOP	
202		CABINET - OUTSIDE - DOORS	
203		- INSIDE - LEFT / RIGHT	
204		- REAR / BOTTOM	
205		- Shelf	
206	∇	CABINET - OUTSIDE - DOOR	
207	1510	- INSIDE - LEFT / RIGHT	

Bld. 118N Room N215

Page 10 of 21

Date: 11/17/06

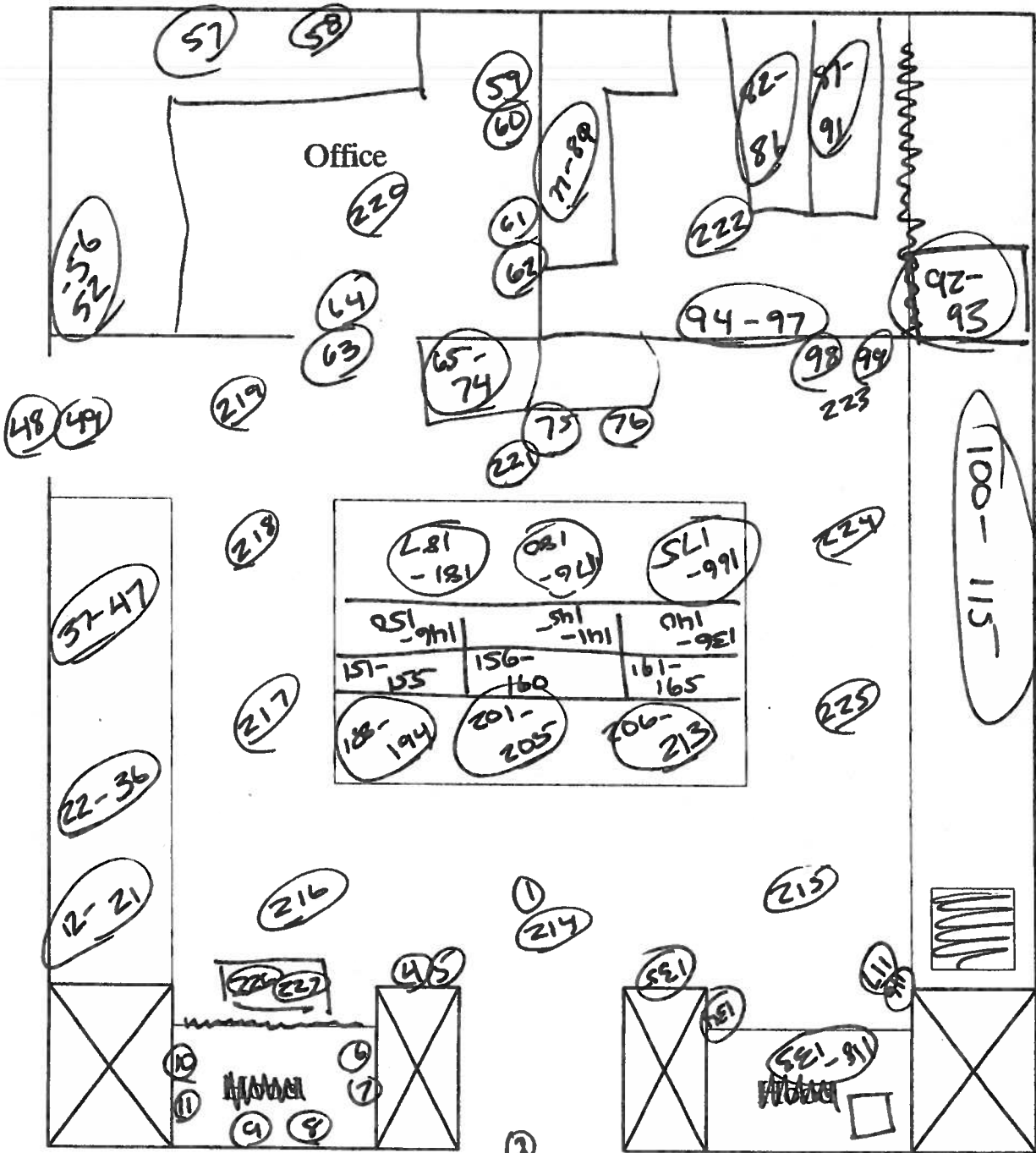

- Surveyed 100% of lower surfaces using 43-68. NO READINGS IN EXCESS OF NORMAL BACKGROUND LEVELS WERE NOTED.

O = wipe location

PROTOCOL : 88 Lab Decon 118N N215
DATE : 2006/11/17
TIME : 14:33
ID : P88AS002

M. Moen, C. Langer

Wallac 1400 DSA ver 2.50 S/N 4091042

Counting mode : CPM
Isotope(s) : H3,C14,K40
H3 = 5- 350,12.43 y
C14 = 5- 660,5730.00 y
K40 = 5-1010,1260000000.00 y
Protocol name : Lab Decon 118N N215
Counting time : 60
Repeats : 1
Cycles : 1
Replicates : 1
2 sigma % : 0.01
Minimum cpm : 0.00 Checking time: 10
Output to Display :
 POS,RACK,CTIME,DATE,CPM1,CPM2,CPMw1,RACKPOS,CPM,SQPI,CPM3
Additions to Display : Header,Listing,Spectrum
Header : M. Moen, C. Langer
Spectrum : Beta
Window 1 : 1-1024 /Beta
Window 2 : 1-1024 /Beta
Window 3 : 1-1024 /Beta
Window 4 : 1-1024 /Beta
Window 5 : 1-1024 /Beta
Window 6 : 1-1024 /Beta
FNCT1 = FNCT1 :
FNCT2 = FNCT2 :
FNCT3 = FNCT3 :
FNCT4 = FNCT4 :

Total count rate:

H3 4871.5 CPM
C14 6361.9 CPM
K40 7583.2 CPM

POS	RACK	CTIME	DATE	CPM1	CPM2	CPMW1
1	0	60	11/17/2006	17.70	19.70	26.00

POS	RACK	CTIME	DATE	CPM1	CPM2	CPMWI
2	0	61	11/17/2006	24.60	33.80	34.80
3	0	60	11/17/2006	16.60	22.90	30.10
4	0	60	11/17/2006	19.80	31.30	34.40
5	0	60	11/17/2006	29.20	34.40	40.60
6	0	60	11/17/2006	35.30	36.40	40.50
7	0	60	11/17/2006	21.80	28.10	33.30
8	0	60	11/17/2006	23.90	29.10	36.30
† 9	0	60	11/17/2006	36.30	43.60	54.00 †
10	0	60	11/17/2006	23.90	33.20	40.50
11	0	60	11/17/2006	18.80	25.00	28.10
12	0	60	11/17/2006	28.10	32.20	35.30
13	0	60	11/17/2006	20.80	31.20	37.40
14	0	60	11/17/2006	17.70	27.00	35.30
15	0	60	11/17/2006	21.80	27.00	32.20
16	0	60	11/17/2006	20.80	28.00	35.30
17	0	60	11/17/2006	30.10	34.30	45.70
18	0	60	11/17/2006	16.60	19.70	24.90
19	0	60	11/17/2006	27.00	32.20	41.60
20	0	60	11/17/2006	20.90	26.10	31.30
21	0	60	11/17/2006	21.90	27.10	38.60
22	0	60	11/17/2006	17.70	21.90	26.10
23	0	60	11/17/2006	22.90	25.00	29.20
24	0	60	11/17/2006	27.00	33.30	44.70
25	0	60	11/17/2006	20.80	31.30	32.30
26	0	60	11/17/2006	18.80	28.10	32.30
27	0	60	11/17/2006	11.40	17.70	23.90
28	0	60	11/17/2006	32.30	41.70	49.00
29	0	60	11/17/2006	18.80	28.10	36.50
30	0	60	11/17/2006	18.70	26.00	30.10
31	0	60	11/17/2006	19.80	28.10	33.30
32	0	60	11/17/2006	26.00	32.20	41.60

POS	RACK	CTIME	DATE	CPM1	CPM2	CPMW1
33	0	61	11/17/2006	17.40	22.50	30.70
34	0	60	11/17/2006	12.50	19.70	24.90
35	0	60	11/17/2006	18.70	29.10	35.30
36	0	60	11/17/2006	26.00	33.20	43.60
37	0	60	11/17/2006	21.90	28.10	32.30
38	0	60	11/17/2006	15.60	20.80	28.10
39	0	60	11/17/2006	20.80	28.00	36.40
40	0	60	11/17/2006	22.90	27.10	32.30
41	0	60	11/17/2006	22.90	26.00	35.30
42	0	60	11/17/2006	23.90	27.00	35.30
43	0	60	11/17/2006	23.90	30.10	37.40
44	0	60	11/17/2006	21.80	30.10	41.60
45	0	60	11/17/2006	18.70	24.90	28.10
46	0	60	11/17/2006	26.00	32.20	37.40
47	0	60	11/17/2006	26.00	37.40	40.50
48	0	60	11/17/2006	18.70	24.90	31.20
49	0	60	11/17/2006	24.90	33.20	40.50
50	0	60	11/17/2006	26.00	31.20	37.40
51	0	60	11/17/2006	16.60	26.00	31.20
52	0	60	11/17/2006	18.70	26.00	33.20
53	0	60	11/17/2006	18.70	26.00	29.10
54	0	60	11/17/2006	24.00	29.20	32.30
55	0	60	11/17/2006	23.90	29.10	37.40
56	0	60	11/17/2006	15.60	21.80	28.00
57	0	60	11/17/2006	16.60	28.00	38.40
58	0	60	11/17/2006	17.70	27.00	29.10
59	0	60	11/17/2006	22.90	29.10	40.50
60	0	60	11/17/2006	15.60	26.00	33.30
61	0	60	11/17/2006	17.70	28.10	32.20
62	0	60	11/17/2006	19.80	26.10	33.30
63	0	60	11/17/2006	16.60	20.80	26.00

POS	RACK	CTIME	DATE	CPM1	CPM2	CPMWI
64	0	60	11/17/2006	21.80	26.00	36.30
65	0	60	11/17/2006	19.70	27.00	29.10
66	0	60	11/17/2006	21.80	29.10	36.40
67	0	60	11/17/2006	16.60	23.90	30.10
68	0	60	11/17/2006	15.60	21.80	28.00
69	0	60	11/17/2006	33.40	37.50	45.90
70	0	60	11/17/2006	26.00	31.30	38.50
71	0	60	11/17/2006	23.90	29.10	31.20
72	0	60	11/17/2006	21.80	32.20	42.60
73	0	60	11/17/2006	21.80	26.00	30.20
74	0	60	11/17/2006	19.70	22.90	32.20
75	0	60	11/17/2006	28.10	33.30	37.40
76	0	60	11/17/2006	27.10	33.40	41.70
77	0	60	11/17/2006	18.70	26.00	34.30
78	0	60	11/17/2006	25.00	32.30	41.70
79	0	60	11/17/2006	19.70	24.90	34.30
80	0	60	11/17/2006	21.80	30.10	37.40
81	0	60	11/17/2006	19.70	30.10	33.30
82	0	60	11/17/2006	20.80	29.10	34.30
83	0	60	11/17/2006	18.70	24.90	33.20
84	0	60	11/17/2006	19.80	24.00	35.40
85	0	60	11/17/2006	24.00	30.20	39.60
86	0	60	11/17/2006	27.00	34.30	36.40
87	0	60	11/17/2006	24.00	27.10	34.40
88	0	60	11/17/2006	21.80	27.00	30.10
89	0	60	11/17/2006	24.00	31.30	35.40
90	0	60	11/17/2006	21.80	31.20	37.40
91	0	60	11/17/2006	27.00	37.40	46.80
92	0	60	11/17/2006	22.90	30.10	32.20
93	0	60	11/17/2006	26.00	32.30	35.40
94	0	60	11/17/2006	18.70	24.90	27.00

POS	RACK	CTIME	DATE	CPM1	CPM2	CPMW1
95	0	60	11/17/2006	19.70	22.80	30.10
96	0	61	11/17/2006	17.40	27.70	34.80
97	0	60	11/17/2006	20.80	27.10	35.40
98	0	60	11/17/2006	25.00	33.30	43.80
99	0	60	11/17/2006	22.90	26.00	28.10
100	0	60	11/17/2006	24.90	32.20	34.30
101	0	60	11/17/2006	28.10	32.20	35.30
102	0	60	11/17/2006	31.20	36.40	43.60
103	0	60	11/17/2006	20.80	26.10	31.30
104	0	60	11/17/2006	26.00	34.30	38.40
105	0	60	11/17/2006	24.90	29.10	33.30
106	0	60	11/17/2006	24.90	27.00	32.20
107	0	60	11/17/2006	18.70	23.90	27.00
108	0	60	11/17/2006	22.90	28.10	36.40
109	0	60	11/17/2006	15.60	25.00	35.50
110	0	60	11/17/2006	33.20	37.40	43.60
111	0	60	11/17/2006	16.60	27.00	28.10
112	0	60	11/17/2006	31.30	38.60	41.70
113	0	60	11/17/2006	13.50	18.70	22.80
114	0	60	11/17/2006	14.60	21.80	23.90
115	0	60	11/17/2006	28.10	36.40	41.60
116	0	60	11/17/2006	23.90	32.20	36.40
117	0	60	11/17/2006	20.80	29.20	34.40
118	0	60	11/17/2006	16.60	26.00	33.20
119	0	60	11/17/2006	23.90	28.00	35.30
120	0	60	11/17/2006	10.40	15.60	22.90
121	0	60	11/17/2006	30.10	41.60	43.60
122	0	60	11/17/2006	22.90	27.10	34.40
123	0	60	11/17/2006	20.80	28.10	31.30
124	0	60	11/17/2006	12.50	14.50	24.90
125	0	60	11/17/2006	25.00	30.10	33.30

POS	RACK	CTIME	DATE	CPM1	CPM2	CPMW1
126	0	60	11/17/2006	17.70	22.90	28.10
127	0	60	11/17/2006	21.80	36.40	39.50
128	0	60	11/17/2006	22.90	29.10	37.40
129	0	60	11/17/2006	21.80	31.20	39.50
130	0	60	11/17/2006	19.80	25.00	35.40
131	0	60	11/17/2006	19.70	23.90	27.00
132	0	60	11/17/2006	23.90	29.10	35.30
133	0	60	11/17/2006	20.80	23.90	28.00
134	0	60	11/17/2006	26.00	31.20	37.40
135	0	60	11/17/2006	22.80	28.00	36.30
136	0	60	11/17/2006	14.60	20.80	25.00
137	0	60	11/17/2006	18.70	22.90	28.10
138	0	60	11/17/2006	18.70	27.00	32.20
139	0	60	11/17/2006	20.80	32.20	41.60
140	0	60	11/17/2006	20.80	32.20	35.30
141	0	60	11/17/2006	17.70	30.10	34.30
142	0	60	11/17/2006	17.70	24.90	28.10
143	0	60	11/17/2006	23.90	29.10	34.30
144	0	60	11/17/2006	22.90	23.90	31.20
145	0	60	11/17/2006	24.00	28.10	33.30
146	0	60	11/17/2006	27.10	33.40	35.40
147	0	60	11/17/2006	23.90	33.20	40.50
148	0	60	11/17/2006	16.60	19.70	24.90
149	0	60	11/17/2006	11.50	16.70	26.00
150	0	60	11/17/2006	16.60	22.90	32.20
151	0	61	11/17/2006	23.60	26.60	30.70
152	0	60	11/17/2006	15.60	23.90	28.10
153	0	61	11/17/2006	16.40	21.50	22.50
154	0	60	11/17/2006	18.70	24.90	35.30
155	0	60	11/17/2006	25.00	32.30	34.40
156	0	60	11/17/2006	10.40	16.60	19.70

POS	RACK	CTIME	DATE	CPM1	CPM2	CPMW1
157	0	60	11/17/2006	20.80	24.90	35.30
158	0	60	11/17/2006	20.80	24.90	31.20
159	0	60	11/17/2006	18.70	23.90	28.00
160	0	60	11/17/2006	17.70	26.00	30.10
161	0	60	11/17/2006	28.10	30.10	35.30
162	0	60	11/17/2006	22.90	24.90	26.00
163	0	60	11/17/2006	27.00	29.10	34.30
164	0	60	11/17/2006	17.70	21.80	24.90
165	0	60	11/17/2006	20.80	21.80	28.00
166	0	60	11/17/2006	22.90	29.10	35.30
167	0	60	11/17/2006	21.90	28.10	34.40
168	0	60	11/17/2006	13.50	24.90	29.10
169	0	60	11/17/2006	17.70	24.90	34.30
170	0	60	11/17/2006	23.90	29.10	33.30
171	0	60	11/17/2006	18.70	26.00	32.20
172	0	60	11/17/2006	15.60	21.80	27.00
173	0	60	11/17/2006	13.50	17.70	27.00
174	0	60	11/17/2006	21.90	30.20	33.30
175	0	60	11/17/2006	19.70	26.00	32.20
176	0	60	11/17/2006	24.00	32.30	41.70
177	0	60	11/17/2006	13.50	21.80	28.10
178	0	60	11/17/2006	26.00	33.20	43.60
179	0	60	11/17/2006	21.80	31.20	35.30
180	0	60	11/17/2006	12.50	16.60	26.00
181	0	60	11/17/2006	19.70	30.10	39.50
182	0	60	11/17/2006	18.70	23.90	30.10
183	0	60	11/17/2006	18.70	28.00	33.20
184	0	60	11/17/2006	31.20	36.40	41.60
185	0	60	11/17/2006	24.90	33.20	40.50
186	0	60	11/17/2006	22.90	35.30	39.50
187	0	60	11/17/2006	19.70	27.00	32.20

POS	RACK	CTIME	DATE	CPM1	CPM2	CPMW1
188	0	60	11/17/2006	15.60	28.10	35.40
189	0	60	11/17/2006	22.80	27.00	33.20
190	0	60	11/17/2006	22.80	26.00	32.20
191	0	60	11/17/2006	26.00	37.40	42.60
192	0	60	11/17/2006	28.00	40.50	44.70
193	0	60	11/17/2006	24.90	32.20	36.30
194	0	60	11/17/2006	14.50	21.80	22.80
195	0	60	11/17/2006	26.00	35.30	39.50
196	0	60	11/17/2006	22.90	32.20	37.40
197	0	60	11/17/2006	21.80	23.90	28.00
198	0	60	11/17/2006	17.70	19.70	26.00
199	0	60	11/17/2006	29.20	36.50	38.60
200	0	60	11/17/2006	22.90	29.10	32.20
201	0	60	11/17/2006	24.90	31.20	33.20
202	0	60	11/17/2006	18.70	23.90	30.10
203	0	60	11/17/2006	21.80	29.10	34.30
204	0	60	11/17/2006	19.80	22.90	29.20
205	0	60	11/17/2006	18.80	25.00	30.20
206	0	60	11/17/2006	23.90	29.10	36.40
207	0	60	11/17/2006	22.90	29.10	31.20
208	0	60	11/17/2006	18.70	27.00	32.20
209	0	60	11/17/2006	18.70	23.90	29.10
210	0	60	11/17/2006	15.60	21.80	31.20
211	0	60	11/17/2006	11.50	18.80	26.10
212	0	60	11/17/2006	22.90	28.10	32.20
213	0	60	11/17/2006	10.40	19.70	28.10
214	0	60	11/17/2006	17.70	25.00	30.20
215	0	60	11/17/2006	19.70	28.10	36.40
216	0	60	11/17/2006	19.70	22.90	27.00
217	0	60	11/17/2006	32.20	37.40	43.70
218	0	60	11/17/2006	27.00	31.20	38.50

POS	RACK	CTIME	DATE	CPM1	CPM2	CPMW1
219	0	60	11/17/2006	21.80	34.30	39.50
220	0	60	11/17/2006	18.70	28.10	31.20
221	0	60	11/17/2006	27.00	31.20	39.50
222	0	60	11/17/2006	19.70	22.90	27.00
223	0	60	11/17/2006	29.10	37.40	40.60
224	0	60	11/17/2006	22.90	28.10	31.30
225	0	60	11/17/2006	22.80	32.20	38.40
226	0	60	11/17/2006	21.80	30.20	35.40
227	0	60	11/17/2006	20.80	27.00	34.30

PROTOCOL : 88 Lab Decon 118N N215
DATE : 2006/11/20
TIME : 11:14
ID : P88AS003

M. Moen, C. Langer

Wallac 1400 DSA ver 2.50 S/N 4091042

Counting mode : CPM
Isotope(s) : H3,C14,K40
H3 = 5- 350,12.43 y
C14 = 5- 660,5730.00 y
K40 = 5-1010,1260000000.00 y
Protocol name : Lab Decon 118N N215
Counting time : 60
Repeats : 1
Cycles : 1
Replicates : 1
2 sigma % : 0.01
Minimum cpm : 0.00 Checking time: 10
Output to Display :
 POS,RACK,CTIME,DATE,CPM1,CPM2,CPMw1,RACKPOS,CPM,SQPI,CPM3
Additions to Display : Header,Listing,Spectrum
Header : M. Moen, C. Langer
Spectrum : Beta
Window 1 : 1-1024 /Beta
Window 2 : 1-1024 /Beta
Window 3 : 1-1024 /Beta
Window 4 : 1-1024 /Beta
Window 5 : 1-1024 /Beta
Window 6 : 1-1024 /Beta
FNCT1 = FNCT1 :
FNCT2 = FNCT2 :
FNCT3 = FNCT3 :
FNCT4 = FNCT4 :

Total count rate:

H3 38.5 CPM
C14 56.2 CPM
K40 68.6 CPM

POS	RACK	CTIME	DATE	CPM1	CPM2	CPMW1
1	0	60	11/20/2006	17.70	28.10	33.30 - Background

POS	RACK	CTIME	DATE	CPM1	CPM2	CPMW1
2	0	60	11/20/2006	20.80	28.00	35.30

-RESWIPE # 9