

## Radiological Survey Sheet

Job Location Pfizer Central Research Grafton 118N/1113 Page 1 of 17  
 Survey Purpose Radiological Assessment Date 1/22/01  
 Performed By Pam Jones (Print) Pam Jones (Sign)

Inst.(1) (Model/SN) <b>Beckman LS 6500</b> #7069448	Inst.(2) <u>Ludlum 2241-a</u> (Model/SN) #137751	Inst.(3) (Model/SN)
Det. <b>Internal</b> (Model/SN)	Det. <u>Ludlum 43-68</u> (Model/SN) #PR140899	Det. (Model/SN)
Eff. <b>See LSC Printout</b>	Eff. <u>~ 8% CI4</u>	Eff.
Type rad. <b>β</b>	Type rad. <b>β</b>	Type rad.
Bkgd. <b>See LSC Printout</b>	Bkgd. <u>300cpm</u>	Bkgd.
Cal. Due: <u>5/12/00</u> <u>12/01</u>	Cal. Due <u>4/28/01</u>	Cal. due

No.	Time	Location	Inst. Used	Total Activity (dpm/100 cm <sup>2</sup> )
1.	1:00	wall	1	See attached LSC Printout
2.		"	1	
3.		"	1	
4.		door	1	
5.		wall	1	
6.		"	1	
7.		floor	1	
8.		"	1	
9.		"	1	
10.		"	1	
11.		shelves	1	
12.		desk	1	
13.		wall	1	
14.		desk	1	
15.		metal bin	1	
16.		floor	1	
17.		door	1	
18.	↓	outside shelves	1	↓

Radiological Survey Continuation Sheet

Page 2 of 17

Date 1/22/01

No.	Time	Location	Inst. Used	Total Activity (dpm/100 cm <sup>2</sup> )
19		top shelf		
20		shelf	1	See attached LSC Printout
21		bottom shelf	1	
22		Chair	1	
23		"	1	
24		top shelf	1	
25		shelf	1	
26		"	1	
27		bot. shelf	1	
28		top shelf	1	
29		bot. shelf	1	
30		counter	1	
31		"	1	
32		"	1	
33		out. drawers	1	
34		top drawer	1	
35		drawer	1	
36		"	1	
37		"	1	
38		bot. drawer	1	
39		out. drawers	1	
40		top drawer	1	
41		drawer	1	
42		"	1	
43		"	1	
44		bot drawer	1	
45		out. drawers	1	
46	✓	top drawer	1	✓

Radiological Survey Continuation Sheet

Page 3 of 17

Date 1/22/01

No.	Time	Location	Inst. Used	Total Activity (dpm/100 cm <sup>2</sup> )
47		drawer	1	See attached LSC Printout
48		"	1	
49		"	1	
50		bot. drawer	1	
51		top shelf	1	
52		bot. shelf	1	
53		floor	1	
54		"	1	
55		"	1	
56		"	1	
57		wall	1	
58		top shelf	1	
59		shelf	1	
60		"	1	
61		bot. shelf	1	
62		counter	1	
63		"	1	
64		"	1	
65		drawer	1	
66		"	1	
67		"	1	
68		top shelf	1	
69		bot. shelf	1	
70		int. drawers	1	
71		top drawer	1	
72		drawer	1	
73		"	1	
74		"	1	

Radiological Survey Continuation Sheet

Page 4 of 17

Date 1/22/01

No.	Time	Location	Inst. Used	Total Activity (dpm/100 cm <sup>2</sup> )
75		bot. drawer	1	See attached LSC Printout
76		out. drawers	1	
77		top drawer	1	
78		drawer	1	
79		"	1	
80		"	1	
81		bot. drawer	1	
82		top shelf	1	
83		bot. shelf	1	
84		out. drawers	1	
85		top <del>shelf</del> drawer	1	
86		drawer	1	
87		"	1	
88		"	1	
89		"	1	
90		bot. drawer	1	
91		out. drawers	1	
92		top drawer	1	
93		drawer	1	
94		"	1	
95		"	1	
96		"	1	
97		bot. drawer	1	
98		top shelf	1	
99		bot. shelf	1	
100		out. shelves	1	
101		top shelf	1	
102	✓	shelf	1	✓

Radiological Survey Continuation Sheet

Page 5 of 17

Date 1/22/01

No.	Time	Location	Inst. Used	Total Activity (dpm/100 cm <sup>2</sup> )
103		bot. shelf	1	See attached LSC Printout
104		out. shelves	1	
105		top shelf	1	
106		shelf	1	
107		bot. shelf	1	
108		out. shelves	1	
109		top shelf	1	
110		shelf	1	
111		bot. shelf	1	
112		counter shelf	1	
113		floor	1	
114		"	1	
115		shelves	1	
116		desk	1	
117		wall	1	
118		shelves	1	
119		desk	1	
120		floor	1	
121		door	1	
122		wall	1	
123		floor	1	
124		"	1	
125		"	1	
126		out. shelves	1	
127		top shelf	1	
128		shelf	1	
129		bot. shelf	1	
130	✓	out. shelves	1	✓

Radiological Survey Continuation Sheet

Page 6 of 17

Date 1/22/01

No.	Time	Location	Inst. Used	Total Activity (dpm/100 cm <sup>2</sup> )
131		TOP SHELF	1	See attached LSC Printout
132		shelf	1	
133		OUT. SHELF	1	
134		INT. DRAWERS	1	
135		TOP SHELF	1	
136		shelf	1	
137		OUT. SHELF	1	
138		COUNTER SHELF	1	
139		OUT. DRAWERS	1	
140		TOP SHELF	1	
141		shelf	1	
142		OUT. SHELF	1	
143		OUT. DRAWERS	1	
144		TOP SHELF	1	
145		shelf	1	
146		OUT. SHELF	1	
147		OUT. DRAWERS	1	
148		TOP SHELF	1	
149		shelf	1	
150		OUT. SHELF	1	
151		COUNTER SHELF	1	
152		COUNTER	1	
153		"	1	
154		"	1	
155		TOP SHELF	1	
156		OUT. SHELF	1	
157		OUT. DRAWERS	1	
158	✓	TOP DRAWER	1	✓

Radiological Survey Continuation Sheet

Page 7 of 17  
 Date 1/22/01

No.	Time	Location	Inst. Used	Total Activity (dpm/100 cm <sup>2</sup> )
159		drawer	1	See attached LSC Printout
160		"	1	
161		"	1	
162		"	1	
163		bot. drawer	1	
164		out. drawers	1	
165		top drawer	1	
166		drawer	1	
167		"	1	
168		"	1	
169		"	1	
170		bot. drawer	1	
171		top shelf	1	
172		bot. shelf	1	
173		drawer	1	
174		"	1	
175		"	1	
176		counter	1	
177		"	1	
178		"	1	
179		out. drawers	1	
180		top drawer	1	
181		drawer	1	
182		"	1	
183		"	1	
184		"	1	
185		bot. drawer	1	
186	✓	out. drawers	1	✓

Radiological Survey Continuation Sheet

Page 8 of 17  
 Date 1/22/01

No.	Time	Location	Inst. Used	Total Activity (dpm/100 cm <sup>2</sup> )
187		TOP DRAWER	1	See attached LSC Printout
188		DRAWER	1	
189		"	1	
190		"	1	
191		"	1	
192		bot. drawer	1	
193		TOP SHELF	1	
194		bot. shelf	1	
195		TOP SHELF	1	
196		bot. shelf	1	
197		FLOOR	1	
198		"	1	
199		door	1	
200		Shelves	1	
201		desk	1	
202		Wall	1	
203		shelves	1	
204		desk	1	
205		FLOOR	1	
206		door	1	
207		OUT. SHelves	1	
208		TOP SHELF	1	
209		shelf	1	
210		bot. shelf	1	
211		out. shelves	1	
212		TOP SHELF	1	
213		shelf	1	
214	✓	bot. shelf	1	✓



Radiological Survey Continuation Sheet

Page 9 of 17  
 Date 1/22/01

No.	Time	Location	Inst. Used	Total Activity (dpm/100 cm <sup>2</sup> )
215		Out. shelves	1	See attached LSC Printout
216		top shelf	1	
217		shelf	1	
218		bot. shelf	1	
219		counter shelf	1	
220		counter	1	
221		"	1	
222		floor	1	
223		"	1	
224		out. drawers	1	
225		top drawer	1	
226		drawer	1	
227		"	1	
228		"	1	
229		"	1	
230		bot. drawer	1	
231		out. drawers	1	
232		top drawer	1	
233		drawer	1	
234		"	1	
235		"	1	
236		"	1	
237		bot. drawer	1	
238		wall	1	
239		"	1	
240		counter	1	
241		sides of sink	1	
242	✓	bottom + drain	1	✓

Radiological Survey Continuation Sheet

Page 10 of 17

Date 1/22/01

No.	Time	Location	Inst. Used	Total Activity (dpm/100 cm <sup>2</sup> )
243		OUT. Cabinet	1	See attached LSC Printout
244		left	1	
245		bottom	1	
246		rt.	1	
247		wall	1	
248		"	1	
249		top shelf	1	
250		shelf	1	
251		"	1	
252		"	1	
253		bottom shelf	1	
254			1	
255			1	
256			1	
257			1	
258			1	
259			1	
260			1	
261			1	
262			1	
263			1	
264			1	
265			1	
266			1	
267			1	
268			1	
269			1	
270			1	

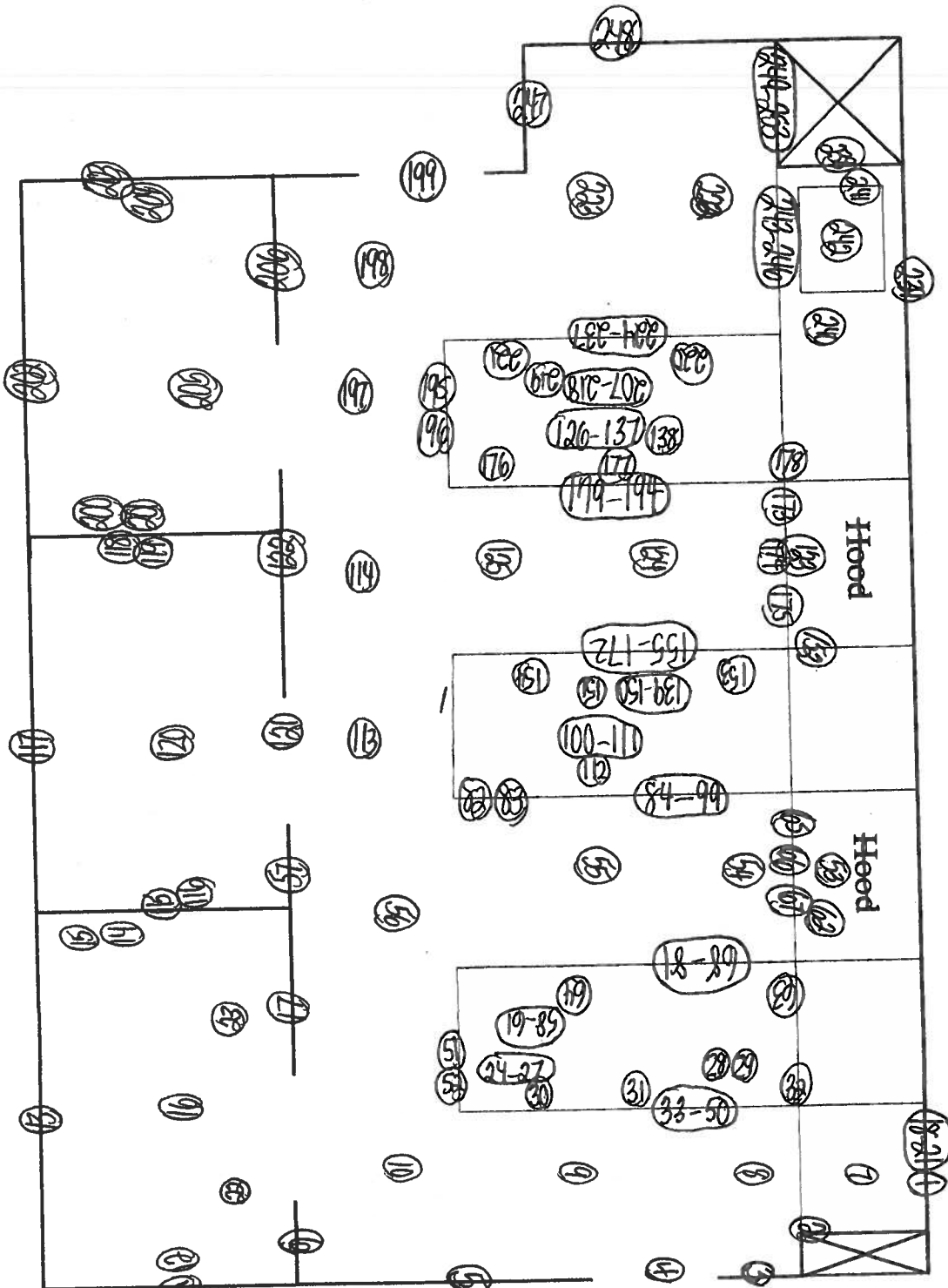

○ = wipe  
LOCATION

Surveyed 100% of all lower surfaces using instrument #2.  
All areas were noted to be at a level of normal background.

~~None~~

ID: MONTHLY WIPES

23 JAN 2001 11:03

USER: 4	COMMENT:				
PRESET TIME :	1.00				
DATA CALC :	DL DPM	H# : YES	SAMPLE REPEATS:	1	PRINTER : EDIT
COUNT BLANK :	YES	IC# : NO	REPLICATES :	1	RS232 : EDIT
TWO PHASE :	NO	AQC : YES	CYCLE REPEATS :	1	
SCINTILLATOR:	LIQUID	LUMEX: YES	LOW SAMPLE REJ:	0	
LOW LEVEL :	NO	HALF LIFE	CORRECTION DATE:		none

ISOTOPE 1:	3H	%ERROR: 2.00	FACTOR: 1.0000	BKG. SUB:	0
ISOTOPE 2:	14C	%ERROR: 2.00	FACTOR: 1.0000	BKG. SUB:	0
WIDE OPEN WINDOW		%ERROR: 0.00	FACTOR: 1.0000	BKG. SUB:	0

Quench Limits

Low:13.688

High:306.34

44-120411

SAM NO	H#	3H CPM	14C CPM	WIDE CPM	3H DPM	14C DPM	RATIO	LUMEX %
B1	73.7	10.00	8.00	28.00	16.84	10.52	1.600	1.99
		Blank Average	DPM	for	3H :	16.84	COEF. OF VAR:	0.000
		Blank Average	DPM	for	14C :	10.52	COEF. OF VAR:	0.000
1	80.1	11.00	4.00	31.00	4.75	-5.35	-0.888	4.74
2	74.4	17.00	15.00	40.00	11.18	9.24	1.209	1.12
3	73.5	17.00	9.00	37.00	14.07	1.22	11.518	1.64
4	75.2	20.00	12.00	38.00	19.10	5.19	3.680	1.32
5	77.2	23.00	4.00	32.00	29.89	-5.55	-5.386	1.51
6	76.0	22.00	6.00	43.00	26.50	-2.86	-9.266	1.42
7	75.8	16.00	15.00	40.00	9.25	9.27	0.997	1.73
8	76.8	23.00	11.00	40.00	26.23	3.81	6.876	2.85
9	79.5	17.00	13.00	46.00	12.88	6.61	1.949	0.80
10	78.4	23.00	11.00	48.00	26.56	3.82	6.946	0.76
11	83.0	22.00	14.00	44.00	23.78	7.90	3.012	1.07
12	78.1	12.00	5.00	27.00	6.15	-4.03	-1.526	1.56
13	73.4	24.00	10.00	41.00	28.15	2.44	11.518	2.58
14	78.7	17.00	12.00	40.00	13.28	5.26	2.523	0.94
15	78.1	20.00	10.00	40.00	20.62	2.53	8.140	0.81
16	78.4	23.00	7.00	40.00	28.62	-1.53	-18.68	1.22
17	76.7	8.00	11.00	26.00	-5.53	4.06	-1.361	1.07
18	76.6	24.00	8.00	40.00	29.83	-0.22	-138.1	1.32
19	83.8	17.00	12.00	35.00	14.03	5.30	2.647	1.35
20	78.6	12.00	7.00	30.00	5.18	-1.35	-3.840	2.04
21	84.2	22.00	10.00	38.00	26.15	2.53	10.328	1.80
22	78.2	24.00	6.00	39.00	31.21	-2.89	-10.81	1.51
23	74.7	17.00	9.00	31.00	14.24	1.23	11.601	1.27
24	80.7	25.00	7.00	45.00	33.45	-1.56	-21.46	1.45
25	78.2	20.00	9.00	39.00	21.15	1.19	17.699	2.62
26	97.6	18.00	7.00	30.00	21.56	-1.39	-15.55	2.18
27	88.0	18.00	11.00	33.00	17.47	3.97	4.404	1.57
28	86.4	20.00	14.00	44.00	20.01	7.96	2.515	0.93
29	108.4	7.00	10.00	24.00	-5.45	2.96	-1.845	2.79
30	79.9	15.00	10.00	30.00	10.20	2.63	3.883	1.77
31	81.1	17.00	12.00	35.00	13.64	5.28	2.582	1.49
32	107.5	20.00	9.00	40.00	27.55	1.33	20.779	1.61
33	78.0	15.00	8.00	32.00	10.99	-0.06	-178.1	1.04
34	76.9	14.00	6.00	28.00	9.75	-2.73	-3.577	0.83
35	75.8	22.00	9.00	37.00	24.94	1.15	21.666	0.72
36	77.8	13.00	12.00	37.00	4.65	5.33	0.874	0.55

SAM NO	H#	3H CPM	14C CPM	WIDE CPM	3H DPM	14C DPM	RATIO	LUMEX %
37	74.0	20.00	9.00	34.00	20.41	1.18	17.365	0.89
38	71.6	13.00	8.00	27.00	6.04	-0.06	-104.0	2.36
39	75.1	17.00	13.00	41.00	12.28	6.58	1.867	0.65
40	72.7	19.00	14.00	45.00	15.62	7.86	1.987	0.52
41	73.3	16.00	8.00	35.00	12.46	-0.10	-126.2	0.83
42	74.6	22.00	11.00	41.00	23.69	3.82	6.205	1.22
43	75.5	23.00	9.00	42.00	26.98	1.13	23.806	0.94
44	80.0	15.00	6.00	29.00	12.29	-2.73	-4.498	1.15
45	79.0	16.00	8.00	31.00	13.25	-0.07	-178.3	1.64
46	75.3	19.00	6.00	36.00	20.05	-2.81	-7.129	0.54
47	73.4	19.00	7.00	33.00	19.23	-1.48	-12.97	0.73

PJ

pg. 1704

50	75.8	14.00	13.00	38.00	6.06	6.63	0.913	0.73
51	83.4	11.00	5.00	24.00	4.57	-4.00	-1.142	1.74
52	98.9	24.00	7.00	38.00	36.10	-1.50	-24.13	1.38
53	77.3	22.00	14.00	43.00	22.67	7.85	2.888	0.78
54	79.0	16.00	10.00	39.00	12.23	2.60	4.694	3.11
55	76.2	22.00	4.00	32.00	27.56	-5.53	-4.979	0.94
56	78.5	20.00	11.00	41.00	20.17	3.87	5.206	0.81
57	75.5	14.00	17.00	36.00	3.99	11.98	0.334	0.90
58	99.9	16.00	10.00	36.00	15.53	2.72	5.699	2.05
59	97.7	18.00	13.00	40.00	18.11	6.73	2.689	1.80
60	86.5	22.00	11.00	47.00	26.10	3.89	6.712	0.85
61	91.2	17.00	15.00	41.00	13.54	9.40	1.441	1.70
62	81.7	18.00	12.00	43.00	15.90	5.27	3.017	1.37
63	94.4	14.00	4.00	28.00	13.34	-5.38	-2.481	2.26
64	88.7	17.00	8.00	35.00	16.99	-0.05	-336.6	1.36
65	76.4	16.00	5.00	32.00	14.42	-4.10	-3.520	1.04
66	75.9	19.00	10.00	39.00	18.12	2.54	7.140	0.85
67	77.8	24.00	7.00	36.00	30.62	-1.55	-19.75	1.62
68	77.8	14.00	9.00	30.00	8.32	1.29	6.438	0.84
69	77.4	16.00	4.00	32.00	15.07	-5.43	-2.774	1.25
70	77.0	15.00	10.00	30.00	9.83	2.61	3.766	0.71
71	76.8	20.00	9.00	40.00	20.90	1.19	17.584	0.96
72	76.8	14.00	13.00	43.00	6.15	6.64	0.927	5.22
73	78.2	24.00	9.00	43.00	29.67	1.13	26.290	0.78
74	74.5	19.00	7.00	40.00	19.40	-1.48	-13.12	0.60
75	74.6	21.00	8.00	37.00	23.12	-0.17	-132.6	0.61
76	75.1	10.00	10.00	32.00	-1.92	5.35	-0.358	0.87
77	79.2	16.00	5.00	28.00	14.84	-4.09	-3.628	2.60
78	76.1	17.00	7.00	34.00	15.46	-1.44	-10.73	1.33
79	75.5	21.00	11.00	37.00	21.76	3.84	5.667	0.73
80	71.8	13.00	13.00	42.00	3.58	6.61	0.541	0.81
81	77.0	21.00	13.00	41.00	21.00	6.52	3.219	0.67
82	96.7	12.00	7.00	30.00	7.30	-1.28	-5.718	1.76
83	83.8	16.00	6.00	33.00	15.04	-2.74	-5.490	1.10
84	77.3	19.00	9.00	44.00	18.86	1.21	15.625	0.65
85	75.6	15.00	13.00	38.00	8.14	6.61	1.231	1.01
86	75.7	20.00	14.00	46.00	18.17	7.87	2.309	0.69
87	74.8	9.00	13.00	32.00	-4.53	6.70	-0.676	0.87
88	76.0	23.00	5.00	35.00	29.13	-4.21	-6.913	0.61
89	75.0	20.00	16.00	43.00	17.05	10.54	1.618	0.55
90	78.8	13.00	5.00	33.00	8.37	-4.04	-2.070	0.63
91	79.4	19.00	10.00	35.00	18.71	2.56	7.317	1.07
92	77.1	9.00	9.00	27.00	-2.37	1.37	-1.726	1.10
93	73.6	18.00	12.00	37.00	14.67	5.21	2.814	0.72
94	76.7	18.00	12.00	39.00	15.12	5.23	2.889	0.93

SAM NO	H#	3H CPM	14C CPM	WIDE CPM	3H DPM	14C DPM	RATIO	LUMEX %
95	76.8	18.00	10.00	39.00	16.16	2.56	6.313	0.78
96	76.0	10.00	9.00	27.00	-0.33	1.35	-0.245	0.97
97	75.5	15.00	14.00	43.00	7.61	7.95	0.958	0.86
98	73.7	14.00	10.00	32.00	7.35	2.61	2.818	0.89
99	75.5	24.00	6.00	40.00	30.60	-2.89	-10.57	0.75
100	78.5	19.00	1.00	28.00	23.20	-9.50	-0.440	0.71
101	81.5	14.00	7.00	28.00	9.81	-1.37	-0.180	0.80
102	82.7	22.00	5.00	60.00	28.48	-4.19	6.001	0.87
103	82.8	16.00	10.00	38.00	12.77	2.63	2.060	1.74
104	77.2	11.00	10.00	32.00	1.38	2.68	0.514	0.56
105	78.1	14.00	7.00	28.00	6.81	5.31	1.282	1.33

pg

108	78.9	15.00	10.00	35.00	10.07	2.62	3.843	0.83
109	80.7	16.00	5.00	28.00	15.08	-4.09	-3.687	1.25
110	77.1	19.00	16.00	41.00	15.26	10.57	1.443	1.03
111	85.1	20.00	7.00	34.00	23.53	-1.46	-16.11	1.41
112	89.8	12.00	19.00	36.00	-0.17	14.87	-0.012	1.25
113	79.6	14.00	10.00	30.00	8.01	2.64	3.033	0.56
114	80.2	24.00	12.00	46.00	28.57	5.16	5.538	0.68
115	78.0	12.00	9.00	33.00	4.08	1.33	3.077	0.87
116	77.6	21.00	11.00	41.00	22.14	3.85	5.747	0.43
117	75.8	13.00	14.00	33.00	3.44	7.98	0.430	0.80
118	79.4	26.00	5.00	38.00	36.32	-4.26	-8.530	1.76
119	81.9	19.00	17.00	48.00	15.46	11.96	1.292	0.43
120	75.5	23.00	16.00	50.00	23.42	10.49	2.233	0.68
121	76.5	13.00	14.00	33.00	3.50	7.99	0.438	0.40
122	80.8	14.00	9.00	29.00	8.68	1.31	6.636	0.97
123	76.7	15.00	12.00	35.00	8.77	5.28	1.660	0.50
124	74.9	16.00	15.00	38.00	9.14	9.26	0.987	0.78
125	77.0	16.00	17.00	46.00	8.38	11.96	0.700	0.78
126	77.4	21.00	11.00	40.00	22.11	3.85	5.741	0.57
127	81.3	20.00	9.00	36.00	21.73	1.21	17.966	1.32
128	76.5	18.00	10.00	32.00	16.12	2.56	6.301	0.59
129	76.3	21.00	9.00	41.00	22.93	1.17	19.602	0.85
130	75.4	19.00	8.00	35.00	19.07	-0.14	-137.8	0.48
131	78.2	15.00	13.00	36.00	8.44	6.63	1.272	1.14
132	75.9	15.00	12.00	38.00	8.68	5.28	1.645	0.28
133	76.6	25.00	15.00	47.00	28.38	9.13	3.108	0.64
134	78.4	22.00	8.00	39.00	25.97	-0.18	-147.4	1.01
135	80.0	20.00	8.00	37.00	22.00	-0.14	-160.7	1.46
136	78.4	15.00	6.00	30.00	12.07	-2.74	-4.407	0.85
137	85.6	19.00	10.00	41.00	19.81	2.59	7.648	0.85
138	93.9	14.00	9.00	32.00	10.43	1.38	7.578	1.90
139	78.8	16.00	12.00	37.00	11.16	5.28	2.114	0.78
140	78.4	15.00	11.00	32.00	9.49	3.96	2.399	1.15
141	76.5	17.00	5.00	28.00	16.55	-4.11	-4.023	0.79
142	89.6	10.00	12.00	30.00	-0.86	5.47	-0.157	3.11
143	77.0	19.00	7.00	40.00	19.84	-1.47	-13.50	0.77
144	78.0	17.00	10.00	33.00	14.22	2.58	5.504	1.06
145	78.7	23.00	12.00	42.00	26.11	5.17	5.055	0.80
146	80.1	15.00	8.00	30.00	11.27	-0.05	-214.8	0.66
147	78.6	22.00	10.00	42.00	24.97	2.50	9.979	0.68
148	88.8	12.00	9.00	28.00	5.22	1.39	3.771	1.83
149	81.3	11.00	5.00	29.00	4.35	-4.00	-1.085	0.62
150	102.7	13.00	5.00	29.00	11.73	-3.99	-2.941	1.31
151	101.6	15.00	8.00	29.00	14.60	0.04	364.89	1.84
152	94.5	17.00	13.00	44.00	15.21	6.73	2.261	1.85

SAM NO	H#	BASE			RATIO	LUMEX %		
		3H CPM	14C CPM	WIDE CPM				
153	83.7	8.00	11.00	32.00	-5.16	4.11	-1.256	0.63
154	90.9	11.00	14.00	37.00	0.42	8.16	0.051	2.31
155	80.5	15.00	8.00	39.00	11.32	-0.05	-222.2	0.68
156	78.2	16.00	8.00	31.00	13.15	-0.08	-169.8	1.07
157	79.3	20.00	8.00	42.00	21.87	-0.14	-156.6	1.18
158	75.8	14.00	8.00	28.00	8.59	-0.06	-155.8	0.79
159	76.5	12.00	7.00	32.00	4.95	-1.36	-3.650	0.80
160	76.1	14.00	10.00	33.00	7.61	2.62	2.904	0.47
161	74.5	19.00	12.00	47.00	16.90	5.20	3.247	0.73
162	78.0	21.00	7.00	37.00	24.28	-1.50	-16.19	0.39
163	76.7	23.00	9.00	38.00	27.24	1.14	23.918	0.73

BASE  
LUMEX  
%

py.1004

166	75.4	16.00	8.00	32.00	12.76	-0.09	-142.6	0.90
167	75.1	17.00	8.00	36.00	14.82	-0.11	-138.5	0.86
168	75.9	18.00	6.00	31.00	18.05	-2.79	-6.457	0.73
169	75.4	14.00	9.00	35.00	8.04	1.28	6.281	1.17
170	76.5	22.00	2.00	30.00	28.65	-8.21	-3.490	1.12
171	81.4	24.00	15.00	47.00	27.26	9.19	2.966	1.42
172	80.4	18.00	10.00	40.00	16.73	2.58	6.487	0.97
173	76.8	9.00	5.00	21.00	-0.34	-3.98	0.086	0.75
174	88.5	14.00	12.00	34.00	8.04	5.39	1.492	1.67
175	86.0	13.00	8.00	30.00	7.66	0.01	1001.0	1.12
176	79.7	24.00	10.00	39.00	29.50	2.48	11.917	1.04
177	84.4	20.00	13.00	43.00	20.18	6.60	3.060	0.82
178	90.2	19.00	11.00	36.00	20.13	3.96	5.080	1.29
179	81.4	18.00	4.00	31.00	20.03	-5.46	-3.667	0.84
180	76.2	25.00	6.00	41.00	32.88	-2.91	-11.30	1.06
181	75.7	18.00	12.00	35.00	14.97	5.23	2.864	1.21
182	78.1	28.00	6.00	49.00	39.73	-2.95	-13.45	0.48
183	76.5	21.00	9.00	38.00	22.96	1.17	19.614	0.60
184	79.3	11.00	7.00	27.00	3.11	-1.33	-2.340	1.60
185	79.3	17.00	10.00	35.00	14.41	2.59	5.564	0.70
186	80.6	14.00	4.00	29.00	11.27	-5.40	-2.088	1.30
187	77.1	19.00	7.00	34.00	19.86	-1.47	-13.51	0.95
188	77.2	13.00	6.00	33.00	7.66	-2.71	-2.829	0.79
189	76.3	27.00	10.00	44.00	35.08	2.41	14.564	0.66
190	78.1	16.00	7.00	30.00	13.65	-1.42	-9.632	1.22
191	76.2	16.00	7.00	30.00	13.36	-1.42	-9.386	0.86
192	94.4	15.00	8.00	29.00	13.38	0.01	1443.5	1.10
193	80.0	18.00	12.00	47.00	15.62	5.26	2.971	0.70
194	81.6	22.00	13.00	46.00	24.02	6.54	3.671	0.87
195	90.4	16.00	6.00	37.00	16.12	-2.72	-5.924	1.23
196	88.9	20.00	13.00	43.00	21.04	6.63	3.173	0.72
197	82.6	25.00	8.00	44.00	33.38	-0.21	-157.6	0.34
198	83.3	18.00	7.00	38.00	18.80	-1.43	-13.12	0.98
199	75.4	23.00	9.00	41.00	26.96	1.13	23.797	1.09
200	82.3	18.00	8.00	36.00	18.09	-0.09	-192.3	0.92
201	82.5	20.00	9.00	39.00	21.96	1.22	18.074	0.69
202	79.5	15.00	10.00	31.00	10.15	2.62	3.869	0.78
203	76.7	18.00	8.00	30.00	17.16	-0.12	-146.8	0.83
204	90.1	24.00	10.00	42.00	31.99	2.53	12.663	0.87
205	83.2	16.00	9.00	35.00	13.34	1.29	10.375	0.84
206	74.7	13.00	6.00	29.00	7.38	-2.72	-2.715	1.03
207	81.3	12.00	9.00	30.00	4.41	1.34	3.282	0.78
208	78.7	18.00	15.00	41.00	13.87	9.27	1.497	0.63
209	79.9	20.00	8.00	41.00	21.98	-0.14	-160.2	0.81
210	91.2	13.00	5.00	31.00	9.99	-4.01	-2.490	0.91

SAM NO	H#	3H CPM	14C CPM	WIDE CPM	3H DPM	14C DPM	RATIO	LUMEX %
211	76.3	13.00	10.00	31.00	5.52	2.64	2.093	0.70
212	84.8	18.00	10.00	38.00	17.46	2.60	6.705	0.70
213	82.7	18.00	8.00	43.00	18.17	-0.09	-197.1	0.38
214	88.5	12.00	13.00	38.00	3.00	6.77	0.443	1.11
215	77.9	16.00	5.00	36.00	14.64	-4.09	-3.574	0.60
216	83.3	20.00	13.00	44.00	19.99	6.59	3.034	0.53
217	89.0	21.00	9.00	38.00	25.50	1.23	20.785	1.35
218	94.3	19.00	11.00	35.00	20.94	3.99	5.249	1.08
219	82.7	19.00	9.00	40.00	19.82	1.23	16.074	0.75
220	85.2	14.00	8.00	31.00	9.78	-0.01	-751.9	0.72
221	85.6	25.00	10.00	49.00	33.08	2.49	13.303	0.32

*[Handwritten signature]*



224	81.4	21.00	6.00	33.00	25.49	-2.83	-9.003	0.50
225	76.2	14.00	6.00	29.00	9.66	-2.73	-3.540	1.14
226	76.2	21.00	13.00	44.00	20.87	6.52	3.202	0.17
227	76.3	15.00	13.00	35.00	8.21	6.62	1.241	0.41
228	78.9	19.00	12.00	42.00	17.59	5.23	3.361	0.49
229	74.3	11.00	17.00	37.00	-2.40	12.01	-0.199	0.49
230	77.7	28.00	12.00	48.00	36.52	5.08	7.196	0.59
231	78.9	23.00	9.00	39.00	27.69	1.15	24.117	0.16
232	78.6	26.00	11.00	41.00	33.00	3.78	8.741	0.71
233	75.8	16.00	11.00	38.00	11.29	3.92	2.876	0.47
234	77.0	22.00	11.00	39.00	24.15	3.83	6.302	0.36
235	77.9	13.00	7.00	29.00	7.23	-1.37	-5.284	0.64
236	77.1	11.00	7.00	27.00	2.90	-1.34	-2.167	0.76
237	80.3	19.00	8.00	33.00	19.91	-0.12	-167.5	0.66
238	79.6	16.00	9.00	37.00	12.83	1.27	10.113	0.78
239	82.9	12.00	5.00	24.00	6.69	-4.02	-1.667	1.54
240	90.6	16.00	15.00	42.00	11.18	9.41	1.188	0.43
241	78.0	24.00	12.00	49.00	28.09	5.14	5.461	0.28
242	81.3	12.00	4.00	23.00	7.03	-5.36	-1.312	0.79
243	80.2	15.00	10.00	30.00	10.24	2.63	3.895	0.49
244	75.9	16.00	11.00	39.00	11.29	3.92	2.877	0.52
245	92.8	24.00	5.00	36.00	35.50	-4.21	-8.432	0.89
246	76.2	12.00	12.00	30.00	2.38	5.33	0.447	0.98
247	80.3	12.00	6.00	27.00	5.88	-2.68	-2.192	0.56
248	81.5	10.00	7.00	24.00	1.15	-1.30	-0.883	0.54
249	77.2	15.00	5.00	28.00	12.41	-4.08	-3.042	0.36
250	85.3	11.00	8.00	30.00	3.16	0.04	80.780	1.12
251	95.7	15.00	12.00	41.00	11.32	5.42	2.088	0.95
252	96.3	23.00	6.00	42.00	33.58	-2.84	-11.84	0.79
253	103.5	15.00	14.00	44.00	11.35	8.20	1.385	1.80