

Radiological Survey Sheet

Job Location Pfizer, Inc. Groton, Ct. 06340

112N/1111

Page 1 of 19

Survey Purpose Radiologic Survey of ^{Lab} Equipment

Date 2/22/2011

Performed by William H. Calver
(Print)

William H. Calver
(Sign)

Instrument (Model/S/N)	Packard Tri-Carb S/N 431521	Packard Tri-Carb S/N 431520	Ludlum 2241-2 163603	Wallac Model 1409 S/N 4061042
Det. (Model/SN)	Internal	Internal	Ludlum 43-68 PR 149613	Internal
Type Rad.	β	β	β	β
Cal. Due:	03/17/2011	03/17/2011	04/07/2011 ¹⁴	04/03/2011
Check Instruments Used		✓	✓	

No.	Time	Locations	See attached LSC printout for Total Activity (cpm/100 cm ²)
1.	0700	BACKGROUND	
2.		2nd Bench Front Upper Cabinets	Left
3.			Right
4.		Inside Cabinet Top Shelf	Left
5.			Right
6.		2nd Shelf	Left
7.			Right
8.		Btm Shelf	Left
9.			Right
10.		#2 Upper Cabinet Doors	Left
11.			Right
12.		Inside Cabinet Top Shelf	Left
13.			Right
14.		2nd Shelf	Left
15.			Right
16.		Btm Shelf	Left
17.			Right
18.	✓	#3 Upper Cabinet Doors	Left

Lab Survey conducted using Ludlum 2241-2 & 43-68 meters. All readings were SATISFACTORY. The Lab has been successfully decommissioned as a Radioactive Lab 3/1/2011
 W.H. Calver
 W.H. Calver

Radiological Survey Continuation Sheet

Page 2 of 19

Date 2/22/2011
118N/N111

No.	Time	Locations	See attached LSC printout for Total Activity (cpm/100 cm ²)
19	0720		#3 Cabinet Doors Right
20			inside Top Shelf Left
21			Right
22			2nd Shelf Left
23			Right
24			3rd Shelf Left
25			Right
26			Long Shelf Below Top Cabinets Left
27			2nd
28			3rd
29			4th
30			5th
31			6th
32		Bench top from aisle	Left Front
33			Rear
34			2ND Front
35			Rear
36			3RD Front
37			Rear
38			4th Front
39			Rear
40			5th Front
41			Rear
42			6th Front
43			Rear
44		Below Left Bench	Top Shelf Front
45	✓		Rear

Radiological Survey Continuation Sheet

Page 3 of 19

Date 2/22/2011

118N/N111

No.	Time	Locations	See attached LSC printout for Total Activity (cpm/100 cm ²)
46	0740		Btm Shelf Left
47			Right
48			Knee Hole Left
49			Rear
50			Right
51		Row of Drawers	Top Outer
52			Inner
53			2nd Outer
54			Inner
55			3rd Outer
56			INNER
57			4th Outer
58			Inner
59			5th Outer
60			Inner
61		2ND Bench Rear from mask	Upper Cabinets Outer Doors Left
62			Right
63		Inside Shelves	Top Left
64			Right
65			2nd Left
66			Right
67			Lowest Shelf Left
68			Right
69		Upper Cabinets	Middle Doors Left
70			Right
71		Top Shelf	Left
72	✓		Right

Radiological Survey Continuation Sheet

Page 4 of 19

Date 2/22/2011
118N/NI11

No.	Time	Locations	See attached LSC printout for Total Activity (cpm/100 cm ²)	
73	0810		2nd Shelf	
74			Left	
75			Btm Shelf	
76				Right
77			Right Upper Cabinet Doors	
78				Left
79			Inside Upper Cabinet Top Shelf	
80				Right
81				2nd Shelf
82				Left
83				Right
84				Btm Shelf
85			Long Shelf below Upper Cabinets from aisle	Left
86				Right
87				1
88				2
89				3
90				4
91			Bench Top from aisle	5
92				6
93			1	
94			2	
95			3	
96			4	
97			5	
98			6	
99	✓		5	

Radiological Survey Continuation Sheet

Page 5 of 19

Date 2/22/2011

118N/N111

No.	Time	Locations	See attached LSC printout for Total Activity (cpm/100 cm ²)	
100	0835	Bench Top	5	Rear
101			6	Front
102				Rear
103		Below Bench Top Aisle End Top Shelf		Front
104				Rear
105			2nd Shelf	Front
106				Rear
107		Knee Hole	Left Wall	
108			Rear Wall	
109			Right Wall	
110		Row of Drawers	Top	Outer
111				Inner
112			2nd	Outer
113				Inner
114			3rd	Outer
115				Inner
116			4th	Outer
117				Inner
118			5th	Outer
119				Inner
120		Right Wall		Upper
121				Lower
122		Black Peg Board		Upper
123				Lower
124		Splash Board behind SINK		Left
125				Right
126	✓	Bench Top left of SINK		1

Radiological Survey Continuation Sheet

Page 6 of 19

Date 2/22/2011

118N/1111

No.	Time	Locations	See attached LSC printout for Total Activity (cpm/100 cm ²)
127	0905	Bench Top left of sink	2
128		Behind sink	
129		Right of Sink	
130		Faucet	
131		SINK Inside Front	Left
132			Right
133		Left Wall	
134		Rear Wall	Left
135			Right
136		Right Wall	
137		FLOOR	Left
138			Right
139		Drain	
140		Below Sink Cabinet Doors	Left
141			Right
142		Inside Cabinet Floor	Left
143			Middle
144			Right
145		3RD Bench Front from aisle Upper Cabinet Doors	Left
146			Right
147		Inside Top Shelf	Left
148			Right
149		2ND Shelf	Left
150			Right
151		Bottom Shelf	Left
152			Right
153	✓	Upper Middle Cabinet Doors	Left

Radiological Survey Continuation Sheet

Page 7 of 19

Date 2/22/2011

118N/N111

No.	Time	Locations	See attached LSC printout for Total Activity (cpm/100 cm ²)	
154	0918	Upper Middle Cabinet	DOORS	Right
155		Top Shelf	Left	
156			Right	
157		2ND Shelf	Left	
158			Right	
159		Bottom Shelf	Left	
160			Right	
161		Long Shelf below Upper Cabinets		Left
162				2ND
163				3RD
164				4TH
165				5TH
166				6TH
167		Bench Top from aisle	1	Front
168				Rear
169			2	Front
170				Rear
171			3	Front
172				Rear
173			4	Front
174				Rear
175			5	Front
176				Rear
177			6	Front
178				Rear
179		Kneehole below Bench Top		Left Wall
180	↓			Rear Wall

Radiological Survey Continuation Sheet

Page 8 of 19

Date 2/22/2011
118N/N111

No.	Time	Locations	See attached LSC printout for Total Activity (cpm/100 cm ²)
181	0937	Kneehole below Bench Top	Right Wall
182		Row of Drawers Top	Outer
183			Inner
184		2nd	Outer
185			Inner
186		3rd	Outer
187			Inner
188		4th	Outer
189			Inner
190		Btm	Outer
191			Inner
192		Aisle End of Bench Shelving Top Shelf	Left
193			Middle
194			Right
195		Btm Shelf	Left
196			Middle
197			Right
198		3RD Bench from aisle ^{Rear} Upper Cabinets Doors	Left
199			Right
200		Inside Top Shelf	Left
201			Right
202		2ND Shelf	Left
203			Right
204		Middle Cabinet Doors	Left
205			Right
206		Inside Top Shelf	Left
207	↓		Right

Radiological Survey Continuation Sheet

Page 9 of 19

Date 2/22/2011
118N/N111

No.	Time	Locations	See attached LSC printout for Total Activity (cpm/100 cm ²)
208	1000	Middle Cabinet Bottom Shelf	Left
209			Right
210		Third Cabinet Doors	Left
211			Right
212		Top Shelf	Left
213			Right
214		Bottom Shelf	Left
215			Right
216		Long Shelf below Cabinets from aisle	1
217			2
218			3
219			4
220			5
221			6
222		Bench Top from aisle	Front
223			Rear
224			Front
225			Rear
226			FRONT
227			Rear
228			Front
229			Rear
230			Front
231			Rear
232			FRONT
233			Rear
234	✓	Kneehole below Bench	Left Wall

Radiological Survey Continuation Sheet

Page 10 of 19

Date 2/27/2011

118N/N111

No.	Time	Locations	See attached LSC printout for Total Activity (cpm/100 cm ²)
235	1028	Knee hole below Bench	Rear Wall
236			Right Wall
237		Row of Drawers	Top Outer
238			Inner
239			2ND Outer
240			Inner
241			3RD Outer
242			Inner
243			4th Outer
244			Inner
245			5th Outer
246			Inner
247		Right Wall	Upper
248			Lower
249		Eye Wash	
250		Black Peg Board	Upper
251			Lower
252		Back Splash	Left
253			Right
254		Bench Top Right from Sink	1
255			2
256		FRONT of Sink	
257		Left	
258		Rear	
259		Inside Sink Front	Left
260			Right
261	✓	Left	

Radiological Survey Continuation Sheet

Page 11 of 19

Date 2/22/2011
118N/VIII

No.	Time	Locations	See attached LSC printout for Total Activity (cpm/100 cm ²)
262	1100	Inside Sink Front	Rear
263			Left
264			Right
265			Right
266			Floor
267			Left
268			Right
269			Drain
270		Cabinet Doors below Sink	Left
271			Right
272		Inside Floor	Left
273			Right
274		Paper Towel Dispenser	
275		Rear Wall	Upper
276			Lower
277			2
278			Upper
279			Lower
280		Fire Extinguisher	
281		Rear Door	Inside
282			Outside
283		Emergency Shower Handle	
284		Right Front ^{Rear} Wall	Upper
285			Lower
286		Left Wall from Front	Upper
287			Lower
288		Sliding Glass Doors	Left
			Right
		Left Wall	Upper
			Lower

Radiological Survey Continuation Sheet

Page 12 of 19

Date 2/22/2011
118N/N111

No.	Time	Locations	See attached LSC printout for Total Activity (cpm/100 cm ²)
289	1215	Sliding Glass Doors	Left
290			Right
291		Left Wall	Upper
292			Lower
293		Sliding Glass Doors	Left
294			Right
295		Left Wall	Upper
296			Lower
297		FLOOR	Inside Front Door
298			Knee Hole 1st Bench Front
299			In Front of Front Office
300			Knee hole 1st Bench rear
301			In Front of Hood
302			Left
303			Right
304			In Front of Second Office
305			Knee hole Second Bench Front
306			In front of sink
307			Left
308			Right
309			Second Bench Rear Knee hole
310			In front of Knee hole Freezer
311			In front of Knee hole Freezer
312			In front of Rear Sink
313			Left
314			Right
315	✓		In front of Portable Hood
			Left
			Right
			In front of Rear Door
			Aisle in front of freezer/fridge

Assay Definition-

Assay Description:
Background check for PM Lab (Mikey)

Assay Type: CPM
Report Name: Report1
Output Data Path: C:\Packard\Tricarb\Results\bill\bills swipes
Raw Results Path: C:\Packard\Tricarb\Results\bill\bills swipes\20110222_0953\20110222_0953.results
RTF File Name: C:\Packard\Tricarb\Results\bill\bills swipes\Report1.rtf
Assay File Name: C:\Packard\TriCarb\Assays\bills swipes.lsa

Count Conditions-

Nuclide: TRIPLE
Quench Indicator: tSIE/AEC
External Std Terminator (sec): 0.5 2s%
Pre-Count Delay (min): 0.00
Quench Set: n/a
Count Time (min): 1.00
Count Mode: Normal
Assay Count Cycles: 1 Repeat Sample Count: 1
#Vials/Sample: 1 Calculate % Reference: Off

Background Subtract: Off
Low CPM Threshold: Off
2 Sigma % Terminator: Off

Regions	LL	UL
A	0.0	18.6
B	18.6	156.0
C	0.0	2000.0

Count Corrections-

Static Controller: On Luminescence Correction: On
Colored Samples: n/a Heterogeneity Monitor: n/a
Coincidence Time (nsec): 18 Delay Before Burst (nsec): 75

Half Life-

Half Life Correction: Off

Regions	Half Life	Units	Reference Date	Reference Time
A				
B				
C				

Cycle 1 Results

S#	CPMA	CPMB	CPMC	MESSAGES
1	30	5	43	
2	15	10	29	
3	6	7	20	
4	12	2	17	
5	11	4	20	
6	7	2	11	
7	5	3	17	
8	12	5	18	
9	7	4	15	
10	8	5	18	
11	12	13	27	

12	9	9	22
13	11	2	14
14	11	5	24
15	16	6	23
16	13	7	25
17	11	5	20
18	9	6	17
19	11	7	24
20	16	6	30
21	14	6	26
22	8	2	12
23	12	7	23
24	12	7	22
25	12	12	32
26	10	3	15
27	6	7	18
28	10	9	22
29	10	7	27
30	9	7	23
31	14	8	28
32	14	2	20
33	13	11	31
34	15	1	26
35	16	8	29
36	7	9	22
37	13	8	28
38	11	6	19
39	7	8	20
40	13	8	26
41	16	5	24
42	19	8	29
43	11	7	20
44	10	6	20
45	12	13	35
46	10	9	25
47	10	6	24
48	7	6	19
49	8	5	14
50	9	10	25
51	16	2	20
52	16	8	32
53	13	14	33
54	10	5	20
55	13	14	29
56	14	4	22
57	10	7	21
58	13	3	21
59	11	7	23
60	9	6	19
61	19	2	25
62	11	7	22
63	13	4	24
64	9	4	18
65	16	9	28
66	7	6	21
67	11	4	19
68	10	8	25
69	7	6	21
70	8	7	17
71	10	9	21
72	17	6	27
73	5	1	14
74	10	10	29

75	6	7	21
76	8	6	21
77	16	9	28
78	7	11	22
79	8	6	18
80	10	10	24
81	10	6	24
82	13	5	23
83	10	3	22
84	8	9	25
85	5	5	12
86	8	3	17
87	11	4	18
88	15	12	32
89	12	9	22
90	11	6	25
91	14	7	29
92	15	4	27
93	15	7	27
94	7	7	19
95	9	8	20
96	12	6	23
97	9	9	21
98	9	8	19
99	10	4	20
100	7	9	19
101	5	5	11
102	12	8	25
103	10	11	26
104	14	3	27
105	12	7	26
106	11	6	26
107	20	7	36
108	9	9	28
109	8	8	18
110	9	9	22
111	12	3	22
112	13	14	31
113	18	9	34
114	9	5	20
115	16	5	26
116	15	3	23
117	9	5	20
118	12	8	25
119	12	9	25
120	8	7	20
121	18	7	31
122	15	5	28
123	15	6	24
124	14	6	27
125	13	10	28
126	10	4	19
127	15	6	29
128	8	9	19
129	8	3	20
130	8	6	18
131	11	8	26
132	14	6	24
133	12	11	29
134	10	11	24
135	10	11	22
136	10	7	21
137	11	6	20

138	15	5	27
139	15	16	37
140	16	5	25
141	15	8	27
142	12	7	27
143	11	7	27
144	13	8	27
145	13	5	21
146	10	9	29
147	13	6	24
148	18	7	31
149	6	8	18
150	9	10	24
151	13	16	34
152	15	7	24
153	13	6	22
154	6	8	16
155	13	10	25
156	14	8	28
157	9	6	20
158	12	4	18
159	13	9	27
160	9	8	23
161	14	9	31
162	7	8	17
163	15	6	25
164	12	5	25
165	8	4	17
166	13	6	25
167	8	2	18
168	21	2	30
169	11	5	21
170	12	8	24
171	12	3	21
172	11	6	22
173	12	15	31
174	17	3	25
175	10	9	22
176	11	8	22
177	13	4	22
178	9	9	20
179	10	5	23
180	9	8	25
181	12	8	32
182	8	12	26
183	18	5	31
184	10	6	24
185	8	0	12
186	14	6	23
187	3	7	13
188	7	5	20
189	18	4	23
190	15	7	29
191	8	5	20
192	16	9	29
193	13	2	18
194	15	4	22
195	3	4	10
196	15	4	26
197	11	5	18
198	9	3	17
199	13	10	26
200	14	7	26

201	13	4	21
202	16	6	30
203	5	9	23
204	13	6	19
205	12	9	24
206	17	6	28
207	13	11	30
208	8	5	18
209	14	2	20
210	11	6	22
211	14	9	26
212	7	9	22
213	8	7	22
214	8	8	18
215	5	5	15
216	11	8	20
217	7	12	23
218	11	2	14
219	11	6	18
220	8	11	26
221	13	8	28
222	8	7	21
223	10	1	19
224	7	10	23
225	11	9	26
226	10	10	28
227	11	7	21
228	8	7	18
229	14	6	28
230	11	11	29
231	13	6	28
232	17	5	24
233	12	4	25
234	12	12	30
235	15	5	23
236	8	7	19
237	11	7	27
238	23	5	29
239	10	6	23
240	17	11	35
241	12	5	23
242	17	4	26
243	8	5	24
244	13	4	21
245	26	7	37
246	20	9	34
247	8	6	22
248	13	5	27
249	6	7	18
250	10	6	28
251	4	7	15
252	10	7	22
253	13	8	24
254	8	9	20
255	16	9	30
256	14	6	27
257	8	3	18
258	14	9	32
259	18	3	26
260	16	3	24
261	9	11	26
262	8	7	21
263	10	10	23

264	16	5	30
265	6	6	18
266	15	6	32
267	10	5	22
268	12	9	27
269	11	10	27
270	13	6	22
271	13	5	21
272	9	8	22
273	10	11	26
274	14	5	25
275	18	4	26
276	13	4	24
277	10	11	26
278	7	6	16
279	3	16	26
280	16	5	28
281	11	6	21
282	11	7	21
283	7	4	16
284	9	9	24
285	15	4	25
286	9	3	17
287	11	10	25
288	17	6	28
289	12	5	20
290	15	9	29
291	10	4	18
292	5	5	14
293	16	11	31
294	9	6	17
295	5	6	15
296	6	7	20
297	11	3	18
298	10	7	21
299	10	2	15
300	15	7	30
301	9	7	24
302	6	4	15
303	14	3	22
304	11	2	17
305	16	12	32
306	8	6	17
307	14	4	21
308	21	12	36
309	12	8	29
310	13	9	29
311	11	7	24
312	6	9	19
313	6	11	21
314	1	7	11
315	9	4	17
316	10	3	17
317	5	7	20
318	9	8	25
319	8	10	22

Bld. 118N Room N111

Page 19A of 19A

Date: 2/22/11

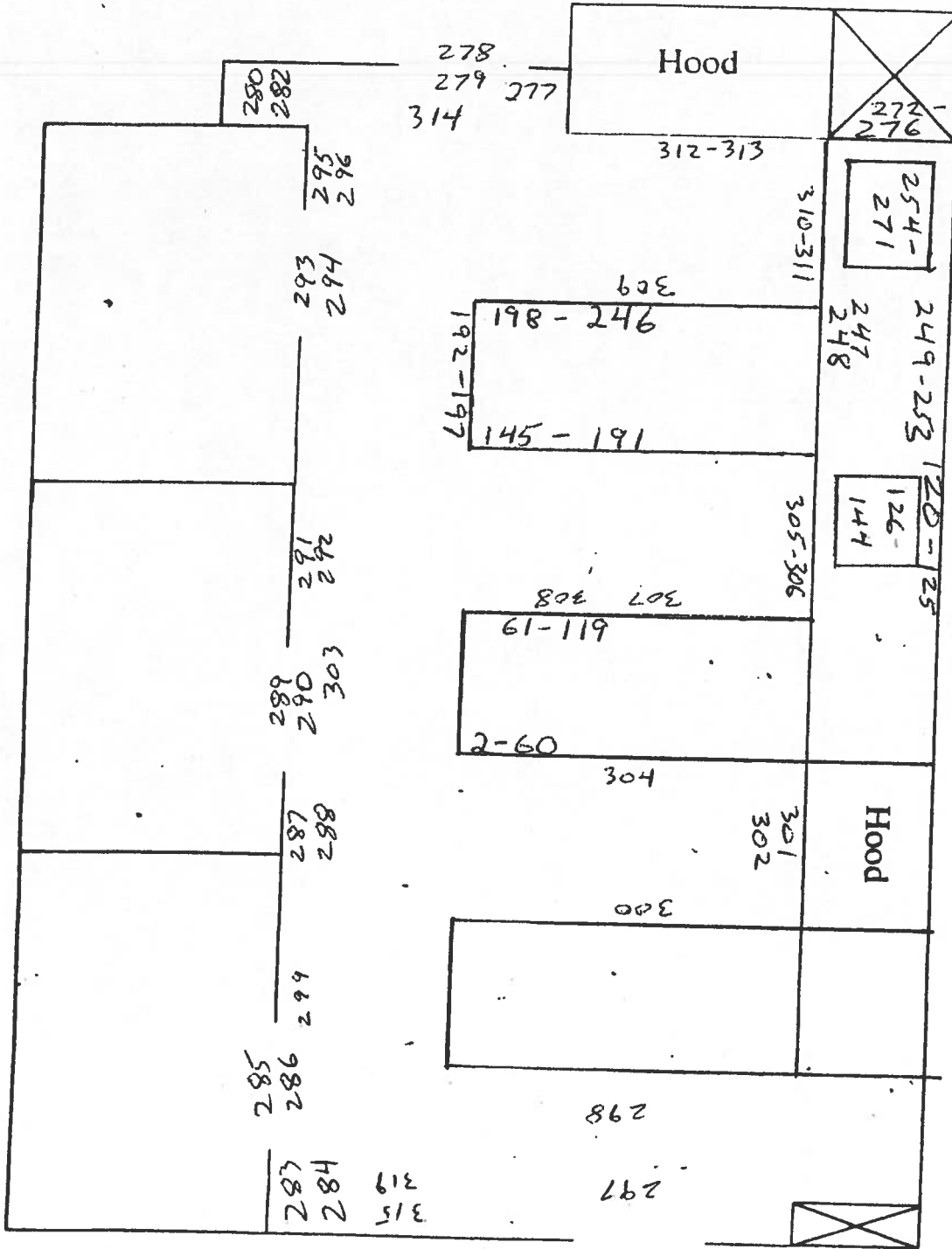

(WIPE LOCATIONS)