

Radiological Survey Sheet

Job Location Pfizer, Inc. Groton, Ct. 06340 118N | N05 Page 1 of 6
 Survey Purpose ^{ES} Radiologic Survey of Equipment LAB DECOMM Date 10-3-12
 Performed by E. GAILOR E. Gailor
 (Print) (Sign)

Instrument (Model/S/N)	Packard Tri-Carb S/N 431521	Packard Tri-Carb S/N 431520	Ludlum 2241-2 163603	Wallac Model 1409 S/N 4061042
Det. (Model/SN)	Internal	Internal	Ludlum 43-68 PR 149613	Internal
Type Rad.	β	β	β	β
Cal. Due:	03/05/2013	03/05/2013	04/17/2013	09/15/2012
Check Instruments Used	✓		✓	

No.	Time	Locations	See attached LSC printout for Total Activity (cpm/100 cm ²)
1.	0815	BACKGROUND	
2.		door	
3.		FLOOR	
4.		UPPER WALL	
5.		LOWER "	
6.		UPPER "	
7.		LOWER "	
8.		UPPER "	
9.		LOWER "	
10.		UPPER "	
11.		LOWER "	
12.		UPPER "	
13.		LOWER "	
14.		UPPER "	
15.		LOWER "	
16.		UPPER "	
17.		LOWER "	
18.	✓	UPPER "	

Radiological Survey Continuation Sheet

Page 2 of 6

Date 10-3-12

No.	Time	Locations	See attached LSC printout for Total Activity (cpm/100 cm ²)
19	0815	LOWER WALL	
20		UPPER "	
21		LOWER "	
22		UPPER "	
23		LOWER "	
24		UPPER "	
25		LOWER "	
26		UPPER "	
27		LOWER "	
28		UPPER "	
29		LOWER "	
30		UPPER "	
31		LOWER "	
32		CAB DOORS	
33		" TOP SHELF	
34		" 2ND "	
35		" 3RD "	
36		SINK AREA	
37		UPPER WALL	
38		LOWER "	
39		FLOOR	
40		"	
41		"	
42		"	
43		"	
44		"	
45	✓	"	

118 N / No 5

Page 4 of 6
10-3-12

O = wipe location

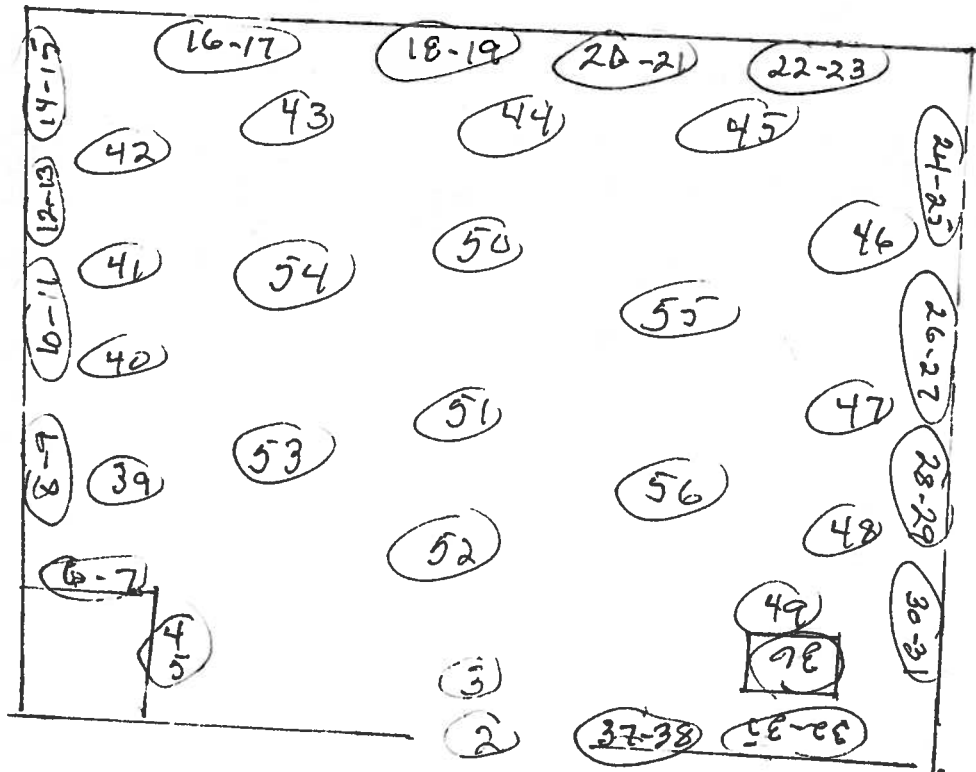

- Swept 100% of lower surfaces using 43-68. NO READINGS IN EXCESS OF NORMAL BACKGROUND LEVELS WERE NOTED.

Assay Definition-

Assay Description:
Equipment Swipes

Assay Type: CPM
Report Name: Report1
Output Data Path: C:\Packard\Tricarb\Results\Ed Gailor\Eds Monthly Swipes
Raw Results Path: C:\Packard\Tricarb\Results\Ed Gailor\Eds Monthly Swipes\20121003_1009
\20121003_1009.results
RTF File Name: C:\Packard\Tricarb\Results\Ed Gailor\Eds Monthly Swipes\Ed's Monthly
Swipes.rtf
Assay File Name: C:\Packard\TriCarb\Assays\Eds Monthly Swipes.lsa

Count Conditions-

Nuclide: Triple
Quench Indicator: tSIE/AEC
External Std Terminator (sec): 5 sec
Pre-Count Delay (min): 0.00
Quench Set: n/a
Count Time (min): 1.00
Count Mode: Normal
Assay Count Cycles: 1 Repeat Sample Count: 1
#Vials/Sample: 1 Calculate % Reference: Off

Background Subtract: On - Manual
Low CPM Threshold: Off
2 Sigma % Terminator: Off

Regions	LL	UL	Bkg Subtract
A	0.0	18.6	0.00
B	18.6	156.0	0.00
C	0.0	2000.0	0.00

Count Corrections-

Static Controller: On Luminescence Correction: On
Colored Samples: n/a Heterogeneity Monitor: n/a
Coincidence Time (nsec): 18 Delay Before Burst (nsec): 75

Half Life-

Half Life Correction: Off

Regions	Half Life	Units	Reference Date	Reference Time
A				
B				
C				

Cycle 1 Results

S#	CPMA	CPMB	CPMC	MESSAGES
1	10	6	24	
2	17	7	31	
3	12	7	24	
4	20	11	36	
5	19	4	30	
6	6	5	20	
7	10	10	26	
8	12	12	28	
9	14	5	26	
10	5	6	18	

11	10	9	23
12	11	4	16
13	4	6	13
14	3	7	17
15	3	12	21
16	7	12	25
17	6	9	22
18	8	7	26
19	15	4	23
20	14	7	27
21	11	7	26
22	17	7	29
23	7	2	14
24	12	4	17
25	10	7	26
26	17	10	33
27	10	11	26
28	15	7	25
29	11	13	33
30	10	7	19
31	6	9	19
32	15	8	29
33	10	7	24
34	8	5	17
35	5	6	19
36	11	3	20
37	4	11	17
38	9	6	21
39	7	6	20
40	10	5	19
41	2	3	8
42	5	9	19
43	7	7	19
44	9	8	20
45	17	10	33
46	3	8	19
47	6	4	15
48	4	16	28
49	16	5	25
50	6	2	14
51	4	5	12
52	11	11	30
53	7	7	20
54	3	5	17
55	8	5	17
56	3	10	23