

## Radiological Survey Sheet

Job Location PEIZER INC, GROTON, CT. 06340 118E/E114 Page 1 of 33

Survey Purpose RADIOLOGIC SURVEY & DECON of RADLAB Date 12/6/06

Performed by William H Calver William H. Calver  
 (Print) (Sign)

<b>Instrument (Model/S/N)</b>	Packard Tri-Carb S/N 431521	Packard Tri-Carb S/N 431520	Ludlum 2241-2 163603	
<b>Det. (Model/SN)</b>	Internal	Internal	Ludlum 43-68 PR 149613	
<b>Type Rad.</b>	β	β	β	
<b>Cal. Due:</b>	09/17/2007	09/17/2007	04/14/07	
<b>Check Instruments Used</b>		✓	✓	

No.	Time	Locations	See attached LSC printout for Total Activity (cpm/100 cm <sup>2</sup> )
1.	0700	BACKGROUND	
2.	0700	Outer Front Door Knob	
3.		Inside Front Door Knob	
4.		Inside door	UPPER
5.			MIDDLE
6.			LOWER
7.		Light Switches, Thermostat	
8.		First Cabinet below Hood Outer Door Left	UPPER
9.			LOWER
10.			Right UPPER
11.			LOWER
12.		FLOOR	Left
13.			Middle
14.			Right
15.		2nd Cabinet below Hood Outer Door Left	Upper
16.			Lower
17.			Right UPPER
18.	↓		LOWER

# Radiological Survey Continuation Sheet

Page 2 of 33

Date 12/6/06

118E/E114

No.	Time	Locations	See attached LSC printout for Total Activity (cpm/100 cm <sup>2</sup> )
19	0715	2nd Cabinet below Hood	Inside Floor Left
20			Middle
21			Right
22		Shelf	Left
23			Middle
24			Right
25		FRONT Wall after Hood	UPPER
26			MIDDLE
27			LOWER
28		Left Wall near Front before Upper Cabinets	UPPER
29			MIDDLE
30			LOWER
31		Left Wall UPPER Cabinets 1st set Outer Left Door	UPPER
32			MIDDLE
33			LOWER
34			Right Door UPPER
35			MIDDLE
36			LOWER
37		Inside Top Shelf	Left
38			MIDDLE
39			RIGHT
40		2nd Shelf	Left
41			Middle
42			Right
43		FLOOR	Left
44			Middle
45	✓		Right

# Radiological Survey Continuation Sheet

Page 3 of 33

Date 12/6/06  
118E/E114

No.	Time	Locations	See attached LSC printout for Total Activity (cpm/100 cm <sup>2</sup> )
46	0735	UPPER CABINET 2ND SET Outer Left Door	Upper
47			Middle
48			Lower
49		Right Door	UPPER
50			MIDDLE
51			LOWER
52		Inside Top Shelf	LEFT
53			MIDDLE
54			RIGHT
55		2ND Shelf	LEFT
56			MIDDLE
57			RIGHT
58		FLOOR	LEFT
59			MIDDLE
60			RIGHT
61		Wall below 1st Cabinet 1st	UPPER
62			MIDDLE
63			LOWER
64			2ND UPPER
65			MIDDLE
66			LOWER
67			3RD UPPER
68			LOWER
69			4TH UPPER
70			LOWER
71		Counter Top Left	FRONT
72	✓		REAR

# Radiological Survey Continuation Sheet

Page 4 of 33

Date 12/6/06

118E/E114

No.	Time	Locations	See attached LSC printout for Total Activity (cpm/100 cm <sup>2</sup> )
73	0750	Counter Top	2ND FRONT
74			REAR
75			3RD FRONT
76			REAR
77		Below Counter Top left	Drawer Outer Front
78			Inside FRONT
79			REAR
80		Cabinet Door	Outer UPPER
81			LOWER
82			Inside Top Shelf Left
83			Right
84			FLOOR FRONT
85			REAR
86		2ND Row Drawers Top Drawer	Outer Front
87			Inside FRONT
88			REAR
89			2ND DRAWER Outer Front
90			INSIDE FRONT
91			REAR
92			3RD DRAWER Outer Front
93			INSIDE FRONT
94			REAR
95			4TH DRAWER Outer Front
96			Inside FRONT
97			REAR
98		3RD ROW Top Drawer	Outer Front
99	✓		INSIDE FRONT

# Radiological Survey Continuation Sheet

Page 5 of 33

Date 12/6/06

118E/E114

No.	Time	Locations	See attached LSC printout for Total Activity (cpm/100 cm <sup>2</sup> )
100	0810	3RD ROW Top DRAWER	INSIDE REAR
101		2ND DRAWER	OUTER FRONT
102			INSIDE FRONT
103			REAR
104		3RD DRAWER	OUTER FRONT
105			INSIDE FRONT
106			REAR
107		HTH DRAWER	OUTER FRONT
108			INSIDE FRONT
109			REAR
110		Door into 112	UPPER
111			MIDDLE
112			LOWER
113		FOUR DRAWER CABINET	TOP Left
114			Right
115		TOP DRAWER	OUTER FRONT Left
116			Right
117			INSIDE Left
118			Right
119		2ND DRAWER	OUTER FRONT Left
120			Right
121			INSIDE Left
122			Right
123		3RD DRAWER	OUTER FRONT Left
124			Right
125			INSIDE Left
126	✓		Right

# Radiological Survey Continuation Sheet

Page 6 of 33

Date 12/6/06  
118E/E114

No.	Time	Locations	See attached LSC printout for Total Activity (cpm/100 cm <sup>2</sup> )
127	0850	HTH DRAWER OUTER FRONT	Left
128			Right
129		Inside	Left
130			Right
131		White Board FRONT	UPPER
132			LOWER
133		TRAY	
134		Rear Wall from Left Windowsill TOP	1
135			2
136			3
137			4
138			5
139			6
140			7
141			8
142			9
143			10
144		Desk EXTENSION TOP	Left
145			MIDDLE
146			RIGHT
147		Below Top Left	UPPER DRAWER Outer
148			Inside FRONT
149			REAR
150			2ND DRAWER Outer FRONT
151			Inside FRONT
152			REAR
153	✓		3RD DRAWER Outer FRONT

# Radiological Survey Continuation Sheet

Page 7 of 23

Date 12/6/06

118E/114

No.	Time	Locations	See attached LSC printout for Total Activity (cpm/100 cm <sup>2</sup> )
154	0915		3RD DRAWER Inside FRONT
155			REAR
156		Shelving Unit above Desk Left	TOP
157			Middle
158			Right
159			2ND shelf Left
160			Middle
161			Right
162		Desk Top From Left	FRONT
163			REAR
164			Middle FRONT
165			REAR
166			Right FRONT
167			REAR
168		End of Desk below Desk TOP	TOP DRAWER Outer FRONT
169			Inside FRONT
170			REAR
171			LOWER DRAWER Outer FRONT
172			Inside FRONT
173			REAR
174		Rear Wall <sup>Below window</sup> <del>to window</del>	1ST UPPER
175			LOWER
176			2ND UPPER
177			LOWER
178			3RD UPPER
179			LOWER
180	✓		4TH UPPER

# Radiological Survey Continuation Sheet

Page 8 of 33

Date 12/6/06

118E/114

No.	Time	Locations	See attached LSC printout for Total Activity (cpm/100 cm <sup>2</sup> )
181	0940	Rear Wall Below Window	LOWER
182			5TH UPPER
183			LOWER
184			6TH UPPER
185			LOWER
186			7TH UPPER
187			LOWER
188			8TH UPPER
189			LOWER
190		RT Wall Rear UPPER CABINET <sup>1</sup>	Outer Door Left Upper
191			MIDDLE
192			LOWER
193			Outer Door Right UPPER
194			MIDDLE
195			LOWER
196		Inside Top Shelf	Left
197			Middle
198			Right
199		2ND	Left
200			Middle
201			Right
202		3RD	Left
203			Middle
204			Right
205		FLOOR	Left
206			MIDDLE
207	✓		RIGHT



# Radiological Survey Continuation Sheet

Page 9 of 33

Date 12/6/06

118E/E114

No.	Time	Locations	See attached LSC printout for Total Activity (cpm/100 cm <sup>2</sup> )
208	1000	RT WALL UPPER CABINET #2 Outer Left Door	UPPER
209			MIDDLE
210			LOWER
211			Right Door UPPER
212			MIDDLE
213			LOWER
214		Inside Top Shelf	TOP Left
215			MIDDLE
216			Right
217			2ND Left
218			Middle
219			Right
220			3RD Left
221			Middle
222			Right
223		UPPER CABINET #3 Outer Left Door	UPPER
224			MIDDLE
225			LOWER
226			Outer Right Door UPPER
227			MIDDLE
228			LOWER
229		Inside Top Shelf	Left
230			MIDDLE
231			RIGHT
232			2ND Left
233			Middle
234	✓		Right

# Radiological Survey Continuation Sheet

Page 10 of 33

Date 12/6/06

118E/E114

No.	Time	Locations	See attached LSC printout for Total Activity (cpm/100 cm <sup>2</sup> )
235	1020	UPPER CABINET #3 FLOOR	Left
236			Middle
237			Right
238		UPPER CABINET #4 Outer Left Door	UPPER
239			MIDDLE
240			LOWER
241		Outer Right Door	UPPER
242			MIDDLE
243			LOWER
244		Inside Top Shelf	Left
245			Middle
246			Right
247		2ND	Left
248			Middle
249		<del>2ND</del>	Right
250		3RD	Left
251			Middle
252			Right
253		Below Upper Cabinet #1 Right Wall Rest	UPPER
254			LOWER
255		Below Upper Cabinet #2	UPPER
256			<del>MIDDLE</del>
257			LOWER
258		Below Upper Cabinet #3	UPPER
259			MIDDLE
260			LOWER
261	✓	Below Upper Cabinet #4	UPPER

# Radiological Survey Continuation Sheet

Page 11 of 33

Date 12/6/06

118E/E114

No.	Time	Locations	See attached LSC printout for Total Activity (cpm/100 cm <sup>2</sup> )
262	1040	Below Upper Cabinet # 4	LOWER
263		RT Wall Rear Table Top from left	FRONT
264			REAR
265		Middle	FRONT
266			REAR
267		Right	FRONT
268			REAR
269		Left Front Drawer Outer	
270		INSIDE	Left
271			Right
272		Right Front Drawer Outer	<del>Left</del> Sink
273		INSIDE	<del>Right</del> Left
274			Right
275		Bench Top RT Wall near Sink from left	FRONT
276			REAR
277			FRONT
278			REAR
279			FRONT
280			REAR
281		Below Bench Top from left Top Drawer Outer	
282			INSIDE FRONT
283			REAR
284		2ND Drawer Outer	
285			INSIDE FRONT
286			REAR
287		3RD Drawer Outer	
288	✓		INSIDE FRONT

# Radiological Survey Continuation Sheet

Page 12 of 33

Date 12/6/06

118E/E114

No.	Time	Locations	See attached LSC printout for Total Activity (cpm/100 cm <sup>2</sup> )
289	1100		3RD Drawer Inside REAR
290			4TH Drawer OUTER FRONT
291			INSIDE FRONT
292			REAR
293		2ND Row Top Drawer OUTER	FRONT
294			INSIDE FRONT
295			REAR
296		2ND DRAWER OUTER	FRONT
297			INSIDE FRONT
298			REAR
299		3RD DRAWER OUTER	FRONT
300			INSIDE FRONT
301			REAR
302		4TH DRAWER OUTER	FRONT
303			INSIDE FRONT
304			REAR
305		RT Wall FRONT Top Shelf	Left
306			Middle
307			Right
308		2ND Shelf	Left
309			Middle
310			Right
311		3RD Shelf	Left
312			Middle
313			Right
314		Wall below Shelf	UPPER
315	✓		LOWER

# Radiological Survey Continuation Sheet

Page 13 of 33

Date 12/6/06

118E/E114

No.	Time	Locations	See attached LSC printout for Total Activity (cpm/100 cm <sup>2</sup> )
316	1130	Sink TOP To left	FRONT
317			REAR
318			FRONT
319			REAR
320		Left Faucet	
321		Right Faucet	
322		Eye Wash	
323		Inside Sink	FRONT Left
324			Right
325			Left
326			REAR Left
327			Right
328			Right
329		FLOOR	Left
330			Right
331		DRAIN	
332		DRAIN Receptacle	
333		Cabinet below Sink	Left Door Outer UPPER
334			LOWER
335			Right Door UPPER
336			LOWER
337		Inside FLOOR	Left FRONT
338			REAR
339			Right FRONT
340			REAR
341		RT WALL Near Front after Sink	UPPER
342	✓		MIDDLE

# Radiological Survey Continuation Sheet

Page 14 of 33

Date 12/6/06

118E/E114

No.	Time	Locations	See attached LSC printout for Total Activity (cpm/100 cm <sup>2</sup> )
343			LOWER
344		FRONT Wall from RT Wall	UPPER
345			MIDDLE
346			LOWER
347			UPPER
348			MIDDLE
349			LOWER
350			UPPER
351			MIDDLE
352			LOWER
353			Phone Receiver
354			BUTTONS
355		Left Center Island LEFT Side from Reat Above Bench Shelves <sup>Top Left</sup>	
356			TOP MIDDLE
357			TOP RIGHT
358			2ND LEFT
359			Middle
360			Right
361			LOWER LEFT
362			Middle
363			Right
364		Bench Top from Reat	FRONT
365			REAR
366			2ND FRONT
367			REAR
368			3RD FRONT
369			REAR

# Radiological Survey Continuation Sheet

Page 15 of 33

Date 12/6/06

118/114

No.	Time	Locations	See attached LSC printout for Total Activity (cpm/100 cm <sup>2</sup> )	
370		Bench Top	4TH	FRONT
371				REAR
372			5TH	FRONT
373				REAR
374			6TH	FRONT
375				REAR
376		DRAWERS below Bench Top 1ST ROW	Top	OUTER
377			INSIDE	FRONT
378				REAR
379			2ND	OUTER
380			INSIDE	FRONT
381				REAR
382			3RD	OUTER
383			INSIDE	FRONT
384				REAR
385			4TH	OUTER
386			INSIDE	FRONT
387				REAR
388			2ND ROW TOP DRAWER	OUTER
389			INSIDE	FRONT
390				REAR
391			2ND	OUTER
392			INSIDE	FRONT
393				REAR
394			3RD	OUTER <sup>UPPER</sup>
395				LOWER
396			INSIDE	FRONT

# Radiological Survey Continuation Sheet

Page 16 of 33

Date 12/6/06

118/114

No.	Time	Locations	See attached LSC printout for Total Activity (cpm/100 cm <sup>2</sup> )
397			INSIDE REAR
398			3RD Row Top DRAWER OUTSIDE
399			INSIDE FRONT
400			REAR
401			2ND OUTSIDE
402			INSIDE FRONT
403			REAR
404			3RD OUTSIDE
405			INSIDE FRONT
406			REAR
407			4TH OUTSIDE
408			INSIDE FRONT
409			REAR
410			4TH Row Top Drawer OUTSIDE
411			INSIDE FRONT
412			REAR
413			2ND DRAWER OUTSIDE
414			INSIDE FRONT
415			REAR
416			3RD DRAWER OUT <sup>UPPER</sup>
417			LOWER
418			INSIDE FRONT
419			REAR
420			LEFT CENTER ISLAND, RT SIDE FROM FRONT Bench Top FRONT
421			REAR
422			2ND FRONT
423			REAR



# Radiological Survey Continuation Sheet

Page 17 of 33

Date 12/6/06

118/114

No.	Time	Locations	See attached LSC printout for Total Activity (cpm/100 cm <sup>2</sup> )
424		Left Center Island, RT Side Bench Top	3RD FRONT
425			REAR
426			4TH FRONT
427			REAR
428			5TH FRONT
429			REAR
430			6TH FRONT
431			REAR
432		1ST ROW Top Drawer	Outer
433			Inside FRONT
434			REAR
435		Cabinet	Outer Door UPPER
436			LOWER
437			INSIDE FRONT
438			REAR
439		2ND ROW Top Drawer	Outer Door UPPER
440			LOWER
441			INSIDE FRONT
442			REAR
443		3RD ROW TOP DRAWER	Outer Door UPPER
444			LOWER
445			INSIDE FRONT
446			REAR
447		Cabinet	Outer Door UPPER
448			LOWER
449			INSIDE FRONT
450			REAR

# Radiological Survey Continuation Sheet

Page 18 of 33

Date 12/6/06

118/114

No.	Time	Locations	See attached LSC printout for Total Activity (cpm/100 cm <sup>2</sup> )
451		4TH Row	TOP DRAWER OUTER
452			INSIDE FRONT
453			REAR
454		Cabinet DOOR	UPPER
455			LOWER
456			INSIDE FRONT
457			REAR
458		RT Center Island, LT Side, from Rear Top Shelf above Bench TOP Left	
459			MIDDLE
460			RIGHT
461			2ND Shelf LEFT
462			MIDDLE
463			RIGHT
464			3RD Shelf LEFT
465			MIDDLE
466			RIGHT
467		Bench <sup>top</sup> Top from Rear	FRONT
468			REAR
469			2ND FRONT
470			REAR
471			3RD FRONT
472			REAR
473			4TH FRONT
474			REAR
475			5TH FRONT
476			REAR
477			6TH FRONT

# Radiological Survey Continuation Sheet

Page 19 of 33

Date 12/6/06

118114

No.	Time	Locations	See attached LSC printout for Total Activity (cpm/100 cm <sup>2</sup> )
478			REAR
479		1ST Row TOP DRAWER	OUTER
480			INSIDE FRONT
481			REAR
482		2ND DRAWER	OUTER
483			INSIDE FRONT
484			REAR
485		3RD DRAWER	OUTER
486			INSIDE FRONT
487			REAR
488		4TH DRAWER	OUTER
489			INSIDE FRONT
490			REAR
491		Center Drawer	OUTER
492			INSIDE Left
493			Right
494		Knee Hole	Left Wall
495			Rear Wall
496			Right Wall
497		2ND Row TOP DRAWER	OUTER
498			Inside FRONT
499			REAR
500		2ND DRAWER	OUTER
501			Inside FRONT
502			REAR
503		3rd DRAWER	OUTER
504			FRONT

# Radiological Survey Continuation Sheet

Page 20 of 33

Date 12/6/06

118114

No.	Time	Locations	See attached LSC printout for Total Activity (cpm/100 cm <sup>2</sup> )
505			REAR
506		4TH DRAWER	OUTER
507		INSIDE	FRONT
508			REAR
509		3RD ROW TOP DRAWER	OUTER
510		INSIDE	FRONT
511			REAR
512		2ND DRAWER	OUTER
513		INSIDE	FRONT
514			REAR
515		Cabinet Outer Door	UPPER
516			LOWER
517		INSIDE	FRONT
518			REAR
519		RT Center Island, RT Side from FRONT Bench Top	FRONT
520			REAR
521		2ND	FRONT
522			REAR
523		3RD	FRONT
524			REAR
525		4TH	FRONT
526			REAR
527		5TH	FRONT
528			REAR
529		6TH	FRONT
530			REAR
531		1ST ROW TOP DRAWER	Outer

# Radiological Survey Continuation Sheet

Page 21 of 33

Date 12/6/06  
118 / 114

No.	Time	Locations	See attached LSC printout for Total Activity (cpm/100 cm <sup>2</sup> )
532		1ST ROW Top Drawer	INSIDE FRONT
533			REAR
534		Cabinet Door	OUTER UPPER
535			LOWER
536		INSIDE	FRONT
537			REAR
538		2ND ROW CABINET DOOR	OUTER UPPER
539			LOWER
540		INSIDE	FRONT
541			REAR
542		Center Drawer	OUTER
543		INSIDE	Left
544			Right
545		Kneehole	Left Wall
546			Rear Wall
547			Right Wall
548		3RD ROW TOP DRAWER	OUTER
549			INSIDE FRONT
550			REAR
551		2ND DRAWER	OUTER
552			INSIDE FRONT
553			REAR
554		3RD DRAWER	OUTER
555			INSIDE FRONT
556			REAR
557		4TH DRAWER	OUTER
558			INSIDE FRONT

## Radiological Survey Continuation Sheet

Page 22 of 33

Date 12/6/06

118/114

No.	Time	Locations	See attached LSC printout for Total Activity (cpm/100 cm <sup>2</sup> )
559		HTH DRAWER	INSIDE REAR
560		FLOOR	in front of Main Door 1
561			2
562		In front of Hood	1
563			2
564			3
565			4
566		In front of door TO 112	
567		In front of Sink	1
568			2
569			3
570		In front of phone	
571		Lead Pig 1	OUTER
572			INNER
573		2	OUTER
574			INNER
575		3	OUTER
576			INNER
577		4	OUTER
578			INNER
579		5	OUTER
580			INNER
581		6	OUTER
582			INNER
583		Small/Nalgene Dish	OUTER
584			INNER

Assay Definition-

Assay Description:  
swipe survey

Assay Type: CPM  
Report Name: Report1  
Output Data Path: C:\Packard\Tricarb\Results\bill\bills swipes  
Raw Results Path: C:\Packard\Tricarb\Results\bill\bills swipes\20061206\_1052\20061206\_1052.results  
RTF File Name: C:\Packard\Tricarb\Results\bill\bills swipes\Report1.rtf  
Assay File Name: C:\Packard\TriCarb\Assays\bills swipes.lsa

Count Conditions-

Nuclide: TRIPLE  
Quench Indicator: tSIE/AEC  
External Std Terminator (sec): 0.5 2s%  
Pre-Count Delay (min): 0.00  
Quench Set: n/a  
Count Time (min): 1.00  
Count Mode: Normal  
Assay Count Cycles: 1 Repeat Sample Count: 1  
#Vials/Sample: 1 Calculate % Reference: Off

Background Subtract: Off  
Low CPM Threshold: Off  
2 Sigma % Terminator: Off

Regions	LL	UL
A	0.0	18.6
B	18.6	156.0
C	0.0	2000.0

Count Corrections-

Static Controller: On Luminescence Correction: On  
Colored Samples: n/a Heterogeneity Monitor: n/a  
Coincidence Time (nsec): 18 Delay Before Burst (nsec): 75

Half Life-

Half Life Correction: Off

Regions	Half Life	Units	Reference Date	Reference Time
A				
B				
C				

Cycle 1 Results

S#	CPMA	CPMB	CPMC	MESSAGES
1	17	3	24	
2	13	8	24	
3	12	6	25	
4	15	4	24	
5	16	8	30	
6	9	5	21	
7	12	6	27	
8	6	7	19	
9	12	10	23	
10	15	5	31	
11	11	5	22	

12	11	2	21
13	6	8	18
14	8	4	18
15	17	7	29
16	11	5	22
17	8	8	19
18	9	6	28
19	15	6	29
20	14	15	34
21	9	5	19
22	6	4	18
23	14	9	35
24	9	4	18
25	12	11	31
26	21	8	34
27	7	6	21
28	9	6	17
29	12	8	26
30	7	8	22
31	18	7	27
32	18	7	30
33	16	4	27
34	14	4	23
35	10	3	14
36	15	11	33
37	15	4	23
38	14	7	23
39	10	4	19
40	17	4	23
41	6	5	18
42	15	5	27
43	12	2	19
44	19	9	31
45	10	2	14
46	6	5	18
47	12	6	21
48	17	5	28
49	11	7	20
50	7	8	19
51	13	7	25
52	13	9	27
53	5	6	18
54	13	7	25
55	15	5	27
56	9	5	21
57	14	4	26
58	6	7	16
59	8	5	15
60	15	10	31
61	4	6	19
62	13	4	25
63	0	4	9
64	13	9	31
65	17	4	27
66	13	8	27
67	22	7	38
68	13	5	24
69	4	6	22
70	7	7	18
71	6	9	18
72	10	11	28
73	21	10	34
74	5	6	13



Protocol# 1 - bills swipes.lsa

75	12	2	21
76	7	7	14
77	17	3	22
78	6	3	16
79	11	5	19
80	7	8	20
81	9	4	17
82	14	5	21
83	12	8	25
84	11	13	27
85	16	6	26
86	6	6	14
87	8	5	22
88	13	14	30
89	1	3	11
90	19	7	32
91	18	7	32
92	14	3	20
93	7	4	14
94	11	11	31
95	9	7	20
96	17	5	29
97	13	11	27
98	16	7	31
99	13	7	25
100	6	6	20
101	17	6	27
102	12	4	27
103	25	5	32
104	13	8	29
105	16	6	29
106	4	4	12
107	15	9	31
108	9	2	19
109	18	3	33
110	7	10	22
111	9	9	22
112	12	3	21
113	16	8	34
114	23	6	35
115	7	1	9
116	1	4	12
117	6	2	11
118	6	5	17
119	9	5	21
120	13	5	24
121	8	5	19
122	19	7	28
123	19	3	29
124	16	8	31
125	11	4	22
126	3	7	13
127	12	8	27
128	15	9	33
129	8	4	15
130	8	6	20
131	5	4	11
132	9	4	20
133	0	5	4
134	5	5	15
135	11	5	21
136	14	5	25
137	11	11	29

138	25	5	33
139	6	4	13
140	11	3	21
141	12	5	19
142	11	3	20
143	1	6	13
144	11	3	20
145	7	5	14
146	12	6	21
147	11	3	22
148	15	6	24
149	11	9	29
150	18	5	29
151	6	10	22
152	12	6	24
153	10	5	23
154	15	8	35
155	14	3	26
156	23	8	38
157	15	5	30
158	8	7	23
159	18	4	27
160	18	6	26
161	10	5	20
162	3	5	16
163	15	7	32
164	21	4	28
165	12	11	31
166	10	4	18
167	7	6	19
168	13	7	23
169	9	5	18
170	7	5	19
171	17	6	29
172	14	4	27
173	3	8	16
174	16	7	27
175	3	6	11
176	9	6	20
177	20	6	30
178	2	7	18
179	15	3	24
180	13	15	31
181	14	4	22
182	14	5	25
183	10	10	28
184	20	8	36
185	5	10	20
186	15	4	23
187	9	5	20
188	15	6	26
189	24	4	31
190	12	7	24
191	8	5	17
192	14	5	24
193	13	5	24
194	8	6	17
195	17	1	23
196	7	3	13
197	16	1	18
198	10	6	20
199	10	5	20
200	21	5	33

201	18	4	28
202	7	8	18
203	12	9	27
204	15	10	28
205	8	8	24
206	6	12	24
207	19	2	24
208	15	11	32
209	7	5	17
210	11	6	21
211	12	9	28
212	11	3	18
213	8	4	21
214	10	3	19
215	13	5	23
216	4	7	14
217	6	6	16
218	7	7	19
219	17	2	27
220	18	4	24
221	15	10	28
222	9	6	18
223	14	6	27
224	5	16	28
225	11	12	27
226	11	6	23
227	9	10	23
228	13	3	19
229	12	4	22
230	3	2	11
231	8	4	15
232	21	4	30
233	19	5	27
234	11	3	16
235	5	6	15
236	16	2	26
237	5	7	19
238	15	7	29
239	9	7	23
240	15	6	27
241	15	6	34
242	17	10	33
243	12	5	21
244	6	7	16
245	11	6	20
246	9	0	16
247	14	6	23
248	15	1	21
249	6	9	24
250	16	7	30
251	6	7	25
252	10	6	19
253	10	5	19
254	17	6	29
255	14	5	25
256	20	7	31
257	10	7	21
258	9	8	26
259	7	3	16
260	14	8	27
261	9	8	27
262	15	9	29
263	9	10	22

264	11	6	23
265	16	1	21
266	7	6	19
267	10	11	27
268	10	2	15
269	8	6	18
270	11	1	17
271	7	3	14
272	12	4	26
273	15	4	26
274	9	3	15
275	10	8	21
276	14	5	26
277	10	4	20
278	3	10	20
279	25	6	36
280	20	6	31
281	14	9	28
282	9	8	22
283	3	4	9
284	10	6	21
285	11	3	20
286	9	8	18
287	23	5	31
288	8	4	16
289	13	7	28
290	10	6	22
291	5	10	21
292	8	7	23
293	8	5	17
294	6	3	12
295	8	2	21
296	7	11	26
297	10	4	22
298	5	2	14
299	6	9	21
300	13	3	20
301	8	7	26
302	17	5	27
303	7	6	21
304	6	4	14
305	10	3	17
306	3	5	14
307	4	4	13
308	8	7	17
309	10	7	23
310	12	7	25
311	7	4	16
312	5	3	11
313	17	9	30
314	4	4	13
315	10	5	22
316	13	8	25
317	15	7	28
318	20	6	29
319	18	6	27
320	15	4	28
321	16	11	33
322	9	10	27
323	10	5	19
324	17	6	25
325	8	7	19
326	14	7	26

327	9	8	21
328	7	5	15
329	4	5	13
330	12	9	25
331	8	8	23
332	0	6	11
333	21	11	37
334	3	9	19
335	22	8	37
336	15	8	30
337	17	5	26
338	14	4	20
339	18	5	28
340	17	8	29
341	14	8	24
342	13	7	23
343	12	4	22
344	20	10	35
345	19	10	33
346	11	4	21
347	14	7	26
348	17	3	23
349	5	4	16
350	14	8	28
351	13	11	29
352	17	2	25
353	12	3	20
354	7	4	21
355	11	2	22
356	14	6	25
357	7	6	18
358	16	4	21
359	10	5	16
360	9	5	20
361	9	7	20
362	6	8	22
363	7	11	20
364	5	2	11
365	1	7	14
366	10	4	20
367	8	7	21
368	15	8	28
369	8	8	21
370	12	7	23
371	12	8	28
372	19	6	33
373	16	8	27
374	11	0	17
375	9	10	22
376	11	7	24
377	13	7	24
378	16	7	28
379	11	7	22
380	9	4	19
381	12	7	29
382	6	8	22
383	13	12	31
384	5	5	17
385	15	5	25
386	14	13	30
387	8	3	17
388	19	6	32
389	16	6	28

390	9	5	19
391	12	7	30
392	15	9	27
393	8	6	21
394	4	7	14
395	11	5	19
396	12	6	24
397	12	8	22
398	22	8	43
399	14	7	25
400	6	6	15
401	16	6	31
402	11	3	18
403	12	3	19
404	9	11	24
405	13	8	25
406	9	4	20
407	17	7	32
408	19	10	33
409	11	7	24
410	7	9	23
411	11	4	26
412	12	10	28
413	12	4	21
414	12	10	28
415	5	4	14
416	14	4	25
417	11	2	19
418	14	3	21
419	11	7	19
420	17	4	26
421	9	6	19
422	21	2	29
423	15	10	32
424	16	8	30
425	10	3	20
426	11	11	27
427	16	11	35
428	10	9	25
429	15	11	35
430	14	2	23
431	17	4	24
432	15	5	22
433	18	8	34
434	4	10	26
435	10	9	21
436	9	5	21
437	8	1	12
438	6	6	18
439	11	11	29
440	5	7	22
441	8	6	18
442	14	6	25
443	10	4	15
444	5	6	15
445	6	9	26
446	6	11	21
447	12	2	21
448	11	6	22
449	11	8	23
450	12	6	25
451	19	1	27
452	12	7	25

Protocol# 1 - bills swipes.lsa

453	11	8	27
454	9	5	16
455	8	4	16
456	11	8	28
457	17	4	29
458	7	8	20
459	10	4	24
460	10	10	28
461	17	5	31
462	4	5	17
463	8	1	12
464	8	8	23
465	14	6	23
466	17	4	26
467	8	3	19
468	13	10	27
469	0	6	11
470	4	10	16
471	14	11	29
472	15	8	31
473	11	10	23
474	21	5	36
475	13	6	24
476	11	4	22
477	19	7	31
478	12	8	28
479	17	9	30
480	11	5	21
481	7	6	16
482	9	9	23
483	15	6	22
484	6	8	17
485	13	7	24
486	17	10	29
487	19	4	28
488	12	8	24
489	13	10	27
490	13	3	26
491	10	11	32
492	16	6	27
493	16	11	32
494	4	5	14
495	22	4	32
496	5	10	20
497	16	3	20
498	10	2	16
499	5	6	16
500	10	8	23
501	11	4	22
502	2	6	12
503	16	12	32
504	9	3	20
505	14	6	25
506	15	5	24
507	18	10	34
508	12	7	27
509	8	6	21
510	6	3	14
511	11	5	22
512	18	6	28
513	7	6	20
514	18	6	27
515	20	6	34

516	13	10	29
517	11	8	21
518	6	6	15
519	9	18	32
520	11	6	26
521	7	7	19
522	3	10	15
523	13	6	23
524	4	10	20
525	12	5	22
526	6	9	21
527	15	10	31
528	24	4	34
529	10	8	23
530	10	4	18
531	16	3	28
532	20	6	34
533	9	6	23
534	3	7	16
535	14	5	25
536	12	7	26
537	13	5	23
538	0	8	13
539	7	5	16
540	16	7	29
541	11	8	23
542	11	5	18
543	20	12	38
544	6	9	19
545	15	4	22
546	8	6	22
547	16	7	26
548	16	10	29
549	12	6	21
550	16	5	27
551	11	6	19
552	3	6	14
553	12	9	24
554	2	5	14
555	5	8	16
556	17	6	32
557	8	14	27
558	15	7	27
559	3	7	15
560	14	5	24
561	14	6	28
562	14	7	30
563	13	8	26
564	11	7	26
565	20	6	30
566	3	9	17
567	12	8	27
568	11	2	16
569	5	8	15
570	17	6	32
571	13	7	21
572	22	8	41
573	21	9	34
574	22	9	37
575	15	6	26
576	16	7	28
577	18	5	30
578	2	4	11



Protocol# 1 - bills swipes.lsa

579	4	8	15
580	7	2	14
581	6	2	9
582	16	1	25
583	13	9	28
584	10	7	22

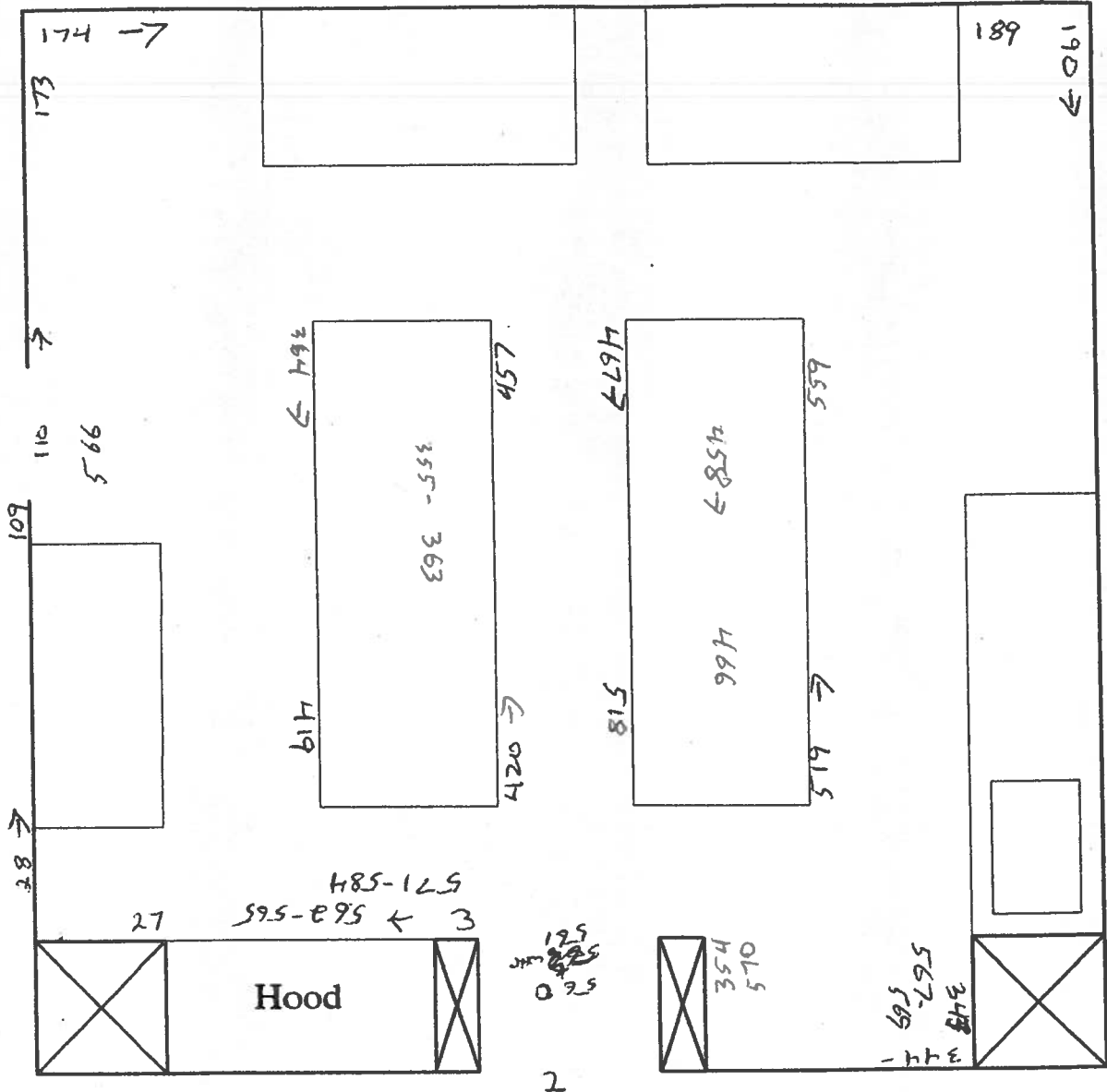

- Wipe Locations

- Surveyed 100% of lower surfaces only 42-68. NO READINGS IN EXCESS OF NORMAL BACKGROUND LEVELS NOTED.