

Radiological Survey Sheet

Job Location Pfizer Inc., Groton, CT, 06240 Page 1 of 25

Survey Purpose LAB USE/112 DECOMMISSIONING Date 3-23-10

Performed by E. GAILOR (Print) E. Gailor (Sign)

Instrument (Model/S/N)	Packard Tri-Carb S/N 431521	Packard Tri-Carb S/N 431520	Ludlum 2241-2 163603	Wallac Model 1409 S/N 4061042
Det. (Model/SN)	Internal	Internal	Ludlum 43-68 PR 149613	Internal
Type Rad.	β	β	β	β
Cal. Due:	04/03/2010	04/03/2010	04/07/2010 <i>21/09</i>	04/03/2010
Check Instruments Used	✓		✓	

No.	Time	Locations	See attached LSC printout for Total Activity (cpm/100 cm ²)
1.	1400	BACKGROUND	
2.		door	
3.		FLOOR	
4.		UPPER WALL	
5.		LOWER WALL	
6.		FLOOR	
7.		LOWER WALL	
8.		" "	
9.		FLOOR	
10.		UPPER WALL	
11.		LOWER "	
12.		FLOOR	
13.		PEG BOARD	
14.		SINK AREA	
15.		CAB. door	
16.		CAB. BOTTOM	
17.		CAB. door & HANDLE	
18.	✓	" TOP SHELF	

Radiological Survey Continuation Sheet

Page 2 of 25

Date 3-23-10

No.	Time	Locations	See attached LSC printout for Total Activity (cpm/100 cm ²)
19	1400	CAB. 2ND SHELF	
20		" 3RD "	
21		CAB door & HNDL	
22		" TOP SHELF	
23		" Bottom "	
24		" doors & HNDLS	
25		" TOP SHELF	
26		" 2ND "	
27		" 3RD "	
28		" doors & HNDLS	
29		" TOP SHELF	
30		" 2ND "	
31		" 3RD "	
32		CAB doors & HNDLS	
33		" TOP SHELF	
34		" 2ND "	
35		" 3RD "	
36		TOP DRAWER	
37		2ND "	
38		3RD "	
39		4TH "	
40		TOP "	
41		2ND "	
42		3RD "	
43		4TH "	
44		TOP "	
45	v	2ND "	

Radiological Survey Continuation Sheet

Page 3 of 25

Date 3.23.10

No.	Time	Locations	See attached LSC printout for Total Activity (cpm/100 cm ²)
46	1700	3RD DRAWER	
47		4TH "	
48		TOP "	
49		2ND "	
50		3RD "	
51		4TH "	
52		TOP "	
53		2ND "	
54		3RD "	
55		4TH "	
56		BENCH	
57		"	
58		"	
59		"	
60		"	
61		"	
62		"	
63		"	
64		CART TOP	
65		" "	
66		" "	
67		TOP DRAWER	
68		2ND "	
69		3RD "	
70		4TH "	
71		CAB. DOORS & HANDLS	
72	✓	" TOP SHELF	

Radiological Survey Continuation Sheet

Page 4 of 25

Date 3-23-10

No.	Time	Locations	See attached LSC printout for Total Activity (cpm/100 cm ²)
73	1400	CAB. BOTTOM SHELF	
74		FLOOR	
75		"	
76		"	
77		"	
78		TOP LEFT DRAWER	
79		" RIGHT "	
80		2ND	"
81		3RD	"
82		4TH	"
83		TOP LEFT	"
84		" RIGHT "	"
85		3RD	"
86		4TH	"
87		TOP	"
88		CAB door & HNDL	
89		" TOP SHELF	
90		" BOTTOM "	
91		TOP DRAWER	
92		2ND	"
93		3RD	"
94		4TH	"
95		TOP	"
96		2ND	"
97		3RD	"
98		4TH	"
99	✓	FLOOR	

Radiological Survey Continuation Sheet

Page 5 of 25

Date 3.23-10

No.	Time	Locations	See attached LSC printout for Total Activity (cpm/100 cm ²)
100	14:00	FLOOR	
101	✓	BENCH	
102		"	
103		"	
104		TOP DRAWER	
105		2ND "	
106		3RD "	
107		4TH "	
108		TOP "	
109		2ND "	
110		3RD "	
111		4TH "	
112		FLOOR	
113		BENCH	
114		DRAWER	
115		CAB DOOR HANDLE	
116		INSIDE CAB	
117		Hood LEFT SIDE	
118		" UPPER BACK LEFT	
119		" LOWER " LEFT	
120		" UPPER " RIGHT	
121		" LOWER " "	
122		" LEFT SIDE	
123		" " BOTTOM	
124		" MIDDLE "	
125		" RIGHT "	
126	✓	" " SIDE	

Radiological Survey Continuation Sheet

Page 6 of 25

Date 3-23-10

No.	Time	Locations	See attached LSC printout for Total Activity (cpm/100 cm ²)
127	1400	Hood SASH	LEFT SIDE
128		" "	RIGHT "
129		Hood LIP	LEFT "
130		" "	RIGHT SIDE
131		CAB door & HNDL	
132		" TOP SHELF	
133		" BOTTOM "	
134		" door & HNDL	
135		" TOP SHELF	
136		" BOTTOM "	
137		" door & HNDL	
138		" TOP SHELF	
139		" BOTTOM "	
140		" door & HNDL	
141		" TOP SHELF	
142		" BOTTOM "	
143		FLOOR	
144		"	
145		"	
146			
147		PEG BOARD	
148		SINK AREA	
149		BENCH	
150		FLOOR	
151		TOP SHELF	
152		BOTTOM "	
153	✓	TOP "	
		2ND "	

Radiological Survey Continuation Sheet

Page 7 of 25

Date 3-23-10

No.	Time	Locations	See attached LSC printout for Total Activity (cpm/100 cm ²)
154	1400	BOTTOM SHELF	
155		TOP //	
156		BOTTOM //	
157		BENCH //	
158		BENCH //	
159		//	
160		//	
161		TOP LEFT DRAWER	
162		" RIGHT //	
163		BOTTOM LEFT //	
164		" RIGHT //	
165		TOP BIG //	
166		BOTTOM " //	
167		TOP LEFT DRAWER	
168		TOP RIGHT //	
169		BOTTOM LEFT //	
170		" RIGHT //	
171		TOP BIG //	
172		BOTTOM " //	
173		TOP SHELF	
174		2ND //	
175		3RD //	
176		CART TOP	
177		TOP DRAWER	
178		2ND //	
179		3RD //	
180	✓	4TH //	

Radiological Survey Continuation Sheet

Page 8 of 25

Date 3.24.10

No.	Time	Locations	
			See attached LSC printout for Total Activity (cpm/100 cm ²)
181	0800	TOP SHELF	
182		BOTTOM "	
183		CART TOP	
184		CAB DOORS & HANDLS	
185		TOP SHELF	
186		BOTTOM "	
187		TOP "	
188		BOTTOM "	
189		CART TOP	
190		TOP DRAWER	
191		2ND "	
192		3RD "	
193		4TH "	
194		FLOOR	
195		"	
196		"	
197		"	
198		TOP DRAWER	
199		2ND "	
200		3RD "	
201		4TH "	
202		TOP "	
203		2ND "	
204		3RD "	
205		4TH "	
206		TOP LEFT DRAWER	
207	✓	" RIGHT "	

Radiological Survey Continuation Sheet

Page 9 of 25

Date 2-24-10

No.	Time	Locations	See attached LSC printout for Total Activity (cpm/100 cm ²)
208	5800	2ND DRAWER	
209		3RD "	
210		4TH "	
211		TOP SHELF	
212		2ND "	
213		CART TOP	
214		TOP DRAWER	
215		2ND "	
216		3RD "	
217		4TH "	
218		TOP SHELF	
219		2ND "	
220		CART TOP	
221		CARD DOORS & HANDLS	
222		" TOP SHELF	
223		" BOTTOM "	
224		CART TOP	
225		FLOOR	
226		"	
227		"	
228		"	
229		TOP RIGHT DRAWER	
230		" LEFT "	
231		2ND "	
232		3RD "	
233		TOP "	
234	✓	2ND "	

Radiological Survey Continuation Sheet

Page 10 of 25

Date 3-24-10

No.	Time	Locations	See attached LSC printout for Total Activity (cpm/100 cm ²)
235	0800	3RD DRAWER	
236		4TH "	
237		CAB TOP DRAWER	
238		CAB DOOR & HANDL	
239		" TOP SHELF	
240		" BOTTOM SHELF	
241		BENCH	
242		"	
243		"	
244		"	
245		TOP SHELF	
246		2ND "	
247		TOP "	
248		2ND "	
249		TOP "	
250		2ND "	
251		BENCH	
252		BENCH	
253		FLOOR	
254		"	
255		BENCH	
256		SINK AREA	
257		BENCH	
258		CAB DOORS & HANDLS	
259		" INSIDE	
260		" DOOR & HANDL	
261		" INSIDE	

Radiological Survey Continuation Sheet

Page 4 of 25

Date 3-24-10

No.	Time	Locations	See attached LSC printout for Total Activity (cpm/100 cm ²)
262	0800	FLOOR	
263		FLOOR	
264		TOP DRAWER	
265		CAB DOOR & HNDL	
266		" TOP SHELF	
267		" BOTTOM SHELF	
268		2ND DRAWER	
269		3RD "	
270		4TH "	
271		BENCH	
272		"	
273		"	
274		"	
275		TOP LEFT DRAWER	
276		" RIGHT "	
277		2ND "	
278		3RD "	
279		TOP LEFT "	
280		" RIGHT "	
281		2ND "	
282		3RD "	
283		BOTTOM "	
284		TOP LEFT "	
285		TOP RIGHT "	
286		2ND "	
287		3RD "	
288		TOP LEFT "	

Radiological Survey Continuation Sheet

Page 12 of 25

Date 3-24-10

No.	Time	Locations	See attached LSC printout for Total Activity (cpm/100 cm ²)
289	0800	TOP RIGHT DRAWER	
290		2ND "	"
291		3RD "	"
292		BOTTOM "	"
293		TOP "	"
294		2ND "	"
295		3RD "	"
296		4TH "	"
297		FLOOR	
298		"	
299		"	
300		"	
301		TOP SHELF	
302		2ND "	
303		CART TOP	
304		TOP SHELF	
305		2ND "	
306		CART TOP	
307		TOP DRAWER	
308		2ND "	
309		3RD "	
310		4TH "	
311		FLOOR	
312		"	
313		TOP SHELF	
314		CART TOP	
315	✓	TOP DRAWER	

Radiological Survey Continuation Sheet

Page 13 of 25

Date 3-24-10

No.	Time	Locations	See attached LSC printout for Total Activity (cpm/100 cm ²)
316	0800	2ND DRAWER	
317		3RD "	
318		4TH "	
319		TOP SHELF	
320		2ND "	
321		CART TOP	
322		TOP DRAWER	
323		2ND "	
324		3RD "	
325		4TH "	
326		FLOOR	
327		CAB DOORS & HANDLS	
328		" TOP SHELF	
329		" 2ND "	
330		" 3RD "	
331		" DOORS & HANDLS	
332		" TOP SHELF	
333		" 2ND "	
334		" 3RD "	
335		" DOORS & HANDLS	
336		" TOP SHELF	
337		" 2ND "	
338		" 3RD "	
339		" DOOR	
340		" TOP "	
341		" 2ND "	
342	✓	" 3RD "	

Radiological Survey Continuation Sheet

Page 14 of 25

Date 3-24-10

No.	Time	Locations	See attached LSC printout for Total Activity (cpm/100 cm ²)
343	0800	BENCH	
344		"	
345		"	
346		"	
347		"	
348		TOP DRAWER	
349		2ND "	
350		3RD "	
351		4TH "	
352		TOP "	
353		2ND "	
354		3RD "	
355		4TH "	
356		LEFT DRAWER	
357		" CAB DOOR	
358		LEFT TOP SHELF	
359		" BOTTOM "	
360		RIGHT DRAWER	
361		" CAB DOOR	
362		" TOP SHELF	
363		" BOTTOM SHELF	
364		FLOOR	
365		FLOOR	
366		FLOOR	
367		UPPER WALL	
368		LOWER "	
369	✓	DOOR	

Radiological Survey Continuation Sheet

Page 15 of 25

Date 2-24-10

No.	Time	Locations	See attached LSC printout for Total Activity (cpm/100 cm ²)
320	8800	FLOOR	
321		UPPER WALL	
322		LOWER "	
323		UPPER "	
324		LOWER "	
325		UPPER "	
326		LOWER "	
327		UPPER "	
328		LOWER "	
329		UPPER "	
380		LOWER "	
381		UPPER "	
382		LOWER "	
383		FLOOR	
384		FLOOR	
385		FLOOR	
386		FLOOR	
387		WALL	
388		"	
389		FLOOR	
390		FLOOR	
391		door	
392		FLOOR	
393		TOP SHELF	
394		2ND "	
395		3RD "	
396	V	BENCH	

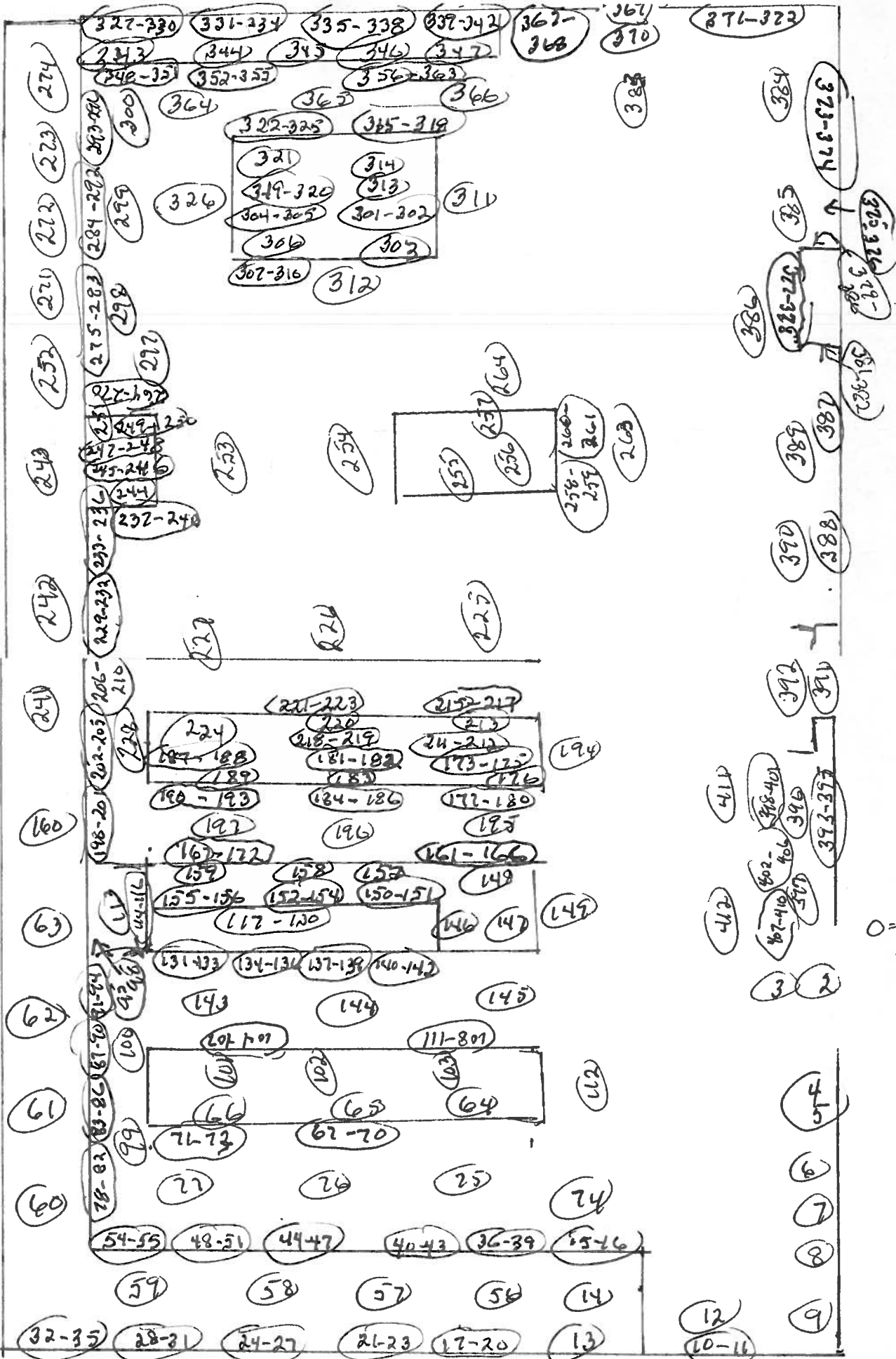

O = wipe LOCATION

Summed 100%
 OF LOWER SURFACES USING INSTRUMENT 43-68. NO
 READINGS IN EXCESS OF NORMAL BACKGROUND
 LEVELS NOTED.

Assay Definition-

Assay Description:
Equipment Swipes

Assay Type: CPM
Report Name: Report1
Output Data Path: C:\Packard\Tricarb\Results\Ed Gailor\Eds Monthly Swipes
Raw Results Path: C:\Packard\Tricarb\Results\Ed Gailor\Eds Monthly Swipes\20100324_0641
\20100324_0641.results
RTF File Name: C:\Packard\Tricarb\Results\Ed Gailor\Eds Monthly Swipes\Ed's Monthly
Swipes.rtf
Assay File Name: C:\Packard\TriCarb\Assays\Eds Monthly Swipes.lsa

Count Conditions-

Nuclide: Triple
Quench Indicator: tSIE/AEC
External Std Terminator (sec): 0.5 2s%
Pre-Count Delay (min): 0.00
Quench Set: n/a
Count Time (min): 1.00
Count Mode: Normal
Assay Count Cycles: 1 Repeat Sample Count: 1
#Vials/Sample: 1 Calculate % Reference: Off

Background Subtract: On - Manual
Low CPM Threshold: Off
2 Sigma % Terminator: Off

Regions	LL	UL	Bkg Subtract
A	0.0	18.6	0.00
B	18.6	156.0	0.00
C	0.0	2000.0	0.00

Count Corrections-

Static Controller: On Luminescence Correction: On
Colored Samples: n/a Heterogeneity Monitor: n/a
Coincidence Time (nsec): 18 Delay Before Burst (nsec): 75

Half Life-

Half Life Correction: Off

Regions	Half Life	Units	Reference Date	Reference Time
A				
B				
C				

Cycle 1 Results

S#	CPMA	CPMB	CPMC	MESSAGES
1	11	8	23	
2	26	13	48	
3	22	9	38	
4	13	8	28	
5	4	7	16	
6	1	8	17	
7	18	6	29	
8	9	7	23	
9	24	5	38	
10	16	6	29	

11	20	8	31
12	13	12	28
13	13	7	26
14	8	4	20
15	13	12	31
16	9	6	19
17	16	8	28
18	20	13	40
19	7	10	25
20	11	12	30
21	23	8	36
22	19	11	34
23	22	8	31
24	25	6	40
25	16	7	31
26	13	6	29
27	7	9	17
28	14	6	27
29	13	6	25
30	0	3	9
31	21	7	34
32	3	12	16
33	6	6	16
34	0	5	6
35	19	13	40
36	9	6	18
37	0	4	8
38	6	5	18
39	8	5	22
40	7	3	13
41	6	7	17
42	6	8	18
43	11	2	19
44	3	8	19
45	1	8	20
46	21	12	40
47	9	7	19
48	12	11	24
49	19	3	30
50	8	4	17
51	14	9	26
52	18	10	34
53	6	6	18
54	20	7	34
55	9	9	22
56	21	7	31
57	11	9	23
58	6	6	15
59	8	3	18
60	1	5	12
61	30	12	44
62	20	6	33
63	11	5	21
64	9	4	22
65	0	8	14
66	8	6	18
67	14	11	33
68	3	6	19
69	9	8	22
70	3	4	16
71	14	10	28
72	15	8	28

73	14	11	32
74	16	3	23
75	15	5	25
76	20	8	30
77	0	12	18
78	10	5	22
79	4	4	16
80	14	11	33
81	0	6	6
82	3	9	24
83	12	11	31
84	11	5	21
85	6	8	16
86	15	7	26
87	13	6	24
88	5	5	17
89	2	10	19
90	15	7	29
91	5	4	13
92	16	6	26
93	25	14	54
94	0	6	6
95	9	13	28
96	11	12	30
97	4	4	10
98	7	8	20
99	6	8	17
100	19	7	33
101	17	9	30
102	14	7	29
103	15	6	28
104	14	7	25
105	13	7	27
106	14	9	29
107	21	9	35
108	6	18	31
109	8	5	18
110	15	10	29
111	16	8	27
112	9	4	18
113	14	8	28
114	7	8	19
115	23	9	38
116	3	8	15
117	0	3	0
118	3	5	15
119	24	5	36
120	11	9	23
121	1	8	14
122	16	11	32
123	23	14	42
124	7	7	16
125	23	7	31
126	7	9	22
127	14	6	22
128	11	12	29
129	0	4	6
130	12	8	26
131	20	12	32
132	16	6	28
133	11	4	23
134	12	8	22
135	21	7	36

136	14	5	24
137	8	8	21
138	8	6	22
139	11	7	28
140	4	10	16
141	4	6	16
142	8	4	15
143	13	6	23
144	9	6	23
145	23	6	31
146	19	10	32
147	10	6	22
148	18	8	32
149	2	9	18
150	20	10	40
151	20	8	31
152	13	6	24
153	10	5	22
154	14	4	23
155	9	11	27
156	16	15	36
157	5	11	22
158	5	5	14
159	29	7	40
160	13	7	25
161	20	8	34
162	15	6	27
163	23	7	35
164	20	11	39
165	11	11	25
166	11	5	20
167	13	11	29
168	17	7	32
169	17	2	28
170	10	6	21
171	4	11	20
172	0	7	9
173	12	7	27
174	11	14	30
175	18	8	38
176	14	12	35
177	11	8	27
178	15	7	28
179	12	6	24
180	10	11	25
181	19	3	26
182	16	9	31
183	15	7	27
184	33	7	48
185	20	6	34
186	5	15	20
187	17	5	26
188	10	3	24
189	12	4	19
190	19	8	32
191	17	6	31
192	6	6	15
193	0	8	8
194	12	8	24
195	15	13	34
196	6	8	20
197	2	4	11
198	8	6	18

199	7	8	18
200	6	6	21
201	13	4	19
202	9	3	14
203	13	7	29
204	7	7	26
205	10	7	20
206	10	6	20
207	7	6	13
208	10	5	20
209	24	6	36
210	12	4	20
211	7	6	18
212	5	8	23
213	2	7	15
214	5	17	28
215	4	13	22
216	10	6	21
217	0	5	9
218	19	10	34
219	2	8	14
220	6	4	15
221	2	9	19
222	18	8	29
223	4	6	18
224	22	6	36
225	8	6	20
226	24	9	38
227	2	4	12
228	0	5	7
229	6	5	17
230	3	8	17
231	0	7	10
232	20	6	31
233	13	10	28
234	12	8	27
235	16	7	26
236	0	3	6
237	2	9	16
238	4	9	19
239	13	4	20
240	7	5	17
241	13	9	31
242	16	7	25
243	13	6	26
244	3	8	16
245	9	10	26
246	12	4	22
247	12	7	26
248	15	10	28
249	10	6	18
250	5	5	21
251	13	7	23
252	15	10	27
253	12	6	26
254	45	9	60
255	7	6	19
256	14	8	27
257	1	8	16
258	5	5	14
259	9	10	21
260	17	7	29
261	13	12	28

262	19	7	33
263	8	9	21
264	17	7	33
265	24	6	35
266	31	9	41
267	13	16	34
268	12	9	23
269	17	5	27
270	0	13	14
271	11	5	22
272	6	10	20
273	16	4	25
274	3	7	18
275	7	3	19
276	13	13	32
277	17	7	26
278	21	8	33
279	0	4	4
280	11	8	25
281	16	6	25
282	13	5	21
283	5	12	21
284	16	7	28
285	24	9	38
286	13	5	19
287	16	11	31
288	21	9	37
289	16	3	21
290	3	8	21
291	13	11	30
292	11	7	21
293	1	7	11
294	15	10	34
295	12	7	24
296	1	6	10
297	5	6	19
298	5	6	16
299	12	2	17
300	43	5	52
301	20	4	31
302	18	4	29
303	10	11	25
304	10	3	20
305	9	12	30
306	9	5	19
307	13	12	31
308	10	9	26
309	1	5	10
310	13	11	30
311	13	4	23
312	6	6	16
313	0	6	12
314	10	8	21
315	17	2	28
316	10	6	21
317	5	5	16
318	8	8	20
319	7	7	19
320	9	8	21
321	4	7	16
322	18	8	30
323	9	7	22
324	13	13	31

325	7	8	24
326	6	8	21
327	6	4	20
328	12	11	25
329	5	8	19
330	15	6	27
331	3	8	18
332	14	9	26
333	10	13	27
334	11	5	20
335	15	5	23
336	8	8	23
337	21	2	25
338	13	5	22
339	15	10	32
340	13	6	25
341	6	11	23
342	1	9	15
343	7	7	17
344	8	4	15
345	16	6	25
346	10	8	23
347	12	6	20
348	19	9	31
349	18	10	31
350	21	3	30
351	0	4	4
352	1	10	15
353	9	3	17
354	17	7	29
355	14	15	35
356	11	3	23
357	4	7	13
358	20	9	34
359	7	8	22
360	16	8	34
361	23	8	39
362	10	7	22
363	7	5	17
364	10	7	24
365	5	3	14
366	9	7	20
367	14	7	29
368	12	13	32
369	13	12	31
370	3	6	9
371	22	11	36
372	21	9	35
373	16	16	37
374	19	8	32
375	19	6	32
376	17	5	30
377	8	10	23
378	13	10	28
379	0	10	4
380	11	11	24
381	0	5	0
382	9	10	26
383	17	4	25
384	29	10	47
385	11	9	30
386	13	2	22
387	6	8	24

388	17	13	36
389	11	7	24
390	10	10	27
391	9	8	24
392	16	6	34
393	19	10	31
394	15	8	26
395	5	4	16
396	17	7	33
397	7	6	21
398	11	6	22
399	18	7	36
400	4	8	17
401	16	5	30
402	7	10	19
403	20	4	30
404	5	2	11
405	17	9	30
406	22	6	36
407	11	6	22
408	5	6	15
409	9	14	28
410	12	9	29
411	16	5	28
412	3	6	19

Note: All of the results are SATISFACTORY, including #s 2, 93, 184, 254, 300, & 384.

WH Calver
WH Calver