

Radiological Survey Sheet

Job Location Pfizer, Inc. Groton, Ct. 06340

PAGE 1 of 5

Survey Purpose DECOMMISSIONING D408 C

Date 3/25/13

Performed by DAVID OUKOS
(Print)

(Sign)

Instrument (Model/S/N)	Packard Tri-Carb S/N 431521	Packard Tri-Carb S/N 431520	Ludlum 2241-2 163603	
Det. (Model/SN)	Internal	Internal	Ludlum 43-68 PR 149613	
Type Rad.	β	β	β	
Cal. Due:	03/05/2013	03/05/2013	04/17/2013	
Check Instruments Used		✓	✓	

No.	Time	Locations	See attached LSC printout for Total Activity (cpm/100 cm ²)	
1.	1325	BACKGROUND		
2.	↓	WALL PANEL		
3.		WALL PANEL		
4.		WALL PANEL		
5.		WALL PANEL		
6.		WALL PANEL		
7.		CONTROL		
8.		CONTROL		
9.		CONTROL		
10.		FLOOR		
11.		FLOOR		
12.		FLOOR		
13.		FLOOR		
14.		FLOOR		
15.		FLOOR		
16.		FLOOR		
17.		FLOOR		
18.			LINE OF CURTAIN	

Radiological Survey Continuation Sheet

Page 2 of 3

Date 3/25/13

No.	Time	Locations	See attached LSC printout for Total Activity (cpm/100 cm ²)
19		UPPER WALL	
20		LOWER WALL	
21		UPPER WALL	
22		LOWER WALL	
23		UPPER WALL	
24		LOWER WALL	
25		UPPER WALL	
26		LOWER WALL	
27		UPPER WALL	
28		LOWER WALL	
29		UPPER WALL	
30		LOWER WALL	
31		UPPER WALL	
32		LOWER WALL	
33		UPPER WALL	
34		LOWER WALL	
35		FRONT OF DRAWER	
36		TOP DRAWER	
37		DRAWER	
38		DRAWER	
39		BOTTOM DRAWER	
40		CABBY	
41		FRONT OF CABINET	
42		DRAWER	
43	↓	INSIDE CABINET	
44	↓	COUNTER DRAWER	

1100 / D48C

Page 3 of 5
DATE: 3/25/13

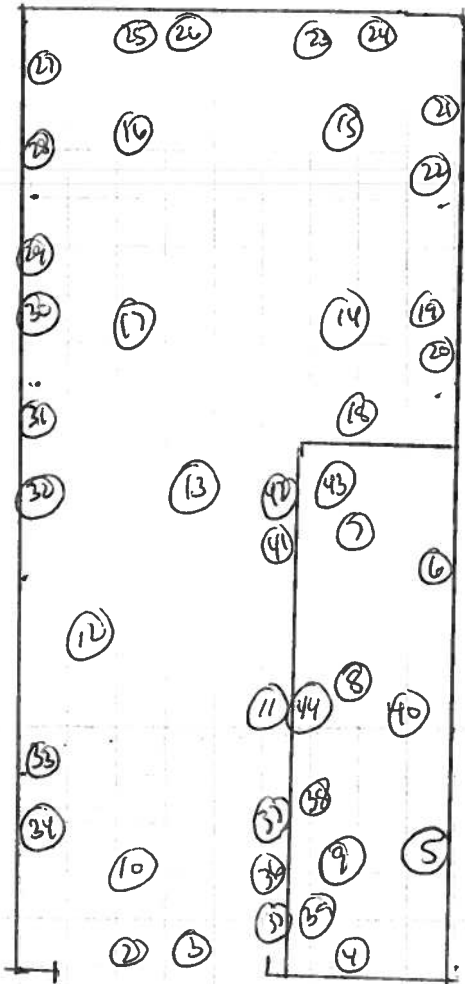

Surveyed 100% of lower surfaces using 43-US. No readings above normal background noise, with the exception of the floor. See page — 7 — on survey dated 11/5/12.

Assay Definition-

Assay Description:
Background check for PM Lab (Mikey)

Assay Type: CPM
Report Name: Report1
Output Data Path: C:\Packard\Tricarb\Results\bc\bills swipes
Raw Results Path: C:\Packard\Tricarb\Results\bc\bills swipes\20130325_1802\20130325_1802.results
RTF File Name: C:\Packard\Tricarb\Results\bc\bills swipes\Report1.rtf
Assay File Name: C:\Packard\TriCarb\Assays\bills swipes.lsa

Count Conditions-

Nuclide: TRIPLE
Quench Indicator: tSIE/AEC
External Std Terminator (sec): 0.5 2s%
Pre-Count Delay (min): 0.00
Quench Set: n/a
Count Time (min): 1.00
Count Mode: Normal
Assay Count Cycles: 1 Repeat Sample Count: 1
#Vials/Sample: 1 Calculate % Reference: Off

Background Subtract: Off
Low CPM Threshold: Off
2 Sigma % Terminator: Off

Regions	LL	UL
A	0.0	18.6
B	18.6	156.0
C	0.0	2000.0

Count Corrections-

Static Controller: On Luminescence Correction: On
Colored Samples: n/a Heterogeneity Monitor: n/a
Coincidence Time (nsec): 18 Delay Before Burst (nsec): 75

Half Life-

Half Life Correction: Off

Regions	Half Life	Units	Reference Date	Reference Time
A				
B				
C				

Cycle 1 Results

S#	CPMA	CPMB	CPMC	MESSAGES	PID	Custom1
1	14	6	25		23	
2	5	8	16		23	
3	3	7	13		23	
4	12	6	27		23	
5	15	10	26		23	
6	29	3	36		23	
7	21	8	33		23	
8	17	9	31		23	
9	10	2	16		23	
10	21	17	43		23	
11	26	16	46		23	

Protocol# 3 - bills swipes.lsa

12	12	11	28	23
13	10	13	28	23
14	14	13	33	23
15	17	5	25	23
16	2	11	19	23
17	16	7	28	23
18	11	7	20	23
19	14	10	32	8
20	12	12	27	8
21	14	5	25	8
22	38	4	45	8
23	18	10	32	8
24	26	2	33	8
25	11	8	24	8
26	27	26	56	8
27	0	3	2	8
28	4	11	17	8
29	14	7	24	8
30	10	13	27	8
31	7	7	16	8
32	23	13	37	8
33	9	2	15	8
34	46	40	89	8
35	10	6	20	8
36	22	4	31	8
37	13	6	24	8
38	5	14	25	8
39	9	11	21	8
40	9	7	22	8
41	12	8	26	8
42	8	4	18	8
43	26	6	36	8
44	21	8	32	8