

## Radiological Survey Sheet

Job Location Pfizer, Inc. Groton, Ct. 06340

PAGE 1 of 9

Survey Purpose Decommissioning D408

Date 3/25/13

Performed by DARD DURKSE  
(Print)

  
(Sign)

<b>Instrument (Model/S/N)</b>	Packard Tri-Carb S/N 431521	Packard Tri-Carb S/N 431520	Ludlum 2241-2 163603	
<b>Det. (Model/SN)</b>	Internal	Internal	Ludlum 43-68 PR 149613	
<b>Type Rad.</b>	β	β	β	
<b>Cal. Due:</b>	03/05/2013	03/05/2013	04/17/2013	
<b>Check Instruments Used</b>		✓	✓	

No.	Time	Locations	See attached LSC printout for Total Activity (cpm/100 cm <sup>2</sup> )
1.	1235	BACKGROUND	
2.	↓	Floor	
3.		Floor	
4.		Floor	
5.		Floor	
6.		Floor	
7.		Floor	
8.		Floor	
9.		Floor	
10.		Floor	
11.		Floor	
12.		Floor	
13.		Floor	
14.		Floor	
15.		Floor	
16.		Floor	
17.		Floor	✓ (500 # 85)
18.		Floor	

# Radiological Survey Continuation Sheet

Page 2 of 9

Date 3/25/13

No.	Time	Locations	See attached LSC printout for Total Activity (cpm/100 cm <sup>2</sup> )
19		Floor	
20		Floor	
21		Counter	
22		Sink	
23		Sink DRAIN LINE	
24		FRONT OF CABINET	
25		INSIDE CABINET	
26		UPPER DOOR	
27		LOWER DOOR	
28		UPPER WALL	
29		LOWER WALL	
30		UPPER WALL	
31		UPPER WALL	
32		TOP/SIDE CABINET	
33		SIDE OF CABINET	
34		INSIDE CABINET	✓ (See # 86)
35		UPPER WALL	
36		LOWER WALL	
37		UPPER WALL	
38		LOWER WALL	
39		UPPER WALL	
40		LOWER WALL	
41		UPPER WALL	
42		LOWER WALL	
43		SIDE OF CABINET	
44		UPPER CABINET	
45		LOWER CABINET	

# Radiological Survey Continuation Sheet

Page 3 of 9

Date 3/25/13

No.	Time	Locations	See attached LSC printout for Total Activity (cpm/100 cm <sup>2</sup> )
46		BASE CABINET	
47		UPPER CABINET	
48		LOWER CABINET	
49		BASE CABINET	
50		UPPER CABINET	
51		LOWER CABINET	
52		BASE CABINET	
53		SIDE OF CABINET	
54		UPPER WALL	
55		LOWER WALL	
56		WALL	
57		UPPER DOOR	✓ (See #57)
58		LOWER DOOR	
59		UPPER WALL	
60		LOWER WALL	
61		WALL	✓ (See #58)
62		UPPER DOOR	
63		LOWER DOOR	✓ (See #59)
64		UPPER WALL	
65		LOWER WALL	
66		UPPER WALL	
67		LOWER WALL	
68		UPPER DOOR	
69		LOWER DOOR	
70		UPPER WALL	
71		LOWER WALL	✓ (See #90)
72	✓	UPPER WALL	

# Radiological Survey Continuation Sheet

Page 4 of 9

Date 3/25/13

No.	Time	Locations	See attached LSC printout for Total Activity (cpm/100 cm <sup>2</sup> )
73	↓	Lower wall	
74		Upper Door	
75		Lower Door	
76		Upper wall	
77		Lower wall	
78		Upper wall	
79		Lower wall	
80		Upper wall	
81		Lower wall	
82		Stool 1	
83		Stool 2	
84		Stool 3	
85	1410	Post Deco # 17	
86	↓	Post Deco # 34	
87		Post Deco # 57	
88		Post Deco # 61	
89		Post Deco # 63	
90		Post Deco # 71	
91		Floor	
92		Floor	

12/13

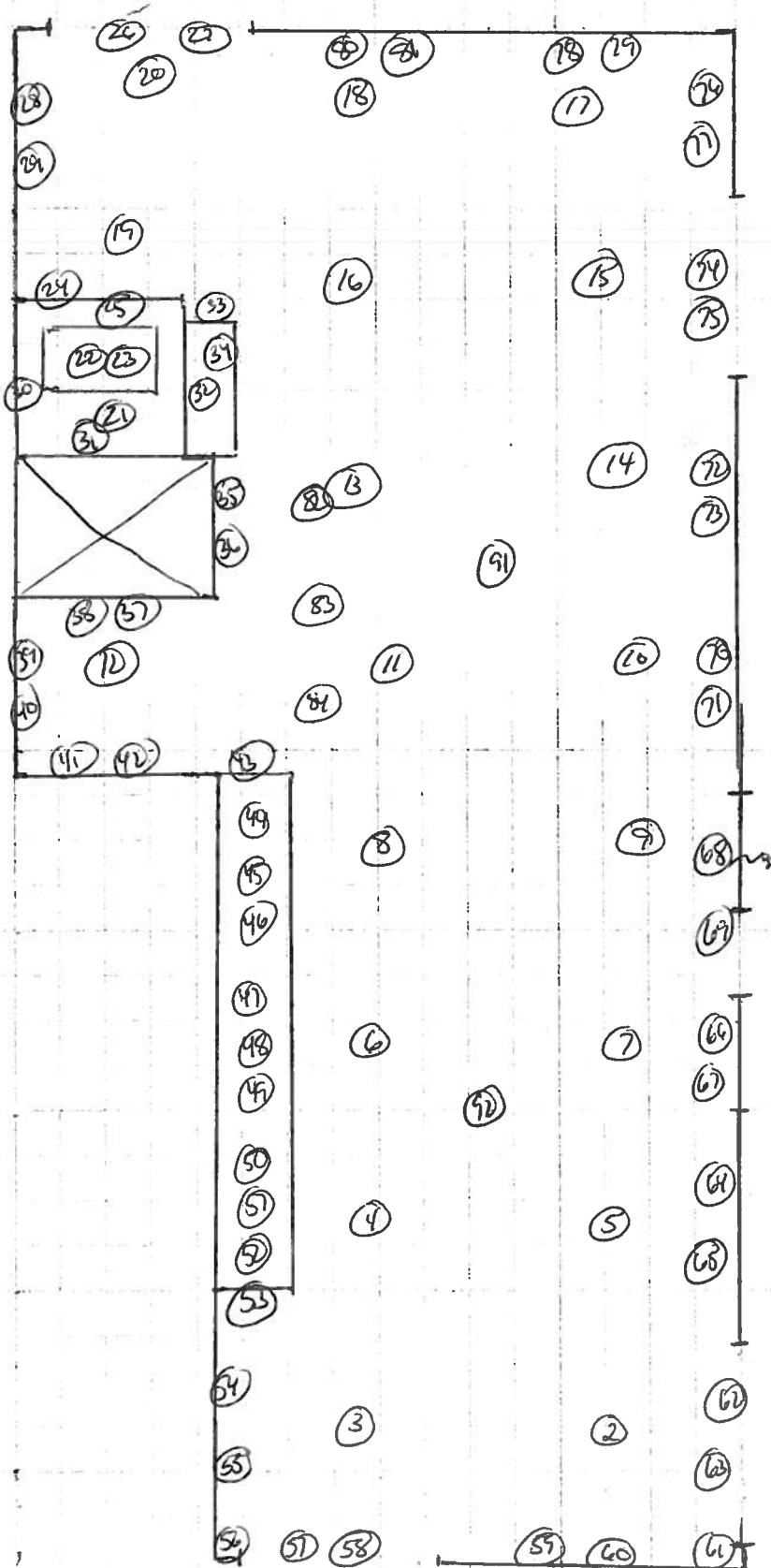

Surveyed 100% of Level Surfaces using 43-68. All surfaces were found to be at normal background levels with the exception of the floor which was found to be contaminated to a maximum level of 4090 dpm/100cm<sup>2</sup>.

Assay Definition-

Assay Description:  
Background check for PM Lab (Mikey)

Assay Type: CPM  
Report Name: Report1  
Output Data Path: C:\Packard\Tricarb\Results\bc\bills swipes  
Raw Results Path: C:\Packard\Tricarb\Results\bc\bills swipes\20130325\_1535\20130325\_1535.results  
RTF File Name: C:\Packard\Tricarb\Results\bc\bills swipes\Report1.rtf  
Assay File Name: C:\Packard\TriCarb\Assays\bills swipes.lsa

Count Conditions-

Nuclide: TRIPLE  
Quench Indicator: tSIE/AEC  
External Std Terminator (sec): 0.5 2s%  
Pre-Count Delay (min): 0.00  
Quench Set: n/a  
Count Time (min): 1.00  
Count Mode: Normal  
Assay Count Cycles: 1 Repeat Sample Count: 1  
#Vials/Sample: 1 Calculate % Reference: Off

Background Subtract: Off  
Low CPM Threshold: Off  
2 Sigma % Terminator: Off

Regions	LL	UL
A	0.0	18.6
B	18.6	156.0
C	0.0	2000.0

Count Corrections-

Static Controller: On Luminescence Correction: On  
Colored Samples: n/a Heterogeneity Monitor: n/a  
Coincidence Time (nsec): 18 Delay Before Burst (nsec): 75

Half Life-

Half Life Correction: Off

Regions	Half Life	Units	Reference Date	Reference Time
A				
B				
C				

Cycle 1 Results

S#	CPMA	CPMB	CPMC	MESSAGES	PID	Custom1
1	14	5	20		12	
2	25	13	41		12	
3	44	15	60		12	
4	20	5	29		12	
5	30	11	46		12	
6	20	16	37		12	
7	36	22	64		12	
8	13	19	37		12	
9	41	37	81		12	
10	20	14	39		12	
11	22	20	48		12	

12	23	11	39	12
13	27	20	50	12
14	26	15	45	12
15	20	16	40	12
16	37	22	60	12
17	48	58	108	12
18	29	15	48	12
19	30	19	54	1
20	28	11	44	1
21	14	12	32	1
22	22	5	30	1
23	8	8	22	1
24	10	13	29	1
25	14	7	26	1
26	12	3	17	1
27	8	9	20	1
28	12	10	27	1
29	19	11	33	1
30	12	3	17	1
31	12	10	24	1
32	38	45	89	1
33	15	10	26	1
34	69	73	144	1
35	18	8	31	1
36	13	11	29	1
37	13	4	19	14
38	19	9	35	14
39	7	7	18	14
40	24	12	37	14
41	7	6	17	14
42	24	10	39	14
43	19	9	37	14
44	16	12	28	14
45	8	9	22	14
46	22	16	43	14
47	12	8	24	14
48	32	11	45	14
49	17	18	42	14
50	18	17	41	14
51	20	16	41	14
52	32	8	44	14
53	20	11	38	14
54	31	32	69	14
55	42	36	81	2
56	40	38	85	2
57	52	58	115	2
58	26	21	51	2
59	16	16	33	2
60	19	14	39	2
61	44	53	100	2
62	16	8	28	2
63	61	43	106	2
64	40	30	76	2
65	33	25	64	2
66	24	23	50	2
67	18	12	34	2
68	17	12	34	2
69	54	18	79	2
70	51	15	67	2
71	62	57	123	2
72	31	16	48	2
73	23	20	46	4
74	24	3	29	4

75	21	19	46	4
76	17	8	29	4
77	11	8	25	4
78	23	6	33	4
79	35	41	81	4
80	12	8	25	4
81	26	34	64	4
82	16	12	35	4
83	14	9	25	4
84	12	17	30	4



Equipment Swipes 220 236 Area

Assay Definition-

Assay Description:  
Decon D408-410

Assay Type: CPM  
Report Name: Report1  
Output Data Path: C:\Packard\Tricarb\Results\Bill Calver\Room Decon\20130328\_1354  
Raw Results Path: C:\Packard\Tricarb\Results\Bill Calver\Room Decon\20130328\_1354\20130328\_1354.results  
RTF File Name: C:\Packard\Tricarb\Results\Bill Calver\Room Decon\20130328\_1354\Lab Decon 118 237.rtf  
Assay File Name: C:\Packard\TriCarb\Assays\Room Decon.lsa

Count Conditions-

Nuclide: Triple  
Quench Indicator: tSIE/AEC  
External Std Terminator (sec): 0.5 2s%  
Pre-Count Delay (min): 0.00  
Quench Set: n/a  
Count Time (min): 1.00  
Count Mode: Normal  
Assay Count Cycles: 1 Repeat Sample Count: 1  
#Vials/Sample: 1 Calculate % Reference: Off

Background Subtract: Off  
Low CPM Threshold: Off  
2 Sigma % Terminator: Off

Regions	LL	UL
A	0.0	18.6
B	18.6	156.0
C	0.0	2000.0

Count Corrections-

Static Controller: On Luminescence Correction: On  
Colored Samples: n/a Heterogeneity Monitor: n/a  
Coincidence Time (nsec): 18 Delay Before Burst (nsec): 75

Half Life-

Half Life Correction: Off

Regions	Half Life	Units	Reference Date	Reference Time
A				
B				
C				

Cycle 1 Results

S#	CPMA	CPMB	CPMC	MESSAGES
<i>Background</i>	4	8	18	
85	1	9	18	
86	0	8	8	
87	15	6	27	
Missing vial 5.				
88	0	8	9	
89	9	15	28	
90	9	19	32	
91	0	11	5	
92	4	14	26	