

Radiological Survey Sheet

Job Location Pfizer Central Research Groton 118D/D311 Page 1 of 10
 Survey Purpose Radiological Assessment Date 12/12/00
 Performed By Pam Jones (Print) Pam Jones (Sign)

Inst.(1) Beckman LS 6500 (Model/SN) #7069448	Inst.(2) Ludlum 2241-2 (Model/SN) #1631003	Inst.(3) (Model/SN)
Det. Internal (Model/SN)	Det. Ludlum 43-68 (Model/SN) #PR149613	Det. (Model/SN)
Eff. See LSC Printout	Eff. ~ 89 G14	Eff.
Type rad. β	Type rad. β	Type rad.
Bkgd. See LSC Printout	Bkgd. 300 cpm	Bkgd.
Cal. Due: 12/00	Cal. Due 2/13/01	Cal. due

No.	Time	Location	Inst. Used	Total Activity (dpm/100 cm ²)
1.	8:00	floor	1	See attached LSC Printout
2.		"	1	
3.		"	1	
4.		"	1	
5.		tabletop	1	
6.		wall	1	
7.		"	1	
8.		"	1	
9.		"	1	
10.		"	1	
11.		"	1	
12.		door inside	1	
13.		door outside	1	
14.		top shelf	1	
15.		shelf	1	
16.		bot. shelf	1	
17.		top shelf	1	
18.	↓	shelf	1	

Radiological Survey Continuation Sheet

Page 2 of 10
 Date 12/12/00

No.	Time	Location	Inst. Used	Total Activity (dpm/100 cm ²)
19		bot. shelf	1	See attached LSC Printout
20		top shelf	1	
21		shelf	1	
22		bot. shelf	1	
23		top shelf	1	
24		shelf	1	
25		bot. shelf	1	
26		top shelf	1	
27		shelf	1	
28		bot. shelf	1	
29		top shelf	1	
30		bot. shelf	1	
31		out. drawers	1	
32		left drawer	1	
33		rt. drawer	1	
34		top shelf	1	
35		bot. shelf	1	
36		out. drawers	1	
37		top drawer	1	
38		drawer	1	
39		"	1	
40		bot. drawer	1	
41		out. cabinet	1	
42		left	1	
43		bottom	1	
44		rt.	1	
45		plastic tray	1	
46	✓	counter	1	↓

Radiological Survey Continuation Sheet

Page 3 of 10

Date 12/12/00

No.	Time	Location	Inst. Used	Total Activity (dpm/100 cm ²)
47		Counter	1	See attached LSC Printout
48		"	1	
49		"	1	
50		"	1	
51		Sides of sink	1	
52		bottom	1	
53		Wall	1	
54		"	1	
55		"	1	
56		"	1	
57		Floor	1	
58		"	1	
59		"	1	
60		"	1	
61		out. cabinet	1	
62		inside cabinet	1	
63		out. cabinets	1	
64		top drawer	1	
65		left	1	
66		bottom	1	
67		rt.	1	
68		outside drawers	1	
69		top drawer	1	
70		left	1	
71		bottom	1	
72		rt.	1	
73		outside drawers	1	
74		top drawer	1	

Radiological Survey Continuation Sheet

Page 4 of 10

Date 12/12/00

No.	Time	Location	Inst. Used	Total Activity (dpm/100 cm ²)
75		left	1	See attached LSC Printout
76		bottom	1	
77		RT.	1	
78		COUNTER	1	
79		"	1	
80		"	1	
81		floor	1	
82		"	1	
83		"	1	
84		"	1	
85		"	1	
86		"	1	
87		"	1	
88		"	1	
89		wall	1	
90		"	1	
91		"	1	
92		outside shelved	1	
93		top shelf	1	
94		shelf	1	
95		bot. shelf	1	
96		out. shelved	1	
97		top shelf	1	
98		shelf	1	
99		bot. shelf	1	
100		out. shelved	1	
101		top shelf	1	
102	↓	bot. shelf	1	↓

Radiological Survey Continuation Sheet

Page 5 of 10

Date 12/12/00

No.	Time	Location	Inst. Used	Total Activity (dpm/100 cm ²)
103		wall	1	See attached LSC Printout
104		"	1	
105		"	1	
106		"	1	
107		"	1	
108		out. shelves	1	
109		top shelf	1	
110		shelf	1	
111		bot. shelf	1	
112		out. shelves	1	
113		top shelf	1	
114		bot. shelf	1	
115		out. shelves	1	
116		top shelf	1	
117		shelf	1	
118		bot. shelf	1	
119		out. shelves	1	
120		top shelf	1	
121		shelf	1	
122		bot. shelf	1	
123		tabletop	1	
124		" "	1	
125		counter	1	
126		"	1	
127		sides of sink	1	
128		bottom	1	
129		out. cabinets	1	
130	✓	left drawer	1	✓

Radiological Survey Continuation Sheet

Page 6 of 10

Date 12/12/00

No.	Time	Location	Inst. Used	Total Activity (dpm/100 cm ²)
131		rt. drawer	1	See attached LSC Printout
132		left	1	
133		bottom	1	
134		rt.	1	
135		out. cabinet	1	
136		left	1	
137		bottom	1	
138		rt.	1	
139			1	
140			1	
141			1	
142			1	
143			1	
144			1	
145			1	
146			1	
147			1	
148			1	
149			1	
150			1	
151			1	
152			1	
153			1	
154			1	
155			1	
156			1	
157			1	
158			1	

Bld. 118D Room D311

Date: 12/12/00

○ = wipe location

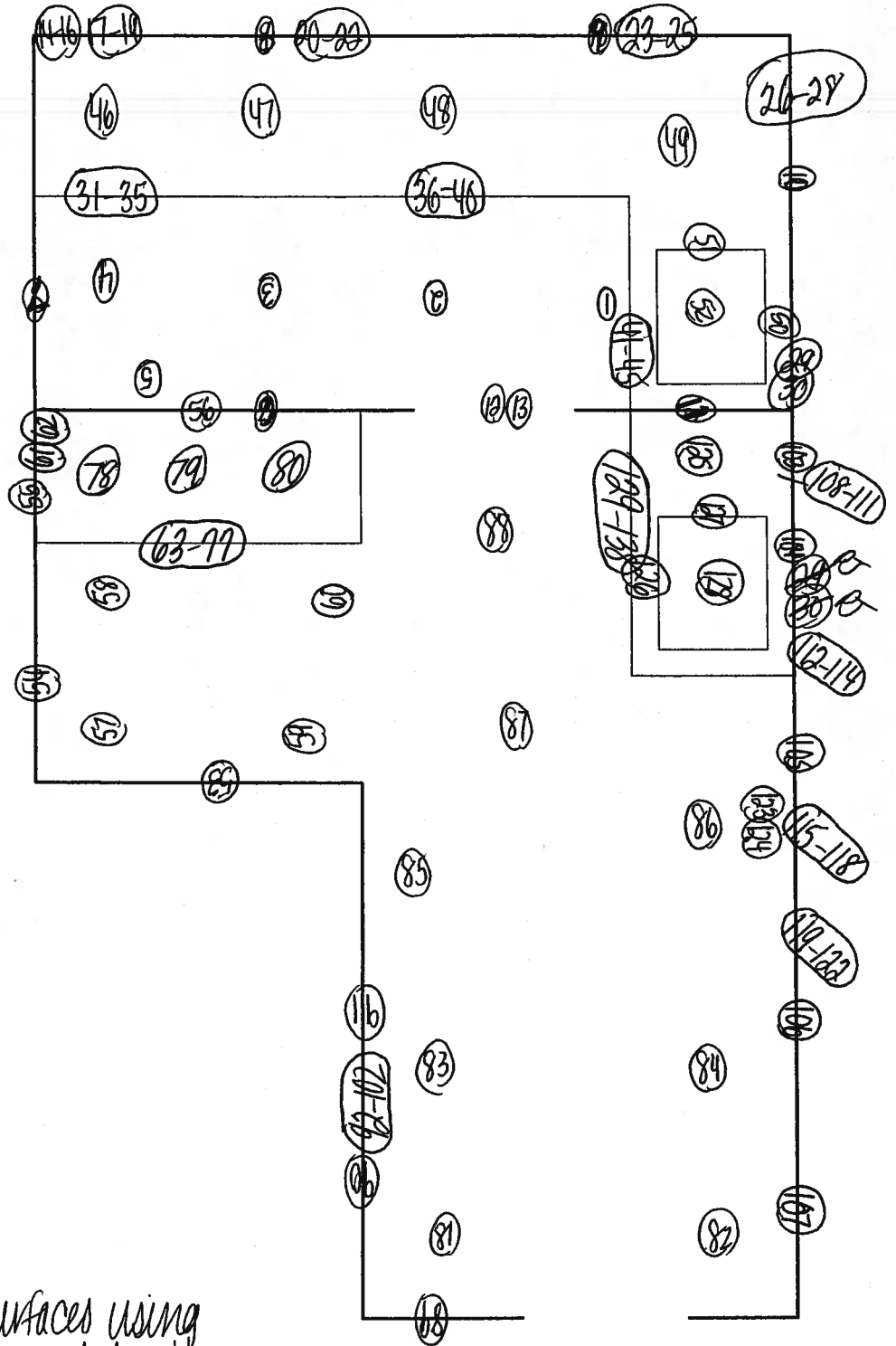

Surveyed 100% of all lower surfaces using instrument #2. All areas were noted to be at a level of normal background.

12 DEC 2000 11:44

EQUIPMENT SURVEY

RUN: 1 COMMENT: EQUIPMENT SURVEY

RESET TIME : 1.00
 DATA CALC : DL DPM H# : YES SAMPLE REPEATS: 1 PRINTER : EDIT
 COUNT BLANK : YES IC# : NO REPLICATES : 1 RS232 : EDIT
 TWO PHASE : NO AGC : YES CYCLE REPEATS : 1
 SCINTILLATOR: LIQUID LUMEX: YES LOW SAMPLE REJ: 0
 LOW LEVEL : NO HALF LIFE CORRECTION DATE: none

ISOTOPE 1: 3H %ERROR: 2.00 FACTOR: 1.0000 BKG. SUB: 0
 ISOTOPE 2: 14C %ERROR: 2.00 FACTOR: 1.0000 BKG. SUB: 0
 WIDE OPEN WINDOW %ERROR: 0.00 FACTOR: 1.0000 BKG. SUB: 0

BACKGROUND QUENCH CURVE: Off COLOR QUENCH CORRECTION: Off

Quench Limits Low: 13.688 High: 306.34

SAM NO	H#	3H CPM	14C CPM	WIDE CPM	3H DPM	14C DPM	LUMEX %	
B1	79.4	12.00	10.00	29.00	20.54	13.20	2.49	
		Blank Average	DPM	for	3H :	20.54	COEF. OF VAR:	0.000
		Blank Average	DPM	for	14C :	13.20	COEF. OF VAR:	0.000

1	83.7	12.00	12.00	36.00	-0.63	2.71	2.64	
2	99.5	16.00	15.00	42.00	8.83	6.82	4.83	
3	93.1	19.00	9.00	42.00	18.68	-2.74	2.98	
4	85.9	11.00	5.00	24.00	1.13	-6.67	4.13	
5	88.6	17.00	10.00	35.00	12.18	-0.03	2.73	
6	75.9	18.00	11.00	35.00	11.81	1.22	2.00	
7	77.2	9.00	10.00	26.00	-6.57	0.04	3.14	
8	77.5	23.00	8.00	38.00	24.22	-2.87	4.99	
9	79.3	17.00	9.00	33.00	11.23	-1.42	2.18	
10	77.3	12.00	7.00	26.00	1.33	-4.03	3.21	
11	79.9	12.00	9.00	30.00	0.57	-1.34	2.09	
12	80.1	11.00	8.00	26.00	-1.04	-2.66	2.34	
13	82.0	13.00	8.00	29.00	3.48	-2.68	2.28	
14	81.7	12.00	11.00	33.00	-2.93	5.06	1.98	
15	79.2	14.00	10.00	34.00	-3.72	4.03	2.71	
16	80.3	12.00	7.00	28.00	1.87	-4.01	4.59	
17	82.0	12.00	5.00	29.00	2.89	-6.69	2.62	
18	81.5	13.00	9.00	32.00	2.90	-1.35	1.44	
19	85.4	15.00	12.00	37.00	6.15	2.67	1.84	
20	83.1	17.00	8.00	41.00	12.34	-2.75	1.34	
21	84.6	24.00	14.00	54.00	24.78	5.20	3.61	
22	89.4	10.00	10.00	27.00	-3.48	0.10	2.21	
23	83.9	14.00	14.00	39.00	2.71	5.37	1.91	
24	87.2	14.00	8.00	39.00	6.34	-2.68	2.16	
25	86.8	17.00	9.00	38.00	12.42	-1.39	2.12	
26	80.9	15.00	10.00	32.00	6.63	-0.04	2.33	
27	82.7	17.00	8.00	40.00	12.29	-2.75	3.59	
28	85.2	17.00	17.00	42.00	7.86	9.36	1.93	
29	85.3	8.00	7.00	19.00	-6.63	-3.93	3.17	
30	87.4	18.00	11.00	43.00	13.66	1.29	1.29	
31	81.7	14.00	7.00	33.00	6.13	-4.04	1.85	
32	96.5	15.00	10.00	36.00	8.88	0.05	4.72	
33	89.2	19.00	3.00	28.00	20.63	-9.49	8.19	
34	87.7	11.00	9.00	23.00	-0.84	-1.28	2.21	
35	87.4	11.00	11.00	31.00	-1.96	1.41	4.08	
36	81.1	22.00	8.00	34.00	22.82	-2.84	1.63	

SAM NO.	H#	3H CPM	14C CPM	WIDE CPM	3H DPM	14C DPM	LUMEX %
37	84.1	14.00	10.00	31.00	4.86	-0.01	3.15
38	89.4	11.00	8.00	31.00	-0.13	-2.62	1.57
39	92.8	20.00	6.00	40.00	22.03	-5.46	2.24
40	87.6	19.00	13.00	42.00	14.85	3.97	1.60
41	82.1	20.00	9.00	38.00	18.18	-1.46	1.20
42	79.1	13.00	7.00	26.00	3.66	-4.04	1.50
43	82.9	14.00	11.00	36.00	4.18	1.33	1.66
44	87.8	12.00	11.00	32.00	0.31	1.40	2.45
45	86.3	15.00	6.00	31.00	9.52	-5.39	2.82
46	87.2	12.00	10.00	31.00	0.80	0.05	4.75
47	87.3	12.00	7.00	26.00	2.43	-3.99	2.68
48	87.6	11.00	8.00	28.00	-0.31	-2.62	3.72
49	91.5	29.00	18.00	56.00	35.58	10.56	2.03
50	86.3	22.00	10.00	39.00	22.91	-0.13	3.29
51	86.8	26.00	9.00	43.00	32.45	-1.54	2.01
52	87.9	17.00	11.00	38.00	11.52	1.31	3.01
53	79.9	13.00	8.00	29.00	3.24	-2.69	2.20
54	83.9	13.00	10.00	32.00	2.64	0.01	2.16
55	85.2	14.00	12.00	37.00	3.92	2.69	1.42
56	81.1	11.00	7.00	25.00	-0.42	-4.00	2.48
57	100.9	7.00	5.00	21.00	-6.67	-6.55	6.26
58	117.8	10.00	11.00	32.00	-1.18	1.66	6.26
59	104.6	5.00	7.00	23.00	-12.49	-3.78	4.10
60	101.3	7.00	13.00	32.00	-11.37	4.30	4.25
61	85.5	16.00	12.00	38.00	8.38	2.66	1.14
62	88.7	16.00	12.00	35.00	8.86	2.68	1.71
63	84.5	14.00	8.00	33.00	5.98	-2.69	2.30
64	96.4	13.00	13.00	33.00	2.46	4.14	2.52
65	81.3	9.00	13.00	29.00	-7.88	4.09	2.24
66	89.6	14.00	13.00	33.00	3.92	4.07	2.41
67	83.0	12.00	7.00	34.00	1.95	-4.00	1.69
68	84.4	11.00	8.00	29.00	-0.63	-2.64	3.62
69	88.1	9.00	19.00	41.00	-10.74	12.22	2.04
70	86.4	13.00	6.00	35.00	5.09	-5.35	2.02
71	89.8	15.00	6.00	30.00	10.06	-5.38	2.07
72	85.8	13.00	9.00	36.00	3.40	-1.32	3.03
73	86.5	10.00	9.00	26.00	-3.19	-1.27	2.90
74	91.9	14.00	12.00	38.00	4.77	2.74	3.90
75	87.1	11.00	10.00	32.00	-1.44	0.06	1.73
76	87.4	12.00	5.00	31.00	3.54	-6.68	2.06
77	83.4	20.00	8.00	36.00	18.96	-2.80	1.38
78	94.0	12.00	11.00	32.00	0.99	1.44	3.45
79	135.3	15.00	8.00	34.00	18.39	-2.49	74.37
80	87.3	15.00	6.00	32.00	9.67	-5.39	5.37
81	98.2	15.00	9.00	39.00	9.73	-1.29	3.16
82	97.8	7.00	8.00	22.00	-8.64	-2.50	5.05
83	86.8	16.00	8.00	33.00	10.74	-2.71	1.53
84	89.3	13.00	7.00	28.00	4.92	-4.00	2.44
85	98.4	16.00	11.00	32.00	10.97	1.40	2.48
86	93.1	16.00	19.00	48.00	5.60	12.16	1.75
87	91.0	20.00	9.00	44.00	19.97	-1.42	1.65
88	98.0	16.00	10.00	39.00	11.48	0.04	2.87
89	82.8	15.00	10.00	35.00	6.87	-0.03	1.30
90	88.8	12.00	13.00	28.00	-0.67	4.10	2.21
91	89.3	11.00	15.00	45.00	-3.98	6.81	1.34
92	83.8	13.00	8.00	26.00	3.70	-2.68	2.65
93	88.7	10.00	9.00	27.00	-2.99	-1.25	3.22
94	84.2	14.00	9.00	31.00	5.41	-1.35	2.28

SAM	H#	3H CPM	14C CPM	WIDE CPM	3H DPM	14C DPM	LUMEX %
95	86.3	7.00	9.00	23.00	-9.86	-1.22	2.70
96	87.3	9.00	10.00	31.00	-5.89	0.10	2.59
97	88.7	11.00	12.00	31.00	-2.38	2.77	1.83
98	88.2	18.00	12.00	40.00	13.27	2.64	1.78
99	93.4	21.00	7.00	40.00	23.92	-4.13	4.35
100	83.9	12.00	13.00	31.00	-1.15	4.06	1.15
101	88.2	12.00	11.00	34.00	0.36	1.40	2.30
102	87.7	13.00	9.00	32.00	8.10	-1.35	1.77
103	83.5	13.00	8.00	34.00	3.66	-2.68	1.07
104	88.6	18.00	7.00	36.00	16.07	-4.09	1.39
105	87.7	18.00	3.00	34.00	18.07	-9.48	1.70
106	86.0	14.00	7.00	29.00	6.72	-4.03	1.49
107	87.7	13.00	9.00	29.00	3.63	-1.31	1.39
108	85.5	8.00	11.00	32.00	-8.76	1.45	1.51
109	91.4	15.00	6.00	26.00	10.32	-5.37	2.09
110	87.6	18.00	13.00	48.00	12.62	3.98	1.67
111	96.8	17.00	8.00	37.00	14.77	-2.69	1.52
112	83.0	20.00	8.00	39.00	18.88	-2.80	1.18
113	85.0	17.00	10.00	40.00	11.59	-0.05	1.16
114	87.5	7.00	10.00	24.00	-10.34	0.14	3.03
115	84.9	11.00	10.00	30.00	-1.65	0.05	1.23
116	90.9	15.00	10.00	34.00	8.03	0.02	2.26
117	88.9	16.00	14.00	43.00	7.78	5.37	1.03
118	88.2	14.00	9.00	36.00	5.93	-1.33	1.51
119	93.5	16.00	7.00	33.00	12.41	-4.04	4.06
120	96.3	10.00	14.00	32.00	-5.15	5.55	3.40
121	89.2	22.00	7.00	35.00	25.19	-4.16	2.11
122	95.2	17.00	8.00	34.00	14.48	-2.70	2.27
123	98.2	15.00	10.00	33.00	9.15	0.06	3.07
124	110.7	14.00	7.00	27.00	10.70	-3.94	4.55
125	113.9	13.00	7.00	27.00	8.71	-3.91	10.81
126	96.2	12.00	11.00	31.00	1.24	1.46	3.31
127	86.2	16.00	12.00	38.00	8.48	2.66	1.30
128	102.3	11.00	9.00	27.00	0.75	-1.20	3.47
129	89.7	11.00	12.00	40.00	-2.29	2.78	3.00
130	94.3	7.00	10.00	28.00	-9.99	0.18	3.31
131	90.7	18.00	6.00	30.00	17.02	-5.43	2.00
132	89.9	20.00	15.00	40.00	16.43	6.66	1.17
133	95.3	15.00	8.00	41.00	9.82	-2.66	1.40
134	86.0	18.00	9.00	40.00	14.51	-1.41	3.34
135	86.2	19.00	9.00	38.00	16.76	-1.42	1.19
136	83.7	13.00	11.00	32.00	2.08	1.35	1.56
137	111.8	9.00	8.00	34.00	-2.54	-2.46	5.36
138	87.6	17.00	14.00	39.00	9.84	5.35	1.77

139 INVALID SAMPLE COUNT; H# ABORT; COUNT RATE TOO LOW