

Radiological Survey Sheet

Job Location Pfizer Central Research Grotto 118/D.310 Page 1 of 19
 Survey Purpose Radiological Assessment Date 12/6/00
 Performed By Pam Jones (Print) Pam Jones (Sign)

Inst.(1) (Model/SN) Beckman LS 6500 #7069448	Inst.(2) <u>Ludlum 2241-2</u> (Model/SN) # <u>103603</u>	Inst.(3) (Model/SN)
Det. Internal (Model/SN)	Det. <u>Ludlum 43-68</u> (Model/SN) # <u>PR149613</u>	Det. (Model/SN)
Eff. <u>See LSC Printout</u>	Eff. <u>~ 8% C14</u>	Eff.
Type rad. β	Type rad. <u>β</u>	Type rad.
Bkgd. <u>See LSC Printout</u>	Bkgd. <u>300 cpm</u>	Bkgd.
Cal. Due: 12/00	Cal. Due <u>2/13/01</u>	Cal. due

No.	Time	Location	Inst. Used	Total Activity (dpm/100 cm ²)
1.	9:00	wall	1	See attached LSC Printout
2.		ledge	1	
3.		wall	1	
4.		glass	1	
5.		"	1	
6.		floor	1	
7.		"	1	
8.		outside cab	1	
9.		shelves	1	
10.		glass	1	
11.		glass	1	
12.		wall	1	
13.		"	1	
14.		glass	1	
15.		wall	1	
16.		"	1	
17.		shelves	1	
18.	✓	ledge	1	

Radiological Survey Continuation Sheet

Page 2 of 19
 Date 12/6/00

No.	Time	Location	Inst. Used	Total Activity (dpm/100 cm ²)
19		wall	1	See attached LSC Printout
20		floor	1	
21		"	1	
22		floor	1	
23		"	1	
24		"	1	
25		"	1	
26		"	1	
27		"	1	
28		outside shelves	1	
29		top shelf	1	
30		bottom shelf	1	
31		outside shelves	1	
32		top shelf	1	
33		bottom shelf	1	
34		counter	1	
35		"	1	
36		"	1	
37		cup sink	1	
38		ledge	1	
39		outside drawers	1	
40		top drawer	1	
41		top shelf	1	
42		bottom shelf	1	
43		outside drawers	1	
44		top drawer	1	
45		drawer	1	
46	✓	"	1	✓

Radiological Survey Continuation Sheet

Page 3 of 19

Date 12/6/00

No.	Time	Location	Inst. Used	Total Activity (dpm/100 cm ²)
47		bottom drawer	1	See attached LSC Printout
48		drawer	1	
49		outside drawers	1	
50		top drawer	1	
51		drawer	1	
52		"	1	
53		bottom drawer	1	
54		drawer	1	
55		outside drawers	1	
56		blw-out	1	
57		top drawer	1	
58		drawer	1	
59		bottom drawer	1	
60		outside shelves	1	
61		top shelf	1	
62		shelf	1	
63		bot. shelf	1	
64		outside shelves	1	
65		top shelf	1	
66		shelf	1	
67		bot. shelf	1	
68		outside shelves	1	
69		top shelf	1	
70		shelf	1	
71		"	1	
72		bottom shelf	1	
73		top shelf	1	
74	✓	bot shelf	1	✓

Radiological Survey Continuation Sheet

Page 4 of 19
 Date 12/6/00

No.	Time	Location	Inst. Used	Total Activity (dpm/100 cm ²)
75		wall	1	See attached LSC Printout
76		"	1	
77		floor	1	
78		"	1	
79		"	1	
80		outside shelves	1	
81		top shelf	1	
82		shelf	1	
83		"	1	
84		bot. shelf	1	
85		outside shelves	1	
86		top shelf	1	
87		shelf	1	
88		"	1	
89		bot. shelf	1	
90		ledge	1	
91		drawer	1	
92		"	1	
93		"	1	
94		shelf door	1	
95		"	1	
96		counter	1	
97		"	1	
98		"	1	(see #271)
99		drawer cabinet	1	
100		drawer	1	
101		"	1	
102	✓	outside drawers	1	✓

Radiological Survey Continuation Sheet

Page 5 of 19

Date 12/6/00

No.	Time	Location	Inst. Used	Total Activity (dpm/100 cm ²)
103		top drawer	1	See attached LSC Printout
104		drawer	1	
105		"	1	
106		bot. drawer	1	
107		drawer	1	
108		outside drawers	1	
109		top drawer	1	
110		drawer	1	
111		"	1	
112		bot. drawer	1	
113		outside drawers	1	
114		top drawer	1	
115		top shelf	1	
116		bot. shelf	1	
117		floor	1	
118		"	1	
119		"	1	
120		"	1	
121		"	1	
122		top shelf	1	
123		shelf	1	
124		bot. shelf	1	
125		top shelf	1	
126		shelf	1	
127		bot. shelf	1	
128		counter	1	
129		"	1	
130	✓	"	1	✓

Radiological Survey Continuation Sheet

Page 6 of 19

Date 12/6/00

No.	Time	Location	Inst. Used	Total Activity (dpm/100 cm ²)
131		cup sink	1	See attached LSC Printout
132		basin	1	
133		outside drawers	1	
134		top drawer	1	
135		top shelf	1	
136		bot. shelf	1	
137		out. drawers	1	
138		top drawer	1	
139		drawer	1	
140		"	1	
141		bot. drawer	1	
142		outside drawers	1	(see #272)
143		top drawer	1	
144		drawer	1	
145		"	1	
146		bot. drawer	1	
147		drawer	1	
148		drawer	1	
149		out. drawers	1	
150		top drawer	1	
151		drawer	1	
152		bot. drawer	1	
153		floor	1	
154		"	1	
155		"	1	
156		out. shelves	1	
157		top shelf	1	
158	✓	shelf	1	✓

Radiological Survey Continuation Sheet

Page 7 of 19
Date 12/6/00

No.	Time	Location	Inst. Used	Total Activity (dpm/100 cm ²)
159		bot. shelf	1	See attached LSC Printout
160		wall	1	
161		pipe driver	1	
162		out. shelves	1	
163		top shelf	1	
164		shelf	1	
165		"	1	
166		bot. shelf	1	
167		outside shelves	1	
168		top shelf	1	
169		shelf	1	
170		"	1	
171		bot. shelf	1	
172		shelf	1	
173		counter	1	
174		"	1	
175		"	1	
176		cup sink	1	
177		sides of sink	1	
178		bottom " "	1	
179		outside cab	1	
180		left	1	
181		bot.	1	
182		rt.	1	
183		out. drawers	1	
184		top drawer	1	
185		drawer	1	
186	✓	"	1	✓

Radiological Survey Continuation Sheet

Page 8 of 19

Date 12/6/00

No.	Time	Location	Inst. Used	Total Activity (dpm/100 cm ²)
187		bot. drawer	1	See attached LSC Printout
188		drawer	1	
189		bot. drawers	1	
190		top drawer	1	
191		drawer	1	
192		"	1	
193		bot. drawer	1	
194		door	1	
195		floor	1	
196		"	1	
197		"	1	
198		"	1	
199		"	1	
200		outside shelves	1	
201		top shelf	1	
202		shelf	1	
203		"	1	
204		bot. shelf	1	
205		outside shelves	1	
206		top shelf	1	
207		shelf	1	
208		"	1	
209		bot. shelf	1	
210		outside shelves	1	
211		top shelf	1	
212		shelf	1	
213		"	1	
214	√	bot. shelf	1	√

Radiological Survey Continuation Sheet

Page 9 of 19

Date 12/6/00

No.	Time	Location	Inst. Used	Total Activity (dpm/100 cm ²)
215		ledge	1	See attached LSC Printout
216		outside drawers	1	
217		pull-out	1	
218		top drawer	1	
219		drawer	1	
220		bot. drawer	1	
221		drawer	1	
222		out. drawers	1	
223		top drawer	1	
224		drawer	1	
225		"	1	
226		bot. drawer	1	
227		drawer	1	
228		out. drawers	1	
229		top drawer	1	
230		drawer	1	
231		"	1	
232		bot. drawer	1	
233		out. drawers	1	
234		top drawer	1	
235		top shelf	1	
236		bot. shelf	1	
237		wall	1	
238		"	1	
239		"	1	
240		tabletop	1	
241		"	1	
242	✓	drawer	1	✓

Radiological Survey Continuation Sheet

Page 10 of 19

Date 12/6/00

No.	Time	Location	Inst. Used	Total Activity (dpm/100 cm ²)
243		dimmer	1	See attached LSC Printout
244		left outside hood	1	
245		top	1	
246		rt.	1	
247		ledge	1	
248		glass + handles	1	
249		blue cover	1	
250		yellow shield	1	
251		forceps (lg)	1	
252		" (sm.)	1	
253		known lead shield	1	
254		left inside hood	1	
255		top back	1	
256		center back	1	
257		bottom back	1	
258		rt. side	1	
259		left counter	1	
260		rt. counter	1	
261		cup sink	1	
262		out. cabinet	1	
263		left	1	
264		bottom	1	
265		rt.	1	
266		outside cabinet	1	
267		left	1	
268		bottom	1	
269		rt.	1	
270	✓	plastic tray	1	✓

Bld. 118D Room D310

Page 12 of 19

Date: 12/6/00

D=wipe LOCATION

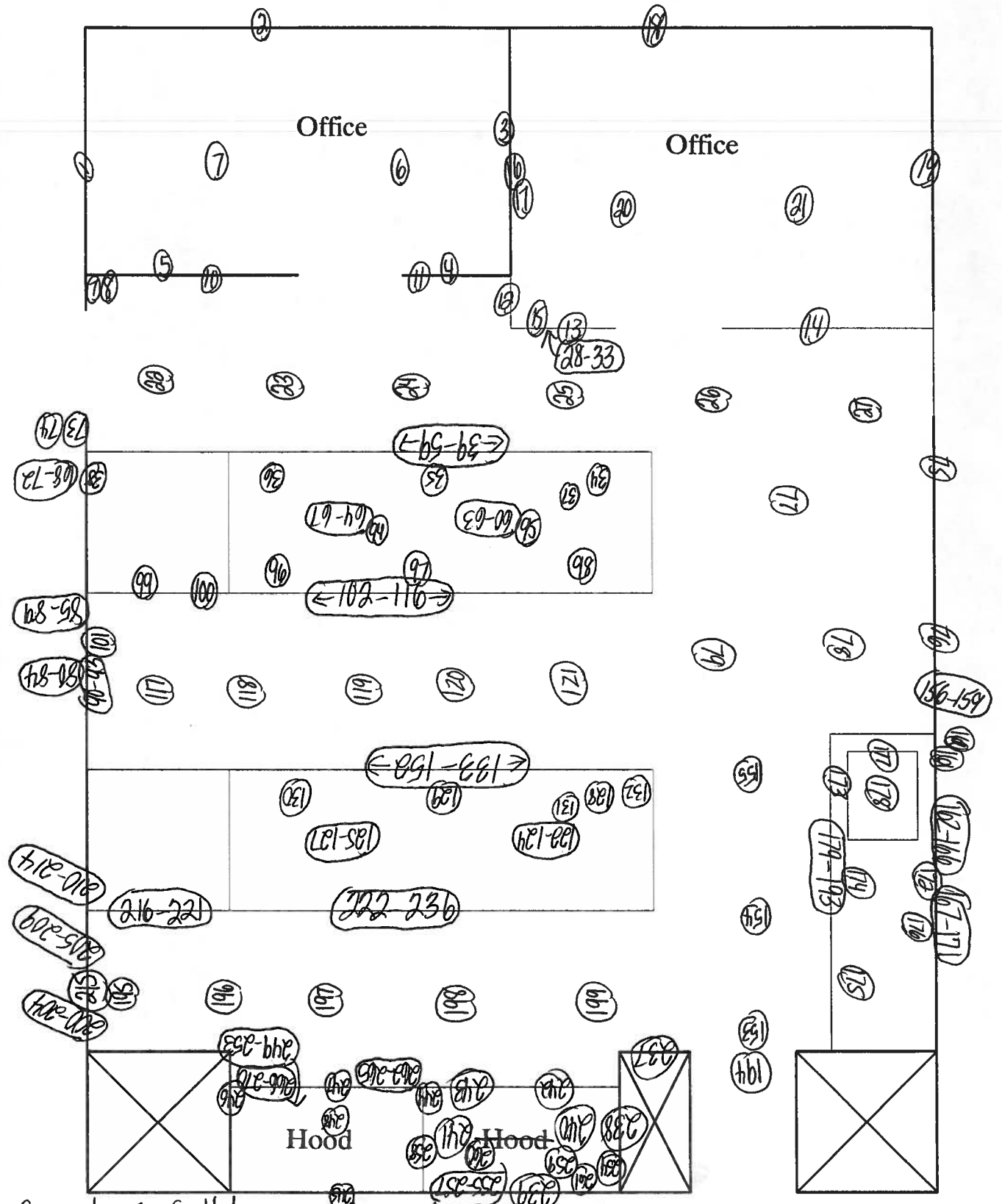

Surveyed 100% of all lower surfaces using instrument #2.
All areas were noted to be at a level of normal background.

B1	75.8	17.00	7.00	34.00	32.26	9.08	1.98	
		Blank Average	DPM	for	3H :	32.26 COEF.	OF VAR:	0.000
		Blank Average	DPM	for	14C :	9.08 COEF.	OF VAR:	0.000
1	82.3	11.00	6.00	28.00	-11.50	-1.22	3.88	
2	87.5	10.00	14.00	35.00	-17.53	9.58	2.85	
3	76.4	15.00	10.00	39.00	-5.67	4.05	2.15	
4	76.7	8.00	10.00	26.00	-20.44	4.16	2.10	
5	78.1	14.00	8.00	32.00	-6.55	1.40	2.51	
6	75.2	12.00	8.00	29.00	-11.10	1.42	2.09	
7	78.2	13.00	11.00	35.00	-10.22	5.43	2.03	
8	74.1	8.00	8.00	22.00	-19.56	1.48	2.51	
9	110.1	14.00	18.00	44.00	-8.02	15.18	1.66	
10	78.2	12.00	5.00	26.00	-9.26	-2.59	2.49	
11	76.7	18.00	16.00	47.00	-2.35	12.03	1.39	
12	77.9	9.00	10.00	27.00	-18.24	4.16	2.37	
13	73.9	19.00	10.00	38.00	2.39	3.97	1.63	
14	75.5	9.00	12.00	32.00	-19.41	6.81	1.72	
15	77.7	17.00	6.00	34.00	0.81	-1.33	1.07	
16	76.7	16.00	6.00	33.00	-1.47	-1.32	1.32	
17	74.8	14.00	7.00	27.00	-6.43	0.05	3.16	
18	79.1	16.00	13.00	41.00	-4.73	8.07	1.47	
19	75.8	12.00	8.00	31.00	-11.05	1.42	1.44	
20	75.3	15.00	17.00	40.00	-9.35	13.40	0.97	
21	78.1	15.00	13.00	37.00	-6.99	8.07	1.52	
22	80.1	13.00	8.00	25.00	-8.46	1.42	1.58	
23	77.9	12.00	13.00	35.00	-13.40	8.12	1.16	
24	80.8	22.00	17.00	49.00	6.34	13.34	1.01	
25	78.6	15.00	7.00	28.00	-3.84	0.04	1.66	
26	78.6	19.00	15.00	41.00	0.58	10.69	1.09	
27	78.3	11.00	14.00	34.00	-16.01	9.48	1.49	
28	76.3	11.00	8.00	32.00	-13.10	1.44	1.28	
29	78.3	13.00	11.00	34.00	-10.21	5.43	1.28	
30	75.9	21.00	8.00	34.00	7.94	1.27	1.27	
31	75.6	15.00	16.00	38.00	-8.80	12.07	1.01	
32	79.4	14.00	10.00	36.00	-7.42	4.08	1.21	
33	74.9	16.00	4.00	32.00	-0.71	-4.00	1.47	
34	80.3	17.00	15.00	38.00	-3.47	10.74	1.42	
35	83.9	22.00	14.00	46.00	8.53	9.34	0.89	
36	84.5	13.00	8.00	26.00	-7.93	1.44	3.13	

SAM NO	H#	3H CPM	14C CPM	WIDE CPM	3H DPM	14C DPM	LUMEX %
37	91.9	30.00	16.00	53.00	27.40	11.96	1.95
38	87.4	25.00	16.00	48.00	14.87	12.01	1.13
39	77.6	17.00	8.00	30.00	-0.23	1.34	2.68
40	77.3	15.00	10.00	33.00	-5.55	4.05	1.38
41	80.5	16.00	10.00	36.00	-2.98	4.06	1.52
42	77.3	14.00	9.00	32.00	-7.16	2.73	1.80
43	77.0	17.00	16.00	41.00	-4.42	12.05	1.39
44	78.3	12.00	11.00	28.00	-12.34	5.45	1.38
45	75.1	14.00	8.00	29.00	-6.91	1.38	1.36
46	76.4	19.00	11.00	48.00	2.28	5.32	1.10
47	82.0	12.00	8.00	30.00	-10.40	1.45	1.08
48	77.0	13.00	4.00	23.00	-6.76	-3.94	2.04
49	78.1	20.00	15.00	46.00	2.63	10.67	0.82
50	79.6	19.00	15.00	44.00	0.74	10.70	1.28
51	76.2	18.00	9.00	35.00	1.15	2.66	0.98
52	77.4	11.00	10.00	35.00	-14.03	4.12	1.19
53	79.5	12.00	12.00	37.00	-12.75	6.80	1.18
54	82.0	24.00	14.00	47.00	12.51	9.29	1.25
55	76.2	11.00	9.00	31.00	-13.62	2.77	2.09
56	78.8	13.00	6.00	27.00	-7.57	-1.26	1.31
57	79.1	11.00	12.00	32.00	-14.92	6.81	1.42
58	76.3	7.00	8.00	26.00	-21.55	1.50	1.68
59	76.6	18.00	10.00	34.00	0.71	4.00	1.78
60	76.0	12.00	6.00	26.00	-10.00	-1.25	1.81
61	83.3	10.00	9.00	29.00	-15.17	2.83	1.46
62	79.2	14.00	6.00	26.00	-5.38	-1.28	2.06
63	80.4	17.00	9.00	34.00	-0.33	2.70	1.55
64	76.9	16.00	9.00	38.00	-2.97	2.70	0.93
65	83.3	13.00	13.00	37.00	-10.73	8.15	1.07
66	80.7	11.00	7.00	30.00	-12.18	0.12	1.38
67	76.3	16.00	9.00	36.00	-3.05	2.69	1.13
68	79.6	8.00	4.00	18.00	-17.17	-3.86	2.15
69	81.1	10.00	5.00	26.00	-13.25	-2.55	2.78
70	80.6	14.00	7.00	32.00	-5.72	0.07	1.35
71	79.3	12.00	6.00	26.00	-9.65	-1.24	1.78
72	78.8	16.00	14.00	41.00	-5.29	9.40	0.87
73	86.2	21.00	9.00	39.00	9.47	2.66	1.69
74	77.9	20.00	9.00	40.00	5.69	2.64	0.99
75	85.9	16.00	10.00	35.00	-2.21	4.09	0.87
76	75.8	19.00	12.00	41.00	1.67	6.65	0.98
77	84.5	14.00	13.00	35.00	-8.41	8.14	1.52
78	79.2	8.00	12.00	31.00	-21.34	6.86	1.78
79	81.1	11.00	3.00	24.00	-10.04	-5.24	1.61
80	78.7	16.00	9.00	35.00	-2.73	2.71	0.81
81	81.1	11.00	11.00	31.00	-14.23	5.48	1.14
82	79.5	18.00	13.00	47.00	-0.39	8.04	0.74
83	80.3	14.00	12.00	29.00	-8.37	6.77	1.09
84	77.6	11.00	15.00	32.00	-16.58	10.81	0.99
85	79.0	12.00	6.00	30.00	-9.69	-1.25	0.88
86	82.1	23.00	11.00	47.00	11.93	5.29	0.83
87	82.3	11.00	11.00	32.00	-14.13	5.49	1.52
88	79.1	15.00	14.00	44.00	-7.39	9.42	0.97
89	77.6	13.00	7.00	31.00	-8.22	0.07	2.20
90	83.7	9.00	15.00	35.00	-20.52	10.91	1.13
91	77.3	15.00	6.00	36.00	-3.50	-1.30	0.87
92	78.7	10.00	14.00	30.00	-18.12	9.50	1.15
93	77.0	13.00	12.00	30.00	-10.85	6.76	1.01
94	76.6	6.00	7.00	22.00	-23.14	0.18	1.34

SAM NO	H#	3H CPM	14C CPM	WIDE CPM	3H DPM	14C DPM	LUMEX %
96	78.3	14.00	6.00	24.00	-5.49	-1.28	1.79
96	88.0	5.00	10.00	25.00	-26.51	4.29	2.48
97	84.7	39.00	23.00	74.00	41.32	21.15	0.97
98	84.1	12.00	16.00	34.00	-14.44	12.20	1.56
99	81.0	14.00	7.00	30.00	-5.67	0.07	2.71
100	77.2	17.00	11.00	36.00	-1.84	5.36	0.88
101	77.4	14.00	14.00	35.00	-9.71	9.42	0.93
102	79.7	9.00	10.00	31.00	-18.13	4.17	0.77
103	76.7	16.00	12.00	39.00	-4.53	6.71	0.72
104	76.8	5.00	9.00	20.00	-26.27	2.88	1.47
105	76.0	14.00	13.00	37.00	-9.34	8.07	0.63
106	76.6	9.00	16.00	36.00	-21.39	12.17	0.73
107	76.2	9.00	14.00	32.00	-20.39	9.49	0.82
108	74.1	8.00	10.00	22.00	-20.57	4.15	1.42
109	87.3	18.00	9.00	41.00	3.01	2.71	1.50
110	77.1	14.00	11.00	33.00	-8.21	5.41	1.21
111	79.0	14.00	14.00	37.00	-9.54	9.44	0.93
112	76.7	15.00	5.00	34.00	-3.08	-2.64	0.68
113	79.5	20.00	13.00	42.00	3.90	8.00	0.60
114	75.8	17.00	12.00	39.00	-2.54	6.69	0.59
115	79.9	17.00	6.00	31.00	1.16	-1.33	0.96
116	80.3	10.00	8.00	24.00	-14.89	1.47	1.06
117	79.2	11.00	14.00	33.00	-15.95	9.49	1.31
118	83.1	13.00	12.00	35.00	-10.22	6.81	0.60
119	80.5	16.00	15.00	38.00	-5.59	10.76	0.67
120	77.9	13.00	6.00	27.00	-7.67	-1.26	1.01
121	78.8	11.00	9.00	25.00	-13.39	2.79	1.09
122	87.4	15.00	12.00	37.00	-5.29	6.80	1.75
123	87.9	16.00	11.00	31.00	-2.44	5.44	1.15
124	88.2	11.00	9.00	25.00	-12.51	2.84	2.11
125	85.4	8.00	14.00	32.00	-22.09	9.60	0.99
126	83.8	14.00	8.00	34.00	-5.84	1.42	0.94
127	95.2	16.00	18.00	44.00	-5.26	14.95	1.14
128	84.9	17.00	9.00	38.00	0.40	2.72	0.87
129	85.5	17.00	11.00	32.00	-0.59	5.41	2.02
130	92.1	17.00	11.00	35.00	0.51	5.45	1.60
131	89.5	14.00	8.00	29.00	-5.06	1.45	2.03
132	80.2	13.00	8.00	26.00	-8.45	1.42	1.08
133	78.6	11.00	14.00	43.00	-15.99	9.48	0.71
134	78.3	14.00	10.00	30.00	-7.55	4.08	1.08
135	76.2	23.00	4.00	41.00	14.25	-4.11	0.81
136	79.1	10.00	18.00	40.00	-20.17	14.86	0.37
137	80.8	15.00	8.00	30.00	-4.05	1.39	1.12
138	81.7	12.00	11.00	33.00	-12.01	5.47	0.92
139	80.8	12.00	9.00	28.00	-11.05	2.78	0.98
140	78.7	13.00	8.00	26.00	-8.61	1.42	1.10
141	91.3	48.00	24.00	79.00	63.77	22.42	2.99
142	81.4	20.00	12.00	42.00	4.76	6.68	0.78
143	76.8	13.00	14.00	36.00	-11.89	9.43	0.78
144	79.9	10.00	8.00	25.00	-14.92	1.47	1.51
145	77.0	20.00	5.00	33.00	7.57	-2.72	1.11
146	82.8	13.00	9.00	31.00	-8.67	2.78	1.07
147	82.9	21.00	9.00	37.00	9.32	1.30	0.64
148	83.5	12.00	7.00	26.00	-9.72	0.11	1.26
149	77.5	10.00	7.00	26.00	-14.61	0.12	1.45
150	84.5	14.00	7.00	30.00	-5.21	0.08	1.44
151	78.1	7.00	11.00	26.00	-23.01	5.53	1.08
152	80.8	12.00	9.00	28.00	-11.06	2.78	0.80

SAM NO	I#	3H CPM	14C CPM	WIDE CPM	3H DPM	14C DPM	LUMEX %
153	82.7	13.00	13.00	31.00	-10.80	8.14	0.98
154	82.7	18.00	10.00	35.00	1.68	4.03	1.06
155	81.3	7.00	9.00	24.00	-21.83	2.87	1.58
156	81.1	13.00	9.00	35.00	-8.86	2.77	0.90
157	82.8	14.00	9.00	32.00	-6.49	2.76	0.55
158	83.5	14.00	11.00	33.00	-7.46	5.45	0.88
159	82.7	17.00	14.00	36.00	-2.61	9.42	0.82
160	73.3	17.00	12.00	39.00	-2.88	6.67	0.71
161	82.7	13.00	8.00	33.00	-8.16	1.43	0.75
162	80.2	13.00	10.00	34.00	-9.49	4.10	0.71
163	81.2	19.00	12.00	41.00	2.55	6.69	0.97
164	84.9	20.00	12.00	41.00	5.40	6.70	1.05
165	82.1	16.00	9.00	30.00	-2.22	2.72	1.04
166	83.0	14.00	16.00	38.00	-10.17	12.16	0.74
167	80.3	12.00	8.00	34.00	-10.58	1.44	0.62
168	87.6	24.00	9.00	42.00	16.49	2.61	1.37
169	87.3	10.00	8.00	29.00	-14.29	1.51	0.89
170	84.4	19.00	10.00	33.00	4.17	4.03	1.08
171	89.9	15.00	11.00	39.00	-4.39	5.47	1.30
172	83.2	13.00	10.00	34.00	-9.15	4.12	0.79
173	84.0	16.00	11.00	40.00	-3.02	5.42	0.67
174	89.5	13.00	13.00	36.00	-10.07	8.20	0.84
175	85.6	13.00	10.00	34.00	-8.87	4.14	0.91
176	87.2	12.00	14.00	33.00	-13.09	9.55	1.24
177	85.5	18.00	3.00	30.00	5.93	-5.36	1.16
178	91.9	18.00	12.00	37.00	2.20	6.78	10.46
179	88.5	19.00	8.00	41.00	6.02	1.35	0.74
180	85.1	15.00	8.00	33.00	-3.46	1.41	1.04
181	96.3	16.00	10.00	36.00	-0.52	4.15	1.69
182	90.0	11.00	18.00	40.00	-17.29	14.98	0.85
183	83.5	17.00	9.00	39.00	0.17	2.71	0.52
184	89.7	17.00	10.00	40.00	0.64	4.09	0.92
185	86.9	12.00	9.00	34.00	-10.41	2.82	0.73
186	84.6	18.00	8.00	34.00	3.08	1.36	0.95
187	86.7	9.00	15.00	32.00	-20.35	10.94	0.97
188	89.6	15.00	12.00	36.00	-4.98	6.82	0.74
189	83.3	14.00	8.00	30.00	-5.90	1.42	0.60
190	88.8	13.00	11.00	34.00	-9.04	5.50	1.07
191	83.4	14.00	10.00	30.00	-6.94	4.11	1.03
192	86.6	17.00	5.00	30.00	2.83	-2.65	1.30
193	96.3	15.00	8.00	37.00	-1.72	1.46	2.70
194	80.9	16.00	7.00	29.00	-1.36	0.03	1.31
195	90.1	11.00	13.00	33.00	-14.53	8.24	0.78
196	89.0	15.00	8.00	34.00	-2.88	1.43	1.33
197	85.8	22.00	12.00	38.00	9.98	6.67	0.89
198	95.3	11.00	9.00	28.00	-11.77	2.88	0.90
199	89.6	11.00	3.00	20.00	-9.07	-5.24	1.65
200	82.5	16.00	10.00	36.00	-2.69	4.07	0.72
201	93.7	7.00	7.00	18.00	-20.05	0.24	2.27
202	85.8	18.00	13.00	33.00	0.59	8.08	1.42
203	89.9	13.00	13.00	34.00	-10.02	8.20	0.92
204	86.0	15.00	7.00	39.00	-2.78	0.07	0.57
205	85.2	20.00	12.00	40.00	5.45	6.70	0.77
206	89.8	8.00	5.00	20.00	-16.93	-2.49	1.59
207	89.9	12.00	6.00	29.00	-8.42	-1.21	1.15
208	87.8	14.00	9.00	33.00	-5.84	2.79	0.72
209	85.3	17.00	12.00	35.00	-1.15	6.75	0.77
210	85.6	20.00	15.00	43.00	3.91	10.74	0.67

SAM NO	H#	3M CPM	14C CPM	WIDE CPM	3H DPM	14C DPM	LUMEX %
212	89.9	11.00	9.00	28.00	-12.34	2.85	1.04
213	88.4	15.00	9.00	34.00	-3.52	2.77	0.99
214	84.5	12.00	16.00	35.00	-14.41	12.21	0.88
215	95.0	9.00	11.00	33.00	-17.59	5.62	1.01
216	90.3	13.00	9.00	34.00	-7.77	2.82	1.01
217	89.1	14.00	10.00	35.00	-6.21	4.14	0.82
218	89.0	13.00	7.00	27.00	-6.82	0.12	1.11
219	90.9	16.00	16.00	41.00	-4.74	12.20	0.83
220	86.4	9.00	19.00	38.00	-22.53	16.31	1.55
221	86.5	8.00	9.00	26.00	-19.34	2.88	1.70
222	86.3	19.00	10.00	39.00	4.53	4.04	0.78
223	85.0	13.00	14.00	42.00	-11.09	9.51	0.93
224	88.2	19.00	16.00	43.00	1.60	12.12	0.76
225	87.3	13.00	7.00	29.00	-7.05	0.11	1.57
226	88.0	10.00	8.00	25.00	-14.22	1.51	1.15
227	88.2	11.00	8.00	32.00	-11.96	1.49	0.93
228	86.3	9.00	14.00	36.00	-19.83	9.59	1.20
229	86.9	14.00	16.00	41.00	-9.74	12.20	0.67
230	83.2	11.00	10.00	34.00	-13.52	4.16	0.96
231	84.6	17.00	14.00	42.00	-2.33	9.44	0.69
232	89.5	16.00	6.00	29.00	0.55	-1.28	0.87
233	90.0	12.00	9.00	26.00	-10.07	2.83	1.14
234	84.9	9.00	10.00	35.00	-17.78	4.20	1.17
235	91.7	7.00	4.00	20.00	-18.50	-3.81	2.16
236	86.3	19.00	11.00	36.00	3.97	5.38	0.82
237	89.0	18.00	16.00	41.00	-0.51	12.15	0.64
238	87.3	17.00	6.00	34.00	2.41	-1.31	0.69
239	82.7	18.00	11.00	37.00	1.16	5.38	0.74
240	87.4	15.00	8.00	35.00	-3.12	1.42	1.03
241	101.6	19.00	15.00	38.00	4.68	10.90	1.83
242	87.3	17.00	10.00	38.00	0.24	4.08	1.41
243	92.3	14.00	15.00	38.00	-8.57	10.91	1.00
244	90.4	18.00	11.00	36.00	2.48	5.42	0.97
245	87.0	11.00	12.00	30.00	-14.25	6.87	1.08
246	91.7	18.00	6.00	29.00	5.51	-1.31	1.01
247	83.0	12.00	11.00	31.00	-11.89	5.48	1.91
248	91.0	15.00	15.00	38.00	-6.45	10.88	0.89
249	92.3	12.00	10.00	33.00	-10.36	4.19	1.16
250	105.8	13.00	14.00	39.00	-8.65	9.70	1.50
251	92.4	15.00	16.00	40.00	-6.83	12.24	0.58
252	94.7	13.00	5.00	30.00	-4.92	-2.56	1.36
253	95.5	20.00	7.00	33.00	10.38	0.01	0.76
254	112.7	15.00	10.00	32.00	0.02	4.26	5.33
255	97.3	11.00	8.00	32.00	-10.98	1.54	1.96
256	111.6	18.00	19.00	48.00	1.80	16.48	1.58
257	92.4	17.00	11.00	34.00	0.56	5.45	1.40
258	112.5	9.00	13.00	25.00	-17.36	8.48	3.26
259	95.8	19.00	10.00	34.00	6.38	4.09	1.04
260	114.7	23.00	18.00	51.00	16.13	15.04	4.09
261	99.6	12.00	9.00	35.00	-8.90	2.89	1.76
262	95.4	11.00	9.00	31.00	-11.76	2.88	2.34
263	87.7	10.00	15.00	44.00	-18.06	10.93	0.48
264	85.9	6.00	6.00	20.00	-22.20	-1.12	1.78
265	94.9	19.00	10.00	39.00	6.20	4.08	1.03
266	88.7	14.00	12.00	34.00	-7.35	6.83	1.65
267	86.9	15.00	11.00	31.00	-4.82	5.45	0.71
268	85.7	17.00	12.00	37.00	-1.09	6.76	0.94
269	113.2	7.00	13.00	28.00	-22.47	8.53	3.57

SAM NO	H#	3H CPM	14C CPM	WIDE CPM	3H DPM	14C DPM	LUMEX %
270	90.1	10.00	14.00	32.00	-17.34	9.61	0.99
	97.4	17.00	8.00	28.00	3.17	1.43	1.80

ID: EQUIPMENT SURVY

7 DEC 2000 15:27

USER: 1 COMMENT: EQUIPMENT SURVEY

RESET TIME : 1.00
 DATA CALC : DL DPM H# : YES SAMPLE REPEATS: 1 PRINTER : EDIT
 COUNT BLANK : YES IC# : NO REPLICATES : 1 RS232 : EDIT
 TWO PHASE : NO AQC : YES CYCLE REPEATS : 1
 SCINTILLATOR: LIQUID LUMEX: YES LOW SAMPLE REJ: 0
 LOW LEVEL : NO HALF LIFE CORRECTION DATE: none

ISOTOPE 1: 3H %ERROR: 2.00 FACTOR: 1.0000 BKG. SUB: 0
 ISOTOPE 2: 14C %ERROR: 2.00 FACTOR: 1.0000 BKG. SUB: 0
 WIDE OPEN WINDOW %ERROR: 0.00 FACTOR: 1.0000 BKG. SUB: 0

BACKGROUND QUENCH CURVE: Off COLOR QUENCH CORRECTION: Off

Quench Limits Low: 13.688 High: 306.34

SAM NO	H#	3H CPM	14C CPM	WIDE CPM	3H DPM	14C DPM	LUMEX %	
B1	86.8	9.00	8.00	28.00	15.70	10.60	5.45	
		Blank Average	DPM	for	3H :	15.70	COEF. OF VAR:	0.000
		Blank Average	DPM	for	14C :	10.60	COEF. OF VAR:	0.000
<i>271</i>	75.5	12.00	11.00	31.00	3.97	3.91	8.51	
<i>272</i>	77.3	15.00	14.00	38.00	8.96	7.88	6.48	