

## Radiological Survey Sheet

Job Location Pfizer Central Research Grotton 118 D/D309 Page 1 of 19  
 Survey Purpose Radiological Assessment Date 12/11/00  
 Performed By Pam Jones (Print) Pam Jones (Sign)

Inst.(1) (Model/SN) <u>Beckman LS 6500</u> <u>#7069448</u>	Inst.(2) <u>Ludlum 2241-2</u> (Model/SN) <u>#163603</u>	Inst.(3) (Model/SN)
Det. <u>Internal</u> (Model/SN)	Det. <u>Ludlum 43-68</u> (Model/SN) <u>#PR149613</u>	Det. (Model/SN)
Eff. <u>See LSC Printout</u>	Eff. <u>~ 8% G14</u>	Eff.
Type rad. <u>β</u>	Type rad. <u>β</u>	Type rad.
Bkgd. <u>See LSC Printout</u>	Bkgd. <u>300 cpm</u>	Bkgd.
Cal. Due: <u>12/00</u> <u>12/01</u>	Cal. Due <u>2/13/01</u>	Cal. due

No.	Time	Location	Inst. Used	Total Activity (dpm/100 cm <sup>2</sup> )
1.	<u>9:00</u>	<u>wall</u>	1	<u>See attached LSC Printout</u>
2.		<u>"</u>	1	
3.		<u>"</u>	1	
4.		<u>"</u>	1	
5.		<u>side of hood</u>	1	
6.		<u>wall</u>	1	
7.		<u>floor</u>	1	
8.		<u>"</u>	1	
9.		<u>"</u>	1	
10.		<u>"</u>	1	
11.		<u>"</u>	1	
12.		<u>"</u>	1	
13.		<u>"</u>	1	
14.		<u>left outside hood</u>	1	
15.		<u>top</u>	1	
16.		<u>rt.</u>	1	
17.		<u>ledge</u>	1	
18.	<u>↓</u>	<u>glass + handles</u>	1	<u>↓</u>

Radiological Survey Continuation Sheet

Page 2 of 19

Date 12/11/00

No.	Time	Location	Inst. Used	Total Activity (dpm/100 cm <sup>2</sup> )
19		left inside hood	1	See attached LSC Printout
20		top back	1	
21		mid. back	1	
22		bottom back	1	
23		rt. side	1	
24		left counter	1	
25		rt. counter	1	
26		cup sink	1	
27		outside cab.	1	
28		left	1	
29		bot.	1	
30		rt.	1	
31		out. cab.	1	
32		left	1	
33		bot.	1	
34		rt.	1	
35		outside shelves	1	
36		top shelf	1	
37		shelf	1	
38		"	1	
39		bot. shelf	1	
40		out. shelves	1	
41		top shelf	1	
42		shelf	1	
43		"	1	
44		bot. shelf	1	
45		ledge	1	
46	↓	wall	1	↓

Radiological Survey Continuation Sheet

Page 3 of 19

Date 12/11/00

No.	Time	Location	Inst. Used	Total Activity (dpm/100 cm <sup>2</sup> )
47		market	1	See attached LSC Printout
48		bucket	1	
49		lead #1	1	
50		#2	1	
51		#3	1	
52		#4	1	
53		↓ #5	1	
54		tube of lead	1	
55		top shelf	1	
56		shelf	1	
57		bot. shelf	1	
58		top shelf	1	
59		shelf	1	
60		bot. shelf	1	
61		counter	1	
62		"	1	
63		"	1	
64		shelf	1	
65		desk top	1	
66		cup sink	1	
67		outside cab.	1	
68		top drawer	1	
69		top shelf	1	
70		bot. shelf	1	
71		drawer	1	
72		out. drawers	1	
73		top drawer	1	
74	↓	drawer	1	↓

Radiological Survey Continuation Sheet

Page 4 of 19

Date 12/11/00

No.	Time	Location	Inst. Used	Total Activity (dpm/100 cm <sup>2</sup> )
75		drawer	1	See attached LSC Printout
76		bot. drawer	1	
77		drawer	1	
78		out. drawers	1	
79		top drawer	1	
80		drawer	1	
81		"	1	
82		bot. drawer	1	
83		drawer	1	
84		out. drawers	1	
85		pull-out	1	
86		drawer	1	
87		"	1	
88		bot. drawer	1	
89		out. shelves	1	
90		top shelf	1	
91		shelf	1	
92		"	1	
93		bot. shelf	1	
94		out. shelves	1	
95		top shelf	1	
96		shelf	1	
97		"	1	
98		bot. shelf	1	
99		counter	1	
100		"	1	
101		"	1	
102	✓	"	1	✓

Radiological Survey Continuation Sheet

Page 5 of 19  
 Date 12/11/00

No.	Time	Location	Inst. Used	Total Activity (dpm/100 cm <sup>2</sup> )
103		Cup sink	1	See attached LSC Printout
104		sides of sink	1	
105		bottom " "	1	
106		Out. drawers	1	
107		top drawer	1	
108		drawer	1	
109		"	1	
110		bot. drawer	1	
111		drawer	1	
112		Out. drawers	1	
113		top drawer	1	
114		drawer	1	
115		"	1	
116		bot. drawer	1	
117		mt. cabinet	1	
118		left	1	
119		bottom	1	
120		rt.	1	
121		plastic tray	1	
122		floor	1	
123		"	1	
124		"	1	
125		"	1	
126		"	1	
127		"	1	
128		top shelf	1	
129		desktop	1	
130	✓	counter	1	✓

Radiological Survey Continuation Sheet

Page 6 of 19

Date 12/11/00

No.	Time	Location	Inst. Used	Total Activity (dpm/100 cm <sup>2</sup> )
131		counter	1	See attached LSC Printout
132		"	1	
133		outside drawers	1	
134		pull-out	1	
135		drawer	1	
136		"	1	
137		bot. drawer	1	
138		drawer	1	
139		"	1	
140		out. drawers	1	
141		top drawer	1	
142		drawer	1	
143		"	1	
144		bot. drawer	1	
145		out. drawer	1	
146		top drawer	1	
147		drawer	1	
148		"	1	
149		bot. drawer	1	
150		out. drawers	1	
151		top drawer	1	
152		top shelf	1	
153		bot. shelf	1	
154		int. shelves	1	
155		top shelf	1	
156		shelf	1	
157		"	1	
158	✓	bot. shelf	1	✓

Radiological Survey Continuation Sheet

Page 7 of 19  
 Date 12/11/00

No.	Time	Location	Inst. Used	Total Activity (dpm/100 cm <sup>2</sup> )
159		out. shelves	1	See attached LSC Printout
160		top shelf	1	
161		shelf	1	
162		"	1	
163		bot. shelf	1	
164		out. shelves	1	
165		top shelf	1	
166		shelf	1	
167		"	1	
168		bot. shelf	1	
169		ledge	1	
170		plastic bin	1	
171		"	1	
172		metal. (top to bottom)	1	
173		"	1	
174		"	1	
175		"	1	
176		"	1	
177		"	1	
178		"	1	
179		"	1	
180		outside cab.	1	
181		top drawer	1	
182		top shelf	1	
183		bot. shelf	1	
184		out. drawers	1	
185		top drawer	1	
186	✓	✓ drawer	1	✓

Radiological Survey Continuation Sheet

Page 8 of 19

Date 12/11/00

No.	Time	Location	Inst. Used	Total Activity (dpm/100 cm <sup>2</sup> )
187		drawer	1	See attached LSC Printout
188		bot. drawer	1	
189		drawer	1	
190		out. drawers	1	
191		top drawer	1	
192		drawer	1	
193		"	1	
194		bot. drawer	1	
195		drawer - pull out	1	
196		out. drawers	1	
197		pull out	1	
198		top drawer	1	
199		drawer	1	
200		bot. drawer	1	
201		counter	1	
202		"	1	
203		"	1	
204		cup sink	1	
205		top shelf	1	
206		shelf	1	
207		bot. shelf	1	
208		desktop	1	
209		top shelf	1	
210		shelf	1	
211		bot. shelf	1	
212		top shelf	1	
213		shelf	1	
214	✓	bot. shelf	1	✓



Radiological Survey Continuation Sheet

Page 9 of 19

Date 12/11/00

No.	Time	Location	Inst. Used	Total Activity (dpm/100 cm <sup>2</sup> )
215		Floor	1	See attached LSC Printout
216		"	1	
217		"	1	
218		"	1	
219		"	1	
220		wall	1	
221		"	1	
222		outsideshellneo	1	
223		top shelf	1	
224		shelf	1	
225		"	1	
226		bot. shelf	1	
227		top shelf	1	
228		shelf	1	
229		"	1	
230		"	1	
231		bot. shelf	1	
232		top shelf	1	
233		shelf	1	
234		bot. shelf	1	
235		desktop	1	
236		counter	1	
237		"	1	
238		"	1	
239		out-drawers	1	
240		pull-out	1	
241		drawer	1	
242	✓	"	1	↓

Radiological Survey Continuation Sheet

Page 10 of 19

Date 12/11/00

No.	Time	Location	Inst. Used	Total Activity (dpm/100 cm <sup>2</sup> )
243		bottom drawer	1	See attached LSC Printout
244		pull-out	1	
245		drawer	1	
246		out. drawers	1	
247		top drawer	1	
248		drawer	1	
249		"	1	
250		bot. drawer	1	
251		out. drawers	1	
252		top drawer	1	
253		drawer	1	
254		"	1	
255		bot. drawer	1	
256		out. drawers	1	
257		top drawer	1	
258		top shelf	1	
259		bot. shelf	1	
260		floor	1	
261		"	1	
262		"	1	
263		"	1	
264		"	1	
265		"	1	
266		"	1	
267		"	1	
268		"	1	
269		counter	1	
270	✓	"	1	✓

Radiological Survey Continuation Sheet

Page 11 of 19

Date 12/11/00

No.	Time	Location	Inst. Used	Total Activity (dpm/100 cm <sup>2</sup> )
271		counter	1	See attached LSC Printout
272		"	1	
273		out. shelves	1	
274		top shelf	1	
275		shelf	1	
276		bot. shelf	1	
277		out. shelves	1	
278		top shelf	1	
279		shelf	1	
280		bot. shelf	1	
281		out. shelves	1	
282		top shelf	1	
283		shelf	1	
284		bot. shelf	1	
285		out. drawer	1	
286		top drawer	1	
287		drawer	1	
288		"	1	
289		bot. drawer	1	
290		out. drawers	1	
291		left drawer	1	
292		rt. drawer	1	
293		top shelf	1	
294		bot. shelf	1	
295		out. drawers	1	
296		top drawer	1	
297		drawer	1	
298	✓	"	1	✓

Radiological Survey Continuation Sheet

Page 12 of 19

Date 12/11/00

No.	Time	Location	Inst. Used	Total Activity (dpm/100 cm <sup>2</sup> )
299		bot. drawer	1	See attached LSC Printout
300		out. drawers	1	
301		top drawer	1	
302		drawer	1	
303		"	1	
304		bot. drawer	1	
305		out. drawers	1	
306		top drawer	1	
307		drawer	1	
308		"	1	
309		bot. drawer	1	
310		wall	1	
311		glass	1	
312		"	1	
313		wall	1	
314		chair	1	
315		"	1	
316		"	1	
317		door	1	
318		floor	1	
319		"	1	
320		wall	1	
321	✓	"	1	
PJ 322		chair PJ	1	✓
			1	
			1	
			1	
			1	

# Bld. 118D Room D309

Page 13 of 19

Date: 12/11/00

○ = wipe location

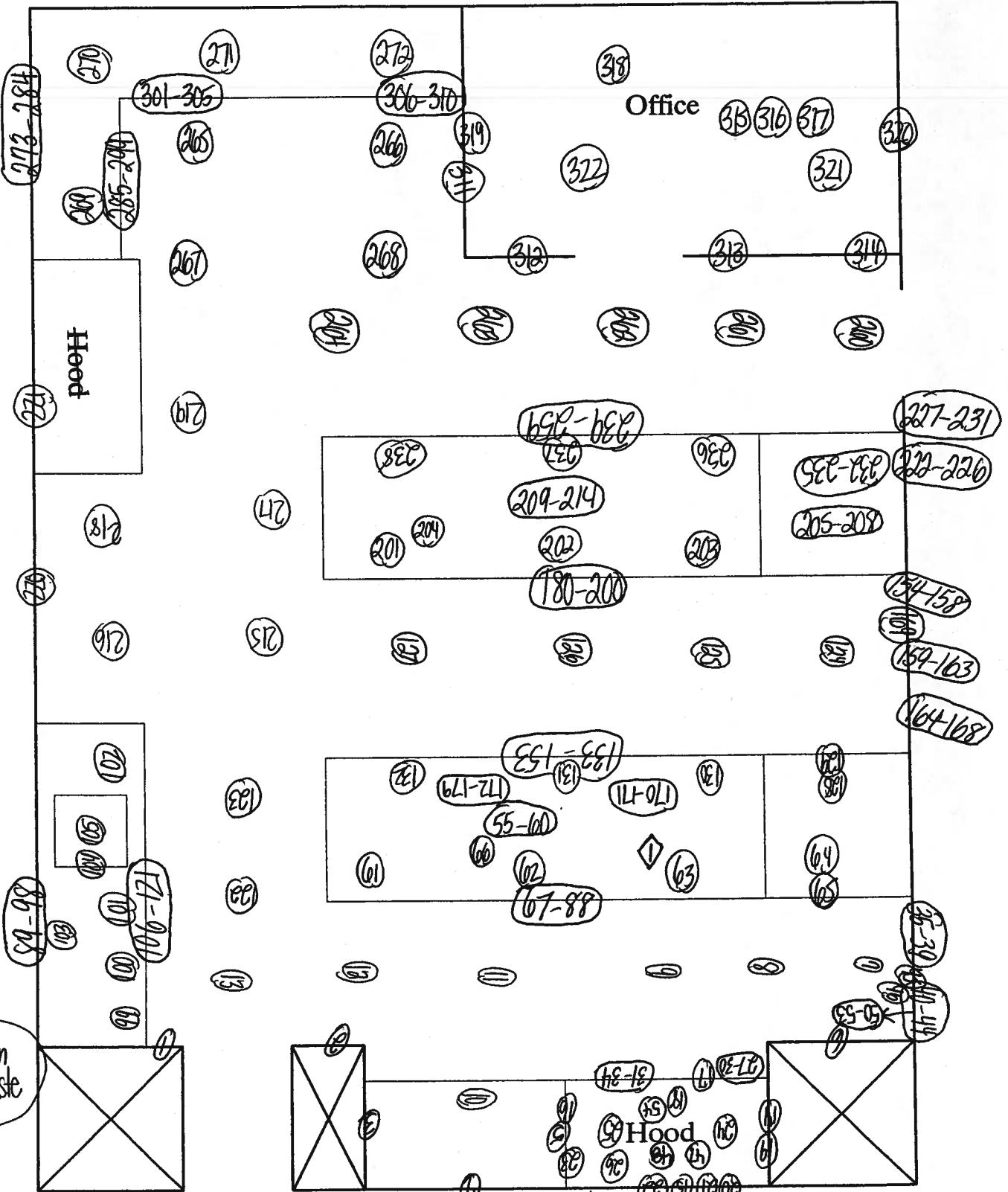

◇ - outlet 1172cpm  
spot of as rad waste

Surveyed 100% of all lower surfaces using instrument #2. All areas were noted to be at a level of normal background with the following exception: an outlet (◇)

ID: EQUIPMENT SURVY

11 DEC 2000 16:35

USER: 1 COMMENT: EQUIPMENT SURVEY

RESET TIME : 1.00  
 DATA CALC : DL DPM H# : YES SAMPLE REPEATS: 1 PRINTER : EDIT  
 COUNT BLANK : YES IC# : NO REPLICATES : 1 RS232 : EDIT  
 TWO PHASE : NO AGC : YES CYCLE REPEATS : 1  
 SCINTILLATOR: LIQUID LUMEX: YES LOW SAMPLE REJ: 0  
 LOW LEVEL : NO HALF LIFE CORRECTION DATE: 0000

ISOTOPE 1: 3H %ERROR: 2.00 FACTOR: 1.0000 BKG. SUB: 0  
 ISOTOPE 2: 14C %ERROR: 2.00 FACTOR: 1.0000 BKG. SUB: 0  
 WIDE OPEN WINDOW %ERROR: 0.00 FACTOR: 1.0000 BKG. SUB: 0

BACKGROUND QUENCH CURVE: Off COLOR QUENCH CORRECTION: Off

Quench Limits Low: 13.599 High: 306.34

SAM NO	H#	3H CPM	14C CPM	WIDE CPM	3H DPM	14C DPM	LUMEX %	
B1	167.3	12.00	16.00	39.00	30.89	22.34	1.00	
		Blank Average DPM for		3H :	30.89	COEF. OF VAR:		0.000
		Blank Average DPM for		14C :	22.34	COEF. OF VAR:		0.000
1	85.1	13.00	15.00	36.00	-10.25	-2.40	1.07	
2	83.9	16.00	10.00	37.00	-1.13	-9.18	0.70	
3	76.6	13.00	9.00	35.00	-8.00	-10.51	0.98	
4	83.0	18.00	6.00	33.00	5.22	-14.59	1.55	
5	82.0	9.00	8.00	22.00	-15.56	-11.75	2.23	
6	85.5	13.00	10.00	30.00	-7.53	-9.12	1.52	
7	83.4	11.00	4.00	25.00	-8.96	-17.15	2.22	
8	82.2	11.00	10.00	30.00	-12.25	-9.10	1.46	
9	78.7	17.00	8.00	31.00	1.30	-11.90	1.44	
10	82.5	4.00	8.00	20.00	-26.41	-11.67	2.37	
11	82.6	14.00	9.00	34.00	-5.16	-10.49	1.06	
12	79.4	15.00	7.00	29.00	-2.37	-13.21	1.61	
13	79.7	16.00	11.00	31.00	-2.26	-7.86	1.34	
14	78.4	20.00	12.00	39.00	5.60	-6.60	0.87	
15	79.0	18.00	13.00	46.00	0.90	-5.22	0.74	
16	74.5	6.00	11.00	24.00	-23.88	-7.73	1.73	
17	77.9	7.00	11.00	25.00	-21.65	-7.73	1.55	
18	81.0	18.00	9.00	31.00	3.29	-10.57	1.15	
19	81.7	11.00	7.00	30.00	-10.72	-13.13	1.56	
20	105.9	13.00	7.00	29.00	-3.00	-13.07	2.59	
21	85.5	12.00	6.00	29.00	-7.59	-14.48	2.53	
22	89.6	13.00	10.00	34.00	-7.03	-9.09	3.26	
23	82.6	10.00	9.00	36.00	-13.87	-10.43	0.77	
24	79.0	10.00	14.00	37.00	-16.74	-3.75	1.50	
25	84.6	17.00	11.00	39.00	0.64	-7.85	2.03	
26	85.4	16.00	13.00	38.00	-2.53	-5.14	1.03	
27	85.0	11.00	12.00	32.00	-13.06	-6.40	1.71	
28	79.0	18.00	14.00	41.00	-6.04	-7.93	1.41	
29	87.3	17.00	12.00	37.00	0.52	-6.49	1.24	
30	86.3	17.00	12.00	37.00	7.34	-10.61	0.89	
31	81.1	12.00	8.00	37.00	-9.13	-11.81	0.99	
32	80.6	17.00	8.00	32.00	1.59	-11.90	2.29	
33	87.9	10.00	14.00	32.00	-16.14	-3.67	2.13	
34	77.2	15.00	4.00	35.00	-1.12	-17.23	1.81	
35	77.1	16.00	9.00	32.00	-1.57	-10.56	0.80	
36	80.1	14.00	8.00	32.00	-4.94	-11.85	1.23	

SAM NO	H#	3H CPM	14C CPM	WIDE CPM	3H DPM	14C DPM	LUMEX %
38	80.2	9.00	8.00	26.00	-15.69	-11.76	1.67
39	80.6	6.00	5.00	22.00	-20.56	-15.73	1.53
40	79.8	11.00	6.00	29.00	-10.39	-14.48	1.42
41	76.6	14.00	7.00	33.00	-4.86	-13.20	1.10
42	79.7	21.00	13.00	48.00	7.44	-5.27	0.52
43	83.2	17.00	11.00	34.00	0.42	-7.86	1.97
44	77.8	15.00	11.00	41.00	-4.64	-7.86	1.60
45	78.8	21.00	9.00	45.00	9.35	-10.63	1.12
46	87.2	13.00	5.00	26.00	-4.61	-15.84	2.32
47	80.2	10.00	10.00	33.00	-14.58	-9.10	0.86
48	77.1	8.00	14.00	33.00	-21.10	-3.73	1.19
49	82.6	10.00	8.00	25.00	-13.33	-11.77	1.51
50	77.5	18.00	10.00	38.00	2.21	-9.25	0.65
51	85.8	16.00	7.00	27.00	0.76	-13.20	1.94
52	79.7	19.00	11.00	40.00	4.19	-7.91	0.89
53	79.5	15.00	5.00	31.00	-1.32	-15.89	1.38
54	82.0	26.00	14.00	51.00	18.20	-3.99	1.43
55	82.6	14.00	7.00	26.00	-4.09	-13.18	1.55
56	93.8	12.00	7.00	24.00	-7.13	-13.10	2.65
57	83.9	10.00	12.00	27.00	-15.35	-6.39	1.41
58	86.7	10.00	8.00	23.00	-12.98	-11.75	1.36
59	94.3	12.00	5.00	35.00	-5.94	-15.80	1.88
60	84.6	10.00	11.00	35.00	-14.76	-7.73	0.95
61	97.8	15.00	11.00	32.00	-1.84	-7.73	2.43
62	78.2	12.00	11.00	33.00	-10.98	-7.81	1.00
63	86.4	14.00	7.00	32.00	-3.58	-13.16	0.96
64	85.2	19.00	14.00	41.00	3.54	-3.85	0.81
65	80.0	15.00	11.00	34.00	-4.36	-7.84	0.84
66	80.3	15.00	10.00	34.00	-3.80	-9.18	0.86
67	89.5	17.00	13.00	44.00	0.32	-5.12	2.18
68	79.9	23.00	15.00	48.00	10.73	-2.62	0.66
69	82.1	14.00	13.00	38.00	-7.32	-5.13	0.93
70	82.8	12.00	11.00	30.00	-10.54	-7.78	0.96
71	83.2	10.00	8.00	29.00	-13.28	-11.77	1.06
72	87.6	14.00	4.00	25.00	-1.78	-17.20	2.06
73	82.8	12.00	6.00	26.00	-7.90	-14.49	1.31
74	83.6	19.00	11.00	36.00	4.86	-7.89	1.14
75	77.6	13.00	6.00	37.00	-6.34	-14.52	0.62
76	75.6	19.00	7.00	38.00	5.54	-13.29	0.84
77	82.9	12.00	6.00	29.00	-7.89	-14.49	1.11
78	80.5	11.00	15.00	33.00	-15.01	-2.41	0.97
79	77.2	12.00	12.00	29.00	-11.58	-6.47	1.45
80	77.9	19.00	10.00	40.00	4.40	-9.26	0.90
81	75.9	16.00	14.00	42.00	-4.28	-3.88	0.62
82	79.2	14.00	10.00	31.00	-6.09	-9.17	1.48
83	79.0	12.00	11.00	36.00	-10.91	-7.80	0.82
84	81.9	14.00	12.00	38.00	-6.82	-6.47	1.06
85	80.0	9.00	9.00	32.00	-16.22	-10.42	1.08
86	78.1	11.00	9.00	26.00	-12.09	-10.47	1.34
87	79.2	19.00	8.00	39.00	5.66	-11.94	1.24
88	77.4	12.00	10.00	33.00	-10.54	-9.15	1.39
89	84.9	11.00	9.00	29.00	-11.47	-10.43	1.28
90	79.5	8.00	8.00	28.00	-17.89	-11.75	1.24
91	88.0	18.00	12.00	40.00	2.88	-6.50	1.91
92	84.4	14.00	11.00	36.00	-5.99	-7.80	1.36
93	84.4	13.00	12.00	35.00	-8.72	-6.44	1.34
94	84.8	12.00	9.00	38.00	-9.28	-10.45	0.64
95	91.0	21.00	21.00	53.00	5.22	5.60	1.20

SAM NO	H#	3H CPM	14C CPM	WIDE CPM	3H DPM	14C DPM	LUMEX %
95	92.0	17.00	12.00	34.00	1.30	-6.45	1.36
96	88.4	12.00	10.00	30.00	-9.43	-9.08	1.44
97	79.8	17.00	10.00	36.00	0.43	-9.22	2.92
98	86.1	11.00	8.00	26.00	-10.82	-11.77	2.53
99	93.0	15.00	12.00	38.00	-3.14	-6.41	1.13
100	93.8	16.00	7.00	31.00	2.11	-13.17	1.41
101	91.0	10.00	8.00	32.00	-12.58	-11.73	1.65
102	86.9	16.00	6.00	28.00	1.48	-14.54	0.74
103	85.7	19.00	10.00	37.00	5.78	-9.22	3.40
104	83.7	5.00	13.00	28.00	-26.85	-4.96	0.79
105	92.9	13.00	9.00	28.00	-6.06	-10.42	10.02
106	85.5	13.00	4.00	25.00	-4.31	-17.18	1.76
107	86.2	13.00	17.00	36.00	-11.22	0.30	3.89
108	85.9	14.00	11.00	35.00	-5.81	-7.79	1.04
109	80.2	14.00	13.00	36.00	-7.53	-5.15	0.78
110	84.1	12.00	6.00	28.00	-7.75	-14.48	1.18
111	83.1	10.00	7.00	26.00	-12.76	-13.11	1.23
112	83.0	12.00	11.00	32.00	-10.52	-7.77	1.27
113	95.6	9.00	7.00	27.00	-13.90	-13.04	4.03
114	90.0	17.00	12.00	37.00	0.96	-6.47	0.95
115	88.4	11.00	15.00	33.00	-14.40	-2.33	1.08
116	85.5	9.00	6.00	26.00	-14.22	-14.43	2.00
117	85.2	8.00	6.00	21.00	-16.45	-14.41	1.11
118	80.5	11.00	10.00	30.00	-12.40	-9.11	1.04
119	90.5	10.00	11.00	31.00	-14.28	-7.69	1.25
120	79.7	10.00	13.00	31.00	-16.17	-5.08	0.78
121	91.1	19.00	6.00	37.00	9.02	-14.59	1.02
122	86.7	17.00	15.00	41.00	-1.20	-2.46	0.71
123	79.7	13.00	10.00	39.00	-8.18	-9.15	0.71
124	87.2	9.00	10.00	29.00	-16.25	-9.04	1.35
125	86.4	7.00	9.00	22.00	-20.21	-10.35	1.78
126	89.3	18.00	7.00	33.00	5.84	-13.22	1.27
127	84.8	8.00	16.00	32.00	-21.83	-0.97	1.36
128	87.3	12.00	12.00	35.00	-10.63	-6.40	1.11
129	89.6	12.00	9.00	28.00	-8.75	-10.42	1.94
130	85.4	25.00	26.00	69.00	10.38	12.18	0.58
131	89.1	16.00	8.00	38.00	0.76	-11.84	1.46
132	87.1	9.00	15.00	34.00	-18.97	-2.31	1.32
133	79.1	19.00	13.00	44.00	3.04	-5.24	0.62
134	85.6	16.00	8.00	38.00	0.19	-11.86	1.30
135	84.7	13.00	13.00	35.00	-9.22	-5.09	1.01
136	85.0	15.00	13.00	40.00	-4.78	-5.12	1.96
137	88.4	17.00	11.00	36.00	1.25	-7.82	2.27
138	84.7	18.00	9.00	37.00	3.92	-10.55	0.92
139	85.6	13.00	10.00	35.00	-7.52	-9.12	1.41
140	80.3	12.00	10.00	31.00	-10.26	-9.13	0.84
141	91.0	14.00	12.00	35.00	-5.70	-6.41	1.49
142	143.3	8.00	15.00	35.00	-17.37	-1.63	0.83
143	81.0	13.00	4.00	26.00	-4.89	-17.19	0.67
144	84.7	13.00	6.00	25.00	-5.48	-14.50	0.98
145	82.9	19.00	4.00	32.00	8.44	-17.29	0.67
146	76.9	21.00	15.00	50.00	5.92	-2.61	0.42
147	83.4	15.00	6.00	38.00	-1.27	-14.54	0.69
148	87.0	17.00	13.00	40.00	-0.07	-5.14	0.88
149	82.1	14.00	12.00	33.00	-6.79	-6.47	0.81
150	83.7	11.00	9.00	32.00	-11.58	-10.44	1.09
151	81.8	12.00	6.00	26.00	-8.02	-14.49	1.02
152	86.7	9.00	10.00	30.00	-16.28	-9.04	0.94



SAM NO	H#	3H CPM	14C CPM	WIDE CPM	3H DPM	14C DPM	LUMEX %
153	86.0	13.00	11.00	36.00	-8.00	-7.77	0.70
154	78.3	12.00	3.00	29.00	-6.85	-18.52	0.72
155	82.2	16.00	8.00	35.00	-0.33	-11.87	0.73
156	82.7	19.00	9.00	39.00	5.76	-10.58	0.50
157	83.9	21.00	13.00	45.00	8.23	-5.24	1.01
158	81.5	13.00	2.00	28.00	-3.78	-19.87	3.21
159	83.1	15.00	6.00	28.00	-1.31	-14.54	0.64
160	86.3	20.00	8.00	37.00	9.18	-11.92	0.68
161	83.7	22.00	8.00	36.00	13.03	-11.97	0.64
162	87.3	12.00	7.00	30.00	-7.92	-13.13	0.65
163	83.0	15.00	5.00	24.00	-0.81	-15.88	1.60
164	81.2	17.00	5.00	26.00	3.26	-15.92	0.82
165	88.4	12.00	8.00	26.00	-8.34	-11.78	0.99
166	90.8	19.00	16.00	49.00	3.42	-1.10	0.70
167	91.8	14.00	10.00	34.00	-4.48	-9.10	1.00
168	90.9	18.00	3.00	32.00	8.37	-18.61	1.42
169	84.4	13.00	14.00	37.00	-9.79	-3.75	0.76
170	102.0	20.00	12.00	44.00	10.35	-6.44	3.14
171	82.9	21.00	4.00	34.00	12.81	-17.32	0.70
172	82.1	10.00	10.00	34.00	-14.43	-9.09	0.83
173	83.9	7.00	6.00	21.00	-18.74	-14.40	1.13
174	81.3	14.00	10.00	28.00	-5.84	-9.16	0.69
175	87.0	13.00	11.00	34.00	-7.89	-7.76	0.82
176	83.1	16.00	11.00	36.00	-1.78	-7.84	0.67
177	84.4	23.00	9.00	41.00	14.87	-10.64	0.75
178	83.2	10.00	9.00	28.00	-13.81	-10.42	0.92
179	83.1	13.00	9.00	33.00	-7.27	-10.48	1.07
180	87.4	11.00	14.00	33.00	-13.94	-3.69	0.99
181	90.9	13.00	12.00	31.00	-7.99	-6.39	1.00
182	82.9	16.00	5.00	28.00	1.37	-15.90	1.09
183	84.2	13.00	5.00	27.00	-5.01	-15.84	0.82
184	87.9	15.00	12.00	42.00	-3.86	-6.45	0.74
185	88.7	14.00	10.00	34.00	-4.90	-9.12	1.20
186	80.5	14.00	15.00	36.00	-8.54	-2.46	0.86
187	85.2	11.00	9.00	33.00	-11.44	-10.43	0.95
188	88.4	12.00	10.00	29.00	-9.43	-9.08	1.39
189	93.1	11.00	9.00	25.00	-10.64	-10.39	1.07
190	83.7	19.00	11.00	40.00	4.87	-7.89	0.51
191	79.8	13.00	11.00	36.00	-8.69	-7.81	0.39
192	84.4	19.00	9.00	37.00	6.07	-10.57	0.52
193	84.5	17.00	5.00	31.00	3.83	-15.91	1.17
194	81.3	25.00	11.00	45.00	17.45	-8.00	0.61
195	85.3	12.00	15.00	43.00	-12.44	-2.38	0.50
196	79.7	14.00	10.00	39.00	-6.03	-9.17	0.37
197	82.6	10.00	8.00	32.00	-13.34	-11.77	1.00
198	84.7	18.00	13.00	44.00	1.79	-5.18	0.60
199	86.2	10.00	13.00	33.00	-15.72	-5.03	0.82
200	87.2	11.00	14.00	34.00	-13.96	-3.69	1.07
201	90.5	13.00	10.00	29.00	-6.92	-9.09	3.28
202	88.2	14.00	12.00	36.00	-6.06	-6.43	1.38
203	92.8	14.00	15.00	38.00	-7.15	-2.34	1.70
204	96.2	14.00	10.00	33.00	-3.87	-9.07	2.47
205	111.1	23.00	9.00	40.00	22.12	-10.53	3.30
206	92.3	14.00	13.00	39.00	-6.09	-5.05	1.20
207	96.5	9.00	6.00	24.00	-13.24	-14.39	5.75
208	88.4	8.00	17.00	30.00	-22.23	0.41	1.25
209	105.0	6.00	6.00	23.00	-19.77	-14.30	4.16
210	96.2	14.00	9.00	34.00	-3.29	-10.42	1.85

SAM NO	H#	3H CPM	14C CPM	WIDE CPM	3H DPM	14C DPM	LUMEX %
212	92.9	15.00	12.00	40.00	-3.15	-6.41	1.24
213	91.4	9.00	15.00	28.00	-18.72	-2.27	1.21
214	110.5	18.00	12.00	35.00	7.34	-6.34	3.73
215	88.0	18.00	10.00	40.00	3.96	-9.19	2.20
216	85.3	15.00	10.00	30.00	-3.14	-9.15	0.69
217	98.3	13.00	13.00	36.00	-7.66	-4.98	2.25
218	89.9	15.00	14.00	36.00	-4.68	-3.74	2.05
219	97.0	16.00	10.00	33.00	0.96	-9.10	1.28
220	87.6	18.00	7.00	33.00	5.53	-13.23	0.91
221	87.9	9.00	10.00	28.00	-16.19	-9.03	1.05
222	85.0	12.00	12.00	31.00	-10.86	-6.42	1.48
223	82.8	10.00	12.00	30.00	-15.43	-6.40	1.05
224	90.0	11.00	12.00	30.00	-12.62	-6.36	1.00
225	84.8	18.00	14.00	42.00	1.27	-3.83	0.65
226	85.4	16.00	6.00	33.00	1.23	-14.55	0.91
227	90.9	15.00	12.00	37.00	-3.44	-6.42	1.54
228	88.2	15.00	12.00	35.00	-3.82	-6.44	1.24
229	85.7	16.00	3.00	32.00	2.90	-18.58	1.32
230	88.6	16.00	13.00	40.00	-2.05	-5.11	0.60
231	86.7	12.00	13.00	30.00	-11.23	-5.06	0.91
232	85.1	11.00	13.00	38.00	-13.59	-5.05	0.71
233	94.9	11.00	15.00	34.00	-13.86	-2.27	1.15
234	95.5	9.00	14.00	31.00	-17.90	-3.58	1.62
235	89.9	12.00	20.00	47.00	-14.77	4.40	1.22
236	86.8	17.00	14.00	40.00	-0.64	-3.80	0.68
237	88.6	7.00	7.00	26.00	-19.00	-13.03	1.01
238	100.1	14.00	10.00	37.00	-3.28	-9.05	2.00
239	89.3	13.00	15.00	38.00	-9.82	-2.36	1.10
240	86.0	11.00	9.00	26.00	-11.36	-10.42	0.99
241	86.8	13.00	5.00	36.00	-4.67	-15.84	0.69
242	88.0	12.00	13.00	37.00	-11.10	-5.05	0.71
243	90.3	13.00	9.00	29.00	-6.40	-10.44	1.19
244	86.0	14.00	7.00	32.00	-3.63	-13.17	0.94
245	93.7	13.00	7.00	27.00	-4.83	-13.12	1.58
246	85.1	23.00	9.00	42.00	15.02	-10.64	0.61
247	84.7	13.00	8.00	32.00	-6.55	-11.81	1.20
248	85.1	20.00	7.00	36.00	9.48	-13.27	0.65
249	89.3	13.00	9.00	34.00	-6.52	-10.44	1.23
250	88.9	15.00	9.00	36.00	-2.07	-10.48	0.91
251	85.1	10.00	13.00	34.00	-15.80	-5.04	0.81
252	87.8	15.00	16.00	39.00	-6.05	-1.06	0.67
253	89.6	6.00	11.00	30.00	-23.40	-7.62	0.89
254	90.1	17.00	11.00	42.00	1.53	-7.81	0.85
255	89.0	11.00	15.00	34.00	-14.35	-2.33	0.99
256	87.8	13.00	9.00	33.00	-6.71	-10.45	0.95
257	86.5	13.00	17.00	36.00	-11.19	0.30	0.66
258	86.4	19.00	5.00	36.00	8.60	-15.94	0.90
259	89.8	18.00	10.00	38.00	4.29	-9.18	0.74
260	90.6	13.00	10.00	35.00	-6.92	-9.09	0.82
261	100.8	14.00	14.00	39.00	-5.52	-3.62	1.29
262	90.8	19.00	18.00	46.00	2.32	1.59	0.84
263	101.2	15.00	9.00	35.00	-0.11	-10.42	5.05
264	94.5	16.00	14.00	37.00	-1.73	-3.71	2.64
265	91.3	11.00	6.00	26.00	-9.17	-14.44	1.44
266	86.7	14.00	7.00	30.00	-3.54	-13.16	1.52
267	91.4	11.00	6.00	24.00	-9.15	-14.44	1.04
268	91.0	11.00	18.00	41.00	-15.85	1.74	0.68
269	93.0	8.00	11.00	31.00	-18.67	-7.63	2.13

SAM NO	H#	3H CPM	14C CPM	WIDE CPM	3H DPM	14C DPM	LUMEX %
270	104.8	15.00	8.00	27.00	1.14	-11.76	5.19
271	112.1	12.00	17.00	40.00	-10.87	0.62	2.80
272	120.1	7.00	15.00	29.00	-22.03	-1.91	11.89
273	95.4	13.00	9.00	33.00	-5.74	-10.41	1.41
274	89.4	14.00	8.00	34.00	-3.70	-11.81	0.95
275	88.0	10.00	5.00	25.00	-11.23	-15.78	0.91
276	93.8	7.00	10.00	25.00	-20.37	-8.96	1.04
277	83.9	22.00	8.00	38.00	13.08	-11.97	0.84
278	86.5	12.00	12.00	33.00	-10.71	-6.40	0.78
279	87.9	14.00	11.00	34.00	-5.55	-7.77	0.75
280	90.2	22.00	9.00	40.00	13.97	-10.60	0.66
281	92.3	15.00	8.00	30.00	-1.00	-11.81	1.02
282	88.3	17.00	10.00	38.00	1.77	-9.17	0.85
283	85.4	15.00	9.00	34.00	-2.59	-10.50	0.70
284	85.1	8.00	9.00	23.00	-18.07	-10.38	1.63
285	88.8	9.00	10.00	27.00	-16.13	-9.03	0.90
286	86.0	16.00	10.00	35.00	-0.81	-9.17	0.74
287	88.4	13.00	5.00	25.00	-4.45	-15.83	0.87
288	88.4	11.00	6.00	27.00	-9.49	-14.45	0.91
289	89.1	8.00	7.00	24.00	-16.72	-13.05	1.78
290	86.7	12.00	16.00	36.00	-12.86	-1.02	0.64
291	82.0	9.00	11.00	26.00	-17.13	-7.73	1.25
292	89.9	8.00	8.00	31.00	-17.21	-11.70	0.66
293	93.2	7.00	6.00	23.00	-18.15	-14.36	1.29
294	87.3	8.00	7.00	25.00	-16.84	-13.06	1.17
295	93.9	14.00	13.00	41.00	-5.88	-5.03	0.74
296	87.4	7.00	13.00	27.00	-22.33	-4.96	1.48
297	91.7	17.00	7.00	32.00	4.02	-13.20	0.88
298	90.1	12.00	8.00	27.00	-8.13	-11.77	1.47
299	91.9	14.00	13.00	31.00	-6.14	-5.05	1.29
300	97.4	10.00	9.00	27.00	-12.53	-10.34	3.17
301	88.2	17.00	8.00	36.00	2.85	-11.86	0.88
302	89.6	16.00	8.00	33.00	0.84	-11.84	0.82
303	88.3	15.00	12.00	35.00	-3.80	-6.44	0.97
304	87.2	17.00	7.00	31.00	3.23	-13.21	0.86
305	90.8	9.00	8.00	31.00	-14.87	-11.71	1.32
306	86.0	13.00	7.00	27.00	-5.86	-13.15	1.54
307	90.0	8.00	14.00	32.00	-20.51	-3.61	1.33
308	89.1	14.00	13.00	40.00	-6.49	-5.07	0.85
309	87.4	22.00	4.00	36.00	16.05	-17.34	1.22
310	93.4	13.00	12.00	33.00	-7.68	-6.37	1.81
311	87.3	15.00	7.00	33.00	-1.23	-13.18	0.89
312	91.7	9.00	13.00	35.00	-17.59	-4.96	0.84
313	89.7	13.00	6.00	32.00	-4.83	-14.48	1.22
314	88.6	11.00	15.00	38.00	-14.38	-2.33	0.92
315	88.8	14.00	7.00	30.00	-3.24	-13.16	0.92
316	85.4	16.00	8.00	34.00	0.17	-11.86	0.90
317	87.6	11.00	8.00	30.00	-10.66	-11.76	1.46
318	85.1	14.00	12.00	37.00	-6.44	-6.45	0.77
319	87.7	12.00	15.00	38.00	-12.22	-2.36	1.37
320	93.5	13.00	10.00	32.00	-6.55	-9.07	1.59
321	91.5	12.00	12.00	30.00	-10.19	-6.37	1.62
321	95.6	15.00	9.00	35.00	-1.04	-10.45	0.95