

Radiological Survey Sheet

Job Location Pfizer Central Research Grafton 118D/D305 Page 1 of 16
 Survey Purpose Radiological Assessment Date 1/10/01
 Performed By Pam Jones (Print) Pam Jones (Sign)

Inst.(1) (Model/SN) <u>Beckman LS 6500</u> <u>#7069448</u>	Inst.(2) <u>Ludlum # 2241-2</u> (Model/SN) <u>#137751</u>	Inst.(3) (Model/SN)
Det. <u>Internal</u> (Model/SN)	Det. <u>Ludlum 43-68</u> (Model/SN) <u>#PR140899</u>	Det. (Model/SN)
Eff. <u>See LSC Printout</u>	Eff. <u>89 CH4</u>	Eff.
Type rad. <u>β</u>	Type rad. <u>β</u>	Type rad.
Bkgd. <u>See LSC Printout</u>	Bkgd. <u>300 cpm</u>	Bkgd.
Cal. Due: <u>12/00 12/01</u>	Cal. Due <u>4/28/01</u>	Cal. due

No.	Time	Location	Inst. Used	Total Activity (dpm/100 cm ²)
1.	8:00	door	1	See attached LSC Printout
2.		wall	1	
3.		"	1	
4.		"	1	
5.		"	1	
6.		"	1	
7.		"	1	
8.		ledge	1	
9.		Floor	1	
10.		"	1	
11.		"	1	
12.		"	1	
13.		"	1	
14.		"	1	
15.		"	1	
16.		top shelf	1	
17.		shelf	1	
18.	✓	bottom shelf	1	

• Radiological Survey Continuation Sheet

Page 2 of 16

Date 1/10/01

No.	Time	Location	Inst. Used	Total Activity (dpm/100 cm ²)
19		cabinet	1	See attached LSC Printout
20		outside shelves	1	
21		top shelf	1	
22		shelf	1	
23		"	1	
24		bot. shelf	1	
25		out. shelves	1	
26		top shelf	1	
27		shelf	1	
28		"	1	
29		bot. shelf	1	
30		top shelf	1	
31		shelf	1	
32		bot. shelf	1	
33		top shelf	1	
34		shelf	1	
35		bot. shelf	1	
36		counter	1	
37		"	1	
38		shelf	1	
39		desktop	1	
40		out. drawers	1	
41		top drawer	1	
42		top shelf	1	
43		bot. shelf	1	
44		out. drawers	1	
45		top drawer	1	
46	✓	drawer	1	✓

Radiological Survey Continuation Sheet

Page 3 of 16

Date 1/10/01

No.	Time	Location	Inst. Used	Total Activity (dpm/100 cm ²)
47		drawer	1	See attached LSC Printout
48		bot. drawer	1	
49		out. drawers	1	
50		top drawer	1	
51		drawer	1	
52		bot. drawer	1	
53		drawer	1	
54		out. drawers	1	
55		top drawer	1	
56		drawer	1	
57		bot. drawer	1	
58		drawer	1	
59		out. drawers	1	
60		pull-out	1	
61		drawer	1	
62		"	1	
63		bot. drawer	1	
64		Floor	1	
65		"	1	
66		"	1	
67		"	1	
68		"	1	
69		top shelf	1	
70		shelf	1	
71		bot. shelf	1	
72		wall	1	
73		"	1	
74	✓	counter	1	✓

Radiological Survey Continuation Sheet

Page 4 of 16
Date 1/10/00

No.	Time	Location	Inst. Used	Total Activity (dpm/100 cm ²)
75		counter	1	See attached LSC Printout
76		sides of sink	1	
77		bottom " "	1	
78		out-drawers	1	
79		top drawer	1	
80		drawer	1	
81		"	1	
82		bot. drawer	1	
83		out. cabinet	1	
84		left	1	
85		bottom	1	
86		right	1	
87		wall	1	
88		"	1	
89		"	1	
90		table counter	1	
91		"	1	
92		metal shelves	1	
93		out. shelves	1	
94		top shelf	1	
95		shelf	1	
96		"	1	
97		bot. shelf	1	
98		out. shelves	1	
99		top shelf	1	
100		shelf	1	
101		"	1	
102	✓	bot. shelf	1	✓

Radiological Survey Continuation Sheet

Page 5 of 16
 Date 1/10/00

No.	Time	Location	Inst. Used	Total Activity (dpm/100 cm ²)
103		mt. shelves	1	See attached LSC Printout
104		top shelf	1	
105		shelf	1	
106		"	1	
107		bot. shelf	1	
108		ledge	1	
109		shelf	1	
110		desktop	1	
111		counter	1	
112		"	1	
113		metal bin	1	
114		"	1	
115		out-drawers	1	
116		pull-out	1	
117		drawer	1	
118		"	1	
119		bot. drawer	1	
120		drawer	1	
121		out-drawers	1	
122		top drawer	1	
123		drawer	1	
124		bot. drawer	1	
125		drawer	1	
126		out-drawers	1	
127		top drawer	1	
128		drawer	1	
129		bot. drawer	1	
130	✓	out-drawers	1	✓

Radiological Survey Continuation Sheet

Page 6 of 16
 Date 1/10/01

No.	Time	Location	Inst. Used	Total Activity (dpm/100 cm ²)
131		top drawer	1	See attached LSC Printout
132		drawer	1	
133		"	1	
134		bot. drawer	1	
135		out. cabinet	1	
136		top drawer	1	
137		top shelf	1	
138		bot. shelf	1	
139		floor	1	
140		"	1	
141		"	1	
142		"	1	
143		"	1	
144		top shelf	1	
145		shelf	1	
146		bot. shelf	1	
147		top shelf	1	
148		shelf	1	
149		bot. shelf	1	
150		counter	1	
151		"	1	
152		shelf	1	
153		desktop	1	
154		out. cabinet	1	
155		top drawer	1	
156		top shelf	1	
157		bot. shelf	1	
158	✓	out. drawers	1	✓

Radiological Survey Continuation Sheet

Page 7 of 16

Date 1/10/01

No.	Time	Location	Inst. Used	Total Activity (dpm/100 cm ²)
159		TOP DRAWER	1	See attached LSC Printout
160		DRAWER	1	
161		"	1	
162		BOTTOM DRAWER	1	
163		OUT. DRAWERS	1	
164		TOP DRAWER	1	
165		DRAWER	1	
166		bot. drawer	1	
167		drawer	1	
168		out. drawers	1	
169		TOP DRAWER	1	
170		drawer	1	
171		bot. drawer	1	
172		drawer	1	
173		out. drawers	1	
174		pull-out	1	
175		drawer	1	
176		"	1	
177		bot. drawer	1	
178		FLOOR	1	
179		"	1	
180		"	1	
181		"	1	
182		"	1	
183		"	1	
184		Shelf	1	
185		"	1	
186	✓	wall	1	✓

Radiological Survey Continuation Sheet

Page 8 of 16

Date 1/10/11

No.	Time	Location	Inst. Used	Total Activity (dpm/100 cm ²)
187		counter		
188		"	1	See attached LSC Printout
189		out. drawer	1	
190		top drawer	1	
191		drawer	1	
192		"	1	
193		bottom drawer	1	
194		drawer	1	
195		out. drawers	1	
196		top drawer	1	
197		drawer	1	
198		"	1	
199		bot. drawer	1	
200		wall	1	
201		"	1	
202		roll desk	1	
203		wall	1	
204		table	1	
205		glass	1	
206		"	1	
207		wall	1	
208		wall	1	
209		ledge	1	
210		wall	1	
211		floor	1	
212		"	1	
213		outside shelves	1	
214	✓	top shelf	1	↓

Radiological Survey Continuation Sheet

Page 9 of 16
 Date 1/10/01

No.	Time	Location	Inst. Used	Total Activity (dpm/100 cm ²)
215		shelf	1	See attached LSC Printout
216		"	1	
217		bot. shelf	1	
218		shelf	1	
219		desktop	1	
220		counter	1	
221		"	1	
222		out. drawers	1	
223		pull-out	1	
224		drawer	1	
225		"	1	
226		bot. drawer	1	
227		drawer	1	
228		out. drawers	1	
229		top drawer	1	
230		drawer	1	
231		bot. drawer	1	
232		drawer	1	
233		out. drawers	1	
234		top drawer	1	
235		drawer	1	
236		bot. drawer	1	
237		out. drawers	1	
238		top drawer	1	
239		drawer	1	
240		"	1	
241		bot. drawer	1	
242	✓	out. cabinet	1	✓

Radiological Survey Continuation Sheet

Page 10 of 16
 Date 1/10/01

No.	Time	Location	Inst. Used	Total Activity (dpm/100 cm ²)
243		top drawer	1	See attached LSC Printout
244		left	1	
245		bottom	1	↓
246	↓	right	1	
247			1	
248			1	
249			1	
250			1	
251			1	
252			1	
253			1	
254			1	
255			1	
256			1	
257			1	
258			1	
259			1	
260			1	
261			1	
262			1	
263			1	
264			1	
265			1	
266			1	
267			1	
268			1	
269			1	
270			1	

○ = w.i.p.c LOCATIONS

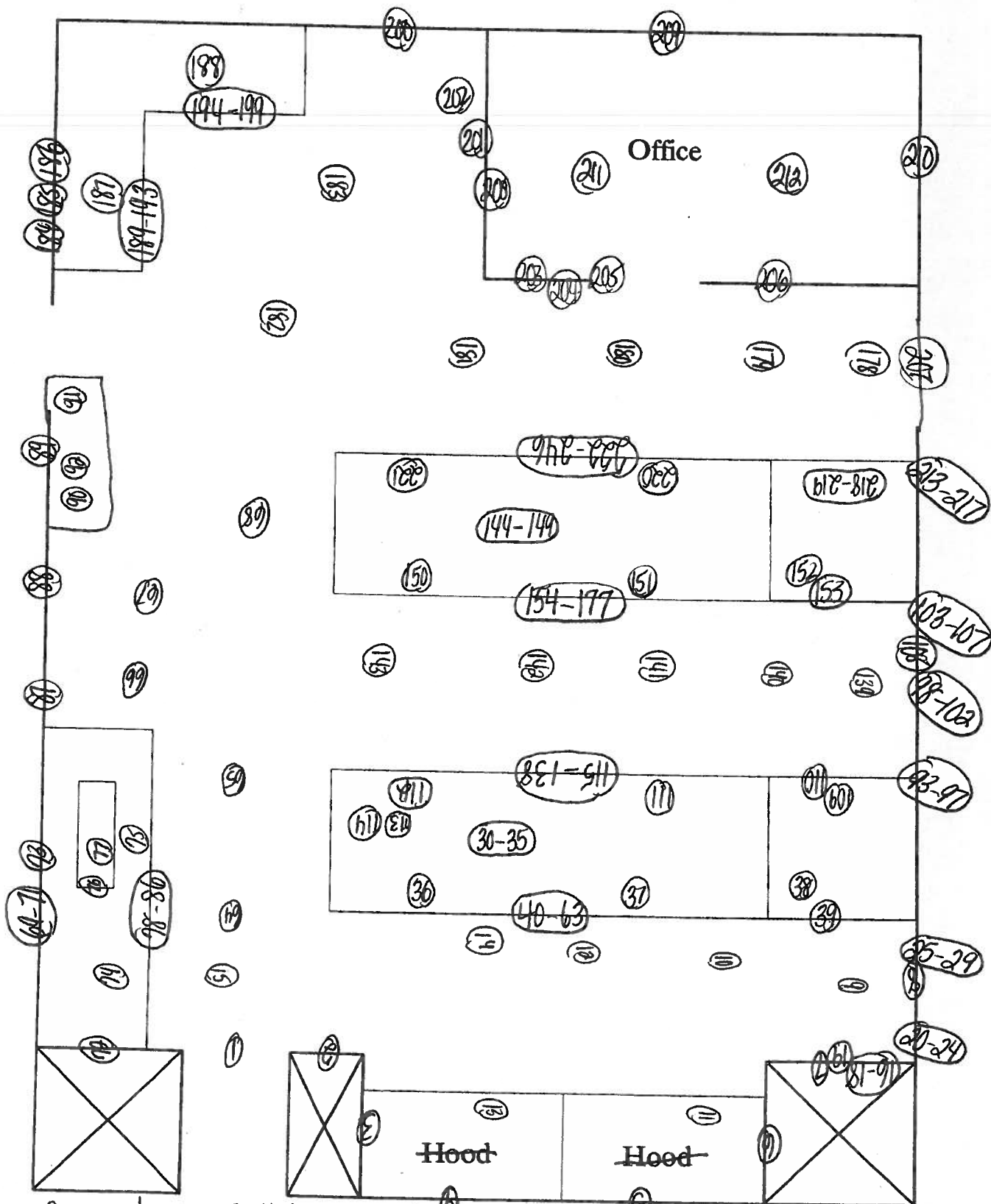

Surveyed 100% of all lower surfaces using instrument #2. All areas were noted to be at a level of normal background.

ED: MONTHLY WIPES

10 JAN 2001 14:31

USER: 4 COMMENT:

PRESET TIME : 1.00
 DATA CALC : DL DPM H# : YES SAMPLE REPEATS: 1 PRINTER : EDIT
 COUNT BLANK : YES IC# : NO REPLICATES : 1 RS232 : EDIT
 TWO PHASE : NO ADC : YES CYCLE REPEATS : 1
 SCINTILLATOR: LIQUID LUMEX: YES LOW SAMPLE REJ: 0
 LOW LEVEL : NO HALF LIFE CORRECTION DATE: none

ISOTOPE 1: 3H %ERROR: 2.00 FACTOR:1.0000 BKG. SUB: 0
 ISOTOPE 2: 14C %ERROR: 2.00 FACTOR:1.0000 BKG. SUB: 0
 WIDE OPEN WINDOW %ERROR: 0.00 FACTOR:1.0000 BKG. SUB: 0

BACKGROUND QUENCH CURVE: Off COLOR QUENCH CORRECTION: Off

Quench Limits Low:13.688 High:306.34

SAM NO	H#	3H CPM	14C CPM	WIDE CPM	3H DPM	14C DPM	RATIO	LUMEX %
B1	74.0	15.00	18.00	43.00	22.28	23.80	0.936	0.75
		Blank Average DPM		for 3H :	22.28	COEF. OF VAR:		0.000
		Blank Average DPM		for 14C :	23.80	COEF. OF VAR:		0.000
1	74.0	15.00	10.00	35.00	4.02	-10.69	-0.376	0.92
2	76.8	23.00	9.00	42.00	21.81	-12.14	-1.796	0.94
3	74.7	13.00	7.00	29.00	1.43	-14.66	-0.098	1.67
4	77.8	18.00	10.00	36.00	10.87	-10.71	-1.015	0.76
5	91.8	24.00	10.00	42.00	26.97	-10.75	-2.510	1.39
6	78.1	19.00	9.00	36.00	13.57	-12.07	-1.124	1.73
7	77.2	25.00	7.00	41.00	27.17	-14.85	-1.830	0.92
8	84.5	13.00	4.00	25.00	4.18	-18.65	-0.224	6.77
9	79.7	16.00	12.00	39.00	5.85	-7.99	-0.732	1.08
10	82.9	24.00	13.00	49.00	23.20	-6.76	-3.431	0.86
11	81.1	18.00	7.00	35.00	12.97	-14.72	-0.881	2.17
12	77.0	17.00	8.00	43.00	9.65	-13.38	-0.721	1.19
13	81.5	17.00	7.00	31.00	10.87	-14.70	-0.740	0.89
14	77.5	20.00	6.00	36.00	17.13	-16.10	-1.064	0.97
15	82.4	23.00	5.00	35.00	25.13	-17.48	-1.438	1.58
16	85.7	14.00	12.00	29.00	2.24	-7.91	-0.284	2.17
17	80.2	12.00	11.00	36.00	-2.18	-9.26	0.235	1.84
18	83.1	13.00	14.00	35.00	-1.31	-5.23	0.250	1.37
19	87.4	11.00	12.00	29.00	-4.24	-7.85	0.540	2.90
20	80.3	19.00	5.00	33.00	16.02	-17.42	-0.920	0.84
21	82.5	22.00	7.00	37.00	21.92	-14.78	-1.483	0.95
22	79.9	17.00	10.00	36.00	9.06	-10.69	-0.848	1.24
23	80.4	13.00	13.00	37.00	-1.05	-6.59	0.159	0.92
24	80.3	10.00	15.00	31.00	-8.56	-3.86	2.215	1.66
25	76.9	17.00	9.00	36.00	9.12	-12.04	-0.758	1.04
26	78.1	23.00	12.00	44.00	20.55	-8.12	-2.531	0.94
27	79.6	11.00	8.00	24.00	-2.82	-13.27	0.213	1.64
28	75.5	26.00	7.00	41.00	28.86	-14.87	-1.941	2.18
29	77.3	22.00	12.00	45.00	18.26	-8.11	-2.252	0.62
30	123.8	13.00	12.00	33.00	5.44	-7.60	-0.717	4.01
31	91.0	20.00	12.00	45.00	16.56	-7.98	-2.075	1.04
32	106.1	12.00	11.00	37.00	0.73	-9.08	-0.080	1.84
33	87.1	12.00	15.00	32.00	-3.66	-3.83	0.956	1.56
34	119.4	13.00	11.00	31.00	5.34	-9.00	-0.593	2.50
35	113.3	14.00	7.00	34.00	9.44	-14.54	-0.650	2.75
36	78.6	20.00	8.00	42.00	16.31	-13.42	-1.215	0.70

SAM NO	H#	3H CPM	14C CPM	WIDE CPM	3H DPM	14C DPM	RATIO	LUMEX %
37	78.4	18.00	8.00	32.00	11.99	-13.39	-0.896	0.78
38	78.9	15.00	7.00	28.00	6.18	-14.68	-0.421	1.30
39	87.1	9.00	17.00	37.00	-11.44	-1.09	10.504	0.83
40	75.4	20.00	14.00	43.00	12.68	-5.41	-2.342	0.54
41	76.9	22.00	10.00	42.00	19.20	-10.79	-1.780	0.76
42	80.5	18.00	12.00	43.00	10.26	-8.02	-1.280	0.75
43	77.9	24.00	8.00	40.00	24.69	-13.49	-1.830	0.64
44	77.4	18.00	13.00	40.00	9.27	-6.70	-1.384	0.78
45	75.3	23.00	8.00	41.00	22.00	-13.48	-1.631	0.65
46	78.1	18.00	12.00	38.00	9.89	-8.04	-1.231	1.36
47	79.7	16.00	10.00	35.00	6.87	-10.67	-0.644	1.45
48	79.6	16.00	8.00	34.00	7.90	-13.35	-0.592	0.80
49	76.3	20.00	11.00	36.00	14.35	-9.42	-1.524	2.14
50	77.8	19.00	12.00	44.00	11.97	-8.05	-1.487	0.80
51	78.8	13.00	13.00	43.00	-1.21	-6.61	0.184	0.70
52	78.7	16.00	8.00	32.00	7.77	-13.36	-0.582	0.73
53	89.6	13.00	6.00	31.00	3.77	-15.95	-0.236	2.31
54	76.7	21.00	9.00	40.00	17.57	-12.11	-1.451	0.40
55	80.3	14.00	14.00	32.00	0.57	-5.27	-0.109	0.79
56	77.1	16.00	8.00	34.00	7.55	-13.36	-0.565	0.74
57	79.1	20.00	10.00	38.00	15.35	-10.74	-1.429	0.61
58	76.4	15.00	8.00	34.00	5.34	-13.35	-0.400	1.20
59	73.3	24.00	4.00	36.00	25.69	-18.85	-1.363	0.77
60	78.0	17.00	8.00	30.00	9.80	-13.38	-0.732	0.99
61	76.3	21.00	11.00	44.00	16.47	-9.43	-1.745	0.83
62	79.1	19.00	11.00	37.00	12.70	-9.39	-1.353	1.16
63	78.2	16.00	9.00	42.00	7.19	-12.02	-0.598	0.88
64	82.1	10.00	10.00	29.00	-5.82	-10.56	0.551	1.67
65	84.1	10.00	11.00	30.00	-6.19	-9.20	0.673	1.19
66	89.4	13.00	11.00	31.00	1.01	-9.21	-0.109	1.36
67	82.4	16.00	11.00	37.00	6.74	-9.31	-0.724	0.90
68	84.3	16.00	8.00	30.00	8.61	-13.33	-0.646	1.37
69	107.5	15.00	9.00	34.00	9.64	-11.85	-0.813	3.10
70	110.8	16.00	15.00	37.00	9.03	-3.67	-2.460	1.92
71	86.7	12.00	7.00	27.00	0.62	-14.60	-0.043	2.01
72	78.9	14.00	13.00	35.00	0.94	-6.62	-0.141	0.72
73	80.3	16.00	9.00	31.00	7.49	-12.01	-0.624	1.19
74	81.6	14.00	11.00	35.00	2.29	-9.29	-0.246	0.54
75	78.7	15.00	22.00	46.00	-1.59	5.41	-0.294	0.41
76	81.0	16.00	6.00	34.00	9.15	-16.03	-0.571	0.59
77	89.2	24.00	9.00	45.00	26.85	-12.11	-2.218	1.71
78	77.4	14.00	11.00	35.00	1.81	-9.31	-0.194	0.67
79	78.5	14.00	5.00	29.00	5.02	-17.34	-0.290	0.63
80	80.6	26.00	5.00	41.00	31.18	-17.54	-1.778	0.66
81	79.2	15.00	7.00	34.00	6.22	-14.68	-0.424	1.10
82	79.5	17.00	9.00	39.00	9.51	-12.03	-0.791	0.84
83	84.3	19.00	11.00	42.00	13.59	-9.35	-1.453	0.62
84	79.3	17.00	6.00	33.00	11.04	-16.05	-0.688	0.92
85	90.3	9.00	11.00	31.00	-7.96	-9.14	0.871	0.92
86	79.9	17.00	10.00	33.00	9.05	-10.69	-0.847	2.13
87	79.2	16.00	12.00	36.00	5.77	-7.99	-0.722	0.64
88	77.4	16.00	5.00	34.00	9.12	-17.38	-0.525	1.05
89	76.2	15.00	11.00	32.00	3.78	-9.34	-0.405	1.22
90	81.6	11.00	5.00	24.00	-1.06	-17.28	-0.062	1.02
91	82.3	20.00	11.00	37.00	15.42	-9.38	-1.142	1.11
92	97.9	16.00	11.00	38.00	9.15	-9.21	-0.083	1.11
93	87.8	20.00	7.00	30.00	18.66	-14.73	-1.264	1.15
94	87.4	17.00	1.00	34.00	11.55	-16.04	-0.720	1.35

SAM NO	4H	3H CPM	14C CPM	WIDE CPM	3H DPM	14C DPM	RATIO	LUMEX %
95	83.0	18.00	9.00	34.00	12.25	-12.03	-1.019	1.18
96	84.7	10.00	12.00	34.00	-6.68	-7.85	0.850	0.84
97	84.5	17.00	11.00	39.00	9.23	-9.32	-0.991	0.75
98	80.9	16.00	6.00	26.00	9.14	-16.03	-0.570	1.72
99	84.0	17.00	11.00	39.00	9.15	-9.32	-0.982	1.34
100	81.5	19.00	5.00	33.00	16.26	-17.42	-0.934	1.32
101	80.3	26.00	4.00	40.00	31.63	-18.88	-1.675	0.53
102	88.1	12.00	7.00	24.00	0.78	-14.59	-0.054	2.52
103	77.1	12.00	13.00	36.00	-3.49	-6.61	0.529	0.83
104	80.4	8.00	14.00	28.00	-12.34	-5.17	2.387	1.16
105	83.2	19.00	12.00	45.00	12.88	-8.02	-1.607	1.40
106	83.3	18.00	15.00	43.00	9.11	-3.97	-2.293	0.66
107	82.3	22.00	8.00	39.00	21.34	-13.44	-1.588	1.63
108	116.9	11.00	9.00	30.00	0.92	-11.72	-0.079	3.03
109	96.2	22.00	11.00	44.00	22.91	-9.34	-2.454	4.86
110	89.1	12.00	6.00	25.00	1.46	-15.93	-0.091	1.67
111	78.1	16.00	8.00	35.00	7.69	-13.36	-0.576	0.87
112	85.5	16.00	5.00	29.00	10.41	-17.36	-0.600	1.18
113	87.7	14.00	4.00	24.00	6.85	-18.67	-0.367	1.20
114	81.3	17.00	10.00	40.00	9.27	-10.68	-0.868	1.31
115	80.3	12.00	5.00	26.00	0.95	-17.30	-0.055	1.04
116	81.1	16.00	10.00	37.00	7.08	-10.66	-0.664	1.20
117	83.5	12.00	7.00	26.00	0.26	-14.61	-0.018	1.34
118	82.7	17.00	14.00	47.00	7.37	-5.30	-1.390	0.82
119	83.1	19.00	14.00	41.00	11.80	-5.33	-2.214	0.65
120	81.2	20.00	14.00	45.00	13.64	-5.37	-2.542	0.70
121	79.9	16.00	7.00	33.00	8.46	-14.69	-0.576	0.55
122	80.0	16.00	7.00	34.00	8.48	-14.69	-0.578	0.68
123	77.8	19.00	10.00	39.00	13.00	-10.73	-1.211	0.46
124	79.8	12.00	9.00	33.00	-1.18	-11.94	0.099	1.07
125	83.5	13.00	7.00	28.00	2.45	-14.63	-0.167	1.52
126	79.9	15.00	12.00	31.00	3.72	-7.97	-0.467	1.24
127	81.4	17.00	9.00	39.00	9.81	-12.02	-0.817	1.11
128	78.8	11.00	5.00	21.00	-1.34	-17.29	0.078	1.43
129	80.8	16.00	10.00	37.00	7.04	-10.66	-0.660	0.74
130	79.9	25.00	10.00	45.00	26.25	-10.82	-2.426	0.77
131	80.3	16.00	11.00	38.00	6.45	-9.33	-0.691	0.75
132	80.1	19.00	11.00	39.00	12.87	-9.38	-1.372	0.78
133	80.1	22.00	6.00	41.00	21.92	-16.13	-1.359	0.81
134	77.4	25.00	6.00	42.00	27.72	-16.19	-1.713	0.65
135	80.0	12.00	14.00	33.00	-3.76	-5.24	0.718	0.80
136	78.1	13.00	7.00	30.00	1.81	-14.65	-0.124	1.28
137	77.1	23.00	7.00	40.00	22.89	-14.82	-1.545	1.06
138	77.1	16.00	9.00	35.00	7.04	-12.02	-0.585	0.91
139	82.2	18.00	11.00	36.00	11.06	-9.35	-1.183	1.12
140	79.2	24.00	8.00	37.00	24.98	-13.49	-1.852	0.82
141	82.8	14.00	9.00	32.00	3.49	-11.96	-0.291	0.94
142	86.0	17.00	11.00	36.00	9.47	-9.31	-1.017	1.08
143	87.4	24.00	15.00	48.00	23.14	-4.04	-5.729	0.71
144	88.7	16.00	11.00	32.00	7.67	-9.27	-0.827	1.81
145	87.4	8.00	9.00	34.00	-9.31	-11.83	0.787	0.99
146	97.8	17.00	15.00	40.00	9.18	-3.82	-2.405	2.47
147	117.4	17.00	4.00	29.00	20.20	-18.70	-1.080	15.50
148	107.0	14.00	7.00	33.00	8.28	-14.56	-0.569	6.84
149	93.0	12.00	14.00	39.00	-2.55	-5.12	0.498	2.00
150	84.5	16.00	13.00	37.00	5.96	-6.61	-0.902	0.87
151	85.4	19.00	10.00	39.00	14.34	-10.69	-1.341	1.08
152	88.4	15.00	11.00	39.00	5.38	-9.26	-0.581	1.39

SAM NO	H#	LUMEX			RATIO			LUMEX %
		3H CPM	14C CPM	WIDE CPM	3H DPM	14C DPM	RATIO	
153	81.7	19.00	11.00	43.00	13.14	-9.37	-1.402	0.68
154	77.8	20.00	10.00	40.00	15.13	-10.75	-1.408	0.63
155	77.8	25.00	15.00	56.00	23.19	-4.14	-5.603	0.48
156	80.8	14.00	6.00	26.00	4.81	-15.99	-0.300	1.20
157	80.0	11.00	8.00	27.00	-2.79	-13.27	0.210	1.11
158	80.8	21.00	7.00	41.00	19.40	-14.77	-1.313	0.73
159	79.9	14.00	3.00	31.00	6.25	-20.02	-0.312	0.88
160	79.2	14.00	9.00	33.00	3.04	-11.98	-0.254	0.60
161	81.9	14.00	5.00	37.00	5.48	-17.33	-0.316	0.68
162	81.5	23.00	6.00	38.00	24.41	-16.14	-1.512	0.61
163	81.4	18.00	12.00	40.00	10.40	-8.01	-1.298	0.60
164	78.2	16.00	9.00	33.00	7.19	-12.02	-0.598	0.92
165	80.3	17.00	6.00	38.00	11.20	-16.05	-0.698	0.74
166	79.5	19.00	11.00	39.00	12.76	-9.38	-1.360	0.64
167	95.2	16.00	7.00	33.00	10.98	-14.64	-0.750	0.91
168	82.9	18.00	7.00	35.00	13.28	-14.71	-0.903	0.93
169	82.7	14.00	16.00	38.00	-0.22	-2.57	0.087	0.89
170	83.0	17.00	13.00	38.00	7.95	-6.64	-1.197	1.16
171	83.0	21.00	3.00	28.00	21.98	-20.13	-1.092	1.11
172	77.7	21.00	8.00	35.00	18.26	-13.44	-1.358	0.80
173	79.3	11.00	13.00	33.00	-5.44	-6.57	0.828	0.65
174	80.7	11.00	7.00	27.00	-2.20	-14.60	0.151	1.11
175	79.0	21.00	11.00	39.00	16.97	-9.42	-1.802	1.01
176	83.2	20.00	12.00	36.00	15.06	-8.03	-1.875	0.89
177	89.7	16.00	14.00	39.00	6.16	-5.22	-1.179	1.31
178	115.2	14.00	13.00	41.00	5.94	-6.32	-0.939	1.71
179	85.3	14.00	6.00	26.00	5.42	-15.98	-0.339	1.24
180	84.8	19.00	6.00	35.00	16.36	-16.07	-1.018	1.16
181	88.2	22.00	11.00	39.00	21.03	-9.38	-2.241	1.62
182	91.7	8.00	13.00	29.00	-11.26	-6.41	1.755	2.27
183	87.9	15.00	11.00	33.00	5.31	-9.26	-0.573	4.60
184	85.7	21.00	13.00	40.00	17.20	-6.69	-2.571	0.91
185	85.7	15.00	15.00	35.00	2.85	-3.90	-0.731	1.01
186	78.9	16.00	14.00	37.00	4.71	-5.32	-0.885	0.64
187	94.8	14.00	12.00	39.00	3.42	-7.85	-0.436	0.83
188	90.3	15.00	8.00	35.00	7.29	-13.29	-0.549	2.04
189	79.7	11.00	14.00	40.00	-5.93	-5.23	1.134	0.70
190	82.3	13.00	15.00	43.00	-1.91	-3.90	0.491	1.04
191	81.2	19.00	12.00	42.00	12.54	-8.03	-1.561	0.82
192	83.8	27.00	8.00	42.00	32.64	-13.52	-2.414	0.72
193	83.8	16.00	7.00	36.00	9.06	-14.68	-0.618	1.05
194	86.0	15.00	8.00	33.00	6.65	-13.31	-0.500	0.97
195	85.0	17.00	6.00	27.00	12.00	-16.03	-0.748	1.35
196	82.7	17.00	7.00	28.00	11.07	-14.70	-0.753	1.30
197	89.8	14.00	12.00	38.00	2.75	-7.88	-0.349	0.85
198	80.7	15.00	5.00	25.00	7.48	-17.35	-0.431	1.07
199	85.9	12.00	15.00	35.00	-3.78	-3.84	0.982	0.97
200	93.9	10.00	4.00	19.00	-1.43	-18.58	0.077	1.49
201	84.7	13.00	9.00	35.00	1.53	-11.93	-0.128	1.18
202	84.7	17.00	12.00	42.00	8.73	-7.97	-1.095	0.83
203	81.3	20.00	11.00	37.00	15.24	-9.39	-1.623	1.13
204	82.8	17.00	9.00	37.00	10.02	-12.01	-0.834	0.83
205	83.3	18.00	9.00	36.00	12.30	-12.03	-1.023	1.10
206	79.9	22.00	17.00	51.00	16.16	-1.39	-11.63	0.52
207	79.9	14.00	10.00	42.00	2.60	-10.64	-0.245	0.79
208	78.3	17.00	12.00	39.00	7.79	-8.02	-0.971	0.48
209	84.5	18.00	7.00	31.00	13.57	-14.71	-0.922	1.08
210	81.8	19.00	8.00	37.00	14.73	-13.39	-1.100	0.75

SAM NO	H#	3H CPM	14C CPM	WIDE CPM	3H DPM	14C DPM	RATIO	LUMEX %
211	83.2	17.00	13.00	38.00	7.97	-6.64	-1.201	1.58
212	87.4	19.00	5.00	37.00	17.41	-17.41	-1.000	0.88
213	83.5	14.00	8.00	32.00	4.11	-13.30	-0.309	0.63
214	85.0	17.00	10.00	33.00	9.85	-10.66	-0.924	0.73
215	87.2	12.00	9.00	29.00	-0.41	-11.90	0.034	0.86
216	91.0	16.00	11.00	34.00	8.01	-9.26	-0.865	0.82
217	85.9	13.00	11.00	33.00	0.60	-9.24	-0.065	1.71
218	84.3	9.00	12.00	33.00	-8.90	-7.84	1.136	1.33
219	87.0	13.00	5.00	31.00	3.97	-17.30	-0.229	0.99
220	84.1	21.00	7.00	35.00	20.09	-14.76	-1.361	0.95
221	84.7	12.00	8.00	31.00	-0.14	-13.26	0.010	1.66
222	79.5	21.00	11.00	39.00	17.07	-9.42	-1.813	1.23
223	85.3	10.00	12.00	32.00	-6.63	-7.85	0.845	0.69
224	82.4	14.00	8.00	29.00	3.96	-13.31	-0.298	0.75
225	84.0	15.00	12.00	33.00	4.24	-7.94	-0.534	1.01
226	87.3	14.00	7.00	26.00	5.15	-14.63	-0.352	0.92
227	84.0	16.00	11.00	35.00	6.96	-9.30	-0.748	0.92
228	80.3	16.00	10.00	36.00	6.97	-10.67	-0.653	0.85
229	82.7	18.00	9.00	38.00	12.20	-12.03	-1.014	0.66
230	81.4	18.00	13.00	40.00	9.88	-6.67	-1.482	0.96
231	85.9	9.00	8.00	28.00	-6.65	-13.20	0.504	1.29
232	87.8	11.00	9.00	33.00	-2.58	-11.88	0.217	1.21
233	82.3	11.00	12.00	33.00	-4.68	-7.89	0.594	0.92
234	86.2	15.00	5.00	27.00	8.30	-17.34	-0.478	1.08
235	82.9	17.00	10.00	32.00	9.52	-10.67	-0.892	0.94
236	84.1	13.00	5.00	29.00	3.60	-17.31	-0.208	1.14
237	79.3	16.00	11.00	40.00	6.30	-9.33	-0.675	0.70
238	79.3	17.00	12.00	36.00	7.93	-8.01	-0.990	0.68
239	84.4	23.00	6.00	37.00	25.09	-16.14	-1.555	1.05
240	86.2	14.00	11.00	34.00	2.85	-9.25	-0.308	1.13
241	81.3	15.00	10.00	32.00	4.95	-10.64	-0.465	1.93
242	79.3	13.00	8.00	35.00	1.44	-13.30	-0.108	0.78
243	86.7	16.00	7.00	33.00	9.52	-14.67	-0.649	0.97
244	83.4	16.00	13.00	44.00	5.81	-6.62	-0.878	0.55
245	83.9	20.00	10.00	36.00	16.26	-10.72	-1.518	0.68
246	85.5	13.00	15.00	42.00	-1.60	-3.86	0.414	1.17