

Radiological Survey Sheet

Job Location Pfizer, Inc. Groton, Ct. 06340 UGD/D218U-V Page 1 18

Survey Purpose Radiologic Survey of Equipment LAB Decomm. Date 11-2-12

Performed by E. GAILOR E Gailor
 (Print) (Sign)

Instrument (Model/S/N)	Packard Tri-Carb S/N 431521	Packard Tri-Carb S/N 431520	Ludlum 2241-2 163603	Wallac Model 1409 S/N 4061042
Det. (Model/SN)	Internal	Internal	Ludlum 43-68 PR 149613	Internal
Type Rad.	β	β	β	β
Cal. Due:	03/05/2013	03/05/2013	04/17/2013	09/15/2012
Check Instruments Used	✓			

No.	Time	Locations	See attached LSC printout for Total Activity (cpm/100 cm ²)
1.	1015	BACKGROUND	
2.		doors	
3.		FLOOR	
4.		U CAB doors	
5.		U TOP SHELF	
6.		U BOTTOM U	
7.		SINK AREA	
8.		BENCH	
9.		CAB doors & CAB	
10.		WALL	
11.		U	
12.		U	
13.		U	
14.		BENCH	
15.		BENCH	
16.		BENCH	
17.		↓	
18.		↓	
		dw R TOP	
		U 2ND	

Radiological Survey Continuation Sheet

Page 2 of 18

Date 11-2-12

No.	Time	Locations	See attached LSC printout for Total Activity (cpm/100 cm ²)
19	6:15	U	DRAWER 3rd
20			" 4TH
21			TOP RIGHT dWR
22			2nd " "
23			TOP LEFT "
24			2nd " "
25			1ST LARGE "
26			2nd " "
27			TOP RIGHT "
28			" LEFT "
29			CAB DOORS
30			CAB TOP SHELF
31			" BOTTOM "
32			TOP RIGHT dWR
33			2nd " "
34			TOP LEFT "
35			2nd " "
36			1ST LARGE dWR
37			2nd " "
38			UPPER WALL
39			LOWER "
40			1ST SHELF
41			2nd "
42			3rd "
43			4TH "
44			5TH "
45			6TH "

Radiological Survey Continuation Sheet

Page 3 of 18

Date 11-2-12

No.	Time	Locations	See attached LSC printout for Total Activity (cpm/100 cm ²)
46	10:15	U	TOP SHELF
47			2ND "
48			2RD "
49			4TH "
50			5TH "
51			6TH "
52			TOP "
53			2ND "
54			3RD "
55			4TH "
56			5TH "
57			6TH "
58			UPPER WALL
59			LOWER WALL
60			WINDOW SILL & CAB TOP
61			" " " "
62			" " " "
63			" " " "
64			TOP SHELF
65			BOTTOM "
66			TOP "
67			BOTTOM "
68			TOP "
69			BOTTOM "
70			" "
71			CAB DOORS
72	✓	✓	" TOP SHELF

Radiological Survey Continuation Sheet

Page 7 of 18

Date 11-2-12

No.	Time	Locations	See attached LSC printout for Total Activity (cpm/100 cm ²)
73	10-15	U CAB	2ND SHELF
74		"	3RD "
75		U	doors
76		"	TOP SHELF
77		"	2ND "
78		"	3RD "
79		U	doors
80		"	TOP SHELF
81		"	2ND "
82		"	3RD "
83		"	doors
84		"	TOP SHELF
85		"	2ND "
86		U	3RD "
87			TOP dWR
88			2ND "
89			3RD "
90			4TH U
91			dWR
92			TOP RIGHT dWR
93			2ND U "
94			TOP LEFT "
95			2ND " "
96			1ST / LARGE "
97			2ND " "
98			drawer
99	✓	✓	TOP RIGHT dWR

Radiological Survey Continuation Sheet

Page 5 of 18

Date 11-2-12

No.	Time	Locations	See attached LSC printout for Total Activity (cpm/100 cm ²)
100	10-15	U	TOP LEFT door
101			CAB doors
102			" TOP SHEET
103			" BOTTOM "
104			TOP RIGHT door
105			2ND " "
106			TOP LEFT "
107			2ND " "
108			LST LARGE "
109			2ND " "
110			BENCH
111			"
112			"
113			"
114			"
115			FLOOR
116			"
117			"
118			"
119			"
120			"
121		↓	"
122		F	BENCH
123			FLOOR
124			UPPER WALL
125			LOWER "
126	↓	↓	CAB doors

Radiological Survey Continuation Sheet

Page 6 of 18

Date 11-2-12

No.	Time	Locations	See attached LSC printout for Total Activity (cpm/100 cm ²)
127	1045	F	CAB TOP SHELF
128			" 2ND "
129			" 3RD "
130			CAB DOORS
131			" TOP SHELF
132			" 2ND "
133			" 3RD "
134			" DOORS
135			" TOP SHELF
136			" 2ND "
137			" 3RD "
138			CAB DOORS
139			" TOP SHELF
140			" 2ND "
141			" 3RD "
142			TOP RIGHT DWR
143			2ND " "
144			TOP LEFT "
145			2ND " "
146			1ST LARGE "
147			2ND " "
148			DWR
149			TOP RIGHT DWR
150			" LEFT "
151			CAB DOORS
152			" TOP SHELF
153	✓	✓	" BOTTOM "

Radiological Survey Continuation Sheet

Page 7 of 18

Date 11-2-12

No.	Time	Locations	See attached LSC printout for Total Activity (cpm/100 cm ²)
154	1015	F	TOP dWR
155			2nd "
156			3rd "
157			4TH "
158			TOP RIGHT dWR
159			2nd " "
160			TOP LEFT "
161			2nd " "
162			1ST LARGE "
163			2nd " "
164			FLOOR
165			BENCH
166			BENCH
167		✓	BENCH
168		G	UPPER WALL
169			LOWER "
170			FLOOR
171			"
172			HOOD LEFT side
173			" " BACK
174			" middle "
175			" RIGHT "
176			" " SIDE
177			" " BOTTOM
178			" middle "
179			" LEFT "
180	✓	✓	" SASH

Radiological Survey Continuation Sheet

Page 8 of 18

Date 11-2-12

No.	Time	Locations	See attached LSC printout for Total Activity (cpm/100 cm ²)
181	1015	G	HOOD LIP
182			CAB DOORS
183			" TOP SHELF
184			" BOTTOM "
185			CAB DOORS
186			" TOP SHELF
187			" BOTTOM "
188			CAB DOORS
189			" TOP SHELF
190			" BOTTOM "
191			" DOORS
192			" TOP SHELF
193			" BOTTOM "
194			HOOD LEFT SIDE
195			" " BACK
196			" MIDDLE "
197			" RIGHT "
198			" RIGHT SIDE
199			" " BOTTOM
200			" MIDDLE "
201			" LEFT "
202			" SASH
203			" LIP
204			BENCH
205			FLOOR
206			FLOOR
207			FLOOR

Radiological Survey Continuation Sheet

Page 7 of 18

Date 11-2-12

No.	Time	Locations	See attached LSC printout for Total Activity (cpm/100 cm ²)
208	10-15	G	FLOOR
209			"
210			"
211		V	"
212		H	WINDOW SILL & CAB TOP
213			CAB TOP SHELF
214			" 2ND "
215			CAB DOORS
216			" TOP SHELF
217			" BOTTOM "
218			CAB DOORS
219			" TOP SHELF
220			" 2ND "
221			" 3RD "
222			" DOORS
223			" TOP SHELF
224			" 2ND "
225			" 3RD "
226			" DOORS
227			" TOP "
228			" 2ND "
229			" 3RD "
230			TOP LEFT DWR
231			2ND " "
232			TOP RIGHT "
233			2ND " "
234			1ST LARGE "
			2ND " "

Radiological Survey Continuation Sheet

Page 10 of 18

Date 11-2-12

No.	Time	Locations	See attached LSC printout for Total Activity (cpm/100 cm ²)
235	10-15	H	TOP dWR
236			2ND "
237			3RD "
238			4TH "
239			LEFT dWR
240			RIGHT "
241			CAB DOORS
242			" TOP SHELF
243			" BOTTOM "
244			TOP LEFT dWR
245			2ND " "
246			TOP RIGHT "
247			2ND " "
248			1ST LARGE "
249			2ND " "
250			BENCH
251			"
252			"
253			"
254			"
255			"
256			"
257			FLOOR
258			"
259			"
260			"
261			"
262			"

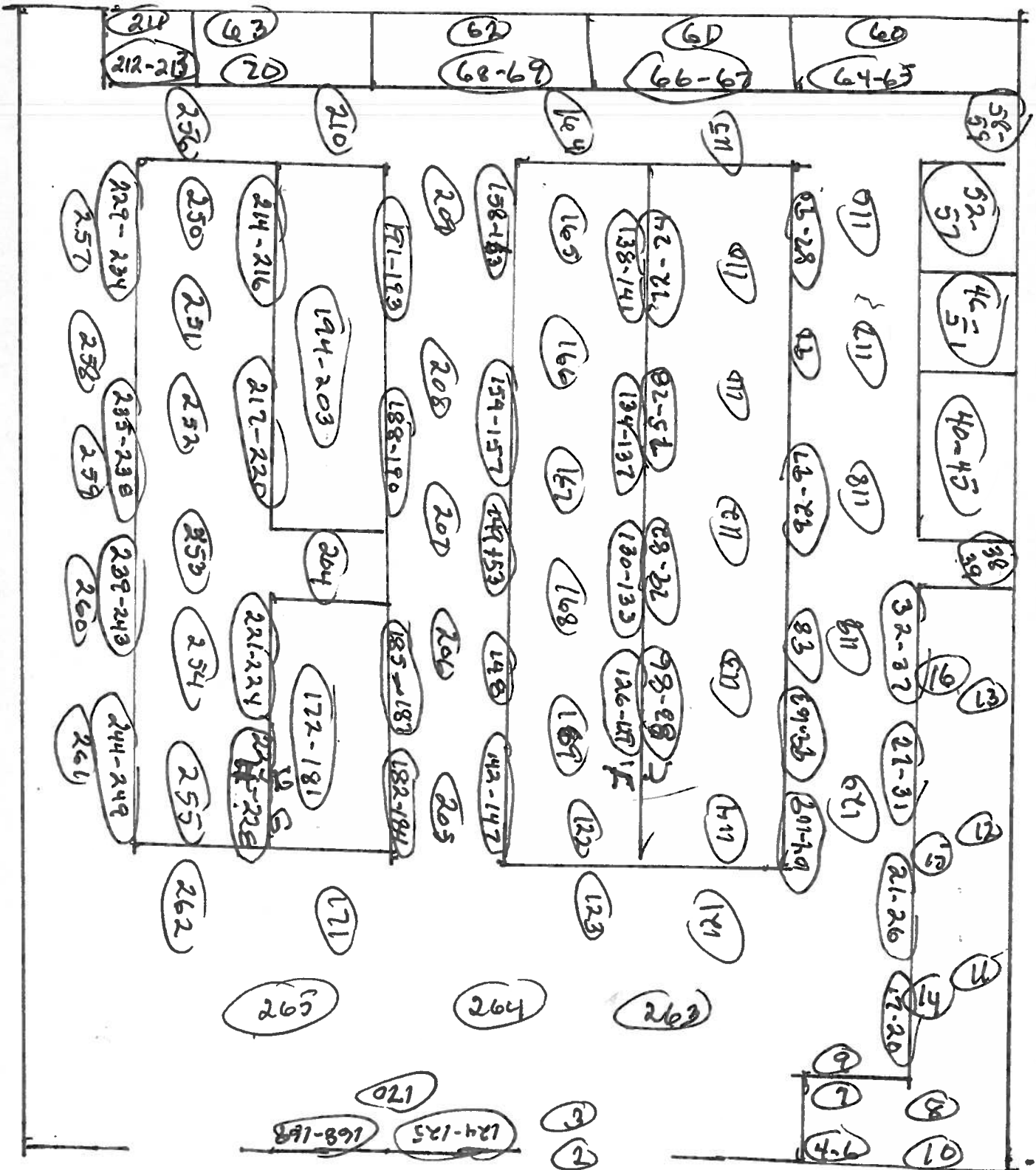

Surveyed 100% of lower surfaces using 43-48. no drawings to check of normal structure
Levels was mixed.

O = wipe location

Assay Definition-

Assay Description:
Equipment Swipes

Assay Type: CPM
Report Name: Report1
Output Data Path: C:\Packard\Tricarb\Results\Ed Gailor\Eds Monthly Swipes
Raw Results Path: C:\Packard\Tricarb\Results\Ed Gailor\Eds Monthly Swipes\20121102_1209
\20121102_1209.results
RTF File Name: C:\Packard\Tricarb\Results\Ed Gailor\Eds Monthly Swipes\Ed's Monthly
Swipes.rtf
Assay File Name: C:\Packard\TriCarb\Assays\Eds Monthly Swipes.lsa

Count Conditions-

Nuclide: Triple
Quench Indicator: tSIE/AEC
External Std Terminator (sec): 5 sec
Pre-Count Delay (min): 0.00
Quench Set: n/a
Count Time (min): 1.00
Count Mode: Normal
Assay Count Cycles: 1 Repeat Sample Count: 1
#Vials/Sample: 1 Calculate % Reference: Off

Background Subtract: On - Manual
Low CPM Threshold: Off
2 Sigma % Terminator: Off

Regions	LL	UL	Bkg Subtract
A	0.0	18.6	0.00
B	18.6	156.0	0.00
C	0.0	2000.0	0.00

Count Corrections-

Static Controller: On Luminescence Correction: On
Colored Samples: n/a Heterogeneity Monitor: n/a
Coincidence Time (nsec): 18 Delay Before Burst (nsec): 75

Half Life-

Half Life Correction: Off

Regions	Half Life	Units	Reference Date	Reference Time
A				
B				
C				

Cycle 1 Results

S#	CPMA	CPMB	CPMC	MESSAGES
1	4	6	12	
2	12	8	26	
3	7	11	21	
4	9	6	19	
5	13	6	23	
6	12	10	28	
7	5	7	16	
8	16	5	23	
9	7	8	21	
10	6	6	17	

11	12	13	29
12	16	10	32
13	14	8	27
14	4	8	16
15	9	7	20
16	13	4	22
17	13	11	27
18	22	7	33
19	14	13	31
20	4	6	14
21	9	6	20
22	14	5	24
23	20	9	35
24	12	7	23
25	10	5	20
26	11	7	25
27	5	8	18
28	14	6	23
29	3	4	10
30	11	6	20
31	11	6	20
32	14	8	29
33	8	5	17
34	7	6	22
35	9	6	20
36	16	12	33
37	9	6	17
38	11	9	22
39	14	10	30
40	12	9	28
41	11	6	22
42	6	6	19
43	3	11	17
44	10	5	16
45	8	7	16
46	12	7	25
47	12	11	27
48	7	2	20
49	6	9	18
50	11	6	21
51	8	10	23
52	15	6	26
53	11	6	24
54	13	7	31
55	4	10	26
56	3	12	22
57	7	5	17
58	7	4	16
59	13	9	23
60	13	4	23
61	13	6	21
62	14	9	26
63	14	3	23
64	3	9	18
65	14	12	31
66	13	4	18
67	11	9	23
68	12	5	22
69	6	6	19
70	12	6	22
71	8	6	18
72	8	5	19
73	13	10	28

74	10	3	17
75	16	5	27
76	14	10	28
77	11	8	24
78	8	5	15
79	4	8	17
80	10	4	16
81	11	3	22
82	10	7	22
83	13	7	22
84	9	2	13
85	10	11	25
86	8	9	21
87	15	9	26
88	5	6	21
89	10	4	17
90	9	4	16
91	12	5	23
92	13	3	25
93	7	8	23
94	8	8	23
95	10	9	25
96	13	2	20
97	7	15	26
98	15	9	36
99	10	4	18
100	12	8	25
101	16	9	32
102	8	11	24
103	6	6	12
104	17	8	29
105	5	14	22
106	9	3	14
107	13	7	25
108	8	4	20
109	12	13	32
110	14	8	25
111	5	10	19
112	8	5	20
113	9	6	19
114	12	11	28
115	9	7	21
116	10	9	27
117	9	6	26
118	9	6	20
119	11	11	30
120	17	7	31
121	11	4	20
122	10	5	22
123	15	2	21
124	10	6	17
125	6	8	20
126	16	9	31
127	8	3	18
128	7	7	21
129	9	3	17
130	6	5	13
131	6	7	18
132	14	12	34
133	5	3	10
134	12	7	24
135	9	6	21
136	21	10	37

137	9	5	19
138	8	4	16
139	14	4	21
140	15	5	23
141	5	9	17
142	12	7	22
143	1	2	4
144	13	6	20
145	8	6	15
146	4	9	15
147	16	5	25
148	10	5	19
149	8	9	19
150	5	11	21
151	6	7	19
152	11	2	18
153	12	4	21
154	14	3	21
155	19	7	29
156	9	6	18
157	9	8	29
158	6	4	15
159	19	8	31
160	9	7	19
161	9	4	22
162	10	9	25
163	5	7	18
164	9	4	17
165	7	2	10
166	7	8	23
167	14	9	28
168	6	3	11
169	10	9	23
170	12	12	27
171	14	4	26
172	7	9	19
173	14	8	25
174	9	4	17
175	13	5	23
176	6	4	13
177	14	9	33
178	5	6	18
179	16	10	31
180	7	3	17
181	10	2	17
182	9	7	21
183	9	8	21
184	4	5	12
185	11	5	20
186	9	8	21
187	5	6	15
188	3	6	14
189	16	15	33
190	12	7	25
191	15	9	30
192	13	12	28
193	15	4	25
194	14	8	26
195	2	7	17
196	8	5	17
197	22	5	33
198	16	7	29
199	6	8	17

Protocol# 4 - Eds Monthly Swipes.lsa

User: Ed Gailor

200	24	3	33
201	20	6	31
202	13	5	23
203	14	11	29
204	19	3	29
205	16	5	25
206	13	6	23
207	16	10	29
208	7	9	18
209	8	8	22
210	7	10	25
211	8	3	16
212	7	8	23
213	4	8	17
214	1	3	9
215	13	8	26
216	15	8	27
217	14	11	29
218	3	5	11
219	24	8	35
220	10	7	24
221	9	11	28
222	13	2	19
223	6	4	14
224	1	9	14
225	10	5	18
226	14	7	26
227	18	4	24
228	21	7	33
229	15	8	25
230	14	7	27
231	17	6	28
232	8	11	22
233	13	5	21
234	5	9	17
235	16	9	31
236	6	9	19
237	18	9	30
238	12	5	21
239	8	11	23
240	13	5	22
241	10	11	25
242	9	6	17
243	7	9	18
244	1	4	9
245	7	5	17
246	0	6	9
247	9	12	26
248	4	7	18
249	0	7	14
250	8	10	21
251	6	5	13
252	12	8	24
253	12	10	26
254	13	10	27
255	9	10	22
256	6	11	21
257	16	11	31
258	13	5	21
259	10	11	23
260	9	6	17
261	6	6	21
262	17	9	35

263	9	8	27
264	8	8	19
265	10	4	14