

Radiological Survey Sheet

Job Location Pfizer Central Research Grotton 118D/D211 Page 1 of 10
 Survey Purpose radiological assessment Date 10/18/00
 Performed By Pam Jones (Print) Pam Jones (Sign)

Inst.(1) (Model/SN) Beckman LS 6500 #7069448	Inst.(2) Ludlum 2241-2 (Model/SN) #163603	Inst.(3) (Model/SN)
Det. Internal (Model/SN)	Det. Ludlum 43-68 (Model/SN) #PR149613	Det. (Model/SN)
Eff. See LSC Printout	Eff. ≈ 89 CI4	Eff.
Type rad. β	Type rad. β	Type rad.
Bkgd. See LSC Printout	Bkgd. 300 cpm	Bkgd.
Cal. Due: 12/00	Cal. Due 2/13/01	Cal. due

No.	Time	Location	Inst. Used	Total Activity (dpm/100 cm ²)
1.	8:00	shelf	1	See attached LSC Printout
2.		top shelf	1	
3.		bottom shelf	1	
4.		wall	1	
5.		"	1	
6.		"	1	
7.		"	1	
8.		tabletop	1	
9.		"	1	
10.		"	1	
11.		floor	1	
12.		outside drawers	1	
13.		top drawer	1	
14.		drawer	1	
15.		bottom drawer	1	
16.		outside drawers	1	
17.		top drawer	1	
18.	✓	bottom drawer	1	

Radiological Survey Continuation Sheet

Page 2 of 10

Date 10/18/00

No.	Time	Location	Inst. Used	Total Activity (dpm/100 cm ²)
19		outside drawers	1	See attached LSC Printout
20		top drawer	1	
21		drawer	1	
22		bottom drawer	1	
23		shelf, para	1	
24		rotator top	1	
25		rotator body	1	
26		wall	1	
27		shelf	1	
28		counter top	1	
29		metal shelves (bottom up ↑)	1	
30		"	1	
31		wall	1	
32		wall	1	
33		shelf	1	
34		shelf	1	
35		metal (bottom)	1	
36		metal	1	
37		plastic	1	
38		metal	1	
39		metal (top)	1	
40		counter	1	
41		counter	1	
42		outside drawers	1	
43		top left	1	
44		top rt	1	
45		drawer	1	
46	✓	drawer	1	✓

Radiological Survey Continuation Sheet

Page 3 of 10
 Date 10/18/00

No.	Time	Location	Inst. Used	Total Activity (dpm/100 cm ²)
47		bottom drawer	1	See attached LSC Printout
48		outside drawers (back room)	1	
49		top drawer	1	
50		drawer	1	
51		bottom drawer	1	
52		outside cab.	1	
53		inside cab	1	
54		sink counter	1	
55		sides of sink	1	
56		bottom	1	
57		drain	1	
58		counter	1	
59		wall	1	
60		plexiglas shield	1	
61		wall	1	
62		outside vacuum area	1	
63		"	1	
64		waste trash can (radioactive labelled)	1	
65		wall	1	
66		floor	1	
67		"	1	
68		"	1	
69		"	1	
70		"	1	
71		"	1	
72		"	1	
73		top outside fridge	1	
74	✓	front	1	✓

Radiological Survey Continuation Sheet

Page 4 of 10

Date 10/18/00

No.	Time	Location	Inst. Used	Total Activity (dpm/100 cm ²)
75		back	1	See attached LSC Printout
76		left side	1	
77		rt. side	1	
78		back in freezer	1	
79		left	1	
80		rt.	1	
81		bottom	1	
82		top shelf (door)	1	
83		bottom shelf (door)	1	
84		back inside fridge	1	
85		left	1	
86		right	1	
87		bottom	1	
88		top shelf	1	
89		shelf	1	
90		shelf	1	
91		rt. crisper	1	
92		left crisper	1	
93		top shelf door	1	
94		shelf	1	
95		bottom shelf	1	
96		chair	1	
97		wall	1	
98		shelf	1	
99		wall	1	
100		wall	1	
101		wall	1	
102	✓	step ladder	1	✓

Radiological Survey Continuation Sheet

Page 5 of 10

Date 10/18/00

No.	Time	Location	Inst. Used	Total Activity (dpm/100 cm ²)
103		Floor	1	See attached LSC Printout
104		"	1	
105		"	1	
106		"	1	
107		top shelf	1	
108		bottom shelf	1	
109		left counter	1	
110		right counter	1	
111		left metal	1	
112		rt. metal	1	
113		outside drawers	1	
114		pull out	1	
115		top drawer	1	
116		drawer	1	
117		bottom drawer	1	
118		outside drawers	1	
119		top drawer	1	
120		drawer	1	
121		bottom drawer	1	
122		Floor	1	
123		"	1	
124		counter	1	
125		"	1	
126		shield	1	
127		outside cabinets	1	
128		left	1	
129		bottom	1	
130	✓	rt.	1	✓

Job Location: 118D/D211
 Survey Purpose: Radiological Assessment
 Performed By: Paul Jones

Page: 7 of 10
 Date: 10/18/00

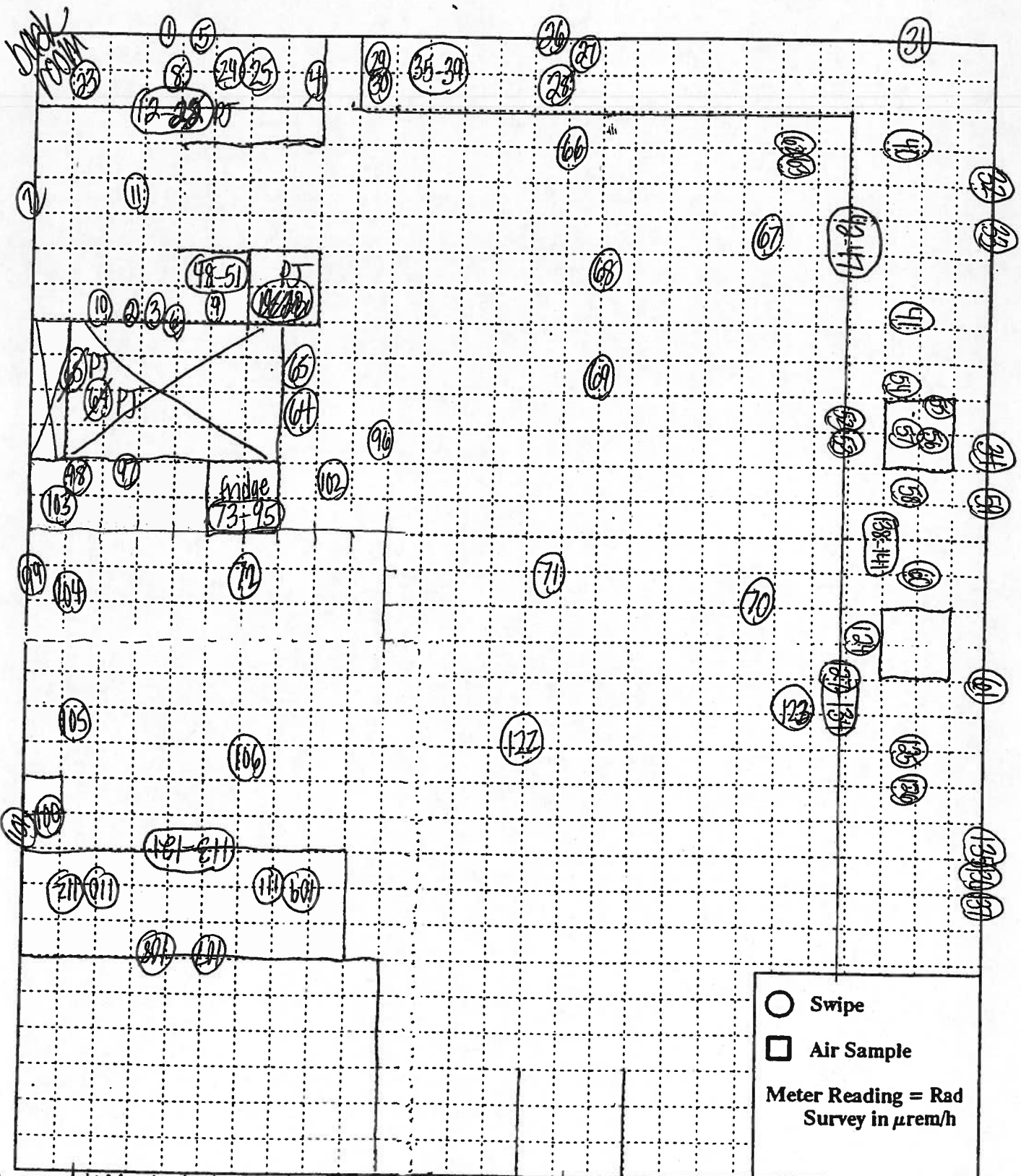

Surveyed 100% of all lower surfaces using instrument #2. All areas were noted to be at a level of normal background.

exit

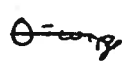

IB EQUIPMENT SURVY

18 OCT 2000 13:37

USER: 3 COMMENT: EQUIPMENT SURVEY

RESET TIME : 1.00
 DATA CALC : DL DPM H# : YES SAMPLE REPEATS: 1 PRINTER : EDIT
 COUNT BLANK : YES IC# : NO REPLICATES : 1 RS232 : EDIT
 TWO PHASE : NO AQC : YES CYCLE REPEATS : 1
 SCINTILLATOR: LIQUID LUMEX: YES LOW SAMPLE REJ: 0
 LOW LEVEL : NO HALF LIFE CORRECTION DATE: none

ISOTOPE 1: 3H %ERROR: 2.00 FACTOR: 1.0000 BKG. SUB: 0
 ISOTOPE 2: 14C %ERROR: 2.00 FACTOR: 1.0000 BKG. SUB: 0
 WIDE OPEN WINDOW %ERROR: 0.00 FACTOR: 1.0000 BKG. SUB: 0

BACKGROUND QUENCH CURVE: Off COLOR QUENCH CORRECTION: Off

Quench Limits Low: 13.688 High: 306.34

SAM NO	H#	3H CPM	14C CPM	WIDE CPM	3H DPM	14C DPM	LUMEX %	
B1	74.4	27.00	12.00	47.00	50.46	15.60	3.01	
		Blank Average	DPM	for	3H :	50.46	COEF. OF VAR:	0.000
		Blank Average	DPM	for	14C :	15.60	COEF. OF VAR:	0.000
1	75.9	20.00	12.00	39.00	-14.41	0.12	2.44	
2	74.1	21.00	8.00	38.00	-10.60	-5.25	2.44	
3	77.6	22.00	9.00	42.00	-8.34	-3.91	2.62	
4	74.5	19.00	12.00	42.00	-16.74	0.13	1.47	
5	75.3	20.00	9.00	43.00	-12.98	-3.89	1.60	
6	74.5	19.00	9.00	36.00	-15.22	-3.88	1.86	
7	75.0	23.00	6.00	37.00	-5.23	-7.95	1.69	
8	86.6	21.00	12.00	40.00	-10.27	0.18	4.08	
9	82.5	19.00	10.00	35.00	-14.37	-2.50	1.92	
10	86.7	14.00	10.00	29.00	-24.74	-2.39	3.45	
11	83.7	15.00	9.00	33.00	-22.38	-3.77	2.12	
12	79.0	12.00	14.00	35.00	-32.03	2.96	1.55	
13	76.9	20.00	12.00	40.00	-14.23	0.13	1.44	
14	89.2	16.00	9.00	33.00	-19.35	-3.76	4.75	
15	77.9	20.00	10.00	38.00	-13.05	-2.54	2.47	
16	78.1	9.00	12.00	30.00	-37.46	0.32	2.15	
17	83.8	24.00	11.00	48.00	-3.72	-1.23	2.33	
18	86.8	22.00	12.00	42.00	-7.99	0.16	1.72	
19	83.0	22.00	12.00	45.00	-8.79	0.14	1.17	
20	75.2	19.00	9.00	37.00	-15.11	-3.88	1.66	
21	78.4	10.00	17.00	33.00	-37.89	7.00	1.63	
22	77.7	16.00	11.00	34.00	-22.09	-1.14	1.85	
23	82.3	15.00	13.00	35.00	-24.69	1.59	1.48	
24	82.8	20.00	10.00	38.00	-12.13	-2.51	1.78	
25	81.5	14.00	8.00	32.00	-24.33	-5.10	1.61	
26	78.7	21.00	11.00	42.00	-11.28	-1.21	1.26	
27	90.2	9.00	12.00	31.00	-36.70	0.42	3.78	
28	87.0	16.00	10.00	32.00	-20.23	-2.42	2.26	
29	81.4	15.00	11.00	33.00	-23.76	-1.10	1.97	
30	78.2	3.00	11.00	25.00	-49.73	-0.92	3.66	
31	80.9	16.00	14.00	37.00	-23.23	2.91	2.71	
32	85.7	14.00	9.00	32.00	-24.32	-3.74	1.32	
33	84.1	20.00	6.00	37.00	-9.77	-7.88	2.17	
34	81.1	19.00	10.00	38.00	-14.62	-2.51	3.04	
35	83.6	19.00	8.00	36.00	-13.12	-5.18	1.27	
36	87.8	22.00	8.00	37.00	-5.60	-5.21	2.22	

SAM NO	H#	3H CPM	14C CPM	WIDE CPM	3H DPM	14C DPM	LUMEX %
37	89.6	23.00	7.00	46.00	-2.38	-6.57	2.87
38	80.1	18.00	10.00	34.00	-16.95	-2.49	2.23
39	76.1	24.00	15.00	47.00	-7.46	4.07	1.19
40	85.5	24.00	11.00	45.00	-3.32	-1.22	1.05
41	90.1	12.00	10.00	31.00	-28.81	-2.33	1.97
42	81.8	18.00	11.00	39.00	-17.19	-1.14	1.61
43	77.9	18.00	9.00	33.00	-16.78	-3.85	1.89
44	75.8	16.00	4.00	25.00	-18.79	-10.51	1.94
45	86.2	11.00	11.00	35.00	-31.99	-0.99	2.00
46	80.4	26.00	5.00	36.00	2.95	-9.33	2.58
47	79.8	18.00	10.00	35.00	-16.99	-2.50	2.26
48	85.3	11.00	15.00	38.00	-34.22	4.38	3.72
49	79.0	19.00	11.00	39.00	-15.51	-1.18	1.76
50	77.7	22.00	12.00	42.00	-9.86	0.10	1.06
51	83.9	20.00	9.00	34.00	-11.40	-3.85	1.38
52	77.4	20.00	11.00	41.00	-13.64	-1.20	1.39
53	80.5	24.00	5.00	41.00	-1.33	-9.30	1.60
54	84.5	26.00	11.00	49.00	0.84	-1.26	1.15
55	74.4	17.00	10.00	38.00	-19.93	-2.51	1.35
56	78.3	14.00	19.00	44.00	-30.40	9.61	1.29
57	81.5	25.00	14.00	49.00	-3.66	2.76	1.02
58	91.8	14.00	12.00	42.00	-25.16	0.34	1.59
59	77.2	20.00	11.00	38.00	-13.67	-1.21	1.64
60	74.6	15.00	4.00	26.00	-21.06	-10.49	2.63
61	77.0	12.00	14.00	37.00	-32.20	2.94	1.40
62	77.9	17.00	13.00	42.00	-20.96	1.53	1.87
63	80.5	14.00	9.00	33.00	-24.98	-3.77	1.62
64	76.2	19.00	12.00	42.00	-16.46	0.14	1.26
65	76.7	12.00	13.00	34.00	-31.71	1.60	1.32
66	85.3	15.00	9.00	34.00	-22.16	-3.76	1.50
67	90.5	17.00	11.00	36.00	-17.98	-1.07	1.73
68	87.3	13.00	9.00	31.00	-26.34	-3.71	1.88
69	87.7	14.00	9.00	37.00	-24.05	-3.73	2.13
70	94.2	16.00	6.00	33.00	-16.82	-7.78	5.96
71	87.7	18.00	13.00	38.00	-17.29	1.58	1.50
72	85.8	13.00	10.00	35.00	-27.06	-2.38	2.78
73	76.9	22.00	6.00	39.00	-6.95	-7.93	1.68
74	82.4	18.00	7.00	32.00	-14.99	-6.51	2.26
75	87.7	13.00	16.00	37.00	-30.10	5.71	1.78
76	79.4	11.00	10.00	31.00	-32.06	-2.38	2.31
77	79.1	22.00	6.00	40.00	-6.47	-7.93	1.20
78	75.6	18.00	13.00	34.00	-19.17	1.49	1.17
79	77.5	12.00	10.00	35.00	-30.10	-2.41	1.64
80	76.6	16.00	5.00	33.00	-19.17	-9.17	1.71
81	79.0	17.00	11.00	39.00	-19.77	-1.14	0.73
82	76.5	17.00	6.00	30.00	-17.59	-7.85	1.46
83	77.6	21.00	16.00	48.00	-14.04	5.47	0.92
84	82.6	16.00	11.00	38.00	-21.42	-1.10	1.43
85	79.3	12.00	12.00	36.00	-30.96	0.28	0.77
86	79.1	20.00	6.00	41.00	-10.76	-7.89	1.33
87	82.0	11.00	10.00	32.00	-31.84	-2.37	4.45
88	77.9	21.00	9.00	42.00	-10.40	-3.90	1.79
89	77.4	17.00	11.00	37.00	-20.01	-1.15	1.35
90	78.6	17.00	9.00	29.00	-18.80	-3.83	3.29
91	76.6	13.00	8.00	35.00	-27.05	-5.11	1.83
92	80.8	15.00	6.00	32.00	-21.22	-7.80	2.08
93	76.8	16.00	6.00	33.00	-19.65	-7.83	1.39
94	78.5	17.00	12.00	35.00	-20.37	0.19	1.83

SAM NO	H#	3H CPM	14C CPM	WIDE CPM	3H DPM	14C DPM	LUMEX %
5	81.0	25.00	15.00	46.00	-4.30	4.10	1.53
76	78.7	13.00	11.00	34.00	-28.37	-1.08	1.62
97	82.0	17.00	10.00	37.00	-18.80	-2.47	1.82
98	81.5	20.00	5.00	38.00	-9.77	-9.23	1.19
99	78.9	12.00	9.00	32.00	-29.46	-3.74	1.30
100	76.2	18.00	15.00	39.00	-20.11	4.17	1.20
101	78.6	18.00	7.00	37.00	-15.63	-6.52	1.04
102	95.5	14.00	10.00	41.00	-23.53	-2.34	14.91
103	91.7	21.00	12.00	42.00	-9.21	0.21	2.10
104	88.5	12.00	5.00	25.00	-26.25	-9.07	3.41
105	89.5	19.00	7.00	38.00	-11.43	-6.50	1.61
106	90.6	10.00	11.00	28.00	-33.85	-0.95	2.62
107	88.1	20.00	12.00	40.00	-12.19	0.21	1.51
108	86.4	15.00	3.00	27.00	-18.77	-11.82	3.78
109	85.6	20.00	9.00	46.00	-11.06	-3.84	1.41
110	86.9	17.00	8.00	35.00	-16.95	-5.13	1.22
111	91.6	19.00	12.00	42.00	-13.78	0.25	1.98
112	85.6	19.00	17.00	48.00	-17.57	6.93	1.69
113	79.6	13.00	17.00	34.00	-31.39	6.97	1.86
114	87.8	16.00	13.00	39.00	-21.75	1.62	2.30
115	93.0	15.00	10.00	32.00	-21.59	-2.37	4.45
116	84.5	11.00	11.00	31.00	-32.14	-1.01	1.63
117	85.1	18.00	11.00	39.00	-16.64	-1.12	1.22
118	84.0	22.00	11.00	40.00	-8.06	-1.20	1.43
119	90.4	24.00	9.00	43.00	-1.02	-3.89	2.41
120	83.4	22.00	14.00	45.00	-9.77	2.83	1.09
121	86.3	14.00	7.00	37.00	-23.17	-6.43	1.26
122	82.5	12.00	11.00	41.00	-30.15	-1.04	1.50
123	91.3	21.00	12.00	43.00	-9.28	0.21	1.26
124	87.4	18.00	10.00	39.00	-15.71	-2.45	2.07
125	96.2	14.00	10.00	31.00	-23.42	-2.33	2.42
126	90.2	15.00	7.00	32.00	-20.34	-6.43	3.96
127	81.5	23.00	10.00	41.00	-5.89	-2.57	1.43
128	85.1	19.00	9.00	39.00	-13.38	-3.83	1.65
129	88.7	15.00	11.00	32.00	-22.77	-1.05	3.17
130	82.4	11.00	11.00	31.00	-32.33	-1.02	1.76
131	84.6	23.00	11.00	38.00	-5.72	-1.21	1.17
132	87.8	11.00	7.00	25.00	-29.67	-6.37	2.60
133	82.1	20.00	11.00	41.00	-12.79	-1.18	1.25
134	84.0	32.00	10.00	52.00	14.41	-2.71	0.69
135	83.8	24.00	6.00	42.00	-1.07	-7.95	1.54
136	92.5	14.00	14.00	39.00	-26.20	3.04	1.97
137	84.9	15.00	10.00	34.00	-22.75	-2.42	2.26
138	86.3	22.00	8.00	44.00	-5.94	-5.22	1.03
139	83.6	20.00	9.00	36.00	-11.46	-3.85	1.16
140	85.5	19.00	8.00	35.00	-12.75	-5.17	1.22
141	84.4	22.00	12.00	42.00	-8.52	0.15	1.44