

Radiological Survey Sheet

Job Location Pfizer Central Research Grafton 1180/D210 Page 1 of 20
 Survey Purpose Radiological Assessment Date 1/16/01
 Performed By Pam Jones (Print) Pam Jones (Sign)

| | | |
|--|--|------------------------|
| Inst.(1) (Model/SN) Beckman LS 6500 #7069448 | Inst.(2) Ludlum model 2241-2 (Model/SN) #137757 | Inst.(3) (Model/SN) |
| Det. Internal (Model/SN) | Det. Ludlum 43-68 (Model/SN) #140899 | Det. (Model/SN) |
| Eff. See LSC Printout | Eff. ~ 850 C-14 | Eff. |
| Type rad. β | Type rad. β | Type rad. |
| Bkgd. See LSC Printout | Bkgd. 300 cpm | Bkgd. |
| Cal. Due: 12/00 <u>0012/01</u> | Cal. Due <u>01/02 + 13/01 + 4/28/01</u> | Cal. due |

| No. | Time | Location | Inst. Used | Total Activity (dpm/100 cm ²) |
|-----|------|-------------------|------------|---|
| 1. | 8:00 | door | 1 | See attached LSC Printout |
| 2. | | wall | 1 | |
| 3. | | " | 1 | |
| 4. | | " | 1 | |
| 5. | | outside hood side | 1 | |
| 6. | | floor | 1 | |
| 7. | | " | 1 | |
| 8. | | " | 1 | |
| 9. | | " | 1 | |
| 10. | | " | 1 | |
| 11. | | " | 1 | |
| 12. | | left outside hood | 1 | |
| 13. | | top | 1 | |
| 14. | | right | 1 | |
| 15. | | ledge | 1 | |
| 16. | | glass + handle | 1 | |
| 17. | | left inside hood | 1 | |
| 18. | ✓ | top back | 1 | |

Radiological Survey Continuation Sheet

Page 2 of 20

Date 1/16/01

| No. | Time | Location | Inst. Used | Total Activity (dpm/100 cm ²) |
|-----|------|--------------|------------|---|
| 19 | | center back | 1 | See attached LSC Printout |
| 20 | | bottom back | 1 | |
| 21 | | right side | 1 | |
| 22 | | left counter | 1 | |
| 23 | | rt. counter | 1 | (See # 302) |
| 24 | | cup sink | 1 | |
| 25 | | out. cabinet | 1 | |
| 26 | | left | 1 | |
| 27 | | bottom | 1 | |
| 28 | | right | 1 | |
| 29 | | out. cabinet | 1 | |
| 30 | | left | 1 | |
| 31 | | bottom | 1 | |
| 32 | | right | 1 | |
| 33 | | wall | 1 | |
| 34 | | edge | 1 | |
| 35 | | out. shelves | 1 | |
| 36 | | top shelf | 1 | |
| 37 | | shelf | 1 | |
| 38 | | bot. shelf | 1 | |
| 39 | | out. shelves | 1 | |
| 40 | | top shelf | 1 | |
| 41 | | shelf | 1 | |
| 42 | | " | 1 | |
| 43 | | bot. shelf | 1 | |
| 44 | | top shelf | 1 | |
| 45 | | shelf | 1 | |
| 46 | ✓ | left shelf | 1 | ✓ |

Radiological Survey Continuation Sheet

Page 3 of 20

Date 1/16/01

| No. | Time | Location | Inst. Used | Total Activity (dpm/100 cm ²) |
|-----|------|--------------|------------|---|
| 47 | | right shelf | 1 | See attached LSC Printout |
| 48 | | desk top | 1 | |
| 49 | | top shelf | 1 | |
| 50 | | shelf | 1 | |
| 51 | | bot. shelf | 1 | |
| 52 | | top shelf | 1 | |
| 53 | | shelf | 1 | |
| 54 | | bot. shelf | 1 | |
| 55 | | Charger | 1 | |
| 56 | | " | 1 | |
| 57 | | " | 1 | |
| 58 | | Cup sink | 1 | |
| 59 | | out. drawers | 1 | |
| 60 | | pull-out | 1 | |
| 61 | | drawer | 1 | |
| 62 | | " | 1 | |
| 63 | | bot. drawer | 1 | |
| 64 | | drawer | 1 | |
| 65 | | out. drawers | 1 | |
| 66 | | top drawer | 1 | |
| 67 | | drawer | 1 | |
| 68 | | " | 1 | |
| 69 | | bot. drawer | 1 | |
| 70 | | drawer | 1 | |
| 71 | | out. drawers | 1 | |
| 72 | | top drawer | 1 | |
| 73 | | drawer | 1 | |
| 74 | ✓ | " | 1 | ✓ (See #303) |

Radiological Survey Continuation Sheet

Page 4 of 20

Date 1/16/01

| No. | Time | Location | Inst. Used | Total Activity (dpm/100 cm ²) |
|-----|------|----------------|------------|---|
| 75 | | bottom drawer | 1 | See attached LSC Printout |
| 76 | | drawer | 1 | |
| 77 | | out. drawers | 1 | |
| 78 | | top drawer | 1 | |
| 79 | | top shelf | 1 | |
| 80 | | bottom shelf | 1 | |
| 81 | | floor | 1 | |
| 82 | | " | 1 | |
| 83 | | " | 1 | |
| 84 | | shelf | 1 | |
| 85 | | out. shelves | 1 | |
| 86 | | top shelf | 1 | |
| 87 | | shelf | 1 | |
| 88 | | " | 1 | |
| 89 | | bot. shelf | 1 | |
| 90 | | out. shelves | 1 | |
| 91 | | shelf | 1 | |
| 92 | | " | 1 | |
| 93 | | bot. shelf | 1 | |
| 94 | | wall | 1 | |
| 95 | | counter | 1 | |
| 96 | | " | 1 | |
| 97 | | " | 1 | |
| 98 | | cup sink | 1 | |
| 99 | | sides of sink | 1 | |
| 100 | | bottom & drain | 1 | |
| 101 | | out. cabinet | 1 | |
| 102 | ✓ | eft | 1 | ✓ |

Radiological Survey Continuation Sheet

Page 5 of 20
 Date 1/16/01

| No. | Time | Location | Inst. Used | Total Activity (dpm/100 cm ²) |
|-----|------|--------------|------------|---|
| 103 | | bottom | 1 | See attached LSC Printout |
| 104 | | right | 1 | |
| 105 | | out. drawers | 1 | |
| 106 | | top drawer | 1 | |
| 107 | | drawer | 1 | |
| 108 | | " | 1 | |
| 109 | | bot. drawer | 1 | |
| 110 | | drawer | 1 | |
| 111 | | out. drawers | 1 | |
| 112 | | top drawer | 1 | |
| 113 | | drawer | 1 | |
| 114 | | " | 1 | |
| 115 | | bot. drawer | 1 | |
| 116 | | top shelf | 1 | |
| 117 | | shelf | 1 | |
| 118 | | bot. shelf | 1 | |
| 119 | | counter | 1 | |
| 120 | | " | 1 | |
| 121 | | " | 1 | |
| 122 | | out. drawers | 1 | |
| 123 | | pull-out | 1 | |
| 124 | | drawer | 1 | |
| 125 | | bot. drawer | 1 | |
| 126 | | out. drawers | 1 | |
| 127 | | top drawer | 1 | |
| 128 | | bot. drawer | 1 | |
| 129 | | out. drawers | 1 | |
| 130 | ✓ | pull-out | 1 | ✓ |

Radiological Survey Continuation Sheet

Page 6 of 20
 Date 1/16/01

| No. | Time | Location | Inst. Used | Total Activity (dpm/100 cm ²) |
|-----|------|--------------|------------|---|
| 131 | | drawer | | |
| 132 | | bot. drawer | 1 | See attached LSC Printout (see #304) |
| 133 | | out. shelves | 1 | |
| 134 | | top shelf | 1 | |
| 135 | | shelf | 1 | |
| 136 | | " | 1 | |
| 137 | | bot. shelf | 1 | |
| 138 | | out. shelves | 1 | |
| 139 | | top shelf | 1 | |
| 140 | | shelf | 1 | |
| 141 | | " | 1 | |
| 142 | | bot. shelf | 1 | |
| 143 | | out. shelves | 1 | |
| 144 | | top shelf | 1 | |
| 145 | | shelf | 1 | |
| 146 | | " | 1 | |
| 147 | | bot. shelf | 1 | (see #305) |
| 148 | | counter | 1 | |
| 149 | | " | 1 | |
| 150 | | " | 1 | |
| 151 | | top shelf | 1 | |
| 152 | | shelf | 1 | |
| 153 | | left shelf | 1 | |
| 154 | | rt. shelf | 1 | |
| 155 | | desk top | 1 | |
| 156 | | out. drawers | 1 | |
| 157 | | top drawer | 1 | |
| 158 | ✓ | top shelf | 1 | ✓ |

Radiological Survey Continuation Sheet

Page 7 of 20
Date 1/17/01

| No. | Time | Location | Inst. Used | Total Activity (dpm/100 cm ²) |
|-----|------|--------------|------------|---|
| 159 | | bot. shelf | 1 | See attached LSC Printout |
| 160 | | out. drawers | 1 | |
| 161 | | top drawer | 1 | |
| 162 | | drawer | 1 | |
| 163 | | " | 1 | |
| 164 | | bot. drawer | 1 | |
| 165 | | drawer | 1 | |
| 166 | | out. drawers | 1 | |
| 167 | | top drawer | 1 | |
| 168 | | drawer | 1 | |
| 169 | | " | 1 | |
| 170 | | bot. drawer | 1 | |
| 171 | | drawer | 1 | |
| 172 | | " | 1 | |
| 173 | | out. drawers | 1 | |
| 174 | | pull-out | 1 | |
| 175 | | drawer | 1 | |
| 176 | | " | 1 | |
| 177 | | bot. drawer | 1 | |
| 178 | | top ledge | 1 | |
| 179 | | bottom ledge | 1 | |
| 180 | | floor | 1 | |
| 181 | | " | 1 | |
| 182 | | " | 1 | |
| 183 | | " | 1 | |
| 184 | | top shelf | 1 | |
| 185 | | shelf | 1 | |
| 186 | ✓ | left shelf | 1 | ✓ |

Radiological Survey Continuation Sheet

Page 8 of 20

Date 1/17/01

| No. | Time | Location | Inst. Used | Total Activity (dpm/100 cm ²) |
|-----|------|--------------|------------|---|
| 187 | | lf. shelf | 1 | See attached LSC Printout |
| 188 | | desk top | 1 | |
| 189 | | top shelf | 1 | |
| 190 | | shelf | 1 | |
| 191 | | bot. shelf | 1 | |
| 192 | | top shelf | 1 | (See # 306) |
| 193 | | shelf | 1 | |
| 194 | | bot. shelf | 1 | |
| 195 | | counter | 1 | |
| 196 | | " | 1 | |
| 197 | | " | 1 | |
| 198 | | cup sink | 1 | |
| 199 | | out. drawers | 1 | |
| 200 | | inlet-out | 1 | |
| 201 | | shelf | 1 | |
| 202 | | " | 1 | |
| 203 | | bot. shelf | 1 | |
| 204 | | drawer | 1 | |
| 205 | | out. drawers | 1 | |
| 206 | | top drawer | 1 | |
| 207 | | drawer | 1 | |
| 208 | | " | 1 | |
| 209 | | bot. drawer | 1 | |
| 210 | | drawer | 1 | |
| 211 | | out. drawers | 1 | |
| 212 | | top drawer | 1 | |
| 213 | | drawer | 1 | |
| 214 | ✓ | " | 1 | ✓ |

Radiological Survey Continuation Sheet

Page 9 of 20
 Date 1/17/01

| No. | Time | Location | Inst. Used | Total Activity (dpm/100 cm ²) |
|-----|------|--------------|------------|---|
| 215 | | bot. drawer | 1 | See attached LSC Printout |
| 216 | | drawer | 1 | |
| 217 | | out. drawers | 1 | |
| 218 | | top drawer | 1 | |
| 219 | | top shelf | 1 | |
| 220 | | bot. shelf | 1 | |
| 221 | | floor | 1 | |
| 222 | | " | 1 | |
| 223 | | " | 1 | |
| 224 | | " | 1 | |
| 225 | | " | 1 | |
| 226 | | " | 1 | |
| 227 | | counter | 1 | |
| 228 | | " | 1 | |
| 229 | | " | 1 | |
| 230 | | " | 1 | |
| 231 | | chamber | 1 | |
| 232 | | shelf | 1 | |
| 233 | | " | 1 | |
| 234 | | " | 1 | |
| 235 | | " | 1 | |
| 236 | | " | 1 | |
| 237 | | out. cabinet | 1 | |
| 238 | | top drawer | 1 | |
| 239 | | top shelf | 1 | |
| 240 | | bot. shelf | 1 | |
| 241 | | out. drawers | 1 | |
| 242 | ✓ | left drawer | 1 | ✓ |

Radiological Survey Continuation Sheet

Page 10 of 20

Date 1/17/01

| No. | Time | Location | Inst. Used | Total Activity (dpm/100 cm ²) |
|-----|------|-------------------|------------|---|
| 243 | | left drawer | 1 | See attached LSC Printout |
| 244 | | rt. drawer | 1 | |
| 245 | | " | 1 | |
| 246 | | " | 1 | |
| 247 | | drawer | 1 | |
| 248 | | bot. drawer | 1 | |
| 249 | | top shelf | 1 | |
| 250 | | bot. shelf | 1 | |
| 251 | | out. shelves | 1 | |
| 252 | | top shelf | 1 | |
| 253 | | shelf | 1 | |
| 254 | | " | 1 | |
| 255 | | bot. shelf | 1 | |
| 256 | | top shelf | 1 | |
| 257 | | bot. shelf | 1 | |
| 258 | | pipetting machine | 1 | |
| 259 | | " | 1 | |
| 260 | | counter | 1 | |
| 261 | | " | 1 | |
| 262 | | " | 1 | |
| 263 | | out. drawers | 1 | |
| 264 | | top drawer | 1 | |
| 265 | | top shelf | 1 | |
| 266 | | bot. shelf | 1 | (see #307) |
| 267 | | out. drawers | 1 | |
| 268 | | top drawer | 1 | |
| 269 | | drawer | 1 | |
| 270 | ✓ | " | 1 | ✓ |

Radiological Survey Continuation Sheet

Page 11 of 20

Date 1/17/01

| No. | Time | Location | Inst. Used | Total Activity (dpm/100 cm ²) |
|-----|------|--------------------|------------|---|
| 271 | | bot. drawer | 1 | See attached LSC Printout |
| 272 | | drawer | 1 | |
| 273 | | out. drawers | 1 | |
| 274 | | top drawer | 1 | |
| 275 | | drawer | 1 | |
| 276 | | " | 1 | |
| 277 | | bot. drawer | 1 | |
| 278 | | drawer | 1 | |
| 279 | | " | 1 | |
| 280 | | out. drawers | 1 | |
| 281 | | pull-out | 1 | |
| 282 | | drawer | 1 | |
| 283 | | " | 1 | |
| 284 | | bot. drawer | 1 | |
| 285 | | automatic pipettor | 1 | |
| 286 | | shelves | 1 | |
| 287 | | floor | 1 | |
| 288 | | " | 1 | |
| 289 | | " | 1 | |
| 290 | | " | 1 | |
| 291 | | glass | 1 | |
| 292 | | " | 1 | |
| 293 | | shelves | 1 | |
| 294 | | desk | 1 | |
| 295 | | shelves | 1 | |
| 296 | | floor | 1 | |
| 297 | | top shelf | 1 | |
| 298 | | shelf | 1 | |

D-wipe location

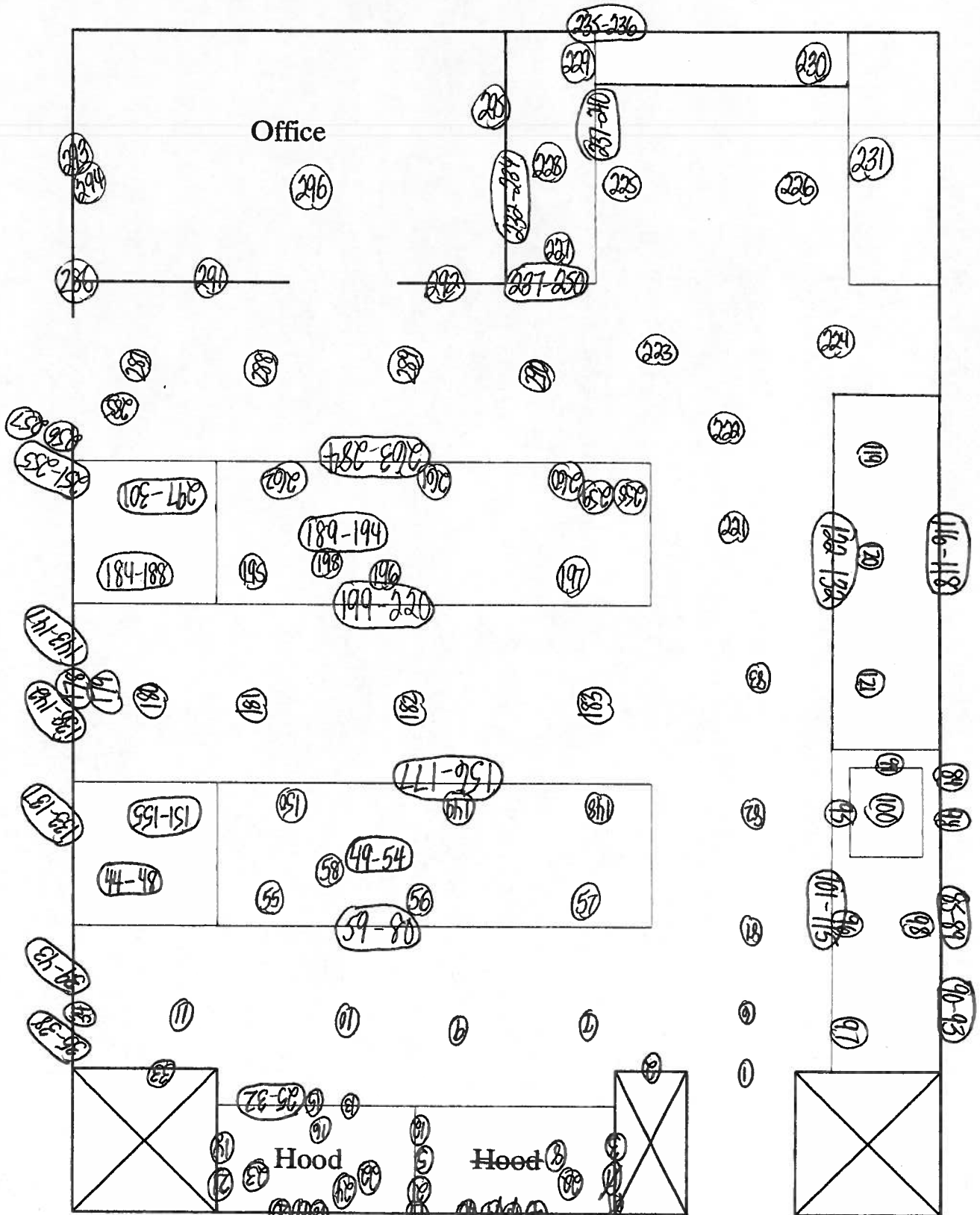

Surveyed 100% of all lower surfaces using instrument #2.
All areas were noted to be at a level of normal background.

ID: MONTHLY WIPES

17 JAN 2001 15:24

USER: 4 COMMENT:

RESET TIME : 1.00
 DATA CALC : DL DPM H# : YES SAMPLE REPEATS: 1 PRINTER : EDIT
 COUNT BLANK : YES IC# : NO REPLICATES : 1 RS232 : EDIT
 TWO PHASE : NO AQC : YES CYCLE REPEATS : 1
 SCINTILLATOR: LIQUID LUMEX: YES LOW SAMPLE REJ: 0
 LOW LEVEL : NO HALF LIFE CORRECTION DATE: none

ISOTOPE 1: 3H %ERROR: 2.00 FACTOR: 1.0000 BKG. SUB: 0
 ISOTOPE 2: 14C %ERROR: 2.00 FACTOR: 1.0000 BKG. SUB: 0
 WIDE OPEN WINDOW %ERROR: 0.00 FACTOR: 1.0000 BKG. SUB: 0

BACKGROUND QUENCH CURVE: Off COLOR QUENCH CORRECTION: Off

Quench Limits Low: 13.688 High: 306.34

| SAM NO | H# | 3H CPM | 14C CPM | WIDE CPM | 3H DPM | 14C DPM | RATIO | LUMEX % |
|--------|-------|-----------------------|---------|----------|--------|---------------|--------|---------|
| B1 | 80.3 | 10.00 | 5.00 | 23.00 | 18.93 | 6.53 | 2.897 | 4.07 |
| | | Blank Average DPM for | | 3H : | 18.93 | COEF. OF VAR: | 0.000 | |
| | | Blank Average DPM for | | 14C : | 6.53 | COEF. OF VAR: | 0.000 | |
| 1 | 81.8 | 13.00 | 13.00 | 33.00 | 2.43 | 10.68 | 0.228 | 4.76 |
| 2 | 97.1 | 12.00 | 8.00 | 31.00 | 4.69 | 4.07 | 1.153 | 4.09 |
| 3 | 98.8 | 12.00 | 12.00 | 32.00 | 2.57 | 9.49 | 0.271 | 3.10 |
| 4 | 92.5 | 8.00 | 14.00 | 30.00 | -8.42 | 12.21 | -0.690 | 4.85 |
| 5 | 85.0 | 10.00 | 4.00 | 22.00 | 0.98 | -1.33 | -0.733 | 4.61 |
| 6 | 83.0 | 14.00 | 8.00 | 28.00 | 7.39 | 3.97 | 1.863 | 1.67 |
| 7 | 84.7 | 16.00 | 8.00 | 35.00 | 12.01 | 3.94 | 3.048 | 2.68 |
| 8 | 109.8 | 15.00 | 15.00 | 40.00 | 9.67 | 13.61 | 0.711 | 2.82 |
| 9 | 88.9 | 24.00 | 9.00 | 46.00 | 30.12 | 5.16 | 5.835 | 1.49 |
| 10 | 84.5 | 11.00 | 10.00 | 28.00 | -0.08 | 6.71 | -0.012 | 1.74 |
| 11 | 93.2 | 13.00 | 7.00 | 33.00 | 7.06 | 2.68 | 2.633 | 1.73 |
| 12 | 82.8 | 17.00 | 8.00 | 33.00 | 13.90 | 3.91 | 3.551 | 1.66 |
| 13 | 82.4 | 17.00 | 11.00 | 31.00 | 12.26 | 7.94 | 1.545 | 2.31 |
| 14 | 84.1 | 15.00 | 9.00 | 36.00 | 9.20 | 5.30 | 1.736 | 1.74 |
| 15 | 87.1 | 16.00 | 15.00 | 36.00 | 8.59 | 13.37 | 0.643 | 1.98 |
| 16 | 86.3 | 13.00 | 15.00 | 36.00 | 1.83 | 13.41 | 0.137 | 1.46 |
| 17 | 91.8 | 13.00 | 12.00 | 34.00 | 4.08 | 9.42 | 0.433 | 1.87 |
| 18 | 88.4 | 9.00 | 13.00 | 26.00 | -5.84 | 10.81 | -0.540 | 2.98 |
| 19 | 81.0 | 15.00 | 10.00 | 33.00 | 8.25 | 6.62 | 1.245 | 1.54 |
| 20 | 81.0 | 12.00 | 6.00 | 21.00 | 3.86 | 1.31 | 2.947 | 3.78 |
| 21 | 86.8 | 17.00 | 14.00 | 40.00 | 11.33 | 12.00 | 0.944 | 1.34 |
| 22 | 80.6 | 22.00 | 13.00 | 50.00 | 21.73 | 10.52 | 2.064 | 0.91 |
| 23 | 81.1 | 14.00 | 14.00 | 38.00 | 4.01 | 12.00 | 0.334 | 1.55 |
| 24 | 79.5 | 14.00 | 7.00 | 27.00 | 7.46 | 2.61 | 2.858 | 2.17 |
| 25 | 79.4 | 9.00 | 10.00 | 25.00 | -4.82 | 6.71 | -0.718 | 1.53 |
| 26 | 80.1 | 15.00 | 7.00 | 28.00 | 9.69 | 2.60 | 3.734 | 1.23 |
| 27 | 80.4 | 14.00 | 14.00 | 39.00 | 3.93 | 12.00 | 0.328 | 1.12 |
| 28 | 84.0 | 6.00 | 10.00 | 33.00 | -11.09 | 6.79 | -1.633 | 1.28 |
| 29 | 78.5 | 11.00 | 8.00 | 33.00 | 0.42 | 4.00 | 0.105 | 1.25 |
| 30 | 78.9 | 17.00 | 9.00 | 37.00 | 12.78 | 5.24 | 2.440 | 0.90 |
| 31 | 80.8 | 10.00 | 12.00 | 27.00 | -3.62 | 9.39 | -0.386 | 0.63 |
| 32 | 78.2 | 15.00 | 9.00 | 31.00 | 8.40 | 5.27 | 1.595 | 1.35 |
| 33 | 78.1 | 10.00 | 5.00 | 26.00 | -0.20 | -0.01 | 33.726 | 1.34 |
| 34 | 86.2 | 10.00 | 12.00 | 34.00 | -3.22 | 9.43 | -0.341 | 1.18 |
| 35 | 77.1 | 15.00 | 8.00 | 29.00 | 8.77 | 3.92 | 2.236 | 1.15 |
| 36 | 75.3 | 14.00 | 14.00 | 45.00 | 3.40 | 11.95 | 0.285 | 1.20 |

| SAM NO | H# | 3H CPM | 14C CPM | WIDE CPM | 3H DPM | 14C DPM | RATIO | LUMEX % |
|--------|-------|--------|---------|----------|--------|---------|--------|---------|
| 37 | 80.6 | 13.00 | 6.00 | 28.00 | 5.97 | 1.29 | 4.622 | 1.40 |
| 38 | 77.1 | 12.00 | 10.00 | 29.00 | 1.39 | 6.65 | 0.209 | 1.86 |
| 39 | 82.3 | 14.00 | 14.00 | 40.00 | 4.14 | 12.01 | 0.344 | 0.85 |
| 40 | 83.8 | 14.00 | 9.00 | 31.00 | 6.96 | 5.31 | 1.310 | 0.92 |
| 41 | 77.7 | 18.00 | 7.00 | 32.00 | 15.74 | 2.54 | 6.201 | 1.31 |
| 42 | 75.3 | 13.00 | 11.00 | 34.00 | 2.82 | 7.96 | 0.354 | 1.52 |
| 43 | 83.1 | 13.00 | 14.00 | 38.00 | 2.04 | 12.04 | 0.169 | 0.74 |
| 44 | 86.8 | 17.00 | 8.00 | 30.00 | 14.56 | 3.93 | 3.705 | 2.04 |
| 45 | 85.2 | 13.00 | 6.00 | 35.00 | 6.54 | 1.30 | 5.010 | 1.52 |
| 46 | 82.7 | 17.00 | 6.00 | 34.00 | 14.94 | 1.23 | 12.152 | 1.38 |
| 47 | 79.1 | 10.00 | 13.00 | 38.00 | -4.25 | 10.71 | -0.397 | 1.94 |
| 48 | 79.9 | 17.00 | 11.00 | 35.00 | 11.88 | 7.92 | 1.500 | 1.37 |
| 49 | 91.3 | 12.00 | 10.00 | 40.00 | 2.85 | 6.74 | 0.423 | 1.09 |
| 50 | 98.1 | 21.00 | 8.00 | 38.00 | 26.09 | 3.90 | 6.688 | 1.43 |
| 51 | 88.4 | 14.00 | 8.00 | 36.00 | 8.11 | 3.99 | 2.032 | 1.54 |
| 52 | 84.0 | 15.00 | 9.00 | 36.00 | 9.19 | 5.30 | 1.735 | 1.68 |
| 53 | 82.8 | 11.00 | 13.00 | 37.00 | -1.82 | 10.73 | -0.170 | 1.03 |
| 54 | 82.8 | 18.00 | 13.00 | 40.00 | 13.44 | 10.61 | 1.267 | 0.59 |
| 55 | 83.4 | 12.00 | 10.00 | 33.00 | 2.01 | 6.69 | 0.300 | 0.86 |
| 56 | 83.1 | 11.00 | 11.00 | 32.00 | -0.74 | 8.04 | -0.092 | 1.15 |
| 57 | 79.7 | 11.00 | 15.00 | 37.00 | -3.10 | 13.38 | -0.232 | 1.53 |
| 58 | 80.3 | 8.00 | 9.00 | 25.00 | -6.40 | 5.39 | -1.186 | 1.73 |
| 59 | 79.6 | 16.00 | 7.00 | 32.00 | 11.76 | 2.58 | 4.565 | 1.43 |
| 60 | 82.4 | 17.00 | 8.00 | 35.00 | 13.84 | 3.91 | 3.537 | 1.14 |
| 61 | 81.4 | 11.00 | 11.00 | 26.00 | -0.89 | 8.03 | -0.110 | 1.40 |
| 62 | 80.1 | 15.00 | 9.00 | 32.00 | 8.66 | 5.28 | 1.641 | 1.31 |
| 63 | 80.6 | 14.00 | 9.00 | 35.00 | 6.56 | 5.30 | 1.239 | 1.18 |
| 64 | 82.6 | 20.00 | 9.00 | 34.00 | 19.87 | 5.20 | 3.819 | 1.61 |
| 65 | 81.7 | 7.00 | 14.00 | 35.00 | -11.11 | 12.13 | -0.916 | 0.67 |
| 66 | 80.4 | 14.00 | 7.00 | 30.00 | 7.58 | 2.61 | 2.900 | 0.95 |
| 67 | 80.8 | 14.00 | 6.00 | 30.00 | 8.16 | 1.27 | 6.398 | 0.79 |
| 68 | 83.9 | 11.00 | 12.00 | 29.00 | -1.20 | 9.39 | -0.127 | 1.17 |
| 69 | 87.2 | 6.00 | 15.00 | 31.00 | -13.69 | 13.54 | -1.011 | 1.01 |
| 70 | 80.1 | 18.00 | 8.00 | 36.00 | 15.63 | 3.89 | 4.021 | 1.24 |
| 71 | 83.3 | 12.00 | 8.00 | 30.00 | 3.05 | 4.00 | 0.763 | 1.02 |
| 72 | 81.9 | 12.00 | 10.00 | 34.00 | 1.85 | 6.68 | 0.278 | 1.08 |
| 73 | 88.5 | 10.00 | 11.00 | 32.00 | -2.49 | 8.10 | -0.308 | 2.13 |
| 74 | 78.5 | 21.00 | 15.00 | 50.00 | 18.15 | 13.20 | 1.375 | 0.68 |
| 75 | 84.1 | 13.00 | 7.00 | 33.00 | 5.87 | 2.64 | 2.219 | 1.03 |
| 76 | 78.7 | 11.00 | 8.00 | 28.00 | 0.44 | 4.00 | 0.111 | 1.20 |
| 77 | 77.6 | 15.00 | 11.00 | 37.00 | 7.30 | 7.94 | 0.919 | 0.66 |
| 78 | 124.4 | 5.00 | 14.00 | 26.00 | -14.69 | 12.62 | -1.164 | 4.40 |
| 79 | 88.1 | 10.00 | 13.00 | 32.00 | -3.62 | 10.79 | -0.335 | 1.11 |
| 80 | 91.8 | 10.00 | 13.00 | 34.00 | -3.33 | 10.82 | -0.308 | 0.79 |
| 81 | 87.5 | 11.00 | 14.00 | 37.00 | -1.97 | 12.11 | -0.163 | 0.72 |
| 82 | 91.8 | 17.00 | 12.00 | 40.00 | 13.21 | 9.35 | 1.414 | 1.10 |
| 83 | 82.4 | 13.00 | 7.00 | 31.00 | 5.67 | 2.64 | 2.149 | 1.04 |
| 84 | 82.2 | 13.00 | 9.00 | 30.00 | 4.58 | 5.32 | 0.862 | 0.75 |
| 85 | 83.5 | 18.00 | 10.00 | 35.00 | 15.14 | 6.59 | 2.300 | 0.86 |
| 86 | 81.3 | 10.00 | 10.00 | 30.00 | -2.53 | 6.71 | -0.377 | 1.05 |
| 87 | 79.1 | 16.00 | 11.00 | 37.00 | 9.62 | 7.93 | 1.213 | 1.05 |
| 88 | 81.3 | 12.00 | 7.00 | 27.00 | 3.37 | 2.65 | 1.270 | 1.09 |
| 89 | 79.8 | 11.00 | 10.00 | 28.00 | -0.50 | 6.68 | -0.075 | 1.24 |
| 90 | 83.0 | 16.00 | 9.00 | 32.00 | 11.23 | 5.27 | 2.129 | 1.13 |
| 91 | 81.4 | 9.00 | 14.00 | 32.00 | -6.79 | 12.09 | -0.561 | 0.83 |
| 92 | 85.2 | 12.00 | 11.00 | 33.00 | 1.65 | 8.04 | 0.206 | 1.92 |
| 93 | 86.0 | 14.00 | 8.00 | 26.00 | 7.79 | 3.98 | 1.957 | 1.47 |
| 94 | 79.5 | 5.00 | 13.00 | 30.00 | -14.95 | 10.80 | -1.384 | 0.92 |

| SAM NO | H# | 3H CPM | 14C CPM | WIDE CPM | 3H DPM | 14C DPM | RATIO | LUMEX % |
|--------|-------|--------|---------|----------|--------|---------|--------|---------|
| 95 | 77.2 | 17.00 | 7.00 | 33.00 | 13.55 | 2.55 | 5.307 | 1.18 |
| 96 | 94.0 | 9.00 | 8.00 | 26.00 | -2.64 | 4.11 | -0.643 | 2.12 |
| 97 | 79.8 | 16.00 | 5.00 | 28.00 | 12.84 | -0.10 | -126.2 | 0.95 |
| 98 | 83.1 | 13.00 | 11.00 | 37.00 | 3.63 | 8.01 | 0.453 | 0.71 |
| 99 | 77.1 | 20.00 | 6.00 | 36.00 | 20.40 | 1.16 | 17.515 | 0.96 |
| 100 | 81.5 | 19.00 | 17.00 | 46.00 | 13.31 | 15.95 | 0.835 | 0.60 |
| 101 | 83.6 | 15.00 | 9.00 | 38.00 | 9.12 | 5.29 | 1.723 | 0.85 |
| 102 | 96.6 | 10.00 | 7.00 | 27.00 | 0.50 | 2.75 | 0.183 | 1.82 |
| 103 | 83.5 | 16.00 | 8.00 | 36.00 | 11.83 | 3.93 | 3.007 | 1.02 |
| 104 | 90.6 | 11.00 | 12.00 | 34.00 | -0.60 | 9.45 | -0.064 | 1.59 |
| 105 | 82.6 | 11.00 | 8.00 | 27.00 | 0.81 | 4.02 | 0.201 | 1.31 |
| 106 | 75.5 | 13.00 | 14.00 | 37.00 | 1.31 | 11.97 | 0.110 | 0.72 |
| 107 | 83.5 | 15.00 | 13.00 | 32.00 | 6.99 | 10.66 | 0.655 | 2.97 |
| 108 | 81.7 | 12.00 | 10.00 | 29.00 | 1.83 | 6.68 | 0.274 | 1.02 |
| 109 | 79.0 | 24.00 | 10.00 | 42.00 | 27.25 | 6.46 | 4.217 | 0.60 |
| 110 | 80.7 | 15.00 | 5.00 | 29.00 | 10.82 | -0.08 | -130.2 | 1.03 |
| 111 | 81.0 | 17.00 | 7.00 | 38.00 | 14.13 | 2.57 | 5.509 | 1.19 |
| 112 | 82.4 | 14.00 | 6.00 | 29.00 | 8.37 | 1.28 | 6.539 | 1.94 |
| 113 | 80.5 | 20.00 | 10.00 | 42.00 | 18.96 | 6.54 | 2.901 | 0.77 |
| 114 | 78.1 | 18.00 | 7.00 | 37.00 | 15.81 | 2.54 | 6.226 | 1.37 |
| 115 | 85.1 | 16.00 | 4.00 | 29.00 | 14.23 | -1.43 | -9.917 | 1.42 |
| 116 | 85.9 | 7.00 | 8.00 | 22.00 | -7.73 | 4.10 | -1.886 | 1.60 |
| 117 | 91.2 | 18.00 | 11.00 | 41.00 | 15.95 | 7.98 | 2.000 | 1.36 |
| 118 | 88.5 | 19.00 | 5.00 | 40.00 | 20.99 | -0.14 | -153.3 | 1.17 |
| 119 | 79.3 | 17.00 | 10.00 | 33.00 | 12.31 | 6.58 | 1.871 | 0.79 |
| 120 | 78.8 | 11.00 | 4.00 | 28.00 | 2.52 | -1.36 | -1.852 | 0.91 |
| 121 | 83.6 | 21.00 | 15.00 | 42.00 | 19.07 | 13.25 | 1.439 | 0.71 |
| 122 | 79.8 | 15.00 | 7.00 | 33.00 | 9.66 | 2.60 | 3.721 | 0.53 |
| 123 | 81.6 | 14.00 | 8.00 | 31.00 | 7.21 | 3.96 | 1.820 | 1.22 |
| 124 | 80.1 | 21.00 | 9.00 | 40.00 | 21.56 | 5.18 | 4.166 | 0.63 |
| 125 | 79.5 | 18.00 | 7.00 | 35.00 | 16.05 | 2.54 | 6.309 | 0.90 |
| 126 | 81.4 | 3.00 | 5.00 | 15.00 | -15.06 | 0.12 | -124.4 | 2.09 |
| 127 | 83.5 | 15.00 | 9.00 | 33.00 | 9.11 | 5.29 | 1.721 | 0.76 |
| 128 | 81.8 | 13.00 | 10.00 | 33.00 | 4.02 | 6.66 | 0.603 | 0.54 |
| 129 | 80.5 | 11.00 | 14.00 | 33.00 | -2.53 | 12.05 | -0.210 | 0.59 |
| 130 | 84.8 | 20.00 | 8.00 | 37.00 | 20.83 | 3.87 | 5.382 | 0.85 |
| 131 | 83.2 | 22.00 | 13.00 | 47.00 | 22.25 | 10.54 | 2.110 | 0.57 |
| 132 | 79.6 | 15.00 | 8.00 | 32.00 | 9.10 | 3.93 | 2.313 | 0.83 |
| 133 | 80.4 | 9.00 | 13.00 | 34.00 | -6.32 | 10.74 | -0.589 | 0.72 |
| 134 | 79.6 | 13.00 | 8.00 | 29.00 | 4.81 | 3.97 | 1.213 | 0.74 |
| 135 | 80.8 | 10.00 | 7.00 | 25.00 | -1.01 | 2.68 | -0.375 | 1.03 |
| 136 | 78.8 | 12.00 | 7.00 | 29.00 | 3.11 | 2.64 | 1.176 | 0.76 |
| 137 | 81.3 | 11.00 | 8.00 | 29.00 | 0.68 | 4.01 | 0.170 | 1.29 |
| 138 | 79.3 | 20.00 | 5.00 | 31.00 | 21.34 | -0.17 | -125.9 | 0.48 |
| 139 | 80.3 | 19.00 | 9.00 | 33.00 | 17.29 | 5.21 | 3.318 | 0.58 |
| 140 | 81.1 | 13.00 | 10.00 | 34.00 | 3.94 | 6.66 | 0.592 | 0.46 |
| 141 | 108.3 | 17.00 | 14.00 | 44.00 | 15.05 | 12.19 | 1.235 | 2.24 |
| 142 | 84.4 | 21.00 | 6.00 | 35.00 | 24.03 | 1.17 | 20.623 | 0.75 |
| 143 | 99.7 | 16.00 | 6.00 | 32.00 | 15.74 | 1.29 | 12.182 | 1.42 |
| 144 | 83.4 | 11.00 | 8.00 | 22.00 | 0.88 | 4.02 | 0.220 | 1.05 |
| 145 | 87.9 | 13.00 | 13.00 | 42.00 | 3.08 | 10.74 | 0.287 | 0.87 |
| 146 | 79.7 | 19.00 | 8.00 | 47.00 | 17.70 | 3.87 | 4.576 | 1.16 |
| 147 | 82.9 | 20.00 | 9.00 | 38.00 | 19.94 | 5.21 | 3.830 | 0.65 |
| 148 | 99.6 | 12.00 | 15.00 | 41.00 | 0.91 | 13.56 | 0.067 | 0.90 |
| 149 | 125.5 | 11.00 | 13.00 | 28.00 | 2.81 | 11.11 | 0.253 | 4.33 |
| 150 | 87.7 | 17.00 | 12.00 | 42.00 | 12.55 | 9.32 | 1.347 | 0.60 |
| 151 | 88.5 | 14.00 | 11.00 | 32.00 | 6.48 | 8.03 | 0.808 | 0.84 |
| 152 | 84.1 | 12.00 | 13.00 | 35.00 | 0.48 | 10.72 | 0.045 | 0.77 |

| SAM NO | H# | 3H CPM | 14C CPM | WIDE CPM | 3H DPM | 14C DPM | RATIO | LUMEX % |
|--------|-------|--------|---------|----------|--------|---------|--------|---------|
| 153 | 78.9 | 15.00 | 4.00 | 31.00 | 11.08 | -1.43 | -7.770 | 0.69 |
| | 80.5 | 16.00 | 10.00 | 28.00 | 10.34 | 6.60 | 1.566 | 1.36 |
| 155 | 80.5 | 6.00 | 12.00 | 25.00 | -12.26 | 9.45 | -1.297 | 0.95 |
| 156 | 84.7 | 15.00 | 15.00 | 40.00 | 6.08 | 13.36 | 0.455 | 0.56 |
| 157 | 80.6 | 17.00 | 13.00 | 35.00 | 10.94 | 10.61 | 1.031 | 0.53 |
| 158 | 80.5 | 18.00 | 4.00 | 34.00 | 17.78 | -1.47 | -12.06 | 0.86 |
| 159 | 79.0 | 16.00 | 12.00 | 37.00 | 9.10 | 9.27 | 0.981 | 0.60 |
| 160 | 81.5 | 14.00 | 19.00 | 40.00 | 1.43 | 18.71 | 0.076 | 0.43 |
| 161 | 80.5 | 12.00 | 15.00 | 38.00 | -0.89 | 13.37 | -0.066 | 0.41 |
| 162 | 79.7 | 15.00 | 13.00 | 40.00 | 6.53 | 10.63 | 0.614 | 0.34 |
| 163 | 79.8 | 19.00 | 7.00 | 39.00 | 18.25 | 2.53 | 7.219 | 0.45 |
| 164 | 80.8 | 15.00 | 3.00 | 26.00 | 11.88 | -2.76 | -4.297 | 0.88 |
| 165 | 84.5 | 10.00 | 10.00 | 28.00 | -2.28 | 6.73 | -0.339 | 0.85 |
| 166 | 82.2 | 7.00 | 12.00 | 29.00 | -10.04 | 9.45 | -1.063 | 0.77 |
| 167 | 79.4 | 8.00 | 9.00 | 26.00 | -6.45 | 5.39 | -1.196 | 0.99 |
| 168 | 81.8 | 15.00 | 7.00 | 31.00 | 9.93 | 2.60 | 3.817 | 0.77 |
| 169 | 78.9 | 17.00 | 10.00 | 36.00 | 12.26 | 6.58 | -1.864 | 0.57 |
| 170 | 80.9 | 15.00 | 13.00 | 40.00 | 6.66 | 10.64 | 0.626 | 0.55 |
| 171 | 78.1 | 8.00 | 10.00 | 28.00 | -7.04 | 6.72 | -1.047 | 0.56 |
| 172 | 79.1 | 10.00 | 6.00 | 19.00 | -0.63 | 1.34 | -0.470 | 1.28 |
| 173 | 77.3 | 12.00 | 13.00 | 31.00 | -0.13 | 10.66 | -0.012 | 0.48 |
| 174 | 86.1 | 17.00 | 9.00 | 37.00 | 13.91 | 5.27 | 2.639 | 0.67 |
| 175 | 93.2 | 12.00 | 22.00 | 41.00 | -3.67 | 22.95 | -0.160 | 1.01 |
| 176 | 86.4 | 14.00 | 14.00 | 43.00 | 4.60 | 12.05 | 0.381 | 0.87 |
| 177 | 84.6 | 10.00 | 10.00 | 25.00 | -2.27 | 6.73 | -0.337 | 0.94 |
| 178 | 85.7 | 10.00 | 7.00 | 33.00 | -0.57 | 2.70 | -0.209 | 0.72 |
| | 82.6 | 16.00 | 6.00 | 28.00 | 12.74 | 1.25 | 10.228 | 0.45 |
| | 81.8 | 19.00 | 8.00 | 34.00 | 18.09 | 3.88 | 4.666 | 0.41 |
| 181 | 104.9 | 11.00 | 10.00 | 26.00 | 2.07 | 6.84 | 0.302 | 1.93 |
| 182 | 84.0 | 17.00 | 11.00 | 37.00 | 12.50 | 7.95 | 1.573 | 0.84 |
| 183 | 95.3 | 17.00 | 6.00 | 31.00 | 17.24 | 1.26 | 13.660 | 0.99 |
| 184 | 78.9 | 13.00 | 11.00 | 31.00 | 3.18 | 7.98 | 0.399 | 0.55 |
| 185 | 81.8 | 13.00 | 10.00 | 32.00 | 4.02 | 6.66 | 0.603 | 0.61 |
| 186 | 101.1 | 11.00 | 8.00 | 23.00 | 2.80 | 4.10 | 0.683 | 0.95 |
| 187 | 82.7 | 5.00 | 9.00 | 16.00 | -12.79 | 5.46 | -2.342 | 0.99 |
| 188 | 89.9 | 13.00 | 10.00 | 33.00 | 4.95 | 6.71 | 0.738 | 0.79 |
| 189 | 89.0 | 13.00 | 6.00 | 24.00 | 7.05 | 1.32 | 5.351 | 1.24 |
| 190 | 99.5 | 15.00 | 7.00 | 30.00 | 12.73 | 2.67 | 4.776 | 1.11 |
| 191 | 115.2 | 6.00 | 8.00 | 20.00 | -8.41 | 4.28 | -1.964 | 2.48 |
| 192 | 94.1 | 14.00 | 17.00 | 40.00 | 3.85 | 16.17 | 0.238 | 0.83 |
| 193 | 88.2 | 10.00 | 11.00 | 27.00 | -2.52 | 8.10 | -0.311 | 1.35 |
| 194 | 81.3 | 12.00 | 14.00 | 32.00 | -0.30 | 12.04 | -0.025 | 0.54 |
| 195 | 88.0 | 20.00 | 10.00 | 40.00 | 20.41 | 6.58 | 3.103 | 0.76 |
| 196 | 81.4 | 13.00 | 6.00 | 24.00 | 6.07 | 1.79 | 3.394 | 0.80 |
| 197 | 81.2 | 17.00 | 11.00 | 31.00 | 12.08 | 7.93 | 1.523 | 0.54 |
| 198 | 79.1 | 18.00 | 13.00 | 31.00 | 6.97 | 9.29 | 0.750 | 0.40 |
| 199 | 77.3 | 14.00 | 11.00 | 38.00 | 5.18 | 7.96 | 0.651 | 0.48 |
| 200 | 87.7 | 12.00 | 9.00 | 30.00 | 3.00 | 5.37 | 0.559 | 1.19 |
| 201 | 81.0 | 18.00 | 9.00 | 39.00 | 15.26 | 5.23 | 2.917 | 1.25 |
| 202 | 84.9 | 18.00 | 6.00 | 36.00 | 17.53 | 1.22 | 14.389 | 1.03 |
| 203 | 91.7 | 13.00 | 13.00 | 39.00 | 3.52 | 10.77 | 0.327 | 0.74 |
| 204 | 87.2 | 14.00 | 9.00 | 33.00 | 7.41 | 5.33 | 1.390 | 0.87 |
| | 80.6 | 17.00 | 5.00 | 32.00 | 15.12 | -0.12 | -129.3 | 0.65 |
| 206 | 83.1 | 14.00 | 13.00 | 37.00 | 4.76 | 10.68 | 0.446 | 0.72 |
| 207 | 89.8 | 12.00 | 8.00 | 26.00 | 3.78 | 4.03 | 0.939 | 1.88 |
| 208 | 91.8 | 12.00 | 15.00 | 39.00 | 0.13 | 13.48 | 0.009 | 0.85 |
| 209 | 92.2 | 14.00 | 9.00 | 28.00 | 8.09 | 5.36 | 1.511 | 6.79 |
| 210 | 89.6 | 15.00 | 8.00 | 32.00 | 10.53 | 3.98 | 2.648 | 0.99 |

| SAM NO | TH# | 3H CPM | 14C CPM | WIDE CPM | 3H DPM | 14C DPM | RATIO | LUMEX % |
|--------|-------|--------|---------|----------|--------|---------|--------|---------|
| 211 | 85.3 | 8.00 | 10.00 | 28.00 | -6.63 | 6.77 | -0.980 | 1.10 |
| 212 | 88.0 | 13.00 | 9.00 | 34.00 | 5.28 | 5.35 | 0.986 | 0.92 |
| 213 | 85.4 | 10.00 | 13.00 | 29.00 | -3.82 | 10.77 | -0.355 | 0.55 |
| 214 | 87.4 | 22.00 | 11.00 | 46.00 | 24.20 | 7.88 | 3.070 | 1.60 |
| 215 | 86.6 | 13.00 | 12.00 | 38.00 | 3.49 | 9.38 | 0.372 | 0.80 |
| 216 | 86.5 | 12.00 | 7.00 | 30.00 | 3.96 | 2.67 | 1.481 | 1.32 |
| 217 | 83.2 | 15.00 | 10.00 | 35.00 | 8.54 | 6.64 | 1.288 | 0.94 |
| 218 | 86.2 | 19.00 | 12.00 | 41.00 | 16.74 | 9.27 | 1.806 | 0.66 |
| 219 | 88.4 | 19.00 | 12.00 | 40.00 | 17.15 | 9.29 | 1.846 | 0.86 |
| 220 | 91.4 | 15.00 | 8.00 | 30.00 | 10.81 | 3.99 | 2.713 | 1.33 |
| 221 | 93.5 | 12.00 | 4.00 | 24.00 | 6.49 | -1.35 | -4.800 | 1.60 |
| 222 | 87.8 | 12.00 | 12.00 | 31.00 | 1.38 | 9.41 | 0.147 | 1.39 |
| 223 | 106.9 | 13.00 | 9.00 | 35.00 | 7.89 | 5.45 | 1.447 | 1.23 |
| 224 | 90.2 | 8.00 | 8.00 | 29.00 | -5.23 | 4.10 | -1.273 | 1.04 |
| 225 | 94.1 | 11.00 | 10.00 | 27.00 | 0.86 | 6.77 | 0.128 | 3.15 |
| 226 | 108.1 | 14.00 | 10.00 | 35.00 | 9.97 | 6.80 | 1.466 | 3.21 |
| 227 | 100.9 | 12.00 | 15.00 | 36.00 | 1.05 | 13.58 | 0.077 | 6.95 |
| 228 | 89.2 | 6.00 | 11.00 | 30.00 | -11.45 | 8.18 | -1.400 | 1.18 |
| 229 | 92.8 | 14.00 | 7.00 | 31.00 | 9.30 | 2.66 | 3.495 | 0.99 |
| 230 | 91.3 | 16.00 | 11.00 | 38.00 | 11.40 | 8.01 | 1.423 | 0.49 |
| 231 | 84.5 | 13.00 | 12.00 | 40.00 | 3.25 | 9.36 | 0.347 | 0.87 |
| 232 | 87.7 | 13.00 | 9.00 | 29.00 | 5.24 | 5.35 | 0.980 | 1.54 |
| 233 | 87.9 | 16.00 | 8.00 | 35.00 | 12.52 | 3.95 | 3.168 | 0.99 |
| 234 | 91.2 | 15.00 | 9.00 | 33.00 | 10.23 | 5.33 | 1.919 | 0.66 |
| 235 | 86.3 | 13.00 | 12.00 | 36.00 | 3.45 | 9.38 | 0.368 | 0.75 |
| 236 | 90.1 | 13.00 | 9.00 | 29.00 | 5.53 | 5.36 | 1.031 | 1.09 |
| 237 | 82.9 | 13.00 | 8.00 | 29.00 | 5.20 | 3.98 | 1.306 | 0.67 |
| 238 | 82.9 | 17.00 | 13.00 | 46.00 | 11.28 | 10.63 | 1.061 | 0.85 |
| 239 | 86.0 | 18.00 | 7.00 | 41.00 | 17.19 | 2.57 | 6.701 | 0.77 |
| 240 | 90.5 | 18.00 | 7.00 | 30.00 | 18.03 | 2.58 | 6.988 | 1.60 |
| 241 | 82.4 | 8.00 | 10.00 | 23.00 | -6.80 | 6.75 | -1.007 | 0.97 |
| 242 | 86.6 | 8.00 | 12.00 | 31.00 | -7.63 | 9.47 | -0.806 | 0.84 |
| 243 | 88.0 | 11.00 | 14.00 | 36.00 | -1.93 | 12.12 | -0.159 | 0.83 |
| 244 | 89.2 | 12.00 | 9.00 | 35.00 | 3.17 | 5.38 | 0.589 | 0.72 |
| 245 | 86.1 | 18.00 | 9.00 | 33.00 | 16.12 | 5.25 | 3.068 | 0.72 |
| 246 | 88.1 | 13.00 | 12.00 | 34.00 | 3.65 | 9.39 | 0.389 | 0.88 |
| 247 | 91.6 | 13.00 | 12.00 | 32.00 | 4.06 | 9.42 | 0.431 | 0.49 |
| 248 | 88.8 | 10.00 | 9.00 | 31.00 | -1.37 | 5.41 | -0.253 | 1.07 |
| 249 | 96.9 | 8.00 | 8.00 | 27.00 | -4.74 | 4.14 | -1.144 | 1.53 |
| 250 | 98.1 | 8.00 | 14.00 | 26.00 | -8.12 | 12.27 | -0.662 | 1.30 |
| 251 | 84.2 | 5.00 | 6.00 | 18.00 | -11.15 | 1.44 | -7.746 | 1.93 |
| 252 | 92.1 | 17.00 | 18.00 | 42.00 | 9.92 | 17.44 | 0.569 | 0.61 |
| 253 | 87.9 | 16.00 | 9.00 | 30.00 | 11.97 | 5.30 | 2.260 | 1.12 |
| 254 | 88.3 | 10.00 | 8.00 | 23.00 | -0.87 | 4.06 | -0.215 | 1.33 |
| 255 | 104.4 | 12.00 | 11.00 | 36.00 | 3.86 | 8.18 | 0.471 | 1.49 |
| 256 | 95.3 | 14.00 | 11.00 | 32.00 | 7.41 | 8.08 | 0.917 | 1.44 |
| 257 | 89.0 | 9.00 | 12.00 | 24.00 | -5.25 | 9.47 | -0.555 | 0.93 |
| 258 | 86.4 | 12.00 | 13.00 | 35.00 | 0.70 | 10.74 | 0.065 | 0.61 |
| 259 | 88.2 | 15.00 | 7.00 | 35.00 | 10.87 | 2.63 | 4.140 | 0.72 |
| 260 | 86.3 | 12.00 | 4.00 | 22.00 | 5.54 | -1.36 | -4.064 | 0.98 |
| 261 | 104.4 | 15.00 | 12.00 | 36.00 | 10.61 | 9.48 | 1.119 | 3.10 |
| 262 | 98.5 | 16.00 | 6.00 | 28.00 | 15.50 | 1.29 | 12.026 | 1.83 |
| 263 | 84.4 | 20.00 | 15.00 | 44.00 | 17.04 | 13.27 | 1.283 | 0.40 |
| 264 | 88.4 | 8.00 | 9.00 | 27.00 | -5.89 | 5.44 | -1.083 | 1.52 |
| 265 | 85.1 | 12.00 | 13.00 | 36.00 | 0.57 | 10.73 | 0.053 | 0.84 |
| 266 | 90.8 | 18.00 | 11.00 | 50.00 | 15.89 | 7.97 | 1.992 | 0.46 |
| 267 | 82.5 | 13.00 | 9.00 | 40.00 | 4.62 | 5.32 | 0.867 | 0.97 |
| 268 | 87.3 | 13.00 | 16.00 | 41.00 | 1.39 | 14.77 | 0.094 | 1.47 |

| SAM NO | H# | 3H CPM | 14C CPM | WIDE CPM | 3H DPM | 14C DPM | RATIO | LUMEX % |
|--------|------|--------|---------|----------|--------|---------|--------|---------|
| 269 | 84.3 | 11.00 | 9.00 | 32.00 | 0.43 | 5.37 | 0.081 | 1.50 |
| 270 | 88.2 | 7.00 | 8.00 | 32.00 | -7.61 | 4.11 | -1.850 | 1.42 |
| 271 | 87.9 | 13.00 | 9.00 | 26.00 | 5.26 | 5.35 | 0.983 | 1.11 |
| 272 | 87.8 | 12.00 | 6.00 | 32.00 | 4.64 | 1.33 | 3.488 | 0.86 |
| 273 | 86.3 | 13.00 | 10.00 | 36.00 | 4.53 | 6.69 | 0.677 | 0.45 |
| 274 | 89.0 | 11.00 | 9.00 | 28.00 | 0.89 | 5.39 | 0.166 | 0.91 |
| 275 | 88.2 | 16.00 | 9.00 | 35.00 | 12.02 | 5.30 | 2.269 | 0.89 |
| 276 | 87.2 | 11.00 | 8.00 | 26.00 | 1.26 | 4.04 | 0.312 | 0.86 |
| 277 | 88.7 | 10.00 | 8.00 | 28.00 | -0.83 | 4.06 | -0.205 | 0.65 |
| 278 | 88.1 | 18.00 | 7.00 | 34.00 | 17.57 | 2.57 | 6.831 | 1.46 |
| 279 | 85.0 | 15.00 | 11.00 | 32.00 | 8.25 | 7.99 | 1.032 | 0.80 |
| 280 | 86.8 | 11.00 | 9.00 | 26.00 | 0.68 | 5.38 | 0.127 | 0.94 |
| 281 | 89.0 | 15.00 | 13.00 | 38.00 | 7.70 | 10.71 | 0.719 | 0.54 |
| 282 | 88.9 | 23.00 | 3.00 | 36.00 | 31.18 | -2.90 | -10.75 | 1.05 |
| 283 | 86.5 | 13.00 | 10.00 | 30.00 | 4.55 | 6.69 | 0.680 | 0.87 |
| 284 | 85.5 | 10.00 | 9.00 | 28.00 | -1.66 | 5.39 | -0.308 | 1.08 |
| 285 | 90.3 | 12.00 | 11.00 | 34.00 | 2.19 | 8.08 | 0.271 | 1.11 |
| 286 | 98.1 | 15.00 | 12.00 | 33.00 | 9.59 | 9.43 | 1.017 | 0.78 |
| 287 | 92.0 | 13.00 | 8.00 | 27.00 | 6.34 | 4.02 | 1.575 | 1.01 |
| 288 | 88.0 | 14.00 | 14.00 | 36.00 | 4.79 | 12.07 | 0.397 | 0.89 |
| 289 | 91.8 | 17.00 | 10.00 | 37.00 | 14.34 | 6.65 | 2.156 | 0.80 |
| 290 | 96.5 | 19.00 | 7.00 | 34.00 | 21.58 | 2.58 | 8.362 | 1.07 |
| 291 | 84.9 | 8.00 | 9.00 | 27.00 | -6.12 | 5.42 | -1.129 | 0.64 |
| 292 | 86.2 | 13.00 | 13.00 | 40.00 | 2.89 | 10.72 | 0.270 | 0.71 |
| 293 | 88.8 | 13.00 | 11.00 | 27.00 | 4.28 | 8.05 | 0.532 | 1.06 |
| 294 | 90.4 | 14.00 | 9.00 | 32.00 | 7.84 | 5.35 | 1.466 | 1.08 |
| 295 | 90.3 | 15.00 | 6.00 | 33.00 | 11.75 | 1.28 | 9.142 | 0.67 |
| 296 | 93.9 | 15.00 | 6.00 | 31.00 | 12.35 | 1.30 | 9.535 | 1.13 |
| 297 | 90.4 | 11.00 | 8.00 | 25.00 | 1.59 | 4.05 | 0.393 | 1.59 |
| 298 | 93.8 | 10.00 | 10.00 | 29.00 | -1.48 | 6.79 | -0.219 | 1.11 |
| 299 | 86.3 | 9.00 | 8.00 | 28.00 | -3.27 | 4.07 | -0.805 | 0.74 |
| 300 | 96.7 | 13.00 | 9.00 | 33.00 | 6.41 | 5.40 | 1.187 | 0.81 |
| 301 | 95.2 | 16.00 | 5.00 | 29.00 | 15.45 | -0.07 | -216.3 | 2.33 |

ID: MB-COPY CALIBRA

19 JAN 2001 17:00

USER:17 COMMENT:
 PRESET TIME : 1.00
 DATA CALC : DL DPM H# :YES SAMPLE REPEATS: 1 PRINTER :EDIT
 COUNT BLANK : YES IC# : NO REPLICATES : 1 RS232 :EDIT
 TWO PHASE : NO AQC :YES CYCLE REPEATS : 1
 SCINTILLATOR: LIQUID LUMEX:YES LOW SAMPLE REJ: 0
 LOW LEVEL : NO HALF LIFE CORRECTION DATE: none

ISOTOPE 1: 3H %ERROR: 2.00 FACTOR:1.0000 BKG. SUB: 0
 ISOTOPE 2: 14C %ERROR: 2.00 FACTOR:1.0000 BKG. SUB: 0
 WIDE OPEN WINDOW %ERROR: 0.00 FACTOR:1.0000 BKG. SUB: 0

BACKGROUND QUENCH CURVE: Off COLOR QUENCH CORRECTION: Off

Quench Limits Low:13.688 High:306.34

| SAM NO | H# | 3H CPM | 14C CPM | WIDE CPM | 3H DPM | 14C DPM | RATIO | LUMEX % |
|--------|------|-----------------------|---------|----------|--------|---------------|-------|---------|
| B1 | 90.9 | 20.00 | 10.00 | 41.00 | 39.94 | 13.13 | 3.043 | 3.05 |
| | | Blank Average DPM for | | 3H : | 39.94 | COEF. OF VAR: | | 0.000 |
| | | Blank Average DPM for | | 14C : | 13.13 | COEF. OF VAR: | | 0.000 |

| | | | | | | | | |
|-----|------|-------|-------|-------|--------|-------|--------|------|
| 302 | 82.4 | 23.00 | 7.00 | 38.00 | 6.42 | -4.12 | -1.557 | 2.74 |
| 303 | 83.9 | 18.00 | 13.00 | 40.00 | -7.39 | 4.03 | -1.836 | 1.89 |
| 304 | 88.6 | 12.00 | 10.00 | 26.00 | -18.45 | 0.13 | -143.4 | 4.33 |
| 305 | 85.5 | 26.00 | 6.00 | 42.00 | 14.31 | -5.51 | -2.597 | 2.69 |
| 306 | 80.2 | 17.00 | 7.00 | 35.00 | -7.00 | -4.03 | 1.738 | 3.36 |
| 307 | 85.7 | 13.00 | 9.00 | 35.00 | -16.01 | -1.25 | 12.801 | 2.85 |