

Radiological Survey Sheet

Job Location Pfizer Central Research 118D/D209 Page 1 of 21
 Survey Purpose Radiological Assessment Date 8/30/00
 Performed By Pam Jones (Print) Pam Jones (Sign)

Inst.(1) (Model/SN) Beckman LS 6500 #7069448	Inst.(2) Ludlum 2241-2 (Model/SN) 163603	Inst.(3) (Model/SN)
Det. Internal (Model/SN)	Det. Ludlum 43-68 (Model/SN) 149613	Det. (Model/SN)
Eff See LSC Printout	Eff. \approx 8% C-14	Eff.
Type rad. β	Type rad. β	Type rad.
Bkgd. See LSC Printout	Bkgd. 300	Bkgd.
Cal. Due: 12/00	Cal. Due 2/13/01	Cal. due

No.	Time	Location	Inst. Used	Total Activity (dpm/100 cm ²)
1.	8:50	door		
2.		wall	1	See attached LSC Printout
3.		wall	1	
4.		desk top	1	
5.		wall	1	
6.		top shelf	1	
7.		shelf	1	
8.		bottom shelf	1	
9.		wall	1	
10.		chair	1	
11.		floor	1	
12.		floor	1	
13.		floor	1	
14.		floor	1	
15.		floor	1	
16.		floor	1	
17.		floor	1	
18.	✓	floor	1	

Radiological Survey Continuation Sheet

Page 2 of 21
 Date 8/30/00

No.	Time	Location	Inst. Used	Total Activity (dpm/100 cm ²)
19		outside drawers	1	See attached LSC Printout
20		top drawer	1	
21		drawer	1	
22		bottom drawer	1	
23		drawer	1	
24		drawer	1	
25		top outside hood	1	
26		rt. " "	1	
27		left " "	1	
28		glass " "	1	
29		ledge of hood	1	
30		left inside hood	1	
31		top	1	
32		back	1	
33		right	1	
34		cup sink	1	
35		left surface	1	
36		rt. surface	1	
37		wall	1	
38		chair	1	
39		chair	1	
40		outside cabinets	1	
41		left inside	1	
42		rt.	1	
43		bottom	1	
44		outside cabinets	1	
45		left	1	
46	✓	rt.	1	

Radiological Survey Continuation Sheet

Page 3 of 21
 Date 8/30/00

No.	Time	Location	Inst. Used	Total Activity (dpm/100 cm ²)
47		bottom	1	See attached LSC Printout
48		outside cabinet	1	
49		top drawer	1	
50		bottom drawer	1	
51		top counter	1	
52		lower counter	1	
53		top shelf	1	
54		shelf	1	
55		shelf	1	
56		bottom shelf	1	
57		top shelf	1	
58		shelf	1	
59		shelf	1	
60		bottom shelf	1	
61		top shelf	1	
62		shelf	1	
63		bottom shelf	1	
64		right shelf	1	
65		desktop	1	
66		outside cabinets	1	
67		top drawer	1	
68		drawer	1	
69		bottom drawer	1	
70		drawer	1	
71		outside cabinets	1	
72		top drawer	1	
73		drawer	1	
74	✓	drawer	1	

Radiological Survey Continuation Sheet

Page 4 of 21

Date 8/30/00

No.	Time	Location	Inst. Used	Total Activity (dpm/100 cm ²)
75		bottom drawer	1	See attached LSC Printout
76		drawer	1	
77		outside drawers	1	
78		top drawer	1	
79		drawer	1	
80		drawer	1	
81		bottom drawer	1	
82		drawer	1	
83		outside file cab.	1	
84		top drawer	1	
85		bottom drawer	1	
86		drawer	1	
87		outside cab.	1	
88		top shelf	1	
89		bottom shelf	1	
90		counter	1	
91		counter	1	
92		counter	1	
93		counter	1	
94		cup sink	1	
95		cup sink	1	
96		top shelf	1	
97		shelf	1	
98		bottom shelf	1	
99		top shelf	1	
100		shelf	1	
101		bottom shelf	1	
102	✓	wall	1	

Radiological Survey Continuation Sheet

Page 5 of 21
 Date 8/30/00

No.	Time	Location	Inst. Used	Total Activity (dpm/100 cm ²)
103		block	1	See attached LSC Printout
104		counter	1	
105		counter	1	
106		cup sink	1	
107		counter	1	
108		back counter sink	1	
109		counter	1	
110		counter	1	
111		tube drier	1	
112		sides of sink	1	
113		bottom + drain	1	
114		outside shelves	1	
115		top shelf	1	
116		shelf	1	
117		shelf	1	
118		bottom shelf	1	
119		outside shelves	1	
120		top shelf	1	
121		shelf	1	
122		shelf	1	
123		bottom shelf	1	
124		top shelf	1	
125		bottom shelf	1	
126		outside cabinets	1	
127		top drawer	1	
128		drawer	1	
129		drawer	1	
130	✓	bottom drawer	1	

Radiological Survey Continuation Sheet

Page 6 of 21
 Date 8/30/00

No.	Time	Location	Inst. Used	Total Activity (dpm/100 cm ²)
131		drawer	1	See attached LSC Printout
132		outside drawers	1	
133		top drawer	1	
134		drawer	1	
135		drawer	1	
136		bottom drawer	1	
137		outside cabinet	1	
138		left	1	
139		back	1	
140		right	1	
141		bottom	1	
142		outside drawers	1	
143		top drawer	1	
144		drawer	1	
145		drawer	1	
146		drawer	1	
147		bottom drawer	1	
148		outside drawers	1	
149		drawer	1	
150		top shelf	1	
151		bottom shelf	1	
152		floor	1	
153		floor	1	
154		floor	1	
155		floor	1	
156		floor	1	
157		floor	1	
158	✓	floor	1	

Radiological Survey Continuation Sheet

Page 7 of 21
 Date 8/30/00

No.	Time	Location	Inst. Used	Total Activity (dpm/100 cm ²)
159		FLOOR	1	See attached LSC Printout
160		FLOOR	1	
161		FLOOR	1	
162		FLOOR	1	
163		FLOOR	1	
164		FLOOR	1	
165		FLOOR	1	
166		CHAIR	1	
167		CHAIR	1	
168		CHAIR	1	
169		CHAIR	1	
170		COUNTER	1	
171		COUNTER	1	
172		COUNTER	1	
173		desk top	1	
174		shelf/ledge	1	
175		inner ledge	1	
176		top shelf	1	
177		shelf	1	
178		shelf	1	
179		bottom shelf	1	
180		top shelf	1	
181		shelf	1	
182		bottom shelf	1	
183		shelf ledge	1	
184		top shelf	1	
185		shelf	1	
186	✓	shelf	1	

Radiological Survey Continuation Sheet

Page 8 of 21
Date 8/30/00

No.	Time	Location	Inst. Used	Total Activity (dpm/100 cm ²)
187		bottom shelf	1	See attached LSC Printout
188		top shelf	1	
189		shelf	1	
190		bottom shelf	1	
191		right shelf	1	
192		desk top	1	
193		outside drawers	1	
194		top drawer	1	
195		drawer	1	
196		bottom drawer	1	
197		drawer	1	
198		outside drawers	1	
199		top drawer	1	
200		drawer	1	
201		drawer	1	
202		bottom drawer	1	
203		drawer	1	
204		outside drawers	1	
205		drawer (top)	1	
206		drawer	1	
207	PJ	bottom drawer	1	
208		drawer (bottom)	1	
209		drawer	1	
210		top shelf	1	
211		shelf	1	
212		bottom shelf	1	
213		left shelf	1	
214	✓	desk top	1	

Radiological Survey Continuation Sheet

Page 9 of 21
 Date 8/30/00

No.	Time	Location	Inst. Used	Total Activity (dpm/100 cm ²)
215		outside drawers	1	See attached LSC Printout
216		top drawer	1	
217		drawer	1	
218		bottom drawer	1	
219		drawer	1	
220		drawer	1	
221		outside drawers	1	
222		top drawer	1	
223		drawer	1	
224		drawer	1	
225		bottom drawer	1	
226		drawer	1	
227		outside drawers	1	
228		top drawer	1	
229		drawer	1	
230		drawer	1	
231		bottom drawer	1	
232		outside drawers	1	
233		drawer	1	
234		shelf	1	
235		shelf	1	
236		counter	1	
237		counter	1	
238		counter	1	
239		CUP sink	1	
240		CUP sink	1	
241		top Rt shelf	1	
242	✓	shelf	1	

• Radiological Survey Continuation Sheet

Page 10 of 21
Date 8/30/00

No.	Time	Location	Inst. Used	Total Activity (dpm/100 cm ²)
243		bottom shelf	1	See attached LSC Printout
244		top left shelf	1	
245		shelf	1	
246		bottom shelf	1	
247		Chair	1	
248		Chair	1	
249		file cabinet	1	
250		wall	1	
251		wall	1	
252		Floor	1	
253		Floor	1	
254		Floor	1	
255		Floor	1	
256		top shelf	1	
257		bottom shelf	1	
258		counter	1	
259		counter	1	
260		counter	1	
261		top shelf	1	
262		bottom shelf	1	
263		counter	1	
264		counter	1	
265		outside drawers	1	
266		top drawer	1	
267		drawer	1	
268		drawer	1	
269		drawer	1	
270	✓	bottom drawer	1	

Radiological Survey Continuation Sheet

Page 11 of 21
 Date 8/30/00

No.	Time	Location	Inst. Used	Total Activity (dpm/100 cm ²)
271		drawer	1	See attached LSC Printout
272		drawer	1	
273		drawer	1	
274		drawer	1	
275		cabinet	1	
276		wind aw sill	1	
277		chair	1	
278		wall	1	
279		wall	1	
280		floor	1	
281		floor	1	
282		floor	1	
283		chair	1	
284		desk top	1	
285		desk top	1	
286		side cabinet	1	
287		front "	1	
288		side "	1	
289		top shelf	1	
290		shelf	1	
291		shelf	1	
292		shelf	1	
293		bottom shelf	1	
294		top shelf	1	
295		shelf	1	
296		shelf	1	
297		shelf	1	
298	✓	shelf	1	

Radiological Survey Continuation Sheet

Page 12 of 21
 Date 8/30/00

No.	Time	Location	Inst. Used	Total Activity (dpm/100 cm ²)
299		bottom shelf	1	See attached LSC Printout
301		door	1	
302		door	1	
303		door	1	
304		door	1	
305		wall	1	
306		top shelf	1	
307		shelf	1	
308		bottom shelf	1	
309		desk table	1	
310		top shelf	1	
311		shelf	1	
312		shelf	1	
313		bottom shelf	1	
314		top shelf	1	
315		shelf	1	
316		bottom shelf	1	
317		left	1	
318		desktop	1	
319		desktop	1	
320		outside drawers	1	
321		pull out drawer	1	
322		top drawer	1	
323		bottom drawer	1	
324		drawer	1	
325		drawer	1	
326		outside drawers	1	
327	↓	drawer	1	

Bld. 118D Room D209

Page 14 of 21

Date: 8/30/00

O = wipe location

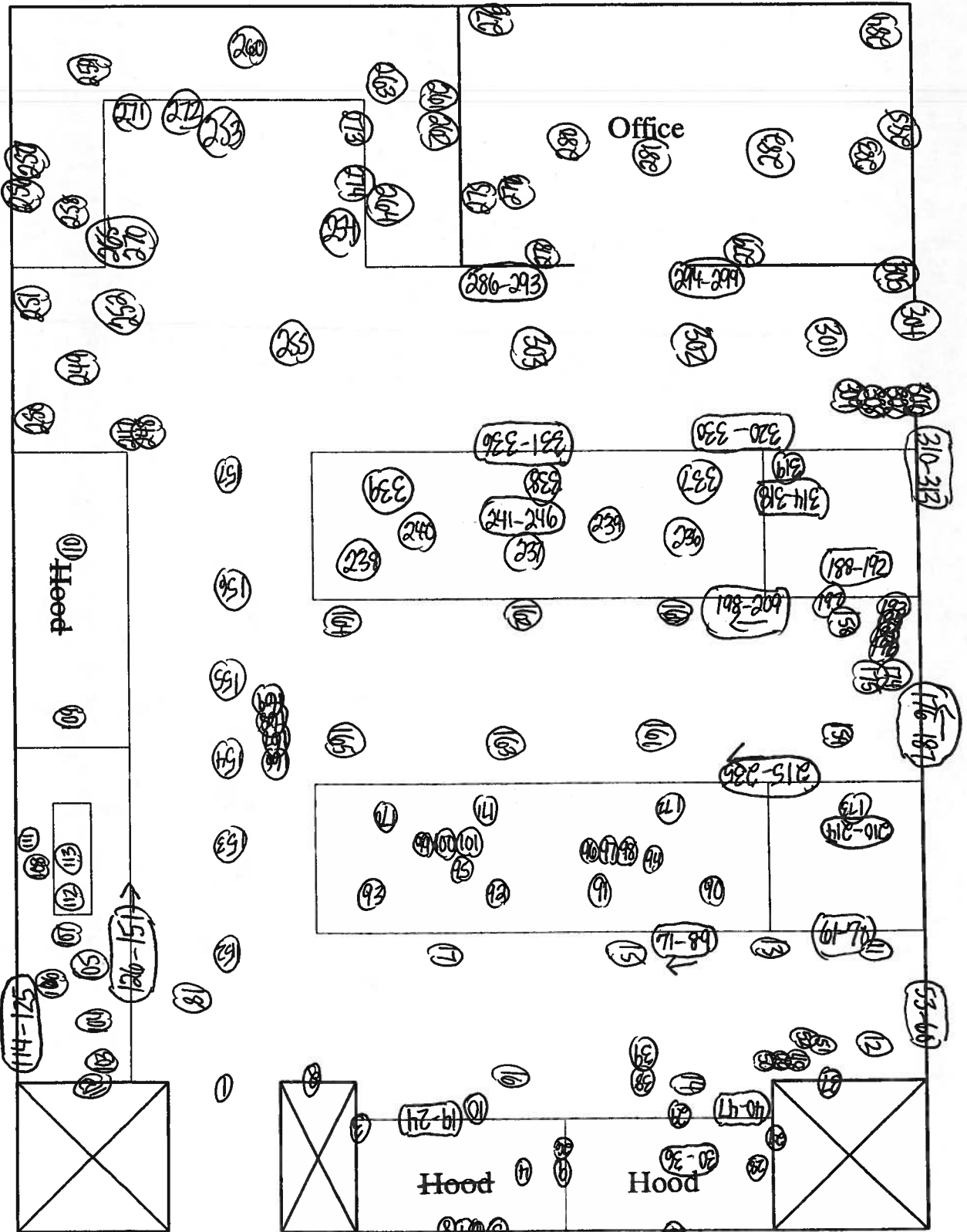

Surveyed 100% of all lower surfaces using instrument #2. All areas were noted to be at

150824

Model: 11111 : Low
 DATA CALC : DEL DPM HH : YES SAMPLE REPEATS : 1 PRINTER : EDIT
 COORD : YES ICN : NO REPLICATES : 1 P8132 : EDIT
 TAD : NO AOC : YES CYCLE REPEATS : 1
 BETA : LIQUID LUMEX : YES LOW SAMPLE RES : 0
 LOW : NO HALF LIFE CORRECTION DATE : none

150 : 3H XERROR: 2.00 FACTOR: 1.000000 BKG. SUB: 0
 150 : 14C XERROR: 2.00 FACTOR: 1.000000 BKG. SUB: 0
 WIDE : 304 XERROR: 0.00 FACTOR: 1.000000 BKG. SUB: 0

D209

BACK : QUENCH CURVE: OFF COLOR QUENCH CORRECTION: OFF

Quench limits Low: 2.706 High: 314.54

SAM NO	HH	3H CPM	14C CPM	WIDE CPM	3H DPM	14C DPM	LUMEX %
81	77.5	18.00	12.00	36.00	29.13	15.93	3.52
1	74.0	23.00	14.00	46.00	8.16	2.60	2.33
2	74.8	27.00	8.00	47.00	18.90	-5.50	2.59
3	79.8	19.00	8.00	36.00	4.26	-5.38	3.59
4	75.3	17.00	8.00	32.00	-0.27	-5.38	11.78
5	76.1	13.00	13.00	40.00	-10.33	1.39	2.54
6	82.5	16.00	8.00	35.00	-1.29	-5.33	2.93
7	79.8	19.00	0.00	30.00	8.24	-16.16	3.87
8	80.1	29.00	13.00	31.00	21.52	1.24	2.19
9	76.1	26.00	8.00	46.00	21.11	-5.50	2.88
10	75.4	23.00	8.00	46.00	11.30	-5.45	2.12
11	79.1	18.00	13.00	39.00	-0.28	1.36	2.74
12	77.4	29.00	9.00	42.00	22.86	-4.17	2.07
13	76.9	18.00	12.00	40.00	-0.08	-0.00	2.11
14	78.5	17.00	11.00	41.00	-1.33	-1.33	2.84
15	77.8	26.00	10.00	46.00	16.61	-2.78	2.88
16	79.7	26.00	7.00	46.00	18.51	-6.81	4.03
17	76.2	22.00	9.00	46.00	9.10	-4.09	3.17
18	79.7	23.00	16.00	47.00	11.12	-2.74	2.42
19	76.8	27.00	9.00	39.00	18.88	-4.14	2.04
20	75.6	26.00	3.00	33.00	17.18	-5.48	1.69
21	73.9	33.00	10.00	46.00	29.21	-2.89	2.58
22	75.4	28.00	11.00	46.00	19.49	-1.48	2.02
23	77.0	18.00	8.00	34.00	1.93	-5.38	2.75
24	74.3	17.00	11.00	41.00	1.99	-1.38	2.36
25	76.1	27.00	10.00	43.00	18.19	-2.80	2.35
26	75.6	13.00	10.00	31.00	-8.92	-2.64	2.91
27	75.3	18.00	9.00	37.00	1.17	-4.05	2.47
28	86.7	22.00	7.00	39.00	11.99	-6.74	2.75
29	81.9	20.00	7.00	43.00	17.00	-6.79	3.71
30	81.2	18.00	14.00	40.00	-0.52	2.72	2.64
31	86.2	31.00	13.00	58.00	26.00	3.96	2.02
32	83.0	14.00	13.00	36.00	-6.02	-2.60	2.45
33	79.2	20.00	18.00	42.00	2.66	4.03	2.69
34	90.0	13.00	10.00	34.00	-7.54	-2.55	2.74
35	83.3	19.00	10.00	43.00	3.80	-2.67	3.27
36	88.8	21.00	13.00	58.00	6.16	4.11	2.93
37	77.9	20.00	10.00	36.00	4.94	-2.71	2.33
38	74.8	18.00	12.00	36.00	-4.19	0.00	2.24

SAM NO : HH : 3H : 14C : WIDE : 3H : 14C : LUMEX %
 : : : : : : : : :

160421

39	76.9	18.00	12.00	37.00	-0.07	-0.00	1.64
40	78.1	22.00	14.00	48.00	6.90	2.65	2.49
41	79.3	17.00	13.00	42.00	-2.22	1.37	2.38
42	75.1	18.00	7.00	34.00	2.12	-6.74	2.48
43	89.9	21.00	9.00	34.00	9.51	-4.01	3.03
44	76.7	12.00	5.00	28.00	-9.78	-5.32	3.76
45	80.2	32.00	7.00	47.00	30.44	-6.88	2.12
46	76.8	35.00	8.00	50.00	35.82	-8.27	1.94
47	83.2	15.00	15.00	40.00	-5.68	4.23	2.19
48	78.3	24.00	11.00	43.00	11.94	-1.42	3.01
49	74.5	19.00	13.00	37.00	1.05	1.31	2.50
50	77.2	18.00	11.00	37.00	0.45	-1.35	3.24
51	73.4	24.00	13.00	43.00	10.46	1.24	2.49
52	76.1	22.00	7.00	41.00	10.00	-6.78	2.98
53	80.6	22.00	14.00	43.00	7.31	2.67	3.04
54	76.7	25.00	14.00	47.00	12.50	2.60	2.56
55	75.4	23.00	12.00	47.00	9.38	-0.07	2.40
56	76.8	24.00	6.00	36.00	14.48	-8.14	3.68
57	80.6	22.00	8.00	43.00	10.32	-5.41	2.03
58	76.8	17.00	3.00	35.00	1.40	-9.41	2.64
59	76.0	24.00	10.00	48.00	12.75	-2.76	1.50
60	77.2	21.00	9.00	43.00	7.27	-4.07	1.84
61	79.0	19.00	8.00	36.00	4.13	-5.39	2.84
62	80.1	29.00	7.00	43.00	24.49	-6.85	2.26
63	73.7	19.00	7.00	35.00	3.84	-6.75	2.87
64	77.7	21.00	11.00	46.00	6.36	-1.38	2.04
65	77.3	16.00	6.00	28.00	-0.97	-8.05	3.22
66	76.3	20.00	10.00	37.00	4.70	-2.72	3.97
67	75.8	18.00	5.00	30.00	3.19	-9.42	3.51
68	75.9	16.00	9.00	39.00	-2.61	-4.02	2.70
69	78.7	22.00	11.00	42.00	8.47	-1.38	2.98
70	75.6	24.00	8.00	41.00	13.87	-5.45	2.84
71	77.0	18.00	9.00	29.00	1.41	-4.04	3.59
72	74.4	19.00	9.00	35.00	2.98	-4.06	3.03
73	76.8	20.00	7.00	35.00	6.23	-6.75	3.03
74	78.4	21.00	11.00	45.00	6.47	-1.37	1.93
75	81.8	29.00	8.00	48.00	24.42	-5.49	2.70
76	81.6	28.00	10.00	49.00	15.44	-2.75	2.33
77	84.4	12.00	4.00	27.00	-7.04	-10.68	3.95
78	79.0	23.00	10.00	43.00	10.99	-2.74	4.13
79	80.9	26.00	6.00	42.00	19.22	-8.16	2.66
80	77.1	25.00	8.00	37.00	15.50	-5.47	2.96
81	82.4	15.00	9.00	35.00	-3.80	-3.97	3.67
82	81.3	29.00	12.00	51.00	22.29	-0.10	3.37
83	81.4	20.00	8.00	38.00	6.50	-5.39	3.54
84	84.7	10.00	13.00	30.00	-15.65	1.50	8.90
85	78.2	23.00	8.00	42.00	11.83	-5.44	4.18
86	76.1	25.00	8.00	42.00	15.30	-5.47	2.61
87	80.2	18.00	8.00	37.00	2.36	-5.37	2.66
88	78.4	18.00	9.00	39.00	1.59	-4.03	3.37
89	81.6	16.00	12.00	37.00	-3.42	0.06	3.51
90	73.8	24.00	7.00	43.00	13.42	-6.81	3.18
91	77.4	18.00	7.00	38.00	2.45	-6.73	3.19
92	87.5	28.00	4.00	57.00	25.95	-10.87	3.30
93	78.8	33.00	8.00	46.00	31.51	-3.55	2.36
94	87.8	20.00	9.00	47.00	7.07	-4.00	3.49
95	83.1	27.00	9.00	43.00	12.66	-4.03	3.29
96	109.1	18.00	10.00	32.00	6.19	-2.49	6.27

17 of 21

97	113.1	15.00	10.00	30.00	-0.04	-2.42	3.01
98	84.2	25.00	8.00	44.00	19.36	-5.39	3.49
99	59.4	18.00	11.00	40.00	3.81	-1.19	8.89
100	97.3	23.00	21.00	58.00	8.67	12.33	3.99
101	98.4	20.00	13.00	51.00	7.02	1.50	8.13
102	90.3	16.00	12.00	42.00	2.13	0.12	4.60
103	61.2	29.00	5.00	46.00	24.29	-5.49	2.31
104	78.8	22.00	5.00	30.00	9.99	-5.42	2.50
105	78.9	21.00	9.00	38.00	7.55	-4.06	2.76
106	84.5	27.00	7.00	49.00	21.62	-6.81	2.05
107	77.1	24.00	4.00	43.00	15.94	-10.83	2.80
108	84.0	16.00	8.00	38.00	-1.10	-5.33	3.23
109	104.3	17.00	10.00	41.00	3.11	-2.51	5.27
110	100.3	21.00	10.00	42.00	11.07	-2.59	7.86
111	75.2	24.00	8.00	43.00	13.79	-5.45	2.80
112	77.9	28.00	18.00	37.00	17.00	7.98	1.53
113	82.5	22.00	7.00	41.00	11.16	-6.75	2.67
114	80.0	28.00	8.00	45.00	22.02	-5.49	2.82
115	89.7	23.00	14.00	42.00	10.98	2.74	2.65
116	84.8	21.00	10.00	37.00	8.06	-2.68	3.34
117	81.3	42.00	9.00	60.00	49.54	-4.30	1.71
118	84.6	27.00	8.00	44.00	22.15	-8.16	2.39
119	79.7	32.00	5.00	53.00	31.29	-9.58	3.10
120	86.9	20.00	18.00	44.00	3.29	5.46	4.48
121	80.9	14.00	16.00	38.00	-6.45	-2.62	2.36
122	82.7	24.00	15.00	53.00	11.13	4.02	2.38
123	83.2	24.00	9.00	48.00	14.28	-4.08	3.07
124	88.0	21.00	8.00	36.00	12.81	-8.04	8.28
125	83.8	22.00	11.00	41.00	9.21	-1.36	3.02
126	77.9	27.00	8.00	45.00	19.57	-5.48	2.74
127	82.1	23.00	7.00	47.00	13.08	-6.77	2.56
128	78.4	22.00	11.00	41.00	8.42	-1.39	2.59
129	80.7	21.00	8.00	36.00	8.35	-5.40	3.08
130	82.4	23.00	13.00	42.00	10.11	1.33	2.54
131	79.9	31.00	14.00	58.00	24.91	2.56	1.80
132	79.4	22.00	7.00	39.00	10.58	-6.77	1.73
133	80.7	24.00	8.00	45.00	14.27	-5.44	2.39
134	81.0	28.00	8.00	44.00	22.26	-5.48	2.46
135	86.0	18.00	9.00	40.00	0.68	-3.98	2.84
136	85.8	14.00	7.00	28.00	-10.49	-6.61	3.75
137	80.8	25.00	10.00	44.00	15.24	-2.75	4.59
138	80.6	18.00	12.00	34.00	0.43	0.03	2.78
139	81.0	20.00	11.00	39.00	4.92	-1.34	2.60
140	80.9	19.00	11.00	41.00	2.93	-1.33	3.73
141	90.6	21.00	10.00	37.00	9.17	-2.64	3.04
142	90.8	23.00	11.00	58.00	16.93	-1.34	4.35
143	79.7	17.00	10.00	27.00	-0.89	12.11	1.00
144	80.2	16.00	11.00	37.00	-8.15	0.04	1.71
145	80.0	18.00	11.00	38.00	12.11	-13.52	1.00
146	80.0	23.00	11.00	37.00	12.65	-6.78	1.54
147	80.0	23.00	11.00	37.00	18.18	-9.49	3.78
148	81.2	20.00	14.00	46.00	3.45	2.70	3.80
149	81.7	25.00	17.00	53.00	11.93	6.69	7.49
150	84.0	17.00	10.00	34.00	-0.04	-2.64	7.13
151	82.3	17.00	4.00	33.00	2.69	-10.74	5.80
152	80.0	20.00	12.00	42.00	4.80	0.02	3.38

18

180521

152	82.8	18.00	7.00	33.00	2.20	-4.01	3.20
154	85.4	18.00	10.00	32.00	2.11	-2.64	3.34
157	80.7	15.00	9.00	36.00	-4.04	-3.98	10.73
158	81.2	19.00	5.00	39.00	5.99	-9.42	4.71
159	81.3	17.00	5.00	32.00	2.05	-9.40	5.33
160	80.4	27.00	10.00	46.00	19.14	-2.78	2.98
161	84.8	17.00	10.00	41.00	-0.00	-2.63	5.61
162	86.2	22.00	5.00	45.00	11.36	-5.39	7.12
163	87.3	22.00	5.00	46.00	11.59	-5.38	2.48
164	81.5	21.00	6.00	37.00	9.50	-8.09	7.38
165	83.4	28.00	6.00	47.00	24.38	-8.17	2.93
166	80.1	13.00	10.00	34.00	-8.51	-2.62	7.42
167	78.4	17.00	7.00	34.00	0.64	-6.71	5.05
168	82.1	20.00	4.00	35.00	8.64	-10.78	3.15
169	80.6	20.00	11.00	45.00	4.85	-1.35	3.41
170	83.9	23.00	9.00	39.00	12.42	-4.06	5.37
171	80.2	21.00	7.00	41.00	8.76	-6.75	3.06
172	78.9	22.00	12.00	45.00	8.02	-0.04	2.79
173	79.1	27.00	5.00	39.00	20.84	-8.17	3.70
174	79.9	25.00	6.00	40.00	17.09	-8.15	5.67
175	80.7	30.00	5.00	50.00	27.64	-9.55	2.36
176	87.2	25.00	15.00	46.00	14.05	4.05	5.71
177	90.7	13.00	9.00	28.00	-6.92	-3.90	10.95
178	82.0	19.00	10.00	33.00	3.59	-2.67	4.24
179	79.8	29.00	12.00	30.00	11.16	-8.11	4.39
180	81.1	20.00	8.00	33.00	2.95	-5.35	7.13

185	82.8	20.00	11.00	38.00	5.20	-1.33	6.60
186	84.4	17.00	7.00	34.00	1.48	-6.69	6.17
187	82.0	15.00	9.00	37.00	-3.85	-3.98	4.46
188	82.7	22.00	16.00	53.00	6.64	5.39	4.21
189	83.6	18.00	9.00	34.00	2.35	-4.00	5.50
190	86.6	20.00	5.00	33.00	8.94	-9.42	2.72
191	79.0	22.00	9.00	43.00	9.52	-4.07	4.13
192	82.0	21.00	11.00	42.00	7.07	-1.35	2.97
193	81.7	25.00	3.00	47.00	16.46	-5.44	4.25
194	88.4	19.00	10.00	35.00	4.60	-2.64	7.70
195	82.2	19.00	5.00	37.00	6.15	-9.42	5.10
196	85.4	30.00	5.00	45.00	27.37	-5.49	6.82
197	79.8	17.00	9.00	32.00	-0.17	-4.01	5.81
198	79.5	20.00	12.00	37.00	4.19	-0.01	3.85
199	82.6	23.00	5.00	38.00	14.20	-9.46	4.88
200	87.1	18.00	4.00	34.00	6.30	-10.77	4.91
201	80.3	16.00	11.00	45.00	-3.08	-1.30	3.32
202	81.4	20.00	5.00	37.00	8.00	-9.43	5.22
203	87.2	14.00	9.00	43.00	13.71	-4.09	2.42
204	78.0	30.00	16.00	38.00	21.50	5.25	2.24
205	82.6	25.00	5.00	43.00	18.19	-4.09	3.70
206	80.9	28.00	14.00	37.00	19.22	2.60	2.90
207	78.2	26.00	10.00	36.00	-2.83	-2.66	2.25
208	80.0	15.00	9.00	36.00	-4.08	-3.93	3.69
209	83.0	37.00	6.00	55.00	41.73	-8.28	2.78
210	82.7	23.00	7.00	42.00	13.20	-6.77	3.47
211	82.7	23.00	9.00	41.00	12.19	-4.07	3.60
212	83.4	28.00	2.00	37.00	25.90	-13.57	1.10

190f21

214	86.0	18.00	9.00	27.00	1.02	-7.57	6.22
214	79.9	17.00	11.00	40.00	-1.15	-1.32	3.98
215	79.5	19.00	11.00	42.00	2.72	-1.34	3.82
216	79.1	18.00	10.00	37.00	1.20	-2.68	5.07
217	83.0	30.00	9.00	46.00	26.22	-4.15	6.58
218	83.1	25.00	12.00	45.00	15.15	-0.03	3.66
219	84.2	21.00	11.00	42.00	7.45	-1.33	3.98
220	80.4	22.00	6.00	35.00	11.26	-8.11	3.50
221	83.0	22.00	11.00	50.00	9.24	-1.35	2.90
222	82.7	22.00	12.00	43.00	8.61	-0.01	4.15
223	84.9	22.00	5.00	38.00	12.66	-9.45	4.87
224	79.5	24.00	12.00	46.00	12.05	-0.06	2.97
225	78.7	30.00	10.00	57.00	24.62	-2.82	2.77
226	80.6	33.00	6.00	46.00	33.03	-8.24	3.18
227	81.2	23.00	11.00	48.00	10.89	-1.38	3.58
228	82.6	21.00	12.00	43.00	6.66	0.00	3.50
229	77.5	25.00	13.00	46.00	12.15	3.95	3.58
230	79.6	17.00	11.00	40.00	-1.19	-1.32	4.64
231	81.9	22.00	11.00	42.00	9.03	-1.36	6.68
232	79.4	18.00	9.00	38.00	1.74	-4.03	3.00
233	78.4	17.00	15.00	50.00	-3.32	4.06	3.53
234	75.7	27.00	11.00	43.00	10.62	-1.39	3.87
235	83.1	31.00	10.00	45.00	27.75	-2.81	3.95
236	78.3	22.00	6.00	36.00	10.87	-8.12	4.42
237	77.8	18.00	13.00	44.00	-11.18	4.10	2.73
238	78.8	23.00	10.00	43.00	10.96	-2.74	3.47
239	89.2	18.00	13.00	37.00	1.10	1.44	6.67
240	99.7	15.00	12.00	37.00	-3.22	0.21	9.47
241	97.1	16.00	14.00	38.00	-2.53	2.90	7.80
242	92.4	11.00	8.00	28.00	-10.39	-5.22	6.28
243	95.9	23.00	12.00	49.00	14.22	0.11	6.71
244	94.8	20.00	8.00	37.00	8.90	-5.32	7.52
245	90.6	22.00	10.00	47.00	11.20	-2.66	5.53
246	96.0	23.00	11.00	45.00	13.90	-1.28	6.91
247	80.3	23.00	11.00	41.00	8.75	-1.37	3.70
248	85.1	17.00	10.00	32.00	0.05	-2.63	3.41
249	83.2	19.00	12.00	55.00	2.62	0.02	4.49
250	85.8	17.00	6.00	38.00	6.25	-8.06	6.73
251	84.9	20.00	7.00	37.00	7.60	-6.72	5.80
252	86.3	30.00	3.00	41.00	30.22	-12.24	5.91
253	83.1	17.00	7.00	39.00	1.29	-6.69	3.35
254	95.3	20.00	10.00	39.00	7.92	-2.60	7.77
255	94.6	14.00	9.00	28.00	-4.38	-3.89	11.80
256	93.1	26.00	11.00	51.00	19.32	-1.34	4.59
257	118.7	21.00	11.00	38.00	14.84	-1.10	10.85
258	82.9	27.00	12.00	43.00	10.70	-0.02	3.93
259	81.1	21.00	11.00	40.00	6.92	-1.36	4.75
260	85.7	24.00	10.00	52.00	13.78	-1.36	2.53
261	85.0	22.00	12.00	47.00	9.08	0.01	4.74
262	100.3	20.00	11.00	40.00	8.32	-1.21	17.05
263	80.5	18.00	9.00	44.00	1.89	-4.02	3.22
264	81.3	23.00	7.00	42.00	12.96	-6.77	3.89
265	82.6	26.00	10.00	46.00	17.65	-2.75	3.92
266	81.6	23.00	8.00	36.00	12.48	-5.42	5.17
267	83.6	18.00	5.00	32.00	4.22	-9.40	9.23
268	83.1	19.00	12.00	45.00	2.76	0.03	4.54
269	90.0	19.00	7.00	35.00	6.45	-6.69	6.05
270	87.7	20.00	10.00	34.00	6.53	-2.65	3.20

200K21

271	84.1	11.00	9.00	34.00	-11.63	-3.72	2.02
272	84.1	23.00	7.00	36.00	13.49	-6.76	5.13
273	89.2	17.00	11.00	40.00	0.09	-1.25	4.62
274	86.2	17.00	9.00	38.00	1.00	-3.96	4.64
275	91.7	15.00	11.00	33.00	-3.71	-1.21	7.49
276	86.1	31.00	17.00	64.00	25.48	6.69	6.37
277	82.9	27.00	8.00	42.00	20.72	-5.46	4.99
278	86.9	22.00	13.00	46.00	8.92	1.38	3.10
279	84.3	13.00	15.00	39.00	-10.66	4.16	3.64
280	85.2	27.00	13.00	47.00	18.70	1.30	4.23
281	83.2	20.00	8.00	34.00	8.31	-9.43	6.36
282	84.9	14.00	9.00	28.00	-5.52	-3.95	8.01
283	84.8	19.00	7.00	35.00	5.56	-6.71	3.46
284	90.2	21.00	10.00	41.00	9.04	-2.65	7.48
285	92.9	18.00	11.00	36.00	2.73	-1.24	10.03
286	84.4	15.00	12.00	35.00	-5.10	0.09	4.33
287	81.2	18.00	9.00	35.00	1.99	-4.02	5.59
288	85.0	17.00	8.00	33.00	1.06	-5.33	6.18
289	86.2	24.00	11.00	45.00	14.29	-1.34	4.17
290	86.0	20.00	13.00	43.00	4.70	1.39	4.42
291	86.9	16.00	10.00	33.00	-1.75	-2.61	6.53
292	92.8	22.00	13.00	41.00	10.03	1.42	4.97
293	95.7	18.00	12.00	43.00	2.64	0.14	6.72
294	84.6	27.00	11.00	50.00	19.58	-1.40	6.44
295	87.0	20.00	9.00	41.00	6.93	-4.01	5.14
296	85.2	14.00	11.00	40.00	-6.51	-1.24	6.42
297	86.6	22.00	12.00	45.00	9.38	0.02	5.59
298	85.8	17.00	10.00	33.00	0.13	-2.63	8.63
299	91.5	27.00	8.00	43.00	24.54	-9.49	9.68
300	83.8	23.00	15.00	48.00	9.70	4.06	4.44
301	84.6	22.00	6.00	42.00	12.09	-8.10	4.64
302	92.0	24.00	7.00	43.00	17.27	-6.74	4.07
303	81.3	19.00	4.00	35.00	6.51	-10.77	6.52
304	83.1	26.00	12.00	43.00	16.74	-0.05	4.90
305	101.7	21.00	10.00	42.00	11.38	-2.58	6.15
306	92.6	16.00	10.00	36.00	-0.98	-2.57	7.67
307	87.3	21.00	10.00	48.00	8.50	-2.67	4.42
308	98.4	21.00	6.00	34.00	12.89	-8.04	6.78
309	92.1	12.00	9.00	31.00	-8.87	-3.88	6.94
310	87.8	25.00	10.00	47.00	16.77	-2.71	4.27
311	89.9	19.00	17.00	47.00	1.15	6.85	3.99
312	87.4	20.00	12.00	41.00	5.44	0.05	4.82
313	94.3	18.00	8.00	33.00	6.21	-9.37	5.86
314	93.0	18.00	14.00	38.00	0.98	2.82	6.97
315	89.8	22.00	6.00	35.00	13.15	-8.08	4.70
316	89.5	15.00	10.00	36.00	-3.46	-2.58	5.98
317	93.7	22.00	4.00	32.00	15.08	-10.78	6.31
318	85.3	27.00	11.00	47.00	19.76	-1.40	5.31
319	88.2	17.00	9.00	35.00	1.00	-3.96	5.17
320	85.2	26.00	12.00	45.00	17.19	-0.04	5.37
321	88.3	11.00	8.00	31.00	-9.20	-9.30	5.78
322	89.9	18.00	9.00	38.00	3.31	-3.97	7.69
323	87.4	19.00	8.00	32.00	7.05	-9.40	7.70
324	89.2	15.00	7.00	34.00	-1.91	-6.64	6.50
325	85.2	16.00	11.00	40.00	-2.48	-1.27	5.64
326	89.9	18.00	9.00	43.00	-0.81	-3.94	3.71
327	84.5	25.00	10.00	41.00	16.04	-2.73	6.39
328	91.6	18.00	14.00	42.00	0.93	2.82	4.89

329	45.3	18.00	12.00	31.00	2.07	0.14	3.77
330	57.3	15.00	7.00	40.00	3.95	-6.69	6.19
331	85.2	23.00	9.00	42.00	12.69	-4.05	4.27
332	56.0	17.00	13.00	45.00	2.67	1.40	4.10
333	56.5	21.00	8.00	35.00	9.40	-5.37	7.11
334	88.5	20.00	11.00	44.00	6.15	-1.29	5.14
335	82.7	20.00	11.00	37.00	5.19	-1.33	4.71
336	84.1	20.00	6.00	34.00	7.98	-8.07	5.42
337	84.2	18.00	10.00	34.00	1.92	-2.65	5.54
338	75.7	20.00	13.00	39.00	3.14	1.31	1.54
339	83.8	30.00	9.00	49.00	26.43	-4.15	1.72

21 of 21