

Radiological Survey Sheet

Job Location Pfizer Central Research 118D/D207 Page 1 of 18
 Survey Purpose Radiological Assessment Date 8/31/00
 Performed By Pam Jones (Print) Pam Jones (Sign)

Inst.(1) Beckman LS 6500 (Model/SN) #7069448	Inst.(2) Ludlum 2241-2 (Model/SN) 163603	Inst.(3) (Model/SN)
Det. Internal (Model/SN)	Det. Ludlum 43-68 (Model/SN) 149613	Det. (Model/SN)
Eff. See LSC Printout	Eff. $\approx 89\%$ C-14	Eff.
Type rad. β	Type rad. β	Type rad.
Bkgd. See LSC Printout	Bkgd. 300	Bkgd.
Cal. Due: 12/00	Cal. Due 02/13/01	Cal. due

No.	Time	Location	Inst. Used	Total Activity (dpm/100 cm ²)
1.	2:00	door	1	See attached LSC Printout
2.		wall	1	
3.		wall	1	
4.		wall	1	
5.		wall	1	
6.		left desktop	1	
7.		rt. desktop	1	
8.		outside drawers	1	
9.		top drawer	1	
10.		bottom drawer	1	
11.		outside drawers	1	
12.		top drawer	1	
13.		drawer	1	
14.		drawer	1	
15.		bottom drawer	1	
16.		outside hood	1	
17.		metal ledge	1	
18.	✓	inside top	1	

Radiological Survey Continuation Sheet

Page 2 of 18

Date 8/31/00

No.	Time	Location	Inst. Used	Total Activity (dpm/100 cm ²)
19		back	1	See attached LSC Printout
20		left	1	
21		right	1	
22		left surface	1	
23		right surface	1	
24		CMD sink	1	
25		outside cabinet	1	
26		left inside	1	
27		center	1	
28		right	1	
29		outside cab.	1	
30		left	1	
31		center	1	
32		right	1	
33		wall	1	
34		left tabletop	1	
35		rt " "	1	
36		counter	1	
37		wall	1	
38		outside cab.	1	
39		outside cab.	1	
40		outside cab.	1	
41		top shelf	1	
42		shelf	1	
43		shelf	1	
44		bottom shelf	1	
45		top shelf	1	
46		shelf	1	

Radiological Survey Continuation Sheet

Page 3 of 18
Date 8/31/00

No.	Time	Location	Inst. Used	Total Activity (dpm/100 cm ²)
47		bottom shelf	1	See attached LSC Printout
48		top shelf	1	
49		shelf	1	
50		bottom shelf	1	
51		metal divider	1	
52		chair	1	
53		metal grate	1	
54		metal grate	1	
55		outside cabinet	1	
56		top drawer	1	
57		drawer	1	
58		drawer	1	
59		bottom drawer	1	
60		drawer	1	
61		outside drawers	1	
62		top drawer	1	
63		drawer	1	
64		drawer	1	
65		bottom drawer	1	
66		drawer	1	
67		outside cab	1	
68		drawer	1	
69		top shelf	1	
70		bottom shelf	1	
71		equipment outside } centrifuge	1	
72		equipment inside }	1	
73		floor	1	
74		floor	1	

• Radiological Survey Continuation Sheet

Page 4 of 18
 Date 8/31/00

No.	Time	Location	Inst. Used	Total Activity (dpm/100 cm ²)
75		FLOOR	1	See attached LSC Printout
76		FLOOR	1	
77		FLOOR	1	
78		FLOOR	1	
79		FLOOR	1	
80		FLOOR	1	
81		COUNTER	1	
82		COUNTER	1	
83		COUNTER	1	
84		CUP SINK	1	
85		OUTSIDE SHELVES	1	
86		TOP SHELF	1	
87	4:00	shelf	1	
88	8:00	shelf	1	
89		bottom shelf	1	
90		outside shelves	1	
91		top shelf	1	
92		shelf	1	
93		shelf	1	
94		bottom shelf	1	
95		top shelf	1	
96		shelf	1	
97		bottom shelf	1	
98		beaker dryer	1	
99		COUNTER	1	
100		COUNTER	1	
101		COUNTER	1	
102	L.V.	CUP SINK	1	

Radiological Survey Continuation Sheet

Page 5 of 18

Date 9/4/00

No.	Time	Location	Inst. Used	Total Activity (dpm/100 cm ²)
103		counter	1	See attached LSC Printout
104		sides of sink	1	
105		bottom	1	
106		drain	1	
107		outside drawers	1	
108		top drawer	1	
109		drawer	1	
110		drawer	1	
111		bottom drawer	1	
112		drawer	1	
113		chair	1	
114		outside cabinets	1	
115		inside left wall	1	
116		left bottom	1	
117		right wall	1	
118		re. bottom	1	
119		wire basket	1	
120		"	1	
121		"	1	
122		"	1	
123		"	1	
124		"	1	
125		floor	1	
126		floor	1	
127		"	1	
128		"	1	
129		"	1	
130	✓	"	1	

Radiological Survey Continuation Sheet

Page 6 of 18
 Date 9/4/00

No.	Time	Location	Inst. Used	Total Activity (dpm/100 cm ²)
131		ledge	1	See attached LSC Printout
132		outside shelves	1	
133		top shelf	1	
134		shelf	1	
135		bottom shelf	1	
136		outside shelves	1	
137		top shelf	1	
138		shelf	1	
139		shelf	1	
140		bottom shelf	1	
141		counter	1	
142		counter	1	
143		counter	1	
144		chair	1	
145		drawer	1	
146		outside drawers	1	
147		top drawer	1	
148		drawer	1	
149		drawer	1	
150		bottom drawer	1	
151		drawer	1	
152		outside drawers	1	
153		top drawer	1	
154		drawer	1	
155		drawer	1	
156		bottom drawer	1	
157		outside drawers	1	
158	✓	top drawer	1	

Radiological Survey Continuation Sheet

Page 7 of 18
 Date 9/4/00

No.	Time	Location	Inst. Used	Total Activity (dpm/100 cm ²)
159		top shelf	1	See attached LSC Printout
160		bottom shelf	1	
161		top shelf	1	
162		shelf	1	
163		bottom left	1	
164		bottom RT.	1	
165		desk top	1	
166		outside drawers	1	
167		pull-out	1	
168		top drawer	1	
169		drawer	1	
170		bottom drawer	1	
171		drawer	1	
172		outside drawers	1	
173		top drawer	1	
174		drawer	1	
175		drawer	1	
176		bottom drawer	1	
177		drawer	1	
178		outside drawers	1	
179		top drawer	1	
180		drawer	1	
181		drawer	1	
182		bottom drawer	1	
183		drawer	1	
184		outside drawer	1	
185		top drawer	1	
186	✓	top shelf	1	

Radiological Survey Continuation Sheet

Page 8 of 18
 Date 9/4/00

No.	Time	Location	Inst. Used	Total Activity (dpm/100 cm ²)
187		bottom shelf	1	See attached LSC Printout
188		counter	1	
189		counter	1	
190		counter	1	
191		cup sink	1	
192		shelf	1	
193		wall	1	
194		wall	1	
195		wall	1	
196		door	1	
197		plastic	1	
198		"	1	
199		"	1	
200		"	1	
201		floor	1	
202		floor	1	
203		floor	1	
204		floor	1	
205		"	1	
206		"	1	
207		"	1	
208		"	1	
209		"	1	
210		"	1	
211		outside shelves	1	
212		top shelf	1	
213		shelf	1	
214	✓	shelf	1	

Radiological Survey Continuation Sheet

Page 9 of 18
 Date 9/4/00

No.	Time	Location	Inst. Used	Total Activity (dpm/100 cm ²)
215		bottom shelf	1	See attached LSC Printout
216		top shelf	1	
217		shelf	1	
218		shelf	1	
219		bottom shelf	1	
220		table top	1	
221		edge	1	
222		top shelf	1	
223		shelf	1	
224		bottom shelf	1	
225		desktop	1	
226		liberglass	1	
227		outside drawers	1	
228		pull-out	1	
229		top drawer	1	
230		drawer	1	
231		bottom drawer	1	
232		drawer	1	
233		outside drawers	1	
234		top drawer	1	
235		drawer	1	
236		drawer	1	
237		bottom drawer	1	
238		drawer	1	
239		outside drawers	1	
240		top drawer	1	
241		drawer	1	
242	✓	drawer	1	

Radiological Survey Continuation Sheet

Page 10 of 18
 Date 9/4/00

No.	Time	Location	Inst. Used	Total Activity (dpm/100 cm ²)
243		bottom drawer	1	See attached LSC Printout
244		outside drawers	1	
245		top drawer	1	
246		top shelf	1	
247		bottom shelf	1	
248		top shelf	1	
249		shelf	1	
250		bottom shelf	1	
251		top shelf	1	
252		shelf	1	
253		shelf	1	
254		bottom shelf	1	
255		counter	1	
256		counter	1	
257		counter	1	
258		kt. arm cabinet	1	
259		top shelf	1	
260		shelf	1	
261		shelf	1	
262		bottom shelf	1	
263		beige cabinet	1	
264		tall cabinet	1	
265		chair	1	
266		"	1	
267		"	1	
268		"	1	
269		shelf	1	
270	✓	shelf/cubbies	1	

Bld. 118D Room D207

Page 12 of 18

Date: 9/4/00

○ = wipe location

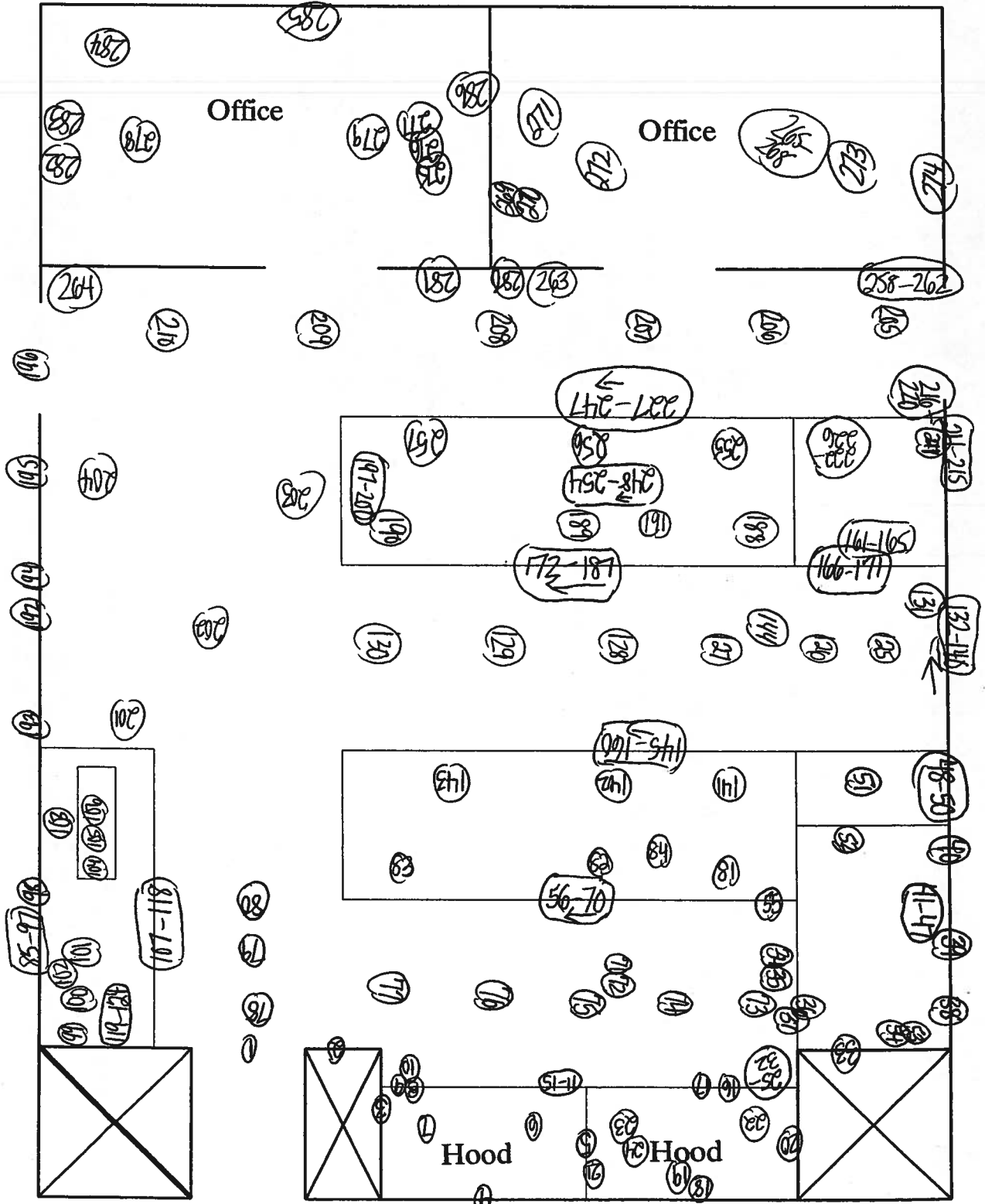

EXIT
Surveyed 100% of all lower surfaces using instrument #2 all areas were noted to be at normal background level

5 SEP 2000 12:30

ID: EQUIPMENT SURVY COMMENT: EQUIPMENT SURVEY

USER: 3
PRESET TIME : 1.00
DATA CALC : DL DPM H# : YES SAMPLE REPEATS: 1 PRINTER : EDIT
COUNT BLANK : YES IC# : NO REPLICATES : 1 RS232 : EDIT
TWO PHASE : NO AQC : YES CYCLE REPEATS : 1
SCINTILLATOR: LIQUID LUMEX: YES LOW SAMPLE REJ: 0
LOW LEVEL : NO HALF LIFE CORRECTION DATE: none

ISOTOPE 1: 3H %ERROR: 2.00 FACTOR: 1.0000 BKG. SUB: 0
ISOTOPE 2: 14C %ERROR: 2.00 FACTOR: 1.0000 BKG. SUB: 0
WIDE OPEN WINDOW %ERROR: 0.00 FACTOR: 1.0000 BKG. SUB: 0

BACKGROUND QUENCH CURVE: Off COLOR QUENCH CORRECTION: Off

Quench Limits Low: 13.688 High: 306.34

Table with 8 columns: SAM NO, H#, 3H CPM, 14C CPM, WIDE CPM, 3H DPM, 14C DPM, LUMEX %. Includes summary rows for Blank Average DPM for 3H and 14C with COEF. OF VAR.

Main data table with 8 columns: SAM NO, H#, 3H CPM, 14C CPM, WIDE CPM, 3H DPM, 14C DPM, LUMEX %. Contains 35 rows of sample data.

SAM NO.	H#	3H CPM	14C CPM	WIDE CPM	3H DPM	14C DPM	LUMEX %
37	77.9	23.00	7.00	38.00	-0.13	-2.64	0.72
38	79.1	14.00	8.00	35.00	-19.65	-1.15	1.04
39	78.4	23.00	9.00	46.00	-1.05	0.04	0.62
40	79.7	14.00	9.00	31.00	-20.09	0.19	0.95
41	90.5	18.00	5.00	35.00	-7.40	-5.21	1.10
42	81.1	21.00	6.00	38.00	-3.22	-3.94	1.11
43	84.9	13.00	11.00	35.00	-22.71	2.93	1.03
44	79.0	20.00	9.00	44.00	-7.33	0.09	0.85
45	80.7	16.00	11.00	37.00	-16.69	2.85	0.94
46	83.9	19.00	5.00	35.00	-6.49	-5.24	0.97
47	92.7	15.00	9.00	31.00	-16.09	0.24	1.01
48	79.6	19.00	4.00	33.00	-6.78	-6.59	1.68
49	81.2	17.00	7.00	28.00	-12.37	-2.53	0.89
50	85.0	30.00	9.00	46.00	15.85	-0.05	0.61
51	83.1	21.00	11.00	46.00	-5.45	2.78	0.66
52	77.2	17.00	12.00	36.00	-15.57	4.15	0.75
53	78.8	14.00	8.00	34.00	-19.68	-1.15	0.93
54	80.9	26.00	9.00	41.00	5.96	-0.00	0.63
55	77.8	18.00	6.00	40.00	-10.27	-3.90	0.64
56	77.0	12.00	6.00	28.00	-23.12	-3.80	1.36
57	78.1	24.00	7.00	39.00	2.06	-2.66	0.56
58	78.0	23.00	10.00	41.00	-1.65	1.38	0.75
59	81.6	15.00	8.00	33.00	-17.17	-1.15	0.79
60	76.1	15.00	6.00	32.00	-16.89	-3.85	0.93
61	76.3	17.00	11.00	40.00	-15.19	2.80	0.60
62	77.8	23.00	12.00	50.00	-2.72	4.05	0.57
63	76.3	20.00	8.00	35.00	-7.31	-1.26	0.88
64	75.6	24.00	3.00	42.00	3.51	-8.01	1.25
65	78.0	18.00	7.00	35.00	-10.76	-2.56	0.91
66	77.1	17.00	7.00	33.00	-13.01	-2.54	1.12
67	77.8	21.00	6.00	35.00	-3.89	-3.95	0.89
68	78.6	20.00	5.00	42.00	-5.34	-5.27	1.06
69	76.6	27.00	8.00	46.00	7.55	-1.37	0.84
70	78.4	14.00	10.00	34.00	-20.77	1.53	0.81
71	85.8	15.00	10.00	34.00	-17.68	1.55	0.89
72	83.6	11.00	14.00	36.00	-28.83	6.98	1.13
73	93.4	23.00	13.00	45.00	0.20	5.50	1.14
74	91.6	19.00	11.00	43.00	-8.23	2.86	1.00
75	79.2	18.00	11.00	36.00	-12.61	2.80	1.10
76	79.6	17.00	10.00	41.00	-14.19	1.48	0.60
77	80.0	12.00	9.00	33.00	-24.35	0.23	1.06
78	80.6	24.00	9.00	40.00	1.59	0.03	0.88
79	80.8	13.00	9.00	36.00	-22.12	0.22	0.69
80	78.0	15.00	10.00	35.00	-18.69	1.51	1.14
81	80.9	22.00	5.00	32.00	-0.56	-5.30	0.94
82	80.7	14.00	9.00	30.00	-19.97	0.20	1.14
83	81.9	26.00	11.00	59.00	5.18	2.69	0.57
84	86.5	25.00	11.00	46.00	4.12	2.73	1.07
85	78.1	13.00	14.00	38.00	-24.99	6.90	0.92
86	82.6	19.00	3.00	29.00	-5.68	-7.93	2.56
87	81.0	15.00	11.00	37.00	-18.82	2.87	1.58
88	81.9	19.00	10.00	47.00	-9.50	1.46	1.25
89	84.2	24.00	10.00	46.00	1.89	1.39	1.83
90	76.7	16.00	7.00	33.00	-15.20	-2.53	1.70
91	84.8	22.00	13.00	44.00	-3.97	5.46	1.26
92	81.3	16.00	10.00	37.00	-16.09	1.51	1.74
93	78.5	17.00	10.00	42.00	-14.35	1.48	2.21

SAM NO.	H#	3H CPM	14C CPM	WIDE CPM	3H DPM	14C DPM	LUMEX %
95	81.3	16.00	13.00	39.00	-17.67	5.53	1.80
96	86.7	19.00	11.00	44.00	-9.16	2.83	0.96
97	90.2	19.00	13.00	44.00	-9.62	5.55	1.89
98	79.4	24.00	4.00	40.00	3.90	-6.67	1.32
99	96.5	20.00	11.00	36.00	-4.92	2.88	2.69
100	90.9	14.00	8.00	37.00	-18.08	-1.10	1.49
101	82.2	14.00	7.00	37.00	-18.73	-2.48	1.70
102	99.2	15.00	3.00	24.00	-11.53	-7.85	2.91
103	81.0	19.00	9.00	37.00	-9.12	0.12	0.79
104	88.0	16.00	13.00	38.00	-16.73	5.59	0.98
105	85.6	22.00	10.00	40.00	-2.19	1.43	1.54
106	93.8	17.00	10.00	39.00	-11.86	1.56	1.40
107	80.2	24.00	6.00	36.00	3.05	-3.99	1.31
108	81.0	19.00	9.00	33.00	-9.14	0.12	1.77
109	81.2	12.00	11.00	35.00	-25.29	2.92	2.44
110	80.6	20.00	4.00	32.00	-4.43	-6.60	1.54
111	78.0	19.00	10.00	36.00	-10.16	1.44	1.40
112	87.6	15.00	9.00	36.00	-16.85	0.22	2.31
113	76.1	18.00	5.00	35.00	-10.04	-5.24	3.10
114	84.5	22.00	9.00	38.00	-1.90	0.08	1.54
115	85.4	14.00	14.00	40.00	-22.06	6.94	1.38
116	81.8	21.00	10.00	44.00	-5.17	1.43	1.55
117	83.3	16.00	7.00	36.00	-14.21	-2.51	1.25
118	85.1	23.00	17.00	50.00	-3.85	10.82	1.09
119	79.3	12.00	11.00	33.00	-25.46	2.91	1.12
120	78.0	13.00	8.00	26.00	-21.91	-1.14	2.03
121	91.5	11.00	8.00	29.00	-24.84	-1.04	2.39
122	80.5	30.00	7.00	55.00	15.54	-2.75	1.04
123	90.3	18.00	7.00	35.00	-8.54	-2.52	1.14
124	95.6	26.00	15.00	56.00	6.61	8.17	0.87
125	82.6	20.00	6.00	37.00	-5.07	-3.92	1.52
126	79.2	23.00	8.00	42.00	-0.36	-1.30	1.08
127	85.3	16.00	15.00	38.00	-18.19	8.25	1.60
128	80.1	22.00	15.00	46.00	-5.96	8.10	1.82
129	82.1	19.00	12.00	42.00	-10.51	4.15	2.60
130	91.1	18.00	10.00	37.00	-10.05	1.53	2.40
131	88.1	15.00	8.00	34.00	-16.23	-1.13	1.57
132	90.5	18.00	10.00	55.00	-10.18	1.53	2.34
133	82.9	21.00	11.00	44.00	-5.47	2.78	1.27
134	83.2	24.00	5.00	33.00	4.30	-5.33	2.63
135	86.6	20.00	11.00	48.00	-6.95	2.82	1.48
136	89.9	17.00	14.00	34.00	-14.74	6.93	2.15
137	79.5	16.00	14.00	45.00	-18.42	6.86	1.28
138	85.0	15.00	7.00	31.00	-16.15	-2.48	1.99
139	92.0	10.00	7.00	29.00	-26.52	-2.37	1.91
140	95.6	29.00	10.00	46.00	16.46	1.35	1.40
141	83.9	13.00	11.00	39.00	-22.82	2.92	0.96
142	92.9	18.00	14.00	41.00	-11.97	6.94	1.55
143	94.0	27.00	10.00	50.00	11.31	1.38	3.35
144	88.9	13.00	14.00	40.00	-23.90	6.99	1.69
145	98.3	14.00	8.00	35.00	-16.97	-1.06	2.06
146	80.4	10.00	8.00	32.00	-28.11	-1.08	1.28
147	87.5	15.00	14.00	38.00	-19.58	6.95	1.34
148	86.2	15.00	9.00	35.00	-17.04	0.21	1.68
149	80.4	11.00	5.00	26.00	-24.39	-5.11	2.46
150	84.4	21.00	17.00	53.00	-8.38	10.85	1.07
151	80.3	13.00	4.00	29.00	-19.56	-6.49	1.27
152	81.1	23.00	7.00	38.00	-2.47	1.10	1.10

SAM NO.	H#	3H CPM	14C CPM	WIDE CPM	3H DPM	14C DPM	LUMEX %
153	83.6	20.00	14.00	43.00	-9.12	6.83	1.26
154	83.4	11.00	16.00	41.00	-29.91	9.66	1.14
155	85.1	17.00	9.00	36.00	-12.80	0.17	1.64
156	79.8	18.00	9.00	35.00	-11.48	0.13	1.30
157	78.8	14.00	6.00	32.00	-18.65	-3.83	0.99
158	87.4	17.00	11.00	36.00	-13.50	2.87	1.82
159	82.9	24.00	10.00	50.00	1.59	1.38	2.14
160	87.9	19.00	8.00	43.00	-7.30	-1.20	2.19
161	87.8	21.00	13.00	40.00	-5.58	5.50	0.73
162	81.4	16.00	14.00	38.00	-18.18	6.88	1.09
163	79.5	25.00	4.00	42.00	6.07	-6.69	1.09
164	87.3	18.00	13.00	46.00	-12.37	5.55	3.43
165	82.0	16.00	11.00	39.00	-16.51	2.86	1.25
166	84.8	21.00	5.00	36.00	-1.89	-5.27	2.17
167	86.6	21.00	10.00	41.00	-4.19	1.45	1.40
168	85.2	11.00	7.00	25.00	-24.95	-2.41	2.98
169	88.1	16.00	6.00	28.00	-12.90	-3.84	2.38
170	91.1	12.00	4.00	25.00	-20.38	-6.45	2.96
171	85.8	9.00	11.00	32.00	-31.46	3.00	1.42
172	83.8	20.00	8.00	37.00	-5.90	-1.23	1.46
173	82.8	24.00	8.00	43.00	2.62	-1.30	1.20
174	80.7	17.00	11.00	39.00	-14.55	2.83	0.96
175	86.5	16.00	9.00	36.00	-14.78	0.20	2.68
176	84.8	24.00	11.00	49.00	1.51	2.74	0.86
177	87.2	10.00	9.00	33.00	-28.06	0.30	2.11
178	81.5	26.00	8.00	44.00	6.66	-1.34	1.26
179	84.1	14.00	9.00	30.00	-19.55	0.22	1.84
180	88.2	17.00	11.00	31.00	-13.37	2.88	1.87
181	82.2	15.00	12.00	34.00	-19.19	4.22	2.06
182	83.5	21.00	11.00	38.00	-5.36	2.78	2.16
183	84.5	13.00	13.00	38.00	-23.82	5.61	1.58
184	80.5	21.00	8.00	38.00	-4.38	-1.26	1.57
185	90.7	12.00	12.00	28.00	-24.87	4.33	1.59
186	82.8	19.00	9.00	34.00	-8.81	0.13	1.74
187	86.4	16.00	10.00	42.00	-15.34	1.54	1.55
188	87.3	17.00	7.00	38.00	-11.34	-2.51	0.92
189	85.1	17.00	6.00	30.00	-11.18	-3.86	1.58
190	83.9	16.00	9.00	35.00	-15.18	0.18	1.43
191	89.0	12.00	10.00	40.00	-23.94	1.63	1.89
192	94.4	16.00	12.00	39.00	-15.19	4.29	2.49
193	85.9	20.00	12.00	41.00	-7.63	4.16	1.90
194	90.7	24.00	11.00	45.00	2.95	2.77	2.87
195	85.3	20.00	14.00	43.00	-8.82	6.84	1.35
196	81.4	20.00	12.00	46.00	-8.47	4.13	0.87
197	94.2	17.00	6.00	36.00	-9.52	-3.84	1.44
198	85.5	25.00	11.00	45.00	3.89	2.72	1.03
199	84.4	21.00	12.00	41.00	-5.72	4.13	1.03
200	102.8	12.00	7.00	28.00	-20.51	-2.36	1.54
201	92.2	15.00	13.00	37.00	-18.40	5.64	2.11
202	86.9	26.00	12.00	48.00	5.92	4.06	1.57
203	89.3	16.00	13.00	46.00	-16.53	5.60	1.09
204	125.3	16.00	7.00	36.00	-5.63	-2.37	2.18
205	94.2	13.00	5.00	28.00	-18.22	-5.12	3.01
206	96.7	20.00	13.00	40.00	-6.00	5.58	1.59
207	86.4	14.00	10.00	39.00	-19.78	1.57	1.15
208	130.2	15.00	5.00	30.00	-5.75	-5.09	1.87
209	87.5	21.00	7.00	40.00	-2.37	-2.58	1.97
210	95.6	20.00	16.00	46.00	-7.95	9.23	1.54

SAM NO.	H#	3H CPM	14C CPM	WIDE CPM	3H DPM	14C DPM	LUMEX %
212	81.2	15.00	9.00	33.00	-17.75	0.19	1.54
213	91.5	24.00	15.00	48.00	0.93	8.17	1.58
214	92.4	14.00	14.00	41.00	-21.22	7.01	1.61
215	95.6	22.00	7.00	36.00	1.83	-2.57	1.54
216	89.5	14.00	14.00	38.00	-21.58	6.98	2.42
217	86.8	18.00	9.00	31.00	-10.28	0.16	1.49
218	84.3	18.00	14.00	37.00	-13.39	6.87	1.91
219	86.4	21.00	8.00	39.00	-3.16	-1.24	1.24
220	81.4	24.00	5.00	43.00	3.88	-5.33	1.35
221	95.1	19.00	12.00	41.00	-8.12	4.24	1.41
222	90.8	19.00	12.00	41.00	-8.95	4.21	1.26
223	85.0	19.00	15.00	42.00	-11.62	8.20	1.48
224	88.2	21.00	9.00	40.00	-3.31	0.12	0.95
225	93.7	21.00	10.00	42.00	-2.63	1.49	1.43
226	91.5	20.00	12.00	48.00	-6.52	4.19	1.60
227	79.6	24.00	12.00	42.00	-0.20	4.05	1.04
228	82.3	18.00	10.00	41.00	-11.59	1.48	1.33
229	82.5	32.00	11.00	51.00	18.38	2.59	1.20
230	83.6	21.00	13.00	46.00	-6.40	5.47	0.73
231	81.9	16.00	5.00	30.00	-13.37	-5.19	2.05
232	79.9	23.00	9.00	43.00	-0.72	0.04	1.14
233	84.1	19.00	14.00	43.00	-11.23	6.85	0.98
234	84.4	17.00	7.00	31.00	-11.85	-2.52	1.75
235	82.7	22.00	10.00	43.00	-2.80	1.42	0.90
236	84.9	17.00	11.00	36.00	-13.90	2.86	1.14
237	83.7	21.00	11.00	48.00	-5.32	2.78	0.95
238	85.7	17.00	11.00	36.00	-13.77	2.86	1.25
239	89.8	22.00	9.00	41.00	-0.69	0.10	1.44
240	86.1	21.00	8.00	37.00	-3.22	-1.24	1.53
241	86.4	9.00	8.00	32.00	-29.81	-1.03	2.48
242	88.5	16.00	10.00	33.00	-15.02	1.55	1.82
243	90.5	21.00	9.00	43.00	-2.81	0.13	0.63
244	86.0	20.00	20.00	54.00	-11.92	14.91	0.81
245	85.8	24.00	10.00	44.00	2.28	1.40	1.01
246	86.4	13.00	14.00	40.00	-24.17	6.97	0.91
247	84.8	19.00	9.00	36.00	-8.44	0.13	1.12
248	85.3	16.00	6.00	30.00	-13.36	-3.84	1.33
249	92.1	13.00	13.00	35.00	-22.98	5.67	1.17
250	94.5	20.00	15.00	44.00	-7.60	8.27	1.84
251	94.9	12.00	7.00	32.00	-21.57	-2.39	3.25
252	86.8	19.00	10.00	36.00	-8.61	1.49	1.18
253	90.2	10.00	13.00	30.00	-30.00	5.71	1.37
254	106.6	14.00	16.00	33.00	-20.49	9.86	2.04
255	100.2	18.00	9.00	40.00	-7.68	0.22	2.32
256	91.0	14.00	6.00	29.00	-16.96	-3.79	1.93
257	86.1	9.00	10.00	34.00	-30.91	1.66	1.43
258	87.5	15.00	4.00	30.00	-14.15	-6.51	1.97
259	85.1	17.00	10.00	40.00	-13.33	1.51	0.97
260	87.2	22.00	9.00	43.00	-1.30	0.09	1.12
261	86.0	24.00	10.00	44.00	2.32	1.40	1.25
262	89.2	15.00	12.00	42.00	-18.26	4.27	1.37
263	87.5	19.00	7.00	32.00	-6.85	-2.54	1.36
264	85.8	26.00	9.00	47.00	7.25	0.02	0.72
265	87.4	19.00	8.00	33.00	-7.40	-1.20	1.26
266	85.5	20.00	10.00	37.00	-6.63	1.47	1.41
267	85.3	24.00	9.00	43.00	2.69	0.05	1.00
268	82.3	14.00	7.00	29.00	-18.71	-2.48	1.58
269	84.1	21.00	8.00	34.00	-3.22	-1.24	1.06

SAM NO.	H#	3H CPM	14C CPM	WIDE CPM	3H DFM	14C DFM	LUMEX %
269	100.2	17.00	13.00	40.00	-12.42	5.67	1.39
270	98.4	20.00	12.00	42.00	-5.07	4.24	1.09
271	99.0	22.00	12.00	45.00	-0.17	4.21	0.73
272	88.4	13.00	11.00	36.00	-22.32	2.95	0.96
273	96.3	13.00	9.00	30.00	-20.20	0.30	1.70
274	87.3	20.00	8.00	39.00	-5.19	-1.22	1.60
275	87.7	15.00	9.00	27.00	-16.84	0.22	1.98
276	83.6	16.00	11.00	39.00	-16.29	2.87	1.67
277	88.4	17.00	12.00	38.00	-13.88	4.23	0.74
278	97.3	16.00	9.00	33.00	-12.99	0.25	1.77
279	91.0	19.00	13.00	46.00	-9.47	5.56	1.06
280	86.2	14.00	14.00	41.00	-21.96	6.95	1.83
281	84.5	18.00	4.00	33.00	-8.03	-6.57	1.25
282	93.7	15.00	9.00	35.00	-15.92	0.25	1.81
283	87.8	23.00	11.00	40.00	-0.02	2.77	1.23
284	88.3	16.00	12.00	38.00	-16.14	4.24	1.07
285	93.7	15.00	6.00	30.00	-14.23	-3.80	1.63
286	90.9	19.00	8.00	40.00	-6.71	-1.19	0.87