

Radiological Survey Sheet

Job Location 118C/C319 Page 1 of 25
 Survey Purpose LAD F/DOSE OUT Date 11-27-00
 Performed By E. GAILOR (Print) E. Gailor (Sign)

Inst.(1) (Model/SN) Beckman LS 6500 #7069448	Inst.(2) <u>LUDIVM 2241-2</u> (Model/SN) # <u>163603</u>	Inst.(3) (Model/SN)
Det. Internal (Model/SN)	Det. <u>LUDIVM 43-68</u> (Model/SN) # <u>PR149613</u>	Det. (Model/SN)
Eff. See LSC Printout	Eff. <u>~ 8%</u>	Eff.
Type rad. β	Type rad. β	Type rad.
Bkgd. See LSC Printout	Bkgd. <u>300 cpm</u>	Bkgd.
Cal. Due: 12/00	Cal. Due <u>2/13/01</u>	Cal. due

No.	Time	Location	Inst. Used	Total Activity (dpm/100 cm ²)
1.	0710	DOOR & HNDL	1	See attached LSC Printout
2.	↑	FLOOR	1	
3.		UPPER WALL	1	
4.		" "	1	
5.		CAB. DOORS & HNDLS	1	
6.		TOP SHELF	1	
7.		2ND "	1	
8.		3R "	1	
9.		BOTTOM "	1	
10.		CAB. DOORS & HNDLS	1	
11.		TOP SHELF	1	
12.		2ND "	1	
13.		3RD "	1	
14.		BOTTOM "	1	
15.		TOP SHELF	1	
16.		BOTTOM "	1	
17.		WALL BETWEEN SHELF	1	
18.	↓	PEG BOARD & TRAY BEHIND SINK	1	✓

Radiological Survey Continuation Sheet

Page 2 of 25

Date 11-27-00

No.	Time	Location	Inst. Used	Total Activity (dpm/100 cm ²)
19	0710	UPPER WALL	1	See attached LSC Printout
20	↑	LOWER "	1	
21		UPPER "	1	
22		LOWER "	1	
23		WALL BELOW CAB.	1	
24		" " "	1	
25		DRAWERS & HANDLS	1	
26		TOP DRAWER	1	
27		2ND "	1	
28		3RD "	1	
29		BOTTOM "	1	
30		DRAWER & HANDL	1	
31		DRAWER	1	
32		FLOOR UNDER COUNTER	1	
33		CAB. doors & HANDLS	1	
34		BACK OF CAB	1	
35		LEFT SIDE OF CAB	1	
36		RIGHT " " "	1	
37		BOTTOM OF CAB	1	
38		WIRE BASKET #1	1	
39		" " #2	1	
40		COUNTER	1	
41		"	1	
42		CUP	1	
43		BEHIND SINK	1	
44		INSIDE "	1	
45		SINK LEDGE	1	
46	↓	SINK "	1	✓

Radiological Survey Continuation Sheet

Page 3 of 25

Date 11-27-00

No.	Time	Location	Inst. Used	Total Activity (dpm/100 cm ²)
47	0710	LEDGE	1	See attached LSC Printout
48	↑	FLOOR	1	
49		"	1	
50		"	1	
51		"	1	
52		SIDE OF COUNTER	1	
53		" " "	1	
54		FLOOR	1	
55		TOP SHELF	1	
56		2ND "	1	
57		3RD "	1	
58		4TH "	1	
59		5TH "	1	
60		BOTTOM "	1	
61		TOP SHELF	1	
62		PC OF SHEET METAL	1	
63		2ND EDGE SHELF	1	
64		3RD EDGE "	1	
65		4TH "	1	
66		5TH "	1	
67		BOTTOM "	1	
68		DRAWER & HNDL	1	
69		DRAWER	1	
70		CAB. DOORS & HNDLS	1	
71		TOP SHELF	1	
72		BOTTOM "	1	
73		BACK OF CAB	1	
74	✓	LEFT SIDE OF CAB.	1	✓

Radiological Survey Continuation Sheet

Page 4 of 25

Date 11-27-00

No.	Time	Location	Inst. Used	Total Activity (dpm/100 cm ²)
75	0710	RIGHT side of CAB	1	See attached LSC Printout
76	↑	DRAWER & HNDL	1	
77		DRAWER	1	
78		FLOOR UNDER COUNTER	1	
79		CAB doors & DRAWERS & HNDLS	1	
80		TOP DRAWER	1	
81		2ND "	1	
82		3RD "	1	
83		BOTTOM "	1	
84		DRAWER & HNDL	1	
85		DRAWER	1	
86		FLOOR UNDER COUNTER	1	
87		DRAWERS & HNDLS	1	
88		TOP DRAWER	1	
89		2ND "	1	
90		3RD "	1	
91		BOTTOM "	1	
92		DRAWER & HNDL	1	
93		DRAWER	1	
94		DRAWERS & HNDLS	1	
95		TOP DRAWER	1	
96		2ND "	1	
97		BOTTOM "	1	
98		MARBLE SLAB	1	
99		COUNTER	1	
100		"	1	
101		CUP	1	
102	↓	SHELF	1	✓

Radiological Survey Continuation Sheet

Page 5 of 25

Date 11-27-00

No.	Time	Location	Inst. Used	Total Activity (dpm/100 cm ²)
103	0710	CVP	1	See attached LSC Printout
104	↑	COUNTER	1	
105		COUNTER	1	
106		DESK	1	
107		PLASTIC TRAY	1	
108		PC OF SHELF	1	
109		FLOOR	1	
110		"	1	
111		"	1	
112		"	1	
113		Cold BOX DOORS & HANDLS	1	
114		UPPER BACK LEFT	1	
115		LOWER " "	1	
116		UPPER " RIGHT	1	
117		LOWER " "	1	
118		UPPER SIDE LEFT	1	
119		LOWER " "	1	
120		UPPER " RIGHT	1	
121		LOWER " "	1	
122		TOP LEFT SHELF	1	
123		2ND " "	1	
124		3RD " "	1	
125		BOTTOM " "	1	
126		" " SIDE	1	
127		TOP RIGHT "	1	
128		2ND " "	1	
129		3RD " "	1	
130	✓	BOTTOM " "	1	✓

Radiological Survey Continuation Sheet

Page 6 of 25

Date 11-27-00

No.	Time	Location	Inst. Used	Total Activity (dpm/100 cm ²)
131	0710	Bottom RIGHT SIDE	1	See attached LSC Printout
132	↑	REFRIG DOORS & HANDLS	1	
133		BACK OF ^{FREEZER} REFRIG	1	
134		LEFT SIDE OF "	1	
135		RIGHT " " "	1	
136		BOTTOM " "	1	
137		TOP SHELF " "	1	
138		BOTTOM " " "	1	
139		BACK OF REFRIG	1	
140		LEFT SIDE OF "	1	
141		RIGHT " " "	1	
142		BOTTOM " "	1	
143		TOP SHELF	1	
144		2ND "	1	
145		3RD "	1	
146		BOTTOM "	1	
147		LEFT PLASTIC TRAY	1	
148		RIGHT " "	1	
149		TOP LEFT SMALL TRAY	1	
150		2ND " " "	1	
151		3RD " " "	1	
152		TOP RIGHT " "	1	
153		2ND " " "	1	
154		3RD " " "	1	
155		TOP BIG TRAY	1	
156		Bottom " "	1	
157		side OF COUNTER	1	
158	✓	" " "	1	✓

Radiological Survey Continuation Sheet

Page 7 of 25

Date 11-27-00

No.	Time	Location	Inst. Used	Total Activity (dpm/100 cm ²)
159	0710	FLOOR	1	See attached LSC Printout
160	↑	"	1	
161		UPPER WALL	1	
162		LOWER "	1	
163		SHELF	1	
164		WALL Below SHELF	1	
165		TOP SHELF	1	
166		2ND "	1	
167		3RD "	1	
168		BOTTOM "	1	
169		WALL	1	
170		TOP SHELF	1	
171		2ND "	1	
172		3RD "	1	
173		BOTTOM "	1	
174		DRAWERS & HANDLS	1	
175		TOP DRAWER	1	
176		MIDDLE "	1	
177		BOTTOM "	1	
178		DRAWER & HANDL	1	
179		DRAWER	1	
180		LAVDA	1	
181		COUNTER	1	
182		FLOOR UNDER COUNTER	1	
183		COUNTER	1	
184		COUNTER	1	
185		COUNTER	1	
186	✓	FLOOR UNDER COUNTER	1	✓

Radiological Survey Continuation Sheet

Page 8 of 25

Date 11-27-06

No.	Time	Location	Inst. Used	Total Activity (dpm/100 cm ²)
187	0710	UPPER WALL	1	See attached LSC Printout
188	K	LOWER "	1	
189		UPPER "	1	
190		LOWER "	1	
191		UPPER "	1	
192		LOWER "	1	
193		UPPER "	1	
194		LOWER "	1	
195		UPPER "	1	
196		LOWER "	1	
197		FLOOR	1	
198		"	1	
199		"	1	
200		"	1	
201		"	1	
202		TOP SHELF	1	
203		2ND "	1	
204		3RD "	1	
205		BOTTOM "	1	
206		TOP "	1	
207		2ND "	1	
208		3RD "	1	
209		BOTTOM "	1	
210		DRAWER & HNDL	1	
211		DRAWER	1	
212		DRAWER & HNDL	1	
213		DRAWER	1	
214	✓	DRAWERS & HNDLS	1	✓

Radiological Survey Continuation Sheet

Page 9 of 25

Date 11-27-00

No.	Time	Location	Inst. Used	Total Activity (dpm/100 cm ²)
215	0710	TOP DRAWER	1	See attached LSC Printout
216		MIDDLE "	1	
217		BOTTOM "	1	
218		COUNTER	1	
219		FLOOR UNDER COUNTER	1	
220		COUNTER	1	
221		SIDE OF COUNTER	1	
222		FLOOR	1	
223		"	1	
224		"	1	
225		OUTSIDE DOOR & HNDL	1	
226		UPPER WALL	1	
227		LOWER "	1	
228		UPPER "	1	
229		LOWER "	1	
230		WALL	1	
231		WALL	1	
232		UPPER WALL	1	
233		LOWER "	1	
234		UPPER "	1	
235		LOWER "	1	
236		TABLE TOP	1	
237		FLOOR	1	
238		"	1	
239		"	1	
240		"	1	
241		PLASTIC CONTAINER #1	1	
242		" " #2	1	

Radiological Survey Continuation Sheet

Page 10 of 25

Date 11-27-00

No.	Time	Location	Inst. Used	Total Activity (dpm/100 cm ²)
243	0710	PLASTIC CONTAINER #3	1	See attached LSC Printout
244	^	DRAWER & HANDLS	1	
245		DRAWER	1	
246		DRAWER & HANDLS	1	
247		DRAWER	1	
248		TABLE TOP	1	
249		" "	1	
250		FLOOR	1	
251		UPPER WALL	1	
252		LOWER "	1	
253		UPPER "	1	
254		LOWER "	1	
255		DRAWER & HANDL	1	
256		DRAWER	1	
257		DRAWERS & HANDLS	1	
258		TOP DRAWER	1	
259		MIDDLE "	1	
260		BOTTOM "	1	
261		FLOOR	1	
262		FLOOR	1	
263		FLOOR	1	
264		CAB. DOORS & HANDLS	1	
265		TOP SHELF	1	
266		2ND "	1	
267		3RD "	1	
268		BOTTOM "	1	
269		CABINET DOORS & HANDLS	1	
270	v	TOP SHELF	1	v

Radiological Survey Continuation Sheet

Page 11 of 25

Date 11-27-00

No.	Time	Location	Inst. Used	Total Activity (dpm/100 cm ²)
271	0710	2ND SHELF	1	See attached LSC Printout
272	↑	3RD "	1	
273		BOTTOM "	1	
274		CAB. DOORS & HANDLS	1	
275		TOP SHELF	1	
276		2ND "	1	
277		3RD "	1	
278		BOTTOM "	1	
279		CAB. DOORS & HANDLS	1	
280		TOP SHELF	1	
281		2ND "	1	(See #376)
282		3RD "	1	
283		BOTTOM "	1	
284		WALL UNDER CABS.	1	
285		LEDGE	1	
286		WALL UNDER CABS.	1	
287		TOP LEFT SHELF	1	
288		TOP RIGHT "	1	
289		BOTTOM "	1	
290		WALL UNDER CABS.	1	
291		DRAWER & HANDL	1	
292		DRAWER	1	
293		DRAWERS & HANDLS	1	
294		TOP DRAWER	1	
295		MIDDLE "	1	
296		BOTTOM "	1	
297		COUNTER	1	
298	✓	COUNTER	1	✓

Radiological Survey Continuation Sheet

Page 12 of 25

Date 11-27-08

No.	Time	Location	Inst. Used	Total Activity (dpm/100 cm ²)
299	0210	COUNTER	1	See attached LSC Printout
300	↑	CAB. DOORS & HANDLS	1	
301		TOP SHELF	1	
302		2ND "	1	
303		3RD "	1	
304		BOTTOM "	1	
305		CAB. DOORS & HANDLS	1	
306		TOP SHELF	1	
307		2ND "	1	
308		3RD "	1	
309		BOTTOM "	1	
310		WALL UNDER CABS,	1	
311		" " "	1	
312		LEDGE	1	
313		LOWER WALL	1	
314		UPPER WALL	1	
315		LOWER "	1	
316		TOP SHELF	1	
317		2ND "	1	
318		3RD "	1	
319		BOTTOM "	1	
320		DRAWERS & HANDLS DESK	1	
321		TOP ^{ES} DRAWERS & HANDLS	1	
322		FA TOP " "	1	
323		GM ^{MIDDLE} BOTTOM "	1	
324		BOTTOM "	1	
325		DRAWER & HANDL	1	
326	✓	DRAWER	1	✓

Radiological Survey Continuation Sheet

Page 13 of 25

Date 11-27-00

No.	Time	Location	Inst. Used	Total Activity (dpm/100 cm ²)
327	0210	DRAWERS & HANDLS	1	See attached LSC Printout
328	↑	TOP DRAWER	1	
329		2ND "	1	
330		3RD "	1	
331		BOTTOM "	1	
332		DRAWERS & HANDLS	1	
333		TOP DRAWER	1	
334		2ND "	1	
335		3RD "	1	
336		BOTTOM "	1	
337		DRAWER & HANDL	1	
338		DRAWER	1	
339		DRAWERS & HANDLS	1	
340		TOP DRAWER	1	
341		2ND "	1	
342		3RD "	1	
343		BOTTOM "	1	
344		DRAWERS & HANDLS	1	
345		TOP DRAWER	1	
346		2ND "	1	
347		3RD "	1	
348		BOTTOM "	1	
349		COUNTER	1	
350		COUNTER	1	
351		COUNTER	1	
352		COUNTER	1	
353		HOOD UPPER LEFT VENT	1	
354	✓	" " RIGHT "	1	✓

Radiological Survey Continuation Sheet

Page 14 of 25

Date 11-27-00

No.	Time	Location	Inst. Used	Total Activity (dpm/100 cm ²)
355	0710	Hood UPPER LEFT SECTION	1	See attached LSC Printout
356	↑	" " RIGHT "	1	
357		" LOWER X LEFT WENT	1	
358		" " RIGHT "	1	
359		" LOWER LEFT SECTION	1	
360		" " RIGHT "	1	
361		" LOWER BOTTOM LEFT	1	
362		" " " RIGH	1	
363		" CUP	1	
364		Hood LEFT SIDE	1	
365		Hood RIGHT "	1	
366		" INSIDE GLASS & SASH	1	
367		" OUTSIDE " & "	1	
368		CAB. doors & HANDLS	1	
369		BACK OF CAB.	1	
370		LEFT SIDE OF "	1	
371		RIGHT " " "	1	
372		BOTTOM " "	1	
373		CAB doors & HANDLS	1	
374		BACK OF CAB.	1	
375		LEFT SIDE OF CAB.	1	
376		RIGHT " " "	1	
377		BOTTOM OF CAB	1	
378		FLOOR	1	
379		UPPER side OF Hood	1	
380		LOWER " " "	1	
381		UPPER WALL	1	
382	✓	LOWER "	1	✓

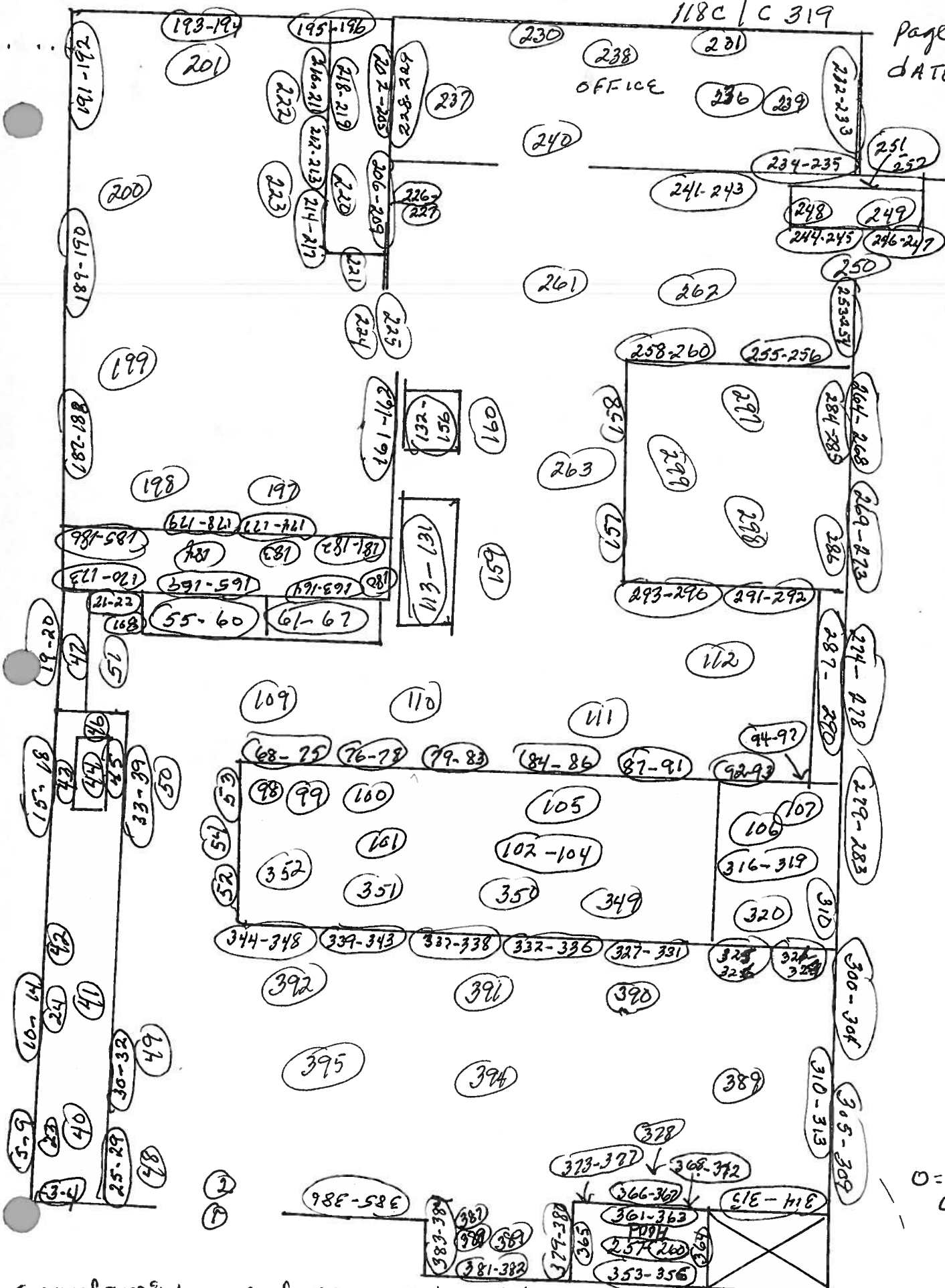

O = wife LOCATION

Surveyed = 100% lower surfaces using instrument #2. All surfaces surveyed were noted to be at normal background levels.

ID: EQUIPMENT SURVY

27 NOV 2000 09:25

USER: 1

COMMENT:

RESET TIME : 1.00

DATA CALC : DL DPM H# :YES SAMPLE REPEATS: 1 PRINTER :EDIT

COUNT BLANK : YES IC# : NO REPLICATES : 1 RS232 :EDIT

TWO PHASE : NO AQC :YES CYCLE REPEATS : 1

SCINTILLATOR: LIQUID LUMEX:YES LOW SAMPLE REJ: 0

LOW LEVEL : NO HALF LIFE CORRECTION DATE: none

ISOTOPE 1: 3H %ERROR: 2.00 FACTOR: 1.000000 BKG. SUB: 0

ISOTOPE 2: 14C %ERROR: 2.00 FACTOR: 1.000000 BKG. SUB: 0

WIDE OPEN WINDOW %ERROR: 0.00 FACTOR: 1.000000 BKG. SUB: 0

BACKGROUND QUENCH CURVE: Off COLOR QUENCH CORRECTION: Off

Quench Limits Low: 2.756 High:314.54

SAM NO	H#	3H CPM	14C CPM	WIDE CPM	3H DPM	14C DPM	LUMEX %
B1	87.5	30.00	8.00	42.00	57.08	10.45	12.68
1	76.6	24.00	5.00	42.00	-13.01	-4.01	5.33
2	83.8	16.00	10.00	35.00	-30.10	2.85	8.80
3	83.3	21.00	14.00	45.00	-22.20	8.19	4.93
4	80.7	19.00	9.00	36.00	-24.06	1.45	6.06
5	80.4	17.00	14.00	43.00	-30.54	8.21	9.59
6	79.0	23.00	12.00	48.00	-17.96	5.43	5.79
7	82.4	21.00	11.00	37.00	-20.82	4.13	5.34
8	82.9	24.00	10.00	42.00	-14.24	2.75	5.03
9	78.3	15.00	10.00	30.00	-32.73	2.83	9.01
10	80.9	10.00	9.00	24.00	-41.82	1.56	7.87
11	78.6	20.00	5.00	40.00	-20.43	-3.96	8.25
12	81.4	20.00	10.00	45.00	-22.47	2.79	5.84
13	78.6	25.00	9.00	37.00	-12.64	1.37	4.86
14	84.2	22.00	9.00	41.00	-17.49	1.43	7.65
15	86.4	17.00	11.00	33.00	-28.25	4.21	10.31
16	86.6	19.00	12.00	39.00	-24.68	5.54	8.09
17	82.5	16.00	7.00	30.00	-28.75	-1.20	8.09
18	80.2	22.00	11.00	40.00	-19.22	4.11	5.18
19	78.7	31.00	3.00	47.00	2.09	-6.78	4.54
20	82.9	22.00	8.00	39.00	-17.23	0.08	13.04
21	84.6	16.00	8.00	33.00	-28.98	0.16	5.73
22	81.8	19.00	11.00	41.00	-24.89	4.15	6.25
23	83.4	20.00	6.00	33.00	-20.11	-2.60	8.59
24	83.3	24.00	7.00	38.00	-12.64	-1.29	4.52
25	82.7	25.00	12.00	46.00	-13.30	5.44	3.51
26	81.7	25.00	12.00	45.00	-13.50	5.43	4.32
27	81.6	13.00	9.00	29.00	-35.82	1.53	6.06
28	82.2	28.00	5.00	39.00	-3.89	-4.04	5.98
29	79.3	28.00	12.00	42.00	-8.09	5.38	4.75
30	82.6	28.00	13.00	45.00	-7.84	6.75	2.77
31	83.9	31.00	17.00	53.00	-3.56	12.12	3.50
32	99.2	15.00	12.00	30.00	-31.25	5.69	11.85
33	86.9	17.00	16.00	39.00	-30.77	10.97	6.68
34	80.4	23.00	9.00	41.00	-16.22	1.40	4.12
35	78.6	13.00	7.00	24.00	-35.12	-1.18	6.77
36	83.2	20.00	13.00	41.00	-23.71	6.85	17.84
37	78.5	26.00	12.00	42.00	-12.19	5.39	2.85
38	81.8	17.00	9.00	35.00	-27.86	1.48	5.66

SAM NO	H#	3H CPM	14C CPM	WIDE CPM	3H DPM	14C DPM	LUMEX %
37	84.3	19.00	7.00	38.00	-22.48	-1.23	5.14
40	83.1	17.00	9.00	30.00	-27.69	1.49	5.20
41	85.4	20.00	10.00	39.00	-21.82	2.81	21.83
42	82.8	21.00	10.00	43.00	-20.24	2.79	10.49
43	88.4	28.00	7.00	49.00	-3.33	-1.33	2.08
44	81.7	11.00	6.00	31.00	-38.27	-2.49	11.66
45	80.8	23.00	8.00	41.00	-15.63	0.06	7.90
46	86.5	34.00	9.00	51.00	7.34	1.30	3.71
47	88.3	18.00	13.00	43.00	-26.99	6.92	4.09
48	89.2	20.00	9.00	42.00	-20.63	1.48	9.76
49	85.6	23.00	11.00	41.00	-16.23	4.13	2.49
50	85.8	20.00	5.00	31.00	-19.16	-3.94	4.76
51	87.5	19.00	7.00	38.00	-21.93	-1.22	6.75
52	82.4	23.00	9.00	47.00	-15.83	1.41	3.35
53	85.3	23.00	11.00	43.00	-16.29	4.13	5.20
54	86.5	17.00	9.00	33.00	-27.20	1.51	8.74
55	87.5	19.00	11.00	39.00	-24.02	4.19	5.05
56	83.3	26.00	5.00	37.00	-7.62	-4.02	6.84
57	85.0	13.00	9.00	29.00	-35.49	1.55	9.47
58	89.0	21.00	9.00	42.00	-18.62	1.47	6.96
59	90.5	17.00	13.00	33.00	-28.73	6.95	11.71
60	97.9	15.00	8.00	39.00	-29.20	0.24	10.76
61	86.6	15.00	7.00	26.00	-30.22	-1.17	12.32
62	85.7	16.00	9.00	37.00	-29.35	1.51	6.54
63	88.2	13.00	9.00	26.00	-35.15	1.56	10.01
64	88.7	17.00	7.00	35.00	-25.84	-1.19	5.17
65	88.6	25.00	11.00	55.00	-11.52	4.13	2.92
66	90.8	20.00	13.00	49.00	-22.46	6.91	5.57
67	90.2	15.00	10.00	41.00	-31.33	2.91	70.29
68	82.1	25.00	9.00	46.00	-11.92	1.39	4.94
69	86.3	24.00	8.00	39.00	-12.51	0.07	6.64
70	80.6	23.00	10.00	45.00	-16.68	2.75	3.44
71	74.2	27.00	8.00	42.00	-9.20	-0.02	1.82
72	81.8	21.00	10.00	36.00	-20.41	2.78	3.48
73	87.4	15.00	12.00	35.00	-32.72	5.59	1.83
74	88.8	18.00	11.00	37.00	-25.86	4.21	6.31
75	86.8	24.00	16.00	54.00	-16.55	10.89	4.35
76	84.4	13.00	11.00	35.00	-36.57	4.24	9.89
77	86.7	23.00	8.00	41.00	-14.45	0.08	11.00
78	89.8	21.00	11.00	49.00	-19.51	4.18	9.30
79	87.0	17.00	11.00	42.00	-28.17	4.21	4.44
80	85.4	15.00	12.00	37.00	-32.94	5.58	6.76
81	85.1	27.00	11.00	50.00	-8.24	4.08	3.61
82	83.8	15.00	6.00	31.00	-30.07	-2.54	4.87
83	86.3	14.00	13.00	36.00	-35.39	6.95	4.47
84	84.8	24.00	9.00	43.00	-13.33	1.41	4.92
85	84.2	13.00	12.00	35.00	-37.09	5.59	7.89
86	91.8	14.00	8.00	35.00	-32.14	0.22	14.09
87	81.6	22.00	10.00	41.00	-18.47	2.77	3.80
88	83.0	19.00	11.00	40.00	-24.71	4.16	3.39
89	83.6	23.00	10.00	44.00	-16.11	2.77	5.25
90	87.4	11.00	7.00	25.00	-38.28	-1.12	8.14
91	84.1	13.00	11.00	30.00	-36.60	4.24	4.65
92	84.5	23.00	9.00	41.00	-15.41	1.42	3.10
93	89.0	13.00	13.00	34.00	-37.17	6.98	3.21
94	89.4	20.00	13.00	39.00	-22.70	6.90	3.89
95	85.4	20.00	8.00	34.00	-20.78	0.11	4.66
96	83.2	12.00	6.00	24.00	-36.14	-2.50	4.72

SAM NO	H#	3H CPM	14C CPM	WIDE CPM	3H DPM	14C DPM	LUMEX %
7	89.7	19.00	12.00	39.00	-24.19	5.56	3.87
78	86.9	17.00	15.00	33.00	-30.26	9.62	6.52
99	87.7	14.00	9.00	32.00	-33.17	1.55	6.56
100	97.9	18.00	13.00	40.00	-25.52	7.00	25.11
101	92.8	17.00	9.00	29.00	-26.26	1.54	8.04
102	90.8	9.00	3.00	26.00	-39.99	-6.50	6.92
103	90.8	19.00	8.00	34.00	-21.89	0.15	5.85
104	89.6	14.00	10.00	34.00	-33.46	2.91	15.55
105	88.3	17.00	13.00	40.00	-29.04	6.93	5.64
106	84.4	18.00	10.00	35.00	-26.00	2.83	3.79
107	92.1	29.00	12.00	47.00	-2.90	5.46	5.63
108	85.5	17.00	11.00	44.00	-28.38	4.20	3.80
109	85.6	13.00	6.00	28.00	-33.88	-2.50	5.81
110	87.6	15.00	11.00	40.00	-32.17	4.24	5.11
111	88.3	19.00	8.00	35.00	-22.32	0.14	5.36
112	87.4	18.00	13.00	40.00	-27.11	6.91	5.38
113	81.4	17.00	13.00	39.00	-29.92	6.87	5.85
114	80.6	21.00	6.00	34.00	-18.62	-2.62	5.93
115	83.0	24.00	10.00	39.00	-14.21	2.75	2.86
116	84.0	26.00	13.00	46.00	-11.54	6.78	3.11
117	81.0	24.00	17.00	56.00	-18.13	12.18	3.77
118	84.3	21.00	7.00	39.00	-18.46	-1.26	5.36
119	81.9	18.00	10.00	34.00	-26.37	2.82	6.90
120	81.0	25.00	9.00	48.00	-12.14	1.38	4.32
121	85.3	20.00	7.00	39.00	-20.28	-1.24	4.08
122	82.6	22.00	10.00	38.00	-18.28	2.77	8.14
123	82.8	24.00	11.00	45.00	-14.77	4.10	3.48
124	83.5	22.00	12.00	43.00	-19.14	5.48	3.71
125	88.2	15.00	15.00	38.00	-34.19	9.66	4.78
126	100.1	20.00	12.00	45.00	-20.22	5.63	2.51
127	85.2	23.00	10.00	40.00	-15.78	2.78	3.94
128	82.1	19.00	13.00	38.00	-25.85	6.85	3.88
129	84.7	17.00	12.00	39.00	-28.99	5.55	6.26
130	84.8	20.00	10.00	37.00	-21.92	2.81	1.95
131	85.9	22.00	10.00	42.00	-17.67	2.79	4.06
132	83.8	25.00	7.00	40.00	-10.53	-1.31	4.82
133	79.5	20.00	11.00	39.00	-23.27	4.12	3.95
134	85.6	18.00	13.00	38.00	-27.37	6.89	5.41
135	82.7	16.00	10.00	37.00	-30.24	2.85	4.51
136	86.9	21.00	6.00	38.00	-17.45	-2.60	6.21
137	84.9	18.00	9.00	40.00	-25.42	1.48	4.87
138	83.0	16.00	18.00	43.00	-34.26	13.64	2.50
139	85.2	14.00	12.00	31.00	-34.99	5.59	7.15
140	83.0	24.00	7.00	40.00	-12.70	-1.30	6.43
141	88.4	25.00	15.00	48.00	-13.66	9.54	3.16
142	86.9	13.00	12.00	34.00	-36.85	5.61	4.40
143	82.6	23.00	10.00	39.00	-16.30	2.76	3.73
144	72.9	24.00	9.00	39.00	-15.67	1.35	1.27
145	72.7	19.00	6.00	35.00	-23.78	-2.62	1.15
146	75.1	26.00	11.00	52.00	-12.39	4.03	1.99
147	84.9	20.00	12.00	40.00	-22.93	5.51	3.71
148	89.6	24.00	6.00	40.00	-10.74	-2.63	1.91
149	86.8	19.00	9.00	45.00	-23.09	1.48	2.81
150	82.4	17.00	4.00	31.00	-25.25	-5.26	12.63
151	88.1	20.00	8.00	35.00	-20.31	0.12	4.58
152	85.8	27.00	8.00	43.00	-6.54	0.03	4.65
153	85.9	14.00	8.00	25.00	-32.86	0.19	5.77
154	83.0	23.00	13.00	48.00	-17.73	6.81	5.66

SAM NO	H#	3H CPM	14C CPM	WIDE CPM	3H DPM	14C DPM	LUMEX %
155	85.4	19.00	12.00	41.00	-24.85	5.53	3.52
156	86.9	25.00	6.00	34.00	-9.31	-2.65	5.40
157	83.0	15.00	8.00	27.00	-31.18	0.16	5.47
158	83.2	22.00	13.00	40.00	-19.70	6.83	4.54
159	87.3	14.00	8.00	33.00	-32.69	0.19	5.60
160	82.2	18.00	11.00	37.00	-26.82	4.17	3.75
161	81.5	21.00	7.00	33.00	-18.97	-1.27	4.27
162	80.2	34.00	8.00	46.00	5.93	-0.08	2.29
163	89.3	19.00	9.00	38.00	-22.67	1.50	20.45
164	86.3	20.00	17.00	48.00	-25.28	12.28	4.61
165	89.2	24.00	13.00	51.00	-14.50	6.85	4.65
166	85.5	19.00	8.00	34.00	-22.78	0.13	10.56
167	84.2	19.00	11.00	43.00	-24.53	4.17	5.95
168	87.5	26.00	6.00	41.00	-7.13	-2.66	5.60
169	82.9	28.00	17.00	52.00	-9.81	12.15	2.97
170	92.0	18.00	7.00	47.00	-23.22	-1.19	7.68
171	92.4	23.00	15.00	49.00	-16.99	9.60	4.47
172	94.4	17.00	8.00	33.00	-25.48	0.19	4.46
173	88.2	13.00	14.00	34.00	-37.77	8.33	10.04
174	84.1	26.00	12.00	47.00	-11.00	5.43	3.28
175	85.9	25.00	8.00	44.00	-10.56	0.05	3.36
176	86.8	18.00	16.00	44.00	-28.76	10.96	3.80
177	89.4	25.00	11.00	50.00	-11.34	4.13	10.29
178	91.1	22.00	11.00	44.00	-17.20	4.18	6.77
179	88.5	15.00	11.00	38.00	-32.06	4.25	3.85
180	86.5	25.00	11.00	46.00	-11.98	4.11	4.60
181	88.4	26.00	9.00	47.00	-8.47	1.41	4.09
182	91.5	13.00	10.00	31.00	-35.33	2.94	10.86
183	87.6	16.00	6.00	36.00	-27.53	-2.53	4.97
184	91.1	18.00	9.00	36.00	-24.44	1.52	6.98
185	93.3	18.00	8.00	39.00	-23.55	0.17	4.58
186	92.2	18.00	9.00	33.00	-24.26	1.53	3.57
187	87.2	9.00	12.00	31.00	-44.97	5.66	1.71
188	86.8	20.00	12.00	37.00	-22.61	5.53	4.45
189	85.5	23.00	8.00	39.00	-14.70	0.08	3.31
190	84.6	18.00	15.00	38.00	-28.53	9.59	2.84
191	88.1	20.00	11.00	39.00	-21.87	4.18	4.49
192	87.5	31.00	8.00	45.00	2.05	-0.01	1.68
193	85.6	17.00	6.00	33.00	-25.78	-2.55	3.51
194	85.5	25.00	6.00	39.00	-9.62	-2.65	11.39
195	87.5	25.00	7.00	40.00	-9.68	-1.29	4.93
196	84.0	19.00	11.00	40.00	-24.57	4.17	9.33
197	90.1	22.00	9.00	46.00	-16.34	1.46	3.92
198	91.4	12.00	7.00	27.00	-35.83	-1.12	5.51
199	104.2	21.00	13.00	55.00	-17.76	7.01	6.06
200	92.7	17.00	14.00	39.00	-28.96	8.32	3.50
201	87.6	13.00	15.00	35.00	-38.34	9.68	5.45
202	90.2	21.00	7.00	38.00	-17.33	-1.23	3.69
203	87.8	20.00	7.00	41.00	-19.84	-1.23	7.86
204	85.6	23.00	13.00	49.00	-17.25	6.83	3.34
205	85.7	21.00	10.00	43.00	-19.74	2.80	5.47
206	87.6	17.00	10.00	37.00	-27.56	2.86	6.66
207	84.9	27.00	8.00	39.00	-6.77	0.03	3.68
208	78.6	24.00	6.00	39.00	-13.11	-2.66	1.55
209	86.8	22.00	10.00	47.00	-17.51	2.80	5.56
210	83.2	14.00	6.00	25.00	-32.14	-2.53	4.33
211	89.1	14.00	19.00	45.00	-38.26	15.10	3.08
212	82.9	23.00	9.00	45.00	-15.74	1.41	6.61

*SAM NO	H#	3H CPM	14C CPM	WIDE CPM	3H DPM	14C DPM	LUMEX %
213	83.7	17.00	12.00	43.00	-29.12	5.54	4.57
214	86.5	10.00	11.00	30.00	-42.46	4.29	4.50
215	86.5	15.00	9.00	32.00	-31.27	1.53	4.58
216	84.6	21.00	7.00	37.00	-18.39	-1.25	7.68
217	88.0	17.00	10.00	33.00	-27.51	2.87	4.10
218	89.4	17.00	10.00	41.00	-27.31	2.88	4.04
219	91.9	19.00	15.00	42.00	-25.44	9.65	2.77
220	84.6	20.00	7.00	35.00	-20.42	-1.24	3.21
221	89.4	13.00	15.00	34.00	-38.19	9.70	5.00
222	87.0	27.00	8.00	48.00	-6.25	0.03	6.44
223	86.2	12.00	12.00	35.00	-38.94	5.62	5.49
224	87.4	13.00	14.00	33.00	-37.84	8.32	3.91
225	86.5	13.00	8.00	35.00	-34.82	0.20	4.61
226	81.5	24.00	11.00	42.00	-15.03	4.09	2.60
227	87.3	12.00	15.00	32.00	-40.41	9.69	5.66
228	85.3	28.00	8.00	48.00	-4.65	0.02	3.60
229	86.9	21.00	13.00	44.00	-21.08	6.87	5.51
230	86.8	22.00	8.00	43.00	-16.47	0.09	4.82
231	87.0	19.00	8.00	33.00	-22.54	0.13	3.29
232	84.8	21.00	11.00	39.00	-20.40	4.15	4.64
233	87.2	18.00	9.00	37.00	-25.06	1.50	4.96
234	88.3	18.00	14.00	45.00	-27.51	8.27	3.29
235	87.7	19.00	11.00	39.00	-23.99	4.19	3.06
236	92.6	15.00	13.00	40.00	-32.63	6.99	6.79
237	100.0	28.00	16.00	51.00	-5.05	10.97	7.07
238	91.7	14.00	5.00	26.00	-30.55	-3.85	7.75
239	92.5	15.00	7.00	34.00	-29.43	-1.15	5.32
240	93.2	14.00	10.00	36.00	-33.05	2.94	6.65
241	84.1	21.00	12.00	40.00	-21.03	5.50	2.48
242	82.0	27.00	11.00	46.00	-8.95	4.06	2.49
243	85.0	28.00	8.00	48.00	-4.73	0.01	2.75
244	84.8	20.00	13.00	38.00	-23.45	6.86	2.59
245	85.9	20.00	10.00	40.00	-21.72	2.82	4.05
246	85.7	17.00	17.00	41.00	-31.43	12.31	3.09
247	87.2	13.00	11.00	34.00	-36.30	4.26	3.57
248	94.4	24.00	9.00	44.00	-11.21	1.46	21.84
249	93.4	20.00	9.00	37.00	-19.86	1.51	9.32
250	90.5	20.00	18.00	46.00	-25.16	13.68	3.11
251	87.1	14.00	16.00	34.00	-36.87	11.01	3.86
252	84.8	22.00	14.00	46.00	-19.93	8.19	4.20
253	84.6	24.00	12.00	42.00	-14.92	5.46	2.91
254	87.0	22.00	11.00	45.00	-17.99	4.15	3.25
255	83.4	27.00	11.00	47.00	-8.64	4.07	3.43
256	85.8	26.00	7.00	42.00	-8.05	-1.31	2.84
257	89.8	18.00	9.00	38.00	-24.66	1.51	4.55
258	84.3	17.00	14.00	38.00	-30.07	8.25	2.86
259	87.3	15.00	9.00	30.00	-31.16	1.53	5.87
260	82.4	25.00	16.00	52.00	-15.38	10.83	1.29
261	90.4	21.00	11.00	36.00	-19.41	4.19	4.08
262	86.4	18.00	7.00	38.00	-24.15	-1.21	3.21
263	87.8	21.00	10.00	43.00	-19.36	2.82	6.90
264	84.8	13.00	5.00	29.00	-33.45	-3.86	6.19
265	84.0	24.00	11.00	44.00	-14.53	4.11	2.91
266	86.1	22.00	15.00	50.00	-20.23	9.55	3.42
267	84.4	25.00	9.00	43.00	-11.41	1.40	3.13
268	83.9	15.00	11.00	36.00	-32.61	4.22	7.69
269	82.4	14.00	14.00	39.00	-36.28	8.26	2.80
270	86.0	17.00	6.00	34.00	-25.72	-2.55	3.12

SAM NO	H#	3H CPM	14C CPM	WIDE CPM	3H DPM	14C DPM	LUMEX %
271	84.0	15.00	12.00	34.00	-33.09	5.57	11.21
272	83.8	17.00	8.00	38.00	-27.08	0.14	3.44
273	86.8	32.00	10.00	53.00	2.84	2.68	2.23
274	71.6	20.00	11.00	37.00	-24.43	4.07	1.34
275	82.1	20.00	9.00	39.00	-21.85	1.45	2.37
276	83.8	20.00	13.00	41.00	-23.61	6.85	5.70
277	84.9	15.00	8.00	32.00	-30.95	0.17	2.15
278	85.3	14.00	12.00	32.00	-34.97	5.59	3.77
279	88.5	15.00	8.00	32.00	-30.49	0.19	6.23
280	85.2	17.00	6.00	36.00	-25.84	-2.55	4.64
281	88.6	61.00	14.00	87.00	60.81	7.74	67.83
282	85.2	20.00	11.00	38.00	-22.36	4.16	5.25
283	88.1	16.00	13.00	35.00	-31.10	6.94	4.02
284	81.9	24.00	10.00	41.00	-14.45	2.75	4.03
285	84.5	16.00	7.00	35.00	-28.47	-1.19	8.92
286	84.7	15.00	10.00	31.00	-32.00	2.87	4.40
287	88.7	19.00	9.00	36.00	-22.77	1.49	4.11
288	105.8	10.00	12.00	34.00	-41.59	5.81	5.54
289	92.1	13.00	9.00	32.00	-34.73	1.59	4.53
290	81.2	24.00	5.00	44.00	-12.06	-4.00	3.23
291	90.5	21.00	7.00	39.00	-17.27	-1.23	5.16
292	90.2	12.00	17.00	34.00	-41.24	12.42	3.01
293	85.1	19.00	8.00	36.00	-22.86	0.12	5.04
294	85.7	25.00	12.00	47.00	-12.67	5.46	2.77
295	86.1	26.00	10.00	49.00	-9.53	2.75	2.02
296	83.7	22.00	14.00	49.00	-20.12	8.18	2.36
297	89.8	17.00	9.00	33.00	-26.72	1.52	4.30
298	87.7	20.00	7.00	31.00	-19.86	-1.23	3.76
299	84.9	15.00	16.00	38.00	-35.05	10.98	2.15
300	90.1	13.00	17.00	40.00	-39.18	12.41	3.85
301	86.2	15.00	14.00	38.00	-33.89	8.29	2.89
302	87.4	19.00	11.00	41.00	-24.02	4.19	3.42
303	83.8	23.00	9.00	44.00	-15.55	1.42	3.14
304	87.6	17.00	11.00	40.00	-28.08	4.22	3.43
305	86.9	15.00	13.00	39.00	-33.29	6.94	3.62
306	90.0	20.00	8.00	36.00	-19.97	0.13	2.88
307	87.7	12.00	12.00	31.00	-38.81	5.63	4.73
308	86.9	18.00	16.00	43.00	-28.74	10.96	5.76
309	91.5	12.00	11.00	32.00	-37.94	4.31	6.93
310	85.3	16.00	11.00	31.00	-30.43	4.21	3.05
311	85.6	22.00	13.00	43.00	-19.28	6.85	2.81
312	88.8	23.00	11.00	46.00	-15.58	4.15	5.75
313	85.9	21.00	10.00	45.00	-19.71	2.81	2.89
314	82.2	23.00	10.00	42.00	-16.37	2.76	6.04
315	84.0	19.00	10.00	38.00	-24.05	2.82	1.64
316	94.4	10.00	14.00	41.00	-43.53	8.43	5.56
317	89.4	17.00	11.00	34.00	-27.83	4.23	5.34
318	93.7	22.00	12.00	43.00	-17.21	5.55	2.93
319	88.6	12.00	6.00	26.00	-35.59	-2.48	6.84
320	103.0	17.00	6.00	29.00	-22.86	-2.49	5.18
321	84.0	35.00	6.00	55.00	10.09	-2.77	2.73
322	85.9	15.00	7.00	29.00	-30.30	-1.18	4.40
323	90.0	26.00	7.00	48.00	-7.02	-1.29	3.53
324	86.2	14.00	9.00	33.00	-33.33	1.54	2.90
325	84.8	17.00	4.00	32.00	-24.88	-5.26	5.97
326	87.7	24.00	15.00	48.00	-15.84	9.54	2.74
327	83.7	15.00	14.00	37.00	-34.15	8.26	14.06
328	81.7	14.00	9.00	29.00	-33.82	1.51	7.24

SAM NO	H#	3H CPM	14C CPM	WIDE CPM	3H DPM	14C DPM	LUMEX %
329	82.0	19.00	8.00	36.00	-23.34	0.11	8.30
330	84.3	28.00	9.00	46.00	-5.40	1.36	2.32
331	82.6	21.00	9.00	37.00	-19.77	1.44	4.69
332	81.9	27.00	10.00	45.00	-8.49	2.71	2.47
333	83.2	10.00	8.00	27.00	-41.16	0.22	5.34
334	79.0	19.00	9.00	36.00	-24.30	1.44	3.11
335	81.5	17.00	6.00	39.00	-26.39	-2.57	2.14
336	85.8	16.00	11.00	33.00	-30.35	4.22	4.48
337	87.6	17.00	16.00	37.00	-30.70	10.98	2.30
338	89.1	19.00	9.00	35.00	-22.71	1.50	2.44
339	84.5	21.00	4.00	36.00	-16.89	-5.31	3.21
340	83.2	23.00	5.00	32.00	-13.64	-3.98	2.61
341	82.2	20.00	11.00	37.00	-22.84	4.14	6.36
342	83.9	27.00	5.00	44.00	-5.47	-4.03	2.67
343	87.0	17.00	9.00	31.00	-27.13	1.51	5.74
344	87.5	17.00	5.00	27.00	-24.98	-3.90	4.48
345	83.4	20.00	17.00	45.00	-25.71	12.25	2.97
346	85.9	20.00	9.00	39.00	-21.22	1.47	2.48
347	84.0	20.00	12.00	39.00	-23.07	5.51	2.17
348	85.8	19.00	12.00	40.00	-24.79	5.53	2.47
349	93.5	23.00	10.00	42.00	-14.07	2.83	2.99
350	86.8	15.00	7.00	34.00	-30.19	-1.17	4.06
351	87.5	20.00	11.00	39.00	-21.98	4.18	3.07
352	87.4	18.00	12.00	36.00	-26.59	5.56	3.32
353	89.0	10.00	15.00	34.00	-44.39	9.73	4.36
354	89.2	17.00	12.00	35.00	-28.39	5.58	3.27
355	84.4	28.00	12.00	53.00	-6.91	5.41	3.14
356	87.8	23.00	12.00	43.00	-16.31	5.50	3.01
357	101.2	18.00	7.00	34.00	-21.56	-1.15	4.48
358	94.5	21.00	9.00	39.00	-17.54	1.50	2.53
359	87.8	25.00	8.00	41.00	-10.14	0.06	4.31
360	87.6	21.00	11.00	45.00	-19.92	4.17	2.08
361	86.2	23.00	6.00	37.00	-13.51	-2.62	13.50
362	84.5	18.00	13.00	39.00	-27.52	6.88	3.13
363	81.5	25.00	14.00	48.00	-14.55	8.12	1.03
364	79.8	14.00	9.00	38.00	-34.03	1.50	1.17
365	77.1	33.00	13.00	55.00	0.65	6.65	0.58
366	84.5	23.00	8.00	38.00	-14.89	0.07	3.96
367	87.7	12.00	17.00	37.00	-41.42	12.40	2.35
368	87.1	17.00	12.00	39.00	-28.68	5.57	4.56
369	87.0	21.00	5.00	36.00	-16.91	-3.95	4.17
370	85.6	10.00	20.00	38.00	-47.15	16.45	4.54
371	88.8	20.00	15.00	41.00	-23.85	9.60	3.15
372	86.4	22.00	9.00	46.00	-17.06	1.44	2.20
373	86.8	18.00	8.00	37.00	-24.60	0.14	4.37
374	83.5	15.00	17.00	46.00	-35.69	12.31	2.94
375	82.5	27.00	5.00	40.00	-5.80	-4.03	2.60
376	88.2	18.00	6.00	30.00	-23.34	-2.56	4.44
377	87.1	19.00	12.00	38.00	-24.60	5.54	2.17
378	94.8	26.00	20.00	57.00	-12.86	16.38	2.45
379	85.8	22.00	9.00	46.00	-17.19	1.44	2.55
380	87.1	9.00	7.00	24.00	-42.38	-1.10	5.30
381	85.3	18.00	14.00	43.00	-27.92	8.24	2.06
382	87.7	18.00	10.00	38.00	-25.51	2.85	3.25
383	83.2	21.00	10.00	38.00	-20.18	2.79	2.34
384	83.5	24.00	9.00	42.00	-13.61	1.41	2.55
385	86.4	16.00	13.00	33.00	-31.32	6.92	2.88
386	87.2	23.00	10.00	42.00	-15.39	2.79	2.12

SAM NO	H#	3H CPM	14C CPM	WIDE CPM	3H DPM	14C DPM	LUMEX %
387	87.9	19.00	10.00	39.00	-23.43	2.84	4.12
388	90.6	14.00	17.00	39.00	-37.07	12.40	5.32
389	90.9	18.00	7.00	35.00	-23.42	-1.19	4.76
390	92.0	12.00	18.00	38.00	-41.65	13.80	4.38
391	91.7	14.00	4.00	24.00	-30.02	-5.21	11.17
392	88.4	14.00	13.00	35.00	-35.18	6.97	6.78
393	87.7	15.00	13.00	32.00	-33.20	6.95	3.00
394	78.4	16.00	7.00	30.00	-29.28	-1.22	1.88
395	88.7	23.00	11.00	42.00	-15.62	4.15	4.76

ID: MONTHLY WIPES

28 NOV 2000 15:56

USER: 4 COMMENT:
 PULSE TIME : 1.00
 DATA CALC : DL DPM H# : YES SAMPLE REPEATS: 1 PRINTER : EDIT
 COUNT BLANK : YES IC# : NO REPLICATES : 1 RS232 : EDIT
 TWO PHASE : NO ADC : YES CYCLE REPEATS : 1
 SCINTILLATOR: LIQUID LUMEX: YES LOW SAMPLE REJ: 0
 LOW LEVEL : NO HALF LIFE CORRECTION DATE: none

ISOTOPE 1: 3H %ERROR: 2.00 FACTOR: 1.0000 BKG. SUB: 0
 ISOTOPE 2: 14C %ERROR: 2.00 FACTOR: 1.0000 BKG. SUB: 0
 WIDE OPEN WINDOW %ERROR: 0.00 FACTOR: 1.0000 BKG. SUB: 0

BACKGROUND QUENCH CURVE: Off COLOR QUENCH CORRECTION: Off

Quench Limits Low: 13.688 High: 306.34

SAM NO	H#	3H CPM	14C CPM	WIDE CPM	3H DPM	14C DPM	RATIO	LUMEX %
B1	128.0	23.00	5.00	35.00	61.89	6.34	9.758	14.24
		Blank Average	DPM	for	3H :	61.89	COEF. OF VAR:	0.000
		Blank Average	DPM	for	14C :	6.34	COEF. OF VAR:	0.000
396	128.0	16.00	10.00	35.00	-23.44	7.07	-3.316	18.94