

Radiological Survey Sheet

Job Location 118C/C318 Page 1 of 23
 Survey Purpose LAB CLOSE OUT Date 11-28-00
 Performed By E. GAILOR E. Gailor
 (Print) (Sign)

Inst.(1) (Model/SN) Beckman LS 6500 #7069448	Inst.(2) <u>Wdium 2241-2</u> (Model/SN) # <u>163603</u>	Inst.(3) (Model/SN)
Det. Internal (Model/SN)	Det. <u>Wdium 43-68</u> (Model/SN) # <u>PR149613</u>	Det. (Model/SN)
Eff. See LSC Printout	Eff. = <u>8% C14</u>	Eff.
Type rad. β	Type rad. β	Type rad.
Bkgd. See LSC Printout	Bkgd. <u>300 cpm</u>	Bkgd.
Cal. Due: 12/00	Cal. Due <u>2/13/01</u>	Cal. due

No.	Time	Location	Inst. Used	Total Activity (dpm/100 cm ²)
1.	1500	look @ HNDL	1	See attached LSC Printout
2.	↑	FLOOR	1	
3.		UPPER WALL	1	
4.		PHONE	1	
5.		LOWER WALL	1	
6.		UPPER " "	1	
7.		LOWER " "	1	
8.		UPPER " "	1	
9.		LOWER " "	1	
10.		UPPER SIDE OF HOOD	1	
11.		Lower " " "	1	
12.		FLOOR	1	
13.		HOOD UPPER LEFT VENT	1	
14.		" UPPER BACK LEFT SIDE	1	
15.		" UPPER RIGHT VENT	1	
16.		" " BACK RIGHT SIDE	1	
17.		" LOWER BACK LEFT SIDE	1	
18.	↓	" " " RIGHT "	1	✓

Radiological Survey Continuation Sheet

Page 2 of 23

Date 4-28-00

No.	Time	Location	Inst. Used	Total Activity (dpm/100 cm ²)
19	1500	Hood LOWER BACK middle LEFT VENT	1	See attached LSC Printout
20	"	" " " " RIGHT VENT	1	
21		Hood " BACK BOTTOM LEFT VENT	1	
22		" " " " RIGHT VENT	1	
23		" LEFT SIDE	1	
24		" RIGHT "	1	
25		" BOTTOM. LEFT SIDE	1	
26		" " RIGHT "	1	
27		Hood CUP	1	
28		Hood INSIDE GLASS & SASH	1	
29		" OUTSIDE " "	1	
30		Hood LIP	1	
31		CAB. doors & HANDLS	1	
32		BACK OF CAB.	1	
33		LEFT side " "	1	
34		RIGHT " " "	1	
35		BOTTOM OF "	1	
36		CAB. doors & HANDLS	1	
37		BACK OF CAB.	1	
38		LEFT side OF CAB.	1	
39		RIGHT " " "	1	
40		BOTTOM OF "	1	
41		FLOOR	1	
42		UPPER WALL	1	
43		LOWER "	1	
44		CAB doors & HANDLS	1	
45		TOP SHELF	1	
46	✓	2ND "	1	✓

Radiological Survey Continuation Sheet

Page 3 of 23

Date 11-28-80

No.	Time	Location	Inst. Used	Total Activity (dpm/100 cm ²)
47	1500	3rd SHELF	1	See attached LSC Printout
48	↑	BOTTOM "	1	
49		CAB. DOORS & HANDLS	1	
50		TOP SHELF	1	
51		2nd "	1	
52		3rd "	1	
53		BOTTOM "	1	
54		CAB. DOORS & HANDLS	1	
55		TOP SHELF	1	
56		2nd "	1	
57		3rd "	1	
58		BOTTOM "	1	
59		DRAWER & HANDLS	1	
60		TOP DRAWER	1	
61		MIDDLE "	1	
62		BOTTOM "	1	
63		DRAWER & HANDL	1	
64		DRAWER	1	
65		WALL BELOW CABS.	1	
66		LEDGE	1	
67		FLOOR	1	
68		SHELF	1	
69		TOP SHELF	1	
70		MIDDLE "	1	
71		BOTTOM "	1	
72		DESK	1	
73		TOP RACK	1	
74	↓	2nd "	1	✓

Radiological Survey Continuation Sheet

Page 4 of 23

Date 11-28-00

No.	Time	Location	Inst. Used	Total Activity (dpm/100 cm ²)
75	1500	SHELF	1	See attached LSC Printout
76		COUNTER	1	
77		CUP	1	
78		TOP RACK	1	
79		2ND "	1	
80		SHELF	1	
81		COUNTER	1	
82		CUP	1	
83		DRAWERS & HANDLS	1	
84		TOP DRAWER	1	
85		2ND "	1	
86		3RD "	1	
87		BOTTOM "	1	
88		DRAWERS & HANDLS	1	
89		TOP DRAWER	1	
90		2ND "	1	
91		3RD "	1	
92		BOTTOM "	1	
93		DRAWER & HANDL	1	
94		DRAWER	1	
95		FLOOR UNDER COUNTER	1	
96		DRAWERS & HANDLS	1	
97		TOP DRAWER	1	
98		2ND "	1	
99		3RD "	1	
100		BOTTOM "	1	
101		COUNTER	1	
102	✓	"	1	✓

Radiological Survey Continuation Sheet

Page 5 of 23

Date 11-29-00

No.	Time	Location	Inst. Used	Total Activity (dpm/100 cm ²)
103	11-29-00 0715	DRAWERS & HANDLS	1	See attached LSC Printout
104		TOP DRAWER	1	
105		2ND "	1	
106		3RD "	1	
107		BOTTOM "	1	
108		COUNTER	1	
109		"	1	
110		SIDE OF COUNTER	1	
111		" " "	1	
112		FLOOR	1	
113		TOP SHELF	1	
114		2ND "	1	
115		3RD "	1	
116		BOTTOM "	1	
117		DRAWER & HANDL	1	
118		DRAWER	1	
119		CAB. DOORS & HANDLS	1	
120		TOP SHELF	1	
121		BOTTOM "	1	
122		DRAWER & HANDL	1	
123		DRAWER	1	
124		FLOOR UNDER COUNTER	1	
125		DRAWERS & HANDLS	1	
126		TOP DRAWER	1	
127		2ND "	1	
128		3RD "	1	
129		BOTTOM "	1	
130	✓	DRAWER & HANDL	1	✓

Radiological Survey Continuation Sheet

Page 6 of 23

Date 11-29-00

No.	Time	Location	Inst. Used	Total Activity (dpm/100 cm ²)
131	0715	DRAWER	1	See attached LSC Printout
132	↑	FLOOR UNDER COUNTER	1	
133		DRAWERS & HANDLS	1	
134		TOP DRAWER	1	
135		2ND "	1	(See #361)
136		3RD "	1	
137		BOTTOM "	1	
138		DRAWER & HANDL	1	
139		DRAWER	1	
140		DRAWERS & HANDLS	1	
141		TOP DRAWER	1	
142		MIDDLE "	1	
143		BOTTOM "	1	
144		TOP SHELF	1	
145		MIDDLE "	1	
146		BOTTOM "	1	
147		DESK	1	
148		SHELF	1	
149		COUNTER	1	
150		"	1	
151		"	1	
152		CAB DOORS & HANDLS	1	
153		TOP SHELF	1	
154		2ND "	1	
155		3RD "	1	
156		BOTTOM "	1	
157		CAB. DOORS & HANDL	1	
158	✓	TOP SHELF	1	✓

Radiological Survey Continuation Sheet

Page 2 of 23

Date 11-29-00

No.	Time	Location	Inst. Used	Total Activity (dpm/100 cm ²)
159	0205	2ND SHELF	1	See attached LSC Printout
160	↑	3RD "	1	
161		BOTTOM "	1	
162		CAB DOORS & HANDLS	1	
163		TOP SHELF	1	
164		2ND "	1	
165		3RD "	1	
166		BOTTOM "	1	
167		DRAWERS & HANDLS	1	
168		TOP DRAWER	1	
169		MIDDLE "	1	
170		BOTTOM "	1	
171		DRAWER & HANDL	1	
172		DRAWER	1	
173		SHELF	1	
174		TOP SHELF	1	
175		MIDDLE "	1	
176		BOTTOM "	1	
177		DESK	1	
178		WALL BELOW CABS.	1	
179		TOP SHELF	1	
180		BOTTOM "	1	
181		FLOOR	1	
182		TOP RACK	1	
183		2ND "	1	
184		SHELF	1	
185		COUNTER	1	
186	↓	CUP	1	✓

Radiological Survey Continuation Sheet

Page 8 of 23

Date 11-29-00

No.	Time	Location	Inst. Used	Total Activity (dpm/100 cm ²)
187	0715	TOP RACK	1	See attached LSC Printout
188		2ND "	1	
189		SHELF	1	
190		COUNTER	1	
191		CUP	1	
192		DRAWERS & HANDLS	1	
193		TOP DRAWER	1	
194		2ND "	1	
195		3RD "	1	
196		BOTTOM "	1	
197		DRAWER & HANDL	1	
198		DRAWER	1	
199		FLOOR ^{ED} DRAWER UNDER COUNTER	1	
200		DRAWERS & HANDLS	1	
201		TOP DRAWER	1	
202		2ND "	1	
203		3RD "	1	
204		BOTTOM "	1	
205		FLOOR UNDER COUNTER	1	
206		DRAWERS & HANDLS	1	
207		TOP DRAWER	1	
208		2ND "	1	
209		3RD "	1	
210		BOTTOM "	1	
211		COUNTER	1	
212		"	1	
213		"	1	
214		FLOOR	1	

Radiological Survey Continuation Sheet

Page 9 of 23
 Date 11-29-00

No.	Time	Location	Inst. Used	Total Activity (dpm/100 cm ²)
215	0715	FLOOR	1	See attached LSC Printout
216	↑	"	1	
217		"	1	
218		"	1	
219		"	1	
220		"	1	
221		"	1	
222		COUNTER	1	
223		SIDE OF COUNTER	1	
224		" " "	1	
225		FLOOR	1	
226		DRAWER & HNDL	1	
227		DRAWER	1	
228		CAB DOORS & HNDLS	1	
229		TOP SHELF	1	
230		BOTTOM "	1	
231		FLOOR UNDER COUNTER	1	
232		DRAWERS & HNDLS	1	
233		TOP DRAWER	1	
234		2ND "	1	
235		3RD "	1	
236		BOTTOM "	1	
237		DRAWER & HNDL	1	
238		DRAWER	1	
239		FLOOR UNDER COUNTER	1	
240		DRAWERS & HNDLS	1	
241		TOP DRAWER	1	
242	↓	2ND "	1	✓

Radiological Survey Continuation Sheet

Page 10 of 23
00

Date 11-29-80
ES

No.	Time	Location	Inst. Used	Total Activity (dpm/100 cm ²)
243	0715	3RD DRAWER	1	See attached LSC Printout
244		BOTTOM "	1	
245		COUNTER	1	
246		"	1	
247		"	1	
248		TOP SHELF	1	
249		MIDDLE "	1	
250		BOTTOM "	1	
251		DESK	1	
252		WALL BELOW CABS	1	
253		SHELF	1	
254		UPPER WALL	1	
255		LOWER "	1	
256		DRAWERS & HANDLS	1	
257		TOP DRAWER	1	
258		MIDDLE "	1	
259		BOTTOM "	1	
260		DRAWER & HANDL	1	
261		DRAWER	1	
262		FLOOR	1	
263		UPPER WALL	1	
264		LOWER "	1	
265		UPPER "	1	
266		LOWER "	1	
267		FLOOR	1	
268		WALL BELOW WINDOW	1	
269		" " "	1	
270		UPPER WALL	1	

Radiological Survey Continuation Sheet

Page 11 of 23

Date 11-29-00

No.	Time	Location	Inst. Used	Total Activity (dpm/100 cm ²)
271	0215	LOWER WALL	1	See attached LSC Printout
272	↑	FLOOR	1	
273		"	1	
274		"	1	
275		COUNTER	1	
276		"	1	
277		TOP SHELF	1	
278		2ND "	1	
279		BOTTOM "	1	
280		FLOOR UNDER COUNTER	1	
281		DRAWERS & HANDLS	1	
282		TOP DRAWER	1	
283		2ND "	1	
284		3RD "	1	
285		BOTTOM "	1	
286		DRAWER & HANDL	1	
287		DRAWER	1	
288		DRAWERS & HANDLS	1	
289		TOP DRAWER	1	
290		2ND "	1	
291		3RD "	1	
292		BOTTOM "	1	
293		FLOOR	1	
294		"	1	
295		"	1	
296		"	1	
297		UPPER WALL	1	
298	↓	LOWER "	1	✓

Radiological Survey Continuation Sheet

Page 12 of 23

Date 11-29-06

No.	Time	Location	Inst. Used	Total Activity (dpm/100 cm ²)
299	0715	FLOOR	1	See attached LSC Printout
300	↑	WALL BELOW WINDOW	1	
301		TABLE TOP	1	
302		UPPER WALL	1	
303		LOWER "	1	
304		FLOOR	1	
305		FLOOR	1	
306		UPPER WALL	1	
307		LOWER "	1	
308		FLOOR	1	
309		UPPER WALL	1	
310		LOWER "	1	
311		UPPER "	1	
312		LOWER "	1	
313		FLOOR	1	
314		"	1	
315		SIDE OF SINK	1	
316		FLOOR	1	
317		"	1	
318		"	1	
319		WALL BEHIND SINK	1	
320		BEHIND SINK	1	
321		SINK LEDGE	1	
322		INSIDE SINK	1	
323		CAB DOORS & HANDLS	1	
324		TOP SHELF	1	
325		2ND "	1	
326	✓	3RD "	1	✓

Radiological Survey Continuation Sheet

Page 13 of 23

Date 11-29-00

No.	Time	Location	Inst. Used	Total Activity (dpm/100 cm ²)
327	0715	BOTTOM SHELF	1	See attached LSC Printout
328		CAB. DOORS & HANDLS	1	
329		TOP SHELF	1	
330		MIDDLE V	1	
331		BOTTOM "	1	
332		COUNTER	1	
333		CUP	1	
334		WALL BELOW CABS.	1	
335		COUNTER	1	
336		SAFETY CAN	1	
337		PLASTIC CONTAINER	1	
338		COUNTER	1	
339		UPPER WALL	1	
340		" "	1	
341		CAB. DOORS & HANDLS	1	
342		BACK OF CAB	1	
343		LEFT SIDE OF CAB	1	
344		RIGHT " " "	1	
345		BOTTOM OF CAB	1	
346		DRAWERS & HANDLS	1	
347		TOP DRAWER	1	
348		2ND "	1	
349		3RD "	1	
350		BOTTOM "	1	
351		DRAWER & HANDL	1	
352		DRAWER	1	
353		FLOOR UNDER COUNTER	1	
354	✓	DRAWER ² & HANDLS	1	✓

Radiological Survey Continuation Sheet

Page 14 of 23

Date 11-29-00

No.	Time	Location	Inst. Used	Total Activity (dpm/100 cm ²)
355	0715	TOP DRAWER	1	See attached LSC Printout
356	↑	2ND " "	1	
357		3RD " "	1	
358		BOTTOM " "	1	
359		FLOOR	1	
360	↓	FLOOR	1	
361	1410	POST OP.COM #134	1	
			1	↓
			1	
			1	
			1	
			1	
			1	
			1	
			1	
			1	
			1	
			1	
			1	
			1	
			1	
			1	
			1	
			1	

12/1/00

Bld. 118C Room C318

Date: 11-28-00

O = wipe location

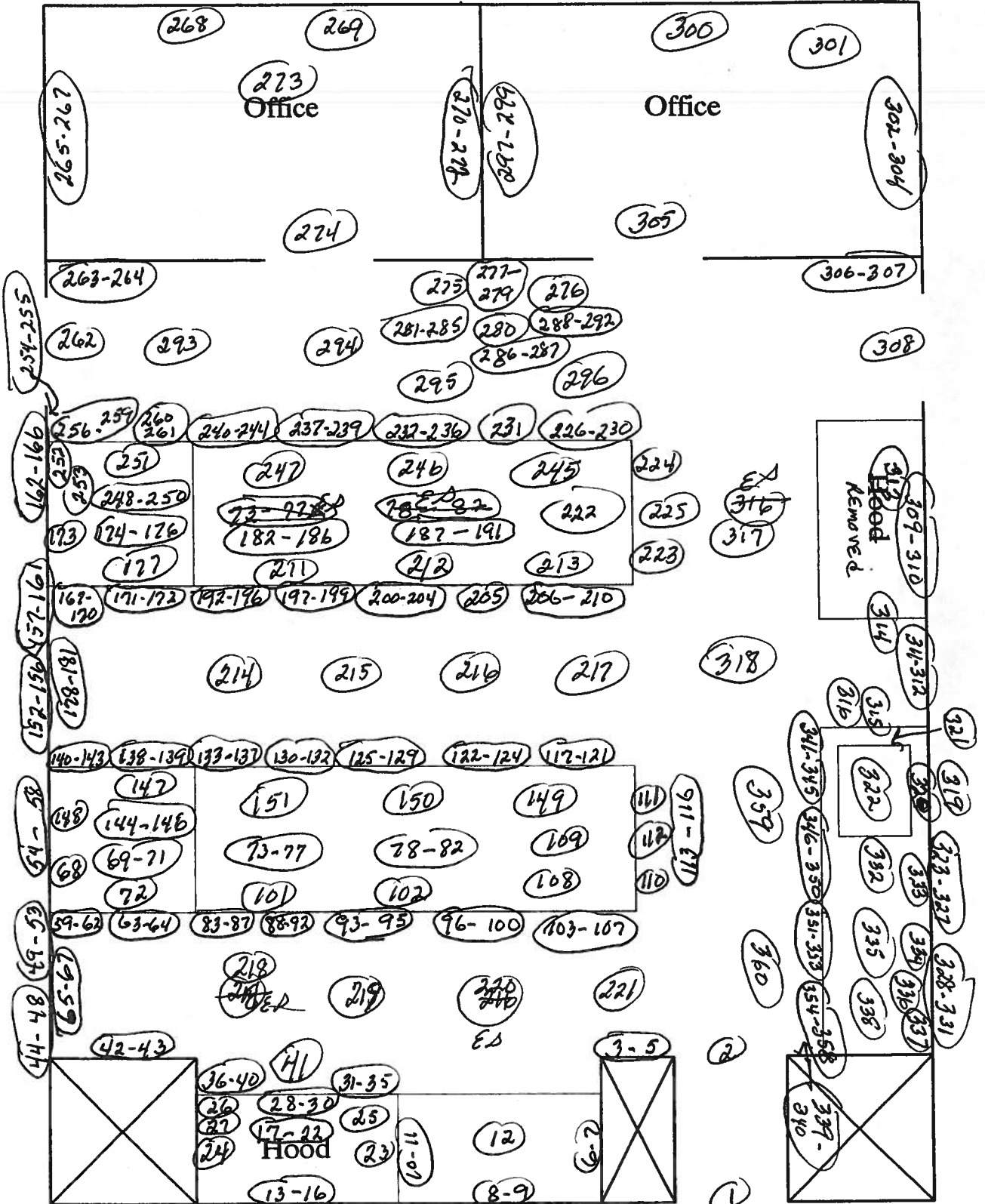

Surveyed 100% of all lower surfaces using instrument #2. All areas were found to be at a level of normal background.

ID: EQUIPMENT SURVY

29 NOV 2000 07:05

USER: 1

COMMENT:

RESET TIME : 1.00
 DATA CALC : DL DPM H# : YES SAMPLE REPEATS: 1 PRINTER : EDIT
 COUNT BLANK : YES IC# : NO REPLICATES : 1 RS232 : EDIT
 TWO PHASE : NO AQC : YES CYCLE REPEATS : 1
 SCINTILLATOR: LIQUID LUMEX: YES LOW SAMPLE REJ: 0
 LOW LEVEL : NO HALF LIFE CORRECTION DATE: none

ISOTOPE 1: 3H %ERROR: 2.00 FACTOR: 1.000000 BKG. SUB: 0
 ISOTOPE 2: 14C %ERROR: 2.00 FACTOR: 1.000000 BKG. SUB: 0
 WIDE OPEN WINDOW %ERROR: 0.00 FACTOR: 1.000000 BKG. SUB: 0

BACKGROUND QUENCH CURVE: Off COLOR QUENCH CORRECTION: Off

Quench Limits Low: 2.756 High: 314.54

SAM NO	H#	3H CPM	14C CPM	WIDE CPM	3H DPM	14C DPM	LUMEX %
B1	88.7	14.00	12.00	35.00	22.46	16.07	4.16
1	77.5	16.00	12.00	42.00	2.77	-0.11	3.29
2	90.2	20.00	12.00	41.00	12.59	-0.06	5.18
3	83.1	16.00	7.00	31.00	5.96	-6.82	2.73
4	88.5	21.00	11.00	42.00	14.87	-1.44	2.38
5	84.8	28.00	10.00	50.00	28.82	-2.90	3.37
6	80.2	33.00	11.00	51.00	37.08	-1.64	3.22
7	83.7	21.00	14.00	45.00	12.49	2.58	1.72
8	82.7	22.00	12.00	44.00	15.34	-0.14	2.06
9	81.0	17.00	12.00	37.00	5.15	-0.10	2.41
10	86.1	18.00	13.00	43.00	7.32	1.28	3.78
11	79.7	15.00	7.00	29.00	3.55	-6.82	8.01
12	89.3	24.00	11.00	48.00	21.18	-1.47	4.72
13	122.9	16.00	15.00	47.00	7.58	4.40	8.72
14	91.7	16.00	8.00	35.00	6.64	-5.42	18.43
15	96.8	22.00	15.00	49.00	16.40	4.04	4.86
16	94.8	21.00	6.00	42.00	18.78	-8.19	3.69
17	96.0	20.00	6.00	34.00	16.90	-8.17	5.87
18	95.4	24.00	9.00	40.00	23.64	-4.15	5.18
19	98.4	23.00	12.00	47.00	20.53	-0.04	2.67
20	102.4	15.00	8.00	35.00	6.09	-5.36	6.51
21	100.5	24.00	7.00	42.00	26.02	-6.85	3.51
22	120.9	16.00	13.00	34.00	8.52	1.62	11.35
23	88.7	23.00	10.00	41.00	19.54	-2.82	3.17
24	90.8	9.00	8.00	24.00	-8.03	-5.34	4.90
25	90.2	21.00	7.00	33.00	17.30	-6.85	4.82
26	83.2	23.00	6.00	39.00	20.46	-8.25	2.31
27	100.5	20.00	12.00	40.00	14.46	0.02	4.17
28	88.6	10.00	16.00	35.00	-10.32	5.46	4.08
29	84.5	18.00	10.00	38.00	8.63	-2.78	4.32
30	84.3	29.00	13.00	49.00	29.19	1.14	2.41
31	86.5	17.00	9.00	34.00	7.42	-4.11	3.14
32	86.3	18.00	12.00	37.00	7.86	-0.07	1.63
33	83.9	21.00	6.00	37.00	16.61	-8.22	4.51
34	85.9	23.00	16.00	46.00	15.88	5.27	7.45
35	87.0	28.00	13.00	47.00	27.81	1.17	4.20
36	86.2	28.00	10.00	52.00	29.16	-2.89	1.62
37	82.8	19.00	5.00	31.00	12.92	-9.55	8.42
38	86.9	17.00	13.00	40.00	5.40	1.30	2.43

SAM NO	H#	3H CPM	14C CPM	WIDE CPM	3H DPM	14C DPM	LUMEX %
39	84.9	16.00	10.00	35.00	4.66	-2.76	3.17
40	99.4	18.00	8.00	39.00	12.16	-5.41	7.96
41	94.9	17.00	11.00	39.00	7.60	-1.35	6.95
42	84.5	21.00	10.00	39.00	14.67	-2.82	5.24
43	85.7	18.00	11.00	37.00	8.29	-1.42	3.89
44	83.8	25.00	12.00	44.00	21.56	-0.17	3.70
45	83.9	25.00	7.00	40.00	24.11	-6.92	2.33
46	84.8	22.00	4.00	38.00	19.80	-10.93	2.43
47	86.0	20.00	2.00	32.00	17.03	-13.61	2.00
48	87.6	11.00	11.00	28.00	-5.72	-1.32	94.74
49	82.7	17.00	14.00	38.00	4.35	2.61	2.56
50	90.6	7.00	11.00	33.00	-13.78	-1.25	3.69
51	87.1	27.00	9.00	42.00	27.88	-4.23	3.45
52	90.1	15.00	17.00	40.00	-0.43	6.77	2.46
53	86.0	23.00	7.00	43.00	20.54	-6.89	2.68
54	83.8	14.00	10.00	35.00	0.51	-2.74	3.17
55	86.2	12.00	7.00	26.00	-1.74	-6.75	5.75
56	91.6	19.00	10.00	36.00	11.82	-2.75	2.78
57	92.5	25.00	9.00	43.00	25.05	-4.18	5.84
58	91.1	18.00	12.00	34.00	8.58	-0.03	3.78
59	85.7	22.00	8.00	34.00	17.94	-5.53	6.88
60	87.7	19.00	11.00	41.00	10.64	-1.42	2.09
61	87.7	18.00	9.00	32.00	9.63	-4.12	4.77
62	96.4	17.00	15.00	41.00	5.63	4.10	4.37
63	83.9	27.00	7.00	41.00	28.12	-6.94	2.02
64	83.7	14.00	9.00	30.00	1.01	-4.09	5.39
65	85.4	20.00	11.00	42.00	12.29	-1.45	2.54
66	85.9	21.00	8.00	35.00	15.96	-5.51	3.30
67	100.1	19.00	17.00	41.00	9.40	6.84	4.45
68	85.8	21.00	11.00	37.00	14.38	-1.46	4.85
69	95.4	17.00	10.00	35.00	8.22	-2.70	14.98
70	89.8	12.00	10.00	26.00	-2.95	-2.67	4.54
71	83.9	19.00	10.00	38.00	10.55	-2.80	2.97
72	87.7	16.00	11.00	35.00	4.51	-1.38	3.15
73	87.7	15.00	10.00	34.00	2.99	-2.73	5.96
74	94.4	20.00	16.00	41.00	11.15	5.40	6.49
75	89.1	20.00	14.00	43.00	11.34	2.64	6.46
76	86.2	26.00	10.00	47.00	25.11	-2.87	3.31
77	102.5	27.00	7.00	38.00	33.16	-6.88	7.48
78	86.6	16.00	7.00	36.00	6.43	-6.80	4.22
79	92.7	19.00	10.00	39.00	12.00	-2.74	4.91
80	88.2	22.00	15.00	45.00	14.77	3.96	4.38
81	85.5	20.00	6.00	38.00	14.88	-8.20	3.53
82	117.4	20.00	17.00	46.00	14.99	7.03	14.19
83	82.6	14.00	12.00	38.00	-0.62	-0.05	3.93
84	88.7	26.00	11.00	51.00	25.18	-1.50	2.17
85	85.3	13.00	7.00	32.00	0.20	-6.77	5.08
86	88.2	20.00	15.00	45.00	10.68	3.98	2.04
87	83.0	19.00	12.00	38.00	9.40	-0.11	5.43
88	87.8	23.00	12.00	48.00	18.31	-0.12	1.79
89	86.8	22.00	8.00	38.00	18.16	-5.52	2.64
90	90.4	14.00	8.00	34.00	2.31	-5.41	4.21
91	85.4	21.00	12.00	42.00	13.81	-0.11	3.86
92	85.2	24.00	9.00	42.00	21.37	-4.20	6.62
93	88.5	18.00	2.00	33.00	13.43	-13.58	4.24
94	94.6	20.00	13.00	43.00	12.82	1.33	2.80
95	107.4	15.00	9.00	36.00	6.28	-3.97	62.68
96	86.5	15.00	8.00	32.00	3.87	-5.44	3.36

SAM NO	H#	3H CPM	14C CPM	WIDE CPM	3H DPM	14C DPM	LUMEX %
97	85.9	20.00	9.00	38.00	13.41	-4.15	2.51
98	90.7	17.00	16.00	39.00	4.31	5.40	8.79
99	85.8	21.00	10.00	38.00	14.89	-2.81	4.42
100	89.9	26.00	13.00	48.00	24.39	1.22	1.93
101	82.9	17.00	6.00	32.00	8.44	-8.18	3.12
102	85.6	15.00	13.00	35.00	1.19	1.31	2.40
103	81.9	22.00	9.00	36.00	16.71	-4.19	5.21
104	79.2	23.00	7.00	43.00	19.18	-6.91	5.97
105	80.8	25.00	10.00	46.00	21.94	-2.89	6.20
106	81.0	21.00	6.00	35.00	16.08	-8.23	5.78
107	81.1	14.00	12.00	35.00	-0.77	-0.06	4.64
108	79.6	19.00	16.00	42.00	6.92	5.26	4.34
109	82.0	23.00	6.00	36.00	20.22	-8.25	10.95
110	82.3	13.00	18.00	37.00	-5.68	8.05	10.19
111	82.6	14.00	10.00	32.00	0.39	-2.75	5.98
112	101.8	26.00	11.00	47.00	28.49	-1.42	8.87
113	98.9	18.00	5.00	29.00	13.74	-9.50	20.61
114	86.0	26.00	7.00	37.00	26.61	-6.92	9.27
115	80.5	12.00	5.00	25.00	-1.28	-9.47	12.54
116	84.7	23.00	13.00	44.00	17.19	1.21	4.68
117	81.0	17.00	9.00	37.00	6.66	-4.14	6.67
118	85.1	20.00	10.00	42.00	12.76	-2.80	15.28
119	78.5	26.00	16.00	53.00	20.47	5.16	6.64
120	86.7	22.00	12.00	46.00	16.06	-0.11	5.94
121	90.2	11.00	8.00	28.00	-3.93	-5.37	8.27
122	82.2	21.00	12.00	36.00	13.27	-0.13	5.08
123	85.1	13.00	16.00	38.00	-4.44	5.39	16.42
124	121.4	15.00	16.00	41.00	4.21	5.77	10.57
125	81.0	17.00	10.00	40.00	6.16	-2.79	2.75
126	83.2	30.00	15.00	54.00	29.90	3.81	5.62
127	83.6	23.00	10.00	36.00	18.52	-2.85	6.88
128	86.0	19.00	6.00	37.00	12.95	-8.19	6.63
129	83.6	18.00	9.00	35.00	9.01	-4.14	8.09
130	83.7	25.00	7.00	44.00	24.09	-6.92	4.40
131	88.0	18.00	8.00	39.00	10.20	-5.47	7.80
132	104.8	12.00	15.00	37.00	-4.30	4.26	25.46
133	82.5	20.00	3.00	32.00	15.87	-12.26	11.91
134	96.8	53.00	8.00	73.00	86.66	-5.87	4.18
135	102.2	16.00	14.00	35.00	4.84	2.81	8.10
136	101.5	21.00	9.00	37.00	18.55	-4.08	40.78
137	97.0	13.00	8.00	31.00	1.00	-5.36	5.67
138	86.6	17.00	13.00	41.00	5.36	1.30	5.18
139	88.7	20.00	11.00	40.00	12.85	-1.43	18.16
140	85.0	23.00	14.00	39.00	16.75	2.56	2.83
141	85.6	16.00	18.00	45.00	0.63	8.06	26.15
142	88.2	13.00	9.00	31.00	-0.53	-4.05	9.31
143	94.2	24.00	12.00	48.00	21.73	-0.08	9.69
144	82.0	19.00	4.00	37.00	13.28	-10.90	6.78
145	87.2	19.00	11.00	41.00	10.56	-1.42	7.43
146	86.5	16.00	11.00	32.00	4.36	-1.39	5.64
147	81.6	15.00	9.00	28.00	2.76	-4.11	8.95
148	86.4	16.00	8.00	31.00	5.89	-5.45	5.70
149	81.9	18.00	8.00	39.00	9.27	-5.50	9.77
150	90.8	20.00	19.00	46.00	8.97	9.43	5.50
151	86.3	11.00	10.00	29.00	-5.31	-2.69	8.43
152	86.2	22.00	10.00	42.00	17.00	-2.82	2.89
153	89.3	21.00	9.00	35.00	16.07	-4.14	7.31
154	94.2	24.00	8.00	41.00	23.92	-5.51	5.99

SAM NO	H#	3H CPM	14C CPM	WIDE CPM	3H DPM	14C DPM	LUMEX %
155	96.0	20.00	11.00	35.00	14.16	-1.38	7.99
156	91.3	15.00	12.00	40.00	2.36	0.01	7.52
157	84.1	9.00	15.00	33.00	-12.05	4.07	12.14
158	88.9	20.00	11.00	47.00	12.89	-1.43	6.85
159	88.6	18.00	12.00	34.00	8.20	-0.05	6.26
160	85.8	27.00	7.00	41.00	28.59	-6.94	5.21
161	91.8	18.00	9.00	32.00	10.29	-4.09	5.67
162	87.2	20.00	5.00	34.00	15.71	-9.55	4.91
163	88.2	24.00	12.00	42.00	20.44	-0.13	3.92
164	87.5	24.00	9.00	39.00	21.84	-4.19	5.69
165	83.6	24.00	9.00	43.00	21.03	-4.21	11.16
166	86.9	22.00	4.00	34.00	20.24	-10.93	6.40
167	87.7	20.00	8.00	35.00	14.24	-5.49	2.38
168	85.3	21.00	10.00	39.00	14.82	-2.81	7.11
169	95.3	12.00	12.00	33.00	-3.51	0.08	8.46
170	95.1	14.00	16.00	38.00	-1.47	5.48	10.16
171	73.0	24.00	4.00	39.00	21.37	-10.98	1.03
172	84.7	22.00	12.00	45.00	15.70	-0.13	3.79
173	77.1	22.00	3.00	40.00	18.80	-12.29	7.13
174	90.4	13.00	11.00	36.00	-1.35	-1.33	6.34
175	92.4	22.00	13.00	40.00	16.62	1.29	6.20
176	92.1	15.00	8.00	34.00	4.61	-5.41	7.44
177	91.0	30.00	9.00	53.00	35.11	-4.25	74.31
178	84.2	28.00	17.00	51.00	25.10	6.55	3.32
179	87.3	17.00	10.00	39.00	7.01	-2.75	7.57
180	86.1	22.00	11.00	39.00	16.46	-1.47	6.20
181	94.6	21.00	11.00	41.00	16.03	-1.40	11.95
182	90.6	22.00	12.00	47.00	16.79	-0.08	4.91
183	85.9	23.00	16.00	47.00	15.88	5.28	5.82
184	91.5	24.00	9.00	43.00	22.74	-4.17	5.40
185	88.8	18.00	8.00	39.00	10.33	-5.46	6.47
186	96.4	14.00	9.00	35.00	2.51	-4.02	10.55
187	86.6	25.00	13.00	54.00	21.63	1.20	5.05
188	88.9	13.00	8.00	33.00	0.06	-5.40	9.18
189	86.9	21.00	7.00	37.00	16.66	-6.86	6.18
190	85.2	16.00	17.00	44.00	1.11	6.70	6.83
191	114.2	27.00	10.00	50.00	35.14	-2.72	8.44
192	84.5	20.00	4.00	30.00	15.73	-10.91	5.28
193	84.2	21.00	10.00	41.00	14.62	-2.82	4.04
194	85.4	26.00	17.00	52.00	21.32	6.58	3.41
195	87.5	24.00	10.00	47.00	21.33	-2.84	8.35
196	91.2	19.00	15.00	41.00	9.08	4.02	7.24
197	89.4	25.00	8.00	46.00	24.86	-5.55	4.45
198	87.6	19.00	6.00	37.00	13.22	-8.19	3.98
199	97.7	25.00	9.00	43.00	26.36	-4.15	16.32
200	90.6	15.00	9.00	37.00	3.87	-4.06	7.36
201	84.2	15.00	10.00	27.00	2.57	-2.75	5.16
202	88.4	19.00	16.00	39.00	8.13	5.35	8.07
203	87.5	20.00	10.00	43.00	13.16	-2.79	2.92
204	92.7	18.00	11.00	37.00	9.37	-1.37	9.82
205	101.2	18.00	8.00	39.00	12.49	-5.40	12.67
206	85.7	26.00	4.00	35.00	28.11	-10.98	13.98
207	87.9	18.00	9.00	37.00	9.66	-4.11	11.66
208	94.0	10.00	9.00	31.00	-6.23	-3.98	7.84
209	84.4	19.00	11.00	39.00	10.12	-1.44	2.87
210	95.6	25.00	7.00	45.00	26.91	-6.88	5.40
211	86.2	22.00	6.00	37.00	19.07	-8.23	4.31
212	83.0	27.00	7.00	41.00	27.90	-6.95	8.00

SAM NO	H#	3H CPM	14C CPM	WIDE CPM	3H DPM	14C DPM	LUMEX %
13	85.8	24.00	13.00	48.00	19.44	1.21	4.89
14	86.0	22.00	7.00	40.00	18.51	-6.88	5.24
215	88.4	23.00	10.00	39.00	19.47	-2.82	22.61
216	90.3	17.00	13.00	38.00	5.86	1.33	4.03
217	90.0	13.00	12.00	32.00	-1.92	0.02	7.18
218	91.0	15.00	6.00	28.00	5.52	-8.13	8.57
219	91.5	22.00	10.00	45.00	18.04	-2.79	6.98
220	88.0	18.00	6.00	41.00	11.24	-8.17	7.71
221	91.7	19.00	7.00	34.00	13.42	-6.82	4.52
222	86.7	22.00	10.00	36.00	17.10	-2.82	6.75
223	83.8	23.00	7.00	36.00	20.08	-6.90	3.26
224	91.7	20.00	9.00	38.00	14.44	-4.12	4.83
225	91.3	11.00	7.00	26.00	-3.29	-6.72	39.49
226	87.4	15.00	7.00	24.00	4.51	-6.79	7.39
227	83.5	22.00	3.00	42.00	20.06	-12.28	4.39
228	87.0	8.00	11.00	27.00	-11.88	-1.29	12.21
229	84.9	14.00	11.00	38.00	0.12	-1.38	5.51
230	84.4	15.00	11.00	32.00	2.07	-1.40	7.92
231	125.0	19.00	11.00	37.00	18.19	-1.16	36.77
232	86.6	22.00	5.00	40.00	19.66	-9.58	3.78
233	85.9	15.00	16.00	39.00	-0.32	5.37	3.47
234	84.0	16.00	12.00	37.00	3.53	-0.06	7.54
235	86.4	17.00	17.00	50.00	3.27	6.70	3.19
236	85.3	15.00	15.00	37.00	0.12	4.01	3.93
237	85.4	31.00	8.00	51.00	36.05	-5.64	3.94
238	89.1	18.00	14.00	39.00	7.23	2.66	3.59
239	124.6	21.00	10.00	38.00	23.79	-2.57	20.49
240	88.2	16.00	8.00	32.00	6.14	-5.44	5.12
241	85.1	21.00	9.00	38.00	15.29	-4.17	3.50
242	91.0	14.00	9.00	33.00	1.85	-4.05	5.39
243	87.0	18.00	13.00	40.00	7.45	1.29	7.16
244	91.0	18.00	11.00	36.00	9.09	-1.39	4.12
245	86.3	18.00	6.00	32.00	10.97	-8.18	3.65
246	89.5	19.00	10.00	35.00	11.46	-2.76	4.19
247	87.0	20.00	8.00	36.00	14.13	-5.50	12.99
248	75.1	19.00	10.00	33.00	9.26	-2.85	1.59
249	79.5	16.00	9.00	35.00	4.50	-4.14	3.21
250	80.0	15.00	8.00	33.00	3.08	-5.47	6.42
251	84.4	21.00	11.00	40.00	14.14	-1.47	5.05
252	90.9	19.00	3.00	36.00	15.42	-12.24	5.58
253	85.1	25.00	14.00	51.00	20.79	2.54	6.34
254	84.8	17.00	13.00	38.00	5.13	1.28	3.73
255	84.9	19.00	5.00	38.00	13.28	-9.55	8.11
256	87.8	22.00	8.00	46.00	18.36	-5.52	3.73
257	103.1	18.00	7.00	39.00	13.41	-6.76	13.59
258	88.3	27.00	7.00	41.00	29.21	-6.93	3.29
259	92.7	12.00	13.00	36.00	-4.29	1.41	5.77
260	88.0	24.00	13.00	51.00	19.87	1.22	3.24
261	90.7	11.00	11.00	28.00	-5.48	-1.30	5.48
262	96.5	26.00	6.00	40.00	29.85	-8.25	6.67
263	81.7	13.00	13.00	37.00	-3.20	1.31	4.58
264	83.4	23.00	6.00	32.00	20.52	-8.25	7.03
265	82.2	18.00	13.00	35.00	6.79	1.25	4.48
266	83.9	24.00	18.00	49.00	16.50	7.94	4.13
267	90.5	18.00	5.00	32.00	12.20	-9.52	8.64
268	82.7	17.00	5.00	29.00	8.91	-9.53	6.46
269	82.8	14.00	12.00	28.00	-0.61	-0.05	5.55
270	81.0	23.00	10.00	41.00	18.03	-2.86	6.73

SAM NO	H#	3H CPM	14C CPM	WIDE CPM	3H DPM	14C DPM	LUMEX %
271	83.5	14.00	10.00	35.00	0.48	-2.74	2.36
272	101.8	27.00	6.00	46.00	33.52	-8.25	7.58
273	94.9	24.00	10.00	42.00	22.98	-2.79	4.56
274	91.2	18.00	9.00	32.00	10.19	-4.10	5.14
275	86.5	19.00	5.00	29.00	13.55	-9.54	6.96
276	86.3	16.00	13.00	35.00	3.29	1.31	5.52
277	85.4	24.00	8.00	45.00	21.91	-5.55	3.43
278	87.7	28.00	6.00	45.00	31.63	-8.30	8.51
279	90.6	18.00	11.00	40.00	9.03	-1.39	8.73
280	100.0	17.00	12.00	34.00	7.83	0.05	8.18
281	81.1	11.00	11.00	28.00	-6.21	-1.37	11.79
282	86.0	16.00	15.00	38.00	2.22	4.01	3.34
283	85.9	22.00	10.00	39.00	16.95	-2.82	3.32
284	88.8	17.00	14.00	37.00	5.12	2.67	4.69
285	104.0	15.00	12.00	36.00	4.03	0.11	3.59
286	83.3	23.00	14.00	50.00	16.43	2.55	4.85
287	90.3	16.00	14.00	40.00	3.26	2.70	9.25
288	88.1	26.00	14.00	50.00	23.48	2.55	6.43
289	86.1	21.00	11.00	46.00	14.43	-1.46	5.52
290	85.6	15.00	12.00	33.00	1.70	-0.04	7.88
291	87.1	26.00	15.00	50.00	22.74	3.90	80.34
292	91.4	19.00	8.00	35.00	12.83	-5.46	12.08
293	91.5	16.00	12.00	42.00	4.47	-0.00	5.33
294	88.7	8.00	11.00	29.00	-11.80	-1.28	8.45
295	88.4	15.00	7.00	32.00	4.64	-6.78	6.56
296	92.6	10.00	12.00	32.00	-7.95	0.08	8.03
297	85.5	16.00	6.00	34.00	6.80	-8.16	4.06
298	84.7	26.00	12.00	47.00	23.75	-0.18	6.45
299	101.2	13.00	8.00	29.00	1.52	-5.34	12.54
300	89.2	23.00	7.00	40.00	21.22	-6.88	5.20
301	92.4	15.00	7.00	32.00	5.17	-6.76	5.70
302	85.4	25.00	6.00	35.00	24.98	-8.27	4.70
303	84.9	23.00	14.00	51.00	16.73	2.56	5.22
304	91.4	16.00	9.00	38.00	6.06	-4.07	9.13
305	92.4	17.00	9.00	37.00	8.30	-4.08	4.62
306	87.1	26.00	6.00	46.00	27.40	-8.27	11.78
307	90.0	27.00	7.00	43.00	29.65	-6.92	5.33
308	113.6	20.00	10.00	39.00	18.47	-2.63	9.86
309	86.0	18.00	9.00	37.00	9.38	-4.12	1.50
310	87.9	19.00	12.00	35.00	10.14	-0.07	7.65
311	92.9	13.00	8.00	34.00	0.51	-5.38	6.49
312	92.6	18.00	7.00	32.00	11.49	-6.80	8.05
313	98.0	26.00	10.00	45.00	28.04	-2.80	13.26
314	98.5	18.00	13.00	38.00	9.20	1.39	10.71
315	87.6	15.00	10.00	35.00	2.97	-2.73	4.20
316	96.7	22.00	5.00	38.00	21.89	-9.55	5.74
317	94.8	16.00	14.00	41.00	3.83	2.74	5.84
318	89.5	19.00	9.00	34.00	11.99	-4.12	4.56
319	83.2	18.00	16.00	40.00	5.40	5.31	4.27
320	90.9	17.00	10.00	35.00	7.53	-2.73	6.33
321	88.0	22.00	9.00	45.00	17.87	-4.16	25.92
322	87.9	22.00	14.00	40.00	15.25	2.60	3.38
323	84.0	18.00	7.00	30.00	10.09	-6.84	6.16
324	90.7	15.00	17.00	42.00	-0.36	6.78	4.15
325	86.6	26.00	14.00	47.00	23.14	2.54	2.79
326	85.3	15.00	7.00	31.00	4.24	-6.79	9.44
327	88.5	13.00	10.00	33.00	-1.02	-2.70	4.26
328	89.3	22.00	14.00	49.00	15.50	2.61	3.34

SAM NO	H#	3H CPM	14C CPM	WIDE CPM	3H DPM	14C DPM	LUMEX %
329	95.9	20.00	8.00	37.00	15.80	-5.45	6.63
330	88.2	22.00	8.00	41.00	18.42	-5.51	15.67
331	91.2	26.00	6.00	43.00	28.43	-8.26	8.55
332	87.7	22.00	8.00	41.00	18.33	-5.52	6.85
333	102.6	14.00	15.00	38.00	-0.09	4.20	12.13
334	86.4	23.00	10.00	41.00	19.07	-2.83	5.57
335	89.1	28.00	11.00	47.00	29.39	-1.52	4.92
336	110.4	11.00	13.00	35.00	-4.87	1.59	14.14
337	87.7	23.00	5.00	35.00	21.95	-9.59	5.74
338	91.5	16.00	14.00	34.00	3.41	2.71	8.45
339	82.6	25.00	12.00	45.00	21.29	-0.18	10.39
340	87.7	24.00	9.00	41.00	21.90	-4.19	4.94
341	82.2	18.00	4.00	30.00	11.34	-10.89	4.06
342	84.0	13.00	8.00	26.00	-0.45	-5.43	8.37
343	86.4	21.00	12.00	38.00	13.98	-0.10	4.60
344	86.4	16.00	11.00	37.00	4.34	-1.39	4.19
345	83.5	22.00	7.00	36.00	18.02	-6.89	3.90
346	89.1	18.00	7.00	41.00	10.91	-6.81	6.77
347	84.1	19.00	6.00	37.00	12.63	-8.20	4.92
348	88.7	17.00	13.00	38.00	5.64	1.32	3.42
349	88.3	25.00	10.00	42.00	23.56	-2.84	4.91
350	95.8	14.00	12.00	33.00	0.80	0.06	6.53
351	84.8	17.00	9.00	34.00	7.18	-4.12	3.73
352	89.9	21.00	8.00	38.00	16.71	-5.49	9.32
353	116.7	20.00	8.00	41.00	20.46	-5.36	39.46
354	89.6	11.00	11.00	28.00	-5.56	-1.31	9.05
355	81.5	26.00	10.00	48.00	24.06	-2.90	4.82
356	85.6	16.00	9.00	34.00	5.27	-4.10	2.23
357	87.7	22.00	10.00	39.00	17.30	-2.81	3.11
358	82.4	22.00	9.00	36.00	16.81	-4.19	1.95
359	90.3	10.00	8.00	34.00	-5.99	-5.36	4.12
360	97.2	13.00	6.00	29.00	2.13	-8.08	6.15

ID: EQUIPMENT SURVY

1 DEC 2000 15:52

USER: 3 COMMENT: EQUIPMENT SURVEY
 PRESET TIME : 1.00
 DATA CALC : DL DPM H# : YES SAMPLE REPEATS: 1 PRINTER : EDIT
 COUNT BLANK : YES IC# : NO REPLICATES : 1 RS232 : EDIT
 TWO PHASE : NO AGC : YES CYCLE REPEATS : 1
 SCINTILLATOR: LIQUID LUMEX: YES LOW SAMPLE REJ: 0
 LOW LEVEL : NO HALF LIFE CORRECTION DATE: none

ISOTOPE 1: 3H %ERROR: 2.00 FACTOR: 1.0000 BKG. SUB: 0
 ISOTOPE 2: 14C %ERROR: 2.00 FACTOR: 1.0000 BKG. SUB: 0
 WIDE OPEN WINDOW %ERROR: 0.00 FACTOR: 1.0000 BKG. SUB: 0

BACKGROUND QUENCH CURVE: Off COLOR QUENCH CORRECTION: Off

Quench Limits Low: 13.688 High: 306.34

SAM NO	H#	3H CPM	14C CPM	WIDE CPM	3H DPM	14C DPM	LUMEX %	
B.1	73.7	30.00	4.00	42.00	60.57	4.86	4.32	
		Blank Average	DPM	for	3H :	60.57	CDEF. OF VAR:	0.000
		Blank Average	DPM	for	14C :	4.86	CDEF. OF VAR:	0.000
361	72.3	16.00	9.00	41.00	-31.91	6.90	7.68	