

Radiological Survey Sheet

Job Location Pfizer, Inc. Groton, Ct. 06340 118 C/ C317 Page 1 A

Survey Purpose CO Radiologic Survey of Equipment LAB DECOM Date 12-20-12

Performed by E. GAILOR (Print) E. Gailor (Sign)

Instrument (Model/S/N)	Packard Tri-Carb S/N 431521	Packard Tri-Carb S/N 431520	Ludlum 2241-2 163603	Wallac Model 1409 S/N 4061042
Det. (Model/SN)	Internal	Internal	Ludlum 43-68 PR 149613	Internal
Type Rad.	β	β	β	β
Cal. Due:	03/05/2013	03/05/2013	04/17/2013	09/15/2012
Check Instruments Used	✓		✓	

No.	Time	Locations	See attached LSC printout for Total Activity (cpm/100 cm ²)
1.	1200	BACKGROUND	
2.		door	
3.		FLOOR	
4.		UPPER WALL	
5.		LOWER "	
6.		CAB DOORS	
7.		TOP SHELF	
8.		2ND "	
9.		3RD "	
10.		CAB DOORS	
11.		TOP SHELF	
12.		2ND "	
13.		3RD "	
14.		TOP SHELF	
15.		2ND "	
16.		WALL	
17.		BENCH	
18.	✓	11	

Radiological Survey Continuation Sheet

Page 2 of 19

Date 12-20-12

No.	Time	Locations	See attached LSC printout for Total Activity (cpm/100 cm ²)
19	1200	BENCH	
20		CUP	
21		SINK AREA	
22		" DRAIN	
23		TOP dwr	
24		2nd "	
25		3rd "	
26		4TH "	
27		CAB door	
28		" INSIDE	
29		" doors	
30		" INSIDE	
31		" doors	
32		" TOP SHELF	
33		" 2nd "	
34		" 3rd "	
35		" 4TH "	
36		" doors	
37		" TOP SHELF	
38		" 2nd "	
39		" 3rd "	
40		TOP SHELF	
41		2nd "	
42		3rd "	
43		BENCH	
44		" & dwr	
45		"	

✓

Radiological Survey Continuation Sheet

Page 3 of 19

Date 12-20-12

No.	Time	Locations	See attached LSC printout for Total Activity (cpm/100 cm ²)
46	1200	BENCH	
47		WALL	
48		"	
49		TOP dWR	
50		2ND "	
51		3RD "	
52		4TH "	
53		dWR	
54		CAB door	
55		" TOP SHELF	
56		" BOTTOM "	
57		LEFT dWR	
58		RIGHT "	
59		CAB doors	
60		" TOP SHELF	
61		" BOTTOM "	
62		FLOOR	
63		"	
64		"	
65		"	
66		"	
67		"	
68		UPPER WALL	
69		LOWER "	
70		UPPER "	
71		LOWER "	
72	↓	UPPER "	

Radiological Survey Continuation Sheet

Page 4 of 19

Date 12-20-12

No.	Time	Locations	See attached LSC printout for Total Activity (cpm/100 cm ²)
73	1200	LOWER WALL	
74		CAB DOORS	
75		" TOP SHELF	
76		2ND "	
77		3RD "	
78		4TH "	
79		WINDOW	
80		DOOR	
81		WINDOW	
82		SHELVES	
83		"	
84		DESK & DOORS	
85		" " "	
86		" " "	
87		" " "	
88		SHELF	
89		"	
90		FLOOR	
91		UPPER WALL	
92		LOWER "	
93		BOOK CASE TOP SHELF	
94		" " 2ND "	
95		" " 3RD "	
96		" " 4TH "	
97		" " 5TH "	
98		SHELVES	
99	✓	"	

Radiological Survey Continuation Sheet

Page 5 of 19

Date 12-20-12

No.	Time	Locations	See attached LSC printout for Total Activity (cpm/100 cm ²)
100	1200	DESK & DWRS	
101		" " "	
102		SHELVES	
103		"	
104		DESK & DWRS	
105		FLOOR	
106		DOOR	
107		CAB TOP & DWRS	
108		" " "	
109		SHELVES	
110		"	
111		DESK & DWRS	
112		" " "	
113		LEDGE & LOWER WALL	
114		FLOOR	
115		DOOR	
116		SHELVES	
117		"	
118		CAB TOP & DOORS	
119		" TOP SHELF	
120		" BOTTOM "	
121		TOP SHELF	
122		2ND "	
123		3RD "	
124		4TH "	
125		WALL	
126		FLOOR	

Radiological Survey Continuation Sheet

Page 6 of 19

Date 12-20-12

No.	Time	Locations	See attached LSC printout for Total Activity (cpm/100 cm ²)
127	1200	CAB DOORS	
128		" TOP SHELF	
129		" 2ND "	
130		" 3RD "	
131		" 4TH "	
132		dWRS	
133		DESK & dWR	
134	✓	TOP SHELF	
135		BOTTOM "	
136		TOP "	
137		BOTTOM "	
138		BENCH & CVP	
139		"	
140		" & CVP	
141		"	
142		dWR	
143		"	
144		"	
145		"	
146		dWR	
147		CAB DOORS	
148		" INSIDE	
149		FLOOR	
150		"	
151		"	
152		"	
153	✓	BENCH	

Radiological Survey Continuation Sheet

Page 7 of 19

Date 12-20-12

No.	Time	Locations	See attached LSC printout for Total Activity (cpm/100 cm ²)
154	1200	SIDE OF CAB	
155		" " "	
156		FLOOR	
157		TOP DWR	
158		2ND "	
159		3RD "	
160		4TH "	
161		TOP "	
162		2ND "	
163		3RD "	
164		4TH "	
165		TOP "	
166		2ND "	
167		3RD "	
168		4TH "	
169		BENCH	
170		"	
171		"	
172		"	
173		SHELF	
174		DESK & DWR	
175		DWRS	
176		CAB DOORS	
177		" TOP SHELF	
178		" 2ND "	
179		" 3RD "	
180		" 4TH "	

Radiological Survey Continuation Sheet

Page 8 of 19

Date 12-20-12

No.	Time	Locations	See attached LSC printout for Total Activity (cpm/100 cm ²)
181	1200	CAB DOORS	
182		" TOP SHELF	
183		" 2ND "	
184		" 3RD "	
185		" 4TH "	
186		" DOORS	
187		" TOP SHELF	
188		" 2ND "	
189		" 3RD "	
190		UPPER WALL	
191		" "	
192		LOWER "	
193		LEDGE	
194		FLOOR	
195		DOOR	
196		DESK & DOOR	
197		TOP SHELF	
198		BOTTOM "	
199		TOP SHELF	
200		BOTTOM "	
201		BENCH	
202		" & CUP	
203		" BENCH	
204		" BENCH & CUP	
205		TOP DOOR	
206		2ND "	
207		3RD "	

Radiological Survey Continuation Sheet

Page 9 of 19

Date 12-20-12

No.	Time	Locations	See attached LSC printout for Total Activity (cpm/100 cm ²)
208	1200	4TH dwr	
209		DWR	
210		TOP dwd	
211		2nd "	
212		3rd "	
213		4TH "	
214		dwr	
215		FLOOR	
216		"	
217		"	
218		"	
219		"	
220		"	
221		"	
222		"	
223		"	
224		"	
225		SIDE OF BENCH	
226		" " "	
227		BENCH	
228		"	
229		"	
230		"	
231		"	
232		"	
233		TOP dwr	
234		2nd "	

Radiological Survey Continuation Sheet

Page 10 of 19

Date 12.20.12

No.	Time	Locations	See attached LSC printout for Total Activity (cpm/100 cm ²)
235	1200	3RD dwr	
236		4TH "	
237		TOP "	
238		2nd "	
239		3rd "	
240		4TH "	
241		GAB door dwr	
242		GAB doors	
243		" TOP SHELF	
244		" BOTTOM "	
245		GAB doors	
246		" TOP SHELF	
247		" 2nd "	
248		" 3rd "	
249		LEDGE & LOWER WALL	
250		UPPER WALL	
251		LOWER "	
252		HOOD LEFT SIDE	
253		" " BACK	
254		" RIGHT "	
255		" " SIDE	
256		" LEFT BOTTOM	
257		" RIGHT "	
258		" CUP	
259		" SASH	
260		" LIP	
261		" OUTSIDE LEFT	

Radiological Survey Continuation Sheet

Page 11 of 19

Date 12-20-12

No.	Time	Locations	See attached LSC printout for Total Activity (cpm/100 cm ²)
262	1200	Hood	OUTSIDE RIGHT
263		"	LEFT VENT
264		"	RIGHT "
265		CAB	DOORS
266		"	INSIDE
267		"	DOORS
268		"	INSIDE
269		SIDE OF	Hood
270		WALL	
271		SHelf	
272		WALL	
273		BENCH	
274		"	
275		Floor	
276		"	
277		"	
278		"	
279		"	
280		"	
281		"	
282		"	
283		UPPER	WALL
284	✓	lower	"
283		FLOOR	
284	✓	FLOOR	

O = wipe LOCATION

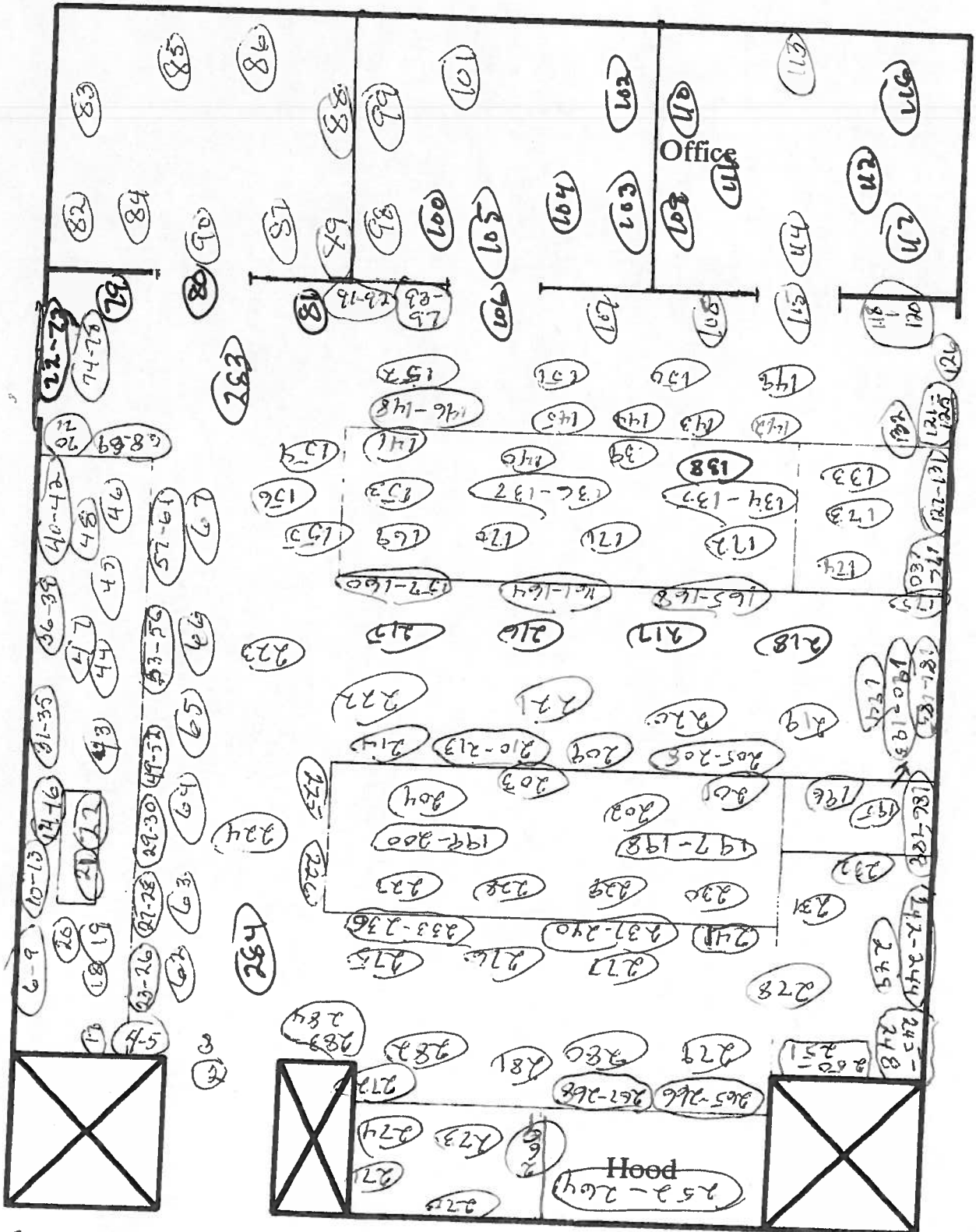

Surveyed 100% of work surfaces using instrument 43-68. No readings were observed above normal background levels.

Assay Definition-

Assay Description:
Equipment Swipes

Assay Type: CPM
Report Name: Report1
Output Data Path: C:\Packard\Tricarb\Results\Ed Gailor\Eds Monthly Swipes
Raw Results Path: C:\Packard\Tricarb\Results\Ed Gailor\Eds Monthly Swipes\20121220_1748
\20121220_1748.results
RTF File Name: C:\Packard\Tricarb\Results\Ed Gailor\Eds Monthly Swipes\Ed's Monthly
Swipes.rtf
Assay File Name: C:\Packard\TriCarb\Assays\Eds Monthly Swipes.lsa

Count Conditions-

Nuclide: Triple
Quench Indicator: tSIE/AEC
External Std Terminator (sec): 5 sec
Pre-Count Delay (min): 0.00
Quench Set: n/a
Count Time (min): 1.00
Count Mode: Normal
Assay Count Cycles: 1 Repeat Sample Count: 1
#Vials/Sample: 1 Calculate % Reference: Off

Background Subtract: On - Manual
Low CPM Threshold: Off
2 Sigma % Terminator: Off

Regions	LL	UL	Bkg Subtract
A	0.0	18.6	0.00
B	18.6	156.0	0.00
C	0.0	2000.0	0.00

Count Corrections-

Static Controller: On Luminescence Correction: On
Colored Samples: n/a Heterogeneity Monitor: n/a
Coincidence Time (nsec): 18 Delay Before Burst (nsec): 75

Half Life-

Half Life Correction: Off

Regions	Half Life	Units	Reference Date	Reference Time
A				
B				
C				

Cycle 1 Results

S#	CPMA	CPMB	CPMC	MESSAGES
1	16	8	31	
2	10	8	24	
3	8	5	16	
4	16	13	35	
5	9	5	21	
6	6	8	18	
7	8	9	23	
8	11	5	22	
9	17	9	34	
10	12	6	19	

11	10	5	17
12	5	4	12
13	14	6	25
14	10	4	16
15	12	7	22
16	14	6	28
17	13	4	23
18	14	11	25
19	11	7	20
20	5	8	17
21	8	9	25
22	12	8	26
23	10	8	25
24	9	7	20
25	6	10	20
26	10	8	24
27	8	5	17
28	14	9	29
29	9	2	16
30	8	7	21
31	10	6	22
32	17	6	28
33	20	8	34
34	9	8	19
35	7	2	11
36	5	4	9
37	15	7	24
38	17	10	32
39	9	4	15
40	14	7	23
41	3	12	26
42	7	4	16
43	11	5	25
44	16	5	31
45	12	5	21
46	6	7	17
47	11	11	24
48	11	4	17
49	9	7	19
50	4	9	19
51	8	7	17
52	15	3	22
53	14	7	24
54	10	5	19
55	6	9	20
56	12	10	24
57	9	5	19
58	14	9	30
59	10	7	23
60	14	7	23
61	11	5	20
62	13	6	22
63	7	4	14
64	7	6	21
65	13	6	23
66	7	4	14
67	15	7	25
68	8	9	27
69	10	4	18
70	9	5	20
71	9	8	24
72	11	9	23
73	7	4	13

Protocol# 4 - Eds Monthly Swipes.lsa

User: Ed Gailor

74	14	6	29
75	9	7	24
76	8	6	18
77	11	7	25
78	12	9	26
79	8	9	24
80	12	6	22
81	18	7	28
82	16	5	28
83	7	7	17
84	11	2	15
85	13	11	29
86	12	6	21
87	6	6	21
88	15	1	20
89	18	7	30
90	5	5	13
91	13	7	25
92	17	4	28
93	5	7	18
94	8	8	21
95	9	6	18
96	13	13	30
97	6	2	15
98	5	10	20
99	20	6	32
100	13	7	27
101	17	5	25
102	11	9	24
103	8	12	25
104	15	10	29
105	3	3	9
106	17	5	29
107	15	6	29
108	6	9	17
109	15	12	31
110	12	7	24
111	16	8	28
112	8	7	23
113	7	7	22
114	9	9	22
115	10	9	26
116	16	4	27
117	8	8	18
118	11	1	17
119	17	5	30
120	10	9	25
121	10	4	16
122	14	2	21
123	3	9	14
124	8	5	19
125	16	4	29
126	10	3	18
127	7	6	19
128	7	6	19
129	14	10	28
130	4	6	17
131	7	7	19
132	13	11	31
133	5	5	12
134	8	7	17
135	5	6	18
136	5	7	18

137	16	6	25
138	14	10	28
139	4	6	16
140	6	6	18
141	14	6	24
142	19	7	29
143	7	4	13
144	15	6	28
145	12	5	22
146	12	5	24
147	17	6	27
148	15	9	26
149	13	6	23
150	10	7	26
151	5	4	13
152	7	7	17
153	5	6	13
154	11	5	18
155	19	3	28
156	10	5	17
157	9	9	20
158	9	6	17
159	11	7	24
160	9	3	19
161	9	5	17
162	11	6	25
163	1	6	9
164	15	2	22
165	13	8	24
166	11	9	22
167	7	6	19
168	10	13	29
169	6	5	13
170	7	7	19
171	10	6	21
172	9	7	21
173	6	5	15
174	3	7	14
175	12	5	18
176	20	7	31
177	9	6	18
178	12	12	29
179	3	3	13
180	9	2	13
181	16	10	29
182	14	11	32
183	10	2	15
184	3	6	15
185	12	3	22
186	12	6	24
187	12	7	22
188	9	10	23
189	4	9	18
190	12	11	30
191	8	2	11
192	11	5	19
193	16	10	30
194	14	6	25

Assay Definition-

Assay Description:
Equipment Swipes

Assay Type: CPM
Report Name: Report1
Output Data Path: C:\Packard\Tricarb\Results\Ed Gailor\Eds Monthly Swipes
Raw Results Path: C:\Packard\Tricarb\Results\Ed Gailor\Eds Monthly Swipes\20121221_0545
\20121221_0545.results
RTF File Name: C:\Packard\Tricarb\Results\Ed Gailor\Eds Monthly Swipes\Ed's Monthly Swipes.rtf
Assay File Name: C:\Packard\TriCarb\Assays\Eds Monthly Swipes.lsa

Count Conditions-

Nuclide: Triple
Quench Indicator: tSIE/AEC
External Std Terminator (sec): 5 sec
Pre-Count Delay (min): 0.00
Quench Set: n/a
Count Time (min): 1.00
Count Mode: Normal
Assay Count Cycles: 1 Repeat Sample Count: 1
#Vials/Sample: 1 Calculate % Reference: Off

Background Subtract: On - Manual
Low CPM Threshold: Off
2 Sigma % Terminator: Off

Regions	LL	UL	Bkg Subtract
A	0.0	18.6	0.00
B	18.6	156.0	0.00
C	0.0	2000.0	0.00

Count Corrections-

Static Controller: On Luminescence Correction: On
Colored Samples: n/a Heterogeneity Monitor: n/a
Coincidence Time (nsec): 18 Delay Before Burst (nsec): 75

Half Life-

Half Life Correction: Off

Regions	Half Life	Units	Reference Date	Reference Time
A				
B				
C				

Cycle 1 Results

S#	CPMA	CPMB	CPMC	MESSAGES
1	13	8	24	
2	5	3	13	
3	12	6	26	
4	9	8	22	
5	19	6	33	
6	12	9	26	
7	10	3	16	
8	14	5	27	
9	11	10	25	
10	8	8	21	

11	205	16	6	24
12	10	9	21	
13	9	8	18	
14	5	8	17	
15	9	4	18	
16	12	6	22	
17	18	5	28	
18	14	9	29	
19	14	9	31	
20	15	9	29	
21	215	9	4	17
22	13	5	23	
23	10	3	14	
24	1	7	12	
25	13	11	30	
26	8	5	16	
27	5	7	16	
28	18	14	35	
29	10	4	18	
30	13	4	21	
31	225	7	7	21
32	14	6	23	
33	13	6	25	
34	7	5	19	
35	8	3	15	
36	6	3	16	
37	13	6	22	
38	14	6	26	
39	20	6	31	
40	13	2	16	
41	235	18	11	33
42	11	3	19	
43	9	7	19	
44	15	11	31	
45	17	9	27	
46	21	7	33	
47	23	19	53	
48	12	3	20	
49	14	5	27	
50	11	6	23	
51	245	11	5	20
52	12	8	28	
53	10	2	14	
54	10	3	16	
55	6	8	19	
56	9	5	21	
57	11	6	20	
58	9	8	20	
59	12	8	24	
60	8	3	16	
61	255	10	5	19
62	8	12	22	
63	8	4	12	
64	18	12	36	
65	15	6	25	
66	8	4	17	
67	4	5	16	
68	14	5	22	
69	11	3	19	
70	2	8	17	
71	265	15	10	27
72	11	10	27	
73	19	3	25	

Protocol# 4 - Eds Monthly Swipes.lsa

User: Ed Gailor

74	22	2	29
75	8	6	18
76	13	6	24
77	10	9	21
78	6	3	14
79	5	7	19
80	8	10	21
81	<u>275</u> 4	<u>12</u>	<u>19</u>
82	9	5	22
83	16	6	29
84	8	4	13
85	13	6	25
86	14	11	31
87	8	4	13
88	11	5	21
89	7	10	22
90	<u>284</u> 6	<u>3</u>	<u>10</u>