

Radiological Survey Sheet

Job Location 118C / C 316 Page 1 of 24
 Survey Purpose LAB CLOSE OUT Date 11-28-00
 Performed By E. GAILOR E. Gailor
 (Print) (Sign)

Inst.(1) (Model/SN) Beckman LS 6500 #7069448	Inst.(2) <i>Ludlum 2241-2</i> (Model/SN) # 163 603	Inst.(3) (Model/SN)
Det. Internal (Model/SN)	Det. <i>Ludlum 43-68</i> (Model/SN) # 149413	Det. (Model/SN)
Eff. See LSC Printout	Eff. <i>= 8% C-4</i>	Eff.
Type rad. β	Type rad. β	Type rad.
Bkgd. See LSC Printout	Bkgd. <i>300cpm</i>	Bkgd.
Cal. Due: 12/00	Cal. Due <i>2/13/01</i>	Cal. due

No.	Time	Location	Inst. Used	Total Activity (dpm/100 cm ²)
1.	1000	DOOR & HAND	1	See attached LSC Printout
2.	↑	FLOOR	1	
3.		UPPER WALL	1	
4.		LOWER "	1	
5.		UPPER "	1	
6.		LOWER "	1	
7.		UPPER "	1	
8.		LOWER "	1	
9.		UPPER SIDE OF HOOD	1	
10.		LOWER " " "	1	
11.		FLOOR	1	
12.		PC OF PLASTIC	1	
13.		HOOD UPPER LEFT VENT	1	
14.		" " RIGHT "	1	
15.		" UPPER LEFT SECTION	1	
16.		" " RIGHT "	1	
17.		HOOD BOTTOM ^{BACK} LEFT "	1	
18.	↓	" " ^{BACK} RIGHT "	1	↓

Radiological Survey Continuation Sheet

Page 2 of 24

Date 11-28-00

No.	Time	Location	Inst. Used	Total Activity (dpm/100 cm ²)
19	1000	Hood ^{BACK} BOTTOM MIDDLE LEFT VENT	1	See attached LSC Printout
20	↑	" " " BACK " " RIGHT "	1	
21		" " " BACK LEFT VENT	1	
22		" " " BACK RIGHT "	1	
23		" " LEFT SIDE	1	
24		" " RIGHT "	1	
25		" " BOTTOM LEFT SIDE	1	
26		" " " RIGHT "	1	
27		" " CVP	1	
28		Hood INSIDE GLASS & SASH	1	
29		" " OUTSIDE " & "	1	
30		Hood LIP	1	
31		CAB doors & HANDLS	1	
32		BACK OF CAB	1	
33		LEFT side OF CAB	1	
34		RIGHT " " "	1	
35		BOTTOM OF CAB	1	
36		FLOOR	1	(see # 369)
37		CAB doors & HANDLS	1	
38		BACK OF CAB	1	
39		LEFT side OF CAB	1	
40		RIGHT " " "	1	
41		BOTTOM " " "	1	
42		PLASTIC COVER	1	(see # 370)
43		OUTSIDE METAL BUCKET	1	radwaste
44		INSIDE METAL " "	1	radwaste
45		LEAD VEST	1	
46	↓	PLASTIC HOSE	1	(see # 371)

Radiological Survey Continuation Sheet

Page 3 of 24

Date 11-28-00

No.	Time	Location	Inst. Used	Total Activity (dpm/100 cm ²)
47	1000	LEAD PC 1	1	See attached LSC Printout
48	↑	" PC 2	1	
49		" PC 3	1	
50		" PC 4	1	
51		TOP SHELF	1	
52		WALL BETWEEN SHELF	1	
53		BOTTOM SHELF	1	
54		WALL BELOW ^{bottom} SHELF	1	
55		CAB. DOORS & HANDLS	1	
56		TOP SHELF	1	
57		2ND "	1	
58		3RD "	1	
59		BOTTOM "	1	
60		CAB. DOORS & HANDLS	1	
61		TOP SHELF	1	
62		2ND "	1	
63		3RD "	1	
64		BOTTOM "	1	
65		CAB. DOORS & HANDLS	1	
66		TOP SHELF	1	
67		MIDDLE "	1	
68		BOTTOM "	1	
69		WALL BELOW CABINETS	1	
70		LEDGE	1	
71		FLOOR	1	
72		SHELF	1	
73		TOP SHELF	1	
74	✓	MIDDLE "	1	✓

Radiological Survey Continuation Sheet

Page 4 of 24

Date 11-28-06

No.	Time	Location	Inst. Used	Total Activity (dpm/100 cm ²)
75	1006	BOTTOM SHELF	1	See attached LSC Printout
76	↑	DESK	1	
77		DRAWERS & HANDLS	1	
78		TOP DRAWER	1	
79		MIDDLE "	1	
80		BOTTOM "	1	
81		DRAWER & HANDL	1	
82		DRAWER	1	
83		DRAWERS & HANDLS	1	
84		TOP DRAWER	1	
85		2ND "	1	
86		3RD "	1	
87		BOTTOM "	1	
88		DRAWERS & HANDLS	1	
89		TOP DRAWER	1	
90		2ND "	1	(see #373)
91		3RD "	1	(see #374)
92		BOTTOM "	1	
93		EDH DRAWER & HANDL	1	
94		METAL TRAY UNDER COUNTER	1	
95		EDH DRAWER "	1	
96		METAL TRAY #1 UNDER COUNTER	1	
97		METAL TRAY #2 UNDER COUNTER	1	
98		" " #3 " "	1	
99		DRAWERS & HANDLS	1	
100		TOP DRAWER	1	
101		2ND "	1	
102		3RD "	1	
102	↓	BOTTOM "	1	↓

Radiological Survey Continuation Sheet

Page 5 of 24

Date 11-28-06

No.	Time	Location	Inst. Used	Total Activity (dpm/100 cm ²)
103	1500	DRAWERS & HANDLS	1	See attached LSC Printout
104	↑	TOP DRAWER	1	
105		2ND "	1	
106		3RD "	1	
107		BOTTOM "	1	
108		TOP SHELF	1	
109		MIDDLE "	1	
110		BOTTOM "	1	(See #375)
111		COUNTER	1	
112		CUP	1	
113		TOP SHELF	1	
114		MIDDLE "	1	
115		BOTTOM "	1	
116		COUNTER	1	
117		CUP	1	
118		COUNTER	1	
119		"	1	
120		"	1	
121		"	1	
122		FLOOR	1	
123		"	1	
124		"	1	
125		"	1	
126		SIDE OF COUNTER	1	
127		" " "	1	
128		FLOOR	1	
129		DRAWER & HANDL	1	
130	✓	DRAWER	1	✓ (See #376)

Radiological Survey Continuation Sheet

Page 6 of 24

Date 11-28-00

No.	Time	Location	Inst. Used	Total Activity (dpm/100 cm ²)
131	1000	CAB. DOORS & HANDLS	1	See attached LSC Printout
132	↑	TOP SHELF	1	
133		BOTTOM "	1	
134		OUTSIDE REFRIG	1	
135		BACK OF "	1	
136		LEFT side of "	1	
137		RIGHT " " "	1	
138		METAL TRAY IN REFRIG.	1	
139		TOP SHELF	1	
140		BOTTOM "	1	
141		PLASTIC TRAY	1	
142		BOTTOM OF REFRIG.	1	
143		TOP SHELF ON DOOR	1	
144		2ND " " "	1	
145		BOTTOM " " "	1	
146		DRAWERS & HANDLS	1	
147		TOP DRAWER	1	
148		2ND "	1	
149		3RD "	1	
150		BOTTOM "	1	
151		DRAWER & HANDL	1	
152		DRAWER	1	
153		DRAWERS & HANDLS	1	
154		TOP DRAWER	1	
155		2ND "	1	
156		3RD "	1	
157		BOTTOM "	1	
158	↓	DRAWER & HANDL	1	

Radiological Survey Continuation Sheet

Page 7 of 24

Date 11-28-00

No.	Time	Location	Inst. Used	Total Activity (dpm/100 cm ²)
159	1000	DRAWER	1	See attached LSC Printout
160	↑	DRAWERS & HANDLS	1	
161		TOP DRAWER	1	
162		MIDDLE "	1	
163		BOTTOM "	1	
164		TOP SHELF	1	
165		2ND "	1	
166		BOTTOM "	1	
167		DESK	1	
168		SHELF	1	
169		PHONE	1	
170		COUNTER	1	
171		"	1	
172		"	1	
173		CAB. DOORS & HANDLS	1	
174		TOP SHELF	1	
175		2ND "	1	
176		3RD "	1	
177		BOTTOM "	1	
178		CAB. DOORS & HANDLS	1	
179		TOP SHELF	1	
180		2ND "	1	
181		3RD "	1	
182		BOTTOM "	1	
183		ED-TOPEdge CAB. DOORS & HANDLS	1	
184		TOP SHELF	1	
185		2ND "	1	
186	↓	3RD "	1	↓

Radiological Survey Continuation Sheet

Page 8 of 24

Date 11-28-00

No.	Time	Location	Inst. Used	Total Activity (dpm/100 cm ²)
187	1000	BOTTOM SHELF	1	See attached LSC Printout
188	↑	WALL UNDER CABS.	1	
189		TOP SHELF	1	
190		BOTTOM "	1	
191		FLOOR	1	
192		DRAWERS & HANDLS	1	
193		TOP DRAWER	1	
194		MIDDLE "	1	
195		BOTTOM "	1	
196		DRAWER & HANDL	1	
197		DRAWER	1	
198		TOP SHELF	1	
199		MIDDLE "	1	
200		BOTTOM "	1	(See #377)
201		SHELF	1	(See #3)
202		DESIC	1	
203		TOP SHELF	1	
204		MIDDLE "	1	
205		BOTTOM "	1	
206		COUNTER	1	
207		CUP	1	
208		TOP SHELF	1	
209		MIDDLE "	1	
210		BOTTOM "	1	
211		COUNTER	1	
212		CUP	1	
213		DRAWERS & HANDLS	1	
214	✓	TOP DRAWER	1	✓

Radiological Survey Continuation Sheet

Page 9 of 24

28-00

Date 11-20-8

ED

No.	Time	Location	Inst. Used	Total Activity (dpm/100 cm ²)
215	1000	2ND DRAWER	1	See attached LSC Printout
216	↑	3RD "	1	
217		BOTTOM "	1	
218		DRAWER & HNDL	1	
219		DRAWER	1	
220		FLOOR UNDER COUNTER	1	
221		DRAWERS & HNDLS	1	
222		TOP DRAWER	1	
223		2ND "	1	
224		3RD "	1	
225		BOTTOM "	1	
226		DRAWER & HNDL	1	
227		DRAWER	1	
228		FLOOR UNDER COUNTER	1	
229		FLOOR	1	
230		"	1	
231		"	1	
232		"	1	(see # 379)
233		SIDE OF CAB.	1	
234		SHELF PIECE	1	
235		SIDE OF CAB.	1	
236		FLOOR	1	
237		DRAWER & HNDL	1	
238		DRAWER	1	
239		FLOOR UNDER COUNTER	1	
240		DRAWERS & HNDLS	1	(see)
241		TOP DRAWER	1	
242	✓	2ND "	1	✓

• Radiological Survey Continuation Sheet

Page 10 of 24

Date 11-28-00

No.	Time	Location	Inst. Used	Total Activity (dpm/100 cm ²)
243	1000	3RD DRAWER	1	See attached LSC Printout
244	↑	BOTTOM "	1	
245		DRAWER & HNDL	1	
246		DRAWER	1	
247		FLOOR UNDER COUNTER	1	
248		DRAWERS & HNDLS	1	
249		TOP DRAWER	1	
250		2ND "	1	
251		3RD "	1	
252		BOTTOM "	1	
253		TOP SHELF	1	
254		MIDDLE "	1	
255		BOTTOM "	1	
256		DESK	1	
257		SHELF	1	
258		UPPER WALL	1	
259		LOWER WALL	1	
260		DRAWER & HNDL	1	
261		DRAWER	1	
262		DRAWER & HNDLS	1	
263		TOP DRAWER	1	
264		MIDDLE "	1	
265		BOTTOM "	1	
266		UPPER WALL	1	
267		LOWER WALL	1	
268		FLOOR	1	(See #381)
269		UPPER WALL	1	
270	✓	LOWER "	1	✓

Radiological Survey Continuation Sheet

Page 11 of 24

Date 11-28-00

No.	Time	Location	Inst. Used	Total Activity (dpm/100 cm ²)
271	1006	WALL	1	See attached LSC Printout
272	↑	"	1	
273		LOWER WALL	1	
274		TOP BACK	1	
275		2ND "	1	
276		3RD "	1	
277		BOTTOM "	1	
278		FLOOR	1	
278		FLOOR	1	
280		FLOOR	1	
281		TABLE TOP	1	
282		" "	1	
283		DRAWERS & HANDLS	1	
284		TOP DRAWER	1	
285		2ND "	1	
286		3RD "	1	
287		BOTTOM "	1	
288		DRAWER & HANDL	1	
289		DRAWER	1	
290		DRAWER UNDER TABLE	1	
291		DRAWERS & HANDLS	1	
292		TOP DRAWER	1	
293		2ND "	1	
294		3RD "	1	
295		BOTTOM "	1	
296		UPPER WALL	1	
297		LOWER "	1	
298	√	FLOOR	1	√

Radiological Survey Continuation Sheet

Page 12 of 24

Date 11-28-00

No.	Time	Location	Inst. Used	Total Activity (dpm/100 cm ²)
299	1000	UPPER WALL	1	See attached LSC Printout
300	↑	LOWER "	1	
301		FLOOR	1	
302		CART	1	
303		FLOOR	1	
304		FLOOR	1	
305		FLOOR	1	
306		FLOOR	1	
307		FLOOR	1	
308		FLOOR	1	
309		UPPER WALL	1	
310		LOWER "	1	
311		FLOOR	1	
312		UPPER WALL	1	
313		LOWER "	1	
314		UPPER "	1	
315		LOWER "	1	
316		FLOOR	1	
317		FLOOR	1	
318		SIDE OF SINK	1	
319		FLOOR	1	
320		TOP SHELF	1	
321		MIDDLE "	1	
322		BOTTOM "	1	
323		PEG BOARD & METAL TRAY BEHIND SINK	1	
324		TOP SHELF	1	
325		MIDDLE "	1	
326	↓	BOTTOM "	1	↓

Radiological Survey Continuation Sheet

Page 13 of 24

Date 11-28-00

No.	Time	Location	Inst. Used	Total Activity (dpm/100 cm ²)
327	1000	TOP SHELF	1	See attached LSC Printout
328	↑	2ND "	1	
329		3RD "	1	
330		BOTTOM "	1	
331		CAB. DOORS & HANDLS	1	
332		BACK OF CAB	1	
333		LEFT SIDE OF CAB	1	
334		RIGHT " " "	1	
335		BOTTOM OF "	1	
336		WIRE MESH BASKET	1	
337		TOP METAL PAN	1	
338		BOTTOM " "	1	
339		DRAWERS & HANDLS	1	
340		TOP DRAWER	1	
341		2ND "	1	
342		3RD "	1	
343		BOTTOM "	1	
344		DRAWER & HANDL	1	
345		DRAWER	1	
346		FLOOR UNDER COUNTER	1	
347		DRAWERS & HANDLS	1	
348		TOP DRAWER	1	
349		2ND "	1	
350		3RD "	1	
351		BOTTOM "	1	
352		UPPER WALL	1	
353		LOWER "	1	
354	↓	BEHIND SINK	1	↓

Radiological Survey Continuation Sheet

Page 14 of 24

Date 11-28-00

No.	Time	Location	Inst. Used	Total Activity (dpm/100 cm ²)
355	1000	INSIDE SINK	1	See attached LSC Printout
356	↑	SINK LEDGE	1	
357		COUNTER	1	
358		CWP	1	
359		COUNTER	1	
360		WALL UNDER CABINETS	1	
361		COUNTER	1	
362		METAL PC 1	1	
363		" " 2	1	
364		FLOOR	1	
365		FLOOR	1	
366		FLOOR	1	
367		FLOOR	1	
368	↓	FLOOR	1	
369		POST DECON #35	1	
370		#41	1	
371		#45	1	
372		#47	1	
373		#89	1	
374		#90	1	
375		#109	1	
376		#130	1	
377		#199	1	
378		#200	1	
379		#231	1	
380		#239	1	
381	↓	↓ #367	1	
382	1000	POST DECON SPOT (1)	1	↓

Bld. 118C Room C316

Date: 11-28-00

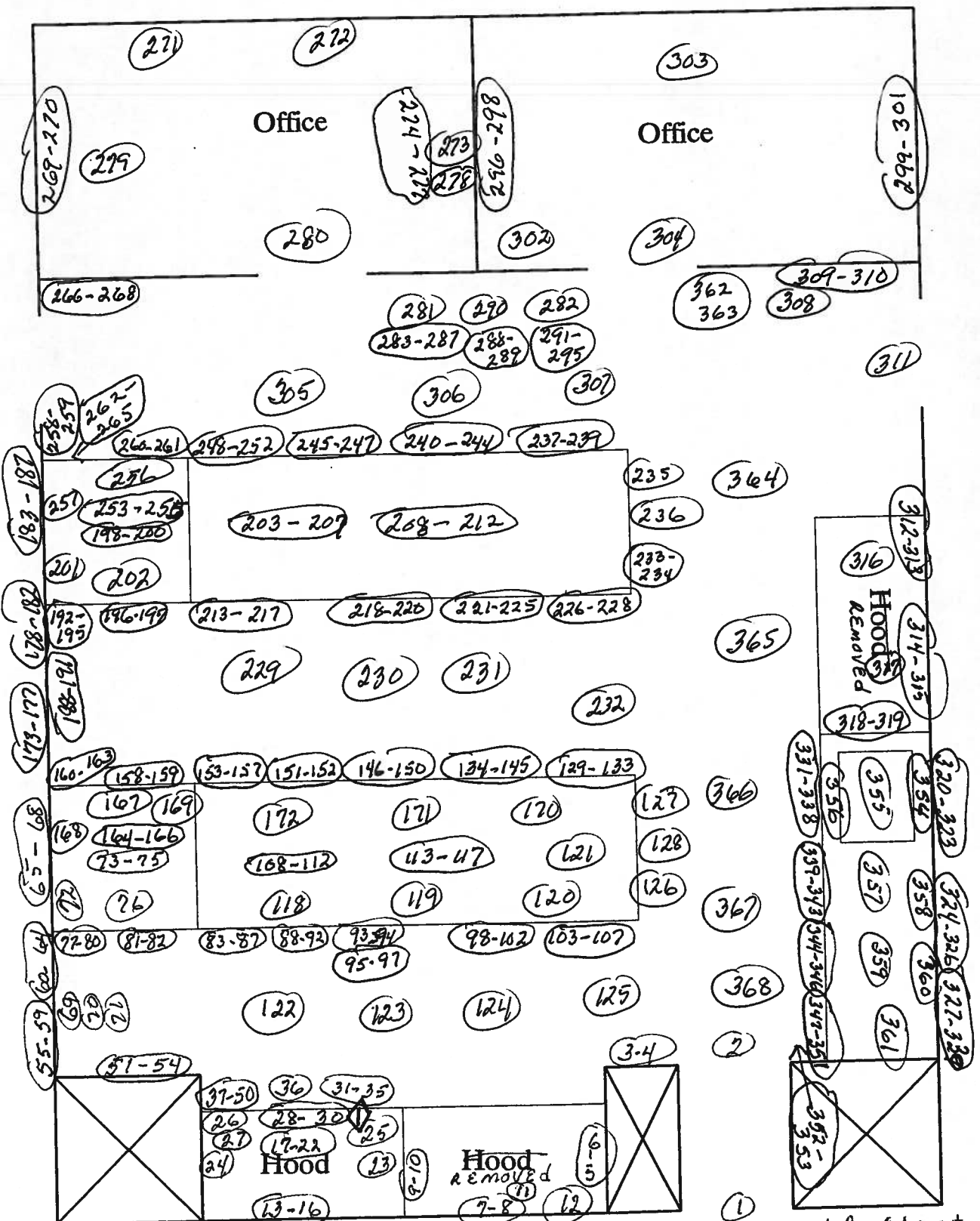

Surveyed = 100% of lower surfaces using instrument #2. All surfaces surveyed were noted to be at normal background levels with one (1) exception: Hood counter was found to be contaminated to a level of 4,1925 dpm.

ID: EQUIPMENT SURVY

28 NOV 2000 18:02

USER: 1 COMMENT:
 RESET TIME : 1.00
 DATA CALC : DL DPM H# :YES SAMPLE REPEATS: 1 PRINTER :EDIT
 COUNT BLANK : YES IC# : NO REPLICATES : 1 RS232 :EDIT
 TWO PHASE : NO AQC :YES CYCLE REPEATS : 1
 SCINTILLATOR: LIQUID LUMEX:YES LOW SAMPLE REJ: 0
 LOW LEVEL : NO HALF LIFE CORRECTION DATE: none

ISOTOPE 1: 3H %ERROR: 2.00 FACTOR: 1.000000 BKG. SUB: 0
 ISOTOPE 2: 14C %ERROR: 2.00 FACTOR: 1.000000 BKG. SUB: 0
 WIDE OPEN WINDOW %ERROR: 0.00 FACTOR: 1.000000 BKG. SUB: 0

BACKGROUND QUENCH CURVE: Off COLOR QUENCH CORRECTION: Off

Quench Limits Low: 2.756 High:314.54

SAM NO	H#	3H CPM	14C CPM	WIDE CPM	3H DPM	14C DPM	LUMEX %
B1	92.1	11.00	10.00	28.00	17.64	13.42	4.88
1	83.5	21.00	8.00	35.00	20.34	-2.88	3.16
2	86.3	20.00	15.00	40.00	15.19	6.61	7.92
3	83.5	25.00	6.00	39.00	29.35	-5.62	1.81
4	87.2	11.00	8.00	27.00	0.63	-2.74	5.15
5	84.3	17.00	6.00	30.00	13.47	-5.53	1.99
6	83.7	23.00	5.00	36.00	25.91	-6.95	3.22
7	82.2	23.00	11.00	41.00	22.57	1.14	2.90
8	81.9	13.00	14.00	40.00	1.13	5.30	7.28
9	81.6	30.00	10.00	47.00	36.85	-0.30	4.90
10	86.2	15.00	8.00	32.00	8.66	-2.79	3.76
11	105.3	18.00	12.00	40.00	15.77	2.73	3.29
12	95.1	26.00	6.00	40.00	34.28	-5.60	5.14
13	92.6	30.00	9.00	50.00	40.40	-1.59	4.10
14	100.5	20.00	8.00	34.00	21.55	-2.79	8.89
15	85.3	23.00	7.00	40.00	25.22	-4.24	3.65
16	85.2	26.00	6.00	44.00	31.76	-5.63	3.70
17	83.4	19.00	12.00	38.00	14.28	2.55	3.72
18	87.3	19.00	10.00	36.00	15.92	-0.13	2.06
19	90.4	15.00	6.00	30.00	10.26	-5.48	5.66
20	92.6	20.00	11.00	41.00	18.36	1.25	4.40
21	91.8	18.00	9.00	30.00	15.12	-1.45	4.64
22	93.3	26.00	15.00	52.00	28.95	6.60	7.60
23	84.8	24.00	10.00	43.00	25.60	-0.21	3.29
24	80.9	22.00	15.00	48.00	18.34	6.53	3.07
25	80.8	20.00	4.00	33.00	19.88	-8.27	2.75
26	84.9	19.00	10.00	41.00	15.53	-0.14	3.09
27	91.5	29.00	9.00	50.00	37.97	-1.58	3.45
28	82.9	26.00	8.00	39.00	30.20	-2.94	2.83
29	83.6	20.00	5.00	37.00	19.88	-6.91	2.88
30	81.3	19.00	10.00	38.00	14.98	-0.17	6.54
31	87.4	19.00	15.00	36.00	13.32	6.63	1.58
32	85.2	28.00	12.00	46.00	32.72	2.45	6.89
33	81.7	16.00	10.00	37.00	9.09	-0.13	2.94
34	84.9	17.00	12.00	38.00	10.48	2.58	3.59
35	91.3	49.00	16.00	73.00	75.80	7.65	2.78
36	89.0	29.00	12.00	56.00	35.71	2.46	2.83
37	82.3	18.00	7.00	36.00	14.65	-4.20	3.96
38	85.9	17.00	14.00	39.00	9.58	5.29	2.96

SAM NO	H#	3H CPM	14C CPM	WIDE CPM	3H DPM	14C DPM	LUMEX %
39	85.7	19.00	11.00	46.00	15.14	1.21	4.11
40	87.5	16.00	7.00	26.00	11.39	-4.15	4.78
41	97.7	115.00	32.00	155.00	212.13	28.62	1.71
42	85.8	25.00	13.00	45.00	26.28	3.84	2.60
43	81.3	68.00	14.00	86.00	110.06	4.64	3.66
44	125.3	1859.00	124.00	1996.00	4599.14	128.91	0.04
45	86.3	44.00	18.00	71.00	62.35	10.37	2.51
46	89.1	16.00	13.00	41.00	8.46	3.98	3.85
47	89.3	35.00	14.00	65.00	47.10	5.10	1.35
48	88.9	22.00	12.00	48.00	21.29	2.55	5.02
49	86.1	19.00	6.00	36.00	17.79	-5.54	2.81
50	86.6	18.00	8.00	37.00	14.80	-2.83	6.47
51	92.6	21.00	7.00	41.00	22.59	-4.19	6.73
52	100.3	19.00	11.00	46.00	17.64	1.31	6.30
53	82.8	18.00	6.00	34.00	15.24	-5.54	8.59
54	79.9	22.00	5.00	36.00	23.16	-6.95	2.98
55	84.9	28.00	11.00	48.00	33.16	1.10	3.26
56	87.0	18.00	14.00	38.00	11.76	5.29	2.42
57	89.9	20.00	5.00	33.00	21.06	-6.90	7.92
58	90.4	24.00	9.00	44.00	27.31	-1.53	3.52
59	97.6	20.00	15.00	45.00	17.07	6.72	11.73
60	85.8	18.00	12.00	36.00	12.62	2.58	2.84
61	88.4	21.00	8.00	42.00	21.24	-2.85	3.97
62	87.8	19.00	11.00	40.00	15.48	1.23	4.15
63	84.6	24.00	7.00	37.00	27.08	-4.26	8.59
64	88.5	19.00	6.00	36.00	18.21	-5.54	4.87
65	86.7	23.00	13.00	42.00	22.41	3.87	2.59
66	83.8	13.00	8.00	27.00	4.35	-2.78	3.59
67	86.1	22.00	4.00	33.00	24.91	-8.28	7.43
68	89.7	15.00	7.00	32.00	9.63	-4.13	7.02
69	84.5	24.00	12.00	45.00	24.51	2.49	2.70
70	89.1	21.00	7.00	35.00	21.90	-4.20	2.92
71	85.0	23.00	13.00	44.00	22.07	3.86	5.06
72	101.2	15.00	11.00	36.00	9.03	1.37	8.42
73	95.6	21.00	18.00	49.00	17.22	10.77	4.22
74	90.4	19.00	6.00	35.00	18.55	-5.53	11.05
75	92.4	17.00	13.00	38.00	10.97	4.00	4.00
76	99.6	18.00	15.00	44.00	13.08	6.77	12.97
77	84.9	18.00	17.00	44.00	9.93	9.32	8.90
78	88.6	19.00	13.00	42.00	14.56	3.94	3.13
79	87.8	21.00	14.00	39.00	18.00	5.26	3.52
80	94.5	23.00	5.00	41.00	28.32	-6.92	3.24
81	85.9	11.00	8.00	30.00	0.52	-2.74	11.28
82	89.3	21.00	11.00	40.00	19.85	1.21	4.32
83	85.9	25.00	10.00	41.00	27.86	-0.21	9.98
84	87.9	16.00	10.00	38.00	9.88	-0.09	3.61
85	84.0	16.00	10.00	30.00	9.37	-0.11	7.51
86	89.8	11.00	14.00	36.00	-2.31	5.40	3.33
87	89.6	15.00	14.00	35.00	5.93	5.35	5.51
88	84.5	19.00	10.00	40.00	15.48	-0.15	3.46
89	84.8	38.00	13.00	58.00	52.26	3.68	2.14
90	92.6	39.00	35.00	78.00	45.28	33.56	2.60
91	90.9	23.00	14.00	46.00	22.70	5.26	1.32
92	89.7	15.00	9.00	30.00	8.59	-1.42	4.57
93	86.1	23.00	11.00	47.00	23.32	1.17	2.66
94	88.7	22.00	11.00	41.00	21.78	1.20	3.47
95	91.8	30.00	8.00	49.00	40.70	-2.95	2.70
96	96.2	19.00	7.00	36.00	19.08	-4.15	4.55

SAM NO	H#	3H CPM	14C CPM	WIDE CPM	3H DPM	14C DPM	LUMEX %
97	105.7	34.00	8.00	48.00	54.16	-2.95	10.81
98	82.9	22.00	11.00	45.00	20.71	1.16	3.75
99	87.7	24.00	12.00	40.00	25.15	2.52	4.21
100	88.6	17.00	12.00	36.00	10.98	2.61	2.34
101	90.1	24.00	7.00	36.00	28.31	-4.24	3.25
102	89.4	19.00	8.00	34.00	17.32	-2.82	3.76
103	90.5	18.00	5.00	32.00	17.03	-6.87	3.26
104	94.7	21.00	10.00	38.00	21.41	-0.11	6.34
105	87.7	20.00	13.00	44.00	16.47	3.92	1.91
106	86.6	17.00	5.00	34.00	14.33	-6.87	2.80
107	86.6	24.00	9.00	43.00	26.48	-1.55	2.37
108	104.7	26.00	14.00	46.00	32.39	5.35	6.77
109	116.6	33.00	20.00	60.00	48.90	13.60	6.31
110	87.7	26.00	8.00	47.00	31.33	-2.92	3.56
111	90.5	19.00	12.00	39.00	15.39	2.60	3.44
112	98.3	25.00	5.00	42.00	33.55	-6.94	4.56
113	104.1	26.00	16.00	53.00	31.08	8.07	5.03
114	79.3	23.00	5.00	39.00	25.02	-6.96	1.86
115	82.2	23.00	12.00	42.00	22.07	2.49	16.44
116	89.7	8.00	8.00	23.00	-5.34	-2.69	5.51
117	92.3	19.00	10.00	40.00	16.75	-0.10	6.62
118	87.2	22.00	9.00	44.00	22.54	-1.52	0.80
119	91.5	20.00	5.00	33.00	21.37	-6.89	3.71
120	86.1	18.00	13.00	38.00	12.15	3.93	5.04
121	97.2	17.00	4.00	30.00	16.64	-8.20	29.04
122	89.7	20.00	13.00	38.00	16.79	3.94	2.96
123	90.1	20.00	7.00	33.00	20.04	-4.19	3.46
124	87.7	8.00	9.00	21.00	-5.98	-1.35	12.82
125	100.7	18.00	13.00	39.00	14.40	4.05	3.94
126	83.6	16.00	11.00	38.00	8.82	1.23	4.18
127	84.9	21.00	6.00	33.00	21.62	-5.57	2.64
128	92.2	23.00	7.00	42.00	26.71	-4.22	4.04
129	83.6	19.00	10.00	40.00	15.33	-0.15	2.71
130	94.2	50.00	33.00	91.00	70.11	30.75	1.71
131	85.2	18.00	6.00	36.00	15.62	-5.53	3.04
132	85.9	18.00	8.00	34.00	14.70	-2.83	2.38
133	85.5	24.00	7.00	41.00	27.28	-4.25	3.29
134	80.7	26.00	8.00	41.00	29.71	-2.95	3.86
135	88.5	18.00	10.00	31.00	14.06	-0.11	4.20
136	84.1	26.00	7.00	41.00	31.00	-4.28	2.75
137	88.0	22.00	10.00	37.00	22.18	-0.16	2.95
138	85.2	12.00	15.00	39.00	-1.12	6.70	4.47
139	85.5	14.00	8.00	32.00	6.55	-2.78	7.38
140	84.5	22.00	9.00	37.00	22.02	-1.53	2.36
141	86.6	19.00	9.00	39.00	16.32	-1.49	4.63
142	88.9	20.00	13.00	41.00	16.67	3.93	2.51
143	84.8	16.00	12.00	31.00	8.45	2.59	3.31
144	86.5	20.00	11.00	42.00	17.30	1.20	3.73
145	90.1	13.00	9.00	32.00	4.50	-1.39	10.85
146	85.7	11.00	8.00	24.00	0.50	-2.75	65.25
147	87.0	22.00	8.00	40.00	23.02	-2.87	5.20
148	88.7	16.00	14.00	41.00	7.88	5.33	2.36
149	86.8	22.00	10.00	40.00	21.93	-0.17	5.40
150	91.2	20.00	13.00	43.00	17.05	3.95	2.60
151	86.2	15.00	8.00	31.00	8.66	-2.79	2.89
152	93.5	22.00	12.00	40.00	22.20	2.59	6.25
153	85.4	15.00	9.00	33.00	8.04	-1.44	2.99
154	85.6	19.00	10.00	43.00	15.64	-0.14	6.68

SAM NO	H#	3H CPM	14C CPM	WIDE CPM	3H DPM	14C DPM	LUMEX %
155	86.9	10.00	12.00	33.00	-3.51	2.68	3.06
156	90.1	19.00	7.00	37.00	17.96	-4.18	2.78
157	94.2	19.00	9.00	34.00	17.62	-1.44	1.31
158	83.9	14.00	7.00	34.00	6.88	-4.14	3.64
159	96.8	20.00	7.00	37.00	21.34	-4.16	6.37
160	88.8	18.00	10.00	40.00	14.11	-0.11	2.91
161	94.4	22.00	6.00	34.00	25.63	-5.55	5.33
162	90.9	19.00	5.00	27.00	19.17	-6.88	2.96
163	98.3	25.00	17.00	54.00	26.89	9.39	1.93
164	105.8	16.00	14.00	37.00	10.19	5.49	6.76
165	89.2	18.00	8.00	37.00	15.22	-2.81	3.38
166	90.1	14.00	9.00	35.00	6.57	-1.40	3.58
167	87.0	19.00	14.00	38.00	13.79	5.28	2.89
168	85.7	17.00	5.00	30.00	14.18	-6.87	4.07
169	87.6	14.00	11.00	32.00	5.23	1.29	3.57
170	91.9	14.00	16.00	46.00	3.04	8.10	2.58
171	91.7	21.00	15.00	38.00	18.15	6.65	4.55
172	92.0	19.00	18.00	48.00	12.43	10.75	3.35
173	86.6	12.00	14.00	32.00	-0.50	5.36	3.74
174	84.7	28.00	8.00	46.00	34.65	-2.96	3.27
175	87.2	20.00	14.00	46.00	15.86	5.27	5.40
176	92.4	20.00	8.00	31.00	19.94	-2.82	1.89
177	91.1	15.00	4.00	28.00	11.42	-8.19	4.21
178	87.3	22.00	9.00	42.00	22.55	-1.52	2.52
179	90.4	22.00	8.00	40.00	23.70	-2.86	1.46
180	86.2	17.00	13.00	40.00	10.14	3.94	3.76
181	86.1	23.00	9.00	43.00	24.34	-1.54	2.01
182	88.2	15.00	12.00	31.00	6.83	2.63	4.70
183	89.5	23.00	6.00	33.00	26.64	-5.58	2.91
184	92.0	15.00	8.00	33.00	9.41	-2.76	2.12
185	92.2	14.00	11.00	29.00	5.75	1.32	4.33
186	90.7	13.00	3.00	23.00	7.75	-9.52	8.11
187	94.5	29.00	11.00	45.00	37.75	1.15	6.35
188	83.9	17.00	9.00	32.00	11.88	-1.48	4.76
189	87.1	25.00	10.00	44.00	28.11	-0.20	2.49
190	99.3	20.00	10.00	39.00	20.17	-0.07	2.68
191	92.3	22.00	5.00	42.00	25.70	-6.92	4.54
192	87.5	20.00	7.00	42.00	19.56	-4.20	2.54
193	92.2	17.00	8.00	30.00	13.62	-2.79	5.03
194	84.3	27.00	11.00	45.00	31.02	1.11	1.47
195	100.5	22.00	9.00	41.00	25.34	-1.45	10.16
196	92.2	23.00	11.00	50.00	24.56	1.21	2.61
197	90.5	20.00	15.00	48.00	15.87	6.65	5.63
198	93.2	18.00	7.00	32.00	16.43	-4.15	18.02
199	93.2	24.00	17.00	60.00	23.65	9.34	2.74
200	87.2	29.00	18.00	62.00	32.12	10.57	2.24
201	85.7	20.00	12.00	37.00	16.65	2.55	3.73
202	83.6	21.00	4.00	37.00	22.40	-8.28	1.91
203	103.3	37.00	7.00	55.00	60.45	-4.36	4.48
204	97.5	12.00	10.00	38.00	2.63	0.02	12.69
205	80.1	18.00	11.00	42.00	12.33	1.18	2.64
206	89.0	31.00	7.00	48.00	42.45	-4.33	2.87
207	92.3	23.00	13.00	44.00	23.51	3.92	14.00
208	87.4	22.00	8.00	40.00	23.11	-2.87	15.61
209	99.2	22.00	10.00	41.00	24.49	-0.10	5.84
210	94.2	18.00	10.00	33.00	14.97	-0.07	9.81
211	86.9	16.00	12.00	35.00	8.71	2.61	1.89
212	126.8	9.00	8.00	23.00	-0.03	-2.49	16.71

SAM NO	H#	3H CPM	14C CPM	WIDE CPM	3H DPM	14C DPM	LUMEX %
213	80.9	10.00	7.00	24.00	-1.37	-4.11	1.89
214	84.8	23.00	11.00	43.00	23.07	1.16	2.72
215	84.3	25.00	7.00	48.00	29.04	-4.27	2.01
216	86.7	25.00	10.00	45.00	28.02	-0.21	3.04
217	82.1	15.00	9.00	33.00	7.65	-1.46	3.74
218	78.6	24.00	9.00	37.00	24.86	-1.59	2.90
219	86.3	26.00	14.00	49.00	27.91	5.19	2.07
220	89.7	26.00	12.00	44.00	29.72	2.51	19.85
221	83.2	15.00	5.00	24.00	9.82	-6.85	3.19
222	83.9	16.00	6.00	29.00	11.40	-5.51	3.50
223	86.4	16.00	5.00	30.00	12.27	-6.86	3.38
224	88.5	24.00	10.00	47.00	26.37	-0.18	3.09
225	88.1	22.00	8.00	39.00	23.23	-2.87	1.98
226	85.1	15.00	12.00	35.00	6.47	2.61	3.78
227	80.4	13.00	9.00	31.00	3.51	-1.45	8.25
228	127.9	14.00	7.00	27.00	13.62	-3.95	17.22
229	87.0	21.00	12.00	49.00	18.91	2.55	3.51
230	85.3	27.00	10.00	43.00	31.75	-0.24	1.99
231	83.3	52.00	10.00	64.00	81.27	-0.55	2.35
232	86.5	17.00	3.00	28.00	15.35	-9.57	5.36
233	88.2	18.00	6.00	32.00	16.11	-5.52	4.98
234	85.2	23.00	11.00	45.00	23.15	1.16	2.29
235	88.2	19.00	5.00	28.00	18.68	-6.89	5.42
236	102.8	25.00	9.00	42.00	32.52	-1.48	10.67
237	82.3	18.00	7.00	34.00	14.66	-4.20	4.86
238	83.8	17.00	7.00	33.00	12.89	-4.18	3.31
239	108.8	29.00	17.00	64.00	38.62	9.45	4.02
240	84.2	21.00	7.00	34.00	20.97	-4.22	3.07
241	83.7	13.00	5.00	25.00	5.87	-6.83	3.22
242	85.2	29.00	12.00	54.00	34.75	2.44	1.80
243	80.5	28.00	6.00	43.00	34.62	-5.67	2.05
244	87.8	19.00	7.00	37.00	17.56	-4.19	1.17
245	84.4	23.00	14.00	52.00	21.45	5.21	2.54
246	87.8	18.00	8.00	37.00	14.99	-2.82	1.67
247	136.3	25.00	8.00	49.00	44.58	-2.71	19.01
248	82.4	22.00	10.00	42.00	21.12	-0.20	0.83
249	82.2	24.00	9.00	41.00	25.57	-1.57	2.87
250	90.2	16.00	6.00	31.00	12.30	-5.49	9.21
251	89.1	18.00	8.00	33.00	15.21	-2.81	6.75
252	89.0	22.00	9.00	45.00	22.89	-1.51	2.73
253	92.3	31.00	9.00	48.00	42.41	-1.61	2.89
254	87.4	15.00	9.00	33.00	8.30	-1.43	1.55
255	87.5	19.00	7.00	39.00	17.52	-4.19	2.19
256	84.9	33.00	9.00	53.00	44.28	-1.66	1.72
257	86.9	17.00	11.00	42.00	11.27	1.24	3.55
258	83.0	24.00	6.00	45.00	27.26	-5.61	2.05
259	85.1	20.00	14.00	39.00	15.53	5.25	2.32
260	84.0	27.00	8.00	44.00	32.47	-2.95	1.79
261	85.0	21.00	6.00	37.00	21.63	-5.57	2.92
262	84.5	25.00	11.00	46.00	27.04	1.13	2.26
263	85.3	22.00	11.00	39.00	21.14	1.17	2.58
264	83.1	23.00	12.00	43.00	22.23	2.50	3.80
265	98.8	21.00	11.00	43.00	21.70	1.28	3.47
266	88.4	28.00	8.00	46.00	35.61	-2.94	6.26
267	88.6	15.00	13.00	37.00	6.34	3.99	3.31
268	100.4	28.00	7.00	49.00	39.57	-4.25	3.03
269	85.4	25.00	17.00	48.00	24.15	9.24	2.27
270	88.1	14.00	9.00	33.00	6.33	-1.42	2.52

SAM NO	H#	3H CPM	14C CPM	WIDE CPM	3H DPM	14C DPM	LUMEX %
271	89.3	24.00	11.00	44.00	26.03	1.18	3.31
272	87.9	14.00	5.00	30.00	8.40	-6.83	3.14
273	85.6	22.00	8.00	37.00	22.75	-2.88	4.27
274	85.5	24.00	10.00	42.00	25.75	-0.20	2.33
275	85.7	18.00	14.00	41.00	11.58	5.28	2.26
276	87.1	18.00	7.00	32.00	15.41	-4.18	3.04
277	86.0	34.00	12.00	53.00	45.08	2.38	1.70
278	120.4	23.00	16.00	49.00	28.49	8.29	46.39
279	101.1	19.00	3.00	32.00	22.31	-9.58	5.60
280	91.9	15.00	5.00	30.00	11.01	-6.83	6.24
281	89.4	25.00	6.00	40.00	30.75	-5.61	2.98
282	88.3	27.00	4.00	36.00	35.62	-8.34	5.11
283	88.6	25.00	10.00	47.00	28.44	-0.20	2.70
284	85.9	26.00	13.00	52.00	28.32	3.83	3.17
285	86.5	24.00	7.00	40.00	27.50	-4.25	2.70
286	89.2	22.00	8.00	40.00	23.46	-2.86	2.89
287	91.2	11.00	14.00	36.00	-2.21	5.42	3.51
288	89.0	24.00	13.00	51.00	24.92	3.88	2.14
289	97.7	13.00	7.00	31.00	6.46	-4.07	7.60
290	98.6	19.00	16.00	43.00	14.53	8.11	8.25
291	89.2	21.00	6.00	32.00	22.46	-5.56	4.07
292	92.0	18.00	4.00	27.00	17.83	-8.22	5.47
293	84.5	19.00	13.00	42.00	13.94	3.90	3.25
294	85.1	16.00	9.00	39.00	10.02	-1.46	4.63
295	88.7	19.00	5.00	29.00	18.76	-6.89	11.29
296	88.0	16.00	10.00	35.00	9.89	-0.09	4.04
297	84.0	26.00	4.00	37.00	32.51	-8.33	8.33
298	122.6	16.00	7.00	30.00	17.57	-4.00	7.91
299	84.8	31.00	5.00	45.00	42.27	-7.04	4.82
300	80.1	22.00	8.00	37.00	21.70	-2.90	2.15
301	104.2	19.00	15.00	45.00	16.07	6.80	3.49
302	88.2	20.00	12.00	43.00	17.06	2.57	13.01
303	110.4	11.00	5.00	22.00	4.77	-6.73	8.32
304	94.4	16.00	16.00	41.00	7.51	8.10	4.87
305	87.5	27.00	8.00	45.00	33.32	-2.93	8.75
306	92.3	22.00	12.00	39.00	21.95	2.58	3.16
307	90.0	13.00	22.00	47.00	-2.39	16.21	2.11
308	114.3	25.00	10.00	42.00	35.28	-0.05	18.92
309	84.6	23.00	6.00	37.00	25.59	-5.60	2.32
310	88.7	24.00	6.00	42.00	28.52	-5.60	4.94
311	88.8	25.00	7.00	39.00	30.06	-4.26	4.38
312	83.2	24.00	10.00	37.00	25.27	-0.22	2.84
313	88.8	20.00	9.00	42.00	18.75	-1.49	6.19
314	86.6	25.00	4.00	38.00	31.10	-8.32	8.20
315	89.2	23.00	8.00	42.00	25.52	-2.88	3.52
316	102.8	15.00	5.00	29.00	12.69	-6.80	7.48
317	98.7	21.00	9.00	42.00	22.79	-1.45	8.79
318	86.0	23.00	10.00	46.00	23.82	-0.19	1.84
319	122.6	18.00	11.00	36.00	19.93	1.49	11.81
320	97.0	23.00	14.00	46.00	23.96	5.32	3.09
321	91.6	24.00	7.00	45.00	28.67	-4.23	7.60
322	88.0	22.00	11.00	42.00	21.66	1.19	3.23
323	104.9	16.00	10.00	40.00	12.38	0.02	2.62
324	89.6	12.00	13.00	29.00	0.27	4.03	7.52
325	91.3	10.00	12.00	36.00	-3.21	2.72	5.21
326	90.9	28.00	12.00	52.00	34.15	2.49	5.14
327	96.2	25.00	7.00	42.00	31.91	-4.23	4.43
328	100.7	22.00	15.00	42.00	22.02	6.73	7.80

SAM NO	H#	3H CPM	14C CPM	WIDE CPM	3H DPM	14C DPM	LUMEX %
29	94.1	22.00	14.00	41.00	21.23	5.30	3.43
330	96.3	21.00	13.00	40.00	20.08	3.98	1.88
331	86.4	16.00	5.00	28.00	12.27	-6.86	3.08
332	84.7	21.00	9.00	41.00	20.04	-1.52	2.91
333	82.4	20.00	11.00	39.00	16.64	1.18	3.77
334	86.4	15.00	8.00	33.00	8.69	-2.79	4.61
335	91.0	27.00	10.00	49.00	33.16	-0.21	2.12
336	85.1	24.00	10.00	44.00	25.65	-0.20	3.77
337	87.8	17.00	10.00	35.00	11.91	-0.10	1.82
338	85.9	11.00	11.00	32.00	-1.03	1.31	3.60
339	83.1	22.00	6.00	35.00	23.28	-5.59	5.06
340	84.5	24.00	8.00	43.00	26.56	-2.91	1.96
341	81.5	19.00	7.00	34.00	16.52	-4.21	1.63
342	85.7	21.00	19.00	48.00	15.07	12.00	1.44
343	88.7	22.00	15.00	49.00	19.68	6.61	2.54
344	87.5	26.00	10.00	50.00	30.24	-0.21	5.92
345	87.8	19.00	12.00	40.00	14.96	2.58	4.47
346	109.6	23.00	13.00	51.00	27.46	4.06	12.04
347	88.2	15.00	6.00	28.00	9.96	-5.49	4.50
348	94.1	17.00	11.00	37.00	12.31	1.30	5.73
349	83.8	25.00	6.00	41.00	29.43	-5.62	3.16
350	87.8	23.00	10.00	35.00	24.18	-0.18	3.32
351	90.2	21.00	9.00	41.00	21.06	-1.49	7.59
352	87.9	15.00	11.00	35.00	7.32	1.28	2.65
353	84.6	14.00	10.00	32.00	5.42	-0.09	2.35
354	89.1	24.00	12.00	48.00	25.45	2.53	6.09
355	88.7	21.00	4.00	32.00	23.40	-8.27	4.07
356	87.8	28.00	8.00	43.00	35.46	-2.94	1.80
357	85.3	12.00	9.00	30.00	1.97	-1.41	3.12
358	96.9	23.00	11.00	42.00	25.58	1.24	4.37
359	88.5	17.00	12.00	39.00	10.96	2.61	1.97
360	88.7	24.00	9.00	42.00	26.94	-1.54	3.53
361	88.6	28.00	13.00	50.00	33.03	3.83	4.15
362	90.3	24.00	13.00	50.00	25.17	3.89	2.11
363	88.2	22.00	3.00	34.00	25.88	-9.63	4.12
364	101.1	18.00	7.00	38.00	17.85	-4.12	4.15
365	93.5	23.00	13.00	44.00	23.75	3.93	12.86
366	89.6	19.00	10.00	33.00	16.30	-0.12	9.94
367	93.4	31.00	14.00	58.00	40.02	5.18	2.80
368	91.0	33.00	9.00	50.00	46.15	-1.64	2.80

ID: EQUIPMENT SURVY 29 NOV 2000 16:41
 USER: 1 COMMENT: EQUIPMENT SURVEY
 RESET TIME : 1.00
 DATA CALC : DL DPM H# : YES SAMPLE REPEATS: 1 PRINTER : EDIT
 COUNT BLANK : YES IC# : NO REPLICATES : 1 RS232 : EDIT
 TWO PHASE : NO AGC : YES CYCLE REPEATS : 1
 SCINTILLATOR: LIQUID LUMEX: YES LOW SAMPLE REJ: 0
 LOW LEVEL : NO HALF LIFE CORRECTION DATE: none

ISOTOPE 1: 3H %ERROR: 2.00 FACTOR: 1.0000 BKG. SUB: 0
 ISOTOPE 2: 14C %ERROR: 2.00 FACTOR: 1.0000 BKG. SUB: 0
 WIDE OPEN WINDOW %ERROR: 0.00 FACTOR: 1.0000 BKG. SUB: 0

BACKGROUND QUENCH CURVE: Off COLOR QUENCH CORRECTION: Off
 Quench Limits Low: 13.688 High: 306.34

SAM NO	H#	3H CPM	14C CPM	WIDE CPM	3H DPM	14C DPM	LUMEX %
B1	126.5	15.00	10.00	37.00	35.23	13.43	6.77
		Blank Average DPM for		3H :	35.23	COEF. OF VAR: 0.000	
		Blank Average DPM for		14C :	13.43	COEF. OF VAR: 0.000	

369	123.5	13.00	11.00	31.00	-6.89	1.40	11.66
370	117.9	14.00	5.00	33.00	-1.27	-6.88	14.53
371	120.7	11.00	15.00	34.00	-15.50	6.92	5.62
372	124.6	9.00	10.00	29.00	-17.12	0.13	13.49
373	124.3	15.00	14.00	38.00	-3.26	5.49	11.74
374	121.1	10.00	11.00	32.00	-15.47	1.45	8.67
375	121.4	15.00	13.00	39.00	-3.17	4.09	6.35
376	123.2	16.00	10.00	38.00	2.01	-0.04	8.38
377	123.2	11.00	7.00	25.00	-9.72	-4.05	15.38
378	120.5	17.00	14.00	34.00	1.38	5.41	15.62
379	126.6	15.00	11.00	41.00	-0.67	1.38	11.24
380	126.7	14.00	13.00	38.00	-4.87	4.16	7.94
381	125.8	17.00	10.00	37.00	5.44	-0.05	10.78

1 DEC 2000 09:00

IDA EQUIPMENT SURVY

USER: 1 COMMENT: EQUIPMENT SURVEY

PRESET TIME : 1.00
 DATA CALC : DL DPM H# : YES SAMPLE REPEATS: 1 PRINTER : EDIT
 JUNT BLANK : YES IC# : NO REPLICATES : 1 RS232 : EDIT
 TWO PHASE : NO AQC : YES CYCLE REPEATS : 1
 SCINTILLATOR: LIQUID LUMEX: YES LOW SAMPLE REJ: 0
 LOW LEVEL : NO HALF LIFE CORRECTION DATE: none

ISOTOPE 1: 3H %ERROR: 2.00 FACTOR: 1.0000 BKG. SUB: 0
 ISOTOPE 2: 14C %ERROR: 2.00 FACTOR: 1.0000 BKG. SUB: 0
 WIDE OPEN WINDOW %ERROR: 0.00 FACTOR: 1.0000 BKG. SUB: 0

BACKGROUND QUENCH CURVE: Off COLOR QUENCH CORRECTION: Off

Quench Limits Low: 13.688 High: 306.34

SAM NO	H#	3H CPM	14C CPM	WIDE CPM	3H DPM	14C DPM	LUMEX %
B1	90.2	14.00	10.00	33.00	26.20	13.23	0.54
		Blank Average DPM for		3H :	26.20	COEF. OF VAR: 0.000	
		Blank Average DPM for		14C :	13.23	COEF. OF VAR: 0.000	
382	84.8	16.00	15.00	42.00	1.03	6.65	0.82