

## Radiological Survey Sheet

Job Location LAB 118C/C.313 Page 1 of 30  
 Survey Purpose LAB CLOSE OUT Date 11-20-00  
 Performed By E. X. GAILOR <sup>EP</sup> (Print) E. X. Gailor (Sign)

Inst.(1) (Model/SN) Beckman LS 6500 #7069448	Inst.(2) <u>Wellm 2241-2</u> (Model/SN) # 163603	Inst.(3) (Model/SN)
Det. Internal (Model/SN)	Det. <u>Wellm 43-6E</u> (Model/SN) # 149613	Det. (Model/SN)
Eff See LSC Printout	Eff. = 8%	Eff.
Type rad. $\beta$	Type rad. $\beta$	Type rad.
Bkgd. See LSC Printout	Bkgd. <u>300cpm</u>	Bkgd.
Cal. Due: 12/00	Cal. Due <u>2/13/01</u>	Cal. due

No.	Time	Location	Inst. Used	Total Activity (dpm/100 cm <sup>2</sup> )
1.	0800	door & HNDL	1	See attached LSC Printout
2.	↑	FLOOR	1	
3.		UPPER WALL	1	
4.		LOWER "	1	
5.		CAB. doors & HNDLS	1	
6.		TOP SHELF	1	
7.		2ND "	1	
8.		3RD "	1	
9.		BOTTOM "	1	
10.		CAB. doors & HNDLS	1	
11.		TOP SHELF	1	
12.		MIDDLE "	1	
13.		BOTTOM "	1	
14.		SHELF	1	
15.		WHITE TRAY	1	
16.		wall below SHELF	1	
17.		PEG BOARD & TRAY	1	
18.	✓	TOP SHELF	1	↓

Radiological Survey Continuation Sheet

Page 2 of 30

Date 11-20-00

No.	Time	Location	Inst. Used	Total Activity (dpm/100 cm <sup>2</sup> )
19	0800	2ND SHELF	1	See attached LSC Printout
20	↑	3RD "	1	
21		4TH "	1	
22		BOTTOM LEFT "	1	
23		TOP SHELF	1	
24		2ND "	1	
25		3RD "	1	
26		BOTTOM RIGHT "	1	
27		UPPER WALL	1	
28		LOWER "	1	
29		FLOOR	1	
30		FLOOR	1	
31		STOOL	1	
32		WALL	1	
33		"	1	
34		"	1	
35		"	1	
36		COUNTER	1	
37		"	1	
38		CUP	1	
39		BEHIND SINK	1	
40		INSIDE "	1	
41		SINK LEDGE	1	
42		SINK FACETS HANDLS	1	
43		COUNTER	1	
44		"	1	
45		"	1	
46	↓	CAB. DOORS & HANDLS	1	↓

Radiological Survey Continuation Sheet

Page 3 of 30

Date 11-20-60

No.	Time	Location	Inst. Used	Total Activity (dpm/100 cm <sup>2</sup> )
47	0800	TOP DRAWER	1	See attached LSC Printout
48	✓	2ND "	1	
49		3RD "	1	
50		BOTTOM "	1	
51		DRAWER & HND	1	
52		DRAWER	1	
53		TRAY UNDER COUNTER	1	
54		FLOOR " "	1	
55		PLASTIC CONTAINER UNDER COUNTER	1	
56		DRAWERS & HANDLS	1	
57		TOP DRAWER	1	
58	✓	2ND "	1	
59		3RD "	1	
60		BOTTOM "	1	
61		CAB. DOORS & HANDLS	1	
62		BACK OF CAB.	1	
63		LEFT SIDE OF CAB.	1	
64		RIGHT " " "	1	
65		BOTTOM OF CAB.	1	
66		WHITE TRAY IN CAB.	1	
67	✓	TOP DRAWER & HANDL	1	
68		TOP DRAWER	1	
69		CAB. DOORS & HANDLS	1	
70		BACK OF CAB.	1	
71		TOP SHELF	1	
72		BOTTOM "	1	
73		YELLOW TRAY # 1	1	
74	✓	" " # 2	1	✓

Radiological Survey Continuation Sheet

Page 4 of 30

Date 11-20-00

No.	Time	Location	Inst. Used	Total Activity (dpm/100 cm <sup>2</sup> )
75	0800	FLOOR UNDER COUNTER	1	See attached LSC Printout
76	↑	PLASTIC TRAY IN TOP DRAWER	1	
77		EP 2ND TOP DRAWER	1	
78		2ND EP 3RD " "	1	
79		3RD BOTTOM DRAWER	1	
80		BOTTOM DRAWER	1	
81		DRAWERS & HANDLS	1	
82		FLOOR	1	
83		" "	1	
84		" "	1	
85		" "	1	
86		CAB DOORS & HANDLS	1	
87		TOP SHELF	1	
88		2ND " "	1	
89		3RD " "	1	
90		4TH " "	1	
91		BOTTOM " "	1	
92		DESK	1	
93		DESK	1	
94		OUTSIDE FILING CAB.	1	
95		FLOOR	1	
96		TOP SHELF	1	
97		MIDDLE " "	1	
98		BOTTOM " "	1	
99		TABLE TOP	1	
100		SMALL DRAWERS & HANDLS	1	
101		LEFT TOP SMALL DRAWER	1	
102	↓	" BOTTOM " "	1	↓

Radiological Survey Continuation Sheet

Page 5 of 30

Date 11-2000

No.	Time	Location	Inst. Used	Total Activity (dpm/100 cm <sup>2</sup> )
103	0800	RIGHT TOP SMALL DRAWER	1	See attached LSC Printout
104	↑	" BOTTOM " "	1	
105		LARGE DRAWERS & HANDLS	1	
106		LARGE TOP DRAWER	1	
107		" BOTTOM "	1	
108		DRAWER & HANDL	1	
109		DRAWER	1	
110		DRAWER <sup>RES</sup> & HANDL	1	
111		DRAWER	1	
112		FLOOR	1	
113		UPPER WALL	1	
114		LOWER "	1	
115		WALL	1	
116		"	1	
117		"	1	
118		UPPER WALL	1	
119		LOWER "	1	
120		UPPER "	1	
121		LOWER "	1	
122		INSIDE GLASS	1	
123		INSIDE "	1	
124		FLOOR	1	
125		"	1	
126		"	1	
127		"	1	
128		CHAIR	1	
129		STOOL	1	
130	√	STOOR	1	↓

Radiological Survey Continuation Sheet

Page 6 of 30

Date 11-20-00

No.	Time	Location	Inst. Used	Total Activity (dpm/100 cm <sup>2</sup> )
131	0800	WHITE TRAY	1	See attached LSC Printout
132	↑	UPPER WALL	1	
133		LOWER "	1	
134		UPPER "	1	
135		LOWER "	1	
136		FLOOR	1	
137		WHITE DRAWER	1	
138		COUNTER	1	
139		ED COUNTER SHELF	1	
140		SHELF	1	
141		SHELF	1	
142		COUNTER	1	
143		WHITE PLASTIC CONTAINER	1	
144		CAB. DOORS & HANDLS	1	
145		TOP SHELF	1	
146		2ND "	1	
147		3RD "	1	
148		BOTTOM "	1	
149		CAB. DOORS & HANDLS	1	
150		TOP SHELF	1	
151		2ND "	1	
152		3RD "	1	
153		BOTTOM "	1	
154		TOP SHELF	1	
155		2ND "	1	
156		BOTTOM "	1	
157		DESK	1	
158	✓	DRAWER & HANDLS	1	✓

Radiological Survey Continuation Sheet

Page 7 of 30

Date 11/26/00

No.	Time	Location	Inst. Used	Total Activity (dpm/100 cm <sup>2</sup> )
159	0800	TOP DRAWER	1	See attached LSC Printout
160	↑	MIDDLE "	1	
161		BOTTOM "	1	
162		DRAWER & HNDL	1	
163		DRAWER	1	
164		TOP SHELF	1	
165		MIDDLE "	1	
166		BOTTOM SHELF	1	
167		CUP	1	
168		TOP SHELF	1	
169		MIDDLE "	1	
170		BOTTOM "	1	
171		CUP	1	
172		COUNTER	1	
173		"	1	
174		"	1	
175		"	1	
176		TOP DRAWER	1	
177		2ND "	1	
178		3RD "	1	
179		BOTTOM "	1	
180		DRAWER & HNDL	1	
181		DRAWER	1	
182		FLOOR UNDE R COUNTER	1	
183		DRAWERS & HNDLS	1	
184		TOP DRAWER	1	
185		2ND "	1	
186	√	3RD "	1	√

Radiological Survey Continuation Sheet

Page 8 of 30

Date 11-20-00

No.	Time	Location	Inst. Used	Total Activity (dpm/100 cm <sup>2</sup> )
187	0800	BOTTOM DRAWER	1	See attached LSC Printout
188	↑	FLOOR UNDER COUNTER	1	
189		WHITE PLASTIC CONTAINER	1	
190		TOP DRAWER & HANDLE	1	
191		" "	1	
192		CAB. DOORS & HANDLES	1	
193		TOP SHELF	1	
194		BOTTOM SHELF	1	
195		BACK OF CAB.	1	
196		LEFT SIDE OF CAB.	1	
197		RIGHT " " "	1	
198		FLOOR	1	
199		"	1	
200		"	1	✓ (See # 495)
201		"	1	
202		COUNTER	1	
203		"	1	
204		"	1	
205		TOP SHELF	1	
206		MIDDLE "	1	
207		BOTTOM "	1	
208		COUNTER	1	
209		WALL	1	
210		DESK	1	
211		CAB. DRAWERS & HANDLES	1	
212		TOP DRAWER	1	
213		2ND DRAWER	1	
214	✓	PLASTIC HOLDER	1	↓



Radiological Survey Continuation Sheet

Page 9 of 30

Date 11-20-00

No.	Time	Location	Inst. Used	Total Activity (dpm/100 cm <sup>2</sup> )
215	0800	PLASTIC HOLDER	1	See attached LSC Printout
216	✓	3RD DRAWER	1	
217		BOTTOM "	1	
218		DRAWER & HNDL	1	
219		DRAWER	1	
220		FLOOR UNDER COUNTER	1	
221		SHELF 1	1	
222		" 2	1	
223		" 3	1	
224		" 4	1	
225		DOORS & HNDLS	1	
226		PLASTIC TRAY IN TOP DRAWER	1	
227		TOP DRAWER	1	
228		2ND "	1	
229		3RD "	1	
230		BOTTOM "	1	
231		FLOOR UNDER COUNTER	1	
232		DRAWERS & HNDLS	1	
233		CAB. <sup>ES</sup> DOORS & HNDLS <sup>TOP</sup> DRAWER	1	
234		2ND DRAWER	1	
235		3RD DRAWER	1	
236		BOTTOM DRAWER	1	
237		DRAWER & HNDL	1	
238		DRAWER	1	
239		DRAWERS & HNDLS	1	
240		TOP DRAWER	1	
241		MIDDLE "	1	
242	✓	BOTTOM "	1	

Radiological Survey Continuation Sheet

Page 10 of 30

Date 11-20-00

No.	Time	Location	Inst. Used	Total Activity (dpm/100 cm <sup>2</sup> )
243	0800	CAB. DOORS & HANDLS	1	See attached LSC Printout
244	Λ	TOP SHELF	1	
245		2ND "	1	
246		3RD "	1	
247		BOTTOM "	1	
248		CAB. DOORS & HANDLS	1	
249		TOP SHELF	1	
250		2ND "	1	
251		3RD "	1	
252		BOTTOM "	1	
253		WALL	1	
254		"	1	
255		TOP SHELF	1	
256		BOTTOM "	1	
257		DRAWERS & HANDLS	1	
258		TOP <del>TRAY</del> DRAWER	1	
259		MIDDLE "	1	
260		BOTTOM "	1	
261		DRAWER & HANDL	1	
262		TRAY IN DRAWER	1	
263		DRAWER	1	
264		TOP SHELF	1	
265		MIDDLE "	1	
266		BOTTOM "	1	
267		DESK	1	
268		TOP SHELF OF RACK	1	
269		2ND "	1	
270	✓	3RD "	1	↓

Radiological Survey Continuation Sheet

Page 11 of 30

Date 11-20-00

No.	Time	Location	Inst. Used	Total Activity (dpm/100 cm <sup>2</sup> )
271	0800	4TH SHELF	1	See attached LSC Printout
272	11	5TH "	1	
273		BOTTOM "	1	
274		TOP SHELF	1	
275		MIDDLE "	1	
276		BOTTOM "	1	
277		CUP	1	
278		TOP SHELF	1	
279		MIDDLE "	1	
280		BOTTOM "	1	
281		CUP	1	
282		COUNTER	1	
283		"	1	
284		"	1	
285		"	1	
286		DRAWERS & HANDLS	1	
287		TOP DRAWER	1	
288		PLASTIC TRAY IN 2ND DRAWER	1	
289		2ND <sup>RD</sup> DRAWER	1	
290		3RD "	1	
291		BOTTOM "	1	
292		DRAWER & HANDL	1	
293		DRAWER	1	
294		PLASTIC CONTAINER UNDER COUNTER	1	
295		FLOOR " "	1	(See # 296)
296		DRAWERS & HANDLS	1	
297		PLASTIC TRAY IN TOP DRAWER	1	
298	✓	TOP DRAWER	1	✓

Radiological Survey Continuation Sheet

Page 12 of 30

Date 11-20-60

No.	Time	Location	Inst. Used	Total Activity (dpm/100 cm <sup>2</sup> )
299	0800	2ND DRAWER	1	See attached LSC Printout
300	^	3RD "	1	
301		BOTTOM "	1	
302		COUNTER	1	
303		COUNTER	1	
304		COUNTER	1	
305		FLOOR	1	
306		"	1	
307		"	1	
308		" UNDER COUNTER	1	
309		FLOOR	1	
310		"	1	
311		"	1	
312		CHAIR	1	
313		DRAWER & HANDLS	1	
314		TOP DRAWER	1	
315		2ND "	1	
316		3RD "	1	
317		BOTTOM "	1	
318		DRAW & HANDL	1	
319		DRAWER	1	
320		FLOOR UNDER COUNTER	1	
321		COUNTER	1	
322		"	1	
323		"	1	
324		"	1	
325		DRAWERS & HANDLS	1	
326	↓	TOP DRAWER	1	↓

Radiological Survey Continuation Sheet

Page 13 of 30

Date 11-20-00

No.	Time	Location	Inst. Used	Total Activity (dpm/100 cm <sup>2</sup> )
327	0800	2nd DRAWER	1	See attached LSC Printout
328	↑	3rd "	1	
329		BOTTOM "	1	
330		DRAWERS & HANDLS	1	
331		TRAY IN TOP DRAWER	1	
332		TOP DRAWER	1	
333		2nd "	1	
334		3rd "	1	
335		BOTTOM "	1	
336		TOP SHELF	1	
337		MIDDLE "	1	
338		BOTTOM "	1	
339		COUNTER	1	
340		DESK	1	
341		DRAWER & HANDL	1	
342		DRAWER	1	
343		DRAWERS & HANDLS	1	
344		TOP DRAWER	1	
345		MIDDLE "	1	
346		BOTTOM "	1	
347		DOORS & HANDLS	1	
348		TOP SHELF	1	
349		2nd "	1	
350		3rd "	1	
351		BOTTOM "	1	
352		DOORS & HANDLS	1	
353		TOP SHELF	1	
354	↓	2nd "	1	↓

Radiological Survey Continuation Sheet

Page 14 of 30

Date 11-20-06

No.	Time	Location	Inst. Used	Total Activity (dpm/100 cm <sup>2</sup> )
355	0800	A 3RD SHELF	1	See attached LSC Printout
356		BOTTOM "	1	
357		WALL Below CABS.	1	
358		LEDGE	1	
359		LOWER WALL	1	
360		UPPER WALL	1	
361		LOWER "	1	
362		OUTSIDE PLASTIC CONTAINER #1	1	
363		INSIDE " " "	1	
364		OUTSIDE #1 " " #2	1	
365		INSIDE " " "	1	
366		DESK TOP	1	
367		CHAIR	1	
368		"	1	
369		PC #1 OF PLEXIGLASS	1	
370		PC #2 "	1	
371		LEAD PC 1 FRONT	1	
372		" " " BACK	1	
373		" " 2 FRONT	1	
374		" " " BACK	1	
375		" " 3 FRONT	1	
376		" " 3 BACK	1	
377		" " 4 FRONT	1	
378		" " 4 BACK	1	
379		INSIDE PLEXIGLASS CONT.	1	
380		OUTSIDE " " "	1	
381		HOOD UPPER LEFT VENT	1	
382		" " RIGHT VENT	1	

Radiological Survey Continuation Sheet

Page 15 of 30

Date 1/20-00

No.	Time	Location	Inst. Used	Total Activity (dpm/100 cm <sup>2</sup> )
383	0800	HOOD UPPER LEFT SECTION	1	See attached LSC Printout
384	↑	" " RIGHT "	1	
385		HOOD LOWER LEFT VENT	1	
386		" " RIGH "	1	
387		" LOWER BACK LEFT SECTION	1	
388		" " " RIGHT SECTION	1	
389		HOOD LEFT SIDE	1	
390		" RIGHT "	1	
391		HOOD BOTTOM LEFT	1	
392		" " RIGHT	1	
393		LSC RACKS 1-4	1	
394		LSC RACKS 5-7	1	
395		INSIDE BETA SHIELD	1	
396		OUTSIDE " "	1	
397		PINK RACK	1	
398		BLUE "	1	
399		SCISSORS	1	
400		PLASTIC HOLDER	1	
401		CUTTER (SQUEEZE)	1	
402		RAZOR BLADE CUTTER	1	
403		PLASTIC CUP	1	
404		PC 3683	1	
405		INSIDE PLASTIC BOTTLE	1	
406		OUTSIDE " "	1	
407		BOX OF GLOVES	1	
408		CUP IN HOOD	1	
409		RAD TRAY IN HOOD	1	
410	✓	CAB. DOORS & HANDLS	1	↓

Radiological Survey Continuation Sheet

Page 16 of 30

Date 11-20-00

No.	Time	Location	Inst. Used	Total Activity (dpm/100 cm <sup>2</sup> )
411	0820	BACK OF CAB.	1	See attached LSC Printout
412	↖	LEFTSIDE " "	1	
413		RIGHT " " "	1	
414		PLASTIC TRAY	1	
414		BOTTOM OF CAB.	1	
416		FRONT PC #5 LEAD	1	
417		BACK " " "	1	
418		INSIDE JUG #1	1	
419		OUTSIDE " #1	1	
420		INSIDE <del>EXE</del> 32 JUG	1	
421		OUTSIDE P32 JUG	1	
422		PLASTIC BLOCK	1	
423		INSIDE ROUND PLASTIC CONT.	1	
424		OUTSIDE " " "	1	
425		INSIDE I 125 JUG	1	
426		OUTSIDE I " "	1	
427		INSIDE PLASTIC BOX	1	
428		OUTSIDE " "	1	
429		OUTSIDE BAG OF WHITE SNAPS	1	
430		INSIDE " " " "	1	
431		CAB. doors & HANDLS	1	
432		BACK OF CAB	1	
433		LEFT SIDE OF CAB.	1	
434		RIGHT " " "	1	
435		TRAY IN "	1	
436		BOTTOM OF CAB.	1	
437		INSIDE #1 I 125 BOTTLE	1	
438	↙	OUTSIDE #1 I " "	1	



Radiological Survey Continuation Sheet

Page 17 of 30

Date 11-20-08

No.	Time	Location	Inst. Used	Total Activity (dpm/100 cm <sup>2</sup> )
439	0800	INSIDE #2 I 125 BOTTLE	1	See attached LSC Printout
440	↑	OUTSIDE #2 I 125 "	1	
441		INSIDE P32 BOTTLE	1	
442		OUTSIDE P32 "	1	
443		INSIDE #3 BOTTLE	1	✓ Admission
444		OUTSIDE #3 "	1	
445		HAIF OF PIG	1	
446		INSIDE GLASS FLASK	1	
447		OUTSIDE " "	1	
448		INSIDE SAFETY CAN	1	
449		OUTSIDE " "	1	
450		FLOOR	1	
451		"	1	
452		"	1	
453		SIDE OF HOOD	1	WV
454		UPPER WALL	1	
455		UPPER "	1	
456		WALL BELOW COUNTER	1	
457		" " "	1	
458		TOP SHELF	1	
459		BOTTOM "	1	
460		TOP "	1	
461		BOTTOM "	1	
462		PLASTIC TRAY	1	
463		INSIDE PLASTIC BUCKET	1	
464		OUTSIDE " "	1	
465		FLOOR UNDER COUNTER	1	
466	✓	METAL PC1	1	↓

Radiological Survey Continuation Sheet

Page 18 of 30

Date 11-20-00

No.	Time	Location	Inst. Used	Total Activity (dpm/100 cm <sup>2</sup> )
467	0800	METAL PC 2	1	See attached LSC Printout
468	↑	" " 3	1	
469		" " 4	1	
470		" " 5	1	
471		" " 6	1	
472		COUNTER	1	
473		"	1	
474		WHITE PLASTIC PC	1	
475		DRAWERS & HANDLS	1	
476		TOP DRAWER	1	
477		2ND "	1	
478		3RD "	1	
479		BOTTOM "	1	
480		BOARD WITH GAUGE 3 <sup>rd</sup> DRAWER	1	
481		METAL PC'S 3 <sup>rd</sup> DRAWER	1	
482		PLASTIC " " "	1	
483		FLOOR	1	
484		FLOOR	1	
485		UPPER WALL	1	
486		lower "	1	
487		STOOL	1	
488		MISC PC'S IN TOP DRAWER	1	
489		" " " "	1	
490		" " " "	1	
491		" " " "	1	
492		" " " "	1	
493		" " " "	1	
494	↓	" " " "	1	



O = wipe location

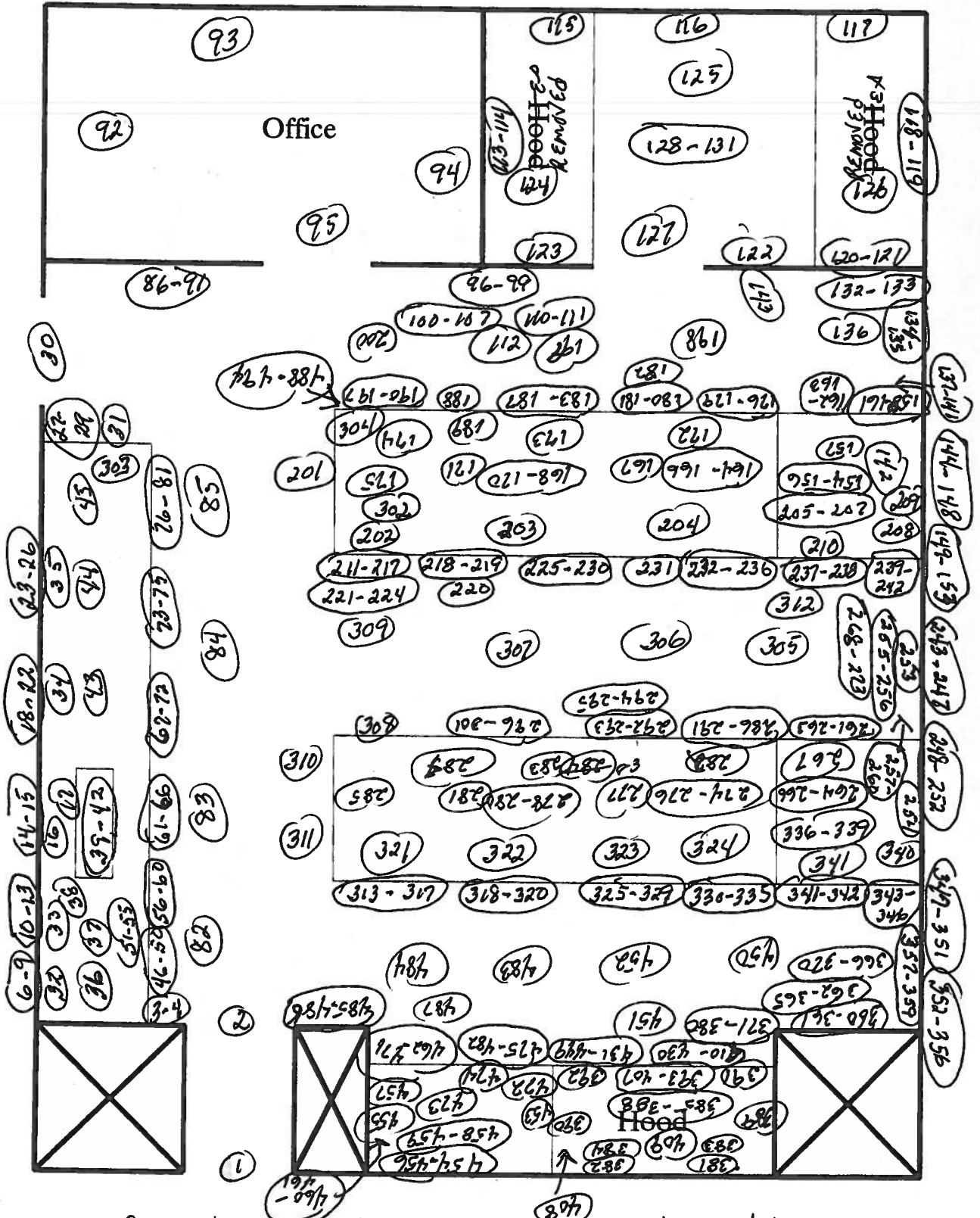

Surveyed 100% of all lower surfaces using instrument #2. All areas were noted to be at a level of normal background.

ID: EQUIPMENT SURVY

20 NOV 2000 10:01

USER: 1 COMMENT:  
 RESET TIME : 1.00  
 DATA CALC : DL DPM H# :YES SAMPLE REPEATS: 1 PRINTER :EDIT  
 COUNT BLANK : YES IC# : NO REPLICATES : 1 RS232 :EDIT  
 TWO PHASE : NO AQC :YES CYCLE REPEATS : 1  
 SCINTILLATOR: LIQUID LUMEX:YES LOW SAMPLE REJ: 0  
 LOW LEVEL : NO HALF LIFE CORRECTION DATE: none

ISOTOPE 1: 3H %ERROR: 2.00 FACTOR: 1.000000 BKG. SUB: 0  
 ISOTOPE 2: 14C %ERROR: 2.00 FACTOR: 1.000000 BKG. SUB: 0  
 WIDE OPEN WINDOW %ERROR: 0.00 FACTOR: 1.000000 BKG. SUB: 0

BACKGROUND QUENCH CURVE: Off COLOR QUENCH CORRECTION: Off

Quench Limits Low: 2.756 High:314.54

SAM NO	H#	3H CPM	14C CPM	WIDE CPM	3H DPM	14C DPM	LUMEX %
B1	73.7	19.00	9.00	39.00	32.00	11.87	5.40
1	73.0	19.00	7.00	36.00	0.86	-2.69	6.64
2	76.0	19.00	9.00	36.00	0.33	0.01	6.62
3	78.3	25.00	8.00	38.00	12.89	-1.39	4.95
4	80.1	27.00	9.00	46.00	16.70	-0.06	9.50
5	76.5	25.00	13.00	44.00	10.07	5.32	4.13
6	77.6	26.00	14.00	51.00	11.74	6.67	15.88
7	76.3	18.00	7.00	39.00	-0.58	-2.66	6.29
8	76.8	19.00	9.00	47.00	0.45	0.02	7.52
9	82.5	26.00	14.00	49.00	12.73	6.71	10.49
10	77.9	21.00	16.00	45.00	1.06	9.42	9.71
11	77.2	23.00	11.00	40.00	7.30	2.66	5.13
12	77.9	22.00	14.00	47.00	3.99	6.72	3.85
13	77.2	28.00	4.00	41.00	20.45	-6.81	4.38
14	89.8	21.00	14.00	45.00	3.98	6.84	14.11
15	77.2	31.00	8.00	45.00	24.32	-1.47	57.95
16	78.1	15.00	4.00	27.00	-4.70	-6.66	10.18
17	83.4	30.00	4.00	46.00	26.00	-6.83	6.36
18	77.6	31.00	8.00	44.00	24.42	-1.46	10.68
19	79.0	29.00	11.00	58.00	19.38	2.60	75.57
20	80.0	10.00	7.00	29.00	-15.80	-2.55	9.77
21	79.9	21.00	11.00	41.00	3.85	2.71	4.48
22	81.5	22.00	8.00	42.00	7.61	-1.34	10.09
23	82.3	25.00	9.00	46.00	13.22	-0.02	29.88
24	79.1	25.00	11.00	41.00	11.55	2.65	21.21
25	80.0	47.00	7.00	62.00	57.04	-2.99	18.55
26	82.5	20.00	12.00	47.00	1.78	4.08	26.50
27	81.4	24.00	13.00	50.00	9.04	5.38	3.77
28	79.9	24.00	13.00	46.00	8.75	5.36	5.94
29	98.8	32.00	9.00	46.00	32.27	-0.03	47.75
30	76.4	21.00	8.00	40.00	4.75	-1.35	4.30
31	77.9	14.00	11.00	31.00	-10.12	2.77	11.89
32	77.3	17.00	11.00	39.00	-4.35	2.73	8.54
33	76.0	32.00	8.00	54.00	25.95	-1.48	3.73
34	79.9	14.00	17.00	38.00	-12.92	10.87	7.30
35	76.1	33.00	9.00	56.00	27.41	-0.15	2.28
36	78.4	9.00	8.00	26.00	-18.36	-1.20	11.99
37	79.9	31.00	13.00	52.00	22.52	5.28	5.26
38	82.8	25.00	6.00	38.00	14.85	-4.07	12.82

SAM NO	H#	3H CPM	14C CPM	WIDE CPM	3H DPM	14C DPM	LUMEX %
39	79.4	24.00	14.00	46.00	8.16	6.71	35.28
40	81.5	16.00	11.00	35.00	-5.81	2.78	2.20
41	78.7	17.00	8.00	36.00	-2.69	-1.30	4.71
42	78.2	16.00	14.00	39.00	-7.67	6.79	4.06
43	82.0	19.00	7.00	33.00	2.24	-2.65	5.28
44	75.8	25.00	7.00	44.00	12.85	-2.75	6.58
45	129.5	22.00	5.00	37.00	21.73	-5.29	60.99
46	78.6	25.00	11.00	45.00	11.47	2.65	11.93
47	76.6	26.00	17.00	54.00	10.07	10.69	3.83
48	87.5	18.00	14.00	42.00	-2.54	6.85	3.47
49	79.7	25.00	10.00	42.00	12.19	1.31	5.87
50	83.0	20.00	9.00	35.00	3.38	0.04	35.62
51	79.1	23.00	12.00	44.00	7.15	4.02	3.78
52	80.5	23.00	9.00	44.00	8.90	-0.01	18.46
53	94.0	28.00	17.00	59.00	17.88	10.86	45.81
54	86.8	0.00	0.00	3.00	-32.00	-11.87	100.00
55	77.7	35.00	13.00	58.00	29.77	5.22	4.23
56	79.7	16.00	7.00	31.00	-4.03	-2.63	6.93
57	78.5	25.00	8.00	46.00	12.92	-1.39	10.23
58	78.1	16.00	10.00	37.00	-5.71	1.41	5.44
59	80.2	18.00	9.00	38.00	-1.01	0.05	5.27
60	81.6	20.00	8.00	36.00	3.65	-1.32	25.36
61	75.0	22.00	11.00	37.00	4.99	2.66	6.28
62	75.6	29.00	11.00	55.00	18.60	2.58	2.49
63	73.0	20.00	7.00	37.00	2.77	-2.70	1.64
64	79.1	18.00	9.00	41.00	-1.18	0.04	2.27
65	84.5	22.00	7.00	36.00	8.68	-2.68	27.29
66	96.9	22.00	11.00	46.00	9.08	2.81	4.69
67	76.7	19.00	17.00	43.00	-3.48	10.78	4.92
68	84.1	15.00	14.00	41.00	-9.03	6.86	15.32
69	81.1	30.00	5.00	40.00	24.88	-5.48	57.62
70	80.2	23.00	12.00	47.00	7.34	4.03	1.81
71	84.8	27.00	10.00	47.00	17.27	1.32	3.71
72	90.6	16.00	9.00	31.00	-3.58	0.13	6.96
73	84.6	16.00	5.00	30.00	-2.35	-5.31	7.62
74	92.4	37.00	7.00	50.00	41.71	-2.84	64.02
75	120.2	0.00	0.00	10.00	-32.00	-11.87	99.90
76	84.6	22.00	10.00	40.00	7.16	1.37	3.44
77	85.4	29.00	7.00	46.00	23.00	-2.76	3.95
78	86.5	19.00	12.00	37.00	0.40	4.13	5.77
79	80.7	20.00	8.00	36.00	3.50	-1.32	5.37
80	84.9	25.00	16.00	51.00	10.19	9.44	10.17
81	84.0	25.00	9.00	37.00	13.58	-0.02	3.11
82	86.1	31.00	13.00	52.00	24.15	5.33	41.61
83	85.4	18.00	11.00	38.00	-1.29	2.78	9.11
84	84.4	19.00	13.00	37.00	-0.43	5.46	4.81
85	84.3	27.00	7.00	39.00	18.70	-2.74	7.97
86	84.4	19.00	8.00	35.00	2.11	-1.29	2.97
87	78.9	20.00	9.00	38.00	2.72	0.02	2.81
88	81.7	23.00	10.00	42.00	8.63	1.35	4.37
89	83.2	26.00	10.00	43.00	14.90	1.32	5.94
90	82.1	11.00	16.00	41.00	-18.20	9.58	66.09
91	83.1	20.00	4.00	33.00	5.93	-6.71	7.03
92	84.0	27.00	12.00	50.00	16.08	4.01	2.32
93	80.4	22.00	6.00	40.00	8.41	-4.04	10.24
94	78.0	21.00	7.00	35.00	5.52	-2.69	3.86
95	82.8	23.00	11.00	39.00	8.32	2.70	9.58
96	85.8	15.00	7.00	24.00	-5.24	-2.59	53.54

SAM NO	H#	3H CPM	14C CPM	WIDE CPM	3H DPM	14C DPM	LUMEX %
7	89.4	24.00	7.00	42.00	13.80	-2.68	11.98
98	85.1	25.00	10.00	40.00	13.30	1.34	12.39
99	80.3	21.00	6.00	36.00	6.42	-4.03	11.70
100	80.8	16.00	7.00	30.00	-3.89	-2.62	3.65
101	79.9	23.00	7.00	41.00	9.78	-2.71	2.19
102	84.7	25.00	8.00	39.00	14.25	-1.36	2.67
103	83.1	22.00	13.00	41.00	5.37	5.41	12.05
104	81.3	20.00	11.00	40.00	2.10	2.73	2.39
105	81.0	15.00	8.00	33.00	-6.33	-1.26	5.50
106	84.0	33.00	7.00	48.00	30.67	-2.81	79.44
107	107.6	30.00	14.00	50.00	27.93	6.87	79.42
108	81.3	22.00	9.00	42.00	7.06	0.01	3.37
109	81.0	19.00	9.00	36.00	1.08	0.04	6.81
110	83.0	13.00	8.00	27.00	-10.09	-1.23	4.93
111	80.6	20.00	9.00	37.00	3.00	0.03	4.72
112	83.8	29.00	9.00	48.00	21.57	-0.06	5.92
113	83.5	28.00	11.00	51.00	18.46	2.65	2.36
114	81.5	23.00	17.00	44.00	5.05	10.78	2.51
115	83.6	20.00	5.00	31.00	5.52	-5.36	4.49
116	82.2	21.00	9.00	40.00	5.24	0.02	6.37
117	83.0	22.00	6.00	39.00	8.90	-4.03	3.05
118	82.8	25.00	14.00	51.00	10.79	6.72	4.71
119	81.3	26.00	9.00	50.00	15.00	-0.04	29.32
120	81.1	18.00	8.00	40.00	-0.39	-1.30	2.12
121	81.0	12.00	10.00	37.00	-13.27	1.47	3.12
122	81.0	18.00	11.00	37.00	-1.90	2.75	5.86
123	84.0	31.00	11.00	51.00	24.61	2.61	7.37
124	91.4	26.00	7.00	40.00	18.40	-2.70	63.07
125	89.5	20.00	17.00	43.00	0.29	10.91	8.28
126	87.8	18.00	6.00	31.00	1.69	-3.97	36.41
127	88.4	18.00	6.00	34.00	1.77	-3.97	18.76
128	87.5	38.00	7.00	51.00	41.95	-2.86	60.55
129	83.3	15.00	4.00	29.00	-4.02	-6.65	6.25
130	90.2	27.00	5.00	40.00	21.24	-5.43	48.95
131	142.9	18.00	18.00	47.00	5.66	13.00	19.58
132	81.5	21.00	12.00	42.00	3.61	4.06	11.06
133	87.7	24.00	9.00	40.00	12.36	0.02	12.63
134	82.0	18.00	10.00	36.00	-1.26	1.41	3.47
135	85.4	11.00	12.00	29.00	-15.94	4.21	9.88
136	110.8	12.00	10.00	35.00	-10.24	1.67	36.20
137	85.1	19.00	9.00	35.00	1.72	0.06	14.72
138	89.0	25.00	11.00	47.00	13.65	2.72	21.70
139	101.7	25.00	12.00	43.00	16.16	4.16	23.15
140	91.0	41.00	10.00	62.00	47.88	1.18	50.79
141	109.8	21.00	10.00	41.00	10.36	1.54	89.43
142	101.7	48.00	15.00	70.00	65.03	7.95	90.98
143	83.0	27.00	6.00	40.00	18.88	-4.09	7.34
144	82.6	22.00	13.00	48.00	5.28	5.41	7.55
145	88.2	18.00	14.00	39.00	-2.44	6.86	3.76
146	87.8	28.00	12.00	49.00	19.01	4.03	10.18
147	86.6	21.00	8.00	37.00	6.54	-1.31	15.63
148	90.1	23.00	6.00	34.00	12.41	-4.02	26.80
149	87.5	14.00	9.00	32.00	-8.10	0.14	6.06
150	86.6	26.00	8.00	43.00	16.70	-1.37	43.03
151	75.9	17.00	8.00	31.00	-3.06	-1.31	17.29
152	76.7	27.00	11.00	43.00	14.97	2.61	8.54
153	78.0	28.00	6.00	42.00	19.67	-4.12	33.10
154	82.4	37.00	2.00	51.00	40.48	-9.41	80.79

SAM NO	H#	3H CPM	14C CPM	WIDE CPM	3H DPM	14C DPM	LUMEX %
155	81.3	19.00	13.00	41.00	-0.89	5.43	63.27
156	81.5	3.00	15.00	25.00	-33.59	8.32	81.29
157	92.8	26.00	4.00	47.00	20.37	-6.77	64.31
158	80.5	19.00	10.00	42.00	0.50	1.39	2.74
159	75.1	19.00	8.00	31.00	0.69	-1.34	2.61
160	77.1	20.00	10.00	38.00	1.95	1.35	2.58
161	80.5	30.00	12.00	50.00	21.22	3.95	3.21
162	75.5	29.00	16.00	48.00	16.15	9.30	2.01
163	78.1	25.00	9.00	40.00	12.35	-0.05	3.91
164	126.1	3.00	8.00	24.00	-29.72	-0.84	73.05
165	76.6	33.00	6.00	47.00	29.02	-4.18	3.95
166	79.8	12.00	10.00	28.00	-13.38	1.46	6.02
167	91.6	20.00	14.00	42.00	2.22	6.86	34.18
168	86.3	29.00	12.00	50.00	20.65	4.00	39.34
169	79.7	16.00	7.00	26.00	-4.02	-2.63	11.54
170	78.2	21.00	12.00	37.00	3.08	4.04	21.42
171	99.1	34.00	8.00	53.00	37.25	-1.42	17.55
172	82.6	15.00	12.00	32.00	-8.17	4.14	24.01
173	77.6	19.00	12.00	35.00	-0.91	4.06	4.04
174	99.1	26.00	9.00	41.00	19.34	0.05	44.55
175	94.6	22.00	13.00	43.00	7.52	5.51	30.52
176	80.8	21.00	6.00	41.00	6.50	-4.03	5.45
177	75.9	37.00	7.00	53.00	36.07	-2.89	4.86
178	78.6	22.00	6.00	36.00	8.06	-4.05	5.38
179	79.0	29.00	11.00	53.00	19.38	2.60	10.78
180	81.7	15.00	9.00	31.00	-6.76	0.09	21.35
181	79.1	22.00	11.00	43.00	5.68	2.69	3.66
182	80.4	29.00	10.00	48.00	20.20	1.27	3.72
183	78.7	16.00	11.00	38.00	-6.13	2.76	3.25
184	79.0	16.00	8.00	36.00	-4.61	-1.28	3.33
185	81.1	25.00	12.00	45.00	11.47	4.01	4.31
186	76.4	16.00	11.00	36.00	-6.39	2.74	5.12
187	82.5	21.00	2.00	31.00	8.84	-9.42	8.38
188	114.8	8.00	11.00	27.00	-19.84	3.13	97.01
189	81.4	30.00	8.00	43.00	23.44	-1.44	26.85
190	78.7	18.00	7.00	37.00	-0.23	-2.65	7.27
191	85.3	29.00	10.00	49.00	21.44	1.29	5.83
192	82.0	19.00	9.00	43.00	1.24	0.05	2.79
193	82.6	17.00	12.00	34.00	-4.18	4.12	5.28
194	78.9	22.00	13.00	42.00	4.66	5.38	2.51
195	79.4	35.00	7.00	46.00	33.23	-2.85	3.99
196	79.5	27.00	15.00	49.00	13.59	8.02	5.64
197	78.4	23.00	13.00	39.00	6.52	5.36	2.71
198	81.9	23.00	8.00	42.00	9.66	-1.35	5.67
199	80.0	30.00	9.00	46.00	22.57	-0.10	10.75
200	85.8	63.00	11.00	95.00	89.88	2.24	91.30
201	83.9	30.00	10.00	54.00	23.08	1.27	17.33
202	84.7	23.00	7.00	40.00	10.73	-2.69	32.60
203	75.8	29.00	8.00	48.00	20.10	-1.45	7.17
204	77.4	18.00	13.00	47.00	-3.38	5.41	10.83
205	82.3	4.00	8.00	17.00	-28.08	-1.12	98.45
206	77.7	25.00	9.00	44.00	12.27	-0.05	14.08
207	78.4	25.00	2.00	39.00	15.86	-9.47	24.46
208	84.2	39.00	11.00	61.00	40.74	2.52	71.04
209	76.6	23.00	9.00	45.00	8.17	-0.03	9.44
210	78.9	31.00	10.00	49.00	23.77	1.23	65.30
211	78.3	14.00	11.00	39.00	-10.08	2.78	16.89
212	80.0	4.00	7.00	18.00	-27.47	-2.51	88.54



SAM NO	H#	3H CPM	14C CPM	WIDE CPM	3H DPM	14C DPM	LUMEX %
213	78.6	28.00	9.00	45.00	18.32	-0.08	4.38
214	78.4	21.00	14.00	45.00	2.12	6.73	14.35
215	81.7	35.00	9.00	63.00	32.95	-0.15	7.86
216	83.2	17.00	11.00	39.00	-3.60	2.78	8.50
217	83.4	22.00	14.00	43.00	4.91	6.77	21.20
218	75.3	23.00	8.00	46.00	8.42	-1.38	5.11
219	76.3	26.00	6.00	44.00	15.39	-4.10	9.21
220	86.8	15.00	10.00	36.00	-6.66	1.47	38.17
221	86.5	19.00	10.00	43.00	1.43	1.42	6.14
222	83.3	40.00	13.00	59.00	41.41	5.20	46.15
223	101.5	46.00	7.00	60.00	65.10	-2.93	57.48
224	84.7	6.00	11.00	28.00	-25.55	2.92	66.91
225	75.3	21.00	11.00	41.00	3.11	2.67	7.83
226	76.5	30.00	7.00	44.00	22.69	-2.80	19.64
227	79.6	21.00	8.00	39.00	5.30	-1.34	22.26
228	80.2	26.00	10.00	43.00	14.26	1.30	7.36
229	75.8	24.00	5.00	34.00	11.90	-5.42	5.19
230	85.6	19.00	14.00	41.00	-0.77	6.82	74.06
231	94.1	58.00	11.00	75.00	84.51	2.33	74.01
232	78.6	21.00	17.00	50.00	0.67	10.77	19.33
233	95.1	2.00	4.00	17.00	-29.93	-6.46	81.19
234	104.6	24.00	13.00	47.00	14.12	5.56	6.32
235	84.0	18.00	11.00	39.00	-1.48	2.77	4.71
236	87.2	0.00	0.00	10.00	-32.00	-11.87	95.80
237	78.6	18.00	20.00	48.00	-6.68	14.85	3.96
238	80.6	25.00	14.00	45.00	10.36	6.71	22.23
239	80.7	33.00	6.00	52.00	30.18	-4.17	30.90
240	79.1	34.00	12.00	59.00	28.72	3.89	11.31
241	86.8	41.00	10.00	53.00	46.23	1.16	72.23
242	89.4	23.00	8.00	39.00	11.21	-1.32	93.47
243	83.2	17.00	8.00	38.00	-2.07	-1.27	2.95
244	83.5	19.00	8.00	37.00	1.97	-1.30	13.43
245	80.3	19.00	11.00	37.00	-0.02	2.73	74.59
246	79.0	28.00	8.00	41.00	18.90	-1.42	21.57
247	84.5	20.00	6.00	40.00	5.16	-4.00	57.17
248	81.6	11.00	10.00	36.00	-15.21	1.49	40.22
249	91.5	14.00	9.00	28.00	-7.62	0.16	41.79
250	87.6	21.00	8.00	42.00	6.73	-1.30	20.35
251	77.0	26.00	13.00	46.00	12.12	5.32	4.37
252	85.8	25.00	9.00	48.00	13.97	-0.01	29.92
253	82.4	26.00	12.00	49.00	13.73	4.01	12.33
254	79.0	24.00	9.00	48.00	10.57	-0.03	2.62
255	79.7	22.00	10.00	38.00	6.28	1.34	58.78
256	83.7	21.00	14.00	45.00	2.96	6.78	11.71
257	78.2	25.00	8.00	42.00	12.87	-1.39	15.84
258	76.1	24.00	7.00	40.00	10.99	-2.73	79.63
259	78.3	33.00	10.00	55.00	27.52	1.21	9.20
260	80.2	15.00	7.00	39.00	-5.94	-2.61	4.59
261	79.3	24.00	8.00	48.00	11.13	-1.37	4.13
262	80.6	18.00	9.00	37.00	-0.96	0.05	15.07
263	79.5	29.00	10.00	51.00	20.01	1.26	1.83
264	82.6	43.00	9.00	64.00	49.16	-0.24	87.96
265	85.1	31.00	7.00	45.00	26.96	-2.78	89.68
266	80.5	23.00	13.00	44.00	6.89	5.38	65.15
267	82.8	23.00	10.00	37.00	8.83	1.35	30.27
268	91.4	22.00	10.00	41.00	8.49	1.42	47.94
269	87.6	21.00	9.00	40.00	6.21	0.05	11.37
270	87.8	31.00	8.00	54.00	28.48	-0.04	42.24

SAM NO	H#	3H CPM	14C CPM	WIDE CPM	3H DPM	14C DPM	LUMEX %
271	92.8	44.00	6.00	57.00	57.08	-4.28	39.81
272	86.6	22.00	10.00	43.00	7.54	1.39	24.08
273	95.9	27.00	13.00	49.00	18.44	5.46	41.40
274	86.4	51.00	12.00	74.00	65.36	3.74	85.21
275	87.0	31.00	3.00	39.00	29.58	-8.19	80.31
276	79.7	34.00	10.00	53.00	29.87	1.20	16.52
277	95.0	14.00	11.00	35.00	-8.28	2.90	70.42
278	93.7	29.00	10.00	52.00	23.71	1.34	62.16
279	89.3	10.00	6.00	27.00	-14.55	-3.87	23.63
280	83.3	23.00	12.00	40.00	7.92	4.05	8.70
281	99.0	33.00	7.00	50.00	35.60	-2.77	57.47
282	83.7	26.00	13.00	45.00	13.48	5.37	13.93
283	88.0	18.00	8.00	36.00	0.67	-1.26	21.85
284	83.8	28.00	16.00	57.00	16.00	9.40	30.56
285	91.5	22.00	11.00	45.00	7.96	2.77	9.26
286	82.0	17.00	9.00	47.00	-2.75	0.07	3.92
287	84.3	19.00	8.00	41.00	2.10	-1.29	6.49
288	88.5	16.00	8.00	32.00	-3.36	-1.24	7.74
289	86.5	22.00	12.00	43.00	6.49	4.09	12.62
290	81.3	25.00	7.00	53.00	14.02	-2.73	5.56
291	80.3	23.00	13.00	44.00	6.85	5.38	4.14
292	80.9	22.00	10.00	40.00	6.49	1.35	5.49
293	78.6	24.00	12.00	44.00	9.02	4.01	3.25
294	88.3	16.00	8.00	35.00	-3.38	-1.24	13.87
295	87.4	65.00	9.00	85.00	95.97	-0.49	93.60
296	92.3	29.00	8.00	44.00	24.39	-1.38	62.18
297	82.2	22.00	8.00	42.00	7.74	-1.34	6.25
298	83.0	28.00	2.00	47.00	22.91	-9.50	3.27
299	81.0	33.00	6.00	49.00	30.27	-4.17	74.11
300	82.2	20.00	7.00	36.00	4.27	-2.66	2.87
301	90.3	19.00	8.00	34.00	3.11	-1.26	11.51
302	87.0	59.00	10.00	76.00	83.00	0.94	71.06
303	92.3	20.00	9.00	42.00	5.03	0.09	13.74
304	112.7	19.00	4.00	28.00	10.04	-6.65	20.77
305	86.3	31.00	10.00	48.00	25.74	1.28	40.98
306	83.0	27.00	4.00	40.00	19.91	-6.79	22.78
307	83.4	24.00	9.00	38.00	11.45	-0.01	4.73
308	91.9	20.00	12.00	43.00	3.34	4.16	97.96
309	85.2	51.00	11.00	75.00	65.32	2.38	75.89
310	109.0	33.00	10.00	55.00	37.65	1.37	62.72
311	93.7	26.00	6.00	43.00	19.54	-4.05	25.00
312	82.9	26.00	15.00	53.00	12.31	8.06	35.12
313	82.6	30.00	8.00	53.00	23.76	-1.43	3.28
314	85.5	20.00	7.00	37.00	4.83	-2.65	3.62
315	82.0	17.00	12.00	40.00	-4.25	4.12	5.77
316	82.9	19.00	18.00	47.00	-3.19	12.19	4.96
317	83.5	21.00	6.00	39.00	7.00	-4.02	4.11
318	84.4	25.00	13.00	52.00	11.63	5.39	2.85
319	85.2	22.00	12.00	41.00	6.25	4.08	6.31
320	99.1	20.00	9.00	33.00	6.35	0.13	60.41
321	80.8	26.00	9.00	49.00	14.89	-0.04	7.09
322	82.0	23.00	5.00	48.00	11.19	-5.40	10.09
323	80.6	31.00	12.00	54.00	23.21	3.94	17.58
324	81.3	17.00	12.00	36.00	-4.35	4.11	12.45
325	86.2	38.00	11.00	61.00	39.41	2.54	3.68
326	82.3	27.00	6.00	45.00	18.73	-4.09	4.60
327	82.4	20.00	7.00	35.00	4.29	-2.66	7.77
328	83.8	22.00	10.00	42.00	7.01	1.37	4.40

SAM NO	H#	3H CPM	14C CPM	WIDE CPM	3H DPM	14C DPM	LUMEX %
329	85.9	18.00	13.00	43.00	-2.24	5.48	24.38
330	80.2	19.00	12.00	43.00	-0.54	4.08	8.11
331	83.0	15.00	7.00	29.00	-5.59	-2.60	5.73
332	84.6	26.00	20.00	53.00	10.10	14.83	7.93
333	78.3	13.00	11.00	28.00	-12.04	2.79	10.77
334	87.5	22.00	17.00	58.00	4.08	10.86	26.42
335	83.9	23.00	9.00	46.00	9.56	0.01	9.29
336	90.0	25.00	4.00	37.00	17.58	-6.76	88.76
337	85.6	29.00	11.00	42.00	21.00	2.65	23.87
338	83.7	24.00	11.00	45.00	10.50	2.69	82.71
339	83.3	35.00	13.00	55.00	31.41	5.26	4.31
340	85.9	26.00	9.00	47.00	16.03	-0.02	58.49
341	84.9	22.00	13.00	53.00	5.68	5.43	3.73
342	86.4	30.00	7.00	40.00	25.30	-2.77	25.58
343	90.1	21.00	8.00	40.00	7.22	-1.29	4.75
344	91.1	19.00	6.00	35.00	4.31	-3.97	33.17
345	84.7	22.00	11.00	44.00	6.68	2.73	5.87
346	82.9	16.00	9.00	39.00	-4.62	0.09	4.11
347	90.0	25.00	11.00	45.00	13.88	2.72	11.09
348	90.9	22.00	9.00	38.00	8.92	0.06	6.85
349	84.3	19.00	11.00	36.00	0.57	2.76	50.46
350	87.1	10.00	5.00	18.00	-14.22	-5.23	29.44
351	77.0	26.00	13.00	50.00	12.10	5.32	10.41
352	74.0	16.00	10.00	34.00	-6.18	1.38	8.17
353	78.0	24.00	7.00	38.00	11.37	-2.73	4.26
354	78.0	22.00	11.00	41.00	5.49	2.68	3.73
355	82.1	27.00	11.00	43.00	16.15	2.65	11.33
356	77.7	22.00	14.00	48.00	3.97	6.72	3.29
357	76.2	15.00	8.00	41.00	-6.89	-1.28	7.70
358	81.2	20.00	11.00	37.00	2.08	2.73	7.78
359	80.4	24.00	7.00	43.00	11.86	-2.72	6.82
360	80.6	14.00	12.00	38.00	-10.35	4.14	3.68
361	79.4	23.00	12.00	44.00	7.21	4.03	5.82
362	83.7	23.00	14.00	43.00	6.97	6.76	12.54
363	76.5	20.00	6.00	41.00	3.82	-4.03	7.27
364	80.0	18.00	10.00	41.00	-1.54	1.39	10.48
365	81.3	14.00	13.00	41.00	-10.79	5.49	3.77
366	79.8	17.00	11.00	32.00	-4.04	2.75	4.67
367	80.7	28.00	9.00	43.00	18.82	-0.07	8.39
368	80.9	23.00	12.00	51.00	7.47	4.04	31.68
369	86.3	20.00	9.00	33.00	3.94	0.06	7.68
370	78.1	17.00	15.00	42.00	-6.22	8.12	57.37
371	87.9	17.00	12.00	36.00	-3.48	4.16	8.94
372	83.8	12.00	10.00	34.00	-13.03	1.49	8.17
373	76.3	17.00	8.00	29.00	-3.00	-1.31	12.88
374	86.8	19.00	14.00	43.00	-0.60	6.83	14.43
375	74.7	26.00	11.00	44.00	12.62	2.61	3.29
376	81.5	16.00	13.00	38.00	-6.80	5.47	3.11
377	81.4	17.00	7.00	35.00	-1.81	-2.63	11.69
378	77.8	35.00	6.00	44.00	33.24	-4.20	4.76
379	78.7	23.00	10.00	40.00	8.06	1.33	3.02
380	83.4	20.00	10.00	41.00	2.94	1.39	39.96
381	114.1	20.00	13.00	44.00	7.20	5.70	31.75
382	109.2	19.00	11.00	42.00	5.03	2.93	24.12
383	81.6	26.00	7.00	36.00	16.06	-2.74	6.22
384	85.0	24.00	13.00	41.00	9.74	5.41	5.58
385	90.5	23.00	17.00	50.00	6.68	10.88	4.80
386	85.7	18.00	12.00	45.00	4.00	4.10	7.51

SAM NO	H#	3H CPM	14C CPM	WIDE CPM	3H DPM	14C DPM	LUMEX %
387	84.2	23.00	14.00	48.00	7.06	6.76	14.40
388	87.0	18.00	11.00	35.00	-1.05	2.79	24.07
389	78.5	13.00	14.00	31.00	-13.50	6.83	12.06
390	85.7	16.00	9.00	36.00	-4.25	0.10	3.89
391	84.6	14.00	9.00	29.00	-8.43	0.12	6.67
392	79.6	28.00	5.00	46.00	20.54	-5.46	4.72
393	84.5	13.00	8.00	31.00	-9.94	-1.22	10.29
394	78.5	18.00	16.00	40.00	-4.71	9.46	5.42
395	77.5	16.00	12.00	38.00	-6.75	4.09	4.37
396	85.8	21.00	9.00	45.00	5.88	0.04	17.81
397	89.5	22.00	8.00	40.00	9.15	-1.30	8.41
398	86.7	14.00	10.00	28.00	-8.70	1.48	35.77
399	113.9	16.00	8.00	36.00	0.80	-1.11	1.91
400	89.6	13.00	8.00	23.00	-9.39	-1.19	36.64
401	100.4	19.00	5.00	29.00	6.68	-5.30	4.49
402	96.8	23.00	9.00	39.00	12.32	0.08	4.45
403	84.3	25.00	8.00	38.00	14.17	-1.36	3.84
404	85.3	21.00	8.00	41.00	6.31	-1.31	4.32
405	88.8	29.00	7.00	48.00	23.93	-2.75	3.19
406	83.2	22.00	13.00	42.00	5.38	5.41	2.83
407	98.5	23.00	10.00	38.00	12.14	1.44	2.37
408	93.4	30.00	12.00	56.00	24.65	4.04	56.77
409	86.6	19.00	10.00	31.00	1.44	1.42	49.20
410	80.7	14.00	12.00	33.00	-10.35	4.14	3.13
411	93.6	7.00	8.00	20.00	-21.57	-1.10	3.79
412	81.7	21.00	16.00	48.00	1.62	9.46	3.20
413	83.2	12.00	9.00	29.00	-12.57	0.14	4.16
414	92.3	18.00	12.00	35.00	-0.78	4.18	2.66
415	89.7	14.00	15.00	46.00	-11.01	8.28	3.11
416	85.1	15.00	7.00	33.00	-5.33	-2.59	5.58
417	84.1	13.00	14.00	29.00	-13.04	6.88	8.63
418	91.3	21.00	8.00	38.00	7.44	-1.28	4.13
419	89.5	14.00	11.00	38.00	-8.92	2.86	6.17
420	87.3	20.00	17.00	45.00	-0.04	10.88	2.46
421	91.2	18.00	9.00	38.00	0.65	0.11	4.79
422	89.6	22.00	6.00	36.00	10.24	-4.01	6.41
423	86.5	24.00	10.00	47.00	11.59	1.36	3.66
424	85.5	23.00	7.00	35.00	10.89	-2.69	4.12
425	85.6	22.00	13.00	42.00	5.81	5.43	3.05
426	86.9	18.00	12.00	38.00	-1.58	4.14	1.44
427	82.2	20.00	11.00	36.00	2.24	2.73	5.72
428	85.4	22.00	6.00	38.00	9.37	-4.03	7.71
429	89.4	14.00	5.00	29.00	-5.78	-5.27	8.98
430	86.2	21.00	9.00	38.00	5.96	0.04	3.17
431	85.1	21.00	8.00	33.00	6.27	-1.31	4.48
432	86.0	17.00	10.00	36.00	-2.70	1.44	5.98
433	82.1	22.00	8.00	32.00	7.72	-1.34	5.99
434	87.7	17.00	13.00	40.00	-4.02	5.51	3.47
435	96.0	21.00	15.00	42.00	4.57	8.25	5.26
436	114.3	13.00	8.00	26.00	-6.21	-1.07	18.77
437	85.5	23.00	7.00	43.00	10.90	-2.69	3.40
438	90.9	14.00	13.00	37.00	-9.83	5.58	7.89
439	91.4	14.00	7.00	28.00	-6.57	-2.55	6.51
440	85.6	15.00	7.00	28.00	-5.26	-2.59	6.51
441	86.9	18.00	23.00	53.00	-7.29	19.02	3.90
442	92.7	20.00	16.00	43.00	1.33	9.59	2.20
443	87.5	58.00	13.00	82.00	79.65	5.01	2.56
444	87.3	20.00	11.00	38.00	4.07	2.04	13.41

SAM NO	H#	3H CPM	14C CPM	WIDE CPM	3H DPM	14C DPM	LUMEX %
445	91.5	12.00	10.00	28.00	-12.33	1.54	12.40
446	86.1	16.00	10.00	35.00	-4.72	1.46	3.28
447	85.5	22.00	9.00	39.00	7.86	0.03	13.24
448	90.5	15.00	13.00	41.00	-7.80	5.56	6.12
449	96.6	21.00	10.00	43.00	7.42	1.46	7.90
450	89.4	17.00	2.00	30.00	1.99	-9.37	10.39
451	94.5	15.00	7.00	33.00	-4.06	-2.55	7.22
452	90.9	15.00	16.00	39.00	-9.34	9.63	2.52
453	81.6	15.00	8.00	33.00	-6.26	-1.26	7.34
454	88.4	15.00	9.00	29.00	-5.95	0.13	8.47
455	83.8	24.00	12.00	46.00	10.01	4.05	4.81
456	87.7	14.00	14.00	40.00	-10.68	6.90	2.77
457	88.2	19.00	10.00	36.00	1.71	1.43	3.76
458	92.2	26.00	10.00	47.00	17.02	1.37	17.13
459	94.1	19.00	7.00	32.00	4.32	-2.60	14.92
460	89.0	17.00	12.00	37.00	-3.32	4.17	19.74
461	90.4	13.00	10.00	31.00	-10.36	1.52	49.75
462	89.0	7.00	4.00	16.00	-19.70	-6.54	71.31
463	84.1	22.00	8.00	36.00	8.10	-1.33	15.34
464	86.7	14.00	10.00	35.00	-8.70	1.48	8.40
465	101.4	0.00	13.00	27.00	-39.37	5.85	74.14
466	87.0	19.00	7.00	31.00	3.07	-2.63	4.50
467	72.9	15.00	16.00	42.00	-11.08	9.44	2.11
468	84.6	20.00	14.00	41.00	1.09	6.80	3.05
469	72.8	24.00	15.00	48.00	6.53	7.99	1.24
470	86.3	13.00	14.00	34.00	-12.85	6.90	3.57
471	90.3	27.00	15.00	54.00	15.97	8.12	20.62
472	85.5	24.00	13.00	45.00	9.85	5.41	28.47
473	85.6	14.00	7.00	24.00	-7.28	-2.58	6.93
474	91.7	23.00	13.00	44.00	9.04	5.47	17.75
475	84.5	17.00	11.00	35.00	-3.42	2.78	13.34
476	89.1	18.00	13.00	36.00	-1.79	5.51	9.33
477	91.8	24.00	14.00	49.00	10.60	6.82	3.43
478	89.0	16.00	9.00	34.00	-3.80	0.12	6.82
479	86.3	21.00	5.00	35.00	8.05	-5.36	4.60
480	80.2	30.00	13.00	51.00	20.65	5.30	3.79
481	88.1	12.00	10.00	32.00	-12.65	1.52	4.59
482	89.1	19.00	7.00	38.00	3.43	-2.62	5.17
483	91.1	18.00	9.00	32.00	0.65	0.11	8.77
484	91.0	19.00	13.00	43.00	0.57	5.52	24.79
485	84.0	23.00	11.00	42.00	8.55	2.71	3.89
486	87.7	16.00	12.00	39.00	-5.55	4.17	6.04
487	82.7	16.00	12.00	39.00	-6.16	4.13	2.66
488	90.2	27.00	13.00	46.00	17.01	5.41	5.69
489	86.8	14.00	9.00	28.00	-8.18	0.13	4.43
490	87.0	23.00	8.00	47.00	10.70	-1.33	3.66
491	84.7	20.00	10.00	42.00	3.15	1.40	3.90
492	92.7	17.00	13.00	42.00	-3.34	5.56	4.39
493	91.4	20.00	15.00	44.00	1.66	8.22	3.47
494	84.9	18.00	12.00	42.00	-1.86	4.13	4.11

ID: EQUIPMENT SURVY 22 NOV 2000 15:25  
 USER: 3 COMMENT: EQUIPMENT SURVEY  
 PRESET TIME : 1.00  
 IDA CALC : DL DPM H# : YES SAMPLE REPEATS: 1 PRINTER : EDIT  
 COUNT BLANK : YES IC# : NO REPLICATES : 1 RS232 : EDIT  
 TWO PHASE : NO ADC : YES CYCLE REPEATS : 1  
 SCINTILLATOR: LIQUID LUMEX: YES LOW SAMPLE REJ: 0  
 LOW LEVEL : NO HALF LIFE CORRECTION DATE: none

ISOTOPE 1: 3H %ERROR: 2.00 FACTOR: 1.0000 BKG. SUB: 0  
 ISOTOPE 2: 14C %ERROR: 2.00 FACTOR: 1.0000 BKG. SUB: 0  
 WIDE OPEN WINDOW %ERROR: 0.00 FACTOR: 1.0000 BKG. SUB: 0

BACKGROUND QUENCH CURVE: Off COLOR QUENCH CORRECTION: Off

Quench Limits Low: 13.688 High: 306.34

SAM NO	H#	3H CPM	14C CPM	WIDE CPM	3H DPM	14C DPM	LUMEX %	
B1	69.0	12.00	8.00	30.00	20.57	10.47	2.42	
		Blank Average	DPM	for	3H :	20.57	COEF. OF VAR:	0.000
		Blank Average	DPM	for	14C :	10.47	COEF. OF VAR:	0.000
495	71.1	19.00	18.00	46.00	9.66	13.24	4.59	
496	72.7	21.00	8.00	39.00	19.02	-0.13	4.04	