

Radiological Survey Sheet

Job Location Pfizer Inc. Glaston CT. Page 1 of 19

Survey Purpose RADIOLOGICAL ASSESSMENT C220 Date 10/26/99

Performed By DAVID DURICE (Print)  (Sign)

Inst.(1) (Model/SN) Packard 2500 TR #405100	Inst.(2) <u>Wellm 2241-2</u> (Model/SN) <u># 163603</u>	Inst.(3) (Model/SN)
Det. Internal (Model/SN)	Det. <u>Wellm 4368</u> (Model/SN) <u># 149613</u>	Det. (Model/SN)
Eff. H-3 (27% - 47%) C-14/P-32 (78% - 83%)	Eff. <u>≈ 850 C-14</u>	Eff.
Type rad. β	Type rad. β	Type rad.
Bkgd. See #1 below	Bkgd. <u>300cpm</u>	Bkgd.
Cal. Due: 2/2000	Cal. Due <u>4/00</u>	Cal. due

No.	Time	Location	Inst. Used	Total Activity (dpm/100 cm ²)	Comments
1.	0919	BACKGROUND	1	25 cpm	
2.		Floor	1	13	
3.		Floor	1	1	
4.		Floor	1	0	
5.		Floor	1	7	
6.		Floor	1	5	
7.		Floor	1	0	
8.		Floor	1	2	
9.		Floor	1	6	
10.		Floor	1	4	
11.		Floor	1	6	
12.		"	1	7	
13.		"	1	0	
14.		"	1	5	
15.		"	1	0	
16.		"	1	0	
17.		"	1	5	
18.	✓	"	1	15	

Radiological Survey Continuation Sheet

Page 2 of 19

Date 10/26/99

No.	Time	Location	Inst. Used	Total Activity (dpm/100 cm ²)	Comments
19		Floor	1	0	
20		"	1	0	
21		"	1	1	
22		Floor	1	6	
23		Desk	1	0	
24		Shelves	1	10	
25		Window sill	1	4	
26		Ledge	1	0	
27		Desk	1	1	
28		Shelves	1	13	
29		Counter	1	2	
30		Cup sink	1	0	
31		Counter	1	13	
32		Cup sink	1	9089	
33		Counter	1	6	
34		Counter	1	12	
35		Counter	1	2	
36		Counter	1	0	
37		Desk	1	1	
38		Shelves	1	0	
39		Ledge	1	0	
40		Desk	1	4	
41		Counter	1	0	
42		Counter	1	24	
43		Counter	1	0	
44		Counter	1	0	
45		Counter	1	9	
46		Cup sink	1	0	

Radiological Survey Continuation Sheet

Page 3 of 19

Date 10/26/99

No.	Time	Location	Inst. Used	Total Activity (dpm/100 cm ²)	Comments
47		counter	1	0	
48		Cup sink	1	10	
49		Lower shelf	1	6	
50		upper shelves	1	0	
51		lower shelf	1	12	
52		upper shelves	1	25	
53		Desk	1	5	
54		lower shelf	1	2	
55		" "	1	11	
56		upper shelves	1	17	
57		" "	1	5	
58		counter	1	2	
59		"	1	4	
60		Cup sink	1	4	
61		counter	1	0	
62		SINK	1	0	
63		WALL	1	6	
64		"	1	0	
65		Desk	1	2	
66		WALL	1	0	
67		"	1	10	
68		"	1	0	
69		TABLE	1	4	
70		labeled incubator cart	1	0	
71		" " "	1	0	
72		Cabinet doors	1	0	
73		top shelf	1	0	
74	✓	Shelf	1	0	

Radiological Survey Continuation Sheet

Page 4 of 19

Date 10/26/99

No.	Time	Location	Inst. Used	Total Activity (dpm/100 cm ²)	Comments
75		Shelf	1	0	
76		Shelf	1	12	
77		Bottom shelf	1	1	
78		SIDE OF CABINET	1	0	
79		LEFT SIDE CONTROLS HOOD	1	5	
80		RODGE "	1	2	
81		Right SIDE controls "	1	0	
82		SASH "	1	1	
83		counter "	1	12	
84		CUP SINK "	1	16	
85		LEFT SIDE "	1	0	
86		BACK TOP "	1	0	
87		BACK BOTTOM "	1	6	
88		BACK BACK "	1	7	
89		Right SIDE "	1	0	
90		SIDE OF CABINET	1	0	
91		FRONT " "	1	5	
92		FRONT " "	1	0	
93		INSIDE CABINET	1	0	
94		" "	1	0	
95		Black rubber counter	1	9	
96		white gook	1	11	
97		Front of cabinet	1	0	
98		VACUUM FLODE	1	2	
99		Top shelf	1	0	
100		Shelf	1	0	
101		Shelf	1	11	
102	↓	Shelf	1	0	

10/26/99

Radiological Survey Continuation Sheet

Page 5 of 19

Date 10/26/99

No.	Time	Location	Inst. Used	Total Activity (dpm/100 cm ²)	Comments
103		Shelf	1	0	
104		Bottom shelf	1	5	
105		ledge	1	17	
106		upper wall	1	5	
107		Lower wall	1	0	
108		Front of cabinet	1	0	
109		Lower shelf	1	9	
110		Shelf	1	5	
111		Shelf	1	0	
112		Top Shelf	1	0	
113		Front of cabinet	1	10	
114		Bottom shelf	1	0	
115		Shelf	1	2	
116		Shelf	1	0	
117		Top Shelf	1	0	
118		Front of cabinet	1	2	
119		Top Drawer	1	0	
120		Drawer	1	12	
121		Bottom Drawer	1	10	
122		Drawer	1	0	
123		Front of cabinet	1	11	
124		Top Drawer	1	15	
125		Drawer	1	1	
126		Drawer	1	4	
127		Bottom Drawer	1	5	
128		Front of cabinets	1	13	
129		Drawer Top	1	15	
130	✓	Drawer	1	7	

Radiological Survey Continuation Sheet

Page 6 of 19

Date 10/26/99

No.	Time	Location	Inst. Used	Total Activity (dpm/100 cm ²)	Comments
131		Drawer	1	1	
132		Bottom Drawer	1	2	
133		Drawer	1	13	
134		Front of cabinets	1	13	
135		TOP Drawer	1	2	
136		Drawer	1	11	
137		Drawer	1	9	
138		Bottom Drawer	1	9	
139		side of CABINETS	1	0	
140		" " "	1	10	
141		Front of cabinet	1	10	
142		Top Drawer	1	0	
143		Drawer	1	4	
144		Drawer	1	2	
145		Bottom Drawer	1	2	
146		Drawer	1	9	
147		Front of CABINET	1	0	
148		Top Drawer	1	0	
149		Drawer	1	9	
150		Drawer	1	0	
151		Bottom Drawer	1	1	
152		Front of CABINETS	1	0	
153		INSIDE CABINET	1	5	
154		wall	1	26	
155		"	1	15	
156		Front of CABINET	1	4	
157		Bottom shelf	1	0	
158	✓	Shelf	1	5	

Radiological Survey Continuation Sheet

Page 7 of 19

Date 10/26/99

No.	Time	Location	Inst. Used	Total Activity (dpm/100 cm ²)	Comments
159		Shelf	1	12	
160		Top Shelf	1	11	
161		Front of cabinets	1	0	
162		Bottom shelf	1	7	
163		Shelf	1	0	
164		Shelf	1	2	
165		Top Shelf	1	125	✓ H-3 (See # 288)
166		Bottom Shelf	1	5	
167		Shelf	1	0	
168		top shelf	1	73	✓ H-3 (See # 289)
169		top of cold box	1	19	
170		side of "	1	11	
171		Door "	1	1	
172		Door " "	1	2	
173		side " "	1	6	
174		inside "	1	7	
175		inside "	1	5	
176		wall	1	9	
177		"	1	6	
178		front of cabinets	1	0	
179		top drawer	1	2	
180		Drawer	1	6	
181		Drawer	1	4	
182		Bottom drawer	1	1	
183		Front of cabinets	1	5	
184		Drawer	1	0	
185		inside cabinets	1	15	
186	✓	Drawer	1	7	

Radiological Survey Continuation Sheet

Page 8 of 19

Date 10/29/99

No.	Time	Location	Inst. Used	Total Activity (dpm/100 cm ²)	Comments
187		front of Drawers	1	5	
188		top Drawer	1	0	
189		Drawer	1	2	
190		Drawer	1	23	
191		Bottom Drawer	1	28	
192		Drawer	1	9	
193		front of Drawers	1	9	
194		top Drawer	1	1	
195		Drawer	1	20	
196		Drawer	1	13	
197		Bottom Drawer	1	6	
198		Drawer	1	7	
199		front of Drawers	1	0	
200		top Drawer	1	11	
201		Drawer	1	24	
202		Bottom Drawer	1	0	
203		upper wall	1	6	
204		lower wall	1	4	
205		front of Drawers	1	1	
206		top Drawer	1	0	
207		Drawer top	1	9	
208		Bottom Drawer	1	0	
209		Drawer	1	0	
210		Chair	1	0	
211		front of cabinet	1	0	
212		bottom shelf	1	0	
213		Shelf	1	11	
214	✓	Shelf	1	18	

Radiological Survey Continuation Sheet

Page 9 of 19

Date 10/26/99

No.	Time	Location	Inst. Used	Total Activity (dpm/100 cm ²)	Comments
215		top shelf	1	16	
216		front of cabinet	1	7	
217		bottom shelf	1	0	
218		shelf	1	9	
219		shelf	1	4	
220		top shelf	1	0	
221		front of cabinet	1	0	
222		bottom shelf	1	0	
223		shelf	1	0	
224		shelf	1	5	
225		top shelf	1	7	
226		front of cabinet	1	23	
227		bottom shelf	1	9	
228		shelf	1	2	
229		shelf	1	0	
230		top shelf	1	0	
231		front of cabinets	1	0	
232		top drawer	1	10	
233		drawer	1	87	
234		drawer	1	10	
235		bottom drawer	1	2	
236		drawer	1	0	
237		front of drawers	1	2	
238		top drawer	1	0	
239		drawer	1	7	
240		drawer	1	6	
241		bottom drawer	1	0	
242		drawer	1	11	

Radiological Survey Continuation Sheet

Page 10 of 19

Date 12/26/99

No.	Time	Location	Inst. Used	Total Activity (dpm/100 cm ²)	Comments
243		Front of cabinets	1	11	
244		Top Drawer	1	6	
245		Drawer	1	0	
246		Drawer	1	4	
247		Bottom Drawer	1	1	
248		SIDE OF CABINETS	1	5	
249		Front of cabinets	1	9	
250		Drawer	1	32	
251		CABINET	1	0	
252		Drawer	1	16	
253		Front of Drawers	1	10	
254		TOP Drawer	1	7	
255		Drawer	1	0	
256		Drawer	1	0	
257		Bottom drawer	1	0	
258		Drawer	1	7	
259		Front of Drawers	1	5	
260		TOP Drawer	1	0	
261		Drawer	1	0	
262		Drawer	1	13	
263		Bottom drawer	1	2	
264		Drawer	1	0	
265		Front of Drawers	1	6	
266		TOP Drawer	1	7	
267		Drawer	1	0	
268		Bottom Drawer	1	0	
269		Desk	1	4	
270	↓	Chair	1	0	

Radiological Survey Continuation Sheet

Date 10/20/99

No.	Time	Location	Inst. Used	Total Activity (dpm/100 cm ²)	Comments
271		Wall	1	0	
272		CRINET	1	13	
273		Door	1	4	
274		Wall	1	11	
275		Wall	1	4	
276		Door	1	0	
277		Wall	1	2	
278		Wall	1	0	
279		Chair	1	6	
280		Chair	1	4	
281		Floor	1	4	
282		Floor	1	0	
283		Floor	1	0	
284		Floor	1	0	
285		Table	1	11	
286		Window sill	1	7	
287	↓	Shelves	1	15	
288	1230	Post Deck #165	1	4	Security
289	↓	" " #165	1	0	
			1		
			1		
			1		
			1		
			1		
			1		
			1		
			1		
			1		
			1		
			1		
			1		
			1		
			1		
			1		

10/27/99

Bld. 118C Room C220

Date: 10/26/99

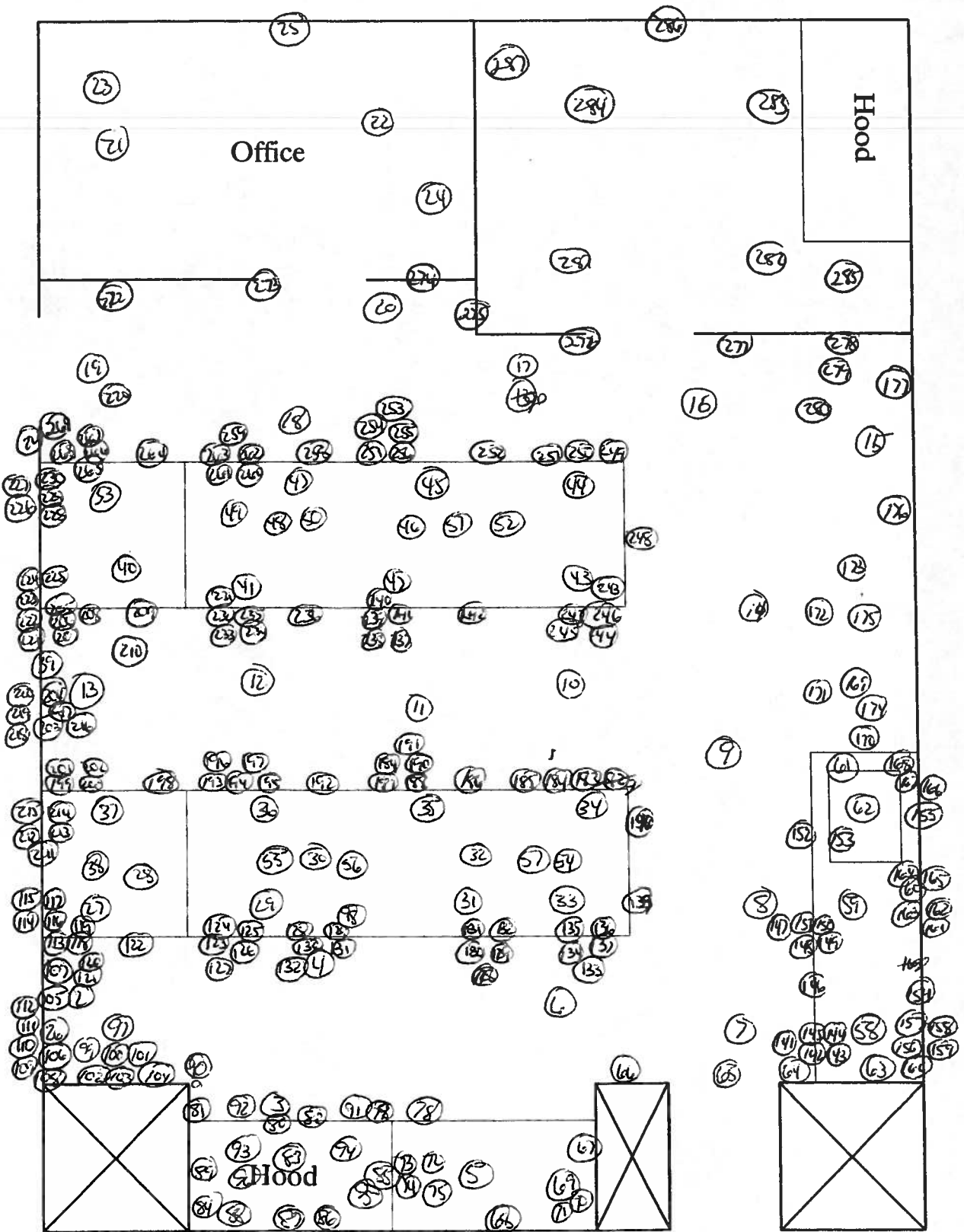

Surveyed 100 sq ft of lower surfaces with 43-68. No readings in excess of normal background were observed

○ = WPA LOCATION

Ext Std Terminator: Count
 Luminescence Correction On
 Coincidence Time(ns): 18
 Delay Before Burst(ns): Normal

page 13 of 19

S#	TIME	CPMA	CPMB	CPMC	SIS	tsIE	FLAG
1	10.00	11.50	7.00	25.10	41.279	508.85	B
2	1.00	3.50	4.00	10.90	80.808	463.61	
3	1.00	6.50	0.00	0.90	0.000	456.24	
4	1.00	0.50	0.00	0.00	0.000	459.69	
5	1.00	0.00	8.00	5.90	121.30	456.61	
6	1.00	0.00	3.00	3.90	239.95	449.09	
7	1.00	0.00	4.00	0.00	0.000	457.09	
8	1.00	2.50	0.00	1.90	0.000	412.91	
9	1.00	7.50	0.00	4.90	0.000	459.77	
10	1.00	2.50	1.00	2.90	0.000	442.33	
11	1.00	3.50	0.00	4.90	28.828	450.83	
12	1.00	5.50	0.00	5.90	0.000	445.71	
13	1.00	2.50	0.00	0.00	0.000	436.48	
14	1.00	6.50	0.00	3.90	0.000	419.52	
15	1.00	0.00	5.00	0.00	157.91	371.28	
16	1.00	0.00	0.00	0.00	0.000	429.40	
17	1.00	5.50	0.00	3.90	0.000	471.46	
18	1.00	6.50	0.00	11.90	0.593	457.19	
19	1.00	0.50	0.00	0.00	0.000	435.44	
20	1.00	1.50	0.00	0.00	0.000	459.28	
21	1.00	0.00	1.00	0.90	0.000	446.77	
22	1.00	2.50	0.00	4.90	0.000	481.33	
23	1.00	0.00	0.00	0.00	0.000	482.93	
24	1.00	3.50	1.00	7.90	51.933	442.98	
25	1.00	5.50	0.00	2.90	0.000	418.32	
26	1.00	0.00	1.00	0.00	0.000	453.08	
27	1.00	6.50	0.00	0.90	0.000	433.10	
28	1.00	5.50	7.00	10.90	59.167	493.13	
29	1.00	4.50	0.00	1.90	0.000	468.92	
30	1.00	0.00	1.00	0.00	0.000	474.21	
31	1.00	2.50	5.00	10.90	59.676	447.95	
32	1.00	4.50	1.00	6.90	53.521	455.78	
33	1.00	0.50	1.00	4.90	0.000	448.76	
34	1.00	6.50	3.00	9.90	15.410	350.72	
35	1.00	0.00	3.00	1.90	57.863	472.97	
36	1.00	3.50	0.00	0.00	0.000	445.81	
37	1.00	0.00	3.00	0.90	0.000	394.36	
38	1.00	0.00	0.00	0.00	0.000	452.42	
39	1.00	0.00	2.00	0.00	0.000	363.79	
40	1.00	2.50	0.00	2.90	0.000	442.75	

26 Oct 99 10:49
 Protocol #: 7

TRI-CARB - 1.02
 General survey

Page #2
 User :

S#	TIME	CPMA	CPMB	CPMC	SIS	tsIE	FLAG
41	1.00	0.50	2.00	0.00	0.000	398.10	
42	1.00	5.50	9.00	18.90	19.233	293.51	
43	1.00	0.00	1.00	0.00	0.000	408.97	
44	1.00	0.00	1.00	0.00	0.000	423.67	
45	1.00	0.00	4.00	6.90	0.000	349.86	
46	1.00	0.00	0.00	0.00	0.000	458.52	
47	1.00	0.00	2.00	0.00	0.000	446.25	
48	1.00	7.50	0.00	7.90	0.000	425.66	

50	1.00	2.50	0.00	0.00	0.000	239.51
51	1.00	0.50	5.00	9.90	94.409	449.89
52	1.00	12.50	7.00	19.90	21.237	374.06
53	1.00	0.00	2.00	3.90	716.10	467.87
54	1.00	7.50	0.00	1.90	0.000	470.43
55	1.00	7.50	0.00	8.90	0.000	476.36
56	1.00	4.50	7.00	13.90	8.666	307.20
57	1.00	0.50	1.00	3.90	0.000	420.00
58	1.00	7.50	0.00	1.90	0.000	465.08
59	1.00	3.50	0.00	2.90	0.000	450.34
60	1.00	1.50	2.00	2.90	21.143	470.39
61	1.00	0.00	0.00	0.00	0.000	423.95
62	1.00	0.00	0.00	0.00	0.000	477.54
63	1.00	5.50	0.00	4.90	0.000	467.85
64	1.00	0.00	0.00	0.00	0.000	485.56
65	1.00	4.50	2.00	1.90	0.000	488.98
66	1.00	0.00	0.00	0.00	0.000	437.88
67	1.00	3.50	1.00	7.90	35.824	488.47
68	1.00	0.00	1.00	0.00	99.201	494.44
69	1.00	0.00	7.00	2.90	17.424	350.83
70	1.00	0.00	2.00	0.00	0.000	474.78
71	1.00	0.00	0.00	0.00	0.000	426.93
72	1.00	0.00	0.00	0.00	0.000	447.51
73	1.00	0.00	0.00	0.00	0.000	480.15
74	1.00	1.50	2.00	0.00	17.717	484.85
75	1.00	0.00	0.00	0.00	0.000	488.20
76	1.00	3.50	2.00	9.90	1.026	489.91
77	1.00	1.50	0.00	0.90	0.000	431.17
78	1.00	0.00	0.00	0.00	0.000	498.24
79	1.00	2.50	0.00	3.90	0.000	478.59
80	1.00	2.50	0.00	1.90	36.366	492.83
81	1.00	0.00	0.00	0.00	0.000	443.35
82	1.00	4.50	0.00	0.90	0.000	471.50
83	1.00	4.50	8.00	9.90	46.601	455.25
84	1.00	6.50	0.00	12.90	33.391	459.85
85	1.00	0.00	1.00	0.00	0.000	473.71
86	1.00	0.50	1.00	0.00	0.000	386.41
87	1.00	4.50	0.00	4.90	0.000	465.12
88	1.00	5.50	2.00	5.90	15.789	418.47
89	1.00	0.00	0.00	0.00	0.000	466.34
90	1.00	0.00	0.00	0.00	0.000	496.61
91	1.00	4.50	0.00	3.90	8.214	469.16
92	1.00	5.50	0.00	0.00	0.000	493.41
93	1.00	0.00	0.00	0.00	0.000	376.50
94	1.00	0.00	1.00	0.00	0.000	323.66
95	1.00	9.50	0.00	6.90	0.000	484.44
96	1.00	6.50	2.00	8.90	0.000	501.85

26 Oct 99 12:29
Protocol #: 7

TRI-CARB - 1.02
General survey

Page #3
User :

S#	TIME	CPMA	CPMB	CPMC	SIS	tSIE	FLAG
97	1.00	0.00	0.00	0.00	0.000	469.76	
98	1.00	0.00	4.00	1.90	0.000	451.39	
99	1.00	0.00	0.00	0.00	0.000	499.76	
100	1.00	0.00	0.00	0.00	0.000	493.52	
101	1.00	10.50	1.00	8.90	15.652	488.99	
102	1.00	0.00	0.00	0.00	0.000	473.25	
103	1.00	0.00	0.00	0.00	19.122	472.82	
104	1.00	2.50	1.00	3.90	48.985	446.14	

107	1.00	0.50	0.00	0.00	0.000	488.52
108	1.00	2.50	0.00	0.00	0.000	481.24
109	1.00	1.50	0.00	6.90	44.878	501.80
110	1.00	9.50	0.00	3.90	0.000	491.85
111	1.00	0.00	2.00	0.00	55.536	496.35
112	1.00	0.00	0.00	0.00	0.000	461.98
113	1.00	7.50	0.00	7.90	0.000	457.37
114	1.00	0.00	4.00	0.00	45.925	460.11
115	1.00	2.50	2.00	1.90	31.003	468.99
116	1.00	0.50	0.00	0.00	0.000	481.14
117	1.00	0.00	1.00	0.00	0.000	492.78
118	1.00	0.00	0.00	1.90	0.000	490.21
119	1.00	0.00	0.00	0.00	0.000	516.75
120	1.00	12.50	0.00	9.90	6.130	446.53
121	1.00	11.50	0.00	7.90	0.000	484.58
122	1.00	0.00	0.00	0.00	0.000	467.15
123	1.00	6.50	0.00	8.90	0.000	486.72
124	1.00	5.50	0.00	11.90	23.029	488.15
125	1.00	0.00	2.00	0.90	0.000	482.36
126	1.00	0.00	1.00	2.90	0.000	490.86
127	1.00	1.50	0.00	3.90	10.895	483.84
128	1.00	5.50	0.00	10.90	32.475	487.77
129	1.00	3.50	4.00	11.90	19.520	488.85
130	1.00	7.50	1.00	5.90	22.180	488.80
131	1.00	0.00	0.00	0.90	42.762	481.97
132	1.00	1.50	3.00	1.90	18.313	478.77
133	1.00	9.50	2.00	10.90	32.911	465.94
134	1.00	10.50	0.00	10.90	5.553	464.90
135	1.00	0.00	4.00	1.90	69.140	497.99
136	1.00	4.50	2.00	8.90	19.901	487.18
137	1.00	3.50	7.00	6.90	43.696	465.64
138	1.00	0.50	1.00	6.90	16.690	434.80
139	1.00	0.00	0.00	0.00	8.719	483.02
140	1.00	7.50	2.00	7.90	17.242	471.51
141	1.00	7.50	0.00	7.90	0.000	480.60
142	1.00	0.00	0.00	0.00	0.000	468.84
143	1.00	4.50	0.00	2.90	0.000	460.81
144	1.00	7.50	0.00	1.90	0.000	463.37
145	1.00	6.50	0.00	1.90	14.063	420.21
146	1.00	10.50	0.00	6.90	0.000	456.35
147	1.00	0.00	0.00	0.00	0.000	479.26
148	1.00	0.50	0.00	0.00	0.000	474.80
149	1.00	3.50	3.00	6.90	14.659	447.79
150	1.00	0.00	2.00	0.00	2.084	429.89
151	1.00	0.00	3.00	0.90	33.995	405.15
152	1.00	0.50	0.00	0.00	0.000	486.78

S#	TIME	CPMA	CPMB	CPMC	SIS	tsIE	FLAG
153	1.00	7.50	0.00	3.90	0.000	415.31	
154	1.00	13.50	4.00	20.90	0.000	331.41	
155	1.00	6.50	3.00	11.90	38.850	377.66	
156	1.00	0.00	4.00	2.90	13.974	455.42	
157	1.00	3.50	0.00	0.00	0.000	445.22	
158	1.00	2.50	0.00	3.90	0.000	497.29	
159	1.00	6.50	1.00	9.90	0.000	484.29	
160	1.00	0.00	5.00	8.90	31.398	480.43	

162	1.00	7.50	0.00	0.00	10.00	482.00
163	1.00	0.00	0.00	0.00	0.000	488.59
164	1.00	3.50	0.00	1.90	0.000	483.32
165	1.00	50.50	1.00	49.90	7.418	462.86
166	1.00	7.50	0.00	3.90	2.996	477.74
167	1.00	0.00	0.00	0.00	0.000	435.93
168	1.00	20.50	7.00	28.90	0.229	162.52
169	1.00	6.50	7.00	14.90	15.167	258.74
170	1.00	6.50	0.00	8.90	0.000	472.50
171	1.00	5.50	0.00	0.90	0.000	480.48
172	1.00	0.00	0.00	1.90	1.229	466.97
173	1.00	2.50	2.00	4.90	1.895	481.91
174	1.00	4.50	0.00	5.90	0.000	465.10
175	1.00	0.00	4.00	3.90	45.544	482.01
176	1.00	2.50	1.00	6.90	4.231	469.58
177	1.00	5.50	0.00	4.90	2.557	412.94
178	1.00	0.00	0.00	0.00	0.000	480.05
179	1.00	0.50	0.00	1.90	0.000	476.78
180	1.00	7.50	1.00	4.90	0.000	472.65
181	1.00	4.50	0.00	2.90	0.000	487.13
182	1.00	0.00	4.00	0.90	4.757	457.16
183	1.00	3.50	0.00	3.90	0.000	486.46
184	1.00	0.00	3.00	0.00	13.275	482.45
185	1.00	9.50	4.00	11.90	17.632	450.69
186	1.00	4.50	1.00	5.90	8.319	475.20
187	1.00	3.50	0.00	3.90	0.000	467.11
188	1.00	0.00	3.00	0.00	27.192	460.38
189	1.00	0.50	1.00	1.90	3.648	464.17
190	1.00	6.50	7.00	18.90	23.239	463.58
191	1.00	14.50	4.00	22.90	8.913	456.79
192	1.00	8.50	0.00	6.90	0.000	462.63
193	1.00	7.50	0.00	6.90	0.000	495.00
194	1.00	3.50	0.00	0.90	7.885	460.38
195	1.00	18.50	0.00	15.90	0.003	486.60
196	1.00	9.50	0.00	10.90	0.000	483.13
197	1.00	0.50	2.00	4.90	28.757	475.58
198	1.00	8.50	0.00	5.90	0.000	482.31
199	1.00	0.00	0.00	0.00	0.000	488.23
200	1.00	4.50	0.00	8.90	0.000	474.67
201	1.00	17.50	0.00	19.90	9.972	474.78
202	1.00	0.00	0.00	0.00	0.000	480.25
203	1.00	0.00	3.00	4.90	17.586	438.96
204	1.00	3.50	0.00	2.90	0.000	476.87
205	1.00	1.50	2.00	0.90	46.611	466.77
206	1.00	0.00	0.00	0.00	0.000	458.40
207	1.00	3.50	0.00	6.90	0.000	452.96
208	1.00	3.50	0.00	0.00	17.812	439.89

S#	TIME	CPMA	CPMB	CPMC	SIS	tSIE	FLAG
209	1.00	0.00	1.00	0.00	2.731	481.69	
210	1.00	0.00	0.00	0.00	0.000	519.72	
211	1.00	0.00	0.00	0.00	8.504	446.03	
212	1.00	0.00	0.00	0.00	0.000	452.35	
213	1.00	9.50	0.00	7.90	25.755	466.26	
214	1.00	9.50	2.00	14.90	9.575	476.86	
215	1.00	7.50	4.00	12.90	21.023	456.28	
216	1.00	8.50	0.00	5.90	0.071	436.01	

218	1.00	5.50	2.00	6.90	0.000	473.03
219	1.00	3.50	0.00	2.90	0.000	443.58
220	1.00	0.00	3.00	0.00	52.373	460.67
221	1.00	0.00	2.00	0.00	30.753	417.29
222	1.00	1.50	0.00	0.00	5.509	432.59
223	1.00	0.00	0.00	0.00	0.000	480.51
224	1.00	6.50	0.00	3.90	0.000	462.17
225	1.00	4.50	2.00	5.90	16.577	439.12
226	1.00	16.50	1.00	18.90	0.000	362.35
227	1.00	4.50	5.00	6.90	13.723	475.75
228	1.00	8.50	0.00	1.90	0.000	487.87
229	1.00	0.00	0.00	0.00	0.000	486.23
230	1.00	0.00	0.00	0.00	0.000	466.32
231	1.00	0.00	0.00	0.00	0.000	474.09
232	1.00	0.50	4.00	7.90	17.611	488.16
233	1.00	6.50	0.00	5.90	0.000	468.44
234	1.00	7.50	1.00	7.90	8.030	488.83
235	1.00	0.50	1.00	1.90	0.000	443.38
236	1.00	0.00	0.00	0.00	0.000	455.78
237	1.00	3.50	0.00	1.90	19.370	486.85
238	1.00	0.00	1.00	0.00	0.000	449.67
239	1.00	0.00	0.00	5.90	34.724	466.96
240	1.00	6.50	0.00	4.90	1.857	463.97
241	1.00	0.00	1.00	0.00	29.084	461.12
242	1.00	8.50	0.00	8.90	8.454	427.57
243	1.00	2.50	0.00	8.90	0.000	464.68
244	1.00	1.50	2.00	4.90	4.710	469.53
245	1.00	0.00	0.00	0.00	0.000	450.89
246	1.00	3.50	0.00	2.90	0.000	454.33
247	1.00	4.50	0.00	0.90	8.695	440.16
248	1.00	8.50	0.00	3.90	2.681	462.34
249	1.00	7.50	0.00	6.90	5.548	483.99
250	1.00	12.50	14.00	25.90	45.062	475.76
251	1.00	0.00	0.00	0.00	0.000	415.72
252	1.00	7.50	4.00	12.90	21.076	416.12
253	1.00	4.50	0.00	7.90	0.000	481.04
254	1.00	4.50	0.00	5.90	0.000	484.23
255	1.00	0.50	0.00	0.00	0.000	468.13
256	1.00	0.50	0.00	0.00	0.000	471.16
257	1.00	0.50	0.00	0.00	0.000	451.47
258	1.00	5.50	0.00	5.90	1.117	435.72
259	1.00	3.50	0.00	3.90	0.000	482.16
260	1.00	0.00	0.00	0.00	0.000	440.41
261	1.00	0.00	0.00	0.00	0.000	460.31
262	1.00	15.50	0.00	10.90	0.000	469.27
263	1.00	3.50	0.00	1.90	21.842	457.82
264	1.00	1.50	0.00	0.00	0.000	466.54

page 17 of 19

Protocol #: 7

General survey

User :

page 18 of 19

S#	TIME	CPMA	CPMB	CPMC	SIS	tSIE	FLAG
265	1.00	7.50	0.00	4.90	0.000	464.28	
266	1.00	0.00	7.00	5.90	27.120	475.42	
267	1.00	0.00	0.00	0.00	0.000	480.57	
268	1.00	0.00	2.00	0.00	64.053	444.75	
269	1.00	4.50	0.00	2.90	0.000	451.58	
270	1.00	2.50	0.00	0.00	0.000	488.41	
271	1.00	0.50	0.00	0.00	0.000	463.43	
272	1.00	1.50	2.00	10.90	0.000	415.36	
273	1.00	7.50	0.00	2.90	0.000	463.61	
274	1.00	1.50	2.00	8.90	9.762	455.97	
275	1.00	7.50	0.00	2.90	0.000	483.13	
276	1.00	0.00	0.00	0.00	0.000	498.28	
277	1.00	0.00	2.00	1.90	63.601	435.74	
278	1.00	0.00	0.00	0.00	0.000	460.39	
279	1.00	0.00	8.00	4.90	169.20	453.28	
280	1.00	2.50	0.00	2.90	0.000	455.72	
281	1.00	2.50	0.00	2.90	2.454	388.39	
282	1.00	0.00	1.00	0.00	0.021	401.97	
283	1.00	0.00	0.00	0.00	0.000	434.31	
284	1.00	0.00	2.00	0.00	11.869	373.55	
285	1.00	0.00	6.00	8.90	14.703	379.56	
286	1.00	1.50	3.00	5.90	34.554	411.35	
287	1.00	0.00	9.00	11.90	114.61	437.33	

PC Data Filename is: C:\drugmet\A2500\A7_197.dat

28 Oct 99 13:07

TRI-CARB - 1.02

Protocol #: 7

General survey

Page #12

User :

Time: 1.00

Data Mode: CPM

Nuclide: MANUAL

Background Subtract: 1st Vial

	LL	UL	LCR	2S%	BKG
Region A:	0.0 - 18.6		0	0.0	12.20
Region B:	18.6 - 156		0	0.0	6.30
Region C:	0.0 - 2000		0	0.0	24.50

Quench Indicator: tSIE/AEC

Ext Std Terminator: Count

Luminescence Correction On

Coincidence Time(ns): 18

Delay Before Burst(ns): Normal

S#	TIME	CPMA	CPMB	CPMC	SIS	tSIE	FLAG
<i>Blayd</i> 1	10.00	12.20	6.30	24.50	36.023	517.64	B
<i>288</i> 2	1.00	0.00	2.70	2.50	163.98	515.15	
<i>289</i> 3	1.00	2.80	0.00	0.50	0.000	513.93	

PC Data Filename is: C:\drugmet\A2500\A7_200.dat