

Radiological Survey Sheet

Job Location PFIZER INC Page 1 of 27

Survey Purpose DECOMMISSIONING LAB C215 Date 7/25/00

Performed By DAVID S. DURKEE (Print)  (Sign)

Inst.(1) ^{Beckman LS 6500} Packard 2500 TR (Model/SN) #405106 #404047	Inst.(2) Luellum model 2241-2 (Model/SN) # 163603	Inst.(3) (Model/SN)
Det. Internal (Model/SN)	Det. Luellum 4368 (Model/SN) # 149613	Det. (Model/SN)
Eff. H-3 (27% - 47%) C-14 (78% - 85%) ^{See printout}	Eff. = 8% C-14	Eff.
Type rad. β	Type rad. β	Type rad.
Bkgd. See #1 below ^{See printout}	Bkgd. 300 cpm	Bkgd.
Cal. Due: 2/2000 7/01	Cal. Due 2/8/01	Cal. due

No.	Time	Location	Inst. Used	Total Activity (dpm/100 cm ²)	Comments
1.	0745	WALL	1	See ATTACHED LSC printout	
2.		WALL	1		
3.		WALL	1		
4.		WALL	1		
5.		WALL	1		
6.		TABLE	1		
7.		Chair	1		
8.		Desk	1		
9.		WALL	1		
10.		WALL	1		
11.		Windowsill	1		
12.		WINDOWS	1		
13.		WALL	1		
14.		lower wall	1		
15.		Window/window sill	1		
16.		Lower wall	1		
17.		upper wall	1		
18.	✓	Lower wall	1		✓

Radiological Survey Continuation Sheet

Page 2 of 27

Date 7/25/00

No.	Time	Location	Inst. Used	Total Activity (dpm/100 cm ²)
19		Countertop	1	See attached LSC Printout
20		Front of Drawers	1	
21		Top Drawer	1	
22		Drawer	1	
23		Drawer	1	
24		Bottom Drawer	1	
25		Floor	1	
26		Floor	1	
27		Side of CABINET	1	
28		Floor	1	
29		Floor	1	
30		Floor	1	
31		Floor	1	
32		Floor	1	
33		Floor	1	
34		Floor	1	
35		Floor	1	
36		Floor	1	
37		Floor	1	
38		Floor	1	
39		Floor	1	
40		Floor	1	✓ (See #330)
41		Floor	1	
42		Floor	1	
43		Floor	1	
44		Floor	1	
45		Floor	1	
46	↓	Floor	1	↓

Radiological Survey Continuation Sheet

Page 3 of 27

Date 7/25/00

No.	Time	Location	Inst. Used	Total Activity (dpm/100 cm ²)
47		Desk	1	See attached LSC Printout
48		Shelves	1	
49		Windowsill	1	
50		Blue chair	1	
51		Brown chair	1	
52		Water glass door	1	
53		Filing cabinet	1	
54		Filing cabinet	1	
55		GLASS WALL	1	
56		WALL	1	
57		WALL	1	
58		Door	1	
59		WALL	1	
60		LEDGE	1	
61		Desktop	1	
62		Top shelf	1	
63		Shelf	1	
64		Bottom shelf	1	
65		Front of Drawers	1	
66		Top Drawer	1	
67		Drawer	1	
68		Bottom Drawer	1	
69		Drawer	1	
70		Front of unit ^{WALL} UNIT	1	(See # 331)
71		Top shelf	1	
72		Shelf	1	
73		Shelf	1	
74	↓	Bottom shelf	1	

Radiological Survey Continuation Sheet

Page 4 of 27

Date 7/25/00

No.	Time	Location	Inst. Used	Total Activity (dpm/100 cm ²)
75		Counter	1	See attached LSC Printout
76		Cup sink	1	
77		Counter	1	
78		Counter	1	
79		Cup sink	1	
80		Counter	1	
81		counter	1	
82		Top Shelf	1	
83		Shelf	1	
84		Bottom shelf	1	
85		Top shelf	1	
86		Shelf	1	
87		Bottom shelf	1	
88		FRONT OF CABINET	1	
89		DRAMON	1	
90		Top shelf	1	
91		Shelf	1	
92		Drawer	1	
93		FRONT OF DRAWERS	1	
94		TOP Drawer	1	
95		Drawer	1	
96		Drawer	1	
97		Bottom Drawer	1	
98		Drawer	1	(See # 332)
99		FRONT OF DRAWERS	1	
100		Top Drawer	1	
101		Drawer	1	
102	↓	Drawer	1	↓

Radiological Survey Continuation Sheet

Page 5 of 27

Date 7/25/00

No.	Time	Location	Inst. Used	Total Activity (dpm/100 cm ²)
103		Bottom Drawer	1	See attached LSC Printout
104		Side of CABINETS	1	
105		counter	1	
106		counter	1	
107		center	1	
108		counter	1	
109		center	1	
110		Desk	1	
111		Front of Drawers	1	
112		top Drawer	1	
113		Drawer	1	
114		Drawer	1	(See #333)
115		Bottom Drawer	1	
116		Drawer	1	
117		FRONT OF DRAWERS	1	
118		Top Drawer	1	
119		Drawer	1	
120		Drawer	1	
121		Bottom Drawer	1	
122		Drawer	1	
123		FRONT OF DRAWERS	1	
124		TOP DRAWER	1	
125		Drawer	1	
126		Drawer	1	
127		Bottom Drawer	1	
128		Drawer	1	
129		FRONT OF DRAWERS	1	
130	↓	TOP DRAWER	1	↓

Radiological Survey Continuation Sheet

Page 6 of 27

Date 7/25/00

No.	Time	Location	Inst. Used	Total Activity (dpm/100 cm ²)
131		Planner	1	See attached LSC Printout
132		Bottom Detector	1	
133		Grey chair	1	
134		Blue chair	1	
135		Red chair	1	
136		Top Shelf	1	
137		Shelf	1	
138		Bottom Shelves	1	
139		Upper wall	1	
140		Upper wall	1	
141		Loose	1	
142		Lower wall	1	
143		Lower wall	1	
144		FRONT OF WALL UNIT	1	
145		Top Shelf	1	
146		Shelf	1	
147		Shelf	1	
148		Bottom Shelf	1	
149		FRONT OF WALL UNIT	1	
150		Top Shelf	1	
151		Shelf	1	
152		Shelf	1	
153		Bottom Shelf	1	
154		FRONT OF WALL UNIT	1	
155		Top Shelf	1	
156		Shelf	1	
157		Shelf	1	
158	↓	Bottom Shelf	1	↓

Radiological Survey Continuation Sheet

Page 7 of 27

Date 7/25/00

No.	Time	Location	Inst. Used	Total Activity (dpm/100 cm ²)
159		Shelf	1	See attached LSC Printout
160		Desk	1	
161		counter	1	
162		Cupsink	1	
163		counter	1	
164		counter	1	
165		Cupsink	1	
166		counter	1	
167		counter	1	
168		FRONT OF DRAWERS	1	
169		TOP DRAWER	1	
170		DRAWER	1	
171		BOTTOM DRAWER	1	
172		DRAWER	1	
173		FRONT OF DRAWER	1	
174		TOP DRAWER	1	
175		DRAWER	1	
176		DRAWER	1	
177		BOTTOM DRAWER	1	
178		DRAWER	1	(See #334)
179		FRONT OF DRAWER	1	
180		TOP DRAWER	1	
181		DRAWER	1	
182		DRAWER	1	
183		BOTTOM DRAWER	1	
184		DRAWER	1	
185		FRONT OF ²⁰ CABINET	1	
186		DRAWER	1	

Radiological Survey Continuation Sheet

Page 8 of 27

Date 7/25/00

No.	Time	Location	Inst. Used	Total Activity (dpm/100 cm ²)
187		Shelf	1	See attached LSC Printout
188		Shelf	1	✓ (See #335)
189		Floor	1	
190		Floor	1	
191		Floor	1	
192		Floor	1	
193		Floor	1	
194		Top Shelf	1	
195		Shelf	1	
196		Bottom Shelf	1	
197		Top Shelf	1	
198		Shelf	1	
199		Bottom Shelf	1	
200		Counter	1	
201		counter	1	
202		counter	1	
203		counter	1	
204		counter	1	
205		Desk	1	
206		END OF CABINETS	1	
207		FRONT OF DRAWERS	1	
208		TOP DRAWER	1	
209		DRAWER	1	
210		DRAWER	1	
211		BOTTOM DRAWER	1	
212		FRONT OF DRAWERS	1	
213		TOP DRAWER	1	
214	↓	DRAWER	1	↓

Radiological Survey Continuation Sheet

Page 9 of 27

Date 7/25/00

No.	Time	Location	Inst. Used	Total Activity (dpm/100 cm ²)
215		DRAMER	1	See attached LSC Printout
216		BOTTOM DRAMER	1	
217		DRAMER	1	
218		FRONT OF DRAMERS	1	
219		TOP DRAMER	1	
220		DRAMER	1	
221		DRAMER	1	
222		BOTTOM DRAMER	1	
223		FRONT OF DRAMERS	1	
224		TOP DRAMER	1	
225		DRAMER	1	
226		DRAMER	1	
227		BOTTOM DRAMER	1	
228		DRAMER	1	
229		FRONT OF DRAMERS	1	
230		TOP DRAMER	1	
231		DRAMER	1	
232		BOTTOM DRAMER	1	
233		Grey chair	1	
234		Ledge	1	
235		upper wall	1	
236		lower wall	1	
237		upper wall	1	
238		lower wall	1	
239		FRONT OF WASH UNIT	1	
240		TOP Shelf	1	
241		Shelf	1	
242		Shelf	1	

Radiological Survey Continuation Sheet

Page 10 of 27

Date 7/25/00

No.	Time	Location	Inst. Used	Total Activity (dpm/100 cm ²)
243		Bottom shelf	1	See attached LSC Printout
244		FRONT OF WALL UNIT	1	
245		Top shelf	1	
246		Shelf	1	
247		Shelf	1	
248		Bottom shelf	1	
249		LEFT SIDE OF HOOD (Front)	1	
250		HOOD EDGES	1	
251		Right front of Hood	1	
252		Front top	1	
253		SWH outside	1	
254		SWH inside	1	✓ (See # 336)
255		LEFT under	1	
256		Right under	1	
257		LEFT SIDE	1	✓ (See # 337)
258		BACK TOP	1	
259		BACK BOTTOM	1	✓ (See # 338)
260		Right side	1	
261		Cup sink	1	
262		Behind panels	1	
263		TOP OF HOOD	1	
264		DUCT	1	
265		FRONT OF CABINET	1	
266		INSIDE CABINET	1	
267		FRONT OF CABINET	1	
268		INSIDE CABINET	1	
269		DESK TOP left	1	
270	↓	" " Right	1	↓

Radiological Survey Continuation Sheet

Page 11 of 27

Date 7/25/00

No.	Time	Location	Inst. Used	Total Activity (dpm/100 cm ²)
271		Front of Demos	1	See attached LSC Printout
272		Top Demos	1	
273		inside cabinet	1	
274		Drawer	1	
275		upper wall	1	
276		upper wall	1	
277		wall	1	
278		Door	1	
279		wall	1	
280		upper wall	1	
281		lower wall	1	
282		lower wall	1	
283		Floor	1	
284		Floor	1	
285		Floor	1	
286		Floor	1	
287		Floor	1	
288		Floor	1	
289		Floor	1	
290		Floor	1	
291		Floor	1	
292		Floor	1	
293		upper wall	1	
294		upper wall	1	
295		Center	1	
296		center	1	
297		center	1	
298	↓	Center	1	↓

Radiological Survey Continuation Sheet

Page 12 of 27

Date 7/25/00

No.	Time	Location	Inst. Used	Total Activity (dpm/100 cm ²)
299		Sink	1	See attached LSC Printout
300		FRANCIS	1	
301		TOP Shelf	1	
302		Shelf	1	
303		Bottom Shelf	1	
304		FRONT OF WALL UNIT	1	
305		TOP Shelf	1	
306		Shelf	1	
307		Bottom Shelf	1	
308		FRONT OF WALL UNIT	1	
309		TOP Shelf	1	
310		Shelf	1	
311		Shelf	1	
312		Bottom Shelf	1	
313		FRONT OF CABINET	1	
314		INSIDE CABINET	1	
315		FRONT OF DRAWERS	1	
316		TOP DRAWER	1	
317		DRAWER	1	
318		DRAWER	1	
319		Bottom DRAWER	1	
320		DRAWER	1	
321		FRONT OF DRAWERS	1	
322		TOP DRAWER	1	
323		DRAWER	1	(See #339)
324		DRAWER	1	
325		Bottom DRAWER	1	
326	↓	Piece of lead	1	↓

Radiological Survey Continuation Sheet

Page 13 of 27

Date 7/25/00

No.	Time	Location	Inst. Used	Total Activity (dpm/100 cm ²)
327		piece of lead	1	✓ RADWASF See attached LSC Printout
328		piece of lead	1	See attached LSC Printout
329	✓	piece of lead	1	
330	0800	Post DECON # 40	1	
331		" " # 70	1	
332		" " # 98	1	
333		" " # 111	1	
334		Post DECON # 178	1	
335		" " # 188	1	
336		" " # 254	1	
337		" " # 257	1	
338		Post DECON # 259	1	
339	↓	Post DECON # 323	1	
340	0915	POST DECON ①	1	See ATTACHED results
341		" " ②	1	
342		POST DECON ③	1	
343		" " ④	1	
344		POST DECON ⑤	1	
345		" " ⑥	1	
346		POST DECON ⑦	1	
347		" " ⑧	1	
348		POST DECON ⑨	1	
349		" " ⑩	1	
350		POST DECON ⑪	1	
351		" " ⑫	1	
352		POST DECON ⑬	1	
353		" " ⑭	1	
354	↓	" " ⑮	1	

26 July

7/27/00

Bld. 118C Room C215

Date: 7/24/00

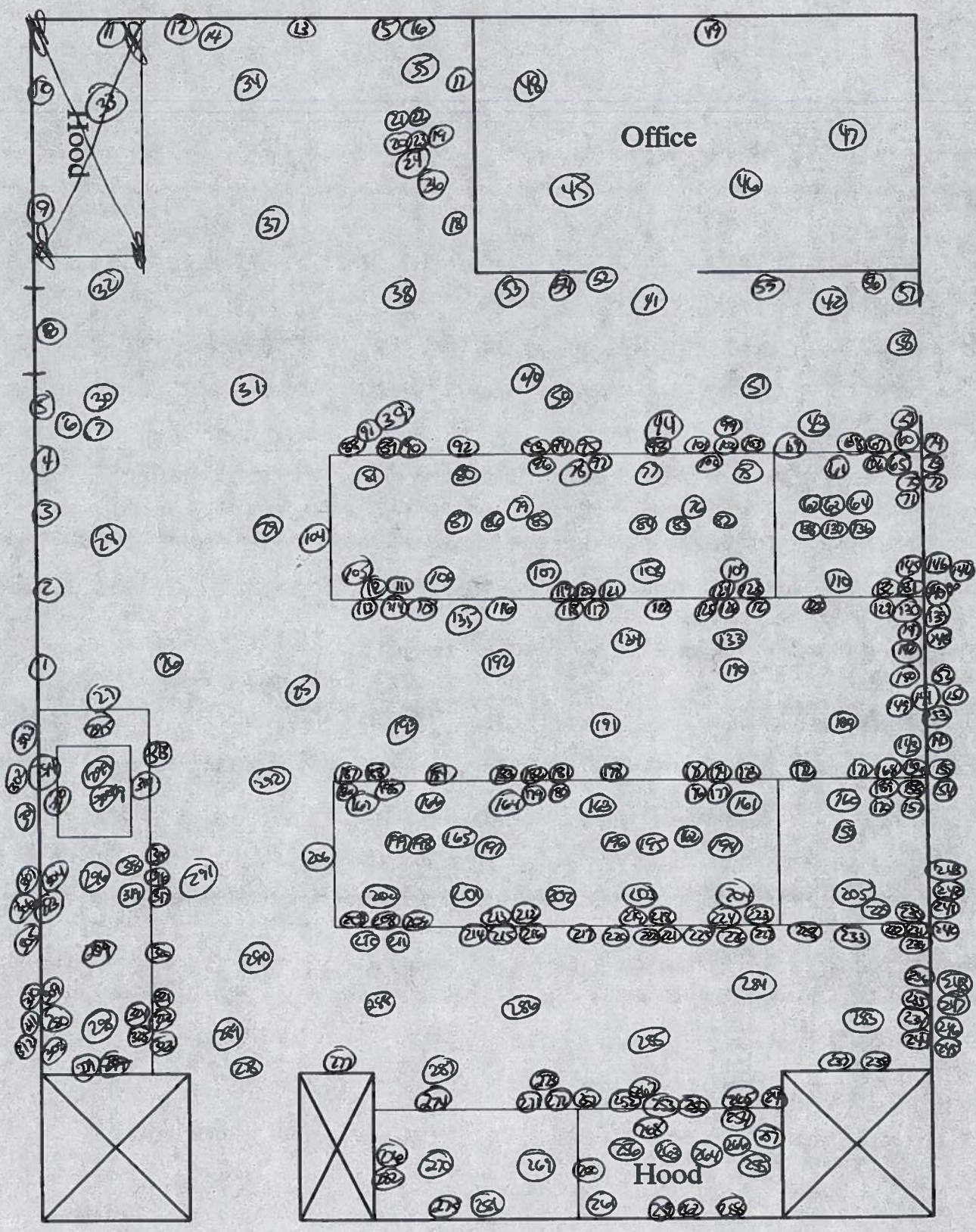

Bld. 118C Room C215

Date: 7/26/00

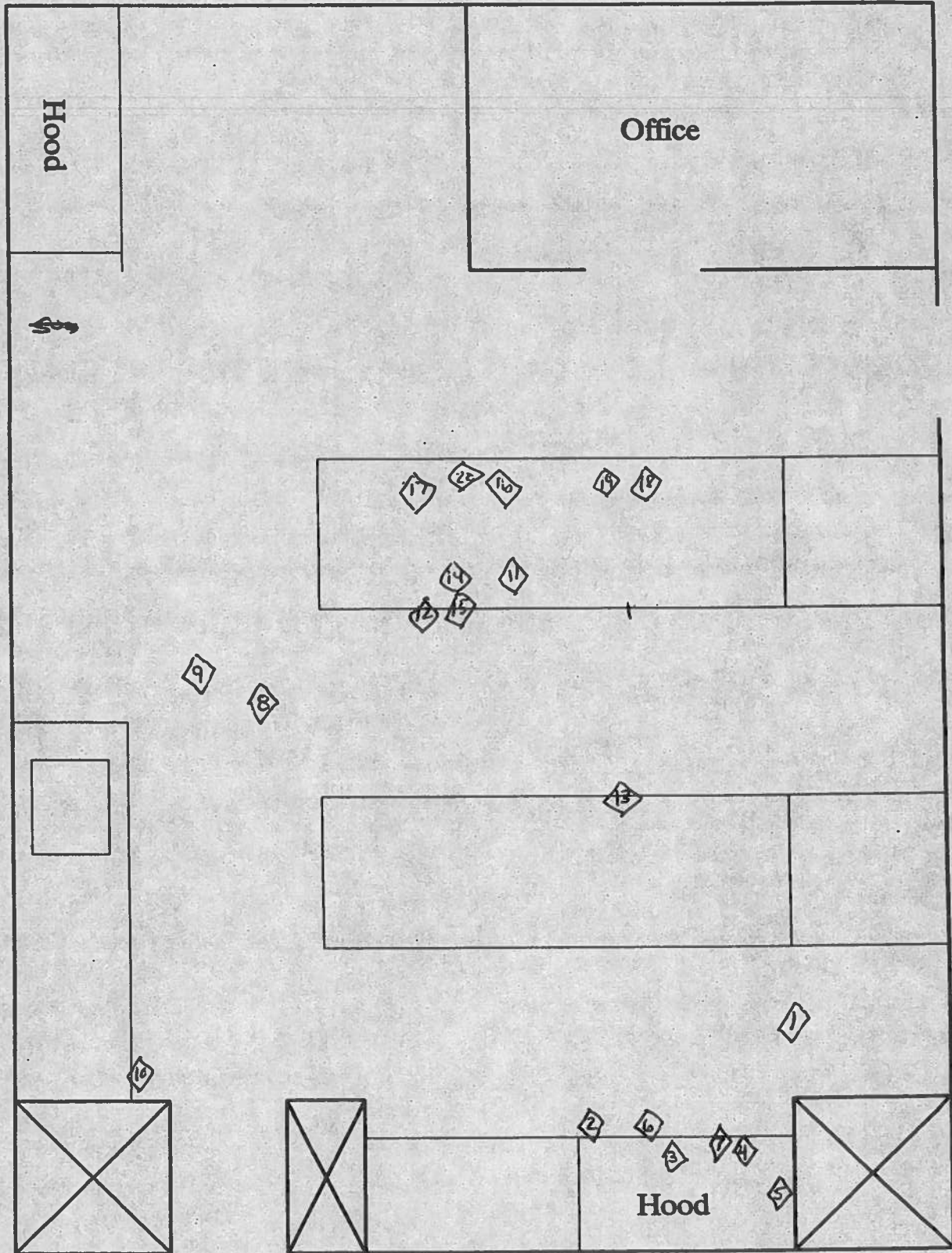

◇ = contaminated areas

Job Location: APPROX. GLETON CT

Page: 17 of 27

Survey Purpose: DECOMMISSIONING C215

Date: 7/26/00

Performed By: DAVID J. SUTKIE

Surveyed 100% of lower surfaces using instrument #2. ALL SURFACES SURVEYED WERE NOTED TO BE AT NORMAL BACKGROUND LEVELS, WITH THE FOLLOWING EXCEPTIONS:

- ① Floor (100 cm²) contaminated to a level of 7,375 dpm/100 cm² (890 cpm).
Decayed to level of Normal Background
- ② FRONT RIGHT SIDE OF HOOD (100 cm²) contaminated to a level of 4,388 dpm/100 cm² (651 cpm).
Decayed to level of Normal Background
- ③ FRONT OF HOOD counter (100 cm²) contaminated to a level of 256,413 dpm/100 cm² (20,813 cpm).
Disposed as radiowaste.
- ④ INSIDE SASH (100 cm²) contaminated to a level of 205,150 dpm/100 cm² (16,712 cpm).
Decayed to level of Normal Background.
- ⑤ INSIDE HOOD, LEFT SIDE (1500 cm²) contaminated to a maximum level of 2092,125 dpm/100 cm² (167,670 cpm).
Disposed as radiowaste.
- ⑥ FRONT OF RIGHT CABINET DOOR (300 cm²) contaminated to a level of 47,775 dpm/100 cm² (4,122 cpm).
Decayed to level of Normal Background
- ⑦ INSIDE LEFT CABINET (100 cm²) contaminated to a level of 368 cpm (850 dpm/100 cm²).
Decayed to a level of Normal Background.
- ⑧ Floor (100 cm²) contaminated to a level of 16,538 dpm/100 cm² (1,623 cpm).
Decayed to a level of Normal Background
- ⑨ Floor (100 cm²) contaminated to a level of 32,425 dpm/100 cm² (2,894 cpm).
Decayed to a level of Normal Background.
- ⑩ INSIDE DRAWER (100 cm²) contaminated to a level of 24,238 dpm/100 cm² (1,939 cpm).
Decayed to a level of Normal Background
- ⑪ Counter top contaminated to a level of 11,850 dpm/100 cm² (1,808 cpm).
Disposed as radiowaste
- ⑫ FRONT RIGHT SIDE OF DRAWERS contaminated to a level of 36,300 dpm/100 cm² (3,204 cpm).
Decayed to a level of Normal Background
- ⑬ Under Counter (Stool Area) contaminated to a level of 84,163 dpm/100 cm² (7,033 cpm).
Decayed to level of Normal Background
- ⑭ Under Counter (Stool Area) contaminated to a level of 124,425 dpm/100 cm² (10,254 cpm).
Decayed to level of Normal Background

Swipe

Air Sample

Meter Reading = Rad
Survey in $\mu\text{rem/h}$

Job Location: Pfizer Inc. Glaston CT

Page: 16 of 27

Survey Purpose: DECOMMISSIONING C25

Date: 7/26/00

Performed By: DAVID T. DURKIE

[Signature]

15) Under counter (Start Area) Contaminated to a level of $75,075 \text{ dpm/100cm}^2$ ($6,042 \text{ cpm}$). Decont. to level of Normal Background

16) Counter Contaminated to a level of $9,800 \text{ dpm/100cm}^2$ ($1,084 \text{ cpm}$). Decont. to a level of $6,500 \text{ dpm/100cm}^2$ (620 cpm). Disposed as radwaste.

17) Counter Contaminated to a level of $12,072 \text{ dpm/100cm}^2$ ($1,266 \text{ cpm}$). Decont. to a level of $5,513 \text{ dpm/100cm}^2$ (741 cpm). Disposed as radwaste.

18) Under Counter Contaminated to a level of $116,863 \text{ dpm/100cm}^2$ ($13,569 \text{ cpm}$). Decont. to level of Normal Background

19) Under Counter Contaminated to a level of $104,038 \text{ dpm/100cm}^2$ ($8,623 \text{ cpm}$). Decont. to level of Normal Background

20) Under Counter Contaminated to a level of $80,675 \text{ dpm/100cm}^2$ ($6,754 \text{ cpm}$). Decont. to level of Normal Background

Swipe

Air Sample

Meter Reading = Rad
Survey in $\mu\text{rem/h}$

ID:WIPE SURVEY

25 JUL 2000 09:08

USER: 1 COMMENT: DECOMMISSION
 PRESET TIME : 1.00
 DATA CALC : DL DPM H# : YES SAMPLE REPEATS: 1 PRINTER : EDIT
 COUNT BLANK : YES IC# : NO REPLICATES : 1 RS232 : EDIT
 TWO PHASE : NO AQC : YES CYCLE REPEATS : 1
 SCINTILLATOR: LIQUID LUMEX: YES LOW SAMPLE REJ: 0
 LOW LEVEL : NO HALF LIFE CORRECTION DATE: none

ISOTOPE 1: 3H %ERROR: 2.00 FACTOR: 1.0000 BKG. SUB: 0
 ISOTOPE 2: 14C %ERROR: 2.00 FACTOR: 1.0000 BKG. SUB: 0
 WIDE OPEN WINDOW %ERROR: 0.00 FACTOR: 1.0000 BKG. SUB: 0

BACKGROUND QUENCH CURVE: Off COLOR QUENCH CORRECTION: Off

Quench Limits Low: 13.688 High: 306.34

SAM NO	H#	3H CPM	14C CPM	WIDE CPM	3H DPM	14C DPM	LUMEX %
B1	73.0	18.00	8.00	36.00	33.42	10.39	3.72
		Blank Average DPM for		3H :	33.42	COEF. OF VAR: 0.000	
		Blank Average DPM for		14C :	10.39	COEF. OF VAR: 0.000	

1	79.5	19.00	6.00	37.00	4.22	-2.67	2.40
2	79.1	31.00	10.00	51.00	27.76	2.49	1.73
3	77.9	24.00	14.00	48.00	10.47	7.95	2.65
4	81.3	8.00	10.00	30.00	-21.35	2.89	4.03
5	74.3	12.00	13.00	34.00	-14.87	6.78	3.21
6	79.3	13.00	6.00	27.00	-8.67	-2.57	3.76
7	86.7	24.00	9.00	46.00	15.10	1.30	9.83
8	76.0	20.00	11.00	43.00	3.16	3.99	3.03
9	80.0	11.00	9.00	27.00	-14.44	1.49	2.80
10	89.9	10.00	9.00	26.00	-15.76	1.56	3.69
11	87.0	15.00	11.00	34.00	-5.96	4.15	4.75
12	78.3	5.00	5.00	15.00	-25.33	-3.78	4.80
13	66.7	16.00	9.00	36.00	-5.46	1.34	1.77
14	81.4	15.00	14.00	39.00	-8.29	8.13	2.33
15	79.1	15.00	9.00	29.00	-5.97	1.41	2.83
16	85.4	17.00	8.00	30.00	-0.15	0.07	4.90
17	71.0	15.00	18.00	39.00	-11.43	13.38	1.82
18	75.3	16.00	9.00	35.00	-4.36	1.38	1.72
19	78.5	13.00	7.00	26.00	-9.29	-1.23	3.46
20	80.4	14.00	9.00	32.00	-7.94	1.44	5.61
21	73.7	13.00	6.00	31.00	-9.31	-2.59	2.00
22	78.0	17.00	6.00	29.00	-0.31	-2.64	2.39
23	74.9	11.00	9.00	33.00	-14.89	1.46	2.69
24	89.1	14.00	5.00	22.00	-4.64	-3.90	4.97
25	83.2	21.00	7.00	41.00	8.75	-1.35	1.58
26	86.6	15.00	12.00	33.00	-6.56	5.49	2.80
27	90.1	12.00	12.00	35.00	-12.87	5.57	2.77
28	90.4	15.00	14.00	41.00	-7.14	8.21	2.48
29	84.4	23.00	6.00	38.00	13.94	-2.73	1.75
30	82.5	12.00	13.00	39.00	-14.15	6.85	1.63
31	83.6	12.00	9.00	28.00	-11.92	1.49	4.80
32	90.4	11.00	12.00	31.00	-15.11	5.59	3.38
33	97.2	10.00	16.00	36.00	-19.11	11.07	3.16
34	90.4	13.00	11.00	35.00	-10.01	4.20	5.63
35	115.5	8.00	9.00	24.00	-18.28	1.75	4.01
36	97.1	21.00	15.00	46.00	7.32	9.51	3.93

SAM NO	H#	3H CPM	14C CPM	WIDE CPM	3H DPM	14C DPM	LUMEX %
37	74.6	19.00	8.00	39.00	2.34	-0.01	1.76
38	89.6	12.00	14.00	39.00	-14.02	8.26	3.24
39	115.8	26.00	20.00	57.00	21.88	16.42	2.36
40	84.2	42.00	48.00	100.00	33.23	53.37	1.24
41	81.9	11.00	9.00	30.00	-14.27	1.50	3.13
42	86.1	16.00	9.00	32.00	-2.79	1.43	2.76
43	94.5	13.00	14.00	37.00	-11.22	8.28	2.37
44	91.3	10.00	12.00	29.00	-17.30	5.61	4.26
45	83.3	17.00	8.00	35.00	-0.50	0.06	2.13
46	86.0	16.00	9.00	38.00	-2.81	1.43	2.44
47	77.3	15.00	5.00	26.00	-4.14	-3.95	2.29
48	76.9	13.00	7.00	26.00	-9.47	-1.24	3.20
49	100.6	11.00	13.00	34.00	-14.69	7.02	2.66
50	88.0	25.00	10.00	41.00	17.11	2.63	1.33
51	77.1	15.00	9.00	39.00	-6.23	1.40	1.27
52	74.4	17.00	6.00	30.00	-0.87	-2.65	1.39
53	80.0	14.00	8.00	33.00	-7.47	0.10	1.87
54	78.6	16.00	7.00	29.00	-2.87	-1.28	1.38
55	90.6	10.00	7.00	23.00	-14.59	-1.13	3.46
56	76.4	10.00	8.00	27.00	-16.37	0.15	3.18
57	71.2	13.00	11.00	32.00	-12.07	4.07	1.67
58	72.9	10.00	11.00	24.00	-18.14	4.13	2.52
59	84.4	14.00	14.00	38.00	-10.11	8.18	1.40
60	78.9	13.00	8.00	32.00	-9.75	0.11	1.98
61	72.6	16.00	7.00	38.00	-3.71	-1.30	1.10
62	77.9	14.00	11.00	40.00	-9.28	4.10	2.36
63	77.6	16.00	10.00	38.00	-4.54	2.73	2.24
64	75.6	16.00	10.00	43.00	-4.81	2.72	1.12
65	81.5	4.00	14.00	25.00	-32.10	8.32	1.99
66	79.2	8.00	14.00	25.00	-23.53	8.23	3.39
67	84.2	18.00	8.00	44.00	1.84	0.05	1.23
68	79.2	15.00	11.00	36.00	-6.99	4.09	2.31
69	75.7	12.00	7.00	30.00	-11.70	-1.23	1.77
70	84.5	44.00	35.00	90.00	44.66	35.87	1.14
71	79.9	20.00	12.00	48.00	3.33	5.36	1.19
72	80.0	15.00	9.00	31.00	-5.85	1.42	2.52
73	76.6	15.00	9.00	29.00	-6.29	1.40	2.38
74	82.6	16.00	13.00	36.00	-5.42	6.78	2.35
75	81.9	18.00	15.00	40.00	-2.23	9.43	1.20
76	89.1	18.00	15.00	42.00	-1.11	9.49	1.87
77	82.2	18.00	18.00	48.00	-3.77	13.46	1.77
78	73.7	15.00	12.00	42.00	-8.16	5.39	1.40
79	101.5	23.00	19.00	55.00	10.80	14.94	2.93
80	86.2	20.00	18.00	47.00	1.24	13.47	1.17
81	75.4	13.00	6.00	30.00	-9.13	-2.58	1.76
82	73.1	14.00	19.00	44.00	-13.81	14.75	1.14
83	77.5	15.00	8.00	32.00	-5.67	0.07	1.27
84	76.7	16.00	12.00	33.00	-5.69	5.40	1.56
85	75.1	14.00	13.00	32.00	-10.60	6.76	1.77
86	77.4	8.00	21.00	34.00	-27.20	17.58	0.89
87	84.4	16.00	12.00	36.00	-4.66	5.45	1.41
88	80.9	14.00	10.00	37.00	-8.41	2.78	1.04
89	87.5	25.00	28.00	62.00	7.20	26.85	0.89
90	77.1	17.00	7.00	30.00	-0.96	-1.30	1.53
91	86.3	13.00	13.00	33.00	-11.57	6.87	2.76
92	85.0	25.00	14.00	44.00	14.21	7.99	2.27
93	85.4	16.00	19.00	42.00	-8.27	14.87	1.61
94	75.1	12.00	15.00	43.00	-15.81	9.46	1.05

SAM NO	H#	3H CPM	14C CPM	WIDE CPM	3H DPM	14C DPM	LUMEX %
269	77.4	9.00	14.00	28.00	-21.49	8.20	1.25
270	79.0	24.00	11.00	46.00	12.24	3.94	1.07
271	84.0	11.00	9.00	26.00	-14.08	1.51	2.46
272	81.2	16.00	5.00	31.00	-1.43	-3.96	1.82
273	86.3	12.00	10.00	30.00	-12.18	2.85	1.83
274	89.3	12.00	14.00	39.00	-14.05	8.26	3.53
275	75.8	15.00	9.00	34.00	-6.39	1.40	1.59
276	76.7	14.00	12.00	39.00	-9.93	5.43	1.77
277	79.0	21.00	3.00	32.00	9.97	-6.72	1.17
278	78.3	16.00	11.00	33.00	-4.97	4.07	0.98
279	77.9	10.00	12.00	29.00	-18.30	5.51	1.58
280	88.5	11.00	13.00	28.00	-15.83	6.92	1.72
281	78.0	11.00	11.00	32.00	-15.65	4.15	1.47
282	81.4	19.00	9.00	41.00	3.00	1.36	0.86
283	120.8	11.00	14.00	31.00	-13.00	8.58	3.34
284	90.9	14.00	15.00	40.00	-9.90	9.58	2.05
285	85.8	16.00	9.00	38.00	-2.84	1.43	1.69
286	84.3	7.00	16.00	35.00	-26.57	10.98	1.74
287	91.8	10.00	10.00	29.00	-16.15	2.92	2.48
288	86.7	20.00	7.00	36.00	7.29	-1.32	1.43
289	83.4	15.00	19.00	43.00	-10.69	14.86	2.29
290	97.0	13.00	7.00	32.00	-6.89	-1.16	2.09
291	89.7	12.00	8.00	28.00	-10.71	0.17	2.00
292	86.1	15.00	10.00	36.00	-5.54	2.80	1.34
293	83.6	26.00	8.00	46.00	19.25	-0.09	1.31
294	86.8	13.00	7.00	36.00	-8.28	-1.20	1.05
295	86.5	10.00	13.00	41.00	-18.22	6.92	1.29
296	91.8	12.00	11.00	34.00	-12.13	4.23	2.24
297	107.8	11.00	13.00	35.00	-13.91	7.09	2.11
298	82.4	12.00	11.00	34.00	-13.11	4.17	0.98
299	92.1	9.00	8.00	24.00	-17.29	0.24	1.96
300	82.9	10.00	4.00	24.00	-13.71	-5.19	2.37
301	106.0	15.00	7.00	26.00	-0.56	-1.17	8.41
302	106.7	14.00	16.00	42.00	-8.41	11.10	3.20
303	88.5	12.00	11.00	40.00	-12.49	4.21	1.67
304	83.6	20.00	11.00	41.00	4.53	4.04	1.53
305	82.2	22.00	14.00	42.00	7.04	8.02	1.39
306	80.4	13.00	11.00	29.00	-11.15	4.14	1.82
307	85.2	17.00	14.00	35.00	-3.40	8.13	1.66
308	89.5	14.00	11.00	37.00	-7.87	4.18	1.46
309	79.7	16.00	16.00	42.00	-7.38	10.78	1.44
310	87.1	13.00	13.00	35.00	-11.49	6.87	2.18
311	79.8	10.00	10.00	26.00	-17.13	2.84	2.20
312	81.4	24.00	6.00	41.00	15.41	-2.75	1.22
313	79.5	19.00	24.00	54.00	-5.11	21.45	0.77
314	107.8	16.00	16.00	48.00	-3.26	11.07	1.53
315	85.9	19.00	10.00	40.00	3.29	2.72	1.00
316	81.8	17.00	6.00	31.00	0.31	-2.63	1.99
317	87.6	22.00	8.00	37.00	11.40	-0.01	2.47
318	91.9	15.00	16.00	42.00	-8.05	10.92	1.56
319	84.2	19.00	16.00	45.00	-0.22	10.77	1.38
320	91.9	16.00	18.00	42.00	-6.89	13.60	2.14
321	111.1	14.00	17.00	37.00	-8.40	12.52	1.74
322	81.5	15.00	11.00	34.00	-6.69	4.11	1.70
323	86.6	84.00	121.00	215.00	87.93	150.90	0.41
324	94.0	17.00	12.00	41.00	-0.89	5.51	2.11
325	83.6	13.00	8.00	28.00	-9.21	0.13	2.00
326	84.3	10.00	15.00	34.00	-19.45	9.59	2.29

SAM NO	H#	3H CPM	14C CPM	WIDE CPM	3H DPM	14C DPM	LUMEX %
211	83.4	18.00	11.00	38.00	0.11	4.07	2.54
212	91.7	15.00	6.00	30.00	-2.51	-2.57	1.58
213	79.1	18.00	10.00	34.00	-0.06	2.70	2.10
214	90.0	16.00	11.00	36.00	-3.27	4.15	2.19
215	83.7	14.00	8.00	35.00	-7.00	0.11	3.83
216	87.8	15.00	5.00	26.00	-2.59	-3.92	8.07
217	80.4	17.00	10.00	41.00	-2.01	2.73	1.52
218	77.8	16.00	9.00	39.00	-4.00	1.39	1.29
219	82.2	19.00	15.00	44.00	-0.02	9.41	1.17
220	86.0	14.00	15.00	38.00	-10.47	9.54	1.89
221	79.3	18.00	16.00	45.00	-3.14	10.74	1.30
222	86.5	10.00	13.00	32.00	-18.22	6.92	1.90
223	82.2	16.00	7.00	32.00	-2.32	-1.27	1.58
224	72.1	13.00	10.00	33.00	-11.48	2.75	1.29
225	79.4	12.00	12.00	34.00	-13.92	5.49	2.55
226	80.3	13.00	8.00	29.00	-9.60	0.11	2.36
227	87.6	16.00	9.00	33.00	-2.56	1.44	1.97
228	82.4	8.00	6.00	21.00	-19.18	-2.48	2.72
229	81.6	14.00	7.00	29.00	-6.75	-1.24	2.74
230	84.6	14.00	7.00	26.00	-6.35	-1.23	1.42
231	84.5	13.00	6.00	31.00	-8.03	-2.55	1.28
232	87.3	8.00	14.00	30.00	-23.17	8.31	1.99
233	80.7	12.00	9.00	34.00	-12.23	1.47	1.75
234	75.4	16.00	9.00	35.00	-4.34	1.38	1.45
235	78.6	19.00	9.00	33.00	2.52	1.35	1.51
236	83.8	12.00	8.00	27.00	-11.38	0.15	2.07
237	77.1	14.00	8.00	30.00	-7.83	0.08	1.01
238	79.9	10.00	13.00	36.00	-18.68	6.86	1.69
239	79.5	14.00	13.00	39.00	-10.14	6.79	1.29
240	80.5	18.00	8.00	32.00	1.21	0.03	2.27
241	81.5	16.00	9.00	33.00	-3.48	1.41	1.88
242	80.4	21.00	4.00	35.00	9.74	-5.38	3.02
243	81.5	16.00	8.00	35.00	-2.96	0.07	1.76
244	84.5	17.00	17.00	43.00	-5.10	12.16	1.37
245	87.0	24.00	7.00	41.00	16.25	-1.39	1.27
246	80.3	12.00	9.00	29.00	-12.27	1.47	1.63
247	80.1	15.00	11.00	40.00	-6.88	4.10	1.63
248	89.4	14.00	13.00	37.00	-8.98	6.87	2.47
249	81.9	19.00	14.00	41.00	0.46	8.07	1.78
250	78.0	13.00	6.00	27.00	-8.82	-2.57	2.39
251	78.0	11.00	10.00	27.00	-15.14	2.81	2.11
252	71.9	15.00	10.00	38.00	-7.36	2.71	0.84
253	86.1	30.00	16.00	60.00	24.48	10.60	1.67
254	81.6	106.00	82.00	195.00	153.29	97.81	0.17
255	81.7	27.00	14.00	51.00	17.78	7.93	0.71
256	75.6	13.00	22.00	41.00	-17.22	18.81	0.82
257	82.1	392.00	512.00	912.00	548.88	669.94	0.07
258	89.2	17.00	13.00	46.00	-2.24	6.82	1.26
259	84.2	250.00	398.00	658.00	303.48	519.94	0.15
260	83.4	23.00	15.00	48.00	8.92	9.36	1.31
261	98.6	19.00	19.00	48.00	0.59	14.98	1.54
262	91.3	20.00	12.00	45.00	5.48	5.43	2.52
263	81.5	19.00	7.00	34.00	4.07	-1.32	1.20
264	92.1	23.00	14.00	48.00	11.40	8.08	1.44
265	85.6	19.00	6.00	32.00	5.39	-2.65	1.54
266	139.5	11.00	22.00	40.00	-16.38	19.92	12.27
267	78.6	25.00	11.00	45.00	14.28	3.92	0.84
268	103.5	14.00	13.00	36.00	-7.07	6.99	4.19

SAM NO	H#	3H CPM	14C CPM	WIDE CPM	3H DPM	14C DPM	LUMEX %
153	81.6	20.00	14.00	45.00	2.58	8.05	1.43
154	80.1	14.00	16.00	45.00	-11.63	10.82	1.16
155	72.7	8.00	12.00	27.00	-22.80	5.50	1.22
156	76.4	15.00	12.00	40.00	-7.84	5.41	1.66
157	79.4	18.00	11.00	34.00	-0.53	4.05	1.49
158	86.1	17.00	13.00	39.00	-2.72	6.79	1.92
159	77.9	14.00	6.00	29.00	-6.70	-2.59	1.90
160	84.4	13.00	10.00	34.00	-10.17	2.82	1.33
161	89.9	14.00	11.00	37.00	-7.82	4.18	3.12
162	91.6	10.00	13.00	32.00	-17.83	6.96	3.08
163	82.8	16.00	11.00	38.00	-4.35	4.10	1.70
164	78.6	15.00	12.00	37.00	-7.57	5.43	2.84
165	97.2	15.00	4.00	24.00	-0.44	-5.26	4.20
166	82.2	15.00	10.00	34.00	-6.07	2.77	3.27
167	86.0	18.00	8.00	38.00	2.16	0.05	0.92
168	89.8	15.00	16.00	44.00	-8.32	10.90	1.44
169	81.7	14.00	4.00	28.00	-5.17	-5.26	3.04
170	79.4	10.00	2.00	19.00	-13.02	-7.88	3.99
171	88.6	11.00	3.00	29.00	-10.35	-6.55	2.70
172	82.7	13.00	5.00	24.00	-7.73	-3.90	1.88
173	81.7	17.00	13.00	43.00	-3.38	6.76	1.85
174	83.7	16.00	8.00	32.00	-2.63	0.08	1.69
175	85.0	13.00	11.00	33.00	-10.64	4.17	2.24
176	82.9	20.00	8.00	42.00	5.99	0.01	1.93
177	84.7	11.00	6.00	27.00	-12.40	-2.52	3.49
178	90.3	112.00	73.00	193.00	180.09	86.00	0.68
179	83.1	15.00	8.00	35.00	-4.90	0.09	1.69
180	78.9	11.00	10.00	36.00	-15.06	2.82	1.15
181	87.7	10.00	7.00	25.00	-14.87	-1.15	2.55
182	87.3	13.00	8.00	28.00	-8.75	0.15	2.83
183	88.7	12.00	10.00	30.00	-11.93	2.86	2.59
184	101.7	37.00	9.00	56.00	50.56	1.10	2.77
185	83.9	18.00	13.00	33.00	-0.87	6.76	1.56
186	78.3	14.00	6.00	28.00	-6.66	-2.59	2.13
187	78.0	12.00	13.00	34.00	-14.55	6.81	1.18
188	84.0	57.00	61.00	126.00	59.13	70.56	0.57
189	91.8	20.00	8.00	42.00	7.81	0.04	1.79
190	101.3	20.00	16.00	48.00	5.28	10.93	2.22
191	107.5	8.00	16.00	34.00	-23.29	11.23	6.09
192	102.0	16.00	14.00	36.00	-3.04	8.30	2.97
193	82.5	20.00	12.00	38.00	3.80	5.37	1.52
194	79.4	12.00	11.00	39.00	-13.40	4.15	1.56
195	78.5	16.00	11.00	34.00	-4.93	4.07	1.58
196	82.3	16.00	10.00	37.00	-3.89	2.76	1.58
197	81.3	13.00	11.00	32.00	-11.05	4.14	0.96
198	81.2	13.00	14.00	33.00	-12.63	8.16	3.58
199	94.7	9.00	20.00	38.00	-23.88	16.47	1.61
200	80.2	20.00	7.00	35.00	5.98	-1.34	1.64
201	78.8	20.00	6.00	37.00	6.24	-2.69	1.29
202	75.1	12.00	9.00	29.00	-12.77	1.44	2.15
203	70.5	14.00	8.00	30.00	-8.60	0.05	1.51
204	80.5	19.00	11.00	45.00	1.81	4.04	1.35
205	75.8	15.00	11.00	32.00	-7.41	4.07	1.39
206	84.4	17.00	11.00	36.00	-1.92	4.09	2.34
207	83.2	12.00	9.00	39.00	-11.97	1.49	1.52
208	77.4	17.00	10.00	34.00	-2.45	2.71	2.74
209	87.7	17.00	10.00	36.00	-0.86	2.77	6.13
210	74.7	16.00	15.00	39.00	-7.46	9.39	1.24

SAM NO	H#	3H CPM	14C CPM	WIDE CPM	3H DPM	14C DPM	LUMEX %
95	79.3	19.00	11.00	34.00	1.60	4.03	1.30
96	80.4	14.00	10.00	31.00	-8.47	2.78	1.96
97	83.7	16.00	8.00	37.00	-2.63	0.08	1.82
98	80.3	61.00	102.00	175.00	44.81	125.31	0.27
99	82.4	13.00	6.00	27.00	-8.29	-2.56	2.47
100	79.1	19.00	13.00	41.00	0.52	6.71	1.17
101	82.1	12.00	12.00	36.00	-13.67	5.51	1.68
102	78.4	16.00	13.00	41.00	-5.99	6.75	1.35
103	85.0	22.00	9.00	36.00	10.27	1.32	2.64
104	80.6	14.00	12.00	34.00	-9.49	5.46	1.79
105	78.2	13.00	5.00	25.00	-8.29	-3.91	2.27
106	78.5	12.00	15.00	33.00	-15.54	9.50	1.32
107	78.8	19.00	18.00	51.00	-2.11	13.40	0.82
108	74.6	17.00	10.00	36.00	-2.86	2.70	1.62
109	84.9	17.00	8.00	37.00	-0.24	0.07	3.68
110	82.5	16.00	7.00	30.00	-2.27	-1.27	2.32
111	79.2	17.00	17.00	43.00	-5.81	12.10	2.40
112	77.6	6.00	7.00	22.00	-24.26	-1.12	2.61
113	83.9	16.00	15.00	41.00	-6.32	9.48	1.54
114	79.2	144.00	46.00	198.00	251.19	48.83	0.43
115	79.8	20.00	9.00	40.00	4.88	1.34	2.28
116	80.5	13.00	14.00	37.00	-12.70	8.16	3.32
117	84.0	19.00	24.00	48.00	-4.51	21.52	1.57
118	85.1	12.00	12.00	30.00	-13.37	5.53	1.39
119	90.1	11.00	11.00	27.00	-14.58	4.24	5.97
120	86.9	14.00	9.00	29.00	-7.12	1.47	2.33
121	84.5	16.00	17.00	43.00	-7.31	12.17	1.75
122	85.7	15.00	12.00	35.00	-6.68	5.48	0.97
123	80.7	14.00	8.00	32.00	-7.39	0.10	1.77
124	76.2	21.00	11.00	41.00	5.30	3.98	1.26
125	84.5	10.00	11.00	29.00	-17.30	4.22	1.54
126	85.4	21.00	15.00	38.00	4.93	9.41	1.79
127	79.1	15.00	9.00	32.00	-5.96	1.41	2.47
128	85.4	12.00	11.00	27.00	-12.81	4.19	2.22
129	85.2	19.00	10.00	41.00	3.16	2.72	1.80
130	79.4	19.00	16.00	41.00	-0.99	10.73	2.73
131	79.6	14.00	8.00	30.00	-7.53	0.09	2.80
132	99.4	11.00	5.00	25.00	-10.14	-3.83	3.87
133	93.8	6.00	12.00	31.00	-26.33	5.71	6.19
134	87.9	17.00	14.00	41.00	-2.99	8.15	2.56
135	89.2	9.00	19.00	34.00	-23.57	15.04	2.70
136	81.3	8.00	8.00	24.00	-20.30	0.20	2.31
137	85.7	15.00	17.00	40.00	-9.37	12.20	1.27
138	84.6	8.00	9.00	26.00	-20.62	1.56	1.56
139	83.3	14.00	14.00	37.00	-10.24	8.17	2.72
140	85.9	13.00	12.00	37.00	-11.08	5.52	1.58
141	81.1	17.00	4.00	27.00	1.24	-5.31	1.37
142	82.7	20.00	8.00	36.00	5.94	0.01	1.50
143	85.6	14.00	14.00	37.00	-9.97	8.19	1.42
144	81.9	20.00	13.00	46.00	3.15	6.71	1.54
145	77.6	12.00	9.00	29.00	-12.53	1.46	2.22
146	77.4	13.00	11.00	32.00	-11.46	4.12	2.58
147	82.0	16.00	7.00	34.00	-2.35	-1.27	1.76
148	78.8	13.00	17.00	33.00	-14.41	12.16	2.56
149	81.2	10.00	10.00	22.00	-17.03	2.85	2.56
150	79.6	19.00	7.00	39.00	3.72	-1.33	1.58
151	82.1	14.00	12.00	37.00	-9.32	5.47	1.38
152	77.6	13.00	7.00	29.00	-9.38	-1.24	0.85

ID:WIPE SURVEY

27 JUL 2000 10:40

USER: 3 COMMENT: DECOMMISSION

PRESET TIME : 1.00
 DATA CALC : DL DPM H# : YES SAMPLE REPEATS: 1 PRINTER : EDIT
 COUNT BLANK : YES IC# : NO REPLICATES : 1 RS232 : EDIT
 TWO PHASE : NO AQC : YES CYCLE REPEATS : 1
 SCINTILLATOR: LIQUID LUMEX: YES LOW SAMPLE REJ: 0
 LOW LEVEL : NO HALF LIFE CORRECTION DATE: none

ISOTOPE 1: 3H %ERROR: 2.00 FACTOR: 1.0000 BKG. SUB: 0
 ISOTOPE 2: 14C %ERROR: 2.00 FACTOR: 1.0000 BKG. SUB: 0
 WIDE OPEN WINDOW %ERROR: 0.00 FACTOR: 1.0000 BKG. SUB: 0

BACKGROUND QUENCH CURVE: Off COLOR QUENCH CORRECTION: Off

Quench Limits Low: 13.688 High: 306.34

SAM NO	H#	3H CPM	14C CPM	WIDE CPM	3H DPM	14C DPM	LUMEX %	
B1	66.1	15.00	8.00	33.00	26.36	10.41	3.33	
		Blank Average	DPM	for	3H :	26.36	COEF. OF VAR:	0.000
		Blank Average	DPM	for	14C :	10.41	COEF. OF VAR:	0.000

30	1	71.8	18.00	13.00	45.00	4.39	6.65	4.91
	2	73.3	20.00	19.00	47.00	5.75	14.64	5.64
	3	70.5	18.00	8.00	31.00	6.67	-0.03	5.33
	4	67.9	20.00	8.00	37.00	10.36	-0.07	3.75
	5	67.3	11.00	15.00	38.00	-11.36	9.39	3.50
	6	73.9	17.00	11.00	39.00	3.61	4.01	6.37
	7	73.5	9.00	11.00	33.00	-13.13	4.14	3.62
	8	85.0	23.00	8.00	39.00	20.06	-0.05	9.34
	9	85.4	17.00	8.00	37.00	6.91	0.05	8.34
	10	67.9	15.00	16.00	39.00	-3.68	10.66	2.03
300	11	71.7	16.00	8.00	31.00	2.72	0.01	3.40
	12	70.6	17.00	19.00	50.00	-0.80	14.66	5.56
	13	74.1	33.00	16.00	55.00	34.56	10.43	6.96
	14	70.4	15.00	14.00	35.00	-2.46	8.02	8.90
	15	72.8	20.00	10.00	45.00	10.18	2.62	3.58
355	16	71.2	27.00	7.00	40.00	25.84	-1.50	1.37
	17	65.6	17.00	7.00	35.00	4.45	-1.36	2.06
	18	70.7	11.00	16.00	35.00	-11.64	10.75	3.41
	19	73.6	24.00	30.00	65.00	8.62	29.27	2.82
357	20	68.2	15.00	11.00	41.00	-1.22	4.00	3.56

35	73.9	13.00	11.00	36.00	4.75	4.07	6.24	
MISSING SAMPLE								
37	81.2	329.00	145.00	483.00	609.25	178.50	0.77	
38	80.9	16.00	13.00	43.00	1.40	6.75	2.58	
39	77.8	19.00	13.00	37.00	7.37	6.68	6.49	
40	85.8	28.00	19.00	61.00	25.40	14.65	3.40	
41	74.6	17.00	9.00	35.00	4.71	1.34	5.26	
MISSING SAMPLE								
46	INVALID SAMPLE COUNT: H# ABORT: COUNT RATE TOO LOW							

Handwritten marks and scribbles at the top right corner.

