

Radiological Survey Sheet

Job Location Pfizer Central Research Groton, CT Page 1 of 7

Survey Purpose Decommissioning Lab Room B 317 Date 5/10/00

Performed By John Purcell (Print) John Purcell (Sign)

Inst.(1) Beckman LS 6500 (Model/SN) #7069448	Inst.(2) Ludlum model 2241-2 (Model/SN) # 163603	Inst.(3) (Model/SN)
Det. Internal (Model/SN)	Det. Ludlum model 43-68 (Model/SN) # 149613	Det. (Model/SN)
Eff. See LSC Printout	Eff. = 8% C-14	Eff.
Type rad. β	Type rad. β	Type rad.
Bkgd. See LSC Printout	Bkgd. 300cpm	Bkgd.
Cal. Due: 12/00	Cal. Due 2/01	Cal. due

No.	Time	Location	Inst. Used	Total Activity (dpm/100 cm ²)
1.	0930	FLOOR	1	See attached LSC Printout
2.		Yellow Box	1	
3.		Bucket	1	
4.		White Box	1	
5.		Wooden Box	1	
6.		Flexiglass container	1	
7.		TRAY	1	
8.		"	1	
9.		"	1	
10.		Fesk	1	
11.		Wooden Box	1	
12.		Black TRAY	1	
13.		FLOOR	1	
14.		FLOOR	1	
15.		"	1	
16.		"	1	
17.		FLOOR	1	
18.		FLOOR	1	

Radiological Survey Continuation Sheet

Page 2 of 7

Date 5/10/00

No.	Time	Location	Inst. Used	Total Activity (dpm/100 cm ²)	Comments
19		Desk Top	1		
20		Drawer	1		
21		Upper Wall	1		
22		Lower "	1		
23		Upper "	1		
24		Lower Wall	1		
25		Upper "	1		
26		Lower "	1		
27		Wall at wall top	1		
28		Wall Wall	1		
29		Upper "	1		
30		Lower Wall	1		
31		Upper "	1		
32		Lower Wall	1		
33		Wall	1		
34		"	1		
35		Upper Wall	1		
36		Lower Wall	1		
37		Wall	1		
38		Wall	1		
39		Wall	1		
40		Stand Top Shelf	1		
41		Stand Shelf	1		
42		cabinet End	1		
43		Ⓞ side sink	1		
44		DRAIN	1		
45		Ⓜ side sink	1		
46	✓	SINK BACK	1	↓	

Radiological Survey Continuation Sheet

Page 3 of 7

Date 5/10/00

No.	Time	Location	Inst. Used	Total Activity (dpm/100 cm ²)	Comments
47		Top Shelf	1		
48		shelf	1		
49		under sink	1		
50		Cabinet End	1		
51		White Counter Top	1		
52		Cabinet side	1		
53		cabinet side	1		
54		Counter	1		
55		Front of Drawers	1		
56		Top Drawer	1		
57		Drawer	1		
58		Top shelf Cabinet	1		
59		Shelf	1		
60		Upper Wall	1		
61		Lower wall	1		
62		Wall	1		
63		"	1		
64		"	1		
65		Wall	1		
66		"	1		
67		Wall	1		
68		Counter	1		
69		"	1		
70		"	1		
71		Counter	1		
72		Cabinet End	1		
73		outer Cabinet	1		
74	✓	TOP Drawer	1	↓	

Job Location: Pfizer Central Research Groton CT Page: 5 of 7
 Survey Purpose: Decommissioning DARK Room B.317 Date: 5/16/00
 Performed By: John Purcell

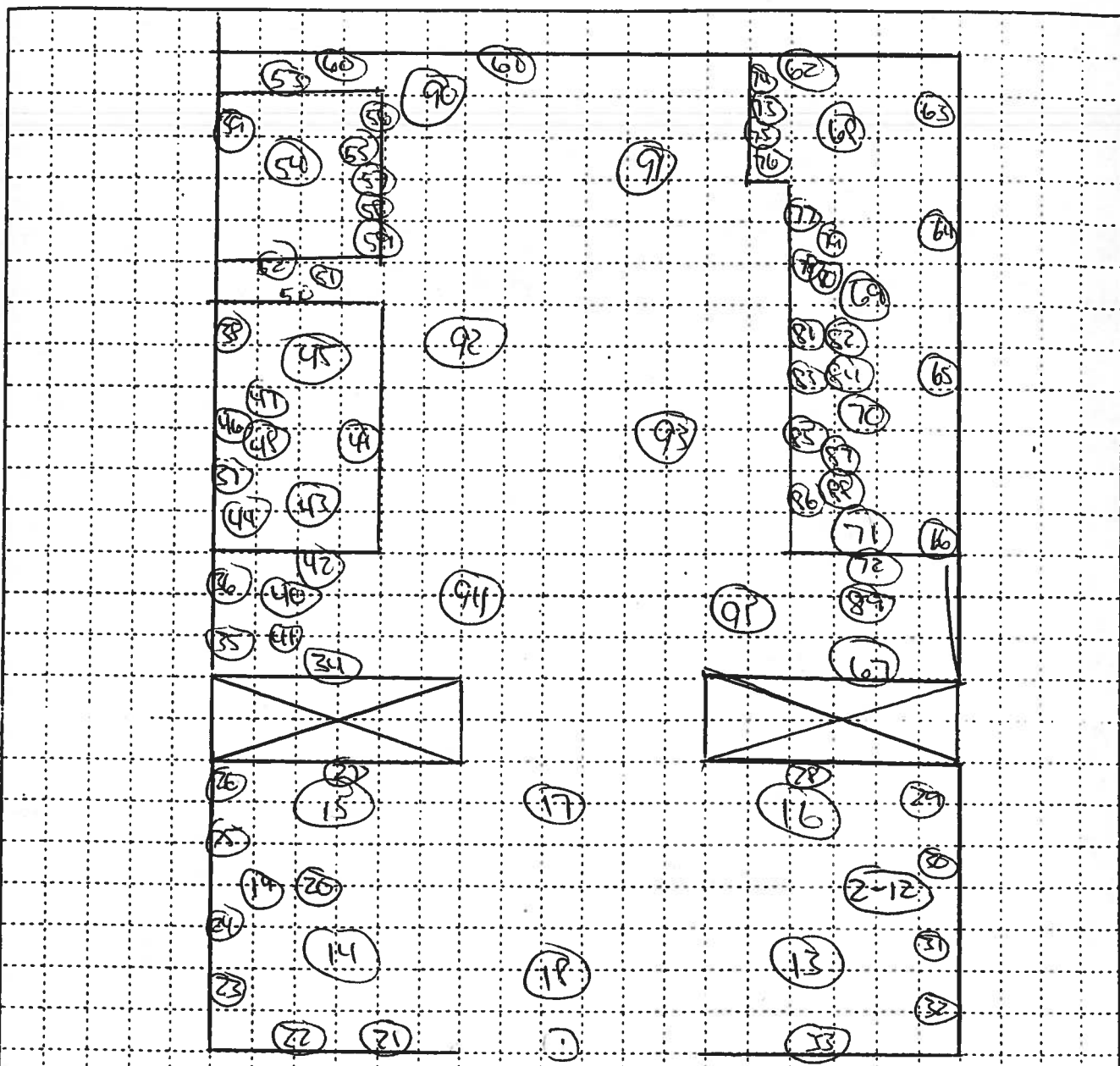

Surveyed 100% of Lower Surfaces using mist #2. All surfaces surveyed were noted to be at normal background levels.

- Swipe
 - Air Sample
- Meter Reading = Rad Survey in $\mu\text{rem/h}$

ID: EQUIPMENT SURVY 11 MAY 2000 00:46
 USER: 2 COMMENT:
 PRESET TIME : 1.00
 DATA CALC : DL DPM H# : YES SAMPLE REPEATS: 1 PRINTER : EDIT
 COUNT BLANK : YES IC# : NO REPLICATES : 1 RS232 : EDIT
 TWO PHASE : NO ADC : YES CYCLE REPEATS : 1
 SCINTILLATOR: LIQUID LUMEX: YES LOW SAMPLE REJ: 0
 LOW LEVEL : NO HALF LIFE CORRECTION DATE: none

ISOTOPE 1: 3H %ERROR: 2.00 FACTOR: 1.000000 BKG. SUB: 0
 ISOTOPE 2: 14C %ERROR: 2.00 FACTOR: 1.000000 BKG. SUB: 0
 WIDE OPEN WINDOW %ERROR: 0.00 FACTOR: 1.000000 BKG. SUB: 0

BACKGROUND QUENCH CURVE: Off COLOR QUENCH CORRECTION: Off

Quench Limits Low: 2.756 High: 314.54

SAM NO	H#	3H CPM	14C CPM	WIDE CPM	3H DPM	14C DPM	LUMEX %
B1	89.1	17.00	15.00	42.00	27.10	20.10	7.81
1	83.7	25.00	9.00	45.00	18.41	-8.25	8.45
2	97.5	17.00	7.00	35.00	5.56	-10.80	9.69
3	89.9	17.00	7.00	35.00	4.33	-10.83	7.53
4	94.0	21.00	10.00	41.00	11.80	-6.79	11.31
5	92.2	21.00	11.00	45.00	10.92	-5.44	7.52
6	87.2	25.00	10.00	53.00	18.66	-6.88	6.42
7	97.0	21.00	10.00	38.00	12.41	-6.77	6.81
8	89.7	15.00	20.00	45.00	-6.69	6.80	6.16
9	94.0	21.00	13.00	45.00	10.18	-2.72	10.71
10	93.0	13.00	6.00	31.00	-3.04	-12.12	8.22
11	97.9	21.00	16.00	45.00	9.26	1.40	9.01
12	89.5	22.00	11.00	49.00	12.48	-5.47	6.75
13	90.2	20.00	6.00	35.00	11.11	-12.22	6.93
14	107.8	16.00	12.00	34.00	2.21	-3.90	10.10
15	93.8	15.00	15.00	39.00	-3.59	0.07	5.65
16	90.3	18.00	4.00	27.00	8.05	-14.90	9.44
17	94.6	20.00	10.00	41.00	9.80	-6.77	8.13
18	92.9	17.00	6.00	43.00	5.34	-12.17	13.75
19	96.5	12.00	17.00	43.00	-10.79	2.86	8.34
20	116.0	12.00	12.00	37.00	-5.94	-3.77	20.07
21	91.8	15.00	11.00	37.00	-1.68	-5.37	5.72
22	88.6	17.00	17.00	53.00	-1.11	2.70	6.74
23	84.9	18.00	9.00	38.00	4.56	-8.16	7.01
24	86.7	22.00	11.00	44.00	11.94	-5.49	8.34
25	87.1	13.00	7.00	29.00	-4.25	-10.79	10.99
26	89.4	16.00	14.00	43.00	-1.49	-1.34	9.23
27	84.9	17.00	12.00	47.00	1.01	-4.09	5.52
28	91.5	16.00	5.00	27.00	3.56	-13.52	11.05
29	89.3	17.00	6.00	33.00	4.76	-12.18	5.94
30	88.6	16.00	18.00	45.00	-3.69	4.07	10.21
31	88.7	18.00	13.00	39.00	3.05	-2.72	7.26
32	94.5	15.00	12.00	40.00	-1.88	-3.99	6.15
33	82.3	19.00	12.00	37.00	4.65	-4.14	7.78
34	85.9	17.00	6.00	37.00	4.24	-12.19	9.03
35	88.9	24.00	9.00	42.00	17.51	-8.21	7.97
36	90.2	16.00	15.00	48.00	-1.93	0.02	8.64
37	85.6	17.00	13.00	34.00	0.59	-2.74	7.14
38	85.5	22.00	12.00	44.00	11.19	-4.15	8.75

SAM NO	H#	3H CPM	14C CPM	WIDE CPM	3H DPM	14C DPM	LUMEX %
39	85.8	11.00	15.00	33.00	-12.56	0.04	11.35
40	88.4	20.00	8.00	46.00	9.73	-9.52	9.61
41	86.2	16.00	7.00	39.00	1.73	-10.83	8.90
42	94.7	13.00	10.00	31.00	-5.00	-6.68	13.82
43	105.5	17.00	13.00	43.00	3.50	-2.57	3.64
44	101.3	14.00	12.00	34.00	-3.18	-3.93	8.91
45	124.1	11.00	10.00	29.00	-6.09	-6.45	7.41
46	92.2	7.00	11.00	25.00	-18.36	-5.27	14.79
47	94.5	16.00	7.00	36.00	2.95	-10.80	12.52
48	92.9	14.00	8.00	34.00	-2.03	-9.42	9.70
49	111.1	25.00	10.00	46.00	24.82	-6.74	13.87
50	89.4	25.00	15.00	51.00	16.54	-0.10	5.24
51	87.1	11.00	9.00	28.00	-9.37	-8.06	10.32
52	84.8	18.00	11.00	41.00	3.52	-5.46	8.38
53	91.4	16.00	15.00	42.00	-1.79	0.04	8.15
54	86.2	15.00	15.00	42.00	-4.42	-0.00	6.14
55	90.3	18.00	7.00	41.00	6.47	-10.84	3.50
56	88.5	23.00	9.00	41.00	15.38	-8.20	6.26
57	88.7	22.00	13.00	50.00	11.27	-2.77	11.43
58	90.2	18.00	5.00	38.00	7.50	-13.55	9.12
59	93.0	17.00	11.00	35.00	2.67	-5.39	10.98
60	88.3	23.00	11.00	45.00	14.28	-5.49	5.33
61	86.4	14.00	5.00	26.00	-1.26	-13.51	13.66
62	85.1	20.00	8.00	42.00	9.14	-9.53	7.75
63	94.3	19.00	13.00	41.00	6.01	-2.69	7.72
64	85.4	16.00	12.00	35.00	-0.94	-4.08	9.45
65	88.8	21.00	9.00	41.00	11.33	-8.17	8.16
66	85.5	16.00	6.00	32.00	2.15	-12.18	6.54
67	92.6	24.00	13.00	51.00	16.19	-2.77	4.97
68	90.3	23.00	13.00	42.00	13.64	-2.77	7.03
69	88.9	21.00	5.00	37.00	13.44	-13.59	7.51
70	90.5	15.00	9.00	35.00	-0.78	-8.09	5.61
71	88.2	15.00	12.00	36.00	-2.64	-4.04	9.32
72	91.3	13.00	5.00	30.00	-2.71	-13.48	17.58
73	88.6	19.00	11.00	42.00	6.14	-5.44	7.67
74	89.4	12.00	9.00	37.00	-7.11	-8.06	10.21
75	90.4	18.00	11.00	35.00	4.35	-5.42	8.98
76	92.2	19.00	10.00	33.00	7.27	-6.77	9.50
77	85.2	23.00	16.00	51.00	11.11	1.24	5.90
78	86.5	23.00	12.00	45.00	13.40	-4.15	7.72
79	86.5	16.00	4.00	27.00	3.34	-14.88	10.99
80	107.2	14.00	4.00	25.00	2.29	-14.82	12.32
81	89.0	13.00	11.00	38.00	-6.14	-5.37	9.97
82	88.2	17.00	13.00	39.00	0.93	-2.72	7.95
83	90.1	22.00	14.00	47.00	11.00	-1.41	10.43
84	88.2	15.00	9.00	39.00	-1.07	-8.10	6.83
85	87.0	14.00	16.00	43.00	-6.90	1.37	5.72
86	88.2	17.00	10.00	35.00	2.50	-6.77	7.08
87	91.6	18.00	9.00	36.00	5.62	-8.12	8.38
88	92.4	22.00	7.00	43.00	15.18	-10.88	7.77
89	92.5	28.00	13.00	53.00	24.56	-2.82	3.31
90	94.0	23.00	9.00	39.00	16.57	-8.17	6.12
91	94.7	17.00	15.00	43.00	0.75	0.06	8.68
92	99.0	18.00	5.00	33.00	9.12	-13.53	11.21
93	103.6	18.00	10.00	41.00	7.15	-6.69	4.07
94	105.1	19.00	12.00	38.00	8.51	-3.96	5.12
95	103.8	15.00	10.00	33.00	0.52	-6.65	7.29