

Radiological Survey Sheet

Job Location Pfizer Central Research B 313 Page 1 of 19

Survey Purpose Radiological Assessment Decommissioning Date 4/26/00

Performed By John Porcell John Porcell
(Print) (Sign)

Inst.(1) (Model/SN) Beckman LS 6500 #7069448	Inst.(2) Lullum model 2241-2 (Model/SN) # 163603	Inst.(3) (Model/SN)
Det. Internal (Model/SN)	Det. Lullum model 43-68 (Model/SN) # 149613	Det. (Model/SN)
Eff. See LSC Printout	Eff. = 8% C-14	Eff.
Type rad. β	Type rad. β	Type rad.
Bkgd. See LSC Printout	Bkgd. 300cpm	Bkgd.
Cal. Due: 12/00	Cal. Due 2/13/01	Cal. due

No.	Time	Location	Inst. Used	Total Activity (dpm/100 cm ²)
1.	8:15	Door	1	See attached LSC Printout
2.		Floor	1	
3.		Shelf	1	
4.		Wall	1	
5.		Top shelf	1	
6.		Shelf	1	
7.		Wall	1	
8.		Wall	1	
9.		Floor	1	
10.		Wall	1	
11.		(B) outside Hood	1	
12.		Top " "	1	
13.		(B) outside Hood	1	
14.		Hood Lip	1	
15.		(C) Hood wall	1	
16.		Upper Back Wall	1	
17.		Lower Back Wall	1	
18.	✓	(E) Hood wall	1	

Radiological Survey Continuation Sheet

Page 2 of 18

Date 4/26/00

No.	Time	Location	Inst. Used	Total Activity (dpm/100 cm ²)
19		① Side Hood Counter	1	See attached LSC Printout
20		② Side Hood Counter	1	
21		Cup Sink	1	
22		Hand Sash	1	
23		④ Outer Cabinet	1	
24		⑤ Inner Cabinet	1	
25		⑥ Outer Cabinet	1	
26		⑦ Inner Cabinet	1	
27		Floor	1	
28		Wall	1	
29		File Cabinet	1	
30		Wall	1	
31		Chair Orange	1	
32		Chair Red	1	
33		Outer Wall Unit	1	
34		Top Shelf	1	
35		Shelf	1	
36		Shelf	1	
37		Shelf	1	
38		Outer Wall Unit	1	
39		Top Shelf	1	
40		Shelf	1	
41		Shelf	1	
42		Shelf	1	
43		Computer Shelf	1	
44		Top Shelf	1	
45		Shelf	1	
46	✓	Shelf	1	✓

Radiological Survey Continuation Sheet

Page 3 of 18

Date 4/26/00

No.	Time	Location	Inst. Used	Total Activity (dpm/100 cm ²)
47		Desktop	1	See attached LSC Printout
48		outer Drawers	1	
49		TOP Drawer	1	
50		MIDDLE DRAWER	1	
51		Bottom Drawer	1	
52		Floor	1	
53		Shelf	1	
54		Cup sink	1	
55		Counter	1	
56		Outer Drawers	1	
57		TOP Drawer	1	
58		Drawer	1	
59		Drawer	1	
60		Bottom Drawer	1	
61		outer Drawers	1	
62		TOP DRAWER	1	
63		Drawer	1	
64		Drawer	1	
65		Bottom Drawer	1	
66		Floor	1	
67		Drawer	1	
68		Shelf	1	
69		Cup Sink	1	
70		Counter	1	
71		Counter	1	
72		Outer Drawers	1	
73		Top Drawer	1	
74	↓	Drawer	1	↓

Radiological Survey Continuation Sheet

Page 4 of 18

Date 4/26/00

No.	Time	Location	Inst. Used	Total Activity (dpm/100 cm ²)
75		Drawer	1	See attached LSC Printout
76		Drawer (Bottom)	1	
77		outer Drawer	1	
78		Top Drawer	1	
79		Drawer	1	
80		Drawer	1	
81		Drawer Bottom	1	
82		Floor	1	
83		Cabinet End	1	
84		Floor	1	
85		Floor	1	
86		Glass Drying Rack	1	
87		Faucet	1	
88		Counter	1	
89		Sink	1	
90		Sink Drain	1	
91		outer Cabinet	1	
92		inner Cabinet	1	
93		Wall	1	
94		cup sink	1	
95		Counter	1	
96		Counter	1	
97		Outer wall Unit	1	
98		Top Shelf	1	
99		shelf	1	
100		shelf	1	
101		outer wall Unit	1	
102	✓	Top Shelf	1	↓

Radiological Survey Continuation Sheet

Page 5 of 18

Date 4/26/00

No.	Time	Location	Inst. Used	Total Activity (dpm/100 cm ²)
103		Shelf	1	See attached LSC Printout
104		shelf	1	
105		Shelf	1	
106		Outer Drawers	1	
107		Top Drawer	1	
108		Drawer	1	
109		Drawer	1	
110		Bottom Drawer	1	
111		Outer Drawer	1	
112		Outer Drawer	1	
113		Top Drawer	1	
114		Drawer	1	
115		Drawer	1	
116		Bottom Drawer	1	
117		FLOOR	1	
118		Counter	1	
119		Drawer	1	
120		outer Cabinet	1	
121		Top Shelf cabinet	1	
122		shelf cabinet	1	
123		Counter	1	
124		Counter	1	
125		FLOOR	1	
126		FLOOR	1	
127		FLOOR	1	
128		File Cabinet	1	
129		Drawer	1	
130	↓	Outer Drawers	1	↓

Radiological Survey Continuation Sheet

Page 6 of 18

Date 4/26/00

No.	Time	Location	Inst. Used	Total Activity (dpm/100 cm ²)
131		TOP DRAWER	1	See attached LSC Printout
132		DRAWER	1	
133		DRAWER	1	
134		DRAWER (Bottom)	1	
135		DRAWER	1	
136		OUTER DRAWERS	1	
137		TOP DRAWER	1	
138		DRAWER	1	
139		DRAWER	1	
140		Bottom DRAWER	1	
141		Black Stool	1	
142		orange chair	1	
143		Plexiglass	1	
144		Top shelf	1	
145		shelf	1	
146		shelf	1	
147		Computer shelf	1	
148		Desk	1	
149		DRAWER	1	
150		outer DRAWERS	1	
151		TOP DRAWER	1	
152		DRAWER	1	
153		Bottom DRAWER	1	
154		Wall Unit	1	
155		Top shelf	1	
156		shelf	1	
157		"	1	
158	✓	Bottom Shelf	1	↓

Radiological Survey Continuation Sheet

Page 7 of 18

Date 4/26/00

No.	Time	Location	Inst. Used	Total Activity (dpm/100 cm ²)
159		Wall Unit	1	See attached LSC Printout
160		Top Shelf	1	
161		Shelf	1	
162		"	1	
163		Bottom Shelf	1	
164		Wall Unit	1	
165		Top Shelf	1	
166		Shelf	1	
167		Shelf	1	
168		Bottom shelf	1	
169		Wall	1	
170		Computer shelf	1	
171		Top Shelf	1	
172		Shelf	1	
173		Shelf	1	
174		Desk	1	
175		Drawer	1	
176		Outer Drawers	1	
177		Top Drawer	1	
178		Drawer	1	
179		Bottom Drawer	1	
180		Plexiglass	1	
181		Shelf	1	
182		Cup Sink	1	
183		Counter	1	
184		Outer Drawer	1	
185		Top Drawer	1	
186	↓	Drawer	1	↓

Radiological Survey Continuation Sheet

Page 8 of 15

Date 4/26/00

No.	Time	Location	Inst. Used	Total Activity (dpm/100 cm ²)
187		Drawer	1	See attached LSC Printout
188		Bottom Drawer	1	
189		Drawer	1	
190		Shelf	1	
191		Cup Sink	1	
192		Counter	1	
193		Outer Drawer	1	
194		Top Drawer	1	
195		Drawer	1	
196		Drawer	1	
197		Bottom Drawer	1	
198		Drawer	1	
199		Counter	1	
200		Outer Drawers	1	
201		Top Drawer	1	
202		Drawer	1	
203		Drawer	1	
204		Bottom Drawer	1	
205		Cabinet End	1	
206		Floor	1	
207		Cabinet End	1	
208		Upper wall	1	
209		Lower wall	1	
210		Upper wall	1	
211		Lower wall	1	
212		Floor	1	
213		Floor	1	
214	↓	Floor	1	↓

Radiological Survey Continuation Sheet

Page 9 of B

Date 4/26/00

No.	Time	Location	Inst. Used	Total Activity (dpm/100 cm ²)
215		Counter	1	See attached LSC Printout
216		Drawer	1	
217		Outer Cabinet	1	
218		Top Shelf	1	
219		shelf	1	
220		File Cabinet	1	
221		File Cabinet	1	
222		Counter	1	
223		Counter	1	
224		File Plexiglass	1	
225		Drawer	1	
226		Outer Drawer	1	
227		Top Drawer	1	
228		Drawer	1	
229		Drawer	1	
230		Bottom Drawer	1	
231		Drawer	1	
232		Outer Drawers	1	
233		Top Drawers	1	
234		Drawers	1	
235		Drawers	1	
236		Bottom Drawer	1	
237		Top Shelf	1	
238		shelf	1	
239		shelf	1	
240		Desk	1	
241		wall	1	
242	✓	Drawer	1	✓

Radiological Survey Continuation Sheet

Page 10 of 18

Date 9/26/00

No.	Time	Location	Inst. Used	Total Activity (dpm/100 cm ²)
243		Outer Drawers	1	See attached LSC Printout
244		Top Drawer	1	
245		Drawer	1	
246		Bottom Drawer	1	
247		Wall Unit	1	
248		Top Shelf	1	
249		shelf	1	
250		shelf	1	
251		shelf (Bottom)	1	
252		Orange Chair	1	
253		Red chair	1	
254		Orange Chair	1	
255		" "	1	
256		FLOOR	1	
257		FLOOR	1	
258		FLOOR	1	
259		FLOOR	1	
260		Upper wall	1	
261		Lower wall	1	
262		Upper wall	1	
263		Lower wall	1	
264		Upper wall	1	
265		Lower wall	1	
266		Door	1	
267		Desk	1	
268		Window sill	1	
269		Shelves	1	
270	↓	File Cabinet	1	↓

Bld. 118B Room B313

Date: 4/26/00

○ = WIRE LOCATIONS

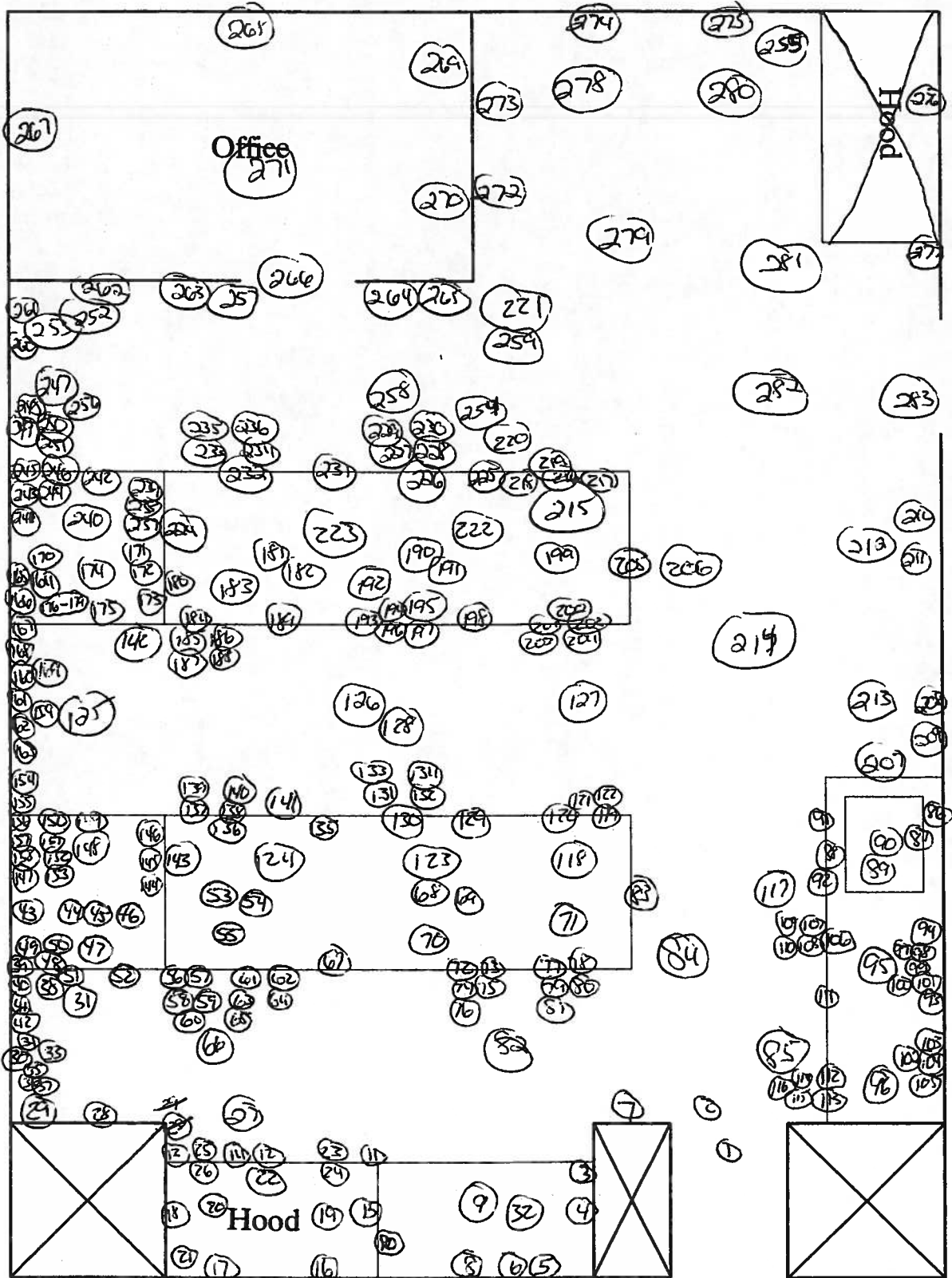

Surveyed 100% of lower surfaces using instrument #2. All surfaces surveyed were noted to be at normal background levels.

ID: EQUIPMENT SURVY

26 APR 2000 09:01

USER: 1 COMMENT:
 PRESET TIME : 1.00
 DATA CALC : DL DPM H# : YES SAMPLE REPEATS: 1 PRINTER : EDIT
 COUNT BLANK : YES IC# : NO REPLICATES : 1 RS232 : EDIT
 TWO PHASE : NO ADC : YES CYCLE REPEATS : 1
 SCINTILLATOR: LIQUID LUMEX: YES LOW SAMPLE REJ: 0
 LOW LEVEL : NO HALF LIFE CORRECTION DATE: none

ISOTOPE 1: 3H %ERROR: 2.00 FACTOR: 1.000000 BKG. SUB: 0
 ISOTOPE 2: 14C %ERROR: 2.00 FACTOR: 1.000000 BKG. SUB: 0
 WIDE OPEN WINDOW %ERROR: 0.00 FACTOR: 1.000000 BKG. SUB: 0

BACKGROUND QUENCH CURVE: Off COLOR QUENCH CORRECTION: Off

Quench Limits Low: 2.756 High: 314.54

SAM NO	H#	3H CPM	14C CPM	WIDE CPM	3H DPM	14C DPM	LUMEX %
B1	85.2	20.00	10.00	41.00	35.23	13.27	11.94
1	79.9	21.00	7.00	44.00	2.61	-4.09	7.19
2	93.2	19.00	10.00	40.00	-0.69	0.06	7.36
3	81.8	21.00	10.00	39.00	1.43	-0.03	5.89
4	86.0	12.00	11.00	34.00	-16.59	1.45	4.13
5	86.0	24.00	9.00	42.00	8.75	-1.40	6.72
6	92.3	22.00	11.00	50.00	4.90	1.38	4.37
7	101.0	13.00	11.00	34.00	-12.97	1.55	11.05
8	83.0	25.00	8.00	37.00	10.63	-2.77	10.91
9	101.1	13.00	6.00	33.00	-10.14	-5.26	12.80
10	84.9	15.00	7.00	32.00	-8.59	-3.99	4.87
11	83.7	19.00	7.00	34.00	-0.72	-4.05	8.40
12	88.2	21.00	12.00	48.00	1.52	2.71	4.42
13	88.0	19.00	2.00	31.00	2.62	-10.79	10.57
14	86.5	16.00	7.00	36.00	-6.35	-4.00	11.44
15	85.5	16.00	8.00	36.00	-7.00	-2.65	7.25
16	85.3	24.00	13.00	47.00	6.55	4.01	19.58
17	87.7	21.00	14.00	43.00	0.38	5.41	10.25
18	84.5	14.00	9.00	31.00	-11.67	-1.28	5.72
19	95.0	16.00	7.00	36.00	-5.11	-3.96	9.37
20	98.3	17.00	12.00	40.00	-5.21	2.84	4.12
21	89.1	14.00	8.00	36.00	-10.63	-2.61	8.00
22	85.4	22.00	10.00	46.00	4.07	-0.02	3.69
23	84.7	15.00	5.00	29.00	-7.59	-6.70	9.21
24	94.9	15.00	12.00	40.00	-9.96	2.84	8.19
25	86.5	17.00	10.00	43.00	-5.88	0.04	2.83
26	128.2	7.00	8.00	28.00	-22.62	-2.30	64.98
27	102.6	13.00	7.00	27.00	-10.51	-3.89	20.47
28	82.9	19.00	11.00	41.00	-2.88	1.35	7.27
29	86.8	17.00	19.00	47.00	-10.49	12.22	7.92
30	84.1	23.00	12.00	43.00	4.82	2.66	12.05
31	84.2	20.00	8.00	38.00	0.85	-2.71	5.96
32	82.9	19.00	7.00	32.00	-0.85	-4.05	14.44
33	88.8	19.00	10.00	40.00	-1.44	0.03	5.16
34	100.2	18.00	8.00	42.00	-0.48	-2.61	7.31
35	93.4	17.00	11.00	38.00	-5.40	1.45	8.95
36	85.5	14.00	10.00	42.00	-12.07	0.07	16.55
37	89.2	19.00	13.00	39.00	-2.94	4.10	16.58
38	97.9	14.00	6.00	28.00	-8.40	-5.29	8.31

SAM NO	H#	3H CPM	14C CPM	WIDE CPM	3H DPM	14C DPM	LUMEX %
39	95.4	20.00	13.00	41.00	0.18	4.14	7.77
40	94.0	17.00	12.00	38.00	-5.86	2.81	8.34
41	85.7	20.00	15.00	51.00	-2.49	6.76	5.03
42	87.6	19.00	9.00	34.00	-1.10	-1.33	3.10
43	144.3	9.00	8.00	26.00	-15.46	-2.23	24.69
44	88.5	17.00	12.00	37.00	-6.63	2.76	7.98
45	90.4	16.00	14.00	42.00	-9.51	5.50	10.24
46	87.2	17.00	7.00	39.00	-4.22	-4.01	7.10
47	112.0	15.00	8.00	34.00	-5.13	-2.51	14.25
48	89.0	10.00	5.00	30.00	-17.29	-6.62	3.80
49	91.4	20.00	14.00	44.00	-1.05	5.46	17.91
50	88.8	14.00	16.00	36.00	-14.86	8.22	2.62
51	91.0	16.00	18.00	39.00	-11.56	10.93	5.92
52	100.1	25.00	16.00	45.00	10.27	8.20	14.02
53	90.7	23.00	14.00	45.00	5.06	5.42	7.34
54	93.6	13.00	13.00	36.00	-14.87	4.21	13.80
55	101.1	13.00	7.00	33.00	-10.70	-3.90	12.98
56	89.6	17.00	5.00	40.00	-2.79	-6.71	8.47
57	85.7	23.00	10.00	50.00	6.16	-0.03	5.28
58	88.1	14.00	5.00	27.00	-9.18	-6.67	11.82
59	98.8	18.00	11.00	40.00	-2.40	1.47	4.90
60	93.8	15.00	12.00	38.00	-10.10	2.83	8.78
61	83.4	16.00	11.00	37.00	-8.81	1.39	4.18
62	83.4	14.00	3.00	21.00	-8.75	-9.39	20.37
63	89.2	19.00	16.00	45.00	-4.53	8.16	10.24
64	88.2	14.00	9.00	31.00	-11.26	-1.26	7.77
65	88.4	20.00	12.00	43.00	-0.50	2.73	7.69
66	98.2	18.00	6.00	33.00	0.27	-5.34	6.48
67	93.2	19.00	12.00	44.00	-1.77	2.78	2.06
68	96.8	20.00	10.00	41.00	2.10	0.07	8.49
69	94.9	20.00	12.00	46.00	0.64	2.78	9.14
70	89.2	17.00	5.00	32.00	-2.86	-6.71	7.80
71	91.5	12.00	10.00	29.00	-15.57	0.14	5.17
72	85.6	10.00	15.00	40.00	-22.73	6.88	9.03
73	88.0	18.00	4.00	34.00	-0.49	-8.08	6.69
74	97.0	18.00	11.00	37.00	-2.72	1.46	6.07
75	91.2	9.00	6.00	22.00	-19.70	-5.25	11.88
76	92.3	20.00	6.00	32.00	3.39	-5.38	2.24
77	89.1	14.00	4.00	24.00	-8.52	-8.02	13.54
78	89.8	15.00	13.00	39.00	-11.11	4.15	5.35
79	96.5	11.00	10.00	32.00	-17.21	0.18	14.88
80	89.4	19.00	8.00	40.00	-0.28	-2.67	4.37
81	98.0	21.00	12.00	40.00	3.37	2.79	6.57
82	92.2	13.00	13.00	33.00	-15.01	4.20	10.24
83	95.8	14.00	7.00	29.00	-9.24	-3.93	11.66
84	89.4	7.00	11.00	28.00	-26.60	1.54	6.94
85	90.3	16.00	11.00	44.00	-7.92	1.44	3.81
86	86.0	23.00	3.00	45.00	9.82	-9.49	7.08
87	92.8	19.00	12.00	41.00	-1.83	2.77	1.62
88	96.4	12.00	13.00	36.00	-16.73	4.25	17.28
89	92.9	19.00	10.00	44.00	-0.74	0.06	2.28
90	93.5	13.00	8.00	31.00	-12.18	-2.57	6.90
91	85.6	25.00	11.00	44.00	9.68	1.29	6.20
92	95.3	12.00	16.00	40.00	-18.47	8.31	7.18
93	85.5	19.00	4.00	34.00	1.12	-8.09	4.66
94	94.1	28.00	8.00	43.00	19.56	-2.76	12.47
95	91.4	13.00	16.00	43.00	-16.69	8.26	6.29
96	94.4	20.00	14.00	46.00	-0.53	5.49	5.39

SAM NO	H#	SH CPM	14C CPM	WIDE CPM	SH DPM	14C DPM	LUMEX %
97	83.4	17.00	8.00	41.00	-5.28	-2.67	7.63
98	93.3	24.00	9.00	44.00	10.38	-1.36	9.56
99	88.2	12.00	12.00	36.00	-16.92	2.82	4.97
100	90.7	13.00	10.00	27.00	-13.57	0.12	10.65
101	95.2	18.00	13.00	42.00	-4.09	4.16	2.49
102	95.3	18.00	8.00	35.00	-1.36	-2.63	5.85
103	96.2	10.00	15.00	34.00	-22.12	6.99	8.47
104	100.5	23.00	10.00	53.00	9.37	0.05	21.67
105	92.4	26.00	13.00	50.00	12.21	4.04	5.72
106	88.0	25.00	12.00	53.00	9.67	2.66	7.23
107	94.0	16.00	10.00	39.00	-6.89	0.10	5.23
108	87.7	26.00	11.00	43.00	12.18	1.30	6.48
109	89.8	14.00	8.00	33.00	-10.55	-2.61	11.62
110	103.2	20.00	12.00	41.00	2.24	2.84	6.55
111	93.7	21.00	11.00	42.00	3.07	1.40	4.47
112	92.8	14.00	11.00	39.00	-11.78	1.48	7.73
113	91.6	14.00	11.00	30.00	-11.92	1.47	4.70
114	97.2	18.00	9.00	39.00	-1.57	-1.26	2.56
115	91.1	13.00	8.00	36.00	-12.46	-2.59	6.63
116	96.4	12.00	11.00	30.00	-15.63	1.53	11.70
117	95.5	16.00	11.00	33.00	-7.21	1.47	2.84
118	98.7	18.00	9.00	37.00	-1.31	-1.25	8.74
119	89.2	15.00	8.00	31.00	-8.56	-2.62	10.37
120	91.6	17.00	10.00	40.00	-5.14	0.08	6.16
121	92.1	11.00	8.00	34.00	-16.52	-2.56	5.19
122	86.6	14.00	12.00	40.00	-12.99	2.79	13.13
123	101.6	17.00	6.00	31.00	-1.28	-5.31	10.45
124	96.6	22.00	11.00	39.00	5.78	1.40	9.71
125	99.7	18.00	9.00	31.00	-1.14	-1.25	10.41
126	89.3	17.00	11.00	39.00	-6.00	1.42	8.58
127	92.1	14.00	9.00	38.00	-10.79	-1.24	10.94
128	92.6	22.00	8.00	38.00	6.56	-2.69	1.98
129	95.5	21.00	12.00	43.00	2.88	2.77	4.72
130	87.8	17.00	7.00	34.00	-4.13	-4.01	12.92
131	89.0	21.00	11.00	45.00	2.19	1.36	4.61
132	87.3	21.00	8.00	44.00	3.44	-2.70	5.48
133	91.1	15.00	9.00	32.00	-8.83	-1.26	13.98
134	92.7	18.00	9.00	35.00	-2.34	-1.29	4.09
135	97.7	18.00	11.00	37.00	-2.59	1.46	3.25
136	85.7	9.00	4.00	25.00	-19.08	-7.97	19.00
137	84.0	26.00	9.00	49.00	12.36	-1.43	8.86
138	88.2	30.00	17.00	59.00	17.35	9.37	10.64
139	88.6	12.00	7.00	29.00	-14.27	-3.94	8.59
140	92.6	24.00	13.00	54.00	8.06	4.06	6.35
141	89.1	19.00	10.00	36.00	-1.38	0.04	4.88
142	87.7	11.00	15.00	31.00	-20.57	6.89	9.52
143	86.6	17.00	4.00	25.00	-2.74	-8.07	6.17
144	94.9	22.00	11.00	46.00	5.44	1.39	5.03
145	101.9	15.00	10.00	35.00	-7.90	0.17	3.54
146	93.6	19.00	7.00	44.00	0.99	-4.01	9.85
147	113.3	21.00	9.00	38.00	8.58	-1.21	8.02
148	90.5	19.00	9.00	37.00	-0.63	-1.31	7.07
149	87.7	13.00	10.00	34.00	-13.87	0.10	13.03
150	90.3	22.00	6.00	37.00	7.14	-5.41	8.10
151	91.0	12.00	15.00	32.00	-18.27	6.91	8.20
152	95.4	23.00	15.00	51.00	5.48	6.82	7.31
153	88.7	15.00	15.00	39.00	-12.29	6.85	6.95
154	92.8	12.00	8.00	28.00	-14.36	-2.57	13.37

SAM NO	H#	3H CPM	14C CPM	WIDE CPM	3H DPM	14C DPM	LUMEX %
155	101.6	22.00	10.00	42.00	7.43	0.07	11.39
156	94.4	15.00	4.00	29.00	-5.68	-8.03	6.57
157	94.1	16.00	10.00	37.00	-6.86	0.11	12.63
158	94.1	17.00	5.00	34.00	-2.04	-6.69	6.98
159	83.7	11.00	11.00	35.00	-18.79	1.45	7.99
160	88.3	24.00	15.00	51.00	6.12	6.74	6.83
161	89.3	15.00	10.00	35.00	-9.59	0.09	9.53
162	91.5	17.00	11.00	35.00	-5.68	1.43	12.17
163	96.9	23.00	11.00	44.00	8.00	1.39	27.57
164	91.0	23.00	12.00	44.00	6.18	2.71	11.44
165	99.0	19.00	5.00	33.00	3.15	-6.71	6.55
166	93.2	18.00	9.00	38.00	-2.26	-1.28	2.71
167	94.9	19.00	11.00	40.00	-0.94	1.43	5.72
168	89.2	20.00	12.00	38.00	-0.37	2.73	2.29
169	85.9	16.00	12.00	37.00	-9.01	2.76	7.84
170	131.5	19.00	13.00	41.00	5.76	4.47	15.28
171	108.7	13.00	8.00	30.00	-10.26	-2.50	9.42
172	96.4	23.00	6.00	41.00	10.62	-5.41	8.49
173	89.4	23.00	10.00	41.00	6.90	-0.01	7.01
174	94.2	9.00	10.00	29.00	-21.64	0.19	13.12
175	96.6	16.00	10.00	33.00	-6.50	0.12	4.93
176	87.6	23.00	13.00	50.00	4.97	4.04	6.25
177	91.7	15.00	11.00	40.00	-9.82	1.46	5.08
178	91.5	22.00	9.00	39.00	5.81	-1.34	10.55
179	93.6	23.00	12.00	42.00	6.72	2.73	2.62
180	86.0	4.00	13.00	24.00	-33.84	4.25	14.00
181	108.6	7.00	7.00	23.00	-23.39	-3.78	23.22
182	100.2	16.00	8.00	39.00	-4.83	-2.58	6.67
183	96.4	19.00	11.00	49.00	-0.67	1.44	7.36
184	87.9	16.00	8.00	40.00	-6.67	-2.64	12.48
185	89.0	13.00	13.00	36.00	-15.32	4.17	5.65
186	89.9	16.00	13.00	38.00	-9.04	4.14	5.08
187	88.3	22.00	9.00	35.00	5.15	-1.36	6.44
188	91.6	12.00	8.00	26.00	-14.49	-2.57	6.90
189	101.4	14.00	17.00	41.00	-14.13	9.72	7.17
190	106.6	16.00	10.00	35.00	-4.94	0.19	7.38
191	101.5	15.00	13.00	35.00	-9.66	4.26	3.72
192	90.6	13.00	8.00	34.00	-12.52	-2.59	14.56
193	87.8	25.00	5.00	43.00	13.28	-6.81	6.09
194	88.8	14.00	7.00	29.00	-10.13	-3.96	7.46
195	91.9	18.00	14.00	36.00	-5.13	5.49	2.99
196	86.2	19.00	9.00	33.00	-1.33	-1.33	6.56
197	96.5	10.00	12.00	35.00	-20.45	2.92	2.03
198	94.5	20.00	13.00	49.00	0.03	4.13	5.60
199	98.7	19.00	15.00	47.00	-2.49	6.90	8.25
200	89.3	17.00	18.00	52.00	-9.69	10.89	4.75
201	100.8	25.00	13.00	55.00	12.13	4.12	4.77
202	98.0	14.00	10.00	31.00	-10.61	0.16	7.21
203	84.8	11.00	11.00	27.00	-18.71	1.46	11.16
204	92.2	16.00	13.00	37.00	-8.74	4.16	9.07
205	102.1	20.00	16.00	47.00	-0.27	8.29	2.84
206	94.4	9.00	11.00	30.00	-22.17	1.55	4.25
207	91.2	15.00	12.00	40.00	-10.41	2.81	9.45
208	94.8	25.00	9.00	47.00	12.85	-1.36	2.27
209	89.6	13.00	11.00	36.00	-14.21	1.47	4.75
210	89.7	7.00	10.00	29.00	-26.06	0.19	11.26
211	91.8	13.00	9.00	36.00	-12.92	-1.23	4.91
212	92.4	27.00	5.00	41.00	18.61	-6.82	3.80

SAM NO	H#	3H CPM	14C CPM	WIDE CPM	3H DPM	14C DPM	LUMEX %
213	107.6	13.00	10.00	28.00	-11.58	0.23	5.94
214	93.3	18.00	5.00	27.00	-0.07	-6.71	8.55
215	96.5	22.00	4.00	43.00	9.61	-8.11	4.82
216	91.9	17.00	8.00	35.00	-4.02	-2.63	7.16
217	94.5	10.00	13.00	34.00	-21.14	4.26	4.34
218	90.8	17.00	9.00	39.00	-4.72	-1.28	4.47
219	99.2	6.00	9.00	22.00	-27.25	-1.09	4.79
220	93.8	15.00	12.00	40.00	-10.10	2.83	4.07
221	95.8	19.00	7.00	37.00	1.41	-4.00	1.33
222	92.2	8.00	12.00	27.00	-24.93	2.91	10.52
223	95.4	20.00	4.00	36.00	5.09	-8.09	1.54
224	87.8	14.00	17.00	39.00	-15.48	9.56	7.29
225	96.5	17.00	7.00	40.00	-2.74	-3.97	2.57
226	92.6	12.00	11.00	35.00	-16.00	1.50	2.06
227	92.5	17.00	11.00	42.00	-5.53	1.44	4.99
228	121.9	9.00	17.00	42.00	-23.99	10.05	35.44
229	91.3	20.00	4.00	32.00	4.27	-8.10	4.88
230	96.3	18.00	15.00	43.00	-5.02	6.89	11.05
231	87.6	17.00	13.00	36.00	-7.28	4.11	5.53
232	93.1	17.00	8.00	30.00	-3.83	-2.63	8.46
233	89.0	16.00	4.00	29.00	-4.42	-8.05	8.07
234	97.3	25.00	8.00	40.00	14.04	-2.71	15.39
235	96.9	22.00	15.00	42.00	3.65	6.84	2.99
236	98.0	14.00	9.00	28.00	-10.06	-1.20	3.74
237	99.6	6.00	6.00	18.00	-25.55	-5.18	5.91
238	96.5	23.00	12.00	42.00	7.36	2.75	3.11
239	94.8	17.00	10.00	37.00	-4.65	0.10	4.81
240	92.7	17.00	13.00	43.00	-6.58	4.15	4.85
241	98.0	23.00	9.00	43.00	9.36	-1.32	5.38
242	91.0	25.00	8.00	39.00	12.46	-2.74	5.60
243	98.4	23.00	10.00	47.00	8.89	0.04	2.90
244	95.8	21.00	7.00	38.00	5.68	-4.02	6.33
245	93.4	16.00	8.00	32.00	-5.89	-2.61	5.56
246	96.7	25.00	12.00	50.00	11.68	2.73	1.06
247	91.9	18.00	7.00	35.00	-1.40	-4.00	3.38
248	96.7	14.00	13.00	36.00	-12.42	4.23	4.60
249	96.4	13.00	6.00	24.00	-10.75	-5.28	13.08
250	90.8	21.00	18.00	46.00	-1.20	10.86	5.25
251	102.1	12.00	11.00	33.00	-15.05	1.57	4.36
252	95.3	19.00	10.00	46.00	-0.32	0.07	6.98
253	91.5	15.00	9.00	34.00	-8.78	-1.25	4.97
254	89.2	12.00	11.00	30.00	-16.31	1.48	9.14
255	90.8	21.00	13.00	39.00	1.47	4.09	3.93
256	94.7	12.00	10.00	37.00	-15.25	0.16	5.90
257	100.7	14.00	11.00	30.00	-10.83	1.54	6.64
258	95.2	12.00	7.00	33.00	-13.57	-3.91	6.30
259	100.3	22.00	6.00	36.00	9.40	-5.38	3.15
260	85.5	29.00	12.00	54.00	17.21	2.60	6.13
261	96.4	18.00	8.00	34.00	-1.16	-2.62	2.28
262	91.2	11.00	13.00	32.00	-19.27	4.22	4.41
263	85.1	17.00	11.00	38.00	-6.59	1.39	6.86
264	89.1	12.00	9.00	26.00	-15.27	-1.23	12.45
265	91.4	13.00	10.00	35.00	-13.49	0.13	6.56
266	94.0	12.00	5.00	30.00	-12.61	-6.63	2.65
267	90.8	20.00	12.00	41.00	-0.09	2.74	3.43
268	96.9	16.00	11.00	34.00	-7.01	1.48	5.88
269	95.4	12.00	11.00	32.00	-15.72	1.52	3.79
270	92.7	14.00	10.00	33.00	-11.26	0.12	5.46

SAM NO	H#	3H CPM	14C CPM	WIDE CPM	3H DPM	14C DPM	LUMEX %
271	97.6	17.00	4.00	27.00	-0.89	-8.05	5.43
272	92.1	15.00	11.00	41.00	-9.78	1.46	2.02
273	94.0	21.00	11.00	37.00	3.14	1.40	4.45
274	96.0	21.00	12.00	45.00	2.98	2.77	4.02
275	96.0	18.00	9.00	40.00	-1.79	-1.27	5.97
276	104.6	23.00	12.00	45.00	9.22	2.81	6.43
277	90.1	18.00	17.00	41.00	-6.99	9.54	6.05
278	109.5	11.00	7.00	27.00	-14.14	-3.83	7.06
279	93.3	21.00	6.00	40.00	5.69	-5.39	4.36
280	106.8	17.00	8.00	31.00	-1.46	-2.56	5.76
281	106.2	21.00	12.00	51.00	5.10	2.85	1.93
282	98.3	18.00	9.00	35.00	-1.38	-1.25	6.42
283	101.5	20.00	7.00	33.00	4.74	-3.99	4.85