

# Radiological Survey Sheet

Job Location Pfizer, Inc. Groton, Ct. 06340

Page 1

32  
WGC

Survey Purpose Decommissioning/Deregistration  
Radiologic Survey of Equipment Lab 118/B311

Date 4/14/2011

Performed by William H. Calver  
(Print)

William H. Calver  
(Sign)

<b>Instrument (Model/S/N)</b>	Packard Tri-Carb S/N 431521	Packard Tri-Carb S/N 431520	Ludlum 2241-2 163603	Wallac Model 1409 S/N 4061042
<b>Det. (Model/SN)</b>	Internal	Internal	Ludlum 43-68 PR 149613	Internal
<b>Type Rad.</b>	$\beta$	$\beta$	$\beta$	$\beta$
<b>Cal. Due:</b>	03/11/2012	03/11/2012	<del>04/04/2011</del> 4/14/12 8	09/20/2011
<b>Check Instruments Used</b>		✓	✓	

No.	Time	Locations	See attached LSC printout for Total Activity (cpm/100 cm <sup>2</sup> )
1.	0700	BACKGROUND	
2.		Front Door	Outer
3.			Inner
4.		Front Wall	Upper
5.			Lower
6.		Light Switch	
7.		Phone	
8.		Fire Extinguisher	
9.		Front Wall	Upper
10.			Lower
11.			Upper
12.			Lower
13.			Upper
14.		<del>Hood Front Upper</del>	Lower
15.		Hood Front Upper	Left
16.			Right
17.		Outer Glass Front Left	Upper
18.			Lower

# Radiological Survey Continuation Sheet

Page 2 of 22<sup>32</sup><sub>24C</sub>

Date 4/14/2011

1188/B311

No.	Time	Locations	See attached LSC printout for Total Activity (cpm/100 cm <sup>2</sup> )	
19	0720	Outer Glass Front	Right	Upper
20				Lower
21		Sill		Left
22				Right
23		Outer Left Side		Upper
24				Lower
25		Inside Glass Front	Left	Upper
26				Lower
27			Right	Upper
28				Lower
29		Inside Left Wall		Upper
30				Lower
31		Rear Wall	Left	Upper
32				Lower
33			Middle Right	Upper
34				Lower
35			Right	Upper
36				Lower
37		Right Wall		Upper
38				Lower
39		Inside Floor	Left	Front
40				Rear
41			Middle	Front
42				Rear
43			Right	Front
44				Rear
45	✓	Cup Hole/Drain		

# Radiological Survey Continuation Sheet

Page 3 of 33 ~~44~~ <sub>unc</sub>

Date 4/14/2011

118B/B311

No.	Time	Locations	See attached LSC printout for Total Activity (cpm/100 cm <sup>2</sup> )
46	0740	Below Hood Panel	Left
47			Right
48		Left Cabinet Doors	Left
49			Right
50		Inside Cabinet Floor	Left
51			Right
52		Right Cabinet Doors	Left
53			Right
54		Inside Cabinet Floor	Left
55			Right
56		Front Wall	Upper
57			Lower
58		Coat Rack in Wall	
59		Left Wall Upper Cabinet Doors	Left
60			Right
61		Inside Top Shelf	Left
62			Right
63		2nd Shelf	Left
64			Right
65		3rd Shelf	Left
66			Right
67		Floor Shelf	Left
68			Right
69		Upper Cabinet #2 Doors	Left
70			Right
71		Inside Top Shelf	Left
72	↓		Right

# Radiological Survey Continuation Sheet

Page 4 of ~~22~~ <sup>32</sup> ~~32~~

Date 4/14/2011  
118/B311

No.	Time	Locations	See attached LSC printout for Total Activity (cpm/100 cm <sup>2</sup> )
73	0800	Shelf below Cabinets <sup>1+2</sup> from left	1
74			2
75			3
76			4
77		Wall below Shelf	Upper
78			Lower
79			Upper
80			Lower
81		Upper Cabinet #3 Outer Doors	Left
82			Right
83		Top Shelf	Left
84			Right
85		2ND Shelf	Left
86			Right
87		3RD Shelf	Left
88			Right
89		Floor Shelf	Left
90			Right
91		Upper Cabinet #4 (NO DOORS) Top Shelf	Left
92			Right
93		2nd Shelf	Left
94			Right
95		3rd Shelf	Left
96			Right
97		Floor Shelf	Left
98			Right
99	✓	Upper Cabinet #5 (NO DOORS) Top Shelf	Left

# Radiological Survey Continuation Sheet

Page 5 of ~~33~~ 37  
Time

Date 4/14/2011

118 B/8311

No.	Time	Locations	See attached LSC printout for Total Activity (cpm/100 cm <sup>2</sup> )
100	0820		Top Shelf Right
101			2ND Shelf Left
102			Right
103			3RD Shelf Left
104			Right
105			Floor Shelf Left
106			Right
107		Upper Cabinet #6 (No Doors)	Top Shelf Left
108			Right
109			2ND Shelf Left
110			Right
111			3RD Shelf Left
112			Right
113			Floor Shelf Left
114			Right
115		Shelf below Cabinets #s 3,4,5,6	1
116			2
117			3
118			4
119			5
120			6
121		Wall below Shelf	Upper
122			Lower
123			Upper
124			Lower
125		Shelfs RT Wall before Door	Top
126	✓		2ND

# Radiological Survey Continuation Sheet

Page 6 of ~~22~~ <sup>32</sup>

Date 4/14/2011

118B/B311

No.	Time	Locations	See attached LSC printout for Total Activity (cpm/100 cm <sup>2</sup> )
127	0845	Shelfs before Door RT Wall	3RD
128			4th
129		Fire ExTINGUISHER	
130		Wall	Upper
131			Lower
132		Door Outer	
133		INNER	
134		Wall before Left Rear Office	
135		Glass Doors Outer LEFT Office	Upper
136			Lower
137			Upper
138			Lower
139		Glass Doors Outer Rear RIGHT Office LEFT	Upper
140			Lower
141			Right Upper
142			Lower
143		Right Rear Wall	Upper
144			Lower
145			Upper
146			Lower
147		Rear RIGHT Wall 1	Upper
148			Lower
149			Upper
150			Lower
151		Nanoplate	
152		Black Peg board	Upper
153	✓		Lower

# Radiological Survey Continuation Sheet

Page 7 of 32<sup>32</sup><sub>W4C</sub>

Date 4/14/2011

118B/B311

No.	Time	Locations	See attached LSC printout for Total Activity (cpm/100 cm <sup>2</sup> )
154	0915	Counter Top around Sink	Front
155			Left
156			Rear
157			Right
158		Eye Wash	
159		Faucet	
160		Inside Sink Front	Left
161			Right
162			Left
163			Rear
164			Left
165			Right
166			Floor
167			Left
168			Right
169		Drain Cup	
170		Drain	
170		Upper Cabinet Doors	Left
171			Upper
172			Lower
173			Right
174			Upper
175			Lower
176		Inside Cabinet Top Shelf	Left
177			Right
178			Left
179			Right
180	V	Exhaust Hose	
		Wall below Cabinet	# 1
			# 2

# Radiological Survey Continuation Sheet

Page 8 of 22<sup>32</sup><sub>with</sub>

Date 4/14/2011  
118B/B311

No.	Time	Locations	See attached LSC printout for Total Activity (cpm/100 cm <sup>2</sup> )
181	0940	Wall below Cabinet	# 3
182			# 4
183		Counter Top from Sink <sup>1</sup>	Front
184			Rear
185			Cuphole Drain
186			<sup>2</sup> Front
187			Rear
188			<sup>3</sup> Front
189			Rear
190			<sup>4</sup> Front
191			Rear
192			<sup>5</sup> Front
193			Rear
194		Cabinet below Sink Doors	Left
195			Right
196		Inside Floor	Left <del>Right</del>
197			Middle
198			Right
199		1st Row of Drawers Top	Outer
200			Inner
201		2ND	Outer
202			Inner
203		3RD	Outer
204			Inner
205		4TH	Outer
206			Inner
207	✓	Knee hole Left Wall	



# Radiological Survey Continuation Sheet

Page 9 of 33  
WORK

Date 4/14/2011

1188/8311

No.	Time	Locations	See attached LSC printout for Total Activity (cpm/100 cm <sup>2</sup> )
208	1000	Knee hole	Rear
209			Right Wall
210		2ND Row Drawers	Top Outer
211			Inner
212			2ND Outer
213			Inner
214			3RD Outer
215			Inner
216			4TH Outer
217			Inner
218		FRONT FROM 1ST Bench Rear	Upper Top Shelf
219			2ND
220			3RD
221		Desk Top	Left
222			Right
223		Below Desk Top	Left Drawers Pull Out
224			Top Drawer Outer
225			Inner
226			2ND Drawer Outer
227			Inner
228			3RD Drawer Outer
229			Inner
230		1ST UNIT Stainless Shelving above Bench Top	from Rear Top Left
231			Right
232			2nd Left
233			Right
234	↓	2ND UNIT TOP	Left

# Radiological Survey Continuation Sheet

Page 10 of 33 pages

Date 4/14/2011

118B/B311

No.	Time	Locations	See attached LSC printout for Total Activity (cpm/100 cm <sup>2</sup> )
235	1015		Right
236		2ND Shelf	Left
237			Right
238		Shelf above bench from Rear	#1
239			2
240			3
241			4
242			5
243		Bench Top from Rear/Left Wall	1 Front
244			Rear
245			Cup Hole
246			2 Front
247			Rear
248			3 Front
249			Rear
250			Cup Hole
251			4 Front
252			Rear
253			5 Front
254			Rear
255			6 Front
256			Rear
257		Below Bench Top 1st row of drawers	Top Outer
258			Inner
259			2ND Outer
260			Inner
261	✓		3RD Outer

# Radiological Survey Continuation Sheet

Page 11 of 33 wite

Date 4/14/2011  
118B/B311

No.	Time	Locations	See attached LSC printout for Total Activity (cpm/100 cm <sup>2</sup> )	
262	1035	1ST Row of Drawers	3RD	INNER
263			4TH	Outer
264				INNER
265		2ND Row of Drawers	Top	Outer
266				INNER
267			2ND	Outer
268				INNER
269			3RD	Outer
270				INNER
271			4TH	Outer
272				INNER
273		Drawer below Knee hole		Outer
274				INNER
275		Knee Hole Left Wall		
276		Rear Wall		
277		Right Wall		
278		3RD Row of Drawers	Top	Outer
279				INNER
280		2ND Drawer		Outer
281				INNER
282		3RD Drawer		Outer
283				INNER
284		4TH Drawer		Outer
285				INNER
286		<sup>4</sup> / <sub>WIK</sub> 5TH Row Top Drawer	Outer	Left
287				Right
288	✓		Inside	Left



# Radiological Survey Continuation Sheet

Page 13 of ~~22~~<sup>32</sup> WDC

Date 4/14/2011

118B/B311

No.	Time	Locations	See attached LSC printout for Total Activity (cpm/100 cm <sup>2</sup> )	
316	1120	Below bench top Drawer Inside	Left	
317			Right	
318		Cabinet Doors	Left	
319			Right	
320		Inside Cabinet Top Shelf	Left	
321			Right	
322		Bottom Shelf	Left	
323			Right	
324		Drawer above knee hole	Outer	
325			Inner	
326		Knee hole	Left Wall	
327			Rear Wall	
328			Right Wall	
329		Row of Drawers Top	Outer	
330			Inner	
331			2ND	
332				
333			3RD	
334				
335			4TH	
336		Drawer above knee hole		
337		Knee hole	Left Wall	
338			Rear Wall	
339			Right Wall	
340		Row of Drawers Top Drawer	Outer	
341			Inner	
342		✓	2ND Drawer	Outer





# Radiological Survey Continuation Sheet

Page 16 of 32  
~~22~~

Date 4/14/2011  
118B/B311

No.	Time	Locations	See attached LSC printout for Total Activity (cpm/100 cm <sup>2</sup> )
397	1250	Bench top	2 Front
398			Rear
399			3 Front
400			Rear
401			Cuphole Drain
402			4 Front
403			Rear
404			5 Front
405			Rear
406			6 Front
407			Rear
408		Below Bench Top	First Row of Drawers Top Outer
409			Inner
410			2ND Outer
411			Inner
412			3RD Outer
413			Inner
414			4TH Outer
415			Inner
416		Drawer above Knee Hole	Outer
417			Inner
418		Knee Hole	Left Wall
419			Rear Wall
420			Right Wall
421		Second Row of Drawers	Top Outer
422			Inner
423	✓		2ND Outer



# Radiological Survey Continuation Sheet

Page 17 of 32<sup>32</sup>~~22~~ <sup>WHE</sup>

Date 4/14/2011  
1188/B311

No.	Time	Locations	See attached LSC printout for Total Activity (cpm/100 cm <sup>2</sup> )
424	1315	2ND ROW	2ND Drawer INNER
425	1316		3RD Drawer OUTER
426			INNER
427			4TH Drawer OUTER
428			INNER
429		Drawer above Knee Hole	OUTER
430			INNER
431		Knee Hole	Left Wall
432			Rear Wall
433			Right Wall
434		Third Row of Drawers	Top Drawer Left OUTER
435			Middle
436			Right
437			INNER Left
438			Middle
439			Right
440			2ND Drawer OUTER Left
441			Middle
442			Right
443			INNER Left
444			Middle
445			Right
446			3RD Drawer OUTER Left
447			Middle
448			Right
449			INNER Left
450	✓		Middle

# Radiological Survey Continuation Sheet

Page 18 of ~~22~~<sup>32</sup>

Date 4/14/2011

118B/B311

No.	Time	Locations	See attached LSC printout for Total Activity (cpm/100 cm <sup>2</sup> )
451	1340	3RD Drawer Inner	Right
452		4TH Outer	
453		INNER	Left
454			Right
455		End of Bench Five Metal Shelf UNIT Top	Left
456			Right
457		2ND	Left
458			Right
459		3RD	Left
460			Right
461		4TH	Left
462			Right
463		5TH	Left
464			Right
465		Second Bench Rear Side Bench Top from RT	Front
466			Rear
467		Second	Front
468			Rear
469		THIRD	Front
470			Rear
471		FOURTH	Front
472			Rear
473		FIFTH	Front
474			Rear
475		SIXTH	Front
476			Rear
477	✓	Seventh	Front

# Radiological Survey Continuation Sheet

Page 19 of 32 ~~32~~ <sup>32</sup> ~~WAC~~

Date 4/14/2011

118B/B311

No.	Time	Locations	See attached LSC printout for Total Activity (cpm/100 cm <sup>2</sup> )
478	1410	Bench Top	Seven Rear
479		Below Bench top	Drawer Outer Left
480			Right
481			Inside Left
482			Right
483		Cabinet Doors	Left
484			Right
485		Inside Top Shelf	Left
486			Right
487		Bottom Shelf	Left
488			Right
489		Drawer above Knee Hole	Outer
490			Inner
491		Knee Hole	Left Wall
492			Rear Wall
493			Right Wall
494		1st Row of Drawers	Top Outer
495			Inner
496			Second Outer
497			Inner
498			Third Outer
499			Inner
500			Fourth Outer
501			Inner
502		Drawer above Knee hole	Outer
503			Inner
504	✓	Knee Hole	Left Wall

# Radiological Survey Continuation Sheet

Page 20 of 32  
~~22~~ WC

Date 4/14/2011  
118B/B311

No.	Time	Locations	See attached LSC printout for Total Activity (cpm/100 cm <sup>2</sup> )
505	1430	Knee Hole	Rear Wall
506			Right Wall
507		2ND set of Drawers	Top
508			Outer
509			INNER
510			2ND
511			3RD
512			4th
513			Outer
514			INNER
515		Shelves above Desk	Top
516			Middle
517			Lower
518		Desk Top	Front
519			Rear
520			Front
521			Rear
522			Front
523			Rear
524		Drawer above Knee hole	Outer
525			INNER
526		Knee hole	Left
527			Rear
528			Right
529		Pull out shelf	
530		Top Drawer	Outer
531	V		INNER

# Radiological Survey Continuation Sheet

Page 21 of ~~22~~<sup>32</sup> ~~22~~<sup>22</sup>

Date 4/14/2011  
118B/B311

No.	Time	Locations	See attached LSC printout for Total Activity (cpm/100 cm <sup>2</sup> )
532	1450	2ND Desk Drawer	Outer
533			Inner
534		3RD Drawer	Outer
535			Inner
536		Floor Inside Front Door	
537		In Front of Hood	
538		In Front of Hood	
539		1st Bench Front Knee Hole Desk	
540		Knee Hole	
541		1st Bench Rear Knee Hole	
542		Knee Hole	
543		Desk Knee Hole	
544		2ND Bench Front Knee Hole Desk	
545		Knee hole	
546		Knee hole	
547		Rear Knee hole	
548		Knee hole	
549		Desk Knee hole	
550		In front of Left Rear Office	
551		Right Rear Office	
552		In front of Sink	
553		In front of Sink	
554	✓	Knee hole	
555			
556			
557			
558	↓		

Assay Definition-

Assay Description:  
Background check for PM Lab (Mikey)

Assay Type: CPM  
Report Name: Report1  
Output Data Path: C:\Packard\Tricarb\Results\bill\bills swipes  
Raw Results Path: C:\Packard\Tricarb\Results\bill\bills swipes\20110414\_1040\20110414\_1040.results  
RTF File Name: C:\Packard\Tricarb\Results\bill\bills swipes\Report1.rtf  
Assay File Name: C:\Packard\TriCarb\Assays\bills swipes.lsa

Count Conditions-

Nuclide: TRIPLE  
Quench Indicator: tSIE/AEC  
External Std Terminator (sec): 0.5 2s  
Pre-Count Delay (min): 0.00  
Quench Set: n/a  
Count Time (min): 1.00  
Count Mode: Normal  
Assay Count Cycles: 1 Repeat Sample Count: 1  
#Vials/Sample: 1 Calculate % Reference: Off

Background Subtract: Off  
Low CPM Threshold: Off  
2 Sigma % Terminator: Off

Regions	LL	UL
A	0.0	18.6
B	18.6	156.0
C	0.0	2000.0

Count Corrections-

Static Controller: On Luminescence Correction: On  
Colored Samples: n/a Heterogeneity Monitor: n/a  
Coincidence Time (nsec): 18 Delay Before Burst (nsec): 75

Half Life-

Regions	Half Life	Units	Reference Date	Reference Time
A				
B				
C				

Cycle 1 Results

S#	CPMA	CPMB	CPMC	MESSAGES
1	18	4	29	
2	12	5	20	
3	15	4	26	
4	11	5	19	
5	13	13	33	
6	13	6	25	
7	13	5	22	
8	16	6	26	
9	11	5	19	
10	10	6	20	
11	7	6	18	

12	9	5	20
13	12	2	21
14	9	8	20
15	14	2	21
16	7	5	18
17	9	6	23
18	10	11	30
19	8	5	22
20	11	5	24
21	9	5	17
22	9	9	18
23	11	7	26
24	3	4	18
25	9	5	17
26	8	8	23
27	15	8	29
28	18	8	37
29	17	10	33
30	10	12	29
31	11	8	26
32	8	6	22
33	11	7	21
34	9	12	25
35	9	4	19
36	9	6	20
37	8	10	24
38	10	3	20
39	10	5	21
40	11	7	22
41	6	8	17
42	10	6	19
43	14	6	23
44	11	8	25
45	15	3	28
46	12	8	25
47	7	8	20
48	13	7	24
49	9	7	19
50	7	7	18
51	9	9	26
52	9	3	13
53	7	9	19
54	6	7	17
55	7	4	15
56	15	8	26
57	10	6	21
58	13	14	33
59	8	5	20
60	13	7	25
61	12	9	25
62	8	6	19
63	8	2	13
64	11	7	22
65	7	5	16
66	11	7	24
67	11	4	17
68	9	4	18
69	15	11	31
70	8	10	24
71	8	9	21
72	11	7	25
73	10	3	19
74	11	9	26

75	14	8	29
76	6	4	19
77	5	5	21
78	10	3	17
79	8	8	24
80	7	6	17
81	16	9	40
82	9	7	20
83	8	8	21
84	15	5	26
85	9	9	20
86	13	8	25
87	16	6	31
88	10	6	20
89	13	5	23
90	16	5	25
91	13	7	25
92	11	9	22
93	8	8	18
94	10	5	21
95	13	4	25
96	14	8	28
97	8	4	19
98	3	8	15
99	7	5	20
100	22	4	33
101	16	10	29
102	12	5	23
103	8	8	22
104	12	3	18
105	10	6	17
106	14	11	32
107	13	9	25
108	10	4	22
109	9	7	25
110	13	8	27
111	12	3	23
112	10	6	20
113	10	6	28
114	13	5	23
115	7	6	15
116	11	8	22
117	8	6	20
118	10	7	25
119	9	11	23
120	11	5	25
121	14	12	34
122	10	8	22
123	7	6	18
124	8	10	20
125	18	7	28
126	6	6	20
127	9	6	21
128	7	11	25
129	10	6	22
130	10	5	21
131	11	5	24
132	10	6	21
133	16	5	23
134	8	9	25
135	12	5	25
136	11	7	22
137	7	6	24



138	11	4	19
139	17	6	26
140	13	7	25
141	11	5	18
142	12	9	26
143	16	2	21
144	14	6	23
145	10	11	27
146	18	6	28
147	15	5	21
148	15	10	32
149	11	2	21
150	12	6	25
151	10	6	22
152	13	11	33
153	11	7	19
154	9	4	17
155	8	8	22
156	7	5	16
157	8	6	24
158	12	5	22
159	7	8	21
160	8	10	23
161	12	5	21
162	14	11	27
163	11	7	24
164	11	6	23
165	4	5	17
166	3	5	9
167	10	11	23
168	12	4	18
169	7	6	14
170	12	8	26
171	10	5	18
172	15	8	32
173	11	6	20
174	12	6	28
175	14	5	25
176	10	9	24
177	23	6	34
178	12	9	30
179	14	6	27
180	14	5	21
181	8	7	19
182	13	7	22
183	21	8	33
184	14	8	25
185	14	5	28
186	7	5	18
187	12	6	24
188	8	4	13
189	6	6	19
190	20	7	29
191	18	10	33
192	10	8	25
193	9	8	23
194	7	4	20
195	11	7	21
196	15	7	29
197	7	6	22
198	5	9	19
199	11	8	25
200	16	5	25

201	10	4	15
202	11	8	23
203	14	7	26
204	11	9	29
205	15	7	28
206	9	8	22
207	13	6	24
208	13	5	22
209	10	9	29
210	16	5	25
211	10	6	20
212	17	7	30
213	12	5	18
214	16	3	29
215	9	7	19
216	12	3	18
217	13	13	32
218	14	7	24
219	12	10	29
220	21	4	31
221	7	2	11
222	10	3	21
223	7	13	27
224	10	3	17
225	14	7	25
226	10	6	22
227	8	5	13
228	11	7	28
229	10	10	28
230	19	9	35
231	9	6	19
232	12	9	25
233	13	5	29
234	10	5	19
235	10	9	24
236	17	6	28
237	9	7	20
238	15	2	20
239	11	6	23
240	16	5	28
241	7	5	14
242	10	6	20
243	11	4	16
244	5	7	14
245	11	8	21
246	10	7	26
247	9	4	19
248	11	7	23
249	10	8	26
250	10	7	18
251	7	9	19
252	9	8	22
253	13	8	26
254	10	9	27
255	18	5	35
256	13	7	27
257	19	5	25
258	14	5	23
259	7	5	20
260	13	0	19
261	13	6	24
262	6	4	10
263	12	8	29

Protocol# 2 - bills swipes.lsa

264	10	4	21
265	7	9	24
266	11	7	24
267	11	4	21
268	14	9	28
269	15	7	25
270	11	4	21
271	11	8	24
272	16	11	28
273	13	2	24
274	11	4	22
275	21	6	29
276	18	4	25
277	8	8	21
278	8	8	22
279	5	12	19
280	14	8	23
281	13	10	27
282	10	6	17
283	6	7	19
284	13	7	26
285	12	5	21
286	14	3	24
287	5	6	19
288	13	3	22
289	14	9	31
290	14	5	22
291	11	5	20
292	11	5	24
293	8	8	16
294	10	5	20
295	8	4	20
296	18	10	31
297	11	12	29
298	12	7	25
299	11	13	29
300	13	6	25
301	8	10	22
302	11	6	19
303	10	9	25
304	11	5	18
305	15	11	36
306	18	7	27
307	8	3	13
308	14	12	26
309	14	6	21
310	15	10	30
311	7	11	20
312	9	4	19
313	19	5	30
314	8	4	18
315	7	4	16
316	11	4	21
317	14	6	23
318	9	9	20
319	7	6	15
320	6	7	15
321	11	7	24
322	8	8	18
323	9	5	21
324	15	8	27
325	17	7	26
326	10	7	21

327	14	7	28
328	9	6	17
329	15	11	33
330	8	4	18
331	9	9	21
332	8	9	23
333	15	5	25
334	12	10	24
335	13	4	25
336	7	5	15
337	13	12	29
338	14	10	29
339	12	6	23
340	10	1	11
341	18	12	35
342	10	5	20
343	19	3	30
344	15	5	27
345	17	8	31
346	16	9	30
347	9	4	20
348	10	6	23
349	12	5	19
350	10	7	25
351	15	2	24
352	13	5	22
353	10	8	24
354	6	7	20
355	5	4	11
356	9	4	19
357	15	10	30
358	9	7	24
359	11	7	22
360	9	5	20
361	13	3	17
362	8	5	18
363	7	6	15
364	6	6	15
365	17	9	31
366	7	6	20
367	9	9	28
368	12	10	29
369	10	4	18
370	8	8	20
371	20	4	27
372	10	8	23
373	13	6	26
374	8	8	20
375	7	5	18
376	15	4	22
377	20	7	31
378	7	4	17
379	8	6	18
380	5	6	17
381	11	3	19
382	13	7	26
383	17	6	28
384	13	4	20
385	7	4	15
386	8	3	14
387	5	8	14
388	8	7	20
389	10	9	22

Protocol# 2 - bills swipes.lsa

390	7	9	20
391	6	8	17
392	9	5	23
393	13	7	24
394	9	7	26
395	12	13	30
396	12	7	21
397	8	5	13
398	14	8	32
399	12	9	25
400	9	3	21
401	5	4	13
402	14	4	21
403	5	2	12
404	17	10	31
405	15	7	25
406	4	4	14
407	8	7	23
408	3	8	19
409	7	8	25
410	12	11	27
411	11	7	19
412	7	6	17
413	8	11	20
414	15	6	28
415	10	4	19
416	14	5	24
417	13	8	25
418	7	4	16
419	13	7	22
420	9	8	20
421	11	6	22
422	14	4	23
423	12	8	26
424	10	8	23
425	15	6	26
426	10	8	23
427	6	10	23
428	16	7	28
429	19	5	28
430	8	4	21
431	12	6	22
432	10	7	25
433	3	13	24
434	3	7	17
435	10	3	14
436	13	7	24
437	8	5	15
438	5	9	21
439	11	6	23
440	12	4	20
441	13	4	21
442	12	5	21
443	8	8	18
444	10	5	21
445	16	1	23
446	9	6	22
447	11	5	23
448	11	3	18
449	13	9	27
450	8	5	17
451	16	4	26
452	15	4	23

Protocol# 2 - bills swipes.lsa

453	7	6	22
454	10	6	18
455	9	4	17
456	15	5	27
457	13	6	23
458	14	8	26
459	15	7	27
460	15	7	28
461	9	6	17
462	8	4	19
463	10	11	26
464	1	6	12
465	8	7	20
466	4	6	12
467	15	4	24
468	5	9	18
469	13	3	22
470	12	6	21
471	10	6	18
472	13	5	26
473	7	8	20
474	7	3	11
475	9	7	20
476	7	8	20
477	9	4	18
478	9	9	24
479	2	8	13
480	16	4	23
481	14	11	34
482	15	5	26
483	15	7	23
484	12	7	24
485	10	4	21
486	5	6	12
487	7	6	17
488	7	7	15
489	11	6	19
490	16	5	26
491	19	9	30
492	14	6	22
493	11	7	21
494	20	5	29
495	5	5	12
496	8	5	19
497	11	3	19
498	11	7	26
499	8	8	24
500	8	8	23
501	10	7	26
502	13	11	26
503	11	10	26
504	8	5	20
505	8	7	17
506	11	6	21
507	10	7	20
508	9	6	19
509	15	6	28
510	15	6	34
511	12	6	26
512	3	4	8
513	5	6	14
514	10	5	25

Protocol# 2 - bills swipes.lsa

515	15	6	29
516	10	7	21
517	11	4	17
518	12	5	21
519	7	10	22
520	17	4	27
521	6	7	14
522	6	6	16
523	7	5	18
524	12	10	28
525	10	10	29
526	9	13	25
527	12	7	26
528	11	7	21
529	12	4	18
530	9	8	26
531	9	7	17
532	10	10	23
533	11	7	20
534	7	4	19
535	11	9	22
536	13	10	28
537	7	3	12
538	10	9	25
539	14	5	24
540	11	8	25
541	10	6	18
542	5	6	14
543	12	12	26
544	16	7	27
545	12	10	27
546	11	8	24
547	6	7	16
548	15	10	29
549	5	9	20
550	15	5	30
551	10	10	24
552	11	5	19
553	8	4	17
554	6	8	22

# Bld. 118B Room B311

Date: 4/14/2011

WIRE LOCATIONS

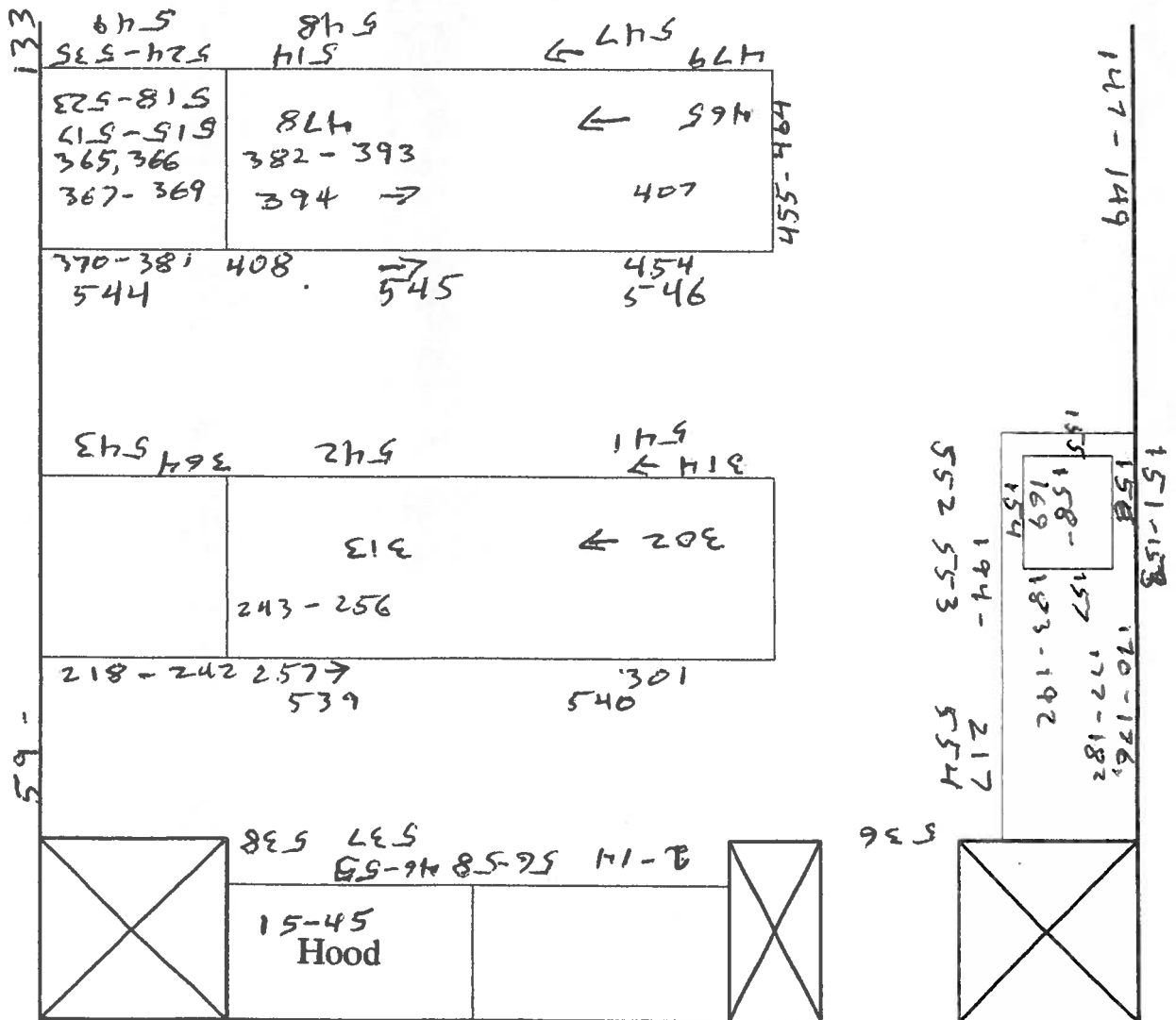
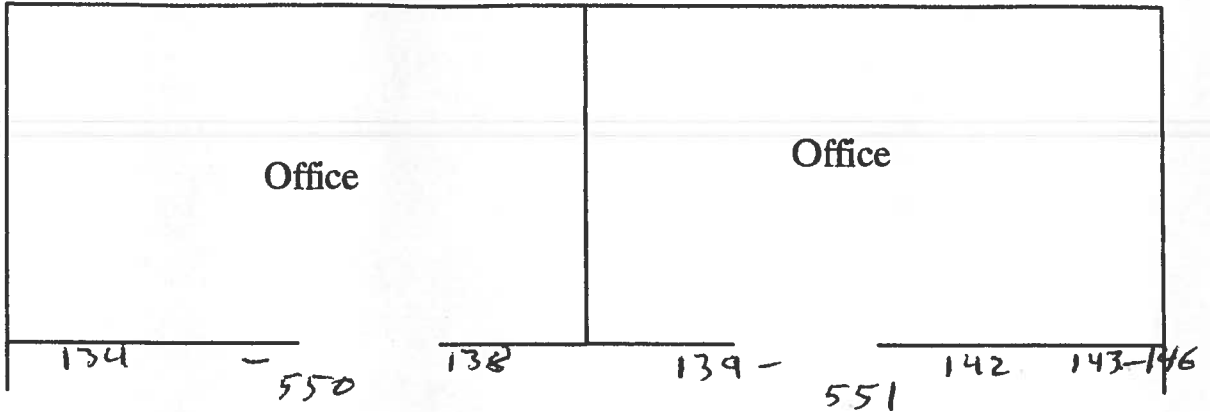

Note: A Ludlum 2241-2 was used to Rad Survey the lab. No Contamination was noted.

W.H. Colver