

## Radiological Survey Sheet

Job Location PFIZER INC, GROTON, CT. 06340 Page 1 of 18

Survey Purpose DECOMMISSIONING OF LAB 118B/B301 Date 12-9-09

Performed by E. GAILOR (Print) E. Gailor (Sign)

|                               |                             |                             |                        |                               |
|-------------------------------|-----------------------------|-----------------------------|------------------------|-------------------------------|
| <b>Instrument (Model/S/N)</b> | Packard Tri-Carb S/N 431521 | Packard Tri-Carb S/N 431520 | Ludlum 2241-2 163603   | Wallac Model 1409 S/N 4061042 |
| <b>Det. (Model/SN)</b>        | Internal                    | Internal                    | Ludlum 43-68 PR 149613 | Internal                      |
| <b>Type Rad.</b>              | β                           | β                           | β                      | β                             |
| <b>Cal. Due:</b>              | 04/03/2010                  | 04/03/2010                  | 04/07/2010             | 04/03/2010                    |
| <b>Check Instruments Used</b> | ✓                           |                             | ✓                      |                               |

| No. | Time | Locations          | See attached LSC printout for Total Activity (cpm/100 cm <sup>2</sup> ) |
|-----|------|--------------------|---|
| 1.  | 1200 | BACKGROUND         |   |
| 2.  |      | door               |   |
| 3.  |      | FLOOR              |   |
| 4.  |      | CAB DOORS & HANDLS |   |
| 5.  |      | TOP SHELF          |   |
| 6.  |      | 2ND "              |   |
| 7.  |      | 3RD "              |   |
| 8.  |      | 4TH                |   |
| 9.  |      | WALL               |   |
| 10. |      | CAB DOORS & HANDLS |   |
| 11. |      | TOP SHELF          |   |
| 12. |      | 2ND "              |   |
| 13. |      | BOTTOM "           |   |
| 14. |      | BENCH              |   |
| 15. |      | BENCH              |   |
| 16. |      | CUP                |   |
| 17. |      | SINK AREA          |   |
| 18. |      | TOP SHELF          |   |

# Radiological Survey Continuation Sheet

Page 2 of 18

Date 12-9-09

| No. | Time       | Locations            | See attached LSC printout for Total Activity (cpm/100 cm <sup>2</sup> ) |
|-----|------------|----------------------|---|
| 19  | 1200       | 2nd SHELF            |   |
| 20  |            | 3rd "                |   |
| 21  |            | PSC BOARD            |   |
| 22  |            | BENCH                |   |
| 23  |            | DRAWERS & HANDLS     |   |
| 24  |            | 1ST DRAWER           |   |
| 25  |            | 2nd "                |   |
| 26  |            | 3rd "                |   |
| 27  |            | 4th "                |   |
| 28  |            | DRAWER               |   |
| 29  |            | TOP "                |   |
| 30  |            | 2nd "                |   |
| 31  |            | 3rd "                |   |
| 32  |            | 4th "                |   |
| 33  |            | CAB. DOORS & HANDLS  |   |
| 34  |            | INSIDE CAB LEFT SIDE |   |
| 35  |            | " " " BACK           |   |
| 36  |            | " " " BOTTOM         |   |
| 37  |            | " " RIGHT "          |   |
| 38  |            | " " " SIDE           |   |
| 39  |            | TOP SHELF            |   |
| 40  |            | 2nd "                |   |
| 41  |            | 3rd "                |   |
| 42  |            | TOP "                |   |
| 43  |            | BOTTOM "             |   |
| 44  | UPPER WALL |                      |   |
| 45  | ↓          | LOWER "              |   |

# Radiological Survey Continuation Sheet

Page 3 of 18

Date 12-9-09

| No. | Time | Locations          | See attached LSC printout for Total Activity (cpm/100 cm <sup>2</sup> ) |
|-----|------|--------------------|---|
| 46  | 1200 | UPPER WALL         |   |
| 47  |      | LOWER "            |   |
| 48  |      | UPPER "            |   |
| 49  |      | LOWER "            |   |
| 50  |      | UPPER "            |   |
| 51  |      | LOWER "            |   |
| 52  |      | UPPER "            |   |
| 53  |      | LOWER "            |   |
| 54  |      | GAP DOORS & HANDLS |   |
| 55  |      | " TOP SHELF        |   |
| 56  |      | 2ND "              |   |
| 57  |      | 2ND "              |   |
| 58  |      | BOTTOM "           |   |
| 59  |      | DESK               |   |
| 60  |      | TOP DRAWER         |   |
| 61  |      | 2ND "              |   |
| 62  |      | BOTTOM "           |   |
| 63  |      | UPPER WALL         |   |
| 64  |      | LOWER "            |   |
| 65  |      | UPPER "            |   |
| 66  |      | LOWER "            |   |
| 67  |      | WALL               |   |
| 68  |      | "                  |   |
| 69  |      | UPPER WALL         |   |
| 70  |      | LOWER WALL         |   |
| 71  |      | GAP DOORS & HANDLS |   |
| 72  |      | TOP SHELF          |   |

# Radiological Survey Continuation Sheet

Page 4 of 18

Date 12-9-08

| No. | Time | Locations          | See attached LSC printout for Total Activity (cpm/100 cm <sup>2</sup> ) |  |  |
|-----|------|--------------------|---|--|--|
| 73  | 1200 | 2ND SHELF          |   |  |  |
| 74  |      | 3RD "              |   |  |  |
| 75  |      | BOTTOM "           |   |  |  |
| 76  |      | UPPER WALL         |   |  |  |
| 77  |      | LOWER "            |   |  |  |
| 78  |      | LEDGE              |   |  |  |
| 79  |      | WALL               |   |  |  |
| 80  |      | BACK OF BENCH      |   |  |  |
| 81  |      | " " "              |   |  |  |
| 82  |      | " " "              |   |  |  |
| 83  |      | " " "              |   |  |  |
| 84  |      | SHELF              |   |  |  |
| 85  |      | "                  |   |  |  |
| 86  |      | "                  |   |  |  |
| 87  |      | CUP                |   |  |  |
| 88  |      | "                  |   |  |  |
| 89  |      | BENCH              |   |  |  |
| 90  |      | "                  |   |  |  |
| 91  |      | "                  |   |  |  |
| 92  |      | "                  |   |  |  |
| 93  |      | "                  |   |  |  |
| 94  |      | TOP SHELF          |   |  |  |
| 95  |      | 2ND "              |   |  |  |
| 96  |      | 3RD "              |   |  |  |
| 97  |      | DESK               |   |  |  |
| 98  |      | CAB DOORS & HANDLS |   |  |  |
| 99  |      | ✓                  | TOP SHELF   |  |  |

# Radiological Survey Continuation Sheet

Page 5 of 18

Date 12-9-09

| No.                   | Time | Locations          | See attached LSC printout for Total Activity (cpm/100 cm <sup>2</sup> ) |
|-----------------------|------|--------------------|---|
| 100                   | 1200 | 2nd SHELF          |   |
| 101                   |      | 3rd "              |   |
| 102                   |      | Bottom "           |   |
| 103                   |      | CAB DOORS & HANDLS |   |
| 104                   |      | TOP SHELF          |   |
| 105                   |      | 2nd "              |   |
| 106                   |      | 3rd "              |   |
| <del>107</del><br>108 |      | 4th "              |   |
| 108                   |      | Bottom "           |   |
| 109                   |      | CAB DOORS & HANDLS |   |
| 110                   |      | TOP SHELF          |   |
| 111                   |      | 2nd "              |   |
| 112                   |      | 3rd "              |   |
| 113                   |      | Bottom "           |   |
| 114                   |      | TOP DRAWER         |   |
| 115                   |      | 2nd "              |   |
| 116                   |      | 3rd "              |   |
| 117                   |      | Bottom "           |   |
| 118                   |      | TOP "              |   |
| 119                   |      | 2nd "              |   |
| 120                   |      | 3rd "              |   |
| 121                   |      | Bottom "           |   |
| 122                   |      | DRAWER             |   |
| 123                   |      | DRAWER             |   |
| 124                   |      | TOP "              |   |
| 125                   |      | 2nd "              |   |
| 126                   | ↓    | 3rd "              |   |



# Radiological Survey Continuation Sheet

Page 6 of 18

Date 12-9-09

| No. | Time | Locations     | See attached LSC printout for Total Activity (cpm/100 cm <sup>2</sup> ) |
|-----|------|---------------|---|
| 127 | 1200 | BOTTOM DRAWER |   |
| 128 |      | DRAWER        |   |
| 129 |      | TOP DRAWER    |   |
| 130 |      | 2nd "         |   |
| 131 |      | 3rd "         |   |
| 132 |      | TOP SHELF     |   |
| 133 |      | LOWER WALL    |   |
| 134 |      | TOP DRAWER    |   |
| 135 |      | 2nd "         |   |
| 136 |      | 3rd "         |   |
| 137 |      | TOP SHELF     |   |
| 138 |      | 2nd "         |   |
| 139 |      | 3rd "         |   |
| 140 |      | DESK          |   |
| 141 |      | DRAWER        |   |
| 142 |      | TOP SHELF     |   |
| 143 |      | 2nd "         |   |
| 144 |      | 3rd "         |   |
| 145 |      | SHELF         |   |
| 146 |      | CUP           |   |
| 147 |      | CUP           |   |
| 148 |      | BENCH         |   |
| 149 |      | "             |   |
| 150 |      | "             |   |
| 151 |      | "             |   |
| 152 |      | "             |   |
| 153 | ✓    | "             |   |

# Radiological Survey Continuation Sheet

Page  2  of  18

Date  12-9-09

| No. | Time | Locations          | See attached LSC printout for Total Activity (cpm/100 cm <sup>2</sup> ) |
|-----|------|--------------------|---|
| 154 | 1200 | BENCH              |   |
| 155 |      | "                  |   |
| 156 |      | TOP DRAWER         |   |
| 157 |      | 2ND "              |   |
| 158 |      | 3RD "              |   |
| 159 |      | 4TH "              |   |
| 160 |      | "                  |   |
| 161 |      | TOP "              |   |
| 162 |      | 2ND "              |   |
| 163 |      | 3RD "              |   |
| 164 |      | 4TH "              |   |
| 165 |      | DRAWER             |   |
| 166 |      | TOP "              |   |
| 167 |      | CAB DOORS & HANDLS |   |
| 168 |      | TOP SHELF          |   |
| 169 |      | BOTTOM "           |   |
| 170 |      | TOP DRAWER         |   |
| 171 |      | 2ND "              |   |
| 172 |      | 3RD "              |   |
| 173 |      | 4TH "              |   |
| 174 |      | TOP "              |   |
| 175 |      | 2ND "              |   |
| 176 |      | 3RD "              |   |
| 177 |      | 4TH "              |   |
| 178 |      | DRAWER             |   |
| 179 |      | TOP "              |   |
| 180 | ✓    | 2ND "              |   |

# Radiological Survey Continuation Sheet

Page 8 of 18

Date 12-9-09

| No. | Time | Locations           | See attached LSC printout for Total Activity (cpm/100 cm <sup>2</sup> ) |
|-----|------|---------------------|---|
| 181 | 1200 | 3rd " DRAWER        |   |
| 182 |      | 4th " "             |   |
| 183 |      | TOP "               |   |
| 184 |      | 2nd "               |   |
| 185 |      | 3rd "               |   |
| 186 |      | BOTTOM "            |   |
| 187 |      | CRAWER              |   |
| 188 |      | TOP "               |   |
| 189 |      | 2nd "               |   |
| 196 |      | 3rd "               |   |
| 191 |      | TOP SHELF           |   |
| 192 |      | 2nd "               |   |
| 193 |      | 3rd "               |   |
| 194 |      | DESK                |   |
| 195 |      | CAB door & HANDLES  |   |
| 196 |      | 1ST SHELF           |   |
| 197 |      | 2nd "               |   |
| 198 |      | 3rd "               |   |
| 199 |      | CAB doors & HANDLES |   |
| 200 |      | TOP SHELF           |   |
| 201 |      | 2nd "               |   |
| 202 |      | 3rd "               |   |
| 203 |      | BOTTOM "            |   |
| 204 |      | UPPER WALL          |   |
| 205 |      | LOWER "             |   |
| 206 |      | UPPER "             |   |
| 207 | ✓    | LOWER "             |   |



# Radiological Survey Continuation Sheet

Page 9 of 18

Date 12-9-08

| No. | Time | Locations  | See attached LSC printout for Total Activity (cpm/100 cm <sup>2</sup> ) |
|-----|------|------------|---|
| 208 | 1200 | BENCY      |   |
| 209 |      | UPPER WALL |   |
| 210 |      | LOWER WALL |   |
| 211 |      |            |   |
| 212 |      |            |   |
| 213 |      |            |   |
| 214 |      | UPPER      |   |
| 215 |      | LOWER      |   |
| 216 |      | UPPER      |   |
| 217 |      | LOWER      |   |
| 218 |      | BENCY      |   |
| 219 |      |            |   |
| 220 |      |            |   |
| 221 |      |            |   |
| 223 |      | TOP DRAWER |   |
| 223 |      | 2ND        |   |
| 224 |      | 3RD        |   |
| 225 |      | 4TH        |   |
| 226 |      |            |   |
| 227 |      | TOP        |   |
| 228 |      | 2ND        |   |
| 229 |      | 3RD        |   |
| 230 |      | 4TH        |   |
| 231 |      |            |   |
| 232 |      | TOP        |   |
| 233 |      | 2ND        |   |
| 234 | ↓    | 3RD        |   |

# Radiological Survey Continuation Sheet

Page 10 of 18

Date 12.9.09

| No. | Time | Locations     | See attached LSC printout for Total Activity (cpm/100 cm <sup>2</sup> ) |
|-----|------|---------------|---|
| 235 | 1200 | BOTTOM DRAWER |   |
| 236 |      | FLOOR         |   |
| 237 |      | "             |   |
| 238 |      | "             |   |
| 239 |      | "             |   |
| 240 |      | "             |   |
| 241 |      | "             |   |
| 242 |      | "             |   |
| 243 |      | "             |   |
| 244 |      | "             |   |
| 245 |      | "             |   |
| 246 |      | "             |   |
| 247 |      | "             |   |
| 248 |      | "             |   |
| 249 |      | "             |   |
| 250 |      | "             |   |
| 251 |      | "             |   |
| 252 |      | "             |   |
| 253 |      | "             |   |
| 254 |      | "             |   |
| 255 |      | "             |   |
| 256 |      | "             |   |
| 257 |      | "             |   |
| 258 |      | "             |   |
| 259 |      | "             |   |
| 260 |      | "             |   |
| 261 | ↓    | "             |   |



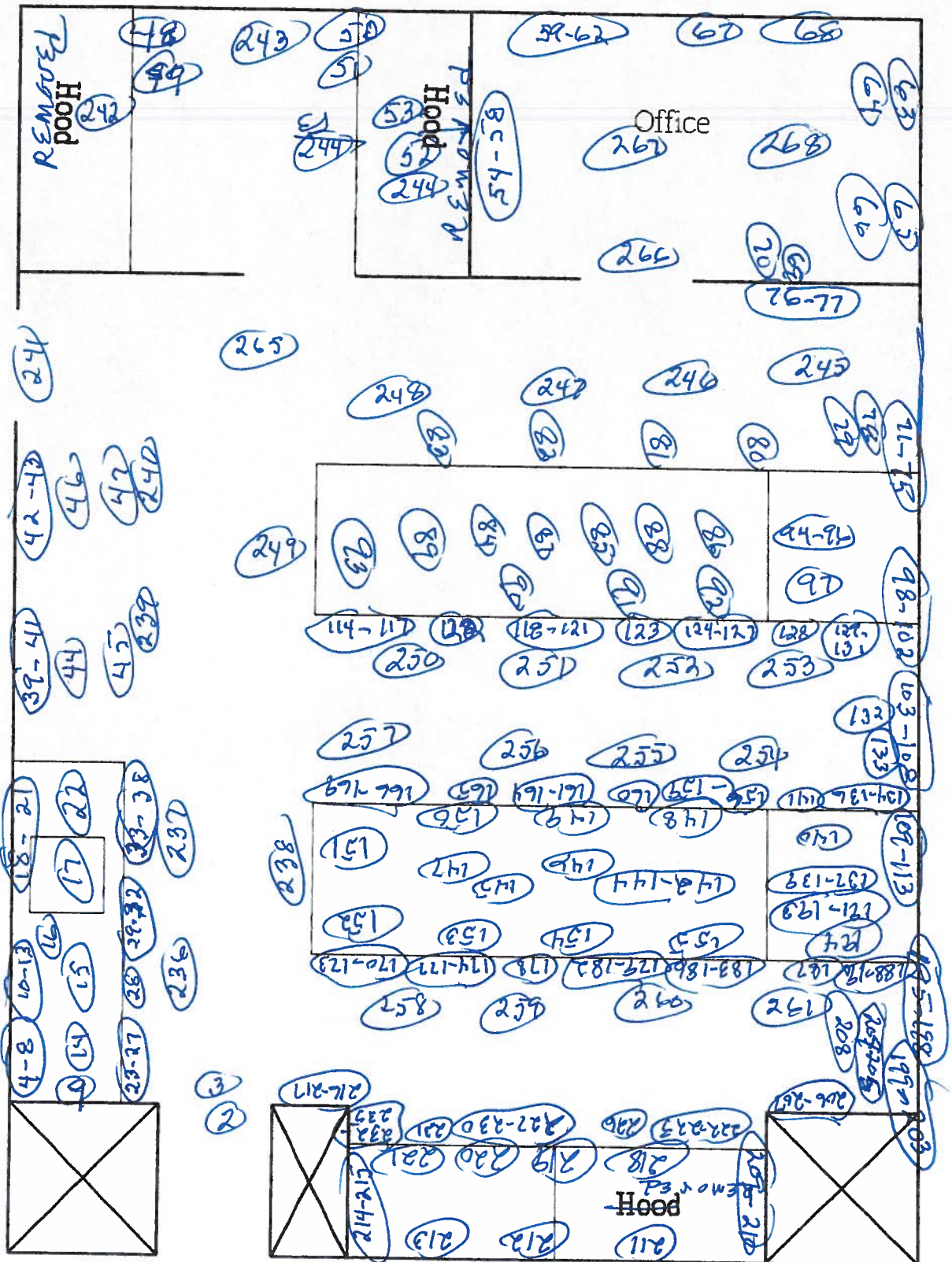

○ = wipe location.

Swabbed 100% of lower surfaces using 43-68. No  
 PAH readings in excess of normal background were noted.



Assay Definition-

Assay Description:  
Equipment Swipes

Assay Type: CPM  
Report Name: Report1  
Output Data Path: C:\Packard\Tricarb\Results\Ed Gailor\Eds Monthly Swipes  
Raw Results Path: C:\Packard\Tricarb\Results\Ed Gailor\Eds Monthly Swipes\20091209\_1613  
\20091209\_1613.results  
RTF File Name: C:\Packard\Tricarb\Results\Ed Gailor\Eds Monthly Swipes\Ed's Monthly  
Swipes.rtf  
Assay File Name: C:\Packard\TriCarb\Assays\Eds Monthly Swipes.lsa

Count Conditions-

Nuclide: Triple  
Quench Indicator: tSIE/AEC  
External Std Terminator (sec): 0.5 2s%  
Pre-Count Delay (min): 0.00  
Quench Set: n/a  
Count Time (min): 1.00  
Count Mode: Normal  
Assay Count Cycles: 1 Repeat Sample Count: 1  
#Vials/Sample: 1 Calculate % Reference: Off

Background Subtract: On - Manual  
Low CPM Threshold: Off  
2 Sigma % Terminator: Off

| Regions | LL   | UL     | Bkg Subtract |
|---------|------|--------|--------------|
| A       | 0.0  | 18.6   | 0.00         |
| B       | 18.6 | 156.0  | 0.00         |
| C       | 0.0  | 2000.0 | 0.00         |

Count Corrections-

Static Controller: On Luminescence Correction: On  
Colored Samples: n/a Heterogeneity Monitor: n/a  
Coincidence Time (nsec): 18 Delay Before Burst (nsec): 75

Half Life-

Half Life Correction: Off

| Regions | Half Life | Units | Reference Date | Reference Time |
|---------|-----------|-------|----------------|----------------|
| A       |           |       |                |                |
| B       |           |       |                |                |
| C       |           |       |                |                |

Cycle 1 Results

| S# | CPMA | CPMB | CPMC | MESSAGES |
|----|------|------|------|----------|
| 1  | 24   | 13   | 42   |          |
| 2  | 0    | 9    | 17   |          |
| 3  | 10   | 9    | 26   |          |
| 4  | 21   | 6    | 35   |          |
| 5  | 22   | 8    | 33   |          |
| 6  | 0    | 11   | 16   |          |
| 7  | 0    | 8    | 13   |          |
| 8  | 15   | 5    | 26   |          |
| 9  | 6    | 7    | 18   |          |
| 10 | 18   | 7    | 29   |          |



|    |    |    |    |
|----|----|----|----|
| 11 | 15 | 7  | 27 |
| 12 | 3  | 7  | 14 |
| 13 | 13 | 9  | 28 |
| 14 | 4  | 7  | 14 |
| 15 | 11 | 10 | 28 |
| 16 | 13 | 6  | 24 |
| 17 | 10 | 8  | 21 |
| 18 | 10 | 9  | 24 |
| 19 | 18 | 7  | 33 |
| 20 | 8  | 5  | 19 |
| 21 | 19 | 6  | 28 |
| 22 | 6  | 6  | 15 |
| 23 | 20 | 8  | 35 |
| 24 | 0  | 5  | 8  |
| 25 | 0  | 4  | 4  |
| 26 | 12 | 9  | 28 |
| 27 | 12 | 7  | 30 |
| 28 | 10 | 5  | 19 |
| 29 | 15 | 11 | 30 |
| 30 | 22 | 3  | 34 |
| 31 | 7  | 6  | 15 |
| 32 | 9  | 7  | 20 |
| 33 | 20 | 4  | 29 |
| 34 | 13 | 6  | 23 |
| 35 | 7  | 4  | 20 |
| 36 | 12 | 8  | 25 |
| 37 | 5  | 6  | 15 |
| 38 | 14 | 6  | 26 |
| 39 | 22 | 5  | 35 |
| 40 | 22 | 5  | 34 |
| 41 | 12 | 6  | 29 |
| 42 | 0  | 9  | 0  |
| 43 | 13 | 8  | 23 |
| 44 | 6  | 8  | 18 |
| 45 | 15 | 8  | 29 |
| 46 | 1  | 5  | 10 |
| 47 | 8  | 10 | 21 |
| 48 | 0  | 5  | 8  |
| 49 | 11 | 14 | 36 |
| 50 | 0  | 14 | 21 |
| 51 | 3  | 7  | 13 |
| 52 | 23 | 10 | 37 |
| 53 | 17 | 4  | 26 |
| 54 | 21 | 9  | 31 |
| 55 | 14 | 11 | 27 |
| 56 | 14 | 8  | 30 |
| 57 | 0  | 8  | 0  |
| 58 | 6  | 5  | 14 |
| 59 | 8  | 8  | 18 |
| 60 | 15 | 6  | 22 |
| 61 | 10 | 6  | 19 |
| 62 | 10 | 6  | 24 |
| 63 | 3  | 12 | 19 |
| 64 | 0  | 8  | 20 |
| 65 | 16 | 8  | 26 |
| 66 | 0  | 8  | 5  |
| 67 | 4  | 7  | 16 |
| 68 | 9  | 6  | 18 |
| 69 | 0  | 8  | 7  |
| 70 | 5  | 9  | 16 |
| 71 | 8  | 12 | 25 |
| 72 | 7  | 7  | 17 |

|     |    |    |    |
|-----|----|----|----|
| 73  | 0  | 5  | 8  |
| 74  | 23 | 7  | 38 |
| 75  | 10 | 10 | 25 |
| 76  | 3  | 2  | 8  |
| 77  | 0  | 6  | 6  |
| 78  | 10 | 8  | 22 |
| 79  | 5  | 4  | 13 |
| 80  | 27 | 6  | 41 |
| 81  | 17 | 5  | 31 |
| 82  | 1  | 13 | 21 |
| 83  | 5  | 10 | 20 |
| 84  | 3  | 2  | 14 |
| 85  | 7  | 7  | 19 |
| 86  | 5  | 4  | 16 |
| 87  | 1  | 9  | 17 |
| 88  | 13 | 10 | 27 |
| 89  | 15 | 5  | 22 |
| 90  | 2  | 11 | 19 |
| 91  | 17 | 8  | 30 |
| 92  | 13 | 5  | 20 |
| 93  | 5  | 4  | 12 |
| 94  | 9  | 5  | 20 |
| 95  | 5  | 10 | 26 |
| 96  | 15 | 8  | 28 |
| 97  | 20 | 8  | 42 |
| 98  | 13 | 2  | 20 |
| 99  | 0  | 5  | 1  |
| 100 | 15 | 12 | 32 |
| 101 | 6  | 10 | 20 |
| 102 | 10 | 7  | 22 |
| 103 | 15 | 3  | 23 |
| 104 | 7  | 10 | 21 |
| 105 | 18 | 10 | 35 |
| 106 | 6  | 7  | 20 |
| 107 | 9  | 10 | 23 |
| 108 | 0  | 5  | 3  |
| 109 | 0  | 11 | 8  |
| 110 | 0  | 7  | 5  |
| 111 | 1  | 9  | 14 |
| 112 | 6  | 5  | 16 |
| 113 | 3  | 9  | 15 |
| 114 | 4  | 8  | 19 |
| 115 | 13 | 8  | 26 |
| 116 | 0  | 4  | 8  |
| 117 | 1  | 11 | 16 |
| 118 | 15 | 3  | 26 |
| 119 | 0  | 15 | 22 |
| 120 | 0  | 11 | 13 |
| 121 | 0  | 7  | 8  |
| 122 | 21 | 6  | 29 |
| 123 | 5  | 8  | 18 |
| 124 | 13 | 5  | 23 |
| 125 | 12 | 7  | 21 |
| 126 | 12 | 7  | 25 |
| 127 | 17 | 8  | 33 |
| 128 | 0  | 8  | 13 |
| 129 | 3  | 5  | 15 |
| 130 | 17 | 12 | 37 |
| 131 | 0  | 6  | 0  |
| 132 | 11 | 6  | 21 |
| 133 | 10 | 6  | 20 |
| 134 | 13 | 4  | 21 |
| 135 | 16 | 7  | 29 |

|     |    |    |    |
|-----|----|----|----|
| 136 | 0  | 11 | 16 |
| 137 | 0  | 3  | 2  |
| 138 | 23 | 7  | 35 |
| 139 | 1  | 9  | 16 |
| 140 | 12 | 2  | 17 |
| 141 | 10 | 7  | 20 |
| 142 | 4  | 6  | 19 |
| 143 | 3  | 3  | 12 |
| 144 | 14 | 2  | 19 |
| 145 | 0  | 7  | 7  |
| 146 | 4  | 9  | 20 |
| 147 | 2  | 7  | 13 |
| 148 | 16 | 7  | 28 |
| 149 | 0  | 9  | 16 |
| 150 | 10 | 10 | 24 |
| 151 | 11 | 10 | 27 |
| 152 | 25 | 9  | 37 |
| 153 | 5  | 12 | 23 |
| 154 | 17 | 10 | 38 |
| 155 | 1  | 9  | 15 |
| 156 | 0  | 11 | 8  |
| 157 | 0  | 10 | 11 |
| 158 | 0  | 11 | 12 |
| 159 | 14 | 6  | 24 |
| 160 | 0  | 13 | 15 |
| 161 | 0  | 5  | 12 |
| 162 | 1  | 8  | 14 |
| 163 | 21 | 13 | 39 |
| 164 | 9  | 7  | 20 |
| 165 | 2  | 8  | 16 |
| 166 | 0  | 12 | 2  |
| 167 | 5  | 13 | 22 |
| 168 | 7  | 12 | 24 |
| 169 | 0  | 5  | 0  |
| 170 | 10 | 8  | 24 |
| 171 | 0  | 5  | 6  |
| 172 | 0  | 4  | 8  |
| 173 | 0  | 8  | 10 |
| 174 | 10 | 10 | 29 |
| 175 | 9  | 8  | 25 |
| 176 | 9  | 5  | 19 |
| 177 | 0  | 6  | 3  |
| 178 | 0  | 2  | 6  |
| 179 | 0  | 12 | 7  |
| 180 | 0  | 7  | 9  |
| 181 | 0  | 9  | 9  |
| 182 | 9  | 7  | 20 |
| 183 | 3  | 7  | 16 |
| 184 | 8  | 7  | 20 |
| 185 | 0  | 8  | 9  |
| 186 | 2  | 3  | 14 |
| 187 | 4  | 12 | 19 |
| 188 | 0  | 8  | 13 |
| 189 | 7  | 10 | 21 |
| 190 | 4  | 5  | 16 |
| 191 | 13 | 12 | 25 |
| 192 | 8  | 8  | 27 |
| 193 | 19 | 10 | 41 |
| 194 | 8  | 9  | 23 |
| 195 | 0  | 5  | 0  |
| 196 | 0  | 14 | 22 |
| 197 | 3  | 9  | 15 |
| 198 | 0  | 4  | 0  |

|     |    |    |    |
|-----|----|----|----|
| 199 | 0  | 9  | 5  |
| 200 | 0  | 7  | 3  |
| 201 | 10 | 7  | 22 |
| 202 | 15 | 4  | 27 |
| 203 | 16 | 8  | 33 |
| 204 | 12 | 4  | 23 |
| 205 | 10 | 8  | 23 |
| 206 | 5  | 8  | 16 |
| 207 | 15 | 5  | 26 |
| 208 | 0  | 11 | 16 |
| 209 | 21 | 9  | 37 |
| 210 | 14 | 7  | 22 |
| 211 | 10 | 12 | 30 |
| 212 | 10 | 11 | 27 |
| 213 | 29 | 8  | 41 |
| 214 | 10 | 5  | 21 |
| 215 | 0  | 11 | 14 |
| 216 | 7  | 7  | 20 |
| 217 | 12 | 14 | 32 |
| 218 | 0  | 2  | 4  |
| 219 | 15 | 8  | 28 |
| 220 | 15 | 7  | 24 |
| 221 | 1  | 6  | 13 |
| 222 | 28 | 6  | 38 |
| 223 | 16 | 8  | 27 |
| 224 | 32 | 9  | 51 |
| 225 | 0  | 7  | 11 |
| 226 | 0  | 9  | 14 |
| 227 | 21 | 11 | 40 |
| 228 | 1  | 8  | 11 |
| 229 | 0  | 7  | 0  |
| 230 | 0  | 10 | 12 |
| 231 | 9  | 6  | 21 |
| 232 | 5  | 4  | 17 |
| 233 | 1  | 8  | 14 |
| 234 | 8  | 12 | 25 |
| 235 | 14 | 4  | 24 |
| 236 | 2  | 8  | 11 |
| 237 | 11 | 9  | 28 |
| 238 | 12 | 5  | 21 |
| 239 | 2  | 6  | 12 |
| 240 | 5  | 7  | 18 |
| 241 | 0  | 7  | 10 |
| 242 | 9  | 4  | 17 |
| 243 | 0  | 6  | 9  |
| 244 | 9  | 2  | 13 |
| 245 | 2  | 4  | 10 |
| 246 | 11 | 10 | 26 |
| 247 | 21 | 14 | 39 |
| 248 | 15 | 10 | 29 |
| 249 | 0  | 15 | 16 |
| 250 | 3  | 9  | 16 |
| 251 | 15 | 3  | 22 |
| 252 | 0  | 9  | 10 |
| 253 | 25 | 9  | 38 |
| 254 | 5  | 9  | 22 |
| 255 | 0  | 3  | 6  |
| 256 | 0  | 9  | 5  |
| 257 | 7  | 9  | 20 |
| 258 | 17 | 2  | 28 |
| 259 | 2  | 11 | 19 |
| 260 | 0  | 5  | 1  |
| 261 | 3  | 5  | 17 |

|     |    |   |    |
|-----|----|---|----|
| 262 | 5  | 2 | 13 |
| 263 | 2  | 4 | 10 |
| 264 | 3  | 8 | 14 |
| 265 | 0  | 9 | 17 |
| 266 | 13 | 7 | 26 |
| 267 | 22 | 6 | 33 |
| 268 | 9  | 4 | 23 |