

Radiological Survey Sheet

Job Location 118B/B210 Page 1 of 27
 Survey Purpose LAB CLOSE OUT Date 11-10-00
 Performed By E. GAILOR E. Gailor
 (Print) (Sign)

Inst.(1) Beckman LS 6500 (Model/SN) #7069448	Inst.(2) Lullum 2241-2 (Model/SN) #163603	Inst.(3) (Model/SN)
Det. Internal (Model/SN)	Det. Lullum 43-68 (Model/SN) #149613	Det. (Model/SN)
Eff. See LSC Printout	Eff. = 85%	Eff.
Type rad. β	Type rad. β	Type rad.
Bkgd. See LSC Printout	Bkgd. 300 cpm	Bkgd.
Cal. Due: 12/00	Cal. Due 2/13/01	Cal. due

No.	Time	Location	Inst. Used	Total Activity (dpm/100 cm ²)
1.	0812	DOOR & HNDL	1	See attached LSC Printout
2.		FLOOR	1	
3.		UPPER WALL	1	
4.		LOWER "	1	
5.		UPPER "	1	
6.		LOWER "	1	
7.		CAB. DOORS & HNDLS	1	
8.		TOP SHELF	1	
9.		2ND "	1	
10.		3RD "	1	
11.		BOTTOM "	1	
12.		CAB. DOORS & HNDLS	1	
13.		TOP SHELF	1	
14.		MIDDLE "	1	
15.		BOTTOM "	1	
16.		TOP SHELF	1	
17.		BOTTOM "	1	
18.		COUNTER	1	

Radiological Survey Continuation Sheet

Page 2 of 27

Date 11-10-00

No.	Time	Location	Inst. Used	Total Activity (dpm/100 cm ²)
19	0812	COUNTER	1	See attached LSC Printout
20		COUNTER	1	
21		CUP	1	
22		WALL	1	
23		PEG BOARD	1	
24		^{EA} BENCH BEHIND SINK	1	
25		INSIDE SINK	1	
26		SINK LEDGE	1	
27		COUNTER	1	
28		DRAWERS & HANDLS	1	
29		TOP DRAWER	1	
30		2ND "	1	
31		3RD "	1	
32		BOTTOM "	1	
33		DRAWER & HANDL	1	
34		DRAWER	1	
35		DRAWERS & HANDLS	1	
36		TOP DRAWER	1	
37		2ND "	1	
38		3RD "	1	
39		BOTTOM "	1	
40		CAB. door ^s & HANDLS	1	
41		BACK OF CAB.	1	
42		LEFT SIDE OF CAB.	1	
43		RIGHT " " "	1	
44		BOTTOM RIGHT SIDE OF CAB.	1	
45		PLASTIC TRAY LEFT SIDE OF CAB.	1	
46	✓	FLOOR	1	✓

Radiological Survey Continuation Sheet

Page 3 of 27

Date 11/10-00

No.	Time	Location	Inst. Used	Total Activity (dpm/100 cm ²)
47	0812	FLOOR	1	See attached LSC Printout
48		FLOOR	1	
49		UPPER WALL	1	
50		LOWER "	1	
51		FLOOR	1	
52		TOP OF REFRIG.	1	
53		RIGHT SIDE OF REFRIG	1	
54		LEFT " " "	1	
55		REFRIG UPPER DOOR & HNDL	1	
56		" LOWER " " "	1	
57		BACK OF FREEZER INSIDE	1	
58		RIGHT SIDE OF FREEZER "	1	
59		LEFT " " " "	1	
60		BOTTOM " FREEZER "	1	
61		TOP OF REFRIG INSIDE	1	
62		BACK OF " "	1	
63		LEFT SIDE " " "	1	
64		RIGHT " " " "	1	
65		REFRIG. TRAYS	1	
66		LEFT CONTAINER REFRIG	1	
67		RIGHT " "	1	
68		REFRIG TOP LEFT SMALL SHELF	1	
69		" " 2ND " "	1	
70		" " 3RD " "	1	
71		REFRIG TOP RIGHT SMALL SHELF	1	
72		" " 2ND " " "	1	
73		" " 3RD " " "	1	
74	✓	REFRIG TOP BIG SHELF	1	✓

Radiological Survey Continuation Sheet

Page 4 of 27

Date 11-10-00

No.	Time	Location	Inst. Used	Total Activity (dpm/100 cm ²)
75	0812	REFRIG. BOTTOM BIG SHELF	1	See attached LSC Printout
76		UPPER WALL	1	
77		LOWER WALL	1	
78		DRAWER & HNDL	1	
79		DRAWER	1	
80		FLOOR	1	
81		FLOOR	1	
82		FLOOR	1	
83		TOP OF CAB	1	
84		DRAWERS & HNDLS	1	
85		TOP DRAWER	1	
86		2ND "	1	
87		BOTTOM "	1	
88		CAB TOP	1	
89		DOORS & HNDLS	1	
90		TOP DRAWER	1	
91		BOTTOM "	1	
92		FLOOR	1	
93		UPPER WALL	1	
94		LOWER "	1	
95		UPPER "	1	
96		LOWER "	1	
97		TABLE TOP	1	
98		DRAWER & HNDL	1	
99		DRAWER	1	
100		FLOOR	1	
101		TABLE TOP	1	
102	✓	FLOOR UNDER TABLE	1	✓

Radiological Survey Continuation Sheet

Page 5 of 27

Date 11-10-00

No.	Time	Location	Inst. Used	Total Activity (dpm/100 cm ²)
103	0812	TABLE TOP	1	See attached LSC Printout
104		" "	1	
105		FLOOR UNDER TABLE	1	
106		" " "	1	
107		UPPER WALL	1	
108		LOWER "	1	
109		TABLE TOP	1	
110		FLOOR UNDER TABLE	1	
111		DRAWER & HNDL	1	
112		DRAWER	1	
113		DRAWER & HNDL	1	
114		DRAWER	1	
115		FLOOR	1	
116		FLOOR	1	
117		FLOOR	1	
118		TABLE TOP	1	
119		" "	1	
120		DRAWER & HNDL	1	
121		DRAWER	1	
122		DRAWER & HNDL	1	
123		DRAWER	1	
124		CAB TOP	1	
125		CAB DOORS & HANDLS	1	
126		TOP DRAWER	1	
127		MIDDLE "	1	
128		BOTTOM "	1	
129		CAB. DOORS & HANDLS	1	
130	✓	TOP DRAWER	1	✓

Radiological Survey Continuation Sheet

Page 6 of 27

Date 11-10-00

No.	Time	Location	Inst. Used	Total Activity (dpm/100 cm ²)
131	0812	2ND DRAWER	1	See attached LSC Printout
132		3RD "	1	
133		4TH "	1	
134		BOTTOM "	1	
135		DESK	1	
136		DESK	1	
137		FLOOR	1	
138		LOWER WALL	1	
139		FLOOR	1	
140		TOP SHELF	1	
141		2ND "	1	
142		3RD "	1	
143		4TH "	1	
144		BOTTOM "	1	
145		DRAWER & HANDLS	1	
146		TOP DRAWER	1	
147		2ND "	1	
148		BOTTOM "	1	
149		DRAWER & HANDL	1	
150		DRAWER	1	
151		CAB. DOORS & HANDLS	1	
152		TOP SHELF	1	
153		2ND "	1	
154		3RD "	1	
155		BOTTOM "	1	
156		TOP SHELF	1	
157		^{ED} 2ND BOTTOM SHELF	1	
158	✓	DESK	1	✓

Radiological Survey Continuation Sheet

Page 7 of 27

Date 11-10-00

No.	Time	Location	Inst. Used	Total Activity (dpm/100 cm ²)
159	0812	TOP SHELF	1	See attached LSC Printout
160		2ND "	1	
161		BOTTOM "	1	
162		DRAWERS & HANDLS	1	
163		TOP DRAWER	1	
164		2ND "	1	
165		3RD "	1	
166		BOTTOM "	1	
167		DRAWERS & HANDLS	1	
168		TOP DRAWER	1	
169		2ND "	1	
170		3RD "	1	
171		BOTTOM "	1	
172		DRAWERS & HANDLS	1	
173		TOP DRAWER	1	
174		2ND "	1	
175		3RD "	1	
176		BOTTOM "	1	
177		CHAIR	1	
178		CHAIR	1	
179		FLOOR	1	
180		FLOOR	1	
181		FLOOR	1	
182		STOOL	1	
183		TOP SHELF	1	
184		MIDDLE "	1	
185		BOTTOM "	1	
186	✓	TOP SHELF	1	✓

Radiological Survey Continuation Sheet

Page 8 of 27

Date 11-10-00

No.	Time	Location	Inst. Used	Total Activity (dpm/100 cm ²)
187	0812	MIDDLE SHELF	1	See attached LSC Printout
188		BOTTOM "	1	
189		TOP SHELF	1	
190		MIDDLE "	1	
191		BOTTOM "	1	
192		METAL TRAY	1	
193		CUP	1	
194		CUP	1	
195		COUNTER	1	
196		COUNTER	1	
197		COUNTER	1	
198		COUNTER	1	
199		COUNTER	1	
200		COUNTER	1	
201		TOP DRAWER & HANDL	1	
202		DRAWER	1	
203		CAB. DOORS & HANDLS	1	
204		TOP SHELF	1	
205		BOTTOM SHELF	1	
206		DRAWER & HANDL	1	
207		DRAWER	1	
208		DRAWERS & HANDLS	1	
209		TOP DRAWER	1	
210		2ND "	1	
211		3RD "	1	
212		BOTTOM "	1	
213		DRAWERS & HANDLS	1	
214	✓	TOP DRAWER	1	✓

Radiological Survey Continuation Sheet

Page 9 of 27
 EA
 Date 11-10-00

No.	Time	Location	Inst. Used	Total Activity (dpm/100 cm ²)
215	0812	2ND DRAWER	1	See attached LSC Printout
216		3RD "	1	
217		BOTTOM "	1	
218		DRAWER & HNDL	1	
219		DRAWER	1	
220		DRAWERS & HNDLS	1	
221		TOP DRAWER	1	
222		MIDDLE "	1	
223		BOTTOM "	1	
224		TOP SHELF	1	
225		MIDDLE "	1	
226		BOTTOM "	1	
227		TOP SHELF	1	
228		BOTTOM "	1	
229		DESK	1	
230		CAB. DOORS & HNDLS	1	
231		TOP SHELF	1	
232		2ND "	1	
233		3RD "	1	
234		BOTTOM "	1	
235		CAB. DOORS & HNDLS	1	
236		TOP SHELF	1	
237		2ND "	1	
238		3RD "	1	
239		BOTTOM "	1	
240		CAB. DOORS & HNDLS	1	
241		TOP SHELF	1	
242	✓	2ND SHELF	1	✓

Radiological Survey Continuation Sheet

Page 10 of 27

Date 11-10-00

No.	Time	Location	Inst. Used	Total Activity (dpm/100 cm ²)
243	0812	3RD SHELF	1	See attached LSC Printout
244		BOTTOM "	1	
245		LEDGE	1	
246		TOP SHELF	1	
247		BOTTOM LEFT SHELF	1	
248		" RIGHT "	1	
249		DRAWERS & HANDLS	1	
250		TOP DRAWER	1	
251		MIDDLE DRAWER	1	
252		BOTTOM "	1	
253		DRAWER & HND	1	
254		DRAWER	1	
255		SHELF	1	
256		TOP SHELF	1	
257		MIDDLE "	1	
258		BOTTOM "	1	
259		DESK	1	
260		DRAWERS & HANDLS	1	
261		TOP DRAWER	1	
262		2ND "	1	
263		3RD "	1	
264		BOTTOM "	1	
265		DRAWERS & HANDLS	1	
266		TOP DRAWER	1	
267		2ND "	1	
268		3RD "	1	
269		BOTTOM "	1	
270		DRAWER & HNDL	1	

Radiological Survey Continuation Sheet

Page ^{11 ES} ~~78~~ of 27

Date 11-10-00

No.	Time	Location	Inst. Used	Total Activity (dpm/100 cm ²)
271	0812	DRAWER	1	See attached LSC Printout
272		DRAWERS & HANDLS	1	
273		TOP DRAWER	1	
274		2ND "	1	
275		3RD "	1	
276		BOTTOM "	1	
277		DRAWERS & HANDLS	1	
278		TOP DRAWER	1	
279		2ND "	1	
280		3RD "	1	
281		BOTTOM "	1	
282		CHAIR	1	
283		CHAIR	1	
284		CHAIR	1	
285		FLOOR	1	
286		FLOOR	1	
287		FLOOR	1	
288		TOP SHELF	1	
289		MIDDLE "	1	
290		BOTTOM "	1	
291		TOP SHELF	1	
292		MIDDLE "	1	
293		BOTTOM "	1	
294		CUP	1	
295		CUP	1	
296		COUNTER	1	
297		COUNTER	1	
298	✓	COUNTER	1	✓

Radiological Survey Continuation Sheet

Page 13 of 27
ES

Date 11-10-00

No.	Time	Location	Inst. Used	Total Activity (dpm/100 cm ²)
299	0812	COUNTER	1	See attached LSC Printout
300		COUNTER	1	
301		SIDE OF COUNTERS	1	
302		OUTSIDE HOOD	1	
303		INSIDE HOOD BOTTOM	1	
304		BACK OF HOOD INSIDE	1	
305		INSIDE LEFT SIDE OF HOOD	1	
306		" " RIGHT " " "	1	
307		COUNTER	1	
308		DRAWER & HNDL	1	
309		DRAWER	1	
310		CAB. DOORS & HNDLS	1	
311		TOP SHELF	1	
312		BOTTOM "	1	
313		DRAWER & HNDL	1	
314		DRAWER	1	
315		DRAWERS & HNDLS	1	
316		TOP DRAWER	1	
317		2ND "	1	
318		3RD "	1	
319		BOTTOM "	1	
320		DRAWERS & HNDLS	1	
321		TOP DRAWER	1	
322		2ND "	1	
323		3RD "	1	
324		BOTTOM "	1	
325		TOP SHELF	1	
326	✓	MIDDLE "	1	✓

Radiological Survey Continuation Sheet

Page 13 of 27

Date 11-10-00

No.	Time	Location	Inst. Used	Total Activity (dpm/100 cm ²)
327	0812	BOTTOM SHELF	1	See attached LSC Printout
328	↑	SHELF	1	
329		DESK	1	
330		TOP SHELF	1	
331		MIDDLE "	1	
332		BOTTOM "	1	
333		TOP SHELF	1	
334		MIDDLE "	1	
335		BOTTOM "	1	
336		DRAWER & HNDL	1	
337		DRAWER	1	
338		DRAWERS & HNDLS	1	
339		TOP DRAWER	1	
340		MIDDLE "	1	
341		BOTTOM "	1	
342		LEDGE	1	
343		TOP SHELF	1	
344		BOTTOM "	1	
345		SHELF	1	
346		UPPER WALL	1	
347		LOWER "	1	
348		CHAIR	1	
349		TOP OF CAB	1	
350		CAB DOORS & HNDLS	1	
351		TOP DRAWER	1	
352		2ND "	1	
353		3RD "	1	
354	✓	4TH "	1	✓

Radiological Survey Continuation Sheet

Page 14 of 27

Date 11-10-02

No.	Time	Location	Inst. Used	Total Activity (dpm/100 cm ²)
355	0812	BOTTOM DRAWER	1	See attached LSC Printout
356		FLOOR	1	
357		FLOOR	1	
358		FLOOR	1	
359		FLOOR	1	
360		CAB. door & HANDLS	1	
361		BACK OF CAB	1	
362		BOTTOM " "	1	
363		LEFT side " "	1	
364		RIGHT " " "	1	
365		CAB. doors & HANDLS	1	
366		BACK OF CAB.	1	
367		BOTTOM " "	1	
368		LEFT side " "	1	
369		RIGHT side " "	1	
370		HOOD TOP RIGHT VENT	1	
371		" " LEFT "	1	
372		" " RIGHT SLANTED SECTION	1	
373		" " LEFT " "	1	
374		HOOD UPPER BACK	1	
375		" LOWER "	1	
376		" LOWER RIGHT VENT	1	
377		" " LEFT VENT	1	
378		RIGHT side OF HOOD	1	
379		LEFT " " "	1	
380		BOTTOM RIGHT side OF HOOD	1	
381		" LEFT " " "	1	
382	✓	HOOD CUP	1	✓

Bld. 118B Room B210

Date: 11-10-00

○ = w.p. Location

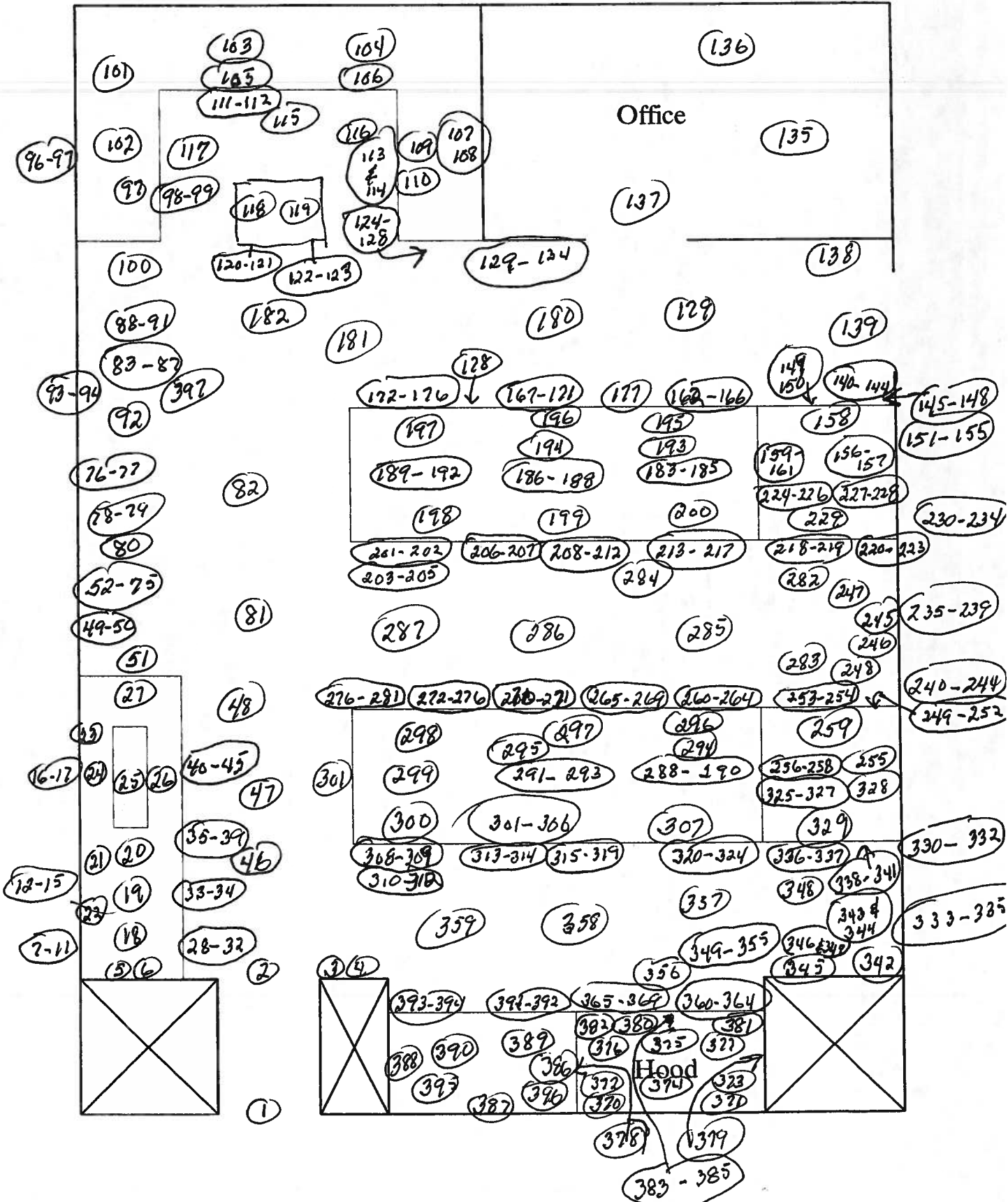

Bld. 118B Room B210

Page 17 of 27

Date: 11/15/00

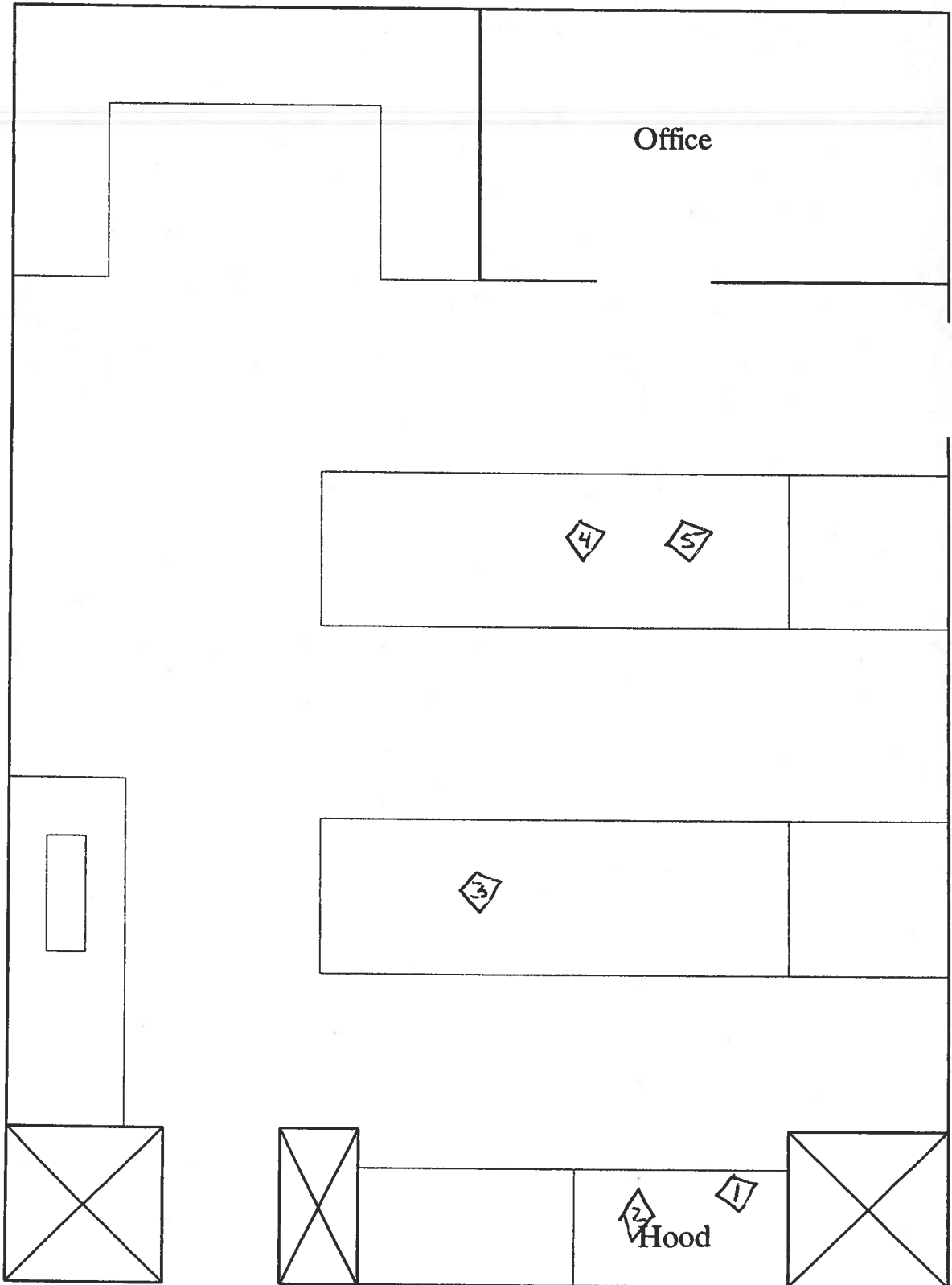

◊ AREAS OF ELEVATED ACTIVITY.

Surveyed approximately 100% of lower surfaces using instrument #2. All surfaces surveyed were noted to be at normal background levels, with the following five (5) exceptions:

1. The left hood counter was noted to be contaminated to a level of 2,897 cpm (32,463 dpm/100 cm²). This area was cut out and disposed of as radioactive waste.
2. The right hood counter was noted to be contaminated to a level of 27,392 cpm (338,650 dpm/100 cm²). This area was cut out and disposed of as radioactive waste.
3. The counter was noted to be contaminated to a level of 676 cpm (4,700 dpm/100 cm²). This area was decontaminated to a fixed level of 4,363 dpm/100 cm².
4. The counter was noted to be contaminated to a level of 2,529 cpm (27,863 dpm/100 cm²). This area was decontaminated to normal background levels.
5. The counter was noted to be contaminated to a level of 1,956 cpm (20,700 dpm/100 cm²). This area was decontaminated to normal background levels.

ID: EQUIPMENT SURVY

10 NOV 2000 10:46

USER: 1 COMMENT:
 RESET TIME : 1.00
 DATA CALC : DL DPM H# : YES SAMPLE REPEATS: 1 PRINTER : EDIT
 COUNT BLANK : YES IC# : NO REPLICATES : 1 RS232 : EDIT
 TWO PHASE : NO AQC : YES CYCLE REPEATS : 1
 SCINTILLATOR: LIQUID LUMEX: YES LOW SAMPLE REJ: 0
 LOW LEVEL : NO HALF LIFE CORRECTION DATE: none

ISOTOPE 1: 3H %ERROR: 2.00 FACTOR: 1.000000 BKG. SUB: 0
 ISOTOPE 2: 14C %ERROR: 2.00 FACTOR: 1.000000 BKG. SUB: 0
 WIDE OPEN WINDOW %ERROR: 0.00 FACTOR: 1.000000 BKG. SUB: 0

BACKGROUND QUENCH CURVE: Off COLOR QUENCH CORRECTION: Off

Quench Limits Low: 2.756 High: 314.54

SAM NO	H#	3H CPM	14C CPM	WIDE CPM	3H DPM	14C DPM	LUMEX %
B1	86.6	29.00	12.00	48.00	52.72	15.87	9.88
1	77.4	26.00	9.00	41.00	-6.57	-4.07	6.56
2	88.9	16.00	7.00	29.00	-23.50	-6.59	11.21
3	80.1	14.00	8.00	31.00	-29.13	-5.26	4.92
4	81.2	24.00	13.00	46.00	-11.72	1.37	5.95
5	80.6	23.00	10.00	46.00	-12.32	-2.67	4.68
6	78.0	24.00	7.00	42.00	-9.36	-6.73	4.79
7	84.0	19.00	13.00	36.00	-21.22	1.45	7.13
8	80.3	14.00	7.00	31.00	-28.61	-6.60	5.49
9	81.5	22.00	16.00	42.00	-17.14	5.44	4.29
10	86.1	22.00	15.00	47.00	-15.86	4.14	4.24
11	82.2	24.00	11.00	40.00	-10.52	-1.32	8.66
12	81.2	16.00	8.00	31.00	-25.05	-5.28	5.12
13	85.2	21.00	12.00	37.00	-16.50	0.09	5.30
14	81.5	36.00	9.00	50.00	14.14	-4.16	6.72
15	81.7	24.00	14.00	46.00	-12.13	2.72	3.87
16	114.1	23.00	12.00	50.00	-5.82	0.28	14.17
17	82.9	21.00	10.00	46.00	-15.87	-2.63	3.99
18	86.0	19.00	5.00	32.00	-16.79	-9.34	6.13
19	88.3	15.00	10.00	35.00	-27.20	-2.52	6.98
20	82.4	24.00	8.00	44.00	-8.97	-5.37	4.15
21	86.1	17.00	15.00	41.00	-26.00	4.20	5.70
22	81.1	22.00	5.00	38.00	-11.68	-9.39	5.92
23	77.1	19.00	7.00	42.00	-19.25	-6.68	3.00
24	86.0	33.00	11.00	58.00	8.48	-1.40	4.71
25	81.5	25.00	13.00	48.00	-9.68	1.36	6.14
26	87.5	22.00	7.00	37.00	-11.44	-6.67	5.85
27	70.9	22.00	16.00	42.00	-18.76	5.33	2.08
28	81.5	20.00	9.00	36.00	-17.59	-3.97	4.39
29	90.5	19.00	9.00	36.00	-18.10	-3.91	9.76
30	77.4	22.00	6.00	38.00	-12.88	-8.06	4.32
31	81.7	19.00	10.00	40.00	-20.04	-2.61	4.09
32	82.0	24.00	10.00	39.00	-10.05	-2.67	5.36
33	88.2	25.00	16.00	52.00	-9.85	5.47	8.65
34	88.9	22.00	17.00	51.00	-16.41	6.87	6.80
35	82.0	28.00	5.00	45.00	0.41	-9.46	4.65
36	86.3	21.00	14.00	44.00	-17.34	2.80	3.67
37	80.6	23.00	8.00	36.00	-11.30	-5.36	3.50
38	88.7	20.00	9.00	37.00	-16.36	-3.93	14.03

SAM NO	H#	3H CPM	14C CPM	WIDE CPM	3H DPM	14C DPM	LUMEX %
39	92.2	23.00	11.00	40.00	-10.52	-1.24	26.32
40	83.8	32.00	10.00	51.00	6.34	-2.76	5.70
41	83.8	18.00	6.00	35.00	-19.68	-7.99	5.92
42	82.4	18.00	12.00	38.00	-22.94	0.10	3.78
43	83.6	18.00	9.00	42.00	-21.24	-3.94	3.00
44	82.4	16.00	10.00	34.00	-25.91	-2.57	8.61
45	87.8	21.00	11.00	48.00	-15.51	-1.25	7.77
46	92.5	15.00	14.00	34.00	-28.82	2.93	6.65
47	94.7	23.00	11.00	41.00	-9.99	-1.22	9.51
48	85.1	40.00	8.00	56.00	23.88	-5.55	2.89
49	82.3	18.00	10.00	37.00	-21.93	-2.60	6.50
50	82.2	19.00	9.00	40.00	-19.47	-3.96	4.62
51	98.4	22.00	12.00	38.00	-11.88	0.17	7.91
52	92.1	26.00	13.00	52.00	-5.34	1.43	18.67
53	87.1	20.00	13.00	43.00	-18.72	1.47	5.83
54	82.8	22.00	9.00	41.00	-13.37	-3.99	18.79
55	82.3	26.00	9.00	42.00	-5.51	-4.04	3.25
56	83.9	26.00	7.00	41.00	-4.14	-6.73	4.33
57	79.9	23.00	13.00	43.00	-13.94	1.37	5.35
58	80.0	18.00	9.00	35.00	-21.77	-3.96	10.11
59	81.3	31.00	9.00	53.00	4.16	-4.11	3.26
60	82.6	19.00	13.00	45.00	-21.43	1.44	8.22
61	81.3	22.00	11.00	43.00	-14.66	-1.30	3.13
62	78.6	33.00	10.00	53.00	6.87	-2.80	3.41
63	80.1	25.00	11.00	47.00	-8.96	-1.35	4.40
64	83.5	33.00	10.00	58.00	8.26	-2.77	2.16
65	82.0	30.00	7.00	48.00	3.38	-6.79	2.60
66	83.4	28.00	8.00	41.00	-0.76	-5.41	4.08
67	81.7	20.00	10.00	35.00	-18.06	-2.62	3.36
68	82.4	25.00	11.00	44.00	-8.48	-1.33	3.92
69	81.3	19.00	13.00	45.00	-21.61	1.43	2.61
70	82.5	26.00	11.00	47.00	-6.48	-1.34	2.92
71	83.0	20.00	7.00	40.00	-16.33	-6.66	2.85
72	87.3	16.00	10.00	38.00	-25.28	-2.54	3.00
73	83.3	26.00	13.00	48.00	-7.33	1.36	2.72
74	82.3	14.00	8.00	30.00	-28.90	-5.25	5.60
75	89.0	24.00	10.00	43.00	-8.60	-2.63	4.27
76	82.5	21.00	11.00	39.00	-16.43	-1.28	5.39
77	90.3	19.00	15.00	40.00	-21.32	4.21	3.70
78	94.8	25.00	10.00	44.00	-5.19	-2.61	5.65
79	88.0	28.00	17.00	58.00	-4.28	6.79	2.43
80	112.6	23.00	12.00	48.00	-6.24	0.27	13.63
81	89.4	30.00	12.00	50.00	2.80	0.01	10.22
82	89.9	20.00	10.00	40.00	-16.67	-2.57	4.00
83	85.0	29.00	12.00	55.00	-0.40	-0.01	3.77
84	81.6	23.00	11.00	45.00	-12.63	-1.31	6.88
85	83.0	24.00	7.00	41.00	-8.33	-6.71	3.62
86	82.8	23.00	11.00	43.00	-12.40	-1.30	3.16
87	85.5	18.00	8.00	35.00	-20.45	-5.28	6.50
88	89.0	18.00	12.00	38.00	-22.00	0.15	7.35
89	79.5	23.00	8.00	39.00	-11.52	-5.37	3.84
90	82.3	20.00	11.00	37.00	-18.47	-1.27	10.31
91	84.7	25.00	11.00	53.00	-8.01	-1.32	3.08
92	117.4	18.00	11.00	39.00	-16.30	-1.00	7.75
93	83.7	23.00	10.00	47.00	-11.72	-2.65	3.79
94	83.5	25.00	14.00	52.00	-9.79	2.73	2.49
95	85.2	27.00	15.00	51.00	-5.92	4.07	3.49
96	86.5	36.00	13.00	55.00	13.70	1.27	3.17

SAM NO	H#	3H CPM	14C CPM	WIDE CPM	3H DPM	14C DPM	LUMEX %
97	91.7	25.00	5.00	41.00	-3.24	-9.40	5.67
98	86.7	23.00	7.00	37.00	-9.57	-6.69	4.39
99	88.1	29.00	12.00	53.00	0.40	0.01	1.68
100	124.5	15.00	11.00	32.00	-22.24	-0.90	22.69
101	81.6	17.00	6.00	32.00	-22.01	-7.98	3.85
102	85.4	27.00	11.00	48.00	-3.82	-1.34	4.70
103	81.7	22.00	11.00	41.00	-14.58	-1.30	2.89
104	81.2	30.00	7.00	50.00	3.16	-6.79	5.19
105	84.3	19.00	9.00	45.00	-19.13	-3.95	5.17
106	82.7	23.00	6.00	37.00	-9.88	-8.05	4.29
107	80.7	19.00	8.00	34.00	-19.19	-5.31	2.99
108	82.7	21.00	7.00	42.00	-14.38	-6.68	3.27
109	83.0	26.00	4.00	36.00	-2.82	-10.78	4.08
110	88.7	27.00	12.00	46.00	-3.56	0.04	4.41
111	81.0	23.00	16.00	48.00	-15.25	5.42	1.89
112	85.7	18.00	10.00	36.00	-21.44	-2.58	4.96
113	83.2	20.00	14.00	42.00	-19.84	2.78	3.32
114	84.4	21.00	10.00	42.00	-15.61	-2.62	4.47
115	84.3	33.00	7.00	51.00	10.04	-6.82	4.66
116	84.2	17.00	11.00	36.00	-24.18	-1.22	7.19
117	83.0	20.00	9.00	38.00	-17.33	-3.97	3.74
118	87.4	24.00	20.00	57.00	-14.15	10.89	4.32
119	84.0	19.00	7.00	33.00	-18.16	-6.65	5.16
120	85.8	23.00	9.00	43.00	-10.79	-3.99	4.81
121	98.6	34.00	11.00	50.00	14.68	-1.34	7.87
122	81.0	24.00	7.00	38.00	-8.75	-6.72	5.18
123	103.5	18.00	8.00	35.00	-17.33	-5.19	16.16
124	87.7	13.00	12.00	35.00	-32.40	0.20	4.22
125	82.5	21.00	7.00	38.00	-14.43	-6.68	3.67
126	88.0	21.00	15.00	41.00	-17.57	4.17	3.34
127	88.5	33.00	12.00	56.00	8.72	-0.04	9.05
128	85.7	20.00	9.00	34.00	-16.89	-3.95	5.26
129	85.5	17.00	8.00	34.00	-22.47	-5.27	3.65
130	84.7	23.00	11.00	44.00	-12.03	-1.29	2.22
131	87.6	25.00	7.00	42.00	-5.29	-6.71	2.33
132	88.7	19.00	7.00	36.00	-17.35	-6.63	3.84
133	88.6	22.00	13.00	41.00	-14.37	1.45	4.99
134	85.6	19.00	8.00	39.00	-18.40	-5.29	3.03
135	81.5	26.00	15.00	46.00	-8.71	4.04	3.78
136	82.9	25.00	12.00	45.00	-8.89	0.02	3.22
137	93.5	27.00	9.00	48.00	-0.74	-4.00	5.66
138	87.6	38.00	14.00	57.00	17.62	2.60	3.15
139	89.3	28.00	7.00	43.00	1.28	-6.74	4.33
140	85.8	21.00	9.00	42.00	-14.85	-3.96	5.92
141	84.2	24.00	8.00	39.00	-8.59	-5.36	4.69
142	87.7	24.00	8.00	42.00	-7.85	-5.34	2.94
143	85.8	17.00	15.00	44.00	-26.03	4.19	4.42
144	84.8	25.00	9.00	52.00	-6.96	-4.02	2.70
145	82.8	12.00	10.00	28.00	-33.84	-2.52	5.03
146	84.0	17.00	12.00	37.00	-24.72	0.13	5.99
147	86.4	25.00	9.00	47.00	-6.61	-4.01	4.41
148	87.5	25.00	5.00	46.00	-4.28	-9.41	5.67
149	88.0	14.00	6.00	25.00	-27.20	-7.92	6.52
150	86.5	22.00	14.00	41.00	-15.28	2.79	3.63
151	81.9	17.00	15.00	41.00	-26.51	4.16	4.54
152	90.1	22.00	13.00	46.00	-14.09	1.47	4.00
153	84.0	17.00	10.00	37.00	-23.70	-2.57	6.45
154	85.8	20.00	12.00	37.00	-18.41	0.10	4.35

SAM NO	H#	3H CPM	14C CPM	WIDE CPM	3H DPM	14C DPM	LUMEX %
155	87.1	23.00	19.00	52.00	-15.73	9.54	4.63
156	85.9	25.00	7.00	39.00	-5.68	-6.71	4.52
157	88.5	33.00	14.00	60.00	7.67	2.67	4.53
158	84.2	27.00	6.00	43.00	-1.53	-8.09	3.29
159	88.8	26.00	15.00	42.00	-7.15	4.11	5.31
160	83.9	24.00	14.00	48.00	-11.72	2.74	3.33
161	84.9	15.00	7.00	26.00	-26.08	-6.60	7.96
162	85.8	22.00	7.00	44.00	-11.79	-6.68	4.05
163	83.3	14.00	9.00	39.00	-29.29	-3.89	4.25
164	84.4	28.00	5.00	46.00	1.02	-9.46	2.42
165	85.8	20.00	8.00	36.00	-16.35	-5.30	4.21
166	85.5	26.00	10.00	46.00	-5.30	-2.67	3.41
167	89.4	14.00	10.00	31.00	-29.13	-2.50	5.82
168	84.8	21.00	11.00	44.00	-16.04	-1.27	4.42
169	85.0	20.00	9.00	38.00	-17.01	-3.96	3.37
170	86.0	27.00	12.00	51.00	-4.19	0.02	2.27
171	86.5	18.00	11.00	36.00	-21.85	-1.22	6.44
172	86.9	14.00	9.00	30.00	-28.89	-3.87	6.05
173	83.6	36.00	10.00	53.00	14.30	-2.80	2.31
174	86.4	17.00	7.00	32.00	-21.82	-6.61	10.62
175	88.7	21.00	16.00	46.00	-17.97	5.53	3.33
176	87.1	29.00	10.00	47.00	1.17	-2.70	2.76
177	84.4	21.00	5.00	32.00	-13.05	-9.37	4.78
178	90.5	15.00	11.00	32.00	-27.45	-1.15	7.64
179	91.0	30.00	12.00	48.00	3.24	0.02	8.67
180	90.8	19.00	6.00	32.00	-16.45	-7.98	5.58
181	96.3	13.00	9.00	33.00	-29.89	-3.80	4.15
182	82.7	31.00	7.00	45.00	5.56	-6.80	2.76
183	125.9	14.00	9.00	30.00	-23.18	-3.64	15.71
184	88.9	18.00	18.00	43.00	-25.16	8.27	3.72
185	84.4	30.00	8.00	43.00	3.50	-5.43	6.48
186	153.6	24.00	9.00	46.00	13.75	-3.67	12.60
187	90.1	18.00	11.00	39.00	-21.30	-1.19	5.76
188	85.8	16.00	15.00	37.00	-28.06	4.21	5.57
189	99.0	23.00	1.00	35.00	-3.44	-14.81	9.11
190	93.2	26.00	11.00	48.00	-4.00	-1.27	6.11
191	85.7	31.00	8.00	48.00	5.90	-5.44	3.54
192	92.1	19.00	17.00	39.00	-22.10	6.94	50.60
193	90.5	24.00	6.00	38.00	-6.16	-8.04	6.15
194	116.5	26.00	13.00	50.00	1.41	1.63	5.42
195	84.7	22.00	17.00	46.00	-17.12	6.82	4.00
196	88.4	32.00	16.00	52.00	4.53	5.39	5.85
197	86.4	21.00	14.00	49.00	-17.31	2.80	2.48
198	82.8	19.00	8.00	35.00	-18.87	-5.30	3.40
199	86.0	19.00	12.00	39.00	-20.40	0.12	7.74
200	88.2	26.00	12.00	48.00	-5.73	0.05	3.23
201	84.1	17.00	15.00	38.00	-26.25	4.18	3.38
202	86.3	17.00	12.00	39.00	-24.41	0.14	3.69
203	85.0	27.00	10.00	48.00	-3.40	-2.69	3.71
204	83.9	20.00	8.00	34.00	-16.68	-5.31	2.79
205	82.5	26.00	11.00	49.00	-6.48	-1.34	3.45
206	85.3	28.00	12.00	48.00	-2.34	0.00	2.94
207	84.4	18.00	8.00	36.00	-20.61	-5.28	4.13
208	83.5	30.00	9.00	49.00	2.76	-4.08	2.41
209	83.2	17.00	6.00	27.00	-21.78	-7.98	4.63
210	82.0	31.00	10.00	59.00	3.86	-2.75	3.29
211	85.2	24.00	10.00	41.00	-9.41	-2.65	3.20
212	84.7	28.00	5.00	40.00	1.10	-9.46	3.74

SAM NO	H#	3H CPM	14C CPM	WIDE CPM	3H DPM	14C DPM	LUMEX %
213	83.5	19.00	8.00	30.00	-18.75	-5.30	4.87
214	81.7	21.00	8.00	36.00	-15.06	-5.33	2.33
215	80.8	13.00	13.00	36.00	-33.54	1.50	4.59
216	77.1	21.00	10.00	41.00	-16.83	-2.66	1.84
217	86.5	23.00	13.00	44.00	-12.72	1.42	3.47
218	81.7	32.00	9.00	45.00	6.28	-4.12	2.16
219	81.5	23.00	7.00	46.00	-10.62	-6.71	2.74
220	86.5	24.00	7.00	43.00	-7.59	-6.70	4.21
221	85.6	17.00	16.00	40.00	-26.58	5.54	3.58
222	85.0	28.00	5.00	44.00	1.20	-9.45	4.65
223	87.6	18.00	6.00	38.00	-19.07	-7.97	8.51
224	87.9	24.00	15.00	47.00	-11.45	4.13	4.85
225	86.4	11.00	11.00	32.00	-36.08	-1.13	40.45
226	85.1	22.00	11.00	38.00	-13.98	-1.28	3.30
227	86.1	23.00	20.00	57.00	-16.41	10.88	3.34
228	84.7	21.00	14.00	54.00	-17.60	2.78	2.60
229	81.2	19.00	10.00	41.00	-20.12	-2.62	3.18
230	86.5	26.00	7.00	45.00	-3.51	-6.72	2.42
231	85.3	24.00	8.00	41.00	-8.36	-5.35	5.23
232	86.2	30.00	7.00	45.00	4.52	-6.77	9.01
233	90.1	19.00	7.00	33.00	-17.12	-6.62	6.21
234	85.3	33.00	10.00	52.00	8.80	-2.76	4.32
235	86.7	18.00	12.00	38.00	-22.33	0.13	3.78
236	90.7	19.00	14.00	40.00	-20.73	2.86	3.22
237	90.3	23.00	11.00	45.00	-10.92	-1.25	2.75
238	86.8	19.00	11.00	38.00	-19.76	-1.23	4.67
239	95.2	21.00	11.00	38.00	-14.13	-1.20	5.40
240	85.8	17.00	11.00	36.00	-23.96	-1.21	2.78
241	86.8	19.00	14.00	44.00	-21.32	2.83	2.60
242	85.4	27.00	8.00	42.00	-2.26	-5.39	2.78
243	86.7	22.00	10.00	41.00	-13.15	-2.62	4.33
244	88.9	12.00	6.00	27.00	-31.20	-7.90	7.69
245	87.8	16.00	10.00	38.00	-25.22	-2.54	3.30
246	88.6	13.00	12.00	38.00	-32.32	0.21	2.86
247	86.4	25.00	18.00	53.00	-11.26	8.16	2.91
248	87.5	18.00	14.00	42.00	-23.26	2.85	2.82
249	88.8	27.00	10.00	51.00	-2.48	-2.67	1.63
250	85.3	22.00	18.00	44.00	-17.53	8.18	2.23
251	84.2	18.00	9.00	36.00	-21.15	-3.93	2.40
252	90.6	19.00	7.00	39.00	-17.03	-6.62	3.82
253	88.8	13.00	5.00	29.00	-28.62	-9.26	3.70
254	87.3	22.00	9.00	34.00	-12.53	-3.97	2.97
255	88.7	16.00	10.00	31.00	-25.10	-2.53	2.37
256	92.7	26.00	10.00	43.00	-3.59	-2.63	4.49
257	89.1	23.00	7.00	40.00	-9.05	-6.68	3.59
258	85.0	31.00	5.00	49.00	7.23	-9.49	4.11
259	87.0	27.00	11.00	44.00	-3.43	-1.32	2.74
260	100.8	22.00	7.00	39.00	-8.54	-6.62	5.24
261	85.8	16.00	9.00	32.00	-24.96	-3.90	2.97
262	89.1	15.00	12.00	41.00	-28.15	0.19	3.26
263	89.2	29.00	10.00	49.00	1.73	-2.69	3.35
264	92.5	25.00	13.00	44.00	-7.35	1.45	3.94
265	85.7	20.00	8.00	41.00	-16.37	-5.30	2.42
266	89.7	20.00	10.00	39.00	-16.71	-2.58	3.73
267	89.3	23.00	7.00	35.00	-9.02	-6.68	4.37
268	88.6	21.00	9.00	39.00	-14.32	-3.95	2.34
269	90.9	19.00	11.00	39.00	-19.10	-1.20	4.51
270	89.8	24.00	12.00	45.00	-9.47	0.09	2.46

SAM NO	H#	3H CPM	14C CPM	WIDE CPM	3H DPM	14C DPM	LUMEX %
1	86.3	26.00	8.00	47.00	-4.08	-5.37	7.08
272	88.7	20.00	7.00	34.00	-15.31	-6.64	3.54
273	88.1	16.00	11.00	32.00	-25.70	-1.18	3.38
274	89.7	19.00	19.00	45.00	-23.52	9.63	1.76
275	87.7	30.00	13.00	54.00	1.81	1.35	2.53
276	94.0	21.00	10.00	37.00	-13.82	-2.56	3.82
277	90.1	22.00	6.00	35.00	-10.39	-8.02	5.49
278	90.3	28.00	11.00	48.00	-0.56	-1.32	2.22
279	85.9	19.00	13.00	46.00	-20.93	1.47	4.35
280	86.2	16.00	5.00	29.00	-22.85	-9.31	4.72
281	84.3	30.00	9.00	48.00	2.97	-4.08	1.97
282	82.6	23.00	7.00	35.00	-10.42	-6.70	3.13
283	88.6	23.00	7.00	38.00	-9.18	-6.68	3.12
284	88.9	25.00	8.00	47.00	-5.52	-5.35	2.13
285	89.8	30.00	7.00	46.00	5.54	-6.76	2.94
286	86.9	15.00	8.00	34.00	-26.33	-5.24	3.83
287	89.9	23.00	12.00	44.00	-11.52	0.10	1.90
288	109.4	20.00	16.00	42.00	-16.33	5.76	8.40
289	88.6	29.00	6.00	44.00	3.67	-8.11	2.23
290	86.8	21.00	14.00	45.00	-17.25	2.80	3.64
291	139.1	28.00	13.00	49.00	15.33	1.78	6.44
292	90.5	22.00	19.00	49.00	-17.19	9.60	2.62
293	91.4	24.00	10.00	40.00	-8.07	-2.61	2.76
294	99.7	28.00	12.00	42.00	1.45	0.11	3.23
295	95.4	25.00	15.00	51.00	-7.76	4.19	5.64
296	89.5	17.00	6.00	37.00	-20.81	-7.96	3.25
297	94.7	21.00	13.00	44.00	-15.30	1.52	4.79
298	89.1	21.00	13.00	40.00	-16.32	1.47	2.78
299	90.1	32.00	21.00	59.00	2.38	12.18	1.92
300	89.7	22.00	19.00	48.00	-17.33	9.59	2.66
301	82.8	28.00	8.00	47.00	-0.91	-5.41	1.95
302	88.4	30.00	8.00	43.00	4.62	-5.41	9.24
303	90.3	18.00	6.00	33.00	-18.62	-7.97	3.50
304	87.7	17.00	13.00	42.00	-24.75	1.51	2.49
305	88.6	17.00	15.00	46.00	-25.68	4.22	3.01
306	89.1	16.00	8.00	35.00	-23.99	-5.24	3.73
307	99.4	25.00	10.00	46.00	-4.01	-2.58	2.78
308	87.1	17.00	5.00	33.00	-20.68	-9.32	4.12
309	88.3	15.00	8.00	30.00	-26.15	-5.23	3.22
310	90.5	29.00	6.00	44.00	4.22	-8.10	2.36
311	88.9	18.00	8.00	31.00	-19.91	-5.26	3.62
312	98.9	23.00	9.00	40.00	-7.93	-3.92	5.78
313	91.4	15.00	10.00	35.00	-26.81	-2.50	2.82
314	88.0	10.00	9.00	28.00	-36.95	-3.82	4.15
315	88.6	19.00	15.00	45.00	-21.58	4.20	3.30
316	88.2	35.00	12.00	58.00	12.72	-0.06	1.78
317	85.0	21.00	13.00	43.00	-17.03	1.44	2.51
318	87.1	21.00	11.00	41.00	-15.64	-1.25	2.21
319	89.7	30.00	5.00	52.00	6.58	-9.47	1.90
320	91.8	19.00	17.00	51.00	-22.16	6.94	2.04
321	86.3	19.00	11.00	39.00	-19.85	-1.23	2.15
322	86.3	20.00	11.00	41.00	-17.81	-1.24	1.89
323	91.3	21.00	13.00	45.00	-15.93	1.49	1.65
324	94.3	26.00	6.00	43.00	-1.01	-8.05	2.43
325	85.3	20.00	7.00	36.00	-15.92	-6.66	3.29
326	87.5	16.00	12.00	36.00	-26.30	0.17	2.50
327	87.1	33.00	11.00	54.00	8.80	-1.40	2.01
328	88.4	26.00	8.00	44.00	-3.59	-5.36	2.10

SAM NO	H#	3H CPM	14C CPM	WIDE CPM	3H DPM	14C DPM	LUMEX %
329	82.4	27.00	11.00	44.00	-4.51	-1.35	3.92
330	98.8	20.00	9.00	41.00	-14.44	-3.88	7.35
331	88.6	21.00	10.00	38.00	-14.85	-2.59	4.05
332	84.7	33.00	5.00	43.00	11.17	-9.52	2.98
333	85.3	26.00	7.00	42.00	-3.79	-6.73	4.28
334	88.9	20.00	11.00	39.00	-17.36	-1.23	4.27
335	87.1	16.00	7.00	30.00	-23.75	-6.60	5.58
336	84.0	17.00	7.00	33.00	-22.16	-6.62	2.88
337	85.1	19.00	12.00	36.00	-20.54	0.11	2.68
338	85.3	24.00	4.00	44.00	-6.30	-10.76	2.73
339	84.1	23.00	6.00	37.00	-9.61	-8.05	3.54
340	85.1	28.00	13.00	49.00	-2.89	1.35	2.97
341	89.2	26.00	10.00	42.00	-4.43	-2.65	26.19
342	85.8	18.00	11.00	38.00	-21.95	-1.22	5.89
343	82.4	29.00	7.00	44.00	1.50	-6.77	7.71
344	85.8	21.00	9.00	38.00	-14.84	-3.96	2.59
345	98.7	20.00	12.00	39.00	-16.13	0.20	5.91
346	85.6	13.00	8.00	30.00	-30.55	-5.22	2.66
347	85.9	28.00	8.00	42.00	-0.12	-5.40	3.00
348	86.8	16.00	12.00	39.00	-26.39	0.16	2.83
349	85.1	15.00	10.00	38.00	-27.58	-2.54	3.25
350	85.1	14.00	9.00	29.00	-29.09	-3.88	3.41
351	87.7	16.00	4.00	30.00	-22.10	-10.66	5.74
352	90.1	29.00	5.00	46.00	4.62	-9.46	3.04
353	87.0	22.00	10.00	38.00	-13.10	-2.62	5.55
354	90.1	15.00	11.00	36.00	-27.51	-1.16	12.93
355	86.3	25.00	14.00	48.00	-9.21	2.75	1.79
356	106.5	16.00	13.00	35.00	-24.19	1.68	4.71
357	99.8	31.00	6.00	46.00	11.39	-8.10	2.43
358	95.7	20.00	4.00	32.00	-12.32	-10.69	4.00
359	94.4	26.00	4.00	39.00	0.09	-10.77	5.11
360	85.8	28.00	5.00	38.00	1.40	-9.45	2.64
361	87.7	23.00	6.00	39.00	-8.84	-8.04	3.14
362	97.5	14.00	14.00	38.00	-30.37	2.99	3.23
363	86.2	29.00	8.00	51.00	1.97	-5.41	2.25
364	83.9	20.00	8.00	37.00	-16.67	-5.31	2.45
365	85.6	23.00	11.00	47.00	-11.85	-1.29	1.73
366	85.5	19.00	5.00	33.00	-16.88	-9.34	5.07
367	94.3	18.00	12.00	38.00	-21.18	0.19	3.93
368	84.5	22.00	11.00	39.00	-14.09	-1.28	2.54
369	87.9	27.00	11.00	47.00	-3.21	-1.32	3.69
370	110.7	43.00	15.00	64.00	37.76	4.08	2.89
371	123.8	39.00	16.00	66.00	34.44	5.63	6.90
372	78.8	34.00	12.00	52.00	7.90	-0.11	1.38
373	75.2	24.00	20.00	54.00	-16.21	10.73	1.24
374	84.9	19.00	12.00	39.00	-20.58	0.11	6.15
375	91.4	22.00	12.00	45.00	-13.30	0.12	2.80
376	94.5	16.00	15.00	42.00	-27.00	4.29	3.81
377	93.3	15.00	5.00	26.00	-23.88	-9.27	8.94
378	86.4	30.00	11.00	43.00	2.52	-1.36	5.98
379	88.0	29.00	7.00	42.00	2.98	-6.75	3.51
380	88.1	17.00	9.00	38.00	-22.60	-3.90	2.46
381	89.2	23.00	6.00	42.00	-8.51	-8.03	1.80
382	87.1	14.00	7.00	27.00	-27.83	-6.58	3.40
383	87.2	22.00	11.00	50.00	-13.58	-1.26	1.45
384	84.7	16.00	12.00	37.00	-26.65	0.14	2.76
385	88.4	19.00	18.00	46.00	-23.17	8.26	2.20
386	85.6	25.00	4.00	33.00	-4.21	-10.77	3.64

SAM NO	H#	3H CPM	14C CPM	WIDE CPM	3H DPM	14C DPM	LUMEX %
7	85.4	17.00	7.00	36.00	-21.97	-6.62	5.78
388	97.5	18.00	17.00	39.00	-23.42	7.02	3.06
389	96.5	15.00	10.00	34.00	-26.14	-2.47	3.73
390	85.0	22.00	10.00	43.00	-13.48	-2.63	3.26
391	87.3	23.00	17.00	50.00	-14.65	6.84	3.35
392	85.0	25.00	6.00	39.00	-5.37	-8.07	3.05
393	91.8	20.00	12.00	45.00	-17.39	0.15	1.85
394	112.5	27.00	9.00	48.00	4.92	-3.91	4.72
395	103.3	19.00	9.00	39.00	-15.73	-3.84	7.00
396	111.6	27.00	10.00	50.00	4.01	-2.54	4.20
397	93.6	31.00	11.00	50.00	6.64	-1.33	1.81

ID: EQUIPMENT SURVY

15 NOV 2000 19:56

USER: 3 COMMENT: EQUIPMENT SURVEY

PRESET TIME : 1.00
 DATA CALC : DL DPM H# : YES SAMPLE REPEATS: 1 PRINTER : EDIT
 COUNT BLANK : YES IC# : NO REPLICATES : 1 RS232 : EDIT
 TWO PHASE : NO AGC : YES CYCLE REPEATS : 1
 SCINTILLATOR: LIQUID LUMEX: YES LOW SAMPLE REJ: 0
 LOW LEVEL : NO HALF LIFE CORRECTION DATE: none

ISOTOPE 1: 3H %ERROR: 2.00 FACTOR: 1.0000 BKG. SUB: 0
 ISOTOPE 2: 14C %ERROR: 2.00 FACTOR: 1.0000 BKG. SUB: 0
 WIDE OPEN WINDOW %ERROR: 0.00 FACTOR: 1.0000 BKG. SUB: 0

BACKGROUND QUENCH CURVE: Off COLOR QUENCH CORRECTION: Off

Quench Limits Low: 13.688 High: 306.34

SAM NO	H#	3H CPM	14C CPM	WIDE CPM	3H DPM	14C DPM	LUMEX %	
B1	77.6	20.00	11.00	39.00	36.86	14.39	0.59	
		Blank Average	DPM	for	3H :	36.86	COEF. OF VAR:	0.000
		Blank Average	DPM	for	14C :	14.39	COEF. OF VAR:	0.000

398 1	80.7	20.00	7.00	37.00	2.64	-5.34	0.73	
399 2	77.8	21.00	10.00	47.00	2.67	-1.35	0.68	
400 3	81.3	16.00	13.00	34.00	-9.04	2.77	0.85	
401 4	82.4	22.00	9.00	42.00	6.28	-2.69	0.61	
402 5	79.2	19.00	7.00	31.00	0.22	-5.33	0.88	
MISSING SAMPLE								
7	82.3	27.00	20.00	58.00	11.33	11.99	0.48	
8	81.3	238.00	95.00	333.00	406.85	109.17	0.20	
9	81.1	29.00	17.00	56.00	16.93	7.92	0.57	
10	84.1	17.00	11.00	35.00	-5.41	0.09	1.56	
11	80.2	23.00	13.00	45.00	5.87	2.65	1.31	
12	82.4	48.00	35.00	97.00	49.13	31.76	0.72	
13	81.9	40.00	12.00	62.00	43.66	1.03	1.32	
14	79.2	20.00	12.00	42.00	-0.23	1.35	1.65	
15	90.7	28.00	15.00	51.00	18.44	5.33	1.33	
16	80.5	16.00	11.00	40.00	-8.11	0.08	1.10	
17	80.0	13.00	10.00	29.00	-14.10	-1.21	1.01	
18	79.3	17.00	6.00	38.00	-3.55	-6.64	1.00	
19	78.7	21.00	7.00	43.00	4.39	-5.37	1.15	
20	76.0	24.00	7.00	38.00	10.19	-5.42	1.00	
21	81.5	12.00	13.00	33.00	-17.69	2.84	1.21	