

Radiological Survey Sheet

Job Location PFIZER INC. GROTON CT. Page 1 of 46

Survey Purpose DECOMMISSIONING B209 Date 5/4/00

Performed By DAVID O'NEKEE (Print)  (Sign)

Inst.(1) (Model/SN) Packard 2500 TR #405100	Inst.(2) <u>Ludlum model 2241-2</u> (Model/SN) <u># 137751</u>	Inst.(3) (Model/SN)
Det. Internal (Model/SN)	Det. <u>Ludlum 43-68</u> (Model/SN) <u># 148899</u>	Det. (Model/SN)
Eff. H-3 (27% - 47%) C-14/P-32 (78% - 83%)	Eff. <u>= 8% C-14</u>	Eff.
Type rad. β	Type rad. <u>B</u>	Type rad.
Bkgd. See #1 below	Bkgd. <u>300 cpm</u>	Bkgd.
Cal. Due: <u>12/2000</u>	Cal. Due <u>4/28/01</u>	Cal. due

No.	Time	Location	Inst. Used	Total Activity (dpm/100 cm ²)	Comments
1.	0930	BACKGROUND	1	28 cpm	
2.		Door	1	35	
3.		Wall	1	0	
4.		Upper Wall	1	68	
5.		Lower Wall	1	68	
6.		Base coat rack	1	4	
7.		Coat rack	1	0	
8.		Upper wall	1	2	
9.		Lower wall	1	0	
10.		Upper side Hood	1	13	
11.		Lower side Hood	1	5	
12.		Ref/Freezer	1	6	
13.		Floor	1	0	
14.		Floor	1	0	
15.		Floor	1	45	
16.		Floor	1	0	
17.		Floor	1	6	
18.	↓	Floor	1	12	

Radiological Survey Continuation Sheet

Page 2 of 46

Date 5/4/00

No.	Time	Location	Inst. Used	Total Activity (dpm/100 cm ²)	Comments
19		FRONT OF cabinet	1	✓ 1486	See wipe # 715 ✓
20		inside cabinet	1	0	
21		tray	1	0	
22		front of cabinet	1	12	
23		inside cabinet	1	0	
24		wall	1	0	
25		Hood ledge	1	0	
26		Hood sash	1	0	
27		outside left	1	✓ 98	See wipe # 716 ✓
28		outside right	1	✓ 235	See wipe # 717 ✓
29		outside top	1	9	
30		inside left side	1	✓ 70	See wipe # 718 ✓
31		BACK upper	1	60	
32		Back lower	1	✓ 75	See wipe # 719 ✓
33		inside right side	1	0	
34		counter left	1	12	
35		counter right	1	✓ 103	See wipe # 720 ✓
36		Cup sink	1	13	
37		inside top	1	0	
38		DECT	1	0	
39		Behind front Hood	1	12	
40		upper wall	1	9	
41		lower wall	1	0	
42		chair	1	5	
43		lower wall	1	45	
44		upper wall	1	15	
45		top shelf	1	0	
46	✓	Bot. Shelf	1	2	

Radiological Survey Continuation Sheet

Page 3 of 46

Date 5/4/00

No.	Time	Location	Inst. Used	Total Activity (dpm/100 cm ²)	Comments
47		Shelf	1	0	
48		Desk top	1	38	
49		Front of cabinet (wall)	1	0	
50		Top Shelf	1	43	
51		Shelf	1	0	
52		Shelf	1	38	
53		Bottom shelf	1	40	
54		Front of wall unit	1	12	
55		Top shelf	1	0	
56		Shelf	1	0	
57		Bottom shelf	1	0	
58		Front of Drawers	1	0	
59		TOP DRAWER	1	0	
60		DRAWER	1	0	
61		BOTTOM DRAWER	1	0	
62		DRAWER	1	0	
63		COUNTER	1	0	
64		Cup sink	1	195	See wipe # 721
65		counter	1	13	
66		Cup sink	1	79	See wipe # 722
67		counter	1	0	
68		Top shelf	1	38	
69		Shelf	1	0	
70		Bottom shelf	1	0	
71		Top shelf	1	0	
72		Shelf	1	111	See wipe # 723
73		Bottom shelf	1	105	See wipe # 724
74	↓	FRONT OF DRAWERS	1	0	

Radiological Survey Continuation Sheet

Page 4 of 46

Date 5/4/00

No.	Time	Location	Inst. Used	Total Activity (dpm/100 cm ²)	Comments
75		TOP DRAWER	1	top 50	
76		DRAWER	1	38	
77		DRAWER	1	top 6	
78		Bottom DRAWER	1	top 78	See wipe # 725
79		FRONT OF DRAWERS	1	9	
80		TOP DRAWER	1	2	
81		DRAWER	1	16	
82		DRAWER	1	4	
83		Bottom DRAWER	1	top 40	
84		DRAWER	1	top 35	
85		Chair	1	55	
86		Front of Drawers	1	4	
87		TOP DRAWER	1	0	
88		Drawer	1	0	
89		Drawer	1	0	
90		Bottom Drawer	1	45	
91		Front of Drawers	1	13	
92		TOP DRAWER	1	48	
93		Drawer	1	0	
94		Drawer	1	110	See wipe # 726
95		Bottom Drawer	1	0	
96		90 Floor side of CABINET	1	78	See wipe # 727
97		Floor	1	0	
98		Sharps	1	15	
99		Bot of Bags	1	11	
100		Counter	1	12	
101		counter	1	16	
102	↓	counter	1	1	

Radiological Survey Continuation Sheet

Page 5 of 46

Date 5/4/00

No.	Time	Location	Inst. Used	Total Activity (dpm/100 cm ²)	Comments
103		counter	1	0	
104		cup sink	1	0	
105		counter	1	2	
106		cup sink	1	132	See wipe # 728
107		counter	1	0	
108		SIDE OF CABINETS	1	9	
109		Floor	1	0	
110		Floor	1	0	
111		Floor	1	0	
112		Floor	1	0	
113		Floor	1	1	
114		Floor	1	0	
115		Floor	1	11	
116		counter	1	7	
117		Faucet	1	1	
118		Sink	1	6	
119		under	1	12	
120		counter	1	0	
121		UPPER WALL	1	6	
122		lower wall	1	0	
123		side of cabinet	1	0	
124		glassware drying wall unit	1	0	
125		top shelf	1	0	
126		shelf	1	0	
127		bottom shelf	1	76	See wipe # 729
128		front of wall unit	1	1	
129		top shelf	1	5	
130	↓	shelf	1	0	

Radiological Survey Continuation Sheet

Page 6 of 46

Date 5/4/00

No.	Time	Location	Inst. Used	Total Activity (dpm/100 cm ²)	Comments
131		Bottom Shelf	1	7	
132		Magnet	1	16	
133		front of wall unit	1	0	
134		top shelf	1	78	See wipe #730
135		shelf	1	1	
136		shelf	1	0	
137		shelf	1	0	
138		bottom shelf	1	0	
139		Back wall	1	7	
140		wall	1	0	
141		front of drawers	1	4	
142		top drawer	1	13	
143		Drawer	1	46	
144		Drawer	1	0	
145		Bottom Drawer	1	48	
146		DRAWER	1	13	
147		FRONT OF DRAWERS	1	10	
148		TOP DRAWER	1	65	
149		DRAWER	1	0	
150		DRAWER	1	12	
151		Bottom DRAWER	1	59	
152		FRONT OF CABINETS	1	43	
153		INSIDE CABINET	1	0	
154		Box Hanging Frames	1	11	
155		" " "	1	40	
156		Shelf	1	0	
157		wall	1	12	
158	↓	Right side cold box	1	0	

Radiological Survey Continuation Sheet

Page 7 of 46

Date 5/4/00

No.	Time	Location	Inst. Used	Total Activity (dpm/100 cm ²)	Comments
159		Front Right Door	1	0	
160		Front LEFT Door	1	0	
161		LEFT SIDE	1	7	
162		TOP Cabinet	1	0	
163		INSIDE left Door	1	0	
164		LEFT SIDE INSIDE	1	934	
165		BACK LEFT SIDE	1	0	
166		TOP " "	1	0	
167		Bottom " "	1	0	
168		TOP Shelf	1	0	
169		Shelf	1	45	
170		Shelf	1	35	
171		Bottom Shelf	1	0	
172		Shelf on Bottom	1	4	
173		" " "	1	0	
174		INSIDE Right Door	1	10	
175		Bottom Right	1	0	
176		TOP Right INSIDE	1	4	
177		Right SIDE	1	0	
178		Right Back	1	0	
179		TOP Shelf	1	4	
180		Shelf	1	0	
181		Bottom shelf	1	0	
182		UPPER WALL	1	4	
183		LOWER WALL	1	6	
184		FRONT OF CABINET	1	57	
185		Top Drawer	1	7	
186	↓	CABINET INSIDE	1	7	

Radiological Survey Continuation Sheet

Page 6 of 46

Date 5/4/80

No.	Time	Location	Inst. Used	Total Activity (dpm/100 cm ²)	Comments
187		INSIDE CABINET (TOP SHLF)	1	95	See wipps # 731
188		DRAWER	1	51	
189		FRONT OF DRAWERS	1	12	
190		TOP DRAWER	1	11	
191		Drawer	1	9	
192		Drawer	1	0	
193		Bottom Drawer	1	145	See wipps # 732
194		FRONT OF DRAWERS	1	7	
195		Top Drawer	1	470	See wipps # 733
196		Drawer	1	1611	See wipps # 734
197		Drawer	1	43	
198		Bottom Drawer	1	0	
199		Drawer	1	50	
200		Filing cabinet	1	7	
201		FRONT OF DRAWERS	1	2	
202		TOP DRAWER	1	0	
203		Drawer	1	0	
204		Drawer	1	0	
205		Bottom Drawer	1	49	
206		Drawer	1	11	
207		FRONT OF DRAWERS	1	13	
208		TOP DRAWER	1	0	
209		Drawer	1	15	
210		Drawer	1	0	
211		BOTTOM DRAWER	1	60	
212		FRONT OF DRAWERS	1	33	
213		Top Shelf TOP DRAWER	1	0	
214	✓	Shelf Drawer	1	38	

Radiological Survey Continuation Sheet

Page 9 of 46

Date 5/1/00

No.	Time	Location	Inst. Used	Total Activity (dpm/100 cm ²)	Comments
215		Drawer	1	38	
216		Bottom Drawer	1	0	
217		Top Shelf	1	13	
218		Shelf	1	6	
219		Bottom Shelf	1	0	
220		top shelf	1	73	See wipe # 735
221		Shelf	1	6	
222		Bottom shelf	1	5	
223		TWEZERS	1	9	
224		SHOEF	1	0	
225		Desk top	1	0	
226		Drawer	1	0	
227		FRONT OF DRAWERS	1	0	
228		Top Drawer	1	0	
229		Drawer	1	0	
230		Bottom Drawer	1	6	
231		Lower wall	1	0	
232		Chair	1	10	
233		Shelf	1	9	
234		Wall	1	0	
235		FRONT OF WALL UNIT	1	0	
236		Top Shelf	1	1	
237		Shelf	1	48	
238		Shelf	1	7	
239		Bottom Shelf	1	0	
240		FRONT OF WALL UNIT	1	5	
241		Shelf (Top)	1	6	
242	↓	Shelf	1	0	

Radiological Survey Continuation Sheet

Page 10 of 46

Date 5/4/00

No.	Time	Location	Inst. Used	Total Activity (dpm/100 cm ²)	Comments
243		Shelf	1	9	
244		Bottom Shelf	1	62	
245		FRONT OF WASH UNIT	1	50	
246		Top Shelf	1	1	
247		Shelf	1	11	
248		Bottom Shelf	1	0	
249		Shelf	1	43	
250		Desk top	1	12	
251		Chair	1	0	
252		Drawer	1		
253		front of Drawers	1	0	
254		Top Drawer	1	10	
255		Drawer	1	0	
256		Bottom Drawer	1	0	
257		Counter	1	0	
258		protective ctr. paper	1	0	
259		" " "	1	5	
260		Shelf	1	0	
261		Desk top	1	11	
262		Shelf	1	1	
263		WASH	1	33	
264		FRONT OF WASH UNIT	1	1	
265		TOP Shelf	1	0	
266		Shelf	1	0	
267		Shelf	1	0	
268		Bottom Shelf	1	0	
269		Top Shelf	1	0	
270	↓	Shelf	1	0	

Radiological Survey Continuation Sheet

Page 11 of 46

Date 5/4/00

No.	Time	Location	Inst. Used	Total Activity (dpm/100 cm ²)	Comments
271		Bottom Shelf	1	0	
272		upper wall	1	0	
273		lower wall	1	0	
274		Front of Drawers	1	0	
275		Top Drawer	1	0	
276		Door Drawer	1	33	
277		Bottom Drawer	1	0	
278		Drawer	1	0	
279		Door	1	0	
280		Chair	1	0	
281		Front of Drawers	1	2	
282		Top Drawer	1	1	
283		Drawer	1	0	
284		Drawer	1	0	
285		Bottom Drawer	1	0	
286		Drawer	1	0	
287		Stool	1	0	
288		Front of Drawers	1	35	
289		Top Drawer	1	48	
290		Drawer	1	0	
291		Drawer	1	0	
292		Bottom Drawer	1	9	
293		Drawer	1	40	
294		Front of Drawer / cab.	1	0	
295		Top Drawer	1	0	
296		inside cabinet top shelf	1	7	
297		" " Bot. Shelf	1	2	
298	↓	Wall	1	0	

Radiological Survey Continuation Sheet

Page 12 of 46

Date 5/4/00

No.	Time	Location	Inst. Used	Total Activity (dpm/100 cm ²)	Comments
299		Filing cabinet	1	0	
300		Door	1	0	
301		Floor	1	0	
302		FLOOR	1	6	
303		Desk	1	11	
304		TOP OF CABINETS	1	38	
305		WINDOW SILL	1	5	
306		Back wall	1	15	
307		TOP OF TABLE	1	0	
308		TABLE LEGS	1	0	
309		WALL	1	9	
310		UPPER WALL	1	11	
311		LOWER WALL	1	43	
312		TOP Shelf	1	0	
313		Bottom Shelf	1	0	
314		Window / sill	1	65	
315		LOWER WALL	1	0	
316		WALL	1	4	
317		Computer cart	1	9	
318		" "	1	0	
319		Window / sill	1	12	
320		Window / sill	1	0	
321		LOWER WALL	1	2	
322		LOWER WALL	1	54	
323		BACK OF CABINET	1	0	
324		BACK OF CABINET	1	0	
325		BACK OF CABINET	1	119	See map # 736
326	↓	FLOOR	1	0	

Radiological Survey Continuation Sheet

Page 13 of 46

Date 5/4/00

No.	Time	Location	Inst. Used	Total Activity (dpm/100 cm ²)	Comments
327		Floor	1	0	
328		Floor	1	0	
329		Floor	1	49	
330		Floor	1	1	
331		Floor	1	2	
332		Floor	1	49	
333		Floor	1	13	
334		Floor	1	0	
335		Floor	1	65	
336		Floor	1	0	
337		Floor	1	111	See wipe # 737
338		Floor	1	0	
339		Floor	1	0	
340		Floor	1	0	
341		Floor	1	11	
342		Floor	1	46	
343		Chair (Low)	1	0	
344		Chair	1	0	
345		HOOD SASH	1	2	
346		COUNTER RIGHT HOOD	1	10	
347		COUNTER left HOOD	1	5	
348		LEFT SIDE	1	2	
349		LEFT BACK	1	38	
350		RIGHT BACK	1	0	
351		RIGHT SIDE	1	9	
352		RIGHT TOP	1	6	
353		LEFT TOP	1	5	
354	✓	OUTSIDE FRONT (UPPER)	1	10	

Radiological Survey Continuation Sheet

Page 14 of 46

Date 5/4/00

No.	Time	Location	Inst. Used	Total Activity (dpm/100 cm ²)	Comments
355		TOP OF WALL UNIT (BK CASE)	1	0	
356		TOP Shelf	1	0	
357		Shelf	1	16	
358		Shelf	1	0	
359		Shelf	1	0	
360		Lower Shelf	1	15	
361		Upper wall	1	4	
362		Lower wall	1	0	
363		SIDE OF CABINET	1	2	
364		SIDE OF CABINET	1	6	
365		FRONT OF DRAWERS	1	0	
366		TOP DRAWER	1	0	
367		DRAWER	1	13	
368		DRAWER	1	9	
369		BOTTOM DRAWER	1	0	
370		DRAWER	1	1	
371		FRONT OF DRAWERS	1	13	
372		TOP DRAWER	1	48	
373		DRAWER	1	12	
374		DRAWER	1	48	
375		BOTTOM DRAWER	1	43	
376		FRONT OF DRAWERS	1	0	
377		TOP DRAWER	1	0	
378		DRAWER	1	5	
379		DRAWER	1	0	
380		BOTTOM DRAWER	1	0	
381		DRAWER	1	0	
382	↓	FRONT OF DRAWERS	1	63	

Radiological Survey Continuation Sheet

Page 15 of 46

Date 5/4/00

No.	Time	Location	Inst. Used	Total Activity (dpm/100 cm ²)	Comments
383		TOP DRAWER	1	0	
384		DRAWER	1	0	
385		DRAWER	1	4	
386		BOTTOM DRAWER	1	0	
387		LOOSE DRAWER	1	0	
388		INSIDE VENT	1	0	
389		OUTSIDE VENT	1	10	
390		TOP Shelf	1	1	
391		Shelf	1	15	
392		Bottom Shelf	1	1	
393		WINDOW/SILL	1	6	
394		LOWER WALL	1	40	
395		FRONT OF CABINET	1	6	
396		TOP DRAWER	1	7	
397		INSIDE CABINET	1	0	
398		WINDOW/SILL	1	7	
399		LOWER WALL	1	6	
400		Upper Shelf	1	9	
401		Shelf	1	4	
402		Drawer	1	35	
403		Front of Drawers	1	0	
404		TOP Drawer	1	2	
405		DRAWER	1	0	
406		DRAWER	1	12	
407		BOTTOM DRAWER	1	63	
408		WALL	1	11	
409		WALL	1	45	
410	↓	counter	1	55	

Radiological Survey Continuation Sheet

Date 5/4/00

No.	Time	Location	Inst. Used	Total Activity (dpm/100 cm ²)	Comments
411		counter	1	0	
412		counter	1	16	
413		counter	1	0	
414		counter	1	10	
415		counter	1	5	
416		computer	1	10	
417		keyboard	1	0	
418		monitor	1	45	
419		MAC monitor	1	0	
420		printer w/stand	1	7	
421		" "	1	0	
422		WATERS interface	1	0	
423		WATERS TCM	1	1	
424		keyboard	1	9	
425		keyboard	1	48	
426		outside lid blue trash can	1	0	
427		inside " " " "	1	15	
428		inside blue trash can	1	13	
429		outside " " "	1	0	
430		MAC monitor	1	55	
431		computer	1	0	
432		Plexiglas shield front	1	68	
433		" " BACK	1	1	
434		TRASH CAN LID out	1	158	See wipe # 738
435		" " " in	1	5	
436		Trash can in	1	0	
437		" " out	1	6	
438	↓	keyboard	1	0	

Radiological Survey Continuation Sheet

Page 17 of 46

Date 5/4/80

No.	Time	Location	Inst. Used	Total Activity (dpm/100 cm ²)	Comments
439		Keyboard	1	0	
440		Keyboard	1	6	
441		Keyboard	1	50	
442		Keyboard	1	15	
443		Computer	1	13	
444		Plexiglas Shield Back	1	0	
445		" " Front	1	5	
446		" " Bottom	1	0	
447		Fraction collector	1	55	
448		" "	1	65	
449		" "	1	40	
450		" "	1	0	
451		BACK plexi shield	1	0	
452		FRONT " "	1	0	
453		LEAD BRICK	1	0	
454		LEAD BRICK	1	0	
455		LEAD BRICK	1	0	
456		LEAD BRICK	1	0	
457		LEAD BRICK	1	7	
458		LEAD BRICK	1	6	
459		LEAD BRICK	1	40	
460		LEAD BRICK	1	0	
461		LEAD BRICK	1	2	
462		LEAD SHEET	1	40	
463		" "	1	9	
464		" "	1	63	
465		LEAD SHEET	1	0	
466	↓	" "	1	9	

Radiological Survey Continuation Sheet

Page 18 of 96

Date 5/4/00

No.	Time	Location	Inst. Used	Total Activity (dpm/100 cm ²)	Comments
467		LEAD SHEET	1	0	
468		" "	1	✓ 225	✓ RAD waste
469		" "	1	38	
470		" "	1	0	
471		LEAD SHEET	1	10	
472		" "	1	11	
473		Plastic	1	0	
474		Plastic case	1	0	
475		LEADED Plastic case	1	40	
476		spatula	1	16	
477		tweezers	1	✓ 188	✓ RAD WASTE
478		Scissors	1	16	
479		LEAD SHEET	1	38	
480		" "	1	0	
481		" "	1	0	
482		Computer	1	0	
483		monitor	1	5	
484		LEAD SHEET	1	✓ 1043	✓ See notes # 739
485		" "	1	5	
486		" "	1	0	
487		monitor	1	10	
488		LEAD SHEET	1	0	
489		" "	1	45	
490		" "	1	38	
491		" "	1	7	
492		" "	1	0	
493		" "	1	12	
494	↓	" "	1	0	

Radiological Survey Continuation Sheet

Page 19 of 46

Date 5/5/00

5/15/00

No.	Time	Location	Inst. Used	Total Activity (dpm/100 cm ²)	Comments
495		WATERBATH Shaker	1	0	
496		" " "	1	13	
497		" " "	1	0	
498		" " " LID	1	0	
499		LEAD SHEET	1	4	
500		" "	1	✓ 108	RAD waste
501		" "	1	✓ 443	✓ RAD waste
502		" "	1	10	
503		LEAD SHEET	1	65	
504		" "	1	10	
505		Z MODULE	1	43	
506		microscope	1	✓ 433	✓ RAD waste
507		white plastic trap table	1	✓ 93	See wipe # 752
508		trap table legs	1	0	
509		white plastic	1	10	
510		Monitor	1	0	
511		WARRIS UNIT	1	35	
512		" "	1	16	
513		" " inside	1	63	
514		computer	1	0	
515		piece of equipment	1	2	
516		plastic case	1	4	
517		cards	1	5	
518		writers equip	1	5	
519		" " inside	1	✓ 80 ^{ok}	
520		" "	1	40	
521		" "	1	0	
522	↓	Spatula	1	0	

Radiological Survey Continuation Sheet

Page 20 of 46

Date 5/15/00

No.	Time	Location	Inst. Used	Total Activity (dpm/100 cm ²)	Comments
523		printer	1	9	
524		Equipment	1	1	
525		Drive	1	0	
526		metal case	1	0	
527		waters	1	11	
528		Box of shift	1	✓ 70	
529		Drawer front	1	0	
530		Desiccator	1	0	
531		Plastic container	1	✓ 869	✓ sample # 781/785 RAD waste
532		Desiccator lid	1	12	
533		stirrer	1	✓ 295	✓ See mps # 748/749
534		sack	1	0	
535		Dikator 401	1	7	
536		Desiccator	1	1	
537		Green thing pan	1	0	
538		pan pan glass	1	0	
539		Bag of pan Green thing	1	0	
540		Harvester Pump	1	0	
541		pan Bag of parts	1	9	
542		pan Harvester	1	5	
543		"	1	0	
544		"	1	✓ 378	✓ RAD waste
545		Aluminum block	1	0	
546		Gel dryer	1	16	
547		Blue thing	1	2	
548		metal plate	1	0	
549		" "	1	13	
550	↓	" "	1	0	

Radiological Survey Continuation Sheet

Page 21 of 46

Date 5/15/00

No.	Time	Location	Inst. Used	Total Activity (dpm/100 cm ²)	Comments
551		metal plate	1	5	
552		spray handle	1	0	
553		ring stand contraptions	1	11	
554		outside glass	1	10	
555		inside "	1	40	
556		outside glass	1	43	
557		inside "	1	5	
558		outside plexiglas	1	12	
559		inside "	1	0	
560		plastic Beaker	1	63	
561		" "	1	4,068	✓ RADWaste
562		Glove	1	13	
563		Tray w/ needles	1	0	
564		Big rock	1	✓ 8,408	✓ RADWaste
565		Bag	1	48	
566		plastic Beaker w/ hose	1	✓ 190	✓ RADWaste
567		plastic tray top	1	65	
568		" " bottom	1	40	
569		Detector	1	0	
570		Harvester	1	43	
571		"	1	4	
572		outside pump	1	✓ 120	✓ See wipe # 742
573		inside "	1	10	
574		waterbath	1	50	
575		glass pan	1	58	
576		Millipore outer	1	45	
577		" inner	1	0	
578	✓	Bag	1	1	

Radiological Survey Continuation Sheet

Page 27 of 46

Date 5/5/00

No.	Time	Location	Inst. Used	Total Activity (dpm/100 cm ²)	Comments
579		Flask	1	✓ 320	✓ RAD waste
580		Outer Harvester	1	0	
581		inner Harvester	1	0	
582		Spinner	1	15	
583		water Bath outer	1	40	
584		water Bath inner	1	0	
585		white tray	1	35	
586		pipettor rack	1	43	
587		" "	1	48	
588		" "	1	53	
589		" "	1	5	
590		pipetter	1	0	
591		"	1	13	
592		"	1	0	
593		"	1	0	
594		"	1	✓ 11,503	✓ RAD waste
595		pipetter	1	0	
596		"	1	✓ 323	✓ RAD waste
597		"	1	16	
598		"	1	68	
599		"	1	✓ 870 - 890	✓ RAD waste
600		pipetter	1	0	
601		"	1	0	
602		"	1	0	
603		"	1	✓ 248	✓ RAD waste
604		pipetter	1	63	
605		"	1	1	
606	↓	"	1	35	

Radiological Survey Continuation Sheet

Page 23 of 46

Date 5/5/00

No.	Time	Location	Inst. Used	Total Activity (dpm/100 cm ²)	Comments
607		pipetter	1	48	
608		"	1	0	
609		"	1	12	
610		"	1	4	
611		pipetter	1	0	
612		"	1	0	
613		"	1	0	
614		"	1	0	
615		"	1	2	
616		pipetter	1	7	
617		"	1	40	
618		"	1	0	
619		"	1	0	
620		"	1	35	
621		pipetter	1	0	
622		"	1	7	
623		"	1	1	
624		"	1	0	
625		"	1	0	
626		pipetter	1	0	
627		"	1	13	
628		"	1	7	
629		"	1	55	
630		"	1	0	
631		pipetter	1	12	
632		"	1	50	
633		"	1	0	
634	√	"	1	50	

Radiological Survey Continuation Sheet

Page 24 of 46

Date 5/5/00

No.	Time	Location	Inst. Used	Total Activity (dpm/100 cm ²)	Comments
635		pipettor	1	10	
636		"	1	2	
637		"	1	103	RA Waste
638		"	1	38	
639		"	1	0	
640		pipettor	1	0	
641		"	1	4	
642		"	1	10	
643		"	1	0	
644		pipettor	1	70	
645		"	1	0	
646		"	1	365	RA Waste
647		pipettor	1	7	
648		memowell	1	10	
649		pipettor	1	16	
650		"	1	80	RA Waste
651		"	1	0	
652		"	1	15	
653		pipettor	1	40	
654		"	1	0	
655		"	1	45	
656		"	1	0	
657		pipettor	1	48	
658		power cord	1	4	
659		" "	1	0	
660		" "	1	0	
661		" "	1	0	
662	✓	Battery	1	7	

Radiological Survey Continuation Sheet

Page 25 of 46

Date 5/5/00

No.	Time	Location	Inst. Used	Total Activity (dpm/100 cm ²)	Comments
663		plastic rack	1	13	
664		" "	1	11	
665		" "	1	0	
666		" "	1	0	
667		" "	1	0	
668		" "	1	9	
669		plastic rack	1	588	✓ RAD waste
670		" "	1	0	
671		" "	1	5	
672		" "	1	✓ 83	RAD waste
673		" "	1	9	
674		plastic rack	1	0	
675		" "	1	0	
676		" "	1	1	
677		" "	1	12	
678		" "	1	35	
679		plastic rack	1	15	
680		" "	1	0	
681		" "	1	6	
682		" "	1	6	
683		" "	1	40	
684		" "	1	0	
685		metal rack	1	0	
686		" "	1	0	
687		" "	1	0	
688		" "	1	0	
689		" "	1	0	
690	✓	Vacuum pan	1	11	

Radiological Survey Continuation Sheet

Page 26 of 46

Date 5/1/00

No.	Time	Location	Inst. Used	Total Activity (dpm/100 cm ²)	Comments
691		plastic Dish	1	0	
692		plastic containers	1	10	
693		plastic tray	1	0	
694		metal rack	1	0	
695		plastic rack	1	35	
696		plastic	1	45	
697		plastic rack	1	1	
698		plastic	1	60	
699		metal	1	11	
700		Styrofoam	1	5	
701		metal	1	0	
702		Styrofoam	1	7	
703		plastic rack	1	10	
704		metal ring	1	0	
705		" "	1	0	
706		" "	1	0	
707		" "	1	43	
708		metal Bracket	1	0	
709		floor	1	5	
710		floor	1	2	
711		floor	1	7	
712		CJR under paper	1	0	
713		" " "	1	48	
714		" " "	1	4	
715	1:10	Post Decon 19	1	7	
716		" " 27	1	4	
717		Post Decon 28	1	15	
718		" " 30	1	0	

5/1/00

Radiological Survey Continuation Sheet

Page 27 of 46

Date 5/11/00

No.	Time	Location	Inst. Used	Total Activity (dpm/100 cm ²)	Comments
719		Post Decon 32	1		
720		" " 35	1	9	
721		" " 64	1		✓ See wipe # 746
722		Post Decon 66	1		✓ See wipe # 747
723		" " 72	1	12 ^{exp}	
724		" " 73	1	12	
725		Post Decon 78	1		
726		" " 94	1	13	
727		" " 96	1		
728		Post Decon 106	1		
729		" " 127	1	15	
730		" " 134	1	0	
731		Post Decon 187	1	0	
732		" " 193	1	0	
733		" " 195	1		✓ See wipe # 748
734		Post Decon 196	1	0	
735		Post Decon 220	1	12	
736		" " 325	1	0	
737		" " 337	1	16	
738		Post Decon 434	1		
739		" " 484	1		✓ See wipe # 749
740		" " ### 533 inner	1		
741		Post Decon 533 outer	1		✓ See wipe # 750
742		" " 572 ##	1	16	
743		Post Decon 531 outer	1	15	
744		Post Decon 531 inner	1		✓ See wipe # 751
745	↓	Lead ring	1	6	
746	1:00	Post Decon 64	1	11	

Bld. 118B Room B209

Date: 5/4/00

Or wipe locations

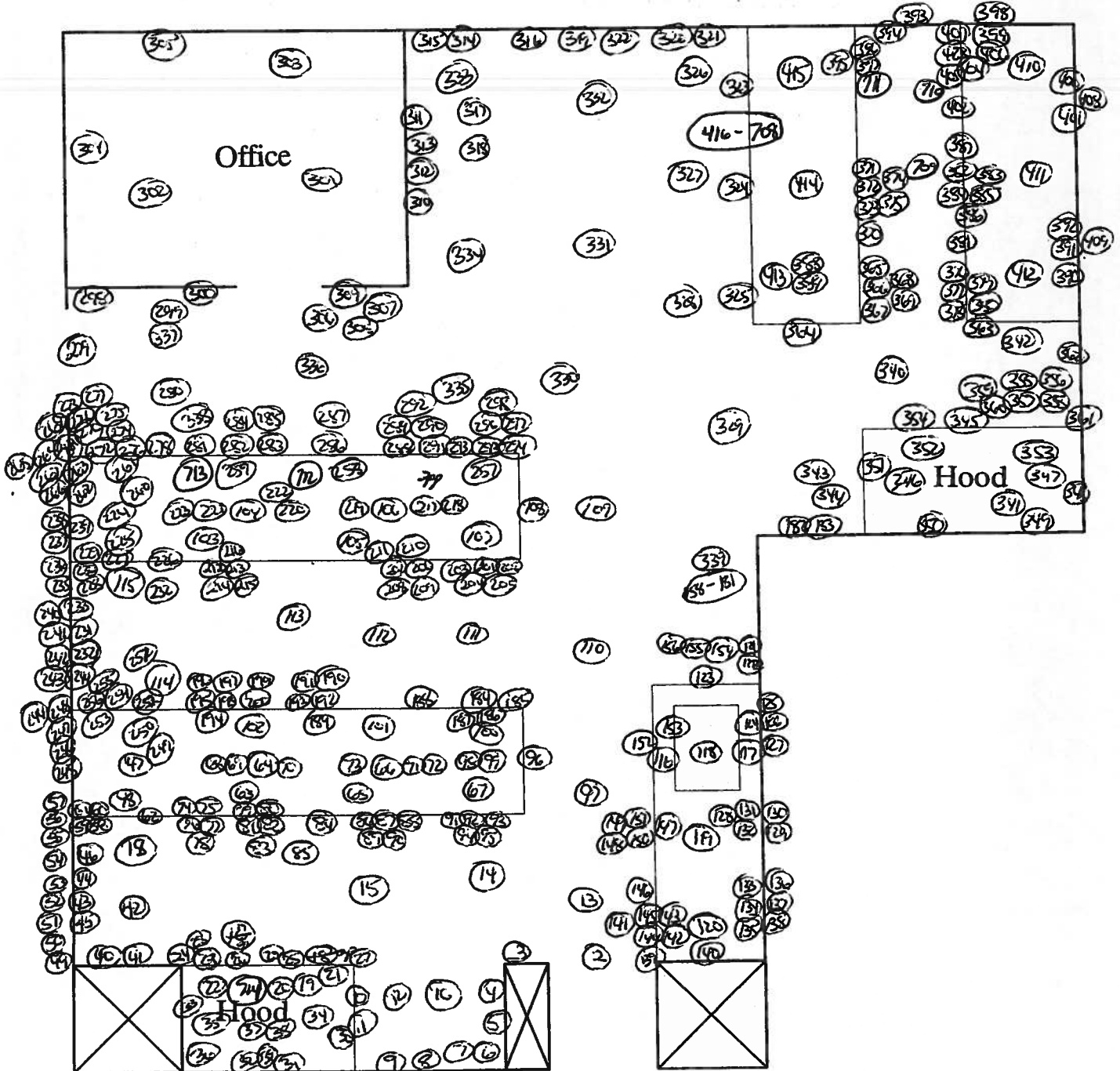

sampled 100% of lower surfaces using inst. #2. All surfaces sampled were noted to be at normal background levels with one exception: \triangle A vortex unit was noted to be contaminated to a level of 18,000 dpm/100cm² (fixed C-14). This unit was disposed of as radioactive waste.

04 May 2000 11:25

TRI-CARB - 1.09

Protocol #:27

rad safety dept

Time: 1.00

Data Mode: CPM

Nuclide: MANUAL

Background Subtract: 1st Vial

	LL	UL	LCR	25%	BKG
Region A:	0.0 - 18.6		0	0.0	16.03
Region B:	18.6 - 156		0	0.0	6.57
Region C:	0.0 - 2000		0	0.0	27.80

Quench Indicator: tSIE/AEC

Ext Std Terminator: Count

Luminescence Correction On

Coincidence Time(ns): 0

Delay Before Burst(ns): 0

Protocol Data Filename: C:\drugmet\f2500\PROT.DAT

Count Data Filename: c:\drugmet\f2500\sdata27.055

Spectrum Data Drive & Path: c:\kermit

S#	TIME	CPMA	CPMB	CPMC	SIS	tSIE	LUM	FLAG
1	10.00	16.03	6.57	27.80	13.407	503.51	70	B
2	1.00	13.56	0.84	14.20	0.000	477.41	49	
3	1.00	0.00	0.00	0.00	0.000	484.92	86	
4	1.00	26.97	0.43	27.20	0.000	488.11	52	
5	1.00	31.97	0.00	27.20	0.000	488.23	53	
6	1.00	1.97	1.43	3.20	0.000	203.50	76	
7	1.00	0.00	3.43	0.00	7.569	448.96	88	
8	1.00	0.00	8.74	2.20	16.601	450.80	83	
9	1.00	0.00	1.35	0.00	13.784	476.09	81	
10	1.00	11.46	0.00	11.20	0.021	445.05	77	
11	1.00	0.00	4.43	4.20	3.111	450.81	81	
12	1.00	8.97	0.00	5.20	0.000	497.89	76	
13	1.00	0.00	0.00	0.00	0.000	458.64	100	
14	1.00	0.00	3.43	0.00	5.277	429.41	98	
15	1.00	11.38	4.02	18.20	33.992	472.23	62	
16	1.00	0.00	0.00	0.00	4.191	425.81	100	
17	1.00	4.97	2.43	5.20	6.684	428.30	76	
18	1.00	4.97	1.43	10.20	6.912	437.32	82	
19	1.00	540.97	5.43	550.20	9.067	436.09	14	
20	1.00	0.00	0.00	0.00	0.000	388.72	100	
21	1.00	0.00	0.00	0.00	0.000	410.10	86	
22	1.00	2.97	2.43	10.20	6.330	480.77	78	
23	1.00	0.00	0.36	0.00	2.110	432.50	91	
24	1.00	0.00	1.43	0.00	8.921	462.84	85	
25	1.00	1.97	0.00	0.00	0.000	471.63	78	
26	1.00	0.00	6.43	0.00	0.000	458.18	78	
27	1.00	36.97	5.43	39.20	7.505	453.19	58	
28	1.00	84.97	1.43	87.20	6.962	438.24	56	
29	1.00	6.49	0.00	7.20	0.000	475.55	79	
30	1.00	30.97	0.00	28.20	0.203	468.19	67	
31	1.00	26.97	0.43	24.20	5.268	462.02	69	
32	1.00	20.97	6.43	30.20	15.131	461.73	65	
33	1.00	0.00	0.00	0.00	0.628	467.87	95	
34	1.00	4.99	4.41	10.20	6.395	431.24	77	
35	1.00	32.97	5.43	41.20	10.513	452.21	66	
36	1.00	7.08	1.32	11.20	4.645	404.34	78	
37	1.00	0.00	2.43	0.00	4.771	462.52	87	

S#	TIME	CPMA	CPMB	CPMC	SIS	tsIE	LUM	FLAG
38	1.00	0.00	0.43	0.00	2.268	393.72	98	
39	1.00	7.97	1.43	10.20	5.153	399.18	74	
40	1.00	2.97	1.43	7.20	12.470	480.95	75	
41	1.00	0.00	2.43	0.00	40.928	476.18	86	
42	1.00	0.97	3.43	4.20	5.721	458.03	79	
43	1.00	15.97	3.43	18.20	365.94	468.32	51	
44	1.00	14.97	0.00	12.20	0.000	500.00	66	
45	1.00	0.00	0.00	0.00	0.000	471.23	83	
46	1.00	0.00	5.75	2.20	36.077	470.10	74	
47	1.00	0.00	0.43	0.00	3.303	468.43	93	
48	1.00	18.20	0.00	15.20	0.000	478.21	74	
49	1.00	0.00	0.00	0.00	0.003	472.47	97	
50	1.00	13.97	3.43	17.20	6.757	482.09	80	
51	1.00	0.00	0.00	0.00	7.410	486.51	88	
52	1.00	9.97	3.33	15.20	6.710	472.68	77	
53	1.00	12.97	2.43	16.20	5.210	477.05	77	
54	1.00	9.25	0.15	10.20	3.074	464.18	82	
55	1.00	0.00	0.00	0.00	0.000	476.71	93	
56	1.00	0.00	0.86	0.00	6.561	476.82	80	
57	1.00	0.00	1.03	0.00	8.586	471.95	92	
58	1.00	0.00	0.00	0.00	1.259	485.87	89	
59	1.00	0.00	0.00	0.00	5.741	494.48	83	
60	1.00	0.00	0.00	0.00	0.000	472.43	78	
61	1.00	0.00	0.43	0.00	0.680	452.09	97	
62	1.00	0.00	1.43	0.00	2.755	483.01	93	
63	1.00	0.00	0.43	0.00	0.000	457.85	96	
64	1.00	73.52	0.00	72.20	3.810	446.85	52	
65	1.00	6.97	2.43	11.20	0.000	468.43	60	
66	1.00	22.97	4.43	31.20	22.072	454.84	61	
67	1.00	0.00	0.00	0.00	0.000	447.47	100	
68	1.00	13.97	0.00	15.20	2.893	476.47	81	
69	1.00	0.00	2.43	0.00	5.024	396.20	97	
70	1.00	0.00	0.00	0.00	4.005	433.91	100	
71	1.00	0.00	0.00	0.00	0.000	432.22	100	
72	1.00	38.97	0.00	41.20	1.620	423.50	67	
73	1.00	32.37	2.03	39.20	2.958	383.16	72	
74	1.00	0.00	0.52	0.00	5.866	457.30	92	
75	1.00	22.97	0.00	20.20	4.450	474.69	66	
76	1.00	10.97	0.43	14.20	11.246	420.35	71	
77	1.00	3.97	0.00	5.20	3.382	461.60	73	
78	1.00	24.97	5.43	29.20	10.294	423.45	56	
79	1.00	0.00	7.43	7.20	40.333	459.32	72	
80	1.00	2.97	0.00	2.20	0.000	482.20	77	
81	1.00	9.97	4.43	13.20	0.000	470.90	51	
82	1.00	4.97	0.00	3.20	0.000	464.53	82	
83	1.00	17.97	0.00	16.20	0.000	467.21	64	
84	1.00	11.97	3.43	14.20	6.895	454.74	68	
85	1.00	18.97	2.43	22.20	8.130	465.55	63	
86	1.00	0.97	0.00	3.20	4.415	451.76	85	
87	1.00	0.00	2.32	0.20	17.645	463.31	81	
88	1.00	0.00	0.43	0.00	0.000	473.99	93	
89	1.00	0.00	0.43	0.00	32.586	473.47	79	
90	1.00	12.99	6.41	18.20	5.807	460.65	73	

S#	TIME	CPMA	CPMB	CPMC	SIS	tsIE	LUM	FLAG
----	------	------	------	------	-----	------	-----	------

93	1.00	0.00	0.00	0.00	12.123	476.84	80
94	1.00	39.97	0.00	44.20	2.557	461.96	58
95	1.00	0.00	0.43	0.00	0.000	398.05	100
96	1.00	23.97	2.43	29.20	7.496	441.32	64
97	1.00	0.00	0.00	0.00	0.000	373.24	100
98	1.00	13.97	2.43	12.20	7.348	441.09	66
99	1.00	7.97	0.43	9.20	6.164	459.33	77
100	1.00	6.97	2.43	10.20	11.327	429.85	66
101	1.00	16.09	0.00	13.20	0.000	447.04	74
102	1.00	0.00	1.93	1.20	7.967	445.15	84
103	1.00	0.00	0.43	0.00	14.075	458.70	94
104	1.00	0.00	0.43	0.00	9.094	437.38	87
105	1.00	3.97	0.00	2.20	0.000	448.76	74
106	1.00	48.97	0.00	49.20	2.349	432.55	65
107	1.00	0.00	0.00	0.00	0.000	445.96	91
108	1.00	5.16	0.24	7.20	1.061	406.53	83
109	1.00	1.97	0.43	0.20	4.764	438.46	83
110	1.00	0.00	0.00	0.00	0.000	405.41	83
111	1.00	0.00	2.27	0.00	0.000	405.78	100
112	1.00	0.00	0.00	0.00	0.000	444.29	90
113	1.00	5.97	0.00	1.20	0.000	415.30	81
114	1.00	0.00	1.15	0.00	16.985	433.30	90
115	1.00	3.97	5.43	9.20	20.906	446.05	75
116	1.00	0.97	3.43	6.20	16.975	407.84	76
117	1.00	0.00	2.43	1.20	7.988	468.28	80
118	1.00	0.00	5.23	5.20	13.323	465.92	79
119	1.00	9.97	0.00	10.20	0.000	447.32	70
120	1.00	0.00	3.43	0.00	6.311	399.63	96
121	1.00	6.64	0.00	5.20	0.000	479.88	71
122	1.00	0.00	0.00	0.00	0.000	434.81	100
123	1.00	0.00	3.43	0.00	29.654	497.85	89
124	1.00	0.00	0.00	0.00	0.000	407.16	99
125	1.00	0.00	1.38	0.00	7.435	431.98	91
126	1.00	3.97	0.00	0.00	0.000	431.95	75
127	1.00	28.11	1.29	28.20	4.009	405.00	84
128	1.00	0.00	1.43	1.20	1.309	476.46	82
129	1.00	1.97	1.43	4.20	15.880	442.01	74
130	1.00	0.00	0.43	0.00	0.000	425.61	84
131	1.00	8.97	0.00	6.20	0.000	435.76	76
132	1.00	11.22	0.00	13.20	46.105	467.49	62
133	1.00	0.00	0.00	0.00	0.000	457.14	100
134	1.00	25.97	0.00	31.20	0.000	454.08	67
135	1.00	1.97	1.43	1.20	29.184	442.24	71
136	1.00	0.00	2.43	0.00	0.000	457.39	76
137	1.00	0.00	0.00	0.00	6.129	459.14	85

138 1.00 0.00 0.00 0.00 0.000 445.82 100
 FATAL ERROR:
 ELEVATOR UP

139 1.00 7.97 0.43 6.20 0.000 459.50 65

S#	TIME	CPMA	CPMB	CPMC	SIS	tsIE	LUM FLAG
140	1.00	0.00	0.00	0.00	0.000	441.54	91
141	1.00	0.00	1.43	3.20	2.578	441.30	87
142	1.00	8.97	0.43	11.20	0.000	446.55	57
143	1.00	17.97	0.43	17.20	3.636	404.10	81
144	1.00	0.00	2.43	0.00	2.121	392.47	94
145	1.00	18.85	0.00	19.20	3.669	456.44	63
146	1.00	8.97	1.43	11.20	6.974	450.04	78
147	1.00	10.97	0.00	8.20	3.186	470.21	69
148	1.00	21.97	0.43	24.20	0.000	409.72	51
149	1.00	0.00	0.99	0.00	0.000	443.37	100
150	1.00	9.97	2.43	10.20	6.584	458.49	72
151	1.00	25.97	0.00	22.20	0.000	423.36	61
152	1.00	20.97	0.00	17.20	0.000	470.51	52
153	1.00	0.00	3.43	0.00	20.467	465.15	82
154	1.00	10.97	0.00	9.20	0.000	476.26	61
155	1.00	12.97	2.43	16.20	2.339	485.06	65
156	1.00	0.00	8.43	0.00	44.318	483.44	85
157	1.00	5.82	1.58	10.20	13.748	426.15	71
158	1.00	0.00	0.00	0.00	0.000	470.47	81
159	1.00	0.00	1.43	0.00	0.000	461.09	78
160	1.00	0.00	3.43	0.20	29.771	453.12	76
161	1.00	6.48	0.00	6.20	0.000	475.21	72
162	1.00	2.97	0.00	0.00	0.000	435.58	78
163	1.00	2.96	0.00	0.00	0.000	459.75	71
164	1.00	0.58	0.82	3.20	0.000	469.15	75
165	1.00	0.00	0.00	0.00	0.967	459.11	94
166	1.00	0.00	0.00	0.00	0.000	481.09	96
167	1.00	0.00	1.39	0.00	0.000	461.09	76
168	1.00	0.00	4.43	0.00	7.673	480.66	87
169	1.00	17.97	0.00	18.20	0.000	486.65	61
170	1.00	13.06	2.34	14.20	17.894	462.76	65
171	1.00	0.00	0.49	0.00	4.880	487.81	84
172	1.00	3.97	0.00	3.20	0.000	450.54	73
173	1.00	0.00	5.43	0.00	17.250	457.50	98
174	1.00	3.97	3.43	8.20	0.000	454.85	58
175	1.00	0.00	1.43	0.00	17.856	469.63	89
176	1.00	2.97	0.00	3.20	9.909	468.85	79
177	1.00	0.00	0.43	0.00	2.487	481.49	82
178	1.00	1.54	0.00	0.20	0.000	424.27	78
179	1.00	0.00	4.62	3.20	81.184	483.89	73
180	1.00	0.00	2.43	0.00	4.313	479.65	88
181	1.00	0.00	2.07	0.00	133.79	470.74	99
182	1.00	3.97	0.00	3.20	0.000	356.59	82
183	1.00	5.97	1.43	5.20	0.000	410.63	78
184	1.00	24.97	0.00	22.20	9.145	443.63	56
185	1.00	6.97	0.43	6.20	4.385	444.92	70

187	1.00	33.73	3.87	38.20	3.888	702.70	57
188	1.00	16.97	2.43	19.20	2.885	426.32	62
189	1.00	12.97	0.00	10.20	0.000	456.71	62
190	1.00	5.97	0.43	9.20	7.394	466.47	69
191	1.00	0.00	3.43	7.20	19.889	464.98	78
192	1.00	0.00	0.00	0.00	0.000	477.77	86

S#	TIME	CPMA	CPMB	CPMC	SIS	tSIE	LUM	FLAG
193	1.00	55.30	0.00	58.20	5.955	469.69	50	
194	1.00	5.97	0.00	6.20	19.713	474.25	74	
195	1.00	174.07	1.33	174.20	8.742	446.87	33	
196	1.00	586.16	9.24	596.20	9.691	442.36	14	
197	1.00	12.97	2.43	17.20	9.011	451.07	75	
198	1.00	0.00	1.28	0.00	1.892	434.96	84	
199	1.00	17.30	4.10	20.20	20.406	469.86	59	
200	1.00	0.87	3.53	6.20	0.000	457.14	59	
201	1.00	2.30	0.00	2.20	0.000	464.96	76	
202	1.00	0.00	0.00	0.00	0.000	439.94	100	
203	1.00	0.00	0.00	0.00	0.000	465.61	97	
204	1.00	0.00	0.00	0.00	0.000	464.96	86	
205	1.00	20.41	0.00	18.20	5.400	443.46	58	
206	1.00	5.97	1.43	9.20	7.923	504.52	70	
207	1.00	12.97	0.00	11.20	0.000	449.62	68	
208	1.00	0.00	3.27	0.00	87.265	478.13	80	
209	1.00	7.97	2.43	12.20	2.991	463.39	61	
210	1.00	0.00	1.02	0.00	0.000	472.13	90	
211	1.00	22.97	0.43	24.20	2.176	464.55	55	
212	1.00	12.97	2.43	13.20	2.487	465.60	62	
213	1.00	0.00	1.43	0.00	3.909	474.74	88	
214	1.00	11.97	0.00	15.20	0.000	478.27	65	
215	1.00	14.97	0.00	14.20	0.000	444.77	66	
216	1.00	0.00	0.00	0.00	0.000	427.60	84	
217	1.00	10.97	2.43	11.20	5.482	395.80	78	
218	1.00	5.97	3.43	5.20	15.733	452.83	67	
219	1.00	0.00	3.43	0.00	10.834	415.61	95	
220	1.00	22.97	4.43	27.20	4.155	373.03	77	
221	1.00	2.97	2.43	5.20	32.903	427.52	67	
222	1.00	3.50	2.90	4.20	15.765	416.68	79	
223	1.00	8.97	0.00	7.20	2.932	495.41	78	
224	1.00	0.00	0.00	0.00	0.000	448.82	99	
225	1.00	0.00	0.00	0.00	0.000	451.27	81	
226	1.00	0.00	2.43	0.00	2.578	467.67	90	
227	1.00	0.00	1.43	0.00	2.225	468.77	100	
228	1.00	0.00	5.53	0.00	47.602	486.74	93	
229	1.00	0.00	1.43	0.00	3.889	456.78	90	
230	1.00	2.97	3.43	5.20	17.275	453.56	71	
231	1.00	0.00	0.00	0.00	4.541	464.57	87	
232	1.00	0.56	2.84	8.20	16.374	477.39	78	
233	1.00	7.49	0.00	7.20	0.918	445.94	86	
234	1.00	5.97	0.00	0.00	0.000	444.22	83	
235	1.00	0.00	3.15	0.00	19.236	468.18	83	
236	1.00	1.97	0.00	1.20	8.600	419.42	81	
237	1.00	17.97	1.43	19.20	2.403	468.24	75	
238	1.00	8.97	0.43	6.20	0.000	488.02	70	
239	1.00	0.00	0.00	0.00	0.000	444.99	100	
240	1.00	8.97	0.00	4.20	0.000	493.17	66	
241	1.00	3.97	0.43	5.20	0.000	465.41	64	
242	1.00	0.00	1.43	0.00	867.50	468.37	100	
243	1.00	9.97	0.00	7.20	0.000	473.65	69	
244	1.00	25.97	0.00	23.20	5.328	427.46	62	

S#	TIME	CPMA	CPMB	CPMC	SIS	tsIE	LUM FLAG
246	1.00	1.97	0.00	1.20	0.000	455.71	89
247	1.00	12.43	0.00	9.20	3.477	444.21	83
248	1.00	0.00	2.07	0.00	5.196	411.53	93
249	1.00	23.97	3.43	26.20	9.816	423.92	65
250	1.00	6.97	2.43	10.20	9.963	433.78	79
251	1.00	0.00	1.04	0.00	2.903	471.51	86
252	1.00	12.97	0.00	16.20	1.415	436.56	75
253	1.00	0.00	0.00	0.00	0.000	470.27	84
254	1.00	0.00	5.43	8.20	13.031	457.46	75
255	1.00	0.00	2.43	0.00	5.640	452.36	97
256	1.00	0.97	0.43	0.20	5.630	471.65	84
257	1.00	0.00	3.93	0.00	9.035	445.20	92
258	1.00	0.00	0.43	0.00	8.966	424.89	89
259	1.00	0.00	3.43	4.20	15.546	428.99	75
260	1.00	0.00	1.00	0.00	77.040	472.83	80
261	1.00	6.97	0.43	9.20	1.759	440.74	75
262	1.00	0.00	1.43	1.20	67.677	458.97	73
263	1.00	9.97	1.43	13.20	0.000	455.38	66
264	1.00	0.00	1.84	1.20	8.791	477.51	88
265	1.00	0.00	1.43	0.00	74.879	486.95	100
266	1.00	0.00	0.43	0.00	2.463	486.94	100
267	1.00	0.00	0.00	0.00	3.184	467.02	100
268	1.00	0.00	0.00	0.00	3.215	467.68	90
269	1.00	0.00	1.43	0.00	6.433	460.49	97
270	1.00	0.00	2.96	0.00	5.269	473.96	90
271	1.00	0.00	0.00	0.00	1.279	493.93	100
272	1.00	0.00	5.43	0.00	14.846	464.96	100
273	1.00	0.00	1.34	0.00	33.211	462.85	75
274	1.00	0.00	0.00	0.00	0.000	452.62	94
275	1.00	0.00	4.43	0.00	16.507	458.78	83
276	1.00	2.97	5.43	13.20	9.093	462.90	74
277	1.00	0.00	1.43	0.00	2.887	474.76	88
278	1.00	0.00	0.00	0.00	0.000	441.63	87
279	1.00	0.00	0.00	0.00	0.000	443.01	82
280	1.00	0.00	0.00	0.00	0.000	470.37	93
281	1.00	1.97	0.00	2.20	3.143	443.04	77
282	1.00	1.97	0.43	1.20	8.405	464.41	81
283	1.00	1.97	0.00	0.00	0.000	464.84	83
284	1.00	0.00	2.43	0.00	0.000	489.48	82
285	1.00	0.00	0.00	0.00	0.000	455.10	89
286	1.00	0.00	0.00	0.00	0.000	467.94	88
287	1.00	0.00	0.00	0.00	0.000	429.46	97
288	1.00	14.28	1.12	14.20	6.716	469.14	74
289	1.00	22.29	2.11	19.20	16.123	469.61	52
290	1.00	0.00	0.00	0.20	0.000	482.43	76
291	1.00	0.00	2.28	0.00	0.000	462.26	89
292	1.00	4.07	0.33	7.20	0.000	463.02	77
293	1.00	12.97	3.43	16.20	31.095	455.26	64
294	1.00	0.00	0.43	0.00	0.000	479.82	86
295	1.00	0.00	0.43	0.00	0.000	479.92	95
296	1.00	0.59	0.00	6.20	5.897	478.27	84
297	1.00	2.97	1.43	2.20	4.997	447.25	78
298	1.00	0.00	3.43	0.00	4.365	440.22	91

OFF	TIME	CRIM	CRIM	CRIM	CRIM	CRIM	CRIM
299	1.00	0.00	1.43	0.00	2.379	470.61	93
300	1.00	0.00	0.00	0.00	1.684	472.39	83
301	1.00	0.00	0.43	0.00	0.000	420.15	83
302	1.00	0.97	2.43	5.20	1.518	448.81	77
303	1.00	3.97	6.43	9.20	114.70	458.12	62
304	1.00	19.38	0.00	14.20	0.000	413.12	74
305	1.00	1.97	1.43	4.20	0.000	390.21	81
306	1.00	13.97	1.43	12.20	3.201	353.00	74
307	1.00	0.00	0.06	0.00	2.531	406.44	93
308	1.00	0.00	0.00	0.00	0.000	446.22	85
309	1.00	1.97	6.43	7.20	26.364	476.33	70
310	1.00	11.97	0.00	9.20	0.000	462.65	60
311	1.00	21.97	0.00	16.20	0.000	417.89	67
312	1.00	0.00	3.43	0.00	6.053	446.70	84
313	1.00	0.00	0.43	0.00	0.000	409.99	88
314	1.00	22.24	0.16	24.20	2.025	438.46	67
315	1.00	0.00	0.00	0.00	7.495	441.52	100
316	1.00	2.33	3.07	3.20	15.634	470.60	79
317	1.00	7.97	0.00	7.20	0.000	476.19	71
318	1.00	0.00	2.43	0.00	39.399	404.73	100
319	1.00	2.97	5.43	10.20	10.611	417.35	76
320	1.00	0.00	0.00	0.00	0.000	446.32	88
321	1.00	1.97	3.43	2.20	10.751	421.40	75
322	1.00	14.97	1.43	20.20	18.776	410.86	64
323	1.00	0.00	6.43	0.00	20.964	430.65	86
324	1.00	0.00	0.00	0.00	4.520	415.32	86
325	1.00	34.97	10.43	44.20	10.192	364.26	55
326	1.00	0.00	3.43	0.00	0.000	390.21	91
327	1.00	0.00	2.46	0.20	12.957	410.90	81
328	1.00	0.00	0.00	0.00	0.000	375.66	89
329	1.00	22.97	0.00	18.20	0.555	413.47	74
330	1.00	0.97	0.00	1.20	0.000	426.74	75
331	1.00	5.97	0.00	2.20	0.000	430.83	71
332	1.00	10.79	7.61	18.20	4.772	366.20	78
333	1.00	9.97	1.43	11.20	5.927	374.18	79
334	1.00	0.00	3.43	0.00	2.023	316.28	97
335	1.00	18.97	2.43	24.20	4.113	360.30	76
336	1.00	0.00	0.00	0.00	1.234	408.03	100
337	1.00	39.97	0.43	41.20	1.617	425.18	55
338	1.00	2.97	0.00	0.00	0.345	437.47	89

FATAL ERROR:
ELEVATOR UP

FATAL ERROR:
ELEVATOR UP

FATAL ERROR:
ELEVATOR UP

FATAL ERROR:

ELEVATOR UP

1 MISSING TUBE(S)
340 1.00 0.00 0.00 0.00 2.610 230.85 100

343	1.00	0.00	4.43	0.00	0.000	310.55	85
344	1.00	0.00	0.77	0.20	0.000	331.91	83
345	1.00	0.00	0.28	2.20	0.000	346.25	80
346	1.00	5.97	0.00	8.20	0.000	357.01	76
347	1.00	1.79	3.26	4.20	14.756	366.11	76
348	1.00	0.00	0.79	2.20	0.000	360.89	74
349	1.00	6.61	1.79	14.20	0.000	360.79	58
350	1.00	0.00	0.00	0.00	0.000	358.93	98
351	1.00	6.97	0.00	7.20	0.000	363.59	74
352	1.00	5.82	0.00	5.20	0.000	367.09	76
353	1.00	2.56	0.00	4.20	0.000	359.34	65
354	1.00	8.97	0.00	8.20	0.000	354.30	76
355	1.00	0.00	0.00	0.00	0.000	338.36	92
356	1.00	0.00	0.00	0.00	0.000	357.72	80
357	1.00	14.97	0.00	13.20	0.000	354.44	58
358	1.00	0.00	4.43	0.00	19.528	352.00	78
359	1.00	0.00	0.00	0.00	0.000	364.37	80
360	1.00	8.97	4.43	12.20	66.237	332.72	61
361	1.00	1.97	2.43	3.20	0.000	374.90	69
362	1.00	0.00	0.69	0.00	0.000	363.78	86
363	1.00	0.97	0.00	2.20	0.000	350.20	72
364	1.00	0.00	2.43	0.00	0.000	329.90	85
365	1.00	3.97	0.00	0.00	0.000	356.63	80
366	1.00	0.00	0.00	0.00	0.000	359.01	75
367	1.00	7.92	0.00	11.20	0.000	355.91	71
368	1.00	9.97	0.00	7.20	0.000	343.84	59
369	1.00	0.00	0.43	0.00	0.000	356.29	81
370	1.00	5.41	0.00	1.20	0.000	354.96	83
371	1.00	4.92	5.48	11.20	6.140	340.41	77
372	1.00	23.97	0.00	19.20	0.000	325.20	53
373	1.00	6.97	1.43	10.20	5.109	352.93	67
374	1.00	11.97	6.43	19.20	30.005	330.48	57
375	1.00	16.29	3.11	17.20	0.000	321.73	63
376	1.00	0.00	0.43	0.00	0.000	354.03	100
377	1.00	0.00	3.43	0.00	0.000	353.77	67
378	1.00	1.97	1.43	4.20	0.000	370.50	68
379	1.00	0.00	1.43	0.00	0.000	369.56	79
380	1.00	0.00	4.43	0.00	0.000	330.04	79
381	1.00	0.00	1.43	0.00	3.398	347.96	89
382	1.00	20.97	3.43	25.20	4.422	346.89	55
383	1.00	0.00	0.00	0.00	0.000	319.90	74
384	1.00	0.00	0.00	0.00	0.000	333.56	100
385	1.00	2.97	0.00	3.20	0.000	361.27	81
386	1.00	0.00	0.00	0.20	0.000	348.75	79
387	1.00	0.00	3.04	0.00	0.000	323.88	82
388	1.00	0.00	2.74	0.00	0.000	332.79	70
389	1.00	7.97	0.00	8.20	0.000	347.90	68

S#	TIME	CPMA	CPMB	CPMC	SIS	tSIE	LUM	FLAG
390	1.00	3.97	0.00	1.20	0.000	358.85	83	
391	1.00	18.97	0.00	12.20	0.000	329.36	66	
392	1.00	0.00	0.43	1.20	0.000	331.83	80	
393	1.00	4.97	0.00	5.20	0.000	319.71	81	
394	1.00	13.78	0.62	16.20	0.000	336.34	67	
395	1.00	1.97	2.43	5.20	27.320	375.10	75	
396	1.00	7.68	0.00	6.20	0.000	333.19	72	
397	1.00	0.00	0.48	0.00	0.000	310.93	100	
398	1.00	5.22	1.18	6.20	0.803	319.83	81	
399	1.00	0.00	3.65	5.20	0.092	279.69	82	

402	1.00	12.97	0.43	14.20	0.000	328.22	74
403	1.00	0.00	0.00	0.00	0.000	295.16	95
404	1.00	4.92	0.00	2.20	0.000	310.78	74
405	1.00	2.97	0.00	0.00	0.000	312.79	85
406	1.00	10.75	0.65	10.20	0.000	335.41	73
407	1.00	22.84	0.56	25.20	1.501	308.42	75
408	1.00	4.97	1.43	9.20	0.000	339.67	71
409	1.00	15.12	1.28	18.20	4.693	346.41	64
410	1.00	21.42	0.00	22.20	0.000	333.84	63
411	1.00	0.00	0.00	0.00	0.000	338.95	81
412	1.00	13.97	0.00	13.20	0.000	326.17	76
413	1.00	0.00	2.43	0.00	0.653	268.12	87
414	1.00	10.97	0.00	8.20	0.000	304.74	73
415	1.00	2.97	3.43	4.20	2.376	328.51	71
416	1.00	5.25	0.15	8.20	0.000	350.21	73
417	1.00	0.00	1.34	0.00	2.885	335.35	99
418	1.00	16.97	0.00	18.20	0.000	313.34	65
419	1.00	0.00	0.00	0.00	0.000	370.99	100
420	1.00	7.97	0.00	6.20	0.000	366.96	68
421	1.00	0.00	1.77	0.00	0.000	361.48	85
422	1.00	0.00	0.00	0.00	0.000	360.04	100
423	1.00	0.00	1.43	1.20	3.529	361.98	83
424	1.00	7.97	0.00	7.20	0.000	361.55	67
425	1.00	15.52	0.88	19.20	2.590	358.22	78
426	1.00	0.00	0.00	0.00	0.000	332.39	86
427	1.00	6.75	0.00	12.20	0.000	364.80	81
428	1.00	11.97	0.00	11.20	0.000	345.91	64
429	1.00	0.00	0.43	0.00	1.462	322.96	100
430	1.00	19.97	0.43	22.20	0.000	345.93	70
431	1.00	0.00	0.00	0.00	0.000	357.42	80
432	1.00	19.97	5.43	27.20	13.752	365.37	63
433	1.00	4.97	0.00	1.20	0.000	352.03	79
434	1.00	59.97	2.43	63.20	2.442	314.64	64
435	1.00	4.97	0.00	4.20	0.000	365.15	82
436	1.00	0.00	0.00	0.00	0.000	366.27	92
437	1.00	6.97	0.00	5.20	0.516	353.17	79
438	1.00	0.00	0.00	0.00	0.000	369.14	100
439	1.00	0.00	2.43	0.00	0.000	348.37	77
440	1.00	2.78	0.62	5.20	0.000	336.18	76
441	1.00	18.93	0.47	20.20	0.000	340.63	69
442	1.00	11.97	0.00	12.20	0.000	350.40	67

S#	TIME	CPMA	CPMB	CPMC	SIS	tSIE	LUM FLAG
443	1.00	13.97	0.00	11.20	0.000	331.04	74
444	1.00	0.00	0.00	0.00	0.000	235.54	98
445	1.00	0.00	3.43	4.20	0.000	304.57	81
446	1.00	0.00	0.03	0.00	0.000	324.13	88
447	1.00	17.66	3.74	22.20	5.498	362.36	71
448	1.00	23.15	0.25	24.20	0.000	270.78	69
449	1.00	16.25	0.00	16.20	0.000	350.25	64
450	1.00	2.10	0.00	0.00	0.000	284.78	85
451	1.00	0.00	1.87	0.00	0.000	358.31	82
452	1.00	0.00	2.43	0.00	0.748	370.49	85
453	1.00	0.00	0.00	0.00	0.000	353.16	94
454	1.00	0.00	1.86	0.00	0.000	329.16	85
455	1.00	3.97	0.00	0.20	0.000	342.62	68
456	1.00	0.00	1.43	0.00	0.000	356.50	87
457	1.00	5.41	2.99	6.20	0.000	363.17	61
458	1.00	7.80	0.00	5.20	0.990	336.92	77

461	1.00	1.74	0.00	2.20	0.000	335.06	75
462	1.00	13.97	1.43	16.20	37.112	358.69	65
463	1.00	6.22	0.00	7.20	0.000	349.33	64
464	1.00	21.97	2.43	25.20	10.398	368.73	52
465	1.00	0.00	0.00	0.00	0.000	363.24	76
466	1.00	3.97	0.00	7.20	0.000	347.62	73
467	1.00	0.00	2.43	0.00	0.000	349.77	82
468	1.00	93.97	0.00	90.20	3.908	361.27	33
469	1.00	15.97	0.00	15.20	0.000	373.45	63
470	1.00	0.00	1.43	0.00	12.373	355.41	98
471	1.00	2.97	0.00	8.20	0.000	346.96	75
472	1.00	5.85	0.55	9.20	0.000	367.98	69
473	1.00	0.00	0.43	0.00	0.000	331.94	81
474	1.00	0.00	5.43	0.00	0.000	338.35	100
475	1.00	15.97	2.43	16.20	121.18	339.35	55
476	1.00	12.97	3.43	13.20	0.000	341.15	52
477	1.00	76.48	0.00	75.20	3.958	357.10	35
478	1.00	7.97	4.43	13.20	1.438	338.75	69
479	1.00	17.97	0.00	15.20	0.000	357.07	63
480	1.00	0.00	0.00	0.00	0.000	352.03	80
481	1.00	0.00	1.43	0.00	0.000	354.12	88
482	1.00	0.00	0.00	0.00	0.000	350.50	91
483	1.00	0.97	0.43	4.20	0.000	336.00	77
484	1.00	412.29	3.11	417.20	7.500	351.29	14
485	1.00	5.97	0.00	4.20	0.000	338.35	78
486	1.00	1.97	0.00	0.00	0.000	315.89	76
487	1.00	10.43	0.00	8.20	0.000	326.02	71
488	1.00	0.00	1.43	0.00	0.000	354.37	78
489	1.00	14.97	0.00	18.20	0.000	356.74	60
490	1.00	10.98	2.42	15.20	0.552	342.07	68
491	1.00	11.97	0.00	6.20	0.000	342.45	81
492	1.00	0.24	0.00	0.00	0.000	349.92	78
493	1.00	11.97	0.00	10.20	0.000	346.10	72
494	1.00	6.97	0.00	0.00	0.000	351.75	70
495	1.00	0.00	0.43	0.00	0.000	372.24	69

S#	TIME	CPMA	CPMB	CPMC	SIS	tsIE	LUM	FLAG
496	1.00	11.97	1.43	11.20	0.000	326.31	63	
497	1.00	0.00	0.49	0.00	0.000	340.14	87	
498	1.00	0.00	0.43	0.00	0.000	366.09	79	
499	1.00	3.97	0.00	3.20	0.000	350.33	78	
500	1.00	42.37	0.00	43.20	0.523	353.63	50	
501	1.00	178.97	0.00	177.20	4.322	360.53	23	
502	1.00	6.97	4.43	8.20	41.692	369.98	65	
503	1.00	30.89	0.00	26.20	0.000	368.99	51	
504	1.00	8.97	0.00	8.20	0.000	345.59	72	
505	1.00	13.44	0.96	17.20	0.000	355.63	70	
506	1.00	165.34	7.06	173.20	6.660	317.89	28	
507	1.00	33.24	5.16	37.20	21.148	349.82	39	
508	1.00	0.00	3.43	0.00	0.000	330.78	70	
509	1.00	6.72	0.68	8.20	0.000	364.04	60	
510	1.00	3.13	0.00	0.20	0.000	346.75	75	
511	1.00	11.97	2.43	14.20	0.000	330.16	63	
512	1.00	9.97	3.43	13.20	0.000	343.45	48	
513	1.00	23.97	0.00	25.20	0.000	352.52	55	
514	1.00	0.00	0.00	0.00	0.000	368.69	84	
515	1.00	0.00	0.00	2.20	0.000	359.22	72	
516	1.00	3.92	0.48	3.20	0.000	369.93	64	
517	1.00	0.00	4.51	4.20	6.632	369.09	76	

517	1.00	07.77	0.00	02.20	0.000	317.04	00
520	1.00	15.97	1.43	16.20	0.062	329.52	74
521	1.00	4.97	0.00	0.00	0.000	339.67	82
522	1.00	0.00	2.29	0.00	0.000	373.49	88
523	1.00	7.95	0.45	7.20	0.000	370.79	58
524	1.00	2.70	0.00	1.20	0.000	363.55	71
525	1.00	0.00	1.55	0.00	97.103	367.87	90
526	1.00	0.00	0.43	0.00	0.000	359.52	82
527	1.00	9.97	0.00	9.20	0.000	346.68	67
528	1.00	30.97	0.00	28.20	0.000	346.55	57
529	1.00	0.00	0.43	0.00	0.000	381.63	72
530	1.00	0.00	2.54	0.00	0.000	338.51	94
531	1.00	263.57	427.83	695.20	40.934	367.76	9
532	1.00	6.94	2.46	10.20	0.000	340.99	64
533	1.00	64.50	170.90	236.20	47.526	356.88	21
534	1.00	0.00	1.53	0.00	0.000	309.26	80
535	1.00	1.28	0.12	6.20	20.500	376.14	75
536	1.00	0.00	3.43	1.20	0.000	372.69	66
537	1.00	0.00	0.43	0.00	0.000	350.29	96
538	1.00	0.00	0.00	0.00	0.000	371.46	91
539	1.00	0.00	0.00	0.00	0.000	356.98	82
540	1.00	0.00	0.43	0.00	0.000	386.93	76
541	1.00	12.97	0.00	7.20	0.000	384.48	50
542	1.00	4.97	0.00	4.20	0.000	346.82	74
543	1.00	0.00	1.43	0.00	0.000	381.14	59
544	1.00	151.97	0.00	151.20	5.787	334.18	24
545	1.00	0.00	0.00	0.00	0.000	378.39	95
546	1.00	11.97	0.00	13.20	0.000	356.39	62
547	1.00	5.97	0.00	2.20	0.000	363.41	68
548	1.00	0.00	2.43	0.00	0.000	390.99	84

S#	TIME	CPMA	CPMB	CPMC	SIS	tsIE	LUM FLAG
549	1.00	6.35	1.05	11.20	0.000	382.51	60
550	1.00	0.00	0.00	0.00	0.000	384.25	87
551	1.00	3.97	0.00	4.20	0.000	364.47	67
552	1.00	0.00	0.00	0.00	0.000	388.24	81
553	1.00	6.97	0.00	9.20	0.000	321.97	65
554	1.00	1.97	0.00	8.20	0.000	372.79	71
555	1.00	13.97	2.43	16.20	6.604	380.38	68
556	1.00	12.97	3.43	17.20	90.415	381.90	54
557	1.00	4.97	0.00	4.20	0.000	365.75	71
558	1.00	9.97	0.43	10.20	0.000	382.50	66
559	1.00	0.00	0.00	0.00	0.000	398.76	100
560	1.00	16.04	4.36	25.20	22.401	373.59	59
561	1.00	627.63	1000.70	1627.20	39.545	370.62	5
562	1.00	12.39	0.00	11.20	0.000	383.70	66
563	1.00	0.00	0.00	0.00	0.000	359.48	87
564	1.00	3341.31	23.09	3363.20	7.541	368.28	3
565	1.00	13.58	2.82	19.20	9.415	389.38	58
566	1.00	78.36	0.04	76.20	3.042	353.55	48
567	1.00	20.32	6.08	26.20	10.896	352.27	69
568	1.00	10.97	0.00	16.20	0.000	361.41	62
569	1.00	0.00	0.43	0.00	0.000	383.44	80
570	1.00	14.08	5.32	17.20	11.918	374.63	66
571	1.00	0.00	3.43	3.20	14.177	374.48	77
572	1.00	47.32	1.08	48.20	2.447	233.96	94
573	1.00	0.00	8.43	8.20	5.486	315.29	83
574	1.00	17.52	0.88	20.20	0.000	358.05	50
575	1.00	22.97	0.00	23.20	0.000	328.34	55
576	1.00	17.97	0.00	18.20	0.000	367.39	57

697	1.00	0.00	2.46	1.20	353.90	311.58	76
698	1.00	26.43	0.00	24.20	1.924	355.62	63
699	1.00	9.97	0.43	9.20	1.442	324.58	79
700	1.00	9.97	0.00	4.20	0.000	362.59	69
701	1.00	1.97	0.00	0.20	0.000	343.18	81
702	1.00	10.65	0.00	6.20	0.000	361.86	62
703	1.00	10.97	0.00	8.20	0.000	368.74	65
704	1.00	0.97	0.43	0.20	0.000	328.58	76
705	1.00	1.97	0.00	0.00	0.000	335.25	78
706	1.00	0.00	0.00	0.20	0.000	340.25	82
707	1.00	9.97	7.43	17.20	3.456	307.02	78

S#	TIME	CPMA	CPMB	CPMC	SIS	tSIE	LUM FLAG
708	1.00	0.00	0.00	0.00	0.000	362.57	85
709	1.00	2.97	2.43	4.20	0.000	332.66	66
710	1.00	0.00	1.43	2.20	0.000	263.61	79
711	1.00	2.97	3.43	6.20	3.455	310.69	75
712	1.00	0.00	5.43	0.00	17.999	343.44	96
713	1.00	11.97	7.43	19.20	41.625	328.04	55
714	1.00	5.97	0.00	3.20	0.000	280.81	66

Region A: 0.0 - 18.6 0 0.0 7.50
 Region B: 18.6 - 156 0 0.0 6.50
 Region C: 0.0 - 2000 0 0.0 19.30

Source Indicator: tSIE/AEC
 Ext Std Terminator: Count
 Rescance Correction On
 Coincidence Time(ns): 0
 Delay Before Burst(ns): 0
 Protocol Data Filename: C:\drugmet\12500\PROT.DAT
 Count Data Filename: c:\drugmet\12500\data27.063
 Spectrum Data Drive & Path: c:\kermi

S#	TIME	CPMA	CPMB	CPMC	SIS	tSIE	LUM	FLAG
1	10.00	7.50	6.50	19.30	5.953	401.67	95	B
715 2	1.00	2.02	0.00	5.70	0.000	416.55	84	
716 3	1.00	0.00	2.30	2.70	0.000	407.25	90	
717 4	1.00	14.50	0.00	11.70	0.000	401.61	83	
718 5	1.00	0.00	1.09	0.00	0.000	413.18	97	
719 6	1.00	21.50	0.00	16.70	0.000	412.03	83	
720 7	1.00	10.67	0.00	6.70	0.000	376.64	80	
721 8	1.00	107.50	0.00	100.70	0.000	403.81	46	
722 9	1.00	30.50	6.50	37.70	0.000	410.68	74	
23 10	1.00	21.63	7.37	29.70	0.000	405.04	71	
124 11	1.00	5.81	4.19	9.70	0.000	410.42	87	
25 12	1.00	27.78	1.22	27.70	0.000	409.37	72	
126 13	1.00	11.50	0.00	10.70	0.000	401.77	89	
127 14	1.00	21.50	3.50	24.70	0.000	409.72	61	
728 15	1.00	23.50	0.00	21.70	0.000	416.15	65	
129 16	1.00	11.50	1.50	11.70	0.000	414.17	81	
130 17	1.00	0.00	0.00	0.00	0.000	417.14	100	
131 18	1.00	0.00	2.50	0.00	0.000	409.94	87	
732 19	1.00	0.00	0.00	0.00	0.000	412.67	100	
733 20	1.00	33.50	1.50	36.70	0.000	410.03	64	
734 21	1.00	0.50	0.50	0.00	0.000	405.36	87	
735 22	1.00	4.73	4.85	9.70	0.000	408.14	88	
736 23	1.00	0.00	0.00	0.00	0.000	398.07	100	
737 24	1.00	13.50	0.00	12.70	0.000	373.42	67	
738 25	1.00	11.61	0.00	13.70	0.000	404.39	81	
739 26	1.00	236.07	2.93	234.70	17.988	388.53	19	
740 27	1.00	31.50	2.50	31.70	0.000	362.95	78	
741 28	1.00	61.36	62.64	123.70	0.000	399.73	27	
742 29	1.00	9.50	1.50	12.70	0.000	358.69	93	
743 30	1.00	9.57	2.43	11.70	0.000	403.21	81	
744 31	1.00	29.41	19.59	49.70	0.000	414.52	63	
745 32	1.00	7.50	0.00	4.70	0.000	397.84	78	

• ID: EQUIPMENT SURVY

12 MAY 2000 15:13

USER: Z COMMENT:
 PRESET TIME : 1.00
 DATA CALC : DL DPM H# : YES SAMPLE REPEATS: 1 PRINTER : EDIT
 COUNT BLANK : YES IC# : NO REPLICATES : 1 RS232 : EDIT
 TWO PHASE : NO ACC : YES CYCLE REPEATS : 1
 SCINTILLATOR: LIQUID LUMEX: YES LOW SAMPLE REJ: 0
 LOW LEVEL : NO HALF LIFE CORRECTION DATE: none

ISOTOPE 1: 3H %ERROR: 2.00 FACTOR: 1.000000 BKG. SUB: 0
 ISOTOPE 2: 14C %ERROR: 2.00 FACTOR: 1.000000 BKG. SUB: 0
 WIDE OPEN WINDOW %ERROR: 0.00 FACTOR: 1.000000 BKG. SUB: 0

BACKGROUND QUENCH CURVE: Off COLOR QUENCH CORRECTION: Off

Quench Limits Low: 2.756 High: 314.54

SAM NO	H#	3H CPM	14C CPM	WIDE CPM	3H DPM	14C DPM	LUMEX %
B1	91.4	21.00	7.00	32.00	40.00	9.23	2.76
716	81.8	28.00	9.00	49.00	11.07	2.58	4.76
717	81.5	75.00	11.00	98.00	103.16	4.71	2.16
718	78.1	19.00	9.00	40.00	-7.36	2.66	5.63
749	82.1	79.00	13.00	103.00	110.57	7.37	2.43
750	82.1	26.00	20.00	55.00	1.61	17.44	5.54
791	78.7	27.00	12.00	49.00	6.89	6.61	3.62

ISOTOPE 1: 3H %ERROR: 2.00 FACTOR: 1.000000 BKG. SUB: 0
 ISOTOPE 2: 14C %ERROR: 2.00 FACTOR: 1.000000 BKG. SUB: 0
 WIDE OPEN WINDOW %ERROR: 0.00 FACTOR: 1.000000 BKG. SUB: 0

BACKGROUND QUENCH CURVE: Off COLOR QUENCH CORRECTION: Off

Quench Limits Low: 2.756 High: 314.54

SAM NO	H#	3H CPM	14C CPM	WIDE CPM	3H DPM	14C DPM	LUMEX %
B1	76.3	24.00	7.00	43.00	43.03	9.13	28.70
752	71.3	25.00	10.00	43.00	-0.49	3.99	15.91

Protocol Data Filename: C:\drugmet\T2500\PROT.DAT
 Count Data Filename: c:\drugmet\f2500\sdata27.056
 Spectrum Data Drive & Path: c:\kermit

S#	TIME	CPMA	CPMB	CPMC	SIS	tSIE	LUM	FLAG
1	10.00	6.68	6.52	19.60	13.456	390.10	77	B
2	1.00	0.00	2.48	0.00	12.148	228.57	95	

copy to other sheet