

Radiological Survey Sheet

Job Location 118B/B206 Page 1 of 24

Survey Purpose LAB CLOSE OUT Date 11-9-00

Performed By E. GAILOR (Print) E. Gailor 11-9-00 (Sign)

Inst.(1) (Model/SN) Beckman LS 6500 #7069448	Inst.(2) Ludlum 2241-2 (Model/SN) # 163603	Inst.(3) (Model/SN)
Det. Internal (Model/SN)	Det. Ludlum 43-68 (Model/SN) # 149613	Det. (Model/SN)
Eff. See LSC Printout	Eff. = 88	Eff.
Type rad. β	Type rad. β	Type rad.
Bkgd. See LSC Printout	Bkgd. 300cpm	Bkgd.
Cal. Due: 12/00	Cal. Due 2/13/01	Cal. due

No.	Time	Location	Inst. Used	Total Activity (dpm/100 cm ²)
1.	6025	door & Floor ^{END} HANDL	1	See attached LSC Printout
2.		FLOOR	1	
3.		UPPER WALL	1	
4.		LOWER WALL	1	
5.		UPPER WALL	1	
6.		LOWER WALL	1	
7.		UPPER WALL	1	
8.		LOWER WALL	1	
9.		UPPER SIDE OF HOOD	1	
10.		LOWER SIDE OF HOOD	1	
11.		FLOOR	1	
12.		^{END} UPPER LEFT (SLANTED) OF HOOD	1	
13.		UPPER LOWER RIGHT (SLANTED) OF HOOD	1	
14.		UPPER LEFT OF HOOD	1	
15.		UPPER RIGHT OF HOOD	1	
16.		BOTTOM LEFT OF HOOD	1	
17.		BOTTOM RIGHT OF HOOD	1	
18.		BOTTOM LEFT VENT	1	

Radiological Survey Continuation Sheet

Page 2 of 24

Date 11-9-00

No.	Time	Location	Inst. Used	Total Activity (dpm/100 cm ²)
19	1025	BOTTOM RIGHT VENT	1	See attached LSC Printout
20		TOP LEFT VENT OF HOOD	1	
21		TOP RIGHT VENT OF HOOD	1	
22		BOTTOM LEFT OF HOOD	1	✓ (See # 355)
23		BOTTOM RIGHT OF HOOD	1	✗ (See # 356)
24		LEFT SIDE OF HOOD	1	
25		RIGHT SIDE OF HOOD	1	
26		INSIDE RIGHT CABINET	1	
27		RIGHT CAB. DOORS & HANDLES	1	
28		INSIDE LEFT CABINET	1	
29		LEFT CAB. DOORS & HANDLES	1	
30		FLOOR	1	
31		WALL	1	
32		TOP SHELF	1	
33		2ND "	1	
34		3RD "	1	
35		BOTTOM "	1	
36		CAB. DOORS & HANDLES	1	
37		" " "	1	
38		TOP SHELF	1	
39		2ND "	1	
40		3RD "	1	
41		BOTTOM "	1	
42		LEDGE	1	
43		SHELF	1	✓
44		SHELF	1	
45		TOP SHELF	1	
46		MIDDLE SHELF	1	↓

Radiological Survey Continuation Sheet

Page 3 of 24

Date 11-9-08

No.	Time	Location	Inst. Used	Total Activity (dpm/100 cm ²)
47	1025	BOTTOM SHELF	1	See attached LSC Printout
48		DESK	1	
49		DRAWERS & HANDLS	1	
50		TOP DRAWER	1	
51		MIDDLE "	1	
52		BOTTOM "	1	
53		DRAWER & HWDL	1	
54		INSIDE DRAWER	1	
55		TOP SHELF	1	
56		MIDDLE SHELF	1	✓ (See #357)
57		BOTTOM "	1	
58		TOP SHELF	1	
59		MIDDLE "	1	✓ (See #358)
60		BOTTOM "	1	
61		COUNTER TOPS	1	
62		CUP	1	
63		COUNTER	1	
64		CUP	1	
65		FLOOR	1	
66		FLOOR	1	
67		FLOOR	1	
68		DRAWERS & HANDLS	1	
69		TOP DRAWER	1	
70		2ND "	1	
71		3RD "	1	
72		BOTTOM "	1	
73		DRAWERS & HANDLS	1	
74	✓	TOP DRAWER	1	

Radiological Survey Continuation Sheet

Page 4 of 24

Date 11-9-00

No.	Time	Location	Inst. Used	Total Activity (dpm/100 cm ²)
75	1025	2ND DRAWER	1	See attached LSC Printout
76	↑	3RD "	1	
77		BOTTOM "	1	
78		DRAWER & HNDL	1	
79		DRAWER	1	
80		DRAWERS & HNDLS	1	
81		TOP DRAWER	1	
82		2ND "	1	
83		3RD "	1	
84		BOTTOM "	1	
85		DRAWERS & HNDLS	1	
86		TOP DRAWER	1	
87		2ND "	1	
88		3RD "	1	
89		BOTTOM "	1	
90		COUNTER	1	
91		COUNTER	1	
92		COUNTER	1	
93		COUNTER	1	
94		COUNTER	1	
95		DESK	1	
96		DRAWER & HNDL (TOP)	1	
97		DRAWER (TOP)	1	
98		CAB door & HNDLS	1	
99		CAB.	1	
100		DRAWERS & HNDLS	1	
101		TOP DRAWER	1	
102	↓	2ND "	1	↓

Radiological Survey Continuation Sheet

Page 5 of 24

Date 11-9-00

No.	Time	Location	Inst. Used	Total Activity (dpm/100 cm ²)
103	1025	3rd DRAWER	1	See attached LSC Printout
104		BOTTOM "	1	
105		DRAWER & HNDL	1	
106		DRAWER	1	
107		DRAWERS & HNDLS	1	
108		TOP DRAWER	1	
109		2nd "	1	
110		3rd "	1	
111		BOTTOM "	1	
112		DRAWER & HNDL	1	
113		DRAWER	1	
114		DRAWERS & HNDLS	1	
115		TOP DRAWER	1	
116		middle "	1	
117		BOTTOM "	1	
118		DOORS & HNDLS	1	
119		TOP SHELF	1	
120		2nd "	1	
121		3rd "	1	
122		BOTTOM "	1	
123		CHAIR	1	
124		SHELF	1	
125		TOP SHELF	1	
126		middle "	1	
127		BOTTOM "	1	
128		DOORS & HNDLS	1	
129		TOP SHELF	1	
130		2nd "	1	

Radiological Survey Continuation Sheet

Page 6 of 24

Date 0 11-9-00

No.	Time	Location	Inst. Used	Total Activity (dpm/100 cm ²)
121	1025	3RD SHELF	1	See attached LSC Printout
132		BOTTOM "	1	
133		DOORS & HANDLS	1	
134		TOP SHELF	1	
135		2ND "	1	
136		3RD "	1	
137		BOTTOM "	1	
138		DOORS & HANDLS	1	
139		TOP SHELF	1	
140		2ND "	1	
141		3RD "	1	
142		BOTTOM "	1	
143		LEDGE	1	
144		TOP SHELF	1	
145		2ND "	1	
146		DESK	1	
147		DRAWERS & HANDLS	1	
148		TOP DRAWER	1	
149		2ND "	1	
150		BOTTOM "	1	
151		DRAWER & HANDL	1	
152		DRAWER	1	
153		CUP	1	
154		CUP	1	
155		TOP SHELF	1	✓ (See # 355)
156		2ND "	1	
157		BOTTOM "	1	✓ (See # 360)
158	✓	TOP SHELF	1	✓ (See # 361)

Radiological Survey Continuation Sheet

Page 7 of 24

Date 11-9-00

No.	Time	Location	Inst. Used	Total Activity (dpm/100 cm ²)
159	1025	2ND SHLF	1	See attached LSC Printout (see #362)
160		BOTTOM "	1	
161		COUNTER	1	(see #33)
162		COUNTER	1	
163		COUNTER	1	
164		COUNTER	1	
165		DRAWERS & HANDLS	1	
166		TOP DRAWER	1	
167		2ND "	1	
168		3RD "	1	
169		BOTTOM "	1	
170		DRAWERS & HANDLS	1	
171		TOP DRAWER	1	
172		2ND "	1	
173		3RD "	1	
174		BOTTOM "	1	
175		DRAWER & HANDL	1	
176		DRAWER	1	
177		CHAIR	1	
178		DRAWERS & HANDLS	1	
179		TOP DRAWER	1	
180		2ND "	1	
181		3RD "	1	
182		BOTTOM "	1	
183		FLOOR	1	
184		FLOOR	1	
185		FLOOR	1	
186	✓	COUNTER	1	

Radiological Survey Continuation Sheet

Page 8 of 24

Date 11-9-00

No.	Time	Location	Inst. Used	Total Activity (dpm/100 cm ²)
187	1025	COUNTER	1	See attached LSC Printout
188		COUNTER	1	
189		TOP DRAWER & HNDL	1	
190		TOP DRAWER	1	
191		CAB. DOORS & HNDL	1	
192		TOP SHELF OF CAB	1	
193		BOTTOM " " "	1	
194		DRAWER & HNDL	1	
195		DRAWER	1	(See # 365)
196		DRAWERS & HNDLS	1	
197		TOP DRAWER	1	
198		2ND "	1	
199		3RD "	1	
200		BOTTOM "	1	
201		TOP SHELF	1	(See # 366)
202		MIDDLE SHELF	1	
203		BOTTOM "	1	
204		DESK	1	
205		SHELF	1	
206		LEDGE	1	
207		DRAWER & HNDL	1	
208		DRAWER	1	
209		DRAWERS & HNDL	1	
210		TOP DRAWER	1	
211		2ND "	1	
212		BOTTOM "	1	
213		UPPER WALL	1	
214		LOWER WALL	1	

(See # 36)

Radiological Survey Continuation Sheet

Page 9 of 24

Date 11-9-00

No.	Time	Location	Inst. Used	Total Activity (dpm/100 cm ²)
215	1025	FLOOR	1	See attached LSC Printout
216		FLOOR	1	
217		FLOOR	1	
218		DESK	1	
219		FLOOR	1	
220		TOP SHELF	1	
221		2ND "	1	
222		3RD "	1	
223		4TH "	1	
224		5TH "	1	
225		BOTTOM "	1	
226		CAB. door S & HNDL	1	
227		TOP DRAWER	1	
228		2ND "	1	
229		3RD "	1	
230		4TH "	1	
231		BOTTOM "	1	
232		UPPER WALL	1	
233		LOWER WALL	1	
234		FLOOR	1	✓ (See # 367)
235		FLOOR	1	✓ (See # 368)
236		WALL	1	
237		TABLE TOP	1	
238		CAB. TOP	1	
239		TABLE TOP	1	
240		FLOOR	1	
241		DRAWERS & HNDLS	1	
242	✓	TOP DRAWER	1	✓

Radiological Survey Continuation Sheet

Page 10 of 24

Date 11-9-00

No.	Time	Location	Inst. Used	Total Activity (dpm/100 cm ²)
243	1025	2ND DRAWER	1	See attached LSC Printout
244	↑	3RD "	1	
245		BOTTOM "	1	
246		DRAWER & HNDL	1	
247		DRAWER	1	
248		CAB. DOORS & HNDLS	1	
249		TOP DRAWER	1	
250		BOTTOM DRAWER	1	
251		FLOOR	1	
252		FLOOR	1	
253		COUNTER	1	
254		FLOOR	1	
255		DRAWER & HNDL	1	
256		DRAWER	1	
257		DRAWERS & HNDLS	1	
258		TOP DRAWER	1	
259		2ND "	1	
260		3RD "	1	
261		BOTTOM "	1	
262		COUNTER	1	
263		COUNTER	1	
264		COUNTER	1	
265		COUNTER	1	
266		TOP DRAWER & HNDL	1	
267		TOP DRAWER	1	
268		CAB. DOORS & HNDL	1	
269		TOP SHELF OF CAB.	1	
270		BOTTOM " " "	1	

Radiological Survey Continuation Sheet

Page 11 of 24

Date 11-9-00

No.	Time	Location	Inst. Used	Total Activity (dpm/100 cm ²)
271	1025	TOP RIGHT DRAWER & HNDL	1	See attached LSC Printout
272		" " "	1	
273		TOP LEFT " & "	1	
274		" " "	1	
275		CAB. DOORS & HNDLS	1	
276		INSIDE CAB	1	
277		FLOOR	1	
278		WALL	1	
279		UPPER WALL	1	
280		LOWER WALL	1	
281		UPPER WALL	1	
282		LOWER "	1	
283		UPPER "	1	
284		LOWER "	1	
285		FLOOR	1	
286		"	1	
287		"	1	
288		"	1	
289		UPPER WALL	1	
290		LOWER "	1	
291		FLOOR	1	
292		FLOOR	1	
293		CHAIR	1	
294		"	1	
295		"	1	
296		"	1	
297		"	1	
298	✓	FLOOR	1	

Radiological Survey Continuation Sheet

Page 12 of 24

Date 11-9-00

No.	Time	Location	Inst. Used	Total Activity (dpm/100 cm ²)
299	1025	DRAWERS & HANDLS	1	See attached LSC Printout
300		TOP DRAWER	1	
301		2ND "	1	
302		3RD "	1	
303		4TH "	1	
304		BOTTOM ^{EA} TOP DRAWERS & HANDLS	1	
305		TOP DRAWER	1	
306		2ND "	1	
307		3RD "	1	
308		4TH "	1	
309		SIDE OF BENCHES	1	
310		FLOOR	1	
311		FLOOR	1	
312		UPPER WALL	1	
313		LOWER "	1	
314		SIDE OF SINK	1	
315		TOP SHELF	1	
316		MIDDLE "	1	
317		BOTTOM "	1	
318		BOARD BEHIND SINK	1	
319		BEHIND SINK	1	
320		INSIDE SINK	1	
321		CAB. DOORS & HANDLS	1	
322		RIGHT SIDE OF CAB.	1	
323		LEFT " " "	1	
324		FLOOR	1	
325		SIDE OF BENCHES	1	
326		COUNTER	1	

Radiological Survey Continuation Sheet

Page 13 of 24

Date 11-9-00

No.	Time	Location	Inst. Used	Total Activity (dpm/100 cm ²)
327	1025	CUP	1	See attached LSC Printout
328		COUNTER	1	
329		COUNTER	1	
330		WALL	1	
331		CAB. doors & HANDLS	1	
332		TOP SHELF	1	
333		2ND "	1	
334		3RD "	1	
335		BOTTOM "	1	
336		CAB. door ^s & HANDLS	1	
337		TOP SHELF	1	
338		2ND "	1	
339		3RD "	1	
340		BOTTOM SHELF	1	
341		ED TOP SHELF DRAWERS & HANDLS	1	
342		ED 2ND " TOP DRAWER	1	
343		ED 3RD " 2ND "	1	
344		ED BOTTOM SHELF 3RD "	1	✓ (See #369)
345		BOTTOM "	1	
346		DRAWER & HANDL	1	
347		DRAWER	1	
348		CAB. DRAWERS & HANDLS	1	
349		TOP DRAWER	1	
350		2ND "	1	
351		3RD "	1	
352		BOTTOM "	1	
353		PA PLASTIC TRAY	1	
354	✓	FLOOR	1	✓

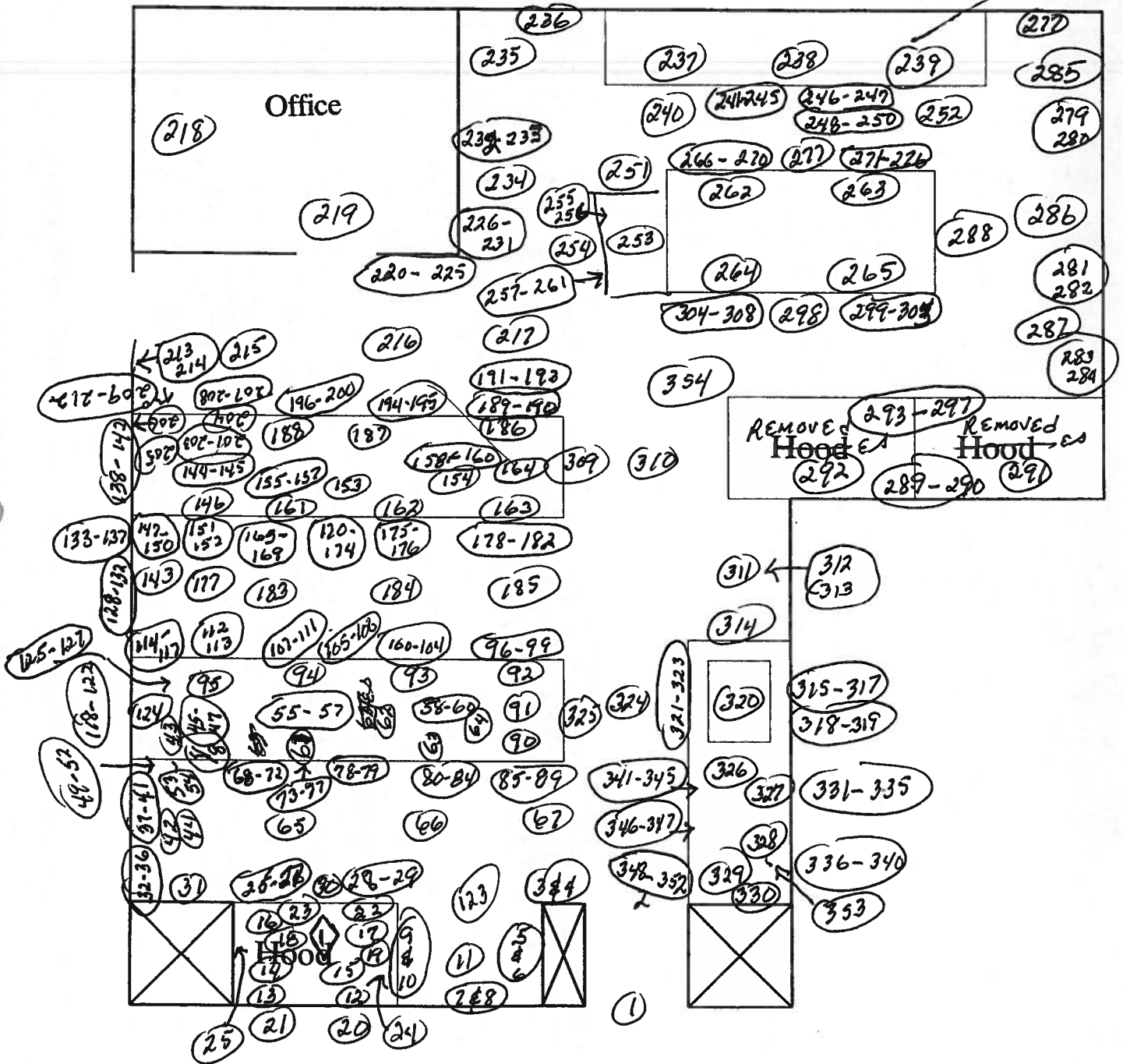

Surveyed 100% of lower surfaces using instrument #2. All surfaces surveyed were noted to be at normal background levels, with the following exceptions:

- 1 Hood center contaminated to a level of 3409 cpm (38,863 dpm/100 cm²). Decontaminated to a fixed level of ~~1613~~ 1613 dpm/100 cm².

ID: EQUIPMENT SURVY

9 NOV 2000 13:44

USER: 1 COMMENT: EQUIPMENT SURVEY

RESET TIME : 1.00
 DATA CALC : DL DPM H# : YES SAMPLE REPEATS: 1 PRINTER : EDIT
 COUNT BLANK : YES IC# : NO REPLICATES : 1 RS232 : EDIT
 TWO PHASE : NO ADC : YES CYCLE REPEATS : 1
 SCINTILLATOR: LIQUID LUMEX: YES LOW SAMPLE REJ: 0
 LOW LEVEL : NO HALF LIFE CORRECTION DATE: none

ISOTOPE 1: 3H %ERROR: 2.00 FACTOR: 1.0000 BKG. SUB: 0
 ISOTOPE 2: 14C %ERROR: 2.00 FACTOR: 1.0000 BKG. SUB: 0
 WIDE OPEN WINDOW %ERROR: 0.00 FACTOR: 1.0000 BKG. SUB: 0

BACKGROUND QUENCH CURVE: Off COLOR QUENCH CORRECTION: Off

Quench Limits Low: 13.688 High: 306.34

SAM NO	H#	3H CPM	14C CPM	WIDE CPM	3H DPM	14C DPM	LUMEX %	
B1	89.2	21.00	8.00	39.00	42.94	10.40	3.34	
		Blank Average	DPM	for	3H :	42.94	COEF. OF VAR:	0.000
		Blank Average	DPM	for	14C :	10.40	COEF. OF VAR:	0.000
1	72.9	13.00	7.00	27.00	-19.42	-1.27	3.02	
2	81.8	31.00	12.00	55.00	18.02	5.17	3.78	
3	77.5	31.00	14.00	56.00	15.72	7.82	1.43	
4	79.4	23.00	11.00	43.00	0.67	3.95	1.90	
5	78.8	27.00	8.00	48.00	10.63	-0.14	6.36	
6	74.6	18.00	5.00	29.00	-7.75	-4.02	3.30	
7	75.6	13.00	12.00	36.00	-21.67	5.43	1.44	
8	79.8	6.00	17.00	31.00	-38.89	12.28	2.60	
9	76.3	27.00	7.00	48.00	10.51	-1.48	1.15	
10	80.0	18.00	11.00	35.00	-9.96	4.04	2.18	
11	127.3	21.00	9.00	38.00	10.18	1.50	6.50	
12	77.9	24.00	13.00	46.00	1.44	6.60	2.84	
13	77.7	25.00	7.00	42.00	6.63	-1.45	1.76	
14	84.3	18.00	11.00	35.00	-9.26	4.06	5.85	
15	82.9	18.00	11.00	43.00	-9.49	4.05	1.38	
16	84.7	17.00	17.00	41.00	-14.60	12.14	1.83	
17	88.4	34.00	6.00	51.00	30.06	-2.92	1.92	
18	99.3	40.00	14.00	65.00	44.13	7.80	5.24	
19	86.5	44.00	11.00	62.00	48.89	3.62	1.85	
20	82.2	22.00	9.00	43.00	0.14	1.30	2.55	
21	85.6	24.00	6.00	37.00	6.92	-2.75	2.50	
22	83.4	58.00	18.00	89.00	74.36	12.77	1.24	
23	80.9	4666.00	50.00	4723.00	10010.62	-21.92	0.03	
24	78.8	16.00	6.00	30.00	-11.83	-2.63	6.63	
25	81.6	36.00	12.00	56.00	28.78	5.08	1.97	
26	83.4	22.00	12.00	43.00	-1.18	5.33	1.27	
27	78.9	44.00	10.00	64.00	46.01	2.26	0.68	
28	79.5	21.00	11.00	39.00	-3.60	3.98	1.30	
29	77.8	31.00	13.00	51.00	16.31	6.48	0.81	
30	84.1	20.00	3.00	32.00	-0.64	-6.72	2.11	
31	76.7	16.00	12.00	39.00	-15.21	5.39	1.12	
32	78.2	24.00	14.00	51.00	1.01	7.94	0.84	
33	81.2	19.00	7.00	38.00	-5.51	-1.34	1.94	
34	81.0	22.00	13.00	49.00	-2.19	6.66	1.34	
35	84.2	8.00	5.00	22.00	-28.04	-3.83	0.65	
36	85.5	24.00	12.00	62.00	3.68	5.31	2.09	

SAM NO	H#	3H CPM	14C CPM	WIDE CPM	3H DPM	14C DPM	LUMEX %
38	77.8	21.00	7.00	37.00	-1.87	-1.38	1.32
39	78.0	19.00	8.00	33.00	-6.60	-0.01	1.61
40	81.2	22.00	9.00	41.00	-0.06	1.29	1.32
41	82.7	20.00	11.00	39.00	-5.16	4.02	1.43
42	80.5	17.00	7.00	36.00	-9.94	-1.31	0.99
43	79.9	20.00	10.00	36.00	-5.15	2.66	1.73
44	80.4	15.00	8.00	29.00	-14.80	0.07	1.62
45	77.7	12.00	15.00	41.00	-25.13	9.48	1.41
46	78.0	28.00	9.00	41.00	12.04	1.18	1.21
47	80.0	12.00	7.00	30.00	-20.78	-1.22	1.45
48	78.6	27.00	9.00	46.00	10.07	1.20	1.63
49	80.5	14.00	9.00	31.00	-17.46	1.43	1.67
50	80.7	13.00	4.00	26.00	-16.99	-5.26	3.03
51	80.6	18.00	11.00	39.00	-9.86	4.04	1.74
52	83.2	22.00	13.00	42.00	-1.76	6.67	1.34
53	82.0	20.00	13.00	49.00	-6.34	6.70	2.08
54	79.0	14.00	14.00	38.00	-20.22	8.12	1.25
55	81.1	17.00	8.00	29.00	-10.37	0.04	1.49
56	85.6	25.00	14.00	51.00	4.82	7.98	0.98
57	97.8	86.00	7.00	105.00	156.07	-2.54	1.25
58	98.5	33.00	11.00	59.00	28.89	3.87	4.97
59	92.9	33.00	13.00	59.00	25.61	6.54	1.96
60	119.7	65.00	16.00	94.00	121.45	10.09	2.80
61	92.4	46.00	14.00	64.00	54.67	7.66	3.08
62	81.9	22.00	11.00	38.00	-0.97	3.98	3.11
63	86.0	17.00	8.00	35.00	-9.57	0.06	1.79
64	79.2	30.00	10.00	51.00	16.13	2.49	1.06
65	86.4	15.00	8.00	29.00	-13.95	0.09	3.37
66	82.3	20.00	13.00	47.00	-6.30	6.70	1.54
67	85.0	14.00	10.00	33.00	-17.42	2.79	1.86
68	83.2	30.00	6.00	48.00	19.44	-2.86	1.75
69	82.7	14.00	6.00	32.00	-15.60	-2.59	1.73
70	79.0	20.00	8.00	40.00	-4.28	-0.02	1.60
71	79.9	19.00	10.00	38.00	-7.31	2.68	1.38
72	79.5	17.00	3.00	25.00	-8.02	-6.67	2.41
73	83.8	23.00	8.00	35.00	3.21	-0.05	1.38
74	84.0	18.00	11.00	40.00	-9.30	4.06	1.14
75	81.3	22.00	10.00	43.00	-0.56	2.64	0.88
76	81.2	22.00	7.00	41.00	0.98	-1.39	1.29
77	88.1	28.00	14.00	51.00	12.15	7.95	1.27
78	87.8	22.00	7.00	44.00	2.45	-1.37	1.85
79	81.3	18.00	9.00	37.00	-8.70	1.36	1.34
80	82.1	14.00	14.00	39.00	-19.90	8.14	1.21
81	81.3	23.00	10.00	52.00	1.60	2.62	1.14
82	76.4	26.00	15.00	51.00	4.36	9.23	1.08
83	83.8	22.00	8.00	38.00	1.02	-0.04	1.54
84	80.2	29.00	21.00	59.00	8.53	17.26	0.81
85	81.8	19.00	13.00	37.00	-8.55	6.71	0.93
86	83.3	19.00	6.00	35.00	-4.58	-2.67	2.09
87	88.0	14.00	12.00	42.00	-18.13	5.50	1.61
88	79.6	17.00	10.00	35.00	-11.64	2.71	2.06
89	84.2	13.00	13.00	33.00	-21.32	6.83	1.31
90	81.5	22.00	12.00	44.00	-1.57	5.32	1.11
91	83.5	13.00	8.00	32.00	-18.75	0.12	1.34
92	93.9	24.00	8.00	38.00	8.00	-0.04	2.84
93	83.6	20.00	8.00	37.00	-3.40	-0.00	1.37
94	80.6	16.00	12.00	41.00	-14.70	5.41	1.11
95	82.1	15.00	12.00	32.00	-16.66	5.44	3.21

SAM NO	H#	3H CPM	14C CPM	WIDE CPM	3H DPM	14C DPM	LUMEX %
95	83.9	20.00	10.00	34.00	-4.41	2.68	2.78
96	81.5	34.00	10.00	61.00	25.47	2.43	0.63
97	85.4	24.00	11.00	48.00	4.18	3.97	1.70
98	87.3	22.00	8.00	45.00	1.80	-0.02	2.04
99	83.0	10.00	7.00	27.00	-24.82	-1.18	2.53
100	82.5	17.00	16.00	39.00	-14.38	10.78	1.07
101	90.8	13.00	8.00	31.00	-19.06	0.10	1.62
102	81.1	20.00	11.00	40.00	-5.47	4.01	0.90
103	84.6	18.00	10.00	41.00	-8.67	2.72	1.24
104	84.0	31.00	9.00	47.00	20.26	1.15	1.21
105	82.9	29.00	8.00	47.00	16.09	-0.16	0.76
106	82.4	28.00	8.00	52.00	13.77	-0.14	1.08
107	81.6	20.00	10.00	37.00	-4.84	2.67	1.11
108	78.3	23.00	14.00	46.00	-1.11	7.96	1.25
109	81.5	17.00	9.00	32.00	-10.84	1.38	1.54
110	80.0	23.00	14.00	45.00	-0.76	7.97	1.31
111	82.0	20.00	8.00	37.00	-3.71	-0.01	1.53
112	78.8	24.00	6.00	37.00	5.27	-2.77	1.25
113	85.8	21.00	5.00	41.00	0.86	-4.05	5.11
114	85.4	14.00	10.00	32.00	-17.37	2.80	2.34
115	81.5	19.00	11.00	41.00	-7.55	4.03	1.17
116	83.4	13.00	6.00	25.00	-17.69	-2.57	1.68
117	87.9	17.00	11.00	43.00	-10.88	4.10	0.97
118	82.6	24.00	7.00	40.00	5.64	-1.42	1.08
119	84.1	25.00	12.00	50.00	5.55	5.29	1.20
120	81.9	21.00	11.00	41.00	-3.13	4.00	1.05
121	80.3	21.00	10.00	38.00	-2.93	2.65	2.99
122	83.9	28.00	9.00	47.00	13.65	1.20	2.23
123	86.3	16.00	14.00	34.00	-14.98	8.14	1.18
124	85.4	19.00	18.00	49.00	-10.63	13.46	1.10
125	85.0	32.00	13.00	52.00	20.65	6.51	1.14
126	78.8	20.00	8.00	36.00	-4.32	-0.02	0.96
127	88.1	10.00	6.00	25.00	-23.80	-2.50	4.91
128	79.6	16.00	4.00	29.00	-10.68	-5.31	1.16
129	89.1	34.00	15.00	59.00	25.42	9.20	1.06
130	83.9	24.00	11.00	43.00	3.82	3.96	1.37
131	84.6	22.00	11.00	46.00	-0.41	4.00	0.95
132	89.4	23.00	14.00	46.00	1.25	8.05	1.33
133	82.7	21.00	7.00	37.00	-0.87	-1.37	1.49
134	89.0	19.00	13.00	40.00	-7.29	6.77	1.51
135	83.7	17.00	8.00	31.00	-9.96	0.05	2.01
136	86.8	16.00	11.00	41.00	-13.29	4.11	2.59
137	86.9	20.00	14.00	44.00	-6.00	8.08	3.12
138	80.4	16.00	10.00	38.00	-13.68	2.73	2.00
139	84.8	20.00	14.00	41.00	-6.37	8.06	0.94
140	84.9	30.00	11.00	48.00	17.28	3.86	1.19
141	82.6	24.00	7.00	47.00	5.64	-1.42	0.92
142	83.2	26.00	15.00	53.00	5.92	9.29	0.74
143	86.1	25.00	17.00	59.00	3.34	12.02	1.60
144	90.5	20.00	11.00	49.00	-3.65	4.07	2.20
145	88.4	26.00	7.00	46.00	11.57	-1.44	2.80
146	88.0	17.00	2.00	44.00	-5.97	-8.01	1.58
147	86.0	18.00	10.00	43.00	-8.44	2.73	1.45
148	82.7	26.00	8.00	45.00	9.51	-0.11	1.37
149	83.3	19.00	13.00	43.00	-8.29	6.73	0.83
150	81.2	20.00	9.00	38.00	-4.39	1.33	1.63
151	84.1	31.00	6.00	48.00	21.90	-2.88	0.90
152	82.8	18.00	13.00	37.00	-10.57	6.74	1.60

SAM NO	H#	3H CPM	14C CPM	WIDE CPM	3H DPM	14C DPM	LUMEX %
153	91.5	15.00	11.00	40.00	-14.85	4.16	1.91
154	89.4	30.00	9.00	50.00	19.80	1.19	1.02
✓ 155	99.7	132.00	11.00	153.00	265.64	1.99	0.70
156	89.7	26.00	12.00	52.00	9.18	5.30	1.18
✓ 157	105.0	75.00	16.00	101.00	131.92	9.86	1.55
✓ 158	97.2	74.00	10.00	94.00	125.41	1.74	1.21
✓ 159	105.3	135.00	24.00	165.00	275.18	19.55	0.72
✓ 160	90.9	79.00	10.00	101.00	131.14	1.66	1.49
161	80.3	16.00	9.00	41.00	-13.18	1.39	0.74
162	81.0	23.00	10.00	44.00	1.53	2.62	0.98
163	86.6	18.00	15.00	44.00	-11.04	9.46	2.89
164	83.6	30.00	12.00	61.00	16.37	5.20	1.12
165	88.2	15.00	13.00	43.00	-16.40	6.83	2.16
166	90.5	19.00	17.00	54.00	-9.24	12.17	1.34
167	86.8	36.00	7.00	56.00	33.38	-1.62	3.47
168	81.9	21.00	9.00	44.00	-2.10	1.31	0.91
169	82.4	28.00	8.00	44.00	13.76	-0.14	1.13
170	86.8	23.00	12.00	47.00	1.76	5.34	0.75
171	80.9	15.00	6.00	31.00	-13.68	-2.61	0.54
172	82.6	18.00	6.00	33.00	-6.89	-2.66	1.19
173	86.0	21.00	9.00	37.00	-1.26	1.33	1.04
174	84.8	13.00	5.00	29.00	-16.98	-3.91	1.24
175	82.1	16.00	10.00	35.00	-13.44	2.74	1.05
176	89.1	20.00	7.00	35.00	-1.74	-1.33	1.50
177	89.4	23.00	8.00	35.00	4.54	-0.04	1.61
178	85.0	26.00	8.00	41.00	10.09	-0.10	37.72
179	91.8	17.00	8.00	33.00	-8.56	0.08	1.61
180	89.2	18.00	14.00	46.00	-10.07	8.13	0.78
181	86.2	22.00	12.00	41.00	-0.61	5.35	0.88
182	94.4	28.00	10.00	58.00	16.27	2.59	1.81
183	89.4	27.00	17.00	62.00	8.62	12.02	1.44
184	88.2	21.00	13.00	45.00	-2.97	6.73	0.86
185	91.4	20.00	9.00	39.00	-2.35	1.37	1.56
186	87.6	21.00	7.00	42.00	0.19	-1.35	1.06
✓ 187	88.5	104.00	10.00	118.00	185.09	1.23	0.36
188	86.2	35.00	5.00	49.00	32.02	-4.29	0.63
189	89.6	27.00	16.00	51.00	9.23	10.67	2.10
190	97.3	23.00	11.00	42.00	4.86	4.05	1.00
191	89.6	16.00	13.00	36.00	-13.97	6.83	2.72
192	97.9	9.00	7.00	27.00	-25.73	-1.10	2.41
193	96.7	22.00	5.00	32.00	5.80	-4.05	1.33
194	89.1	30.00	11.00	49.00	18.60	3.88	1.17
✓ 195	90.3	110.00	15.00	134.00	198.04	7.85	0.24
196	88.4	14.00	10.00	31.00	-16.98	2.81	1.29
197	104.8	23.00	6.00	32.00	9.94	-2.70	0.94
198	92.5	18.00	7.00	32.00	-5.58	-1.28	0.96
199	90.3	22.00	9.00	41.00	1.95	1.33	0.93
200	92.3	24.00	6.00	38.00	8.68	-2.74	1.56
✓ 201	101.9	75.00	17.00	103.00	128.18	11.21	0.69
202	87.1	30.00	10.00	46.00	18.50	2.53	1.58
203	93.1	35.00	9.00	49.00	32.51	1.11	2.43
204	95.4	32.00	9.00	48.00	26.47	1.17	1.87
205	86.8	27.00	13.00	52.00	10.12	6.61	1.12
206	97.0	28.00	14.00	48.00	14.82	8.02	1.78
207	82.9	17.00	15.00	43.00	-13.78	9.44	1.11
208	85.4	24.00	9.00	47.00	5.26	1.28	1.38
209	82.8	24.00	5.00	39.00	6.74	-4.10	1.31
210	83.6	29.00	5.00	42.00	17.91	-4.19	1.49

SAM NO	H#	3H CPM	14C CPM	WIDE CPM	3H DPM	14C DPM	LUMEX %
211	81.4	26.00	10.00	45.00	8.11	2.57	2.11
212	82.7	40.00	7.00	57.00	40.52	-1.69	0.78
213	81.0	19.00	12.00	42.00	-8.17	5.37	0.94
214	80.6	16.00	9.00	37.00	-13.13	1.39	0.99
215	85.4	15.00	14.00	38.00	-17.31	8.15	1.83
216	84.4	21.00	10.00	37.00	-2.11	2.67	1.33
217	86.5	17.00	11.00	34.00	-11.11	4.09	1.31
218	78.4	19.00	12.00	43.00	-8.59	5.35	1.01
219	89.0	22.00	11.00	38.00	0.55	4.02	1.53
220	80.1	18.00	5.00	33.00	-6.82	-4.00	1.80
221	82.3	20.00	13.00	41.00	-6.28	6.70	1.16
222	83.1	26.00	8.00	47.00	9.60	-0.11	1.39
223	84.4	20.00	13.00	46.00	-5.91	6.72	1.84
224	79.9	23.00	8.00	34.00	2.34	-0.07	0.61
225	93.0	21.00	9.00	38.00	0.29	1.36	72.39
226	83.9	21.00	11.00	38.00	-2.76	4.01	1.37
227	87.7	26.00	5.00	41.00	12.47	-4.13	1.65
228	89.8	19.00	11.00	41.00	-6.06	4.08	2.10
229	82.6	17.00	16.00	39.00	-14.36	10.78	1.00
230	82.6	21.00	20.00	52.00	-7.76	16.08	1.13
231	87.4	9.00	12.00	28.00	-29.36	5.59	1.42
232	82.1	28.00	5.00	40.00	15.25	-4.17	0.89
233	76.2	25.00	13.00	45.00	3.21	6.57	0.69
234	148.2	32.00	7.00	45.00	56.64	-1.56	1.60
235	283.5	24.00	23.00	59.00	253.65	22.66	1.35
236	84.3	12.00	9.00	28.00	-21.38	1.48	1.71
237	88.4	21.00	9.00	38.00	-0.74	1.34	26.48
238	90.5	21.00	17.00	47.00	-4.69	12.14	1.29
239	90.4	24.00	10.00	47.00	5.95	2.65	48.77
240	92.1	20.00	9.00	43.00	-2.20	1.38	1.37
241	83.1	18.00	6.00	35.00	-6.81	-2.66	1.34
242	83.1	18.00	11.00	36.00	-9.46	4.06	1.96
243	82.1	12.00	5.00	23.00	-19.50	-3.90	3.04
244	82.9	29.00	7.00	40.00	16.61	-1.50	1.69
245	82.4	20.00	7.00	42.00	-3.11	-1.35	1.32
246	82.3	21.00	7.00	40.00	-0.96	-1.37	1.19
247	84.2	13.00	12.00	36.00	-20.79	5.49	0.89
248	83.3	28.00	8.00	43.00	14.04	-0.14	1.21
249	89.9	13.00	16.00	36.00	-22.36	10.92	3.05
250	94.7	16.00	14.00	40.00	-13.75	8.22	0.98
251	89.8	26.00	7.00	44.00	11.98	-1.43	1.54
252	92.8	31.00	13.00	50.00	20.98	6.58	3.46
253	89.9	24.00	12.00	45.00	4.74	5.34	5.70
254	83.4	22.00	9.00	38.00	0.41	1.30	1.42
255	83.3	15.00	6.00	31.00	-13.34	-2.60	1.76
256	91.5	27.00	13.00	48.00	11.40	6.64	1.52
257	83.3	19.00	12.00	38.00	-8.32	6.72	1.22
258	81.7	20.00	10.00	38.00	-4.90	2.67	1.77
259	81.4	14.00	13.00	36.00	-19.44	6.80	1.54
260	84.5	16.00	5.00	27.00	-10.42	-3.96	2.09
261	87.4	16.00	14.00	37.00	-14.83	8.15	1.12
262	87.4	16.00	9.00	36.00	-12.11	1.43	1.54
263	87.7	19.00	5.00	34.00	-3.18	-4.01	1.94
264	85.2	15.00	8.00	37.00	-14.13	0.09	1.57
265	81.4	22.00	10.00	43.00	-0.54	2.64	1.64
266	78.8	29.00	15.00	55.00	11.31	9.20	0.98
267	85.7	21.00	9.00	37.00	-1.31	1.33	1.24
268	82.2	14.00	11.00	32.00	-18.30	4.12	1.53

ID: EQUIPMENT SURVY 10 NOV 2000 16:39
USER: 3 COMMENT: EQUIPMENT SURVEY

RESET TIME : 1.00
DATA CALC : DL DPM H# : YES SAMPLE REPEATS: 1 PRINTER : EDIT
COUNT BLANK : YES IC# : NO REPLICATES : 1 RS232 : EDIT
TWO PHASE : NO ADC : YES CYCLE REPEATS : 1
SCINTILLATOR: LIQUID LUMEX: YES LOW SAMPLE REJ: 0
LOW LEVEL : NO HALF LIFE CORRECTION DATE: none

ISOTOPE 1: 3H %ERROR: 2.00 FACTOR: 1.0000 BKG. SUB: 0
ISOTOPE 2: 14C %ERROR: 2.00 FACTOR: 1.0000 BKG. SUB: 0
WIDE OPEN WINDOW %ERROR: 0.00 FACTOR: 1.0000 BKG. SUB: 0

BACKGROUND QUENCH CURVE: Off COLOR QUENCH CORRECTION: Off

Quench Limits Low: 13.688 High: 306.34

SAM NO	H#	3H CPM	14C CPM	WIDE CPM	3H DPM	14C DPM	LUMEX %	
B1	88.9	25.00	6.00	42.00	52.95	7.64	1.83	
		Blank Average	DPM	for	3H :	52.95	COEF. OF VAR:	0.000
		Blank Average	DPM	for	14C :	7.64	COEF. OF VAR:	0.000

169 B 79.3 19.00 7.00 37.00 -15.87 1.42 19.28

SAM NO	H#	3H CPM	14C CPM	WIDE CPM	3H DPM	14C DPM	LUMEX %
270	84.4	25.00	12.00	45.00	5.61	5.29	0.79
271	90.4	21.00	14.00	44.00	-3.06	8.09	1.04
272	84.8	19.00	15.00	43.00	-9.11	9.42	0.75
273	87.9	16.00	12.00	36.00	-13.66	5.47	0.88
274	83.6	25.00	14.00	50.00	4.36	7.97	1.03
275	86.6	27.00	12.00	50.00	10.59	5.27	0.85
276	83.1	15.00	10.00	32.00	-15.48	2.76	1.05
277	89.4	23.00	8.00	39.00	4.55	-0.03	2.13
278	89.5	22.00	11.00	44.00	0.66	4.02	7.64
279	86.7	27.00	15.00	50.00	9.00	9.30	0.95
280	86.9	16.00	7.00	39.00	-11.11	-1.27	0.78
281	87.6	24.00	16.00	45.00	2.00	10.71	0.85
282	102.0	23.00	13.00	46.00	4.95	6.79	1.45
283	94.1	14.00	14.00	37.00	-18.47	8.25	1.39
284	85.2	17.00	17.00	44.00	-14.54	12.15	1.40
285	87.3	15.00	11.00	33.00	-15.44	4.13	1.21
286	92.8	24.00	9.00	47.00	7.15	1.31	1.67
287	97.9	28.00	10.00	51.00	17.40	2.61	1.17
288	92.6	15.00	12.00	38.00	-15.24	5.52	1.60
289	95.3	27.00	16.00	54.00	10.82	10.72	1.78
290	86.4	30.00	11.00	49.00	17.74	3.87	0.77
291	91.1	23.00	5.00	32.00	6.65	-4.07	3.08
292	108.2	27.00	15.00	52.00	15.50	9.48	5.01
293	96.3	11.00	10.00	30.00	-22.91	2.92	9.61
294	84.3	24.00	14.00	49.00	2.33	7.99	1.01
295	85.6	10.00	6.00	25.00	-24.05	-2.51	1.83
296	85.4	24.00	7.00	39.00	6.33	-1.41	0.92
297	88.0	16.00	17.00	42.00	-16.37	12.20	1.07
298	89.8	23.00	12.00	42.00	2.44	5.36	18.68
299	91.3	22.00	8.00	36.00	2.75	-0.01	2.64
300	88.5	30.00	20.00	56.00	13.49	16.00	0.76
301	86.8	16.00	11.00	37.00	-13.28	4.11	1.11
302	85.2	14.00	10.00	39.00	-17.40	2.79	1.06
303	85.8	24.00	10.00	49.00	4.83	2.62	1.32
304	87.3	26.00	5.00	44.00	12.37	-4.13	1.03
305	91.0	19.00	8.00	37.00	-4.16	0.04	1.26
306	89.8	25.00	10.00	41.00	8.05	2.63	0.91
307	86.7	9.00	13.00	31.00	-29.95	6.93	1.45
308	87.0	20.00	8.00	34.00	-2.73	0.01	1.13
309	85.1	18.00	10.00	39.00	-8.58	2.72	1.14
310	86.1	16.00	11.00	38.00	-13.39	4.11	0.79
311	88.5	16.00	7.00	32.00	-10.84	-1.26	2.25
312	116.5	30.00	10.00	50.00	29.69	2.63	5.79
313	91.8	14.00	15.00	36.00	-19.32	9.58	1.44
314	89.4	16.00	8.00	32.00	-11.41	0.08	1.39
315	89.2	19.00	7.00	33.00	-3.97	-1.31	1.13
316	94.6	24.00	14.00	44.00	4.78	8.07	2.23
317	99.6	21.00	12.00	47.00	0.13	5.46	1.69
318	90.8	17.00	9.00	32.00	-9.29	1.43	1.20
319	86.7	46.00	12.00	65.00	52.88	4.94	0.45
320	88.3	18.00	3.00	32.00	-4.21	-6.68	1.50
321	89.3	53.00	10.00	73.00	71.08	2.13	1.23
322	88.6	18.00	11.00	37.00	-8.53	4.09	1.15
323	91.9	16.00	11.00	35.00	-12.51	4.15	1.08
324	95.8	20.00	12.00	42.00	-3.10	5.45	1.67
325	97.7	20.00	10.00	40.00	-1.52	2.76	1.75
326	84.6	22.00	12.00	42.00	-0.94	5.34	0.86
327	86.3	13.00	11.00	36.00	-20.02	4.16	1.11

SAM NO	H#	3H CPM	14C CPM	WIDE CPM	3H DPM	14C DPM	LUMEX %
327	87.9	9.00	9.00	27.00	-27.70	1.55	1.50
328	91.8	23.00	13.00	43.00	2.36	6.72	9.51
329	91.0	25.00	12.00	49.00	7.29	5.33	1.26
330	86.0	13.00	11.00	33.00	-20.06	4.16	0.94
331	90.2	14.00	12.00	34.00	-17.85	5.52	1.25
332	94.7	25.00	11.00	47.00	8.85	4.00	0.75
333	91.4	19.00	12.00	41.00	-6.30	5.44	1.90
334	91.8	27.00	10.00	42.00	13.17	2.60	0.99
335	91.8	28.00	12.00	52.00	14.35	5.28	1.24
336	85.3	19.00	16.00	44.00	-9.57	10.77	0.77
337	90.8	16.00	12.00	36.00	-13.22	5.49	1.59
338	87.0	20.00	14.00	39.00	-5.97	8.08	1.66
339	89.2	16.00	9.00	37.00	-11.82	1.44	1.63
340	102.9	20.00	11.00	42.00	-0.89	4.14	1.75
341	87.2	28.00	13.00	48.00	12.44	6.60	3.18
342	94.1	18.00	9.00	32.00	-6.39	1.42	1.59
343	93.7	18.00	6.00	32.00	-4.78	-2.63	2.80
344	98.5	77.00	12.00	98.00	132.55	4.39	4.60
345	115.5	35.00	17.00	56.00	37.79	12.10	5.73
346	86.5	16.00	13.00	42.00	-14.41	6.80	1.07
347	97.0	17.00	7.00	30.00	-7.02	-1.25	2.23
348	86.8	23.00	16.00	47.00	-0.42	10.72	1.19
349	95.1	18.00	12.00	41.00	-7.89	5.48	1.20
350	109.5	27.00	12.00	48.00	17.82	5.40	1.66
351	108.1	25.00	12.00	45.00	12.28	5.43	1.88
352	94.8	14.00	6.00	27.00	-13.83	-2.55	1.94
353	89.8	14.00	9.00	37.00	-16.25	1.47	1.75
354	94.8	16.00	10.00	37.00	-11.47	2.81	2.86

ID: EQUIPMENT SURVY
 USER: 3 COMMENT: EQUIPMENT SURVEY

10 NOV 2000 14:04

RESET TIME : 1.00
 DATA CALC : DL DPM H# : YES SAMPLE REPEATS: 1 PRINTER : EDIT
 COUNT BLANK : YES IC# : NO REPLICATES : 1 RS232 : EDIT
 TWO PHASE : NO AQC : YES CYCLE REPEATS : 1
 SCINTILLATOR: LIQUID LUMEX: YES LOW SAMPLE REJ: 0
 LOW LEVEL : NO HALF LIFE CORRECTION DATE: none

ISOTOPE 1: 3H %ERROR: 2.00 FACTOR: 1.0000 BKG. SUB: 0
 ISOTOPE 2: 14C %ERROR: 2.00 FACTOR: 1.0000 BKG. SUB: 0
 WIDE OPEN WINDOW %ERROR: 0.00 FACTOR: 1.0000 BKG. SUB: 0

BACKGROUND QUENCH CURVE: Off COLOR QUENCH CORRECTION: Off

Quench Limits Low: 13.688 High: 306.34

SAM NO	H#	3H CPM	14C CPM	WIDE CPM	3H DPM	14C DPM	LUMEX %
B1	80.0	21.00	5.00	36.00	42.55	6.35	10.59
		Blank Average DPM for		3H :	42.55	COEF. OF VAR: 0.000	
		Blank Average DPM for		14C :	6.35	COEF. OF VAR: 0.000	

355	75.1	27.00	11.00	47.00	8.57	7.91	8.42
356	72.0	44.00	6.00	58.00	45.51	0.95	15.53
357	71.0	21.00	11.00	50.00	-4.73	7.99	4.21
358	72.6	16.00	9.00	35.00	-13.84	5.41	6.06
359	72.5	24.00	12.00	43.00	1.24	9.28	5.39
360	74.3	26.00	15.00	50.00	4.28	13.27	3.08
361	74.2	17.00	4.00	30.00	-9.01	-1.28	6.67
362	76.9	17.00	10.00	34.00	-11.66	6.75	5.88
363	73.3	26.00	11.00	47.00	6.06	7.92	3.54
364	72.0	16.00	9.00	32.00	-13.91	5.40	3.93
365	73.4	17.00	8.00	31.00	-11.15	4.06	4.70
366	76.0	21.00	14.00	44.00	-5.38	12.03	3.99
367	74.0	17.00	14.00	37.00	-14.08	12.08	4.24
368	76.0	22.00	9.00	41.00	-0.73	5.33	3.53