

Radiological Survey Sheet

Job Location Pfizer Central Research Grotto 118B/B201 Page 1 of 24
 Survey Purpose Radiological Assessment Date 11/15/00
 Performed By Pam Jones (Print) Pam Jones (Sign)

Inst.(1) (Model/SN) Beckman LS 6500 #7069448	Inst.(2) Ludlum 2241-2 (Model/SN) #163603	Inst.(3) (Model/SN)
Det. Internal (Model/SN)	Det. Ludlum 43-68 (Model/SN) #149613	Det. (Model/SN)
Eff. See LSC Printout	Eff. = 8%	Eff.
Type rad. β	Type rad. β	Type rad.
Bkgd. See LSC Printout	Bkgd. 300cpm	Bkgd.
Cal. Due: 12/00	Cal. Due 2/13/01	Cal. due

No.	Time	Location	Inst. Used	Total Activity (dpm/100 cm ²)
1.	12:30	door	1	See attached LSC Printout
2.		wall	1	
3.		wall	1	
4.		wall	1	
5.		side outside hood	1	
6.		floor	1	
7.		"	1	
8.		"	1	
9.		"	1	
10.		"	1	
11.		"	1	
12.		"	1	
13.		"	1	
14.		left outside hood	1	
15.		top	1	
16.		rt.	1	
17.		glass + handles	1	
18.	✓	ledge	1	

Radiological Survey Continuation Sheet

Page 2 of 24

Date 11/15/00

No.	Time	Location	Inst. Used	Total Activity (dpm/100 cm ²)
19		left top inside (side)	1	See attached LSC Printout
20		bottom	1	
21		back top	1	
22		back middle	1	
23		rt. top side	1	
24		rt. bottom	1	
25		back bottom & underneath	1	
26		left counter	1	
27		rt. counter	1	
28		cup sink	1	
29		outside cab	1	
30		left	1	
31		bottom	1	
32		rt.	1	
33		outside cab	1	
34		left	1	
35		bottom	1	
36		rt.	1	
37		wall	1	
38		ledge	1	
39		"	1	
40		shelf under ledge	1	
41		outside shelves	1	
42		top shelf	1	
43		shelf	1	
44		"	1	
45		bottom shelf	1	
46	✓	outside shelves	1	✓ (see # 330)

Radiological Survey Continuation Sheet

Page 3 of 24

Date 11/15/00

No.	Time	Location	Inst. Used	Total Activity (dpm/100 cm ²)
47		top shelf	1	See attached LSC Printout
48		shelf	1	
49		"	1	
50		bottom shelf	1	
51		top shelf	1	
52		shelf	1	
53		bottom shelf	1	
54		top shelf	1	
55		shelf	1	
56		bottom shelf	1	
57		counter	1	
58		"	1	
59		"	1	
60		cup sink	1	
61		"	1	
62		desk shelf	1	
63		desk top	1	
64		outside cab.	1	
65		top drawer	1	
66		left	1	
67		bottom	1	
68		ft.	1	
69		drawer	1	
70		outside drawers	1	
71		top drawer	1	
72		drawer	1	
73		"	1	
74	✓	bottom drawer	1	✓

Radiological Survey Continuation Sheet

Page 4 of 29
 Date 11/15/00

No.	Time	Location	Inst. Used	Total Activity (dpm/100 cm ²)
75		drawer	1	See attached LSC Printout
76		outside drawers	1	
77		top drawer	1	
78		drawer	1	
79		"	1	
80		bottom drawer	1	
81		drawer	1	
82		outside drawers	1	
83		top drawer	1	
84		drawer	1	
85		bottom drawer	1	
86		magnet	1	
87		bin	1	
88		bin	1	
89		basket	1	
90		wall	1	
91		outside shelves	1	
92		top shelf	1	
93		shelf	1	
94		"	1	
95		bottom shelf	1	
96		outside shelves	1	
97		top shelf	1	
98		shelf	1	
99		"	1	
100		bottom shelf	1	
101		top shelf	1	
102	✓	shelf	1	✓

Radiological Survey Continuation Sheet

Page 5 of 24

Date 11/15/00

No.	Time	Location	Inst. Used	Total Activity (dpm/100 cm ²)
103		bottom shelf	1	See attached LSC Printout
104		pipe dryer	1	
105		counter	1	
106		"	1	
107		"	1	
108		"	1	
109		cup sink	1	
110		sides of sink	1	
111		bottom	1	
112		drain	1	
113		plastic bottle (soap)	1	
114		outside drawers	1	
115		top drawer	1	
116		drawer	1	
117		"	1	
118		bottom drawer	1	
119		drawer	1	
120		outside drawers	1	
121		top drawer	1	
122		drawer	1	
123		drawer	1	
124		bottom drawer	1	
125		outside cab	1	
126		left	1	
127		bottom	1	
128		rt.	1	
129		floor	1	
130	✓	"	1	✓

Radiological Survey Continuation Sheet

Page 6 of 24

Date 11/15/00

No.	Time	Location	Inst. Used	Total Activity (dpm/100 cm ²)
131		floor	1	See attached LSC Printout
132		lead	1	
133		chair	1	
134		"	1	
135		"	1	
136		"	1	
137		"	1	
138		"	1	
139		floor	1	
140		"	1	
141		"	1	
142		"	1	
143		"	1	
144		outside shelves	1	
145		top shelf	1	
146		shelf	1	
147		"	1	
148		bottom shelf	1	
149		outside shelves	1	
150		top shelf	1	
151		shelf	1	
152		"	1	
153		bottom shelf	1	
154		outside shelves	1	
155		top shelf	1	
156		shelf	1	
157		"	1	
158	✓	bottom shelf	1	✓

Radiological Survey Continuation Sheet

Page 7 of 24

Date 11/15/00

No.	Time	Location	Inst. Used	Total Activity (dpm/100 cm ²)
159		shelf (desk)	1	See attached LSC Printout
160		desktop	1	
161		counter	1	
162		"	1	
163		"	1	
164		"	1	
165		outside drawers	1	
166		pull-out	1	
167		top drawer	1	
168		drawer	1	
169		bottom drawer	1	
170		drawer	1	
171		outside drawers	1	
172		top drawer	1	
173		drawer	1	
174		"	1	
175		bottom drawer	1	
176		outside drawers	1	
177		top drawer	1	
178		drawer	1	
179		"	1	
180		bottom drawer	1	✓
181		drawer	1	(see # 331)
182		outside drawers	1	
183		top drawer	1	
184		drawer	1	
185		"	1	
186	✓	bottom drawer	1	✓

Radiological Survey Continuation Sheet

Page 8 of 24
 Date 11/15/00

No.	Time	Location	Inst. Used	Total Activity (dpm/100 cm ²)
187		outside drawers	1	See attached LSC Printout
188		top drawer	1	
189		drawer	1	
190		"	1	
191		bottom drawer	1	
192		cardboard	1	
193		outside fridge	1	
194		inside freezer door	1	
195		left	1	
196		bottom	1	
197		A.	1	
198		top shelf fridge door	1	
199		2nd shelf	1	
200		3rd shelf	1	
201		bottom shelf	1	
202		1st shelf	1	
203		2nd shelf	1	
204		3rd shelf	1	
205		top shelf	1	
206		shelf	1	
207		bottom shelf	1	
208		top shelf	1	
209		shelf	1	
210		bottom shelf	1	
211		desk shelf	1	
212		desk top	1	
213		ledge	1	
214	✓	wall	1	✓

Radiological Survey Continuation Sheet

Page 9 of 24
 Date 11/15/00

No.	Time	Location	Inst. Used	Total Activity (dpm/100 cm ²)
215		outside shelved	1	See attached LSC Printout
216		top shelf	1	
217		shelf	1	
218		"	1	
219		bottom shelf	1	
220		outside shelved	1	
221		top shelf	1	
222		shelf	1	
223		"	1	
224		bottom shelf	1	
225		counter	1	
226		"	1	
227		"	1	
228		"	1	
229		cup sink	1	
230		"	1	✓ (see # 332)
231		outside cab.	1	
232		top drawer	1	
233		top shelf	1	
234		bottom shelf	1	
235		drawer	1	
236		outside drawers	1	
237		top drawer	1	
238		drawer	1	
239		"	1	
240		bottom drawer	1	
241		drawer	1	
242	✓	outside drawers	1	✓

Radiological Survey Continuation Sheet

Page 10 of 24
 Date 11/15/00

No.	Time	Location	Inst. Used	Total Activity (dpm/100 cm ²)
243		top drawer	1	See attached LSC Printout
244		drawer	1	
245		"	1	
246		bottom drawer	1	
247		drawer	1	
248		outside drawers	1	
249		pull-out	1	
250		top drawer	1	
251		drawer	1	
252		bottom drawer	1	
253		floor	1	
254		"	1	
255		"	1	
256		"	1	
257		"	1	
258		"	1	
259		wall	1	
260		"	1	
261		door	1	
262		wall	1	
263		desk counter	1	
264		"	1	
265		"	1	
266		"	1	
267		"	1	
268		"	1	
269		wall	1	
270	✓	outside drawers	1	✓

Radiological Survey Continuation Sheet

Page 11 of 24

Date 11/15/00

No.	Time	Location	Inst. Used	Total Activity (dpm/100 cm ²)
271		pull-out	1	See attached LSC Printout
272		top drawer	1	
273		drawer	1	
274		bottom drawer	1	
275		outside drawers	1	
276		pull-out	1	
277		top drawer	1	
278		drawer	1	
279		bottom drawer	1	
280		sm. cabinet	1	
281		lg. cabinet	1	
282		blue cab.	1	
283		cab.	1	
284		cab.	1	
285		floor	1	
286		"	1	
287		"	1	
288		"	1	
289		"	1	
290		"	1	
291		desk shelf	1	
292		desk top	1	
293		counter	1	
294		"	1	
295		"	1	
296		"	1	
297		plastic tray	1	
298	✓	rollaway shelves	1	✓

Radiological Survey Continuation Sheet

Page 12 of 24

Date 11/15/00

No.	Time	Location	Inst. Used	Total Activity (dpm/100 cm ²)
299		blue cab.	1	See attached LSC Printout
300		wall	1	
301		across wall	1	
302		outside drawers	1	
303		pull-out	1	
304		top drawer	1	
305		drawer	1	
306		bottom drawer	1	
307		drawer	1	
308		outside drawers	1	
309		top drawer	1	
310		drawer	1	
311		"	1	
312		bottom drawer	1	
313		drawer	1	
314		outside drawers	1	
315		top drawer	1	
316		drawer	1	
317		"	1	
318		bottom drawer	1	
319		drawer	1	
320		outside drawers	1	
321		top drawer	1	
327		drawer	1	
323		drawer	1	
324		bottom drawer	1	
325		shelves	1	
326	✓	desk	1	✓

Bld. 118B Room B201

Page 14 of 24

Date: 11/15/00

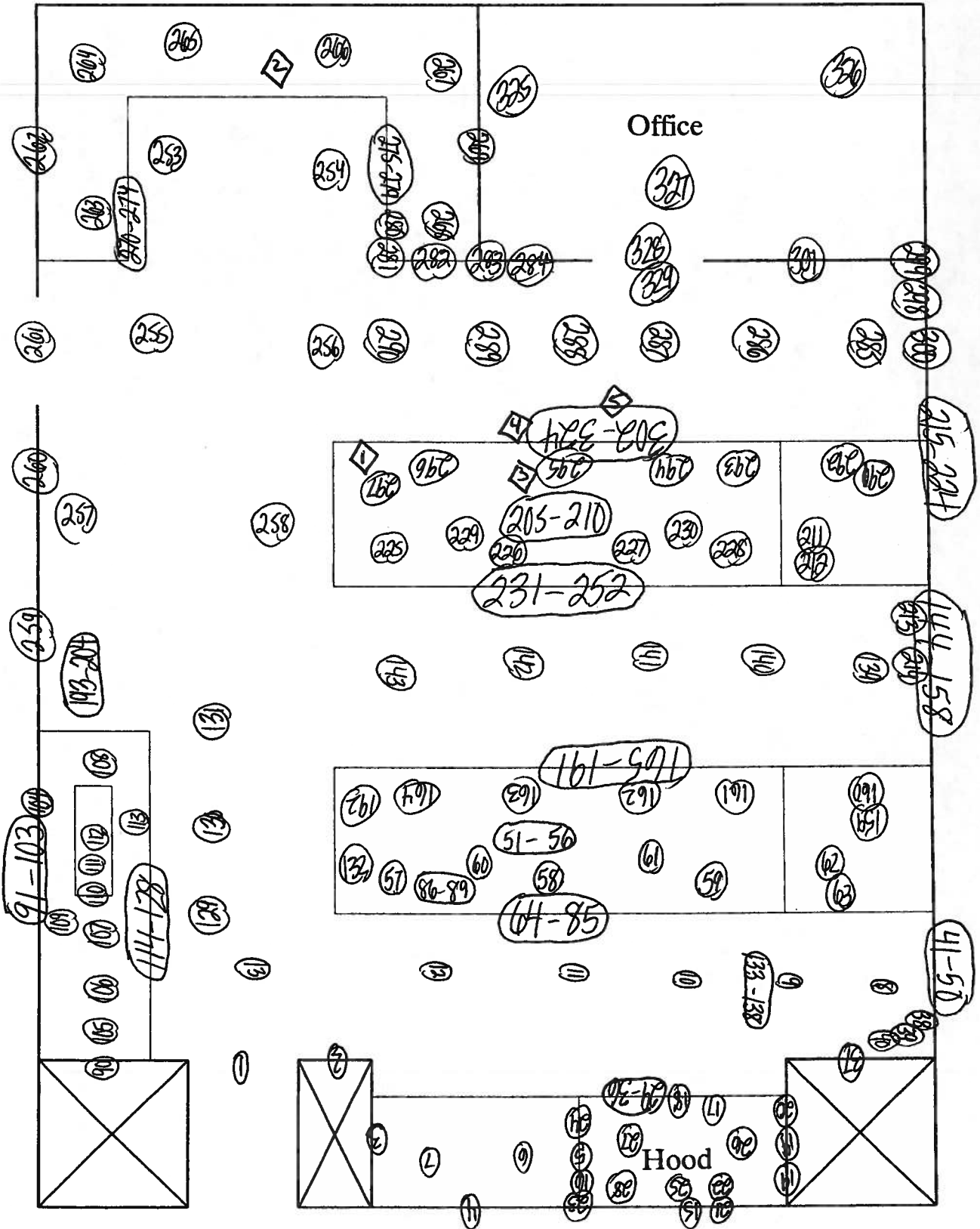

O = Wipe Location

◻ = Fixed Activity IDENTIFIED w/ INST. # 2.

Surveyed approximately 100% of lower surfaces using instrument #2. All surfaces surveyed were noted to be at normal background levels, with the following five (5) exceptions:

1. A plastic tray was noted to be contaminated to a level of 102,243 cpm (1,274,288 dpm/100 cm²). This item was disposed of as radioactive waste.
2. A piece of equipment was noted to be contaminated to a level of 2,000 cpm (21,250 dpm/100 cm²). This item was decontaminated to normal background levels.
3. The outlet was noted to be contaminated to a level of 2,488 cpm (27,350 dpm/100 cm²). This item was removed and disposed of as radioactive waste.
4. The floor was noted to be contaminated to a level of 1,656 cpm (16,950 dpm/100 cm²). This area was decontaminated to normal background levels.
5. The floor was noted to be contaminated to a level of 11,467 cpm (139,588 dpm/100 cm²). This area was decontaminated to normal background levels.

ID: EQUIPMENT SURVY
USER: 3 COMMENT: EQUIPMENT SURVEY

16 NOV 2000 09:51

SET TIME : 1.00
 DATA CALC : DL DPM H# : YES SAMPLE REPEATS: 1 PRINTER : EDIT
 COUNT BLANK : YES IC# : NO REPLICATES : 1 RS232 : EDIT
 TWO PHASE : NO ABC : YES CYCLE REPEATS : 1
 SCINTILLATOR: LIQUID LUMEX: YES LOW SAMPLE REJ: 0
 LOW LEVEL : NO HALF LIFE CORRECTION DATE: none

ISOTOPE 1: 3H %ERROR: 2.00 FACTOR: 1.0000 BKG. SUB: 0
 ISOTOPE 2: 14C %ERROR: 2.00 FACTOR: 1.0000 BKG. SUB: 0
 WIDE OPEN WINDOW %ERROR: 0.00 FACTOR: 1.0000 BKG. SUB: 0

BACKGROUND QUENCH CURVE: Off COLOR QUENCH CORRECTION: Off

Quench Limits Low: 13.689 High: 306.34

SAM NO	H#	3H CPM	14C CPM	WIDE CPM	3H DPM	14C DPM	LUMEX %	
B1	72.0	16.00	8.00	35.00	29.13	10.42	0.79	
		Blank Average		DPM for	3H :	29.13	COEF. OF VAR:	0.000
		Blank Average		DPM for	14C :	10.42	COEF. OF VAR:	0.000

1	72.1	19.00	11.00	37.00	4.73	3.96	0.95	
2	75.6	18.00	8.00	37.00	4.70	-0.02	0.90	
3	73.5	20.00	8.00	36.00	8.54	-0.06	0.62	
4	76.5	15.00	7.00	29.00	-0.99	-1.30	0.97	
5	75.8	13.00	7.00	31.00	-5.29	-1.27	0.99	
6	79.2	12.00	6.00	24.00	-6.53	-2.58	1.69	
7	81.0	20.00	9.00	36.00	9.39	1.31	1.38	
8	82.8	22.00	10.00	47.00	13.55	2.63	0.84	
9	102.8	19.00	14.00	44.00	8.66	8.22	4.73	
10	89.4	20.00	9.00	38.00	11.05	1.35	1.58	
11	77.1	11.00	8.00	27.00	-9.90	0.10	1.76	
12	81.1	10.00	9.00	27.00	-12.22	1.48	1.82	
13	99.3	18.00	12.00	41.00	6.73	5.50	13.75	
14	79.7	14.00	9.00	28.00	-3.75	1.41	2.03	
15	77.4	17.00	6.00	29.00	3.89	-2.67	3.87	
16	75.8	19.00	12.00	39.00	4.81	5.32	1.23	
17	77.4	15.00	7.00	32.00	-0.87	-1.30	1.76	
18	83.1	15.00	7.00	26.00	-0.08	-1.28	2.15	
19	81.8	16.00	7.00	30.00	1.91	-1.30	1.23	
20	81.1	34.00	12.00	59.00	38.09	5.10	1.00	
21	97.8	14.00	16.00	40.00	-5.32	10.98	1.62	
22	91.9	36.00	15.00	65.00	44.80	9.17	1.14	
23	80.1	21.00	4.00	34.00	13.98	-5.41	1.35	
24	82.1	21.00	8.00	35.00	12.29	-0.04	1.16	
25	97.3	28.00	8.00	47.00	32.17	-0.12	1.67	
26	82.6	23.00	13.00	41.00	14.11	6.64	1.26	
27	82.6	33.00	11.00	54.00	36.96	3.78	1.00	
28	75.4	24.00	13.00	48.00	14.76	6.57	0.78	
29	76.9	17.00	15.00	42.00	-0.79	9.37	0.67	
30	75.1	23.00	5.00	41.00	16.63	-4.11	0.58	
31	92.7	17.00	14.00	42.00	2.05	8.17	0.74	
32	74.1	21.00	8.00	39.00	10.73	-0.07	0.76	
33	78.4	34.00	22.00	70.00	32.06	18.48	0.80	
34	71.3	23.00	12.00	46.00	12.37	5.22	0.50	
35	81.1	20.00	5.00	35.00	11.49	-4.05	1.05	
36	71.9	22.00	8.00	36.00	12.40	-0.10	0.64	

SAM NO	H#	3H CPM	14C CPM	WIDE CPM	3H DPM	14C DPM	LUMEX %
37	69.2	20.00	9.00	41.00	7.31	1.26	0.55
38	75.2	19.00	14.00	41.00	3.70	7.99	1.08
39	74.8	13.00	11.00	29.00	-7.42	4.07	2.67
40	75.5	21.00	6.00	35.00	12.01	-2.74	2.06
41	76.9	14.00	9.00	35.00	-4.07	1.39	0.88
42	78.6	8.00	7.00	23.00	-15.66	-1.18	1.66
43	77.1	18.00	10.00	38.00	3.91	2.67	0.85
44	81.2	11.00	12.00	33.00	-11.62	5.49	1.67
45	78.0	15.00	12.00	36.00	-3.37	5.40	1.23
46	74.2	137.00	12.00	161.00	251.27	3.39	0.18
47	78.5	15.00	8.00	29.00	-1.24	0.04	4.80
48	79.9	9.00	13.00	30.00	-16.54	6.85	1.46
49	81.9	15.00	8.00	33.00	-0.78	0.06	2.51
50	77.4	14.00	13.00	34.00	-6.06	6.75	1.97
51	72.4	19.00	9.00	36.00	5.78	1.29	0.80
52	73.6	15.00	7.00	28.00	-1.36	-1.31	1.36
53	72.6	19.00	13.00	43.00	3.81	6.63	0.47
54	77.2	13.00	16.00	36.00	-9.74	10.78	0.56
55	73.7	17.00	13.00	40.00	-0.19	6.67	0.52
56	72.7	13.00	2.00	22.00	-3.14	-7.96	0.98
57	75.1	16.00	10.00	37.00	-0.59	2.69	1.23
58	78.0	18.00	8.00	32.00	5.08	-0.01	1.20
59	78.3	11.00	13.00	32.00	-12.36	6.81	1.00
60	77.4	16.00	12.00	45.00	-1.31	5.38	0.97
61	74.8	12.00	12.00	39.00	-10.03	5.42	0.65
62	76.2	14.00	11.00	34.00	-5.18	4.06	0.82
63	77.8	15.00	8.00	32.00	-1.33	0.04	0.87
64	77.4	20.00	9.00	38.00	8.73	1.30	0.98
65	80.8	15.00	14.00	34.00	-4.06	8.10	0.94
66	74.1	10.00	13.00	36.00	-14.77	6.79	0.68
67	74.6	15.00	11.00	33.00	-3.26	4.04	1.53
68	69.2	15.00	11.00	35.00	-3.87	4.00	0.57
69	73.6	22.00	12.00	44.00	10.72	5.25	0.30
70	74.9	7.00	5.00	20.00	-16.97	-3.85	0.85
71	73.2	18.00	14.00	40.00	1.32	7.98	0.72
72	74.0	19.00	7.00	32.00	7.04	-1.38	0.70
73	71.5	26.00	11.00	50.00	19.08	3.84	0.55
74	74.9	22.00	18.00	54.00	7.92	13.28	0.36
75	78.4	12.00	9.00	26.00	-8.17	1.43	1.95
76	76.9	17.00	10.00	41.00	1.77	2.68	0.44
77	73.9	32.00	8.00	47.00	33.66	-0.25	0.44
78	74.3	22.00	7.00	39.00	13.37	-1.42	0.88
79	72.4	14.00	7.00	28.00	-3.59	-1.30	3.12
80	73.8	25.00	8.00	38.00	19.03	-0.14	0.82
81	71.9	23.00	8.00	41.00	14.47	-0.11	0.71
82	74.9	12.00	11.00	32.00	-9.51	4.09	2.40
83	72.7	18.00	9.00	40.00	3.74	1.31	0.74
84	73.1	17.00	8.00	33.00	2.23	-0.01	0.74
85	73.9	18.00	10.00	34.00	3.43	2.65	0.55
86	74.5	11.00	9.00	28.00	-10.64	1.43	1.05
87	73.7	17.00	11.00	41.00	0.81	4.00	0.61
88	74.3	15.00	9.00	29.00	-2.28	1.36	0.70
89	82.7	13.00	10.00	38.00	-6.08	2.78	1.72
90	75.3	18.00	6.00	38.00	5.67	-2.69	1.27
91	82.3	26.00	15.00	52.00	19.51	9.27	0.43
92	75.8	19.00	5.00	36.00	8.35	-4.04	0.65
93	73.2	31.00	8.00	57.00	31.39	-0.24	0.41
94	75.5	13.00	9.00	32.00	-6.34	1.40	0.77

52

SAM NO	H#	3H CPM	14C CPM	WIDE CPM	3H DPM	14C DPM	LUMEX %
95	81.9	17.00	5.00	26.00	5.14	-4.00	1.38
96	79.2	13.00	10.00	37.00	-6.46	2.76	1.10
97	72.5	17.00	10.00	35.00	1.14	2.66	0.65
98	75.0	16.00	6.00	31.00	1.42	-2.66	0.60
99	72.6	21.00	14.00	42.00	7.47	7.93	0.60
100	77.1	16.00	7.00	35.00	1.21	-1.32	0.78
101	92.3	15.00	8.00	36.00	0.77	0.10	1.43
102	93.3	22.00	8.00	36.00	17.05	-0.02	1.84
103	81.2	10.00	4.00	24.00	-9.59	-5.22	2.03
104	75.3	21.00	5.00	37.00	12.48	-4.08	0.74
105	81.3	18.00	10.00	38.00	4.59	2.69	1.05
106	81.2	15.00	11.00	34.00	-2.45	4.08	0.80
107	75.7	15.00	7.00	35.00	-1.10	-1.30	0.74
108	78.0	20.00	12.00	41.00	7.28	5.31	0.78
109	72.0	16.00	7.00	35.00	0.50	-1.33	0.72
110	73.2	23.00	12.00	44.00	12.72	5.23	0.49
111	76.5	43.00	8.00	60.00	57.70	-0.42	0.29
112	76.1	13.00	16.00	37.00	-9.84	10.77	0.63
113	72.6	15.00	6.00	26.00	-0.99	-2.65	0.83
114	75.6	17.00	10.00	40.00	1.58	2.67	1.23
115	75.1	13.00	8.00	28.00	-5.88	0.06	0.95
116	79.1	20.00	10.00	38.00	8.52	2.64	0.94
117	78.2	19.00	13.00	42.00	4.67	6.67	0.97
118	80.5	18.00	12.00	35.00	3.41	5.37	0.86
119	79.3	15.00	11.00	34.00	-2.69	4.07	1.03
120	76.6	15.00	7.00	33.00	-0.98	-1.30	0.65
121	73.7	16.00	11.00	33.00	-1.28	4.01	0.94
122	76.6	17.00	11.00	35.00	1.21	4.02	0.73
123	73.3	22.00	5.00	32.00	14.18	-4.10	0.97
124	77.8	14.00	8.00	27.00	-3.45	0.06	1.65
125	73.0	14.00	11.00	34.00	-5.52	4.04	0.65
126	73.7	22.00	5.00	35.00	14.25	-4.10	0.48
127	86.7	17.00	10.00	38.00	3.27	2.74	0.80
128	73.5	15.00	7.00	35.00	-1.38	-1.31	0.52
129	77.3	15.00	11.00	35.00	-2.94	4.05	1.12
130	82.1	15.00	13.00	37.00	-3.38	6.77	14.97
131	82.9	14.00	10.00	34.00	-3.87	2.77	1.64
132	87.3	19.00	9.00	35.00	8.39	1.36	1.00
133	75.3	24.00	7.00	41.00	17.78	-1.45	0.50
134	74.6	16.00	7.00	28.00	0.86	-1.32	0.67
135	74.1	13.00	8.00	30.00	-5.98	0.06	0.57
136	74.6	10.00	7.00	31.00	-11.71	-1.23	0.75
137	77.4	15.00	10.00	36.00	-2.41	2.72	0.62
138	75.0	17.00	9.00	37.00	2.00	1.33	0.59
139	94.0	15.00	14.00	32.00	-2.35	8.22	3.15
140	83.4	13.00	12.00	32.00	-7.06	5.47	0.90
141	101.6	14.00	14.00	35.00	-3.65	8.30	1.30
142	79.6	25.00	10.00	43.00	19.32	2.56	1.20
143	89.2	20.00	7.00	34.00	12.10	-1.34	7.26
144	78.8	18.00	10.00	37.00	4.19	2.68	0.80
145	82.2	20.00	6.00	37.00	11.20	-3.71	0.87
146	77.1	15.00	8.00	28.00	0.12	-3.98	1.16
147	77.8	10.00	7.00	34.00	-14.06	5.47	0.85
148	78.8	19.00	8.00	37.00	7.20	-0.02	0.83
149	73.1	24.00	9.00	42.00	16.29	1.21	0.49
150	76.9	16.00	5.00	31.00	2.20	-3.99	0.56
151	76.3	22.00	13.00	41.00	10.71	6.61	1.32
152	76.7	7.00	9.00	23.00	-18.91	1.51	1.66

SAM NO	H#	3H CPM	14C CPM	WIDE CPM	3H DPM	14C DPM	LUMEX %
154	79.3	23.00	12.00	39.00	13.94	5.27	0.54
155	79.6	13.00	9.00	32.00	-5.89	1.42	0.69
156	76.9	19.00	11.00	40.00	5.50	3.99	0.75
157	77.7	23.00	10.00	42.00	14.64	2.59	1.00
158	82.4	14.00	10.00	35.00	-3.94	2.76	1.05
159	73.4	14.00	12.00	33.00	-5.98	5.38	0.56
160	76.8	21.00	9.00	39.00	10.72	1.28	0.63
161	75.2	17.00	8.00	37.00	2.53	-0.00	1.21
162	78.0	15.00	13.00	34.00	-3.88	6.74	0.66
163	77.2	23.00	12.00	46.00	13.51	5.26	0.48
164	78.4	11.00	11.00	34.00	-11.33	4.13	0.64
165	76.0	13.00	10.00	34.00	-6.80	2.74	0.54
166	72.7	20.00	9.00	37.00	7.90	1.27	0.46
167	78.4	24.00	9.00	48.00	17.45	1.23	0.69
168	80.5	16.00	10.00	33.00	0.15	2.72	2.08
169	79.0	16.00	10.00	31.00	-0.06	2.71	1.00
170	80.7	23.00	11.00	46.00	14.75	3.94	0.74
171	73.0	12.00	14.00	33.00	-11.18	8.08	0.70
172	79.2	12.00	5.00	25.00	-6.01	-3.92	1.31
173	81.2	16.00	5.00	27.00	2.86	-3.98	3.92
174	75.3	14.00	11.00	36.00	-5.27	4.06	0.59
175	75.6	22.00	11.00	37.00	11.60	3.93	0.94
176	72.1	16.00	10.00	40.00	-0.98	2.67	0.34
177	80.8	9.00	4.00	21.00	-11.78	-5.21	0.85
178	82.0	23.00	6.00	45.00	17.67	-2.76	0.53
179	74.2	11.00	18.00	39.00	-15.19	13.45	0.68
180	80.8	14.00	16.00	39.00	208.64	9.12	0.56
181	81.0	16.00	9.00	33.00	0.74	1.38	1.58
182	73.3	13.00	10.00	33.00	-7.07	2.73	0.62
183	82.4	19.00	12.00	49.00	5.89	5.36	0.77
184	78.2	16.00	6.00	29.00	1.89	-2.65	0.76
185	74.5	16.00	8.00	39.00	0.34	0.01	0.59
186	79.7	17.00	10.00	38.00	2.18	2.70	0.84
187	74.4	18.00	11.00	40.00	3.00	3.99	0.52
188	78.2	16.00	10.00	29.00	-0.18	2.70	0.84
189	73.6	20.00	6.00	35.00	9.56	-2.73	0.62
190	75.0	18.00	9.00	43.00	4.09	1.32	0.73
191	77.5	11.00	9.00	31.00	-10.38	1.44	0.93
192	78.2	15.00	13.00	42.00	-3.85	6.74	0.51
193	79.0	15.00	7.00	32.00	-0.65	-1.29	1.01
194	73.0	21.00	13.00	43.00	8.03	6.60	0.44
195	71.9	12.00	8.00	26.00	-8.29	0.06	0.70
196	75.2	25.00	8.00	45.00	19.35	-0.13	0.33
197	72.1	13.00	8.00	31.00	-6.20	0.05	0.67
198	75.3	17.00	11.00	39.00	1.02	4.01	0.84
199	75.7	20.00	8.00	40.00	8.93	-0.05	0.66
200	73.3	17.00	10.00	39.00	1.26	2.66	0.41
201	73.3	21.00	10.00	39.00	9.58	2.60	0.51
202	75.8	29.00	10.00	55.00	26.89	2.48	0.32
203	75.2	25.00	11.00	51.00	17.82	3.88	0.34
204	74.0	17.00	11.00	35.00	0.85	4.00	0.45
205	75.3	23.00	8.00	51.00	15.16	-0.10	0.30
206	74.3	20.00	13.00	46.00	-6.16	6.63	0.48
207	75.3	18.00	5.00	32.00	6.18	-4.03	0.44
208	76.4	22.00	14.00	47.00	10.23	7.95	0.98
209	75.3	17.00	7.00	33.00	3.05	-1.34	0.60
210	75.8	20.00	10.00	38.00	7.93	2.63	0.47

SAM NO	H#	3H CPM	14C CPM	WIDE CPM	3H DPM	14C DPM	LUMEX %
211	73.7	18.00	8.00	37.00	4.40	-0.03	0.54
212	77.2	18.00	5.00	25.00	6.49	-4.02	0.76
213	77.4	17.00	13.00	37.00	0.30	6.70	4.67
214	76.0	29.00	9.00	43.00	27.45	1.14	0.66
215	75.6	17.00	12.00	33.00	0.57	5.35	0.53
216	76.8	12.00	6.00	23.00	-6.78	-2.59	1.64
217	74.0	14.00	11.00	41.00	-5.42	4.05	0.56
218	73.5	24.00	14.00	49.00	13.86	7.89	0.80
219	81.2	17.00	10.00	37.00	2.40	2.70	0.74
220	80.1	27.00	4.00	38.00	26.89	-5.51	0.46
221	80.3	17.00	9.00	38.00	2.79	1.36	1.00
222	80.3	14.00	7.00	30.00	-2.63	-1.27	1.46
223	78.6	18.00	7.00	36.00	5.69	-1.34	0.62
224	78.9	18.00	11.00	42.00	3.68	4.01	0.74
225	75.8	14.00	10.00	38.00	-4.71	2.72	0.48
226	79.7	14.00	10.00	30.00	-4.26	2.75	0.64
227	75.0	16.00	13.00	36.00	-2.12	6.70	0.48
228	78.9	15.00	8.00	40.00	-1.18	0.05	0.60
229	78.8	16.00	5.00	30.00	2.50	-3.99	0.49
230	76.2	34.00	62.00	111.00	11.07	71.95	0.16
231	73.6	20.00	13.00	46.00	6.05	6.62	0.39
232	77.4	21.00	8.00	37.00	11.35	-0.06	0.51
233	75.4	15.00	7.00	33.00	-1.13	-1.31	0.63
234	79.3	25.00	10.00	40.00	19.25	2.56	0.75
235	80.4	16.00	8.00	29.00	1.18	0.04	0.98
236	74.0	14.00	10.00	37.00	-4.91	2.71	0.43
237	79.7	23.00	5.00	39.00	17.67	-4.10	0.37
238	74.8	19.00	9.00	42.00	6.17	1.30	0.36
239	74.3	28.00	9.00	48.00	24.91	1.15	0.39
240	76.7	11.00	11.00	33.00	-11.47	4.12	0.74
241	75.1	21.00	12.00	39.00	8.90	5.28	0.56
242	76.7	31.00	11.00	53.00	30.84	3.79	0.83
243	74.8	20.00	6.00	38.00	9.79	-2.73	0.31
244	76.2	32.00	17.00	55.00	29.77	11.79	8.81
245	77.0	22.00	9.00	41.00	12.88	1.26	0.98
246	78.5	21.00	10.00	40.00	10.54	2.62	0.33
247	77.6	29.00	11.00	47.00	26.85	3.82	0.32
248	75.9	19.00	7.00	34.00	7.36	-1.37	0.93
249	78.5	23.00	8.00	45.00	15.84	-0.09	0.29
250	82.0	21.00	12.00	43.00	10.16	5.33	0.52
251	77.3	19.00	9.00	38.00	6.59	1.31	0.36
252	82.8	22.00	9.00	44.00	14.09	1.29	0.49
253	83.9	23.00	6.00	38.00	18.11	-2.75	15.74
254	81.3	24.00	10.00	48.00	17.57	2.59	5.35
255	87.8	26.00	10.00	42.00	23.60	2.58	45.70
256	80.4	18.00	6.00	31.00	6.53	-2.68	0.55
257	93.5	21.00	5.00	34.00	16.49	-4.05	2.56
258	80.9	20.00	8.00	36.00	9.88	-0.03	0.59
259	80.3	19.00	15.00	46.00	3.98	9.37	0.37
260	81.3	15.00	6.00	30.00	0.19	-2.63	0.77
261	74.5	26.00	15.00	52.00	17.75	9.20	0.32
262	79.7	19.00	12.00	40.00	5.43	5.34	0.39
263	78.0	16.00	10.00	36.00	-0.21	2.70	0.42
264	76.8	20.00	9.00	39.00	8.61	1.29	0.25
265	75.0	20.00	10.00	40.00	7.80	2.62	0.42
266	73.7	8.00	15.00	40.00	-19.97	9.49	0.34
267	74.1	21.00	8.00	34.00	10.74	-0.07	0.34
268	75.0	12.00	8.00	29.00	-7.99	0.08	0.79

SAM NO	H#	3H CPM	14C CPM	WIDE CPM	3H DPM	14C DPM	LUMEX %
270	78.6	18.00	6.00	39.00	6.21	-2.68	0.20
270	76.2	19.00	16.00	44.00	2.84	10.67	0.54
271	75.4	13.00	12.00	37.00	-7.87	5.41	0.47
272	85.9	23.00	8.00	44.00	17.53	-0.06	0.54
273	76.8	26.00	8.00	44.00	21.83	-0.14	0.31
274	75.2	22.00	13.00	46.00	10.52	6.60	0.29
275	78.2	21.00	11.00	46.00	9.97	3.96	0.33
276	74.0	20.00	8.00	38.00	8.63	-0.06	0.93
277	73.6	21.00	10.00	37.00	9.63	2.60	0.36
278	73.8	25.00	11.00	41.00	17.51	3.87	0.41
279	79.5	21.00	14.00	42.00	8.66	7.99	0.44
280	73.4	21.00	10.00	45.00	9.61	2.60	0.36
281	77.5	19.00	11.00	36.00	5.60	3.99	0.48
282	80.8	14.00	8.00	28.00	-3.08	0.07	0.80
283	76.8	18.00	9.00	35.00	4.38	1.33	0.36
284	76.2	23.00	4.00	37.00	17.38	-5.45	0.44
285	88.9	20.00	12.00	41.00	9.29	5.39	1.09
286	82.9	25.00	10.00	48.00	20.11	2.58	0.48
287	95.9	16.00	9.00	35.00	3.11	1.45	32.65
288	80.1	24.00	12.00	44.00	16.25	5.26	0.98
289	78.8	17.00	10.00	39.00	2.04	2.69	0.31
290	76.0	15.00	6.00	33.00	-0.54	-2.64	0.48
291	73.9	23.00	11.00	41.00	13.36	3.90	0.41
292	76.0	21.00	9.00	37.00	10.58	1.27	0.41
293	75.6	28.00	8.00	45.00	25.74	-0.18	0.35
294	78.7	21.00	13.00	46.00	9.03	6.64	0.31
295	76.3	16.00	7.00	31.00	1.10	-1.32	0.51
296	76.3	18.00	10.00	43.00	3.79	2.66	0.39
297	81.0	36.00	20.00	67.00	38.20	15.79	0.80
298	82.3	19.00	7.00	34.00	8.52	-1.35	0.57
299	76.7	9.00	8.00	32.00	-14.17	0.14	0.47
300	77.0	18.00	13.00	35.00	2.36	6.68	0.46
301	74.2	27.00	8.00	48.00	23.31	-0.17	0.32
302	76.3	21.00	10.00	41.00	10.13	2.61	0.28
303	77.0	16.00	9.00	38.00	0.17	1.36	0.35
304	78.6	8.00	12.00	30.00	-18.24	5.52	0.65
305	95.1	11.00	7.00	25.00	-7.52	-1.16	0.70
306	81.4	29.00	12.00	49.00	27.36	5.19	4.69
307	76.3	21.00	11.00	40.00	9.61	3.95	0.40
308	76.8	21.00	11.00	40.00	9.72	3.95	0.27
309	82.6	18.00	10.00	40.00	4.81	2.70	1.15
310	84.1	25.00	8.00	44.00	21.48	-0.10	5.31
311	77.7	19.00	7.00	35.00	7.67	-1.36	1.33
312	79.4	18.00	14.00	46.00	2.21	8.04	0.27
313	77.1	43.00	15.00	69.00	54.36	8.94	0.28
314	78.0	29.00	9.00	48.00	27.99	1.15	0.49
315	78.6	17.00	11.00	43.00	1.50	4.03	0.32
316	71.9	9.00	10.00	30.00	-15.49	2.78	0.51
317	78.6	26.00	5.00	46.00	23.81	-4.16	0.31
318	73.9	20.00	8.00	38.00	8.60	-0.06	0.74
319	80.1	17.00	2.00	29.00	6.41	-8.02	0.76
320	76.7	18.00	8.00	36.00	4.87	-0.01	0.41
321	74.1	14.00	12.00	34.00	-5.91	5.39	0.47
322	78.6	20.00	7.00	35.00	9.96	-1.38	0.36
323	75.2	16.00	18.00	40.00	-4.63	13.38	0.44
324	79.0	22.00	10.00	39.00	12.77	2.61	0.48
325	77.5	20.00	9.00	33.00	8.74	1.30	0.39
326	88.1	19.00	14.00	44.00	5.81	8.09	0.61

SAM NO	H#	3H CPM	14C CPM	WIDE CPM	3H DPM	14C DPM	LUMEX %
328	90.1	13.00	7.00	34.00	-3.55	-1.22	0.62
328	75.6	14.00	8.00	30.00	-3.71	0.05	0.53
329	76.4	12.00	7.00	28.00	-7.34	-1.25	0.60

ID: EQUIPMENT SURVY

17 NOV 2000 11:35

NUMBER: 1 COMMENT: EQUIPMENT SURVEY

PRESET TIME : 1.00
 DATA CALC : DL DPM H# : YES SAMPLE REPEATS: 1 PRINTER : EDIT
 COUNT BLANK : YES IC# : NO REPLICATES : 1 RS232 : EDIT
 TWO PHASE : NO AQC : YES CYCLE REPEATS : 1
 SCINTILLATOR: LIQUID LUMEX: YES LOW SAMPLE REJ: 0
 LOW LEVEL : NO HALF LIFE CORRECTION DATE: none

ISOTOPE 1: 3H %ERROR: 2.00 FACTOR: 1.0000 BKG. SUB: 0
 ISOTOPE 2: 14C %ERROR: 2.00 FACTOR: 1.0000 BKG. SUB: 0
 WIDE OPEN WINDOW %ERROR: 0.00 FACTOR: 1.0000 BKG. SUB: 0

BACKGROUND QUENCH CURVE: Off COLOR QUENCH CORRECTION: Off

Quench Limits Low: 13.688 High: 306.34

SAM NO	H#	3H CPM	14C CPM	WIDE CPM	3H DPM	14C DPM	LUMEX %
B1	72.6	17.00	14.00	38.00	28.29	18.42	5.34
		Blank Average DPM for		3H :	28.29	COEF. OF VAR: 0.000	
		Blank Average DPM for		14C :	18.42	COEF. OF VAR: 0.000	

330	1	73.8	20.00	8.00	33.00	9.42	-8.05	47.77
331	2	73.7	22.00	10.00	44.00	12.58	-5.41	11.97
332	3	74.2	19.00	8.00	37.00	7.41	-8.04	5.96
3		72.0	20.00	10.00	39.00	8.12	-5.39	4.06
316	5	84.2	24.00	11.00	48.00	18.54	-4.05	5.33
317	6	75.4	24.00	14.00	53.00	15.08	-0.09	3.33
318	7	74.5	19.00	18.00	44.00	2.41	5.33	3.33
319	8	112.9	13.00	9.00	32.00	-0.49	-6.40	18.68
320	9	74.2	12.00	5.00	28.00	-5.72	-11.93	2.23
321	10	89.3	17.00	13.00	44.00	2.89	-1.21	5.29
322	11	78.5	40.00	32.00	85.00	40.56	23.77	2.59
323	12	80.2	31.00	15.00	53.00	30.61	1.17	2.69
324	13	74.0	25.00	14.00	51.00	18.97	-0.13	2.68
325	14	100.0	19.00	11.00	38.00	10.67	-3.87	19.09
326	15	79.0	20.00	7.00	34.00	10.88	-9.37	3.14
327	16	75.1	18.00	10.00	33.00	4.45	-5.34	2.36
328	17	82.0	21.00	12.00	40.00	11.00	-2.67	3.44
329	18	74.1	23.00	9.00	42.00	15.24	-6.76	2.30
330	19	74.4	16.00	11.00	35.00	-0.36	-3.98	3.30
331	20	72.2	25.00	7.00	42.00	20.01	-9.47	2.19
332	21	77.6	25.00	7.00	39.00	21.24	-9.46	1.40
333	22	76.9	18.00	5.00	31.00	7.27	-12.02	1.19
334	23	73.6	30.00	9.00	46.00	29.73	-6.88	1.84
335	24	85.2	19.00	21.00	47.00	2.39	9.48	2.83
336	25	72.1	15.00	12.00	36.00	-3.22	-2.64	1.78
337	26	84.3	27.00	9.00	45.00	26.23	-6.79	5.26

ID: MONTHLY WIFES

20 NOV 2000 20:39

USER: 4 COMMENT:

PULSE TIME : 1.00
 DATA CALC : DL DPM H# : YES SAMPLE REPEATS: 1 PRINTER : EDIT
 COUNT BLANK : YES IC# : NO REPLICATES : 1 RS232 : EDIT
 TWO PHASE : NO AQC : YES CYCLE REPEATS : 1
 SCINTILLATOR: LIQUID LUMEX: YES LOW SAMPLE REJ: 0
 LOW LEVEL : NO HALF LIFE CORRECTION DATE: none

ISOTOPE 1: 3H %ERROR: 2.00 FACTOR: 1.0000 BKG. SUB: 0
 ISOTOPE 2: 14C %ERROR: 2.00 FACTOR: 1.0000 BKG. SUB: 0
 WIDE OPEN WINDOW %ERROR: 0.00 FACTOR: 1.0000 BKG. SUB: 0

BACKGROUND QUENCH CURVE: Off COLOR QUENCH CORRECTION: Off

Quench Limits Low: 13.688 High: 306.34

SAM NO	H#	3H CPM	14C CPM	WIDE CPM	3H DPM	14C DPM	RATIO	LUMEX %
B1	74.2	16.00	9.00	36.00	28.92	11.76	2.458	0.40
		Blank Average	DPM	for	3H :	28.92	COEF. OF VAR:	0.000
		Blank Average	DPM	for	14C :	11.76	COEF. OF VAR:	0.000
333	82.8	19.00	9.00	46.00	7.75	-0.01	-991.5	1.18
331	88.6	14.00	16.00	40.00	-6.22	9.53	-0.652	1.36
335	99.2	18.00	12.00	37.00	6.90	4.15	1.663	0.99