

Radiological Survey Sheet

Job Location Pfizer Central Research Groton 118/370 Page 1 of 14
 Survey Purpose Radiological Assessment Date 9/24/01
 Performed By Pam Jones (Print) Pam Jones (Sign)

Inst.(1) Beckman LS 6500 (Model/SN) #7060743	Inst.(2) Ludlum 2241-2 (Model/SN) #163603	Inst.(3) (Model/SN)
Det. Internal (Model/SN)	Det. Ludlum 43-68 (Model/SN) #PR149613	Det. (Model/SN)
Eff. See LSC Printout	Eff. \approx 8% C14	Eff.
Type rad. β	Type rad. β	Type rad.
Bkgd. See LSC Printout	Bkgd. 300 cpm	Bkgd.
Cal. Due: 5/1/02	Cal. Due 1/20/02	Cal. due

No.	Time	Location	Inst. Used	Total Activity (dpm/100 cm ²)
1.	0900	Floor	1	See attached LSC Printout
2.			1	
3.			1	
4.			1	
5.			1	
6.			1	
7.			1	
8.			1	
9.			1	
10.		↓	1	
11.		door	1	
12.		↓	1	
13.		wall	1	
14.			1	
15.			1	
16.		↓	1	
17.		counter	1	
18.	✓	out. container	1	↓

Radiological Survey Continuation Sheet

Page 2
Date 9/24/01

No.	Time	Location	Inst. Used	Total Activity (dpm/100 cm ²)
19		inside container	1	See attached LSC Printout
20		outside hood top left	1	
21		top right	1	
22		glove + handles	1	
23			1	
24			1	
25			1	
26		ledge	1	
27			1	
28		inside hood left side	1	
29		top shelf	1	
30		shelf	1	
31		bottom shelf	1	
32		top back	1	
33		bottom back	1	
34		counter	1	
35			1	
36		cup sink	1	
37			1	
38		inside hood top back	1	
39		bottom back	1	✓ (see # 20)
40		right side	1	
41		counter	1	
42			1	
43		cup sink	1	
44		out. cabinet	1	
45		left	1	
46		bottom	1	

Radiological Survey Continuation Sheet

Page 3 of 14

Date 9/24/01

No.	Time	Location	Inst. Used	Total Activity (dpm/100 cm ²)
47		right		
48		off cabinet	1	See attached LSC Printout
49		left	1	
50		bottom	1	
51		right	1	
52		wall	1	
53		↓	1	
54		door	1	
55		out shelves	1	
56		↓	1	
57		top shelf	1	
58		bottom shelf	1	
59		floor	1	
60		↓	1	
61		↓	1	
62		↓	1	
63		↓	1	
64		↓	1	
65		wall	1	
66		door	1	
67		wall	1	
68		shelves	1	
69		desk top	1	
70		radiator	1	
71		desk top	1	
72		shelves	1	
73		door	1	
74	↓	floor	1	↓

Radiological Survey Continuation Sheet

Page 4 of 14

Date 9/24/01

No.	Time	Location	Inst. Used	Total Activity (dpm/100 cm ²)
75		wall		
76		counter	1	See attached LSC Printout
77			1	
78			1	
79			1	
80		↓ sides of sink	1	
81		bottom	1	
82		drain	1	
83		plg.	1	
84			1	
85			1	
86			1	
87			1	
88			1	
89			1	
90			1	
91		↓	1	
92		plg.	1	
93			1	
94			1	
95			1	
96			1	
97			1	
98			1	
99			1	
100			1	
101		plg #18	1	√ (see #202)
102	✓	plg.	1	

Radiological Survey Continuation Sheet

Page 5
9/24/01

No.	Time	Location		
103		↓		
104		↓	1	See attached LSC Printout
105		↓	1	
106		↓	1	
107		↓	1	
108		↓	1	
109		↓ pig	1	
110		↓ pig # 27	1	√ (see # 3)
111		↓	1	
112		↓	1	
113		↓ pig	1	
114		out. shelves	1	
115		top shelf	1	
116		shelf	1	
117		bot. shelf	1	
118		out. shelves	1	
119		top shelf	1	
120		shelf	1	
121		bot. shelf	1	
122		out. shelves	1	
123		top shelf	1	
124		shelf	1	
125		bot. shelf	1	
126		shelf	1	
127		shelf	1	
128		out. drawers	1	
129		top drawer	1	
130	↓	drawer	1	↓

Radiological Survey Continuation Sheet

6 of 14
9/25/01

No.	Time	Location	Inst. Used	Total Activity (dpm/100 cm ²)
131		drawer		
132		bot. drawer		See attached LSC Printout
133		out. drawer		
134		top drawer		
135		drawer		
136		↓	1	
137		bot. drawer		
138		out. drawers		
139		left top drawer	1	
140		right top drawer		
141		left		
142		bottom		
143		right		
144		out. drawers		
145		left drawer top	1	
146		↓	1	
147		↓	1	
148		right drawer top	1	
149		↓	1	
150		↓	1	
151		left drawer	1	
152		right drawer	1	
153		drawer	1	
154		bot. drawer	1	
155		out. cabinet	1	
156		left	1	
157		bottom	1	
158		right	1	

Radiological Survey Continuation Sheet

Page 7 of 14
 Date 9/25/01

No.	Time	Location	Inst. Used	Total Activity (dpm/100)
159		Floor		
160			1	See attached LSC Printout
161			1	
162		↓	1	
163		• glass door	1	
164		• wall	1	
165		out. shelves	1	
166		shelves	1	
167		wall	1	
168		↓	1	
169		glass door	1	
170		shelves	1	
171		desktop	1	
172		radiator	1	
173		shelves	1	
174		desktop	1	
175		wall	1	
176		↓		
177		Floor		
178		Floor		
179			1	
180			1	
181			1	
182			1	
183			1	
184			1	
185			1	
186	↓	↓ door	1	
			1	↓

Radiological Survey Continuation Sheet

Page 8 of 14

Date 9/25/01

No.	Time	Location	Inst. Used	Total Activity (dpm/100 cm ²)
187		wall		
188		↓	1	See attached LSC Printout
189			1	
190		↓	1	
191		wall	1	
192		↓	1	
193		wall	1	
194		↓	1	
195		↓	1	
196		wall	1	
197		↓	1	
198		shelf	1	
199		counter	1	
200		wall	1	
201		post de.com # 39	1	
202		↓ #100	1	
203	✓	↓ #109	1	✓ rad waste
204			1	↓
205			1	
206			1	
207			1	
208			1	
209			1	
210			1	
211			1	
212			1	
213			1	
214			1	

Bld. 118 Room 370

O = WIPOR LOCATION

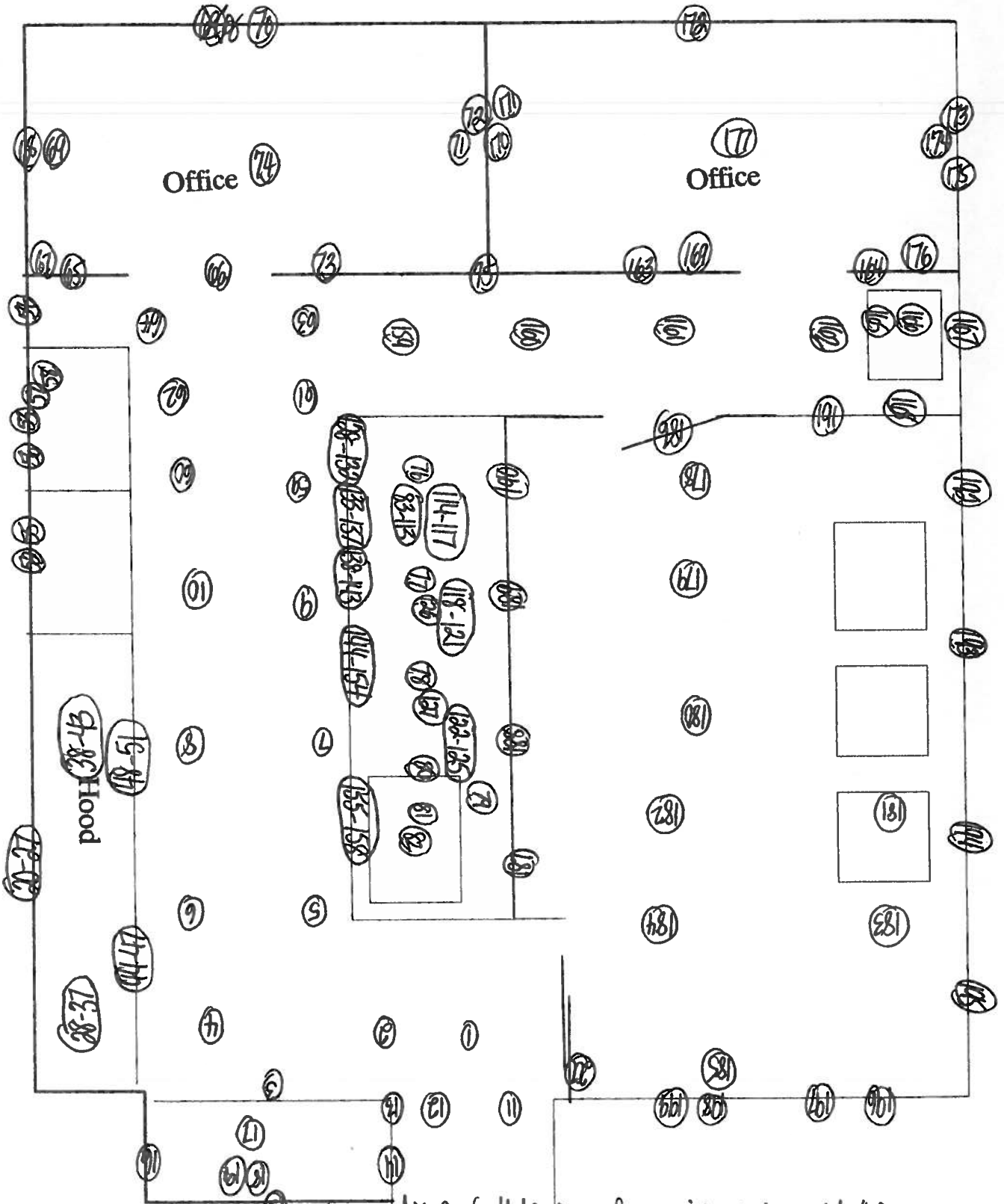

Surveyed 100% of all lower surfaces using instrument #2
all areas were found to be at normal background levels.

ID # EQUIPMENT SURVY

25 SEP 2001 15:05

USER: 2 COMMENT: EQUIPMENT SURVEY

PRESET TIME : 1.00
 DA CALC : DL DPM H# : YES SAMPLE REPEATS: 1 PRINTER : EDIT
 COUNT BLANK : YES IC# : NO REPLICATES : 1 RS232 : STD
 TWO PHASE : NO AQC : YES CYCLE REPEATS : 1
 SCINTILLATOR: LIQUID LUMEX: YES LOW SAMPLE REJ: 0
 LOW LEVEL : NO HALF LIFE CORRECTION DATE: none

ISOTOPE 1: 3H %ERROR: 2.00 FACTOR: 1.0000 BKG. SUB: 0
 ISOTOPE 2: 14C %ERROR: 2.00 FACTOR: 1.0000 BKG. SUB: 0
 WIDE OPEN WINDOW %ERROR: 0.00 FACTOR: 1.0000 BKG. SUB: 0

BACKGROUND QUENCH CURVE: Off COLOR QUENCH CORRECTION: Off

Quench Limits Low: 13.688 High: 306.34

SAM NO	H#	3H CPM	14C CPM	WIDE CPM	3H DPM	14C DPM	LUMEX %	
B1	84.4	18.00	10.00	36.00	34.23	13.12	0.87	
		Blank Average DPM for		3H :	34.23	COEF. OF VAR:		0.000
		Blank Average DPM for		14C :	13.12	COEF. OF VAR:		0.000
1	99.2	16.00	13.00	40.00	-3.75	4.18	0.53	
2	88.5	15.00	8.00	29.00	-4.92	-2.62	0.79	
3	93.3	12.00	7.00	34.00	-10.53	-3.89	0.70	
4	86.4	17.00	15.00	46.00	-4.57	6.75	0.59	
5	89.9	15.00	11.00	32.00	-6.37	1.43	0.63	
6	84.5	21.00	7.00	36.00	8.22	-4.08	0.49	
7	95.3	17.00	7.00	32.00	1.37	-3.98	0.64	
8	84.7	13.00	10.00	36.00	-10.96	0.09	0.83	
9	93.4	21.00	11.00	42.00	7.97	1.35	0.64	
10	86.8	11.00	3.00	24.00	-11.37	-9.28	1.03	
11	78.8	16.00	6.00	27.00	-3.13	-5.35	0.50	
12	78.5	18.00	9.00	31.00	-0.45	-1.37	0.68	
13	80.5	14.00	9.00	28.00	-8.75	-1.29	0.63	
14	86.1	11.00	11.00	30.00	-15.76	1.48	0.79	
15	89.5	12.00	9.00	31.00	-12.09	-1.21	0.70	
16	86.3	18.00	7.00	34.00	1.94	-4.02	0.64	
17	96.9	14.00	8.00	30.00	-5.93	-2.56	0.99	
18	91.9	12.00	16.00	36.00	-15.72	8.24	0.62	
19	88.1	13.00	12.00	34.00	-11.64	2.80	0.67	
20	81.2	15.00	12.00	35.00	-8.06	2.72	0.61	
21	80.2	17.00	9.00	36.00	-2.32	-1.35	0.49	
22	94.3	11.00	9.00	27.00	-13.85	-1.17	0.79	
23	86.3	22.00	5.00	34.00	11.90	-6.78	0.46	
24	83.8	27.00	12.00	53.00	18.55	2.53	0.39	
25	86.7	16.00	16.00	40.00	-7.30	8.12	0.54	
26	89.6	21.00	18.00	47.00	3.29	10.75	0.51	
27	98.5	17.00	13.00	39.00	-1.48	4.16	0.55	
28	86.4	20.00	8.00	34.00	5.87	-2.71	0.57	
29	86.7	15.00	12.00	40.00	-7.36	2.76	0.38	
30	89.0	6.00	6.00	24.00	-24.01	-5.15	0.75	
31	85.2	12.00	10.00	33.00	-13.10	0.11	0.48	
32	94.9	10.00	19.00	38.00	-21.78	12.37	0.47	
33	111.1	8.00	12.00	30.00	-21.37	3.08	0.48	
34	97.2	20.00	10.00	35.00	7.07	0.03	0.45	
35	107.8	16.00	11.00	41.00	-0.99	1.53	0.60	
36	100.2	14.00	17.00	42.00	-10.70	9.65	0.56	

SAM NO	H#	3H CPM	14C CPM	WIDE CPM	3H DPM	14C DPM	LUMEX %
37	92.1	8.00	15.00	34.00	-24.30	6.97	0.68
38	85.2	10.00	6.00	24.00	-15.37	-5.23	1.11
39	112.2	120.00	57.00	184.00	237.89	62.19	0.11
40	88.0	18.00	13.00	41.00	-1.00	4.06	0.37
41	97.4	14.00	12.00	40.00	-8.17	2.85	0.52
42	98.7	13.00	8.00	37.00	-8.03	-2.54	0.85
43	98.0	15.00	16.00	47.00	-8.04	8.25	0.41
44	96.1	10.00	10.00	32.00	-16.56	0.21	0.59
45	81.2	9.00	9.00	29.00	-19.47	-1.21	0.73
46	102.0	18.00	11.00	41.00	2.75	1.45	0.59
47	79.8	17.00	8.00	32.00	-1.87	-2.69	0.43
48	89.0	8.00	14.00	29.00	-23.89	5.59	0.72
49	90.2	14.00	12.00	37.00	-9.13	2.80	0.46
50	93.8	16.00	11.00	34.00	-3.49	1.44	1.29
51	87.9	17.00	10.00	42.00	-1.63	0.04	0.40
52	87.8	14.00	10.00	29.00	-8.36	0.09	0.65
53	97.3	11.00	9.00	34.00	-13.52	-1.15	0.51
54	82.5	17.00	5.00	26.00	0.15	-6.70	0.76
55	82.8	13.00	5.00	26.00	-8.52	-6.63	0.83
56	81.8	15.00	11.00	36.00	-7.47	1.38	0.53
57	83.6	20.00	3.00	31.00	7.95	-9.44	0.81
58	86.3	14.00	8.00	28.00	-7.46	-2.61	0.67
59	94.5	10.00	6.00	21.00	-14.44	-5.20	1.35
60	90.1	11.00	13.00	28.00	-16.50	4.20	0.68
61	103.7	18.00	16.00	43.00	0.11	8.26	0.81
62	90.2	13.00	6.00	33.00	-8.09	-5.27	0.53
63	90.5	14.00	9.00	30.00	-7.44	-1.24	0.66
64	93.6	10.00	10.00	26.00	-16.80	0.20	0.73
65	85.0	16.00	12.00	41.00	-5.38	2.73	0.33
66	84.8	6.00	6.00	27.00	-24.22	-5.17	0.62
67	84.1	17.00	12.00	34.00	-3.30	2.70	0.57
68	83.9	10.00	14.00	32.00	-19.75	5.51	0.56
69	84.5	15.00	11.00	42.00	-7.12	1.40	0.49
70	88.2	17.00	10.00	29.00	-1.58	0.04	0.59
71	91.0	16.00	10.00	34.00	-3.37	0.07	0.69
72	85.1	9.00	9.00	31.00	-19.19	-1.18	0.39
73	81.8	14.00	14.00	39.00	-11.21	5.42	0.55
74	83.3	14.00	12.00	36.00	-9.99	2.75	0.56
75	87.9	21.00	10.00	39.00	7.32	-0.03	0.32
76	90.3	16.00	14.00	56.00	-5.69	5.46	0.41
77	93.8	21.00	16.00	51.00	5.25	8.10	0.48
78	95.1	16.00	9.00	41.00	-2.13	-1.26	0.60
79	98.1	19.00	5.00	34.00	7.81	-6.71	0.97
80	80.5	18.00	9.00	40.00	-0.12	-1.36	0.51
81	87.2	17.00	10.00	37.00	-1.74	0.03	3.76
82	80.4	21.00	12.00	40.00	4.75	2.61	0.45
83	84.4	19.00	13.00	36.00	0.60	4.01	0.47
84	83.9	17.00	5.00	32.00	0.39	-6.70	0.51
85	89.6	14.00	7.00	36.00	-6.47	-3.94	0.47
86	90.0	11.00	10.00	31.00	-14.85	0.16	0.76
87	87.8	18.00	12.00	44.00	-0.50	2.71	0.40
88	91.3	14.00	8.00	31.00	-6.78	-2.59	0.56
89	87.2	16.00	10.00	40.00	-3.98	0.05	0.55
90	88.0	8.00	4.00	17.00	-18.49	-7.88	1.15
91	88.9	18.00	14.00	47.00	-1.40	5.41	0.40
92	92.0	9.00	11.00	29.00	-19.78	1.55	0.70
93	88.8	8.00	10.00	30.00	-21.71	0.20	0.68
94	89.5	18.00	9.00	35.00	1.44	-1.32	0.43

SAM NO	H#	3H CPM	14C CPM	WIDE CPM	3H DPM	14C DPM	LUMEX %
95	83.5	5.00	9.00	33.00	-28.06	-1.13	0.64
96	81.2	16.00	11.00	39.00	-5.38	1.36	0.47
97	87.7	18.00	7.00	32.00	2.20	-4.02	0.52
98	87.7	12.00	20.00	41.00	-18.28	13.58	0.40
99	85.5	20.00	7.00	33.00	6.23	-4.06	0.44
100	81.2	5981.00	37.00	6029.00	12884.29	-64.35	0.01
101	82.5	22.00	6.00	35.00	10.50	-5.45	0.47
102	89.1	23.00	13.00	41.00	10.44	3.98	0.45
103	83.3	37.00	5.00	55.00	44.02	-7.04	0.35
104	88.5	15.00	13.00	39.00	-7.66	4.11	0.43
105	84.4	32.00	19.00	59.00	25.98	11.85	0.28
106	90.3	22.00	7.00	35.00	11.78	-4.08	0.60
107	88.9	26.00	9.00	44.00	19.33	-1.46	0.30
108	83.7	14.00	12.00	39.00	-9.93	2.75	0.34
109	93.4	37.00	35.00	81.00	31.35	33.46	0.25
110	91.1	18.00	9.00	35.00	1.75	-1.31	0.53
111	91.5	11.00	19.00	43.00	-19.70	12.30	0.47
112	96.8	21.00	11.00	43.00	8.76	1.37	0.36
113	88.8	20.00	8.00	36.00	6.38	-2.70	0.47
114	85.8	11.00	13.00	32.00	-16.87	4.16	0.57
115	84.8	18.00	12.00	35.00	-1.00	2.69	0.65
116	82.1	16.00	10.00	33.00	-4.73	0.02	0.63
117	82.2	12.00	12.00	37.00	-14.47	2.77	0.66
118	87.9	8.00	7.00	22.00	-20.14	-3.84	0.71
119	85.1	9.00	10.00	27.00	-19.73	0.16	0.77
120	83.2	21.00	11.00	39.00	5.83	1.28	0.62
121	84.7	17.00	11.00	37.00	-2.67	1.36	0.75
122	84.1	26.00	9.00	49.00	18.05	-1.48	0.43
123	83.6	22.00	17.00	45.00	4.92	9.33	0.51
124	86.2	17.00	5.00	31.00	0.78	-6.70	0.63
125	83.1	7.00	7.00	26.00	-22.65	-3.85	0.98
126	93.9	14.00	19.00	43.00	-12.60	12.28	0.67
127	95.0	13.00	13.00	41.00	-11.40	4.20	0.79
128	84.9	21.00	13.00	48.00	5.10	3.98	0.55
129	83.8	9.00	14.00	29.00	-21.95	5.52	0.84
130	83.1	9.00	8.00	29.00	-18.81	-2.54	0.90
131	84.8	13.00	9.00	31.00	-10.40	-1.26	0.67
132	84.8	15.00	11.00	30.00	-7.07	1.40	0.57
133	87.3	13.00	14.00	36.00	-12.82	5.49	0.60
134	84.0	20.00	10.00	36.00	4.33	-0.04	0.61
135	84.5	12.00	18.00	40.00	-17.44	10.85	0.46
136	86.9	9.00	13.00	30.00	-21.22	4.21	0.72
137	87.5	16.00	16.00	37.00	-7.18	8.13	0.48
138	86.4	9.00	8.00	32.00	-18.56	-2.52	0.52
139	86.9	20.00	12.00	42.00	3.82	2.67	0.59
140	87.4	10.00	5.00	22.00	-14.62	-6.57	0.92
141	82.9	11.00	9.00	26.00	-14.99	-1.23	1.42
142	90.3	16.00	8.00	34.00	-2.38	-2.63	0.61
143	84.3	15.00	12.00	38.00	-7.68	2.74	0.60
144	89.8	15.00	14.00	34.00	-8.03	5.47	0.80
145	83.6	20.00	19.00	46.00	-0.53	12.05	0.52
146	86.8	12.00	15.00	37.00	-15.64	6.84	0.64
147	86.2	18.00	9.00	35.00	0.86	-1.33	0.54
148	83.8	19.00	8.00	34.00	3.16	-2.71	0.66
149	86.2	14.00	6.00	25.00	-6.40	-5.30	1.07
150	83.7	14.00	10.00	33.00	-8.87	0.06	0.62
151	82.5	16.00	10.00	38.00	-4.66	0.02	0.60
152	89.3	15.00	8.00	34.00	-4.81	-2.61	0.54

SAM NO	H#	3H CPM	14C CPM	WIDE CPM	3H DPM	14C DPM	LUMEX %
153	86.1	21.00	13.00	43.00	5.32	3.99	0.54
154	86.8	15.00	7.00	33.00	-4.64	-3.97	0.77
155	85.2	9.00	13.00	25.00	-21.33	4.19	0.96
156	84.7	18.00	12.00	34.00	-1.01	2.69	0.72
157	94.7	13.00	8.00	31.00	-8.60	-2.55	0.76
158	84.1	20.00	8.00	37.00	5.41	-2.72	0.80
159	91.2	11.00	7.00	30.00	-13.07	-3.88	0.86
160	94.1	10.00	3.00	27.00	-12.79	-9.26	0.81
161	97.7	13.00	9.00	36.00	-8.76	-1.19	0.65
162	106.5	17.00	12.00	40.00	0.63	2.86	0.80
163	83.6	16.00	9.00	31.00	-3.97	-1.31	0.76
164	82.9	20.00	8.00	33.00	5.17	-2.73	0.96
165	85.1	17.00	10.00	35.00	-2.08	0.02	0.90
166	88.7	13.00	9.00	33.00	-9.93	-1.23	0.84
167	89.3	17.00	9.00	34.00	-0.85	-1.50	0.78
168	86.9	16.00	11.00	36.00	-4.56	1.39	0.66
169	84.9	11.00	10.00	33.00	-15.34	0.12	0.68
170	92.6	12.00	11.00	29.00	-12.85	1.50	0.72
171	86.5	18.00	12.00	37.00	-0.72	2.70	0.65
172	93.6	14.00	13.00	36.00	-9.25	4.17	0.66
173	86.2	15.00	7.00	36.00	-4.73	-3.97	1.02
174	85.5	17.00	12.00	34.00	-3.09	2.71	0.79
175	86.4	17.00	7.00	36.00	-0.26	-4.01	0.65
176	84.2	16.00	7.00	29.00	-2.82	-4.00	0.79
177	96.7	20.00	15.00	41.00	4.09	6.79	1.35
178	101.2	12.00	13.00	39.00	-13.02	4.28	1.12
179	95.8	12.00	7.00	31.00	-10.21	-3.88	1.09
180	91.4	13.00	14.00	36.00	-12.37	5.52	0.67
181	100.4	16.00	5.00	33.00	1.16	-6.65	1.32
182	92.8	13.00	11.00	29.00	-10.53	1.49	1.25
183	93.8	14.00	7.00	32.00	-5.85	-3.93	0.95
184	97.6	14.00	9.00	34.00	-6.41	-1.21	1.04
185	103.4	17.00	13.00	39.00	-0.59	4.20	1.08
186	85.5	14.00	14.00	42.00	-10.79	5.45	0.45
187	82.0	14.00	16.00	38.00	-12.24	8.11	0.62
188	88.2	13.00	8.00	33.00	-9.46	-2.58	0.92
189	85.9	13.00	11.00	33.00	-11.35	1.44	0.75
190	85.9	16.00	9.00	31.00	-3.63	-1.30	0.74
191	83.0	21.00	17.00	47.00	2.61	9.34	0.64
192	86.8	15.00	11.00	32.00	-6.80	1.41	0.77
193	86.1	12.00	7.00	31.00	-11.39	-3.92	0.79
194	91.3	15.00	10.00	35.00	-5.61	0.09	0.65
195	85.0	14.00	14.00	38.00	-10.85	5.45	0.70
196	83.3	16.00	8.00	32.00	-3.49	-2.66	0.68
197	85.9	13.00	8.00	33.00	-9.74	-2.59	0.84
198	94.8	20.00	10.00	36.00	6.55	0.02	1.15
199	91.5	5.00	10.00	30.00	-28.39	0.27	0.99
200	102.9	22.00	9.00	38.00	13.88	-1.33	0.79

ID: EQUIPMENT SURVY
 USER: 2 COMMENT: EQUIPMENT SURVEY
 3 OCT 2001 11:53

PRESET TIME : 1.00
 CALC : DL DPM H# : YES SAMPLE REPEATS: 1 PRINTER : EDIT
 COUNT BLANK : YES IC# : NO REPLICATES : 1 RS232 : STD
 TWO PHASE : NO ABC : YES CYCLE REPEATS : 1
 SCINTILLATOR: LIQUID LUMEX: YES LOW SAMPLE REJ: 0
 LOW LEVEL : NO HALF LIFE CORRECTION DATE: none

ISOTOPE 1: 3H %ERROR: 2.00 FACTOR: 1.0000 BKG. SUB: 0
 ISOTOPE 2: 14C %ERROR: 2.00 FACTOR: 1.0000 BKG. SUB: 0
 WIDE OPEN WINDOW %ERROR: 0.00 FACTOR: 1.0000 BKG. SUB: 0

BACKGROUND QUENCH CURVE: Off COLOR QUENCH CORRECTION: Off

Quench Limits Low: 13.688 High: 306.34

BAM NO	H#	3H CPM	14C CPM	WIDE CPM	3H DPM	14C DPM	LUMEX %
81	83.0	15.00	5.00	30.00	30.09	6.46	0.61
		Blank Average	DFM	for	3H :	30.09	COEF. OF VAR: 0.000
		Blank Average	DFM	for	14C :	6.46	COEF. OF VAR: 0.000
<i>201</i>	93.0	15.00	17.00	43.00	-5.14	16.22	3.67
<i>202</i>	93.4	3276.00	28.00	3312.00	7501.85	-28.27	0.07
<i>203</i>	99.0	16.00	15.00	45.00	-0.80	13.56	3.97