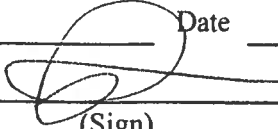

# Radiological Survey Sheet

Job Location Pfizer GROTON CT 06340 Page 1 of 15  
 Survey Purpose LAB DELON LAB 118 336 Date 4/4/05  
 Performed by P. KEEFE (Print)  (Sign)

Instrument (Model/S/N)	Packard Tri-Carb S/N 431521	Packard Tri-Carb S/N 431520	Ludlum 2241-2 163603
Det. (Model/SN)	Internal	Internal	Ludlum 43-68 PR 149613
Type Rad.	β	β	β
Cal. Due:	10/12/05	10/12/05	4/14/06 03/07/05 P
Check Instruments Used		X	✓

No.	Time	Locations	See attached LSC printout for Total Activity (cpm/100 cm <sup>2</sup> )	
1.	1140	BACKGROUND		
2.		ENTRANCE DOOR - LEFT - OUT		
3.		- IN		
4.		- RIGHT - OUT		
5.		- IN		
6.		Wall SWIPES - LEFT - UPPER		
7.		- LOWER		
8.		- REAR - LEFT		
9.		- RIGHT		
10.		- RIGHT - UPPER		
11.		- LOWER		
12.		Wall shelves - UPPER		
13.		- LOWER		
14.		SUPPORTS		
15.		Wall SWIPES - UPPER		
16.		- LOWER		
17.		✓	META RACK - TOP	
18.		1200	- SUPPORTS	

*PK*

# Radiological Survey Continuation Sheet

Page 2 of 15

Date 4/4/05

CAS DECON 118 336

No.	Time	Locations	See attached LSC printout for Total Activity (cpm/100 cm <sup>2</sup> )
19	1200	Wall SWIPES - LEFT	
20		- RIGHT	
21		OVERHEAD CABINET - OUTSIDE - SIDES	
22		- BOTTOM	
23		- DOORS - OUTSIDE	
24		- INSIDE	
25		- INSIDE - LEFT   RIGHT	
26		- BOTTOM	
27		- REAR	
28		- SHELVES	
29		Wall SWIPES - Right of METAL RACK - UPPER	
30		- LOWER	
31		- NARROW - UPPER	
32		- LOWER	
33		- LEFT - UPPER	
34		- LOWER	
35		- REAR - LEFT - UPPER	
36		- LOWER	
37		- RIGHT - UPPER	
38		- LOWER	
39		- RIGHT - UPPER <del>LOW</del>	
40		- LOWER	
41		BENCHTOP shelf - FRONT	
42		- REAR	
43		CABINET DOOR - OUT	
44	↓	- INSIDE	
45	1300	OUTSIDE CABINET - LEFT	

# Radiological Survey Continuation Sheet

Page 3 of 15

Date 4/4/05

LAB DELON 118 336

No.	Time	Locations	See attached LSC printout for Total Activity (cpm/100 cm <sup>2</sup> )
46	1300	CABINET - INSIDE - LEFT	
47			- RIGHT
48			- REAR
49			- BOTTOM
50			- shelf
51		Wall SWIPE - UPPER	
52			- LOWER
53		Wall SWIPE - LEFT - LEFT	
54			- RIGHT
55			- REAR - LEFT
56			- RIGHT
57			- RIGHT - UPPER
58			- LOWER
59		LAB DOOR - OUTSIDE	
60			- INSIDE
61		OFFICE GLASS DOOR - OUTSIDE	
62			- INSIDE
63		OFFICE shelves - UPPER	
64			- MIDDLE
65			- BOTTOM
66		SUPPORTS	
67		Wall UNDER shelves - LEFT	
68			- RIGHT
69		DESK SWIPES - LEFT	
70			- Right
71	↓		- DRAWS - OUT
72	1320		- IN

# Radiological Survey Continuation Sheet

Page 4 of 15

Date 4/04/05

LAB DECON 118 336

No.	Time	Locations	See attached LSC printout for Total Activity (cpm/100 cm <sup>2</sup> )
73	1325	Office shelves - UPPER	
74		- MIDDLE	
75		- BOTTOM	
76		SUPPORTS	
77		Wall UNDER shelves - LEFT	
78		- RIGHT	
79		GLASS PART OF DOOR	
80		Wall SWIPE - LEFT	
81		- RIGHT	
82		Office Glass door - OUTSIDE	
83		- INSIDE	
84		Office shelves - UPPER	
85		- MID	
86		- LOWER	
87		SUPPORTS	
88		Wall under shelves - LEFT	
89		- RIGHT	
90		DESK SWIPE	
91		DRAWNS - OUTSIDE	
92		- INSIDE	
93		Office shelves - UPPER	
94		- MID	
95		- LOWER	
96		SUPPORTS	
97		Wall SWIPES - LEFT - UPPER	
98	↓	- LOWER	
99	1340	Shelves - UPPER	

# Radiological Survey Continuation Sheet

Page 5 of 15

Date 4/4/05

(198) DECON 118 336

No.	Time	Locations	See attached LSC printout for Total Activity (cpm/100 cm <sup>2</sup> )
100	1340	Shelves - lower	
101		wall under shelves - LEFT	
102		- RIGHT	
103		shelves - UPPER	
104		- LOWER	
105		SUPPORTS	
106		wall under shelves	
107		Narrow wall - UPPER	
108		- LOWER	
109		BENCHTOP SWIPE - LEFT	
110		- RIGHT	
111		SUPPORTS	
112		wall behind bench - LEFT	
113		- RIGHT	
114		shelves - UPPER	
115		- LOWER	
116		SUPPORTS	
117		BENCHTOP (1)	
118		DRAWS - TOP - OUT/IN	
119		- UPPER MID - OUT/IN	
120		- LOWER MID - OUT/IN	
121		- Bottom - OUT/IN	
122		BENCHTOP (2)	
123		DRAWS - TOP - OUT/IN	
124		- UPPER <sup>(MID)</sup> - OUT/IN	
125	↓	- LOWER MID - OUT/IN	
126	1400	- Bottom - OUT/IN	

# Radiological Survey Continuation Sheet

Page 6 of 15

Date 4/4/05

LAB DECON 118 336

No.	Time	Locations	See attached LSC printout for Total Activity (cpm/100 cm <sup>2</sup> )
127	1400	BENCHTOP (3)	
128		DRAWS - TOP - OUTSIDE / INSIDE	
129		- UPPER MID - OUT / IN	
130		- LOWER MID - OUT / IN	
131		- BOTTOM - OUT / IN	
132		HOOD - OUTSIDE - LEFT	
133		- FRONT - TOP	
134		- MID	
135		- LOWER	
136		- GLASS SASH - OUTSIDE	
137		- INSIDE	
138		- INSIDE - UPPER - LEFT	
139		- RIGHT	
<del>140</del>		- MID / REAR - LEFT	
141		- RIGHT	
142		- RIGHT - UPPER	
143		- LOWER	
144		- LEFT - UPPER	
145		- LOWER	
146		- CABINET - DOORS - LEFT	
147		- OUT	
148		- INSIDE	
149		- INSIDE - LEFT	
150		- RIGHT	
151		- REAR	
152	↓	- BOTTOM	
153	1420	- shelf	

# Radiological Survey Continuation Sheet

Page 7 of 15

Date 4/4/05

LAB DECON 118 336

No.	Time	Locations	See attached LSC printout for Total Activity (cpm/100 cm <sup>2</sup> )
154	1420	CABINET (under hood) - Right - DOORS - OUT	
155			- INSIDE
156			- INSIDE - LEFT
157			- RIGHT
158			- REAR
159			- Bottom
160			- shelf
161		Wall SWIPES - LEFT - UPPER	
162			- LOWER
163		Wall CABINETS - DOORS - OUTSIDE	
164			- INSIDE
165			- INSIDE - LEFT
166			- RIGHT
167			- REAR
168			- Bottom
169			- shelf
170		Wall under CABINETS - LEFT	
171			- RIGHT
172		Wall SWIPES - RIGHT - UPPER	
173			- LOWER
174		SINK AREA - COUNTERTOP	
175		BASIN - LEFT / RIGHT	
176			- REAR / BOTTOM
177			- DRAIN
178		CABINET UNDER SINK - DOORS - OUT	
179	V		- INSIDE
180	1445		INSIDE - LEFT / RIGHT

# Radiological Survey Continuation Sheet

Page 8 of 15

Date 4/4/05

LAB DECON 118 336

No.	Time	Locations	See attached LSC printout for Total Activity (cpm/100 cm <sup>2</sup> )
181	1445	CABINET - INSIDE - REAR / BOTTOM	
182		- Shelf	
183		GLASS RACK	
184		Dispenser	
185		BENCHTOP	
186		CABINET - DOORS - OUT / INSIDE	
187		- INSIDE - LEFT / RIGHT	
188		- REAR / BOTTOM	
189		- Shelf	
190		DRAWLS - TOP - OUT / IN	
191		- UPPER MID ↓ ↓	
192		- LOWER MID ↓ ↓	
193		- Bottom out / IN	
194		METAL RACK	
195		SUPPORTS	
196		BENCHTOP	
197		DRAWLS - TOP - OUT / IN	
198		- UPPER MID - OUT / IN	
199		- LOWER MID - OUT / IN	
200		- Bottom - OUT / IN	
201		METAL RACK	
202		SUPPORTS	
203		Lg METAL RACK ON END - Shelves	
204		- SUPPORTS	
205		BENCHTOP - LEFT	
206	↓	- RIGHT	
207	1510	CABINET DOORS - OUT / IN	



# Radiological Survey Continuation Sheet

Page 9 of 15

Date 4/4/05

LAB DECON 118 336

No.	Time	Locations	See attached LSC printout for Total Activity (cpm/100 cm <sup>2</sup> )
208	1510	CABINET - INSIDE - LEFT / RIGHT	
209		- REAR / BOTTOM	
210		- Shelf	
211		BENCHTOP	
212		DRAWS - TOP - OUT / IN	
213		- UPPER MID - OUT / IN	
214		- LOWER MID - OUT / IN	
215		- Bottom - OUT / IN	
216		METAL RACK	
217		SUPPORTS	
218		BENCHTOP	
219		DRAWS - TOP - OUT / IN	
220		- UPPER MID - OUT / IN	
221		- LOWER MID - OUT / IN	
222		- Bottom - OUT / IN	
223		CABINET - DOOR - OUT / IN	
224		- INSIDE - LEFT / RIGHT	
225		- REAR / BOTTOM	
226		- Shelf	
227		OUTSIDE CABINET UNDER SINK AREA - LEFT	
228		- RIGHT	
229		FLOOR SWIPES	
<del>230</del>			
295	1600	FLOOR SWIPES	

**Bld. 118 Room 336**

Page 10 of 15

Date: 4/04/05

DECONTAMINATION TEST LOCATIONS

LAB. DECON 118 336

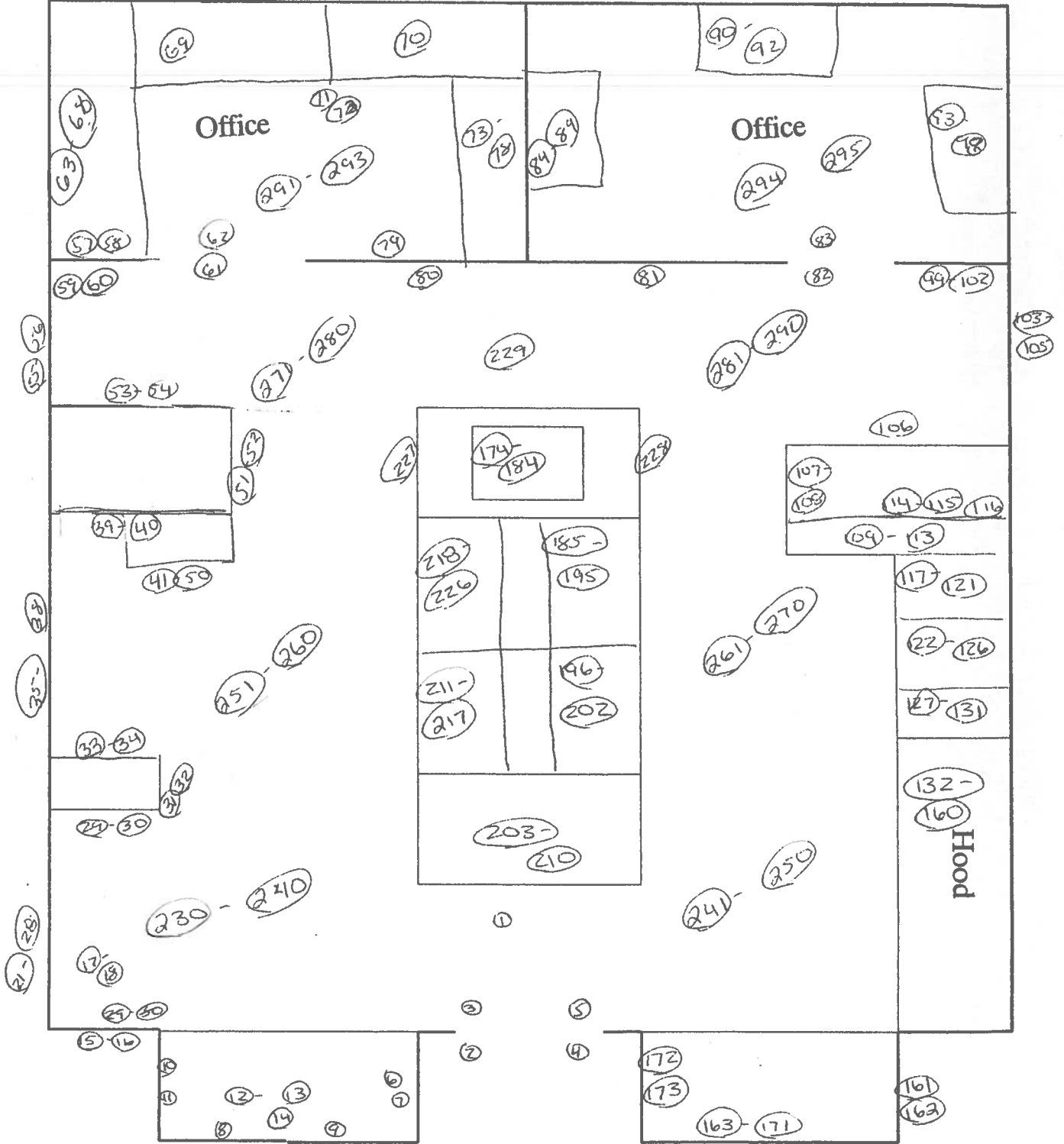

All surfaces surveyed and found to be within limits w/ Cesium 2241 and found to be within limits 5/3/05

Protocol# 10 - Room Decon.lsa

Lab Decon 118 336

User: Peter Keefe

Assay Definition-

Assay Description:  
Rad Room Monthly Swipes

Assay Type: CPM  
Report Name: Report1  
Output Data Path: C:\Packard\Tricarb\Results\Peter Keefe\Room Decon  
Raw Results Path: C:\Packard\Tricarb\Results\Peter Keefe\Room Decon\20050404\_1341.results  
Assay File Name: C:\Packard\TriCarb\Assays\Room Decon.lsa

Count Conditions-

Nuclide: TRIPLE  
Quench Indicator: tSIE/AEC  
External Std Terminator (sec): 0.5 2s%  
Pre-Count Delay (min): 0.00  
Quench Set: n/a  
Count Time (min): 1.00  
Count Mode: Normal  
Assay Count Cycles: 1 Repeat Sample Count: 1  
#Vials/Sample: 1 Calculate % Reference: Off

Background Subtract: Off  
Low CPM Threshold: Off  
2 Sigma % Terminator: Off

Regions	LL	UL
A	0.0	18.6
B	18.6	156.0
C	0.0	2000.0

Count Corrections-

Static Controller: On Luminescence Correction: On  
Colored Samples: n/a Heterogeneity Monitor: n/a  
Coincidence Time (nsec): 18 Delay Before Burst (nsec): 75

Half Life-

Half Life Correction: Off  
Regions Half Life Units Reference Date Reference Time  
A  
B  
C

Cycle 1 Results

S#	CPMA	CPMB	CPMC	MESSAGES
1	17	8	31	
2	17	3	30	
3	8	3	17	
4	9	6	21	
5	23	11	40	
6	9	10	25	
7	6	6	19	
8	10	9	30	
9	7	10	24	
10	1	9	15	
11	8	6	22	
12	18	8	31	
13	12	5	21	

Protocol# 10 - Room Decon.lsa

User: Peter Keefe

Lab Decon 118 336

14	0	9	13
15	4	15	25
16	13	7	27
17	17	8	29
18	17	6	27
19	12	4	27
20	9	7	21
21	6	5	21
22	0	10	12
23	19	3	28
24	0	6	9
25	22	13	41
26	7	4	22
27	19	4	31
28	13	5	28
29	9	8	25
30	2	8	16
31	4	3	16
32	16	6	25
33	4	7	18
34	5	8	18
35	4	5	16
36	9	1	10
37	17	6	29
38	8	9	24
39	17	8	33
40	9	4	14
41	0	4	9
42	7	14	32
43	22	10	39
44	13	7	26
45	18	9	33
46	13	7	26
47	1	8	17
48	3	10	22
49	14	7	26
50	6	8	19
51	13	11	29
52	14	10	28
53	16	6	28
54	18	4	27
55	14	7	31
56	1	4	10
57	19	3	23
58	11	4	16
59	3	2	9
60	22	7	33
61	18	12	36
62	5	4	16
63	11	8	25
64	7	7	19
65	8	8	24
66	19	4	28
67	15	7	36
68	12	4	20
69	11	8	26
70	8	8	27
71	23	6	38
72	12	6	22
73	9	6	23
74	13	10	31
75	15	7	27
76	4	9	20

Protocol# 10 - Room Decon.lsa

User: Peter Keefe

Lab Decon 118 336

77	28	5	39
78	7	4	18
79	11	9	27
80	15	7	30
81	14	8	27
82	7	6	25
83	8	7	17
84	3	5	16
85	15	6	29
86	2	13	20
87	7	6	20
88	8	6	23
89	12	5	23
90	7	9	19
91	12	4	27
92	3	4	17
93	21	5	32
94	19	6	30
95	7	5	16
96	21	12	37
97	0	8	16
98	20	12	39
99	25	4	35
100	16	9	30
101	11	9	28
102	22	6	33
103	25	10	37
104	14	5	31
105	10	7	27
106	19	15	40
107	9	7	18
108	17	9	34
109	22	8	36
110	16	8	30
111	9	8	19
112	11	12	28
113	13	16	36
114	12	8	26
115	12	8	24
116	11	8	23
117	12	4	22
118	19	8	30
119	18	12	39
120	13	5	23
121	8	10	23
122	15	10	35
123	8	11	22
124	22	7	33
125	12	6	21
126	17	9	33
127	16	8	32
128	16	7	28
129	6	11	20
130	25	9	42
131	27	16	50
132	8	7	23
133	18	11	33
134	26	11	42
135	12	5	22
136	31	10	47
137	21	7	31
138	11	3	22
139	10	6	28

Protocol# 10 - Room Decon.lsa

User: Peter Keefe

Lab Decon 118 336

140	19	8	36
141	9	5	24
142	11	6	24
143	22	10	34
144	25	9	38
145	10	9	23
146	14	5	29
147	3	10	19
148	24	4	33
149	14	10	28
150	10	3	18
151	21	8	32
152	12	9	28
153	14	13	31
154	22	10	38
155	18	5	30
156	9	8	20
157	18	11	36
158	21	5	33
159	13	14	34
160	4	3	12
161	13	6	26
162	4	2	10
163	13	7	32
164	11	6	23
165	0	5	14
166	16	9	31
167	15	9	34
168	17	8	33
169	19	9	32
170	25	12	40
171	19	7	31
172	5	11	24
173	13	10	27
174	15	9	28
175	14	9	26
176	22	10	39
177	14	11	31
178	10	9	28
179	7	2	14
180	26	10	41
181	8	4	25
182	13	8	26
183	6	9	22
184	12	3	22
185	7	10	21
186	6	7	18
187	11	5	19
188	17	8	31
189	11	5	24
190	17	9	30
191	17	10	38
192	10	7	22
193	15	8	36
194	16	6	24
195	9	10	25
196	18	7	32
197	8	8	20
198	5	12	25
199	16	4	23
200	10	2	16
201	17	10	31
202	23	6	37

Protocol# 10 - Room Decon.lsa

Lab Decon 118 336

User: Peter Keefe

203	18	9	33
204	18	7	34
205	26	8	43
206	18	8	30
207	13	9	30
208	8	9	21
209	8	5	17
210	26	5	38
211	16	10	34
212	5	6	18
213	6	8	17
214	11	6	20
215	9	11	24
216	18	3	24
217	18	6	31
218	19	7	28
219	0	9	18
220	10	8	21
221	4	8	19
222	16	6	29
223	13	4	22
224	18	12	35
225	14	7	30
226	12	10	24
227	11	5	21
228	23	10	37
229	13	8	29
230	23	5	36
231	10	5	23
232	10	6	20
233	13	7	24
234	0	8	14
235	16	8	29
236	15	7	30
237	12	6	23
238	13	4	21
239	27	4	39
240	25	8	40
241	15	5	24
242	8	9	20
243	17	8	29
244	14	7	28
245	14	8	29
246	10	10	26
247	20	6	33
248	9	8	21
249	5	11	21
250	10	10	27
251	14	11	32
252	6	9	21
253	11	10	30
254	9	3	15
255	18	7	29
256	15	4	22
257	14	6	23
258	19	5	33
259	17	3	22
260	12	9	29
261	18	10	34
262	14	2	23
263	12	3	19
264	7	7	24
265	13	7	24

Protocol# 10 - Room Decon.lsa

User: Peter Keefe

Lab Decon 118 336

266	9	10	24
267	27	7	39
268	16	7	27
269	13	4	22
270	8	4	22
271	11	6	22
272	11	15	32
273	22	4	31
274	8	4	21
275	8	12	28
276	11	12	28
277	14	6	27
278	19	8	34
279	8	11	25
280	18	7	32
281	13	9	30
282	19	6	32
283	3	5	14
284	12	6	21
285	11	6	20
286	21	6	31
287	23	6	33
288	4	9	19
289	24	6	40
290	20	13	38
291	6	6	16
292	27	8	38
293	18	10	35
294	34	3	45
295	17	9	34