

Radiological Survey Sheet

Job Location Rizer Inc Groton, CT Page 1 of 27

Survey Purpose Decommissioning 118/270 Date 8/1/00

Performed By John Turcell (Print) John Turcell (Sign)

Inst.(1) (Model/SN) Beckman LS 6500 #7069448	Inst.(2) Ludlum Model 2241-2 (Model/SN)# 163603	Inst.(3) (Model/SN)
Det. Internal (Model/SN)	Det. Ludlum model 43-66 (Model/SN) #149613	Det. (Model/SN)
Eff. See LSC Printout	Eff. $\approx 80\%$ C-14	Eff.
Type rad. β	Type rad. β	Type rad.
Bkgd. See LSC Printout	Bkgd. 300 cpm	Bkgd.
Cal. Due: 12/00	Cal. Due 8/13/01	Cal. due

No.	Time	Location	Inst. Used	Total Activity (dpm/100 cm ²)
1.	9:00	Door	1	See attached LSC Printout
2.		Wall	1	
3.		Top shelf	1	
4.		Shelf	1	
5.		Shelf	1	
6.		Top Drawer	1	
7.		Drawer	1	
8.		Drawer	1	
9.		Upper wall	1	
10.		Lower wall	1	
11.		Upper wall	1	
12.		Lower wall	1	
13.		Upper wall	1	
14.		Lower wall	1	
15.		Upper wall	1	
16.		Lower wall	1	
17.		Upper wall	1	
18.	✓	Lower wall	1	

Radiological Survey Continuation Sheet

Page 2 of 27

Date 8/1/00

No.	Time	Location	Inst. Used	Total Activity (dpm/100 cm ²)
19		Phone/Wall	1	See attached LSC Printout
20		Wall	1	
21		Floor	1	
22		"	1	
23		"	1	
24		"	1	
25		"	1	
26		Floor	1	
27		"	1	
28		"	1	
29		"	1	
30		Floor	1	
31		"	1	
32		"	1	
33		"	1	
34		Floor	1	
35		Chair	1	
36		Door	1	
37		Upper wall	1	
38		lower wall	1	
39		metal Sheets	1	
40		Upper wall	1	
41		upper lower wall	1	
42		Upper wall	1	
43		lower wall	1	
44		Upper wall	1	
45		lower wall	1	
46	✓	Upper wall	1	✓

Radiological Survey Continuation Sheet

Page 3 of 27

Date 8/1/00

No.	Time	Location	Inst. Used	Total Activity (dpm/100 cm ²)
47		Lower wall	1	See attached LSC Printout
48		Floor	1	
49		"	1	
50		"	1	
51		"	1	
52		"	1	
53		Floor	1	
54		Floor	1	
55		Floor	1	
56		① Cabinet doors	1	
57		Top shelf	1	
58		shelf	1	
59		shelf	1	
60		② Cabinet doors	1	
61		Top shelf	1	
62		shelf	1	
63		shelf	1	
64		shelf	1	
65		shelf	1	
66		Counter	1	
67		Counter	1	
68		"	1	
69		"	1	
70		Counter	1	
71		outer cabinet	1	
72		Drawer	1	
73		shelf	1	
24	✓	shelf	1	

• Radiological Survey Continuation Sheet

Page 4 of 27

Date 8/1/00

No.	Time	Location	Inst. Used	Total Activity (dpm/100 cm ²)
75		Outer Drawers	1	See attached LSC Printout
76		Top Drawers	1	
77		Drawer	1	
78		Drawer	1	
79		Drawer	1	
80		Drawer	1	
81		Knee hole walls	1	
82		Outer Drawers	1	
83		Top Drawer	1	
84		Drawer	1	
85		Drawer	1	
86		Drawer	1	
87		Outer cabinet	1	
88		Drawer	1	
89		shelf	1	
90		shelf	1	
91		Cabinet End	1	
92		" "	1	
93		" "	1	
94		" "	1	
95		⊙ Cabinet doors	1	
96		Top shelf	1	
97		shelf	1	
98		shelf	1	
99		⊙ Cabinet doors	1	
100		top shelf	1	
101		shelf	1	
102	✓	shelf	1	✓

• Radiological Survey Continuation Sheet

Page 5 of 27

Date 8/1/00

No.	Time	Location	Inst. Used	Total Activity (dpm/100 cm ²)
103		Counter	1	See attached LSC Printout
104		Counter	1	
105		"	1	
106		"	1	
107		Counter	1	
108		Outer Cabinet	1	
109		Drawer	1	
110		Top Shelf	1	
111		Shelf	1	
112		Outer Drawers	1	
113		Top Drawer	1	
114		Drawer	1	
115		Drawer	1	
116		Drawer	1	
117		Chair	1	
118		Drawer	1	
119		Knee hole walls	1	
120		Outer Drawers	1	
121		Top Drawers	1	
122		Drawer	1	
123		"	1	
124		Drawer	1	
125		Outer Cabinet	1	
126		Drawer	1	
127		Shelf	1	
128		Shelf	1	
129		Floor	1	
130	✓	Floor	1	✓

Radiological Survey Continuation Sheet

Page 6 of 27

Date 8/1/02

No.	Time	Location	Inst. Used	Total Activity (dpm/100 cm ²)
131		Floor	1	See attached LSC Printout
132		"	1	
133		"	1	
134		Floor	1	
135		• Cabinet doors	1	
136		• Top Shelf	1	
137		Shelf	1	
138		Shelf	1	
139		• Cabinet doors	1	
140		Top Shelf	1	
141		Shelf	1	
142		shelf	1	
143		shelf	1	
144		shelf	1	
145		Counter	1	
146		"	1	
147		"	1	
148		"	1	
149		Counter	1	
150		outer cabinet	1	
151		Drawer	1	
152		shelf	1	
153		shelf	1	
154		outer drawer	1	
155		top drawer	1	
156		Drawer	1	
157		"	1	
158	✓	Drawer	1	✓

Radiological Survey Continuation Sheet

Page 7 of 27

Date 8/1/00

No.	Time	Location	Inst. Used	Total Activity (dpm/100 cm ²)
159		Drawer	1	See attached LSC Printout
160		Knee hole walls	1	
161		outer Drawers	1	
162		Top Drawers	1	
163		Drawer	1	
164		" "	1	
165		Drawer	1	
166		outer Cabinet	1	
167		Drawer	1	
168		shelf	1	
169		shelf	1	
170		② Cabinet Doors	1	
171		Top shelf	1	
172		shelf	1	
173		shelf	1	
174		② Cabinet Doors	1	
175		Top shelf	1	
176		shelf	1	
177		shelf	1	
178		Counter	1	
179		"	1	
180		"	1	
181		"	1	
182		Counter	1	
183		outer cabinet	1	
184		Drawers	1	
185		shelf	1	
186	✓	shelf	1	✓

Radiological Survey Continuation Sheet

Page 8 of 27

Date 5/1/00

No.	Time	Location	Inst. Used	Total Activity (dpm/100 cm ²)
187		Outer Drawers	1	See attached LSC Printout
188		Top Drawers	1	
189		Drawers	1	
190		"	1	
191		"	1	
192		" Drawers	1	
193		Knee hole wall	1	
194		Outer Drawers	1	
195		Top Drawers	1	
196		Drawers	1	
197		Drawers	1	
198		Drawers	1	
199		outer Cabinet	1	
200		Drawer	1	
201		shelf	1	
202		shelf	1	
203		Cabinet End	1	
204		" "	1	
205		" "	1	
206		Cabinet End	1	
207		(D) Control Knobs	1	
208		(R) Control Knobs	1	
209		vent shields	1	
210		(D) wall	1	
211		(R) wall	1	
212		Upper Back (D) wall	1	
213		lower Back (D) wall	1	
214	✓	Upper Back (R) wall	1	✓

Radiological Survey Continuation Sheet

Page 9 of 27

Date 8/1/00

No.	Time	Location	Inst. Used	Total Activity (dpm/100 cm ²)
215		Lower Back Wall	1	See attached LSC Printout
216		Next ceiling	1	
217		① Counter	1	
218		② Counter	1	
219		L.P.	1	
220		inner sash	1	
221		outer sash	1	
222		Door cabinet door	1	
223		inner cabinet	1	
224		② cabinet door	1	
225		inner cabinet	1	
226		knee hole walls	1	
227		Chair	1	
228		wall unit	1	
229		Top shelf	1	
230		shelf	1	
231		shelf	1	
232		wall unit	1	
233		Top shelf	1	
234		shelf	1	
235		shelf	1	
236		wall	1	
237		wall	1	
238		wall	1	
239		counter	1	
240		counter	1	
241		outer drawers	1	
242	✓	Top drawer	1	✓

Radiological Survey Continuation Sheet

Page 10 of 27

Date 8/1/00

No.	Time	Location	Inst. Used	Total Activity (dpm/100 cm ²)
243		Drawer	1	See attached LSC Printout
244		Drawer	1	
245		Drawer	1	
246		ⓐ Drawer	1	
247		ⓑ Drawer	1	
248		▼ Knee Aisle Walls	1	
249		Chair	1	
250		Chair	1	
251		Wall	1	
252		Wall	1	
253		Wall	1	
254		Wall	1	
255		Counter	1	
256		"	1	
257		"	1	
258		Counter	1	
259		Sink	1	
260		DRAIN	1	
261		FRONT	1	
262		OUTER DRAWERS	1	
263		TOP LEFT DRAWER	1	
264		DRAWER	1	
265		TOP RIGHT DRAWERS	1	
266		DRAWER	1	
267		DRAWER	1	
268		BOTTOM DRAWER	1	
269		CABINET DOOR	1	
270	Y	INSIDE CABINET	1	✓

Radiological Survey Continuation Sheet

Page 11 of 27

Date 8/1/00

No.	Time	Location	Inst. Used	Total Activity (dpm/100 cm ²)
271		SP Chair	1	See attached LSC Printout
272		Control Knobs	1	
273		Control Knobs	1	
274		Wall	1	
275		Wall	1	
276		Upper Back wall	1	
277		Lower Back wall	1	
278		Upper Back wall	1	
279		Lower Back wall	1	
280		Cent Shields	1	
281		Counter	1	
282		Counter	1	
283		inner Sash	1	
284		outer Sash	1	
285		Lip	1	
286		Cabinet door	1	
287		inner cabinet	1	
288		Knee hole	1	
289		Cabinet door	1	
290		inner cabinet	1	
291		Chair	1	
292		Wall	1	
293		Wall	1	
294		Top Shelf	1	
295		Shelf	1	
296		Shelf	1	
297		Counter	1	
298	iv	Cabinet door	1	✓

Radiological Survey Continuation Sheet

Page 12 of 27

Date 8/1/02

No.	Time	Location	Inst. Used	Total Activity (dpm/100 cm ²)
299		Topshelf	1	See attached LSC Printout
300		shelf	1	
301		Floor	1	
302		"	1	
303		"	1	
304		"	1	
305		"	1	
306		"	1	
307		Floor	1	
308		"	1	
309		"	1	
310		"	1	
311		"	1	
312		Floor	1	
313		(L) Control Knobs	1	
314		(R) Control Knobs	1	
315		vent shields	1	
316		Lip	1	
317		inner sash	1	
318		outer sash	1	
319		(L) wall	1	
320		(R) wall	1	
321		Chair	1	
322		Upper (L) Rock Wall	1	
323		Lower (L) Rock Wall	1	
324		Upper (R) Rock Wall	1	
325		Lower (R) Rock Wall	1	
326	↓	(D) Counter	1	↓

Radiological Survey Continuation Sheet

Page 13 of 27

Date 8/1/00

No.	Time	Location	Inst. Used	Total Activity (dpm/100 cm ²)
327		Ⓜ Counter	1	See attached LSC Printout
328		Head Ceiling	1	
329		wall	1	
330		"	1	
331		"	1	
332		Wall	1	
333		Counter	1	
334		Faucet	1	
335		Sink	1	
336		DRMIM	1	
337		Counter	1	
338		"	1	
339		Counter	1	
340		Cabinet	1	
341		inner cabinet	1	
342		outer Drawers	1	
343		Top Ⓜ Drawer	1	
344		Ⓜ Drawer	1	
345		Top Ⓜ Drawer	1	
346		Ⓜ Drawer	1	
347		Drawer	1	
348		Drawer	1	
349		Wall Unit	1	
350		Top shelf	1	
351		shelf	1	
352		shelf	1	
353		wall unit	1	
354	✓	Top shelf	1	✓

Radiological Survey Continuation Sheet

Page 14 of 27

Date 8/1/00

No.	Time	Location	Inst. Used	Total Activity (dpm/100 cm ²)
355		Shelf	1	See attached LSC Printout
356		shelf	1	
357		Wall Unit	1	
358		Top shelf	1	
359		shelf	1	
360		shelf	1	
361		Wall Unit	1	
362		Top shelf	1	
363		shelf	1	
364		shelf	1	
365		chair	1	
366		Wall	1	
367		Wall	1	
368		Wall	1	
369		Counter	1	
370		Counter	1	
371		"	1	
372		top counter	1	
374		counter outer Cabinet	1	
375		Ⓐ Drawer	1	
376		Ⓑ Drawer	1	
377		inner cabinet	1	
378		outer Drawers	1	
379		Top Drawers	1	
380		Drawer	1	
381		Drawer	1	
382		Drawer	1	
383	14	Outer Drawers	1	✓

Radiological Survey Continuation Sheet

Page 15 of 27

Date 8/10/00

No.	Time	Location	Inst. Used	Total Activity (dpm/100 cm ²)
384		Top Drawer	1	See attached LSC Printout
385		Drawer	1	
386		Drawer	1	
387		Drawer	1	
388		Drawer	1	
389		Knee hole walls	1	
390		outer drawers	1	
391		Top (D) Drawer	1	
392		(D) Drawer	1	
393		Top (R) Drawer	1	
394		(R) Drawer	1	
395		Drawer	1	
396		Drawer	1	
397		Chair #2	1	
398		Cabinet End	1	
399		Chair 3	1	
400		" 4	1	
401		" 5	1	
402		Chair 6	1	
403		wall	1	
404		upper wall	1	
405		lower wall	1	
406		Top Shelf	1	
407		shelf	1	
408		shelf	1	
409		Desk	1	
410		outer drawers	1	
411	✓	Top Drawer	1	✓

Radiological Survey Continuation Sheet

Page 16 of 27

Date 8/11/00

No.	Time	Location	Inst. Used	Total Activity (dpm/100 cm ²)
412		Drawer	1	See attached LSC Printout
413		Drawer	1	
414		Top Shelf	1	
415		Shelf	1	
416		Shelf	1	
417		Desk	1	
418		Outer Drawers	1	
419		Top Drawer	1	
420		Drawer	1	
421		Drawer	1	
422		Floor	1	
423		"	1	
424		Floor	1	
425		"	1	
426		"	1	
427		"	1	
428		Floor	1	
429		"	1	
430		"	1	
431		"	1	
432		Floor	1	
433		"	1	
434		"	1	
435		Floor	1	
436		"	1	
437		"	1	
438		"	1	
439	✓	Floor	1	✓

Demolition Location

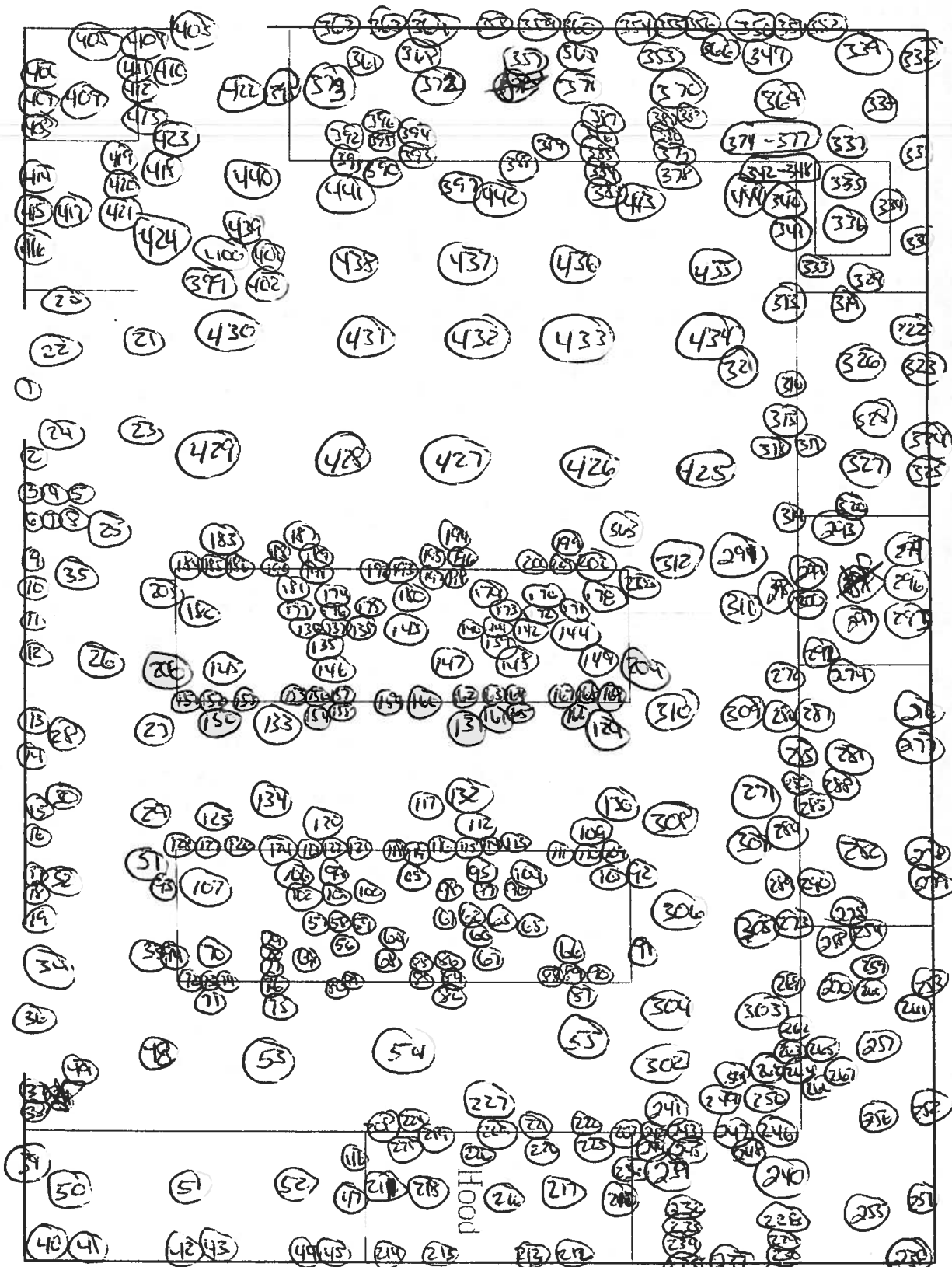

Surveyed = 100% of lower surfaces using instrument #2. All surfaces surveyed were noted to be at normal background level.

WIPESURVEY

1 AUG 2000 11:01

USER: 2 COMMENT: DECOMMISSION

PRESET TIME : 1.00

DATA CALD : DL DPM H# : YES SAMPLE REPEATS: 1 PRINTER : EDIT

COUNT BLANK : YES IC# : NO REPLICATES : 1 RS232 : EDIT

TWO PHASE : NO ACC : YES CYCLE REPEATS : 1

SCINTILLATOR: LIQUID LUMEX: YES LOW SAMPLE REJ: 0

LOW LEVEL : NO HALF LIFE CORRECTION DATE: none

ISOTOPE 1: 3H %ERROR: 2.00 FACTOR: 1.0000 BKG. SUB: 0

ISOTOPE 2: 14C %ERROR: 2.00 FACTOR: 1.0000 BKG. SUB: 0

WIDE OPEN WINDOW %ERROR: 0.00 FACTOR: 1.0000 BKG. SUB: 0

BACKGROUND QUENCH CURVE: Off COLOR QUENCH CORRECTION: Off

Quench Limits Low: 13.688 High: 306.34

SAM NO	H#	3H CPM	14C CPM	WIDE CPM	3H DPM	14C DPM	LUMEX %	
B1	69.9	19.00	10.00	42.00	34.02	13.03	3.07	
		Blank Average	DPM	for	3H :	34.02	COEF. OF VAR:	0.000
		Blank Average	DPM	for	14C :	13.03	COEF. OF VAR:	0.000

1	68.7	16.00	7.00	33.00	-4.83	-3.96	2.72
2	68.8	18.00	5.00	29.00	0.25	-6.65	2.60
3	76.9	20.00	10.00	40.00	3.23	0.02	3.64
4	80.1	10.00	12.00	32.00	-18.75	2.89	3.61
5	76.9	11.00	11.00	29.00	-16.35	1.51	2.89
6	72.8	11.00	8.00	29.00	-15.17	-2.53	5.77
7	73.2	14.00	6.00	32.00	-7.89	-5.24	1.99
8	78.7	19.00	14.00	38.00	-0.65	5.41	3.31
9	70.6	7.00	10.00	24.00	-24.56	0.19	3.83
10	67.8	16.00	14.00	35.00	-8.35	5.36	4.25
11	72.1	16.00	8.00	36.00	-4.87	-2.61	1.74
12	75.6	10.00	2.00	23.00	-13.98	-10.52	3.00
13	66.6	18.00	9.00	41.00	-2.03	-1.33	2.11
14	72.6	11.00	12.00	33.00	-17.18	2.81	2.28
15	69.5	17.00	8.00	33.00	-3.17	-2.64	2.56
16	69.3	18.00	14.00	44.00	-4.10	5.34	1.97
17	68.0	21.00	13.00	42.00	2.32	3.95	2.62
18	69.2	14.00	11.00	35.00	-10.81	1.41	1.72
19	70.0	8.00	11.00	33.00	-23.03	1.51	2.58
20	68.1	15.00	17.00	40.00	-11.81	9.38	1.82
21	73.9	7.00	11.00	25.00	-24.93	1.55	2.66
22	74.4	13.00	10.00	31.00	-11.85	0.12	2.98
23	72.8	12.00	9.00	30.00	-13.59	-1.21	2.76
24	72.1	14.00	12.00	40.00	-11.00	2.76	2.27
25	75.0	22.00	8.00	43.00	8.11	-2.69	3.20
26	73.0	10.00	8.00	30.00	-17.23	-2.51	2.75
27	74.4	13.00	3.00	28.00	-8.32	-9.23	3.99
28	75.4	11.00	10.00	26.00	-15.95	0.16	5.39
29	81.5	19.00	12.00	46.00	0.85	2.75	3.28
30	77.7	19.00	6.00	32.00	3.29	-5.31	3.57
31	74.4	11.00	8.00	30.00	-15.03	-2.52	5.66
32	76.1	19.00	10.00	37.00	0.98	0.03	1.57
33	80.2	11.00	12.00	33.00	-16.59	2.87	2.97
34	76.3	23.00	13.00	46.00	7.93	3.98	2.33
35	68.8	8.00	10.00	32.00	-22.60	0.17	0.91
36	72.4	14.00	10.00	33.00	-9.97	0.09	1.66

SAM. NO	HH	3H CPM	14C CPM	WIDE CPM	3H DPM	14C DPM	LUMEX %
37	70.1	9.00	12.00	28.00	-21.46	2.83	1.84
38	73.4	11.00	12.00	28.00	-17.12	2.82	1.45
39	76.6	10.00	15.00	33.00	-20.52	6.87	3.62
40	69.5	20.00	7.00	36.00	3.46	-4.02	2.85
41	76.0	13.00	3.00	28.00	-8.13	-9.23	4.92
42	77.6	9.00	10.00	31.00	-20.02	0.21	2.28
43	72.6	12.00	10.00	28.00	-14.11	0.13	4.06
44	75.4	19.00	12.00	40.00	-0.14	2.70	5.96
45	70.1	12.00	10.00	31.00	-14.32	0.11	3.11
46	75.7	16.00	10.00	36.00	-5.41	0.08	1.70
47	76.4	16.00	12.00	39.00	-6.33	2.76	5.64
48	75.4	12.00	20.00	47.00	-18.92	13.51	2.25
49	77.8	7.00	13.00	27.00	-25.81	4.26	2.95
50	84.1	12.00	10.00	31.00	-13.01	0.20	5.74
51	80.4	18.00	6.00	35.00	1.64	-5.29	4.87
52	76.5	11.00	17.00	36.00	-19.44	9.53	2.74
53	77.6	11.00	5.00	23.00	-13.20	-6.52	2.59
54	79.5	14.00	16.00	40.00	-12.28	8.18	2.10
55	76.9	11.00	4.00	22.00	-12.76	-7.86	2.72
56	71.9	14.00	13.00	37.00	-11.52	4.09	2.15
57	72.0	21.00	8.00	40.00	5.45	-2.69	1.84
58	73.0	13.00	13.00	37.00	-13.50	4.12	1.94
59	72.1	10.00	9.00	28.00	-17.79	-1.18	2.42
60	80.2	24.00	9.00	48.00	12.94	-1.37	2.75
61	73.6	9.00	7.00	28.00	-18.77	-3.82	3.09
62	70.7	11.00	8.00	31.00	-15.35	-2.54	2.54
63	73.7	13.00	11.00	36.00	-12.43	1.45	2.45
64	80.0	11.00	7.00	25.00	-14.00	-3.83	4.89
65	74.1	27.00	6.00	42.00	19.38	-5.45	2.41
66	73.0	13.00	12.00	34.00	-12.99	2.78	2.77
67	71.0	21.00	9.00	38.00	4.79	-1.36	1.92
68	72.0	11.00	8.00	29.00	-15.24	-2.53	2.45
69	71.5	15.00	5.00	30.00	-5.54	-6.60	3.45
70	72.1	9.00	10.00	28.00	-20.36	0.17	4.07
71	73.0	18.00	11.00	38.00	-2.10	1.37	1.54
72	74.6	14.00	13.00	37.00	-11.25	4.12	3.43
73	69.1	16.00	11.00	43.00	-6.74	1.38	1.75
74	74.3	13.00	9.00	33.00	-11.35	-1.21	1.68
75	68.5	11.00	6.00	23.00	-14.55	-5.21	3.65
76	68.9	15.00	10.00	31.00	-8.31	0.06	3.24
77	72.6	15.00	9.00	32.00	-7.35	-1.25	2.66
78	71.8	12.00	6.00	26.00	-12.19	-5.21	2.91
79	76.3	11.00	9.00	30.00	-15.38	-1.17	2.49
80	71.3	15.00	10.00	35.00	-8.03	0.07	3.04
81	77.7	18.00	10.00	35.00	-0.88	0.06	5.27
82	74.9	16.00	9.00	32.00	-5.02	-1.26	1.31
83	74.0	15.00	8.00	34.00	-6.71	-2.58	2.72
84	72.5	17.00	10.00	33.00	-3.68	0.05	1.28
85	72.5	9.00	7.00	33.00	-18.81	-3.83	2.52
86	78.2	15.00	10.00	32.00	-7.20	0.11	6.02
87	75.1	9.00	10.00	33.00	-20.18	0.19	2.14
88	75.0	18.00	17.00	50.00	-4.84	9.40	1.92
89	73.8	12.00	15.00	37.00	-16.51	6.81	2.32
90	77.0	16.00	6.00	34.00	-3.19	-5.26	2.06
91	72.3	14.00	13.00	38.00	-11.49	4.10	2.56
92	74.6	14.00	14.00	41.00	-11.75	5.45	2.37
93	77.7	16.00	7.00	35.00	-3.60	-3.92	2.85
94	78.6	6.00	12.00	27.00	-27.40	2.94	2.69

SAM NO	H#	3H CPM	14C CPM	WIDE CPM	3H DPM	14C DPM	LUMEX %
95	83.5	10.00	13.00	32.00	-19.04	4.26	2.73
96	76.3	13.00	9.00	30.00	-11.15	-1.20	2.64
97	78.5	16.00	11.00	34.00	-5.53	1.44	2.18
98	74.5	12.00	12.00	35.00	-14.95	2.81	2.28
99	71.3	16.00	16.00	40.00	-8.94	8.06	2.90
100	73.6	20.00	7.00	38.00	4.16	-4.00	2.04
101	73.3	8.00	7.00	27.00	-20.87	-3.81	3.67
102	71.6	14.00	15.00	41.00	-12.55	6.76	1.53
103	73.3	15.00	9.00	41.00	-7.30	-1.25	1.64
104	75.2	15.00	8.00	34.00	-6.51	-2.58	2.55
105	72.3	11.00	12.00	34.00	-17.20	2.81	3.03
106	74.5	12.00	12.00	29.00	-14.95	2.81	3.37
107	72.0	11.00	8.00	25.00	-15.23	-2.53	3.50
108	73.8	14.00	12.00	37.00	-10.83	2.77	2.53
109	72.6	14.00	10.00	34.00	-9.96	0.10	2.84
110	74.6	15.00	4.00	28.00	-4.61	-7.93	3.31
111	77.5	17.00	10.00	33.00	-3.04	0.07	3.70
112	71.4	16.00	14.00	38.00	-7.94	5.39	2.90
113	71.9	12.00	4.00	24.00	-11.18	-7.88	2.98
114	70.6	11.00	7.00	36.00	-14.86	-3.87	1.92
115	74.0	18.00	13.00	39.00	-2.95	4.05	2.60
116	75.5	11.00	10.00	30.00	-15.95	0.16	3.32
117	66.6	9.00	8.00	25.00	-19.71	-2.52	2.51
118	71.3	10.00	12.00	31.00	-19.34	2.82	2.34
119	72.0	17.00	7.00	41.00	-2.32	-3.96	2.35
120	74.7	16.00	14.00	37.00	-7.55	5.42	2.95
121	74.7	14.00	11.00	36.00	-10.23	1.44	2.58
122	70.6	12.00	10.00	36.00	-14.28	0.12	2.19
123	74.1	14.00	12.00	37.00	-10.80	2.78	2.28
124	76.9	18.00	14.00	39.00	-3.06	5.41	1.76
125	71.8	17.00	12.00	38.00	-4.84	2.71	2.35
126	72.9	16.00	10.00	36.00	-5.77	0.06	2.59
127	72.8	13.00	8.00	30.00	-11.01	-2.56	2.29
128	72.7	11.00	13.00	34.00	-17.67	4.15	2.67
129	78.0	12.00	7.00	23.00	-12.07	-3.86	8.87
130	79.8	10.00	8.00	30.00	-16.69	-2.47	2.29
131	82.4	14.00	10.00	35.00	-8.83	0.15	1.73
132	74.0	21.00	17.00	51.00	1.29	9.34	1.57
133	77.5	13.00	6.00	30.00	-9.49	-5.21	2.07
134	81.5	7.00	11.00	29.00	-24.63	1.61	1.75
135	74.8	13.00	9.00	31.00	-11.31	-1.21	2.70
136	73.2	12.00	9.00	28.00	-13.55	-1.20	2.88
137	72.8	9.00	8.00	26.00	-19.32	-2.49	3.91
138	74.3	11.00	6.00	28.00	-14.03	-5.19	3.02
139	85.7	17.00	12.00	35.00	-2.85	2.81	1.97
140	80.2	20.00	7.00	34.00	5.39	-3.98	2.17
141	74.1	13.00	9.00	31.00	-11.36	-1.22	2.18
142	73.8	10.00	5.00	22.00	-15.64	-6.51	4.08
143	74.4	14.00	13.00	36.00	-11.27	4.11	1.40
144	87.1	12.00	9.00	35.00	-12.15	-1.13	2.61
145	72.0	15.00	10.00	41.00	-7.95	0.08	1.86
146	71.2	11.00	11.00	31.00	-16.79	1.47	1.26
147	72.3	20.00	6.00	37.00	4.43	-5.34	2.03
148	68.6	11.00	14.00	31.00	-18.44	5.45	1.32
149	71.2	11.00	9.00	28.00	-15.79	-1.20	0.93
150	74.0	20.00	4.00	38.00	5.75	-8.01	1.33
151	73.1	25.00	11.00	45.00	12.47	1.26	2.07
152	71.9	15.00	9.00	32.00	-7.47	-1.26	1.77

SAM NO	H#	3H CPM	14C CPM	WIDE CPM	3H DPM	14C DPM	LUMEX %
153	77.6	14.00	8.00	35.00	-8.35	-2.55	2.09
154	72.3	18.00	11.00	41.00	-2.20	1.36	2.66
155	72.3	15.00	7.00	31.00	-6.42	-3.93	3.52
156	73.7	15.00	8.00	30.00	-6.75	-2.59	2.49
157	72.3	17.00	11.00	37.00	-4.27	1.38	2.20
158	79.5	8.00	13.00	27.00	-23.60	4.26	1.62
159	75.6	13.00	9.00	31.00	-11.22	-1.21	3.86
160	81.8	18.00	14.00	41.00	-2.33	5.45	1.96
161	72.5	17.00	10.00	44.00	-3.75	0.05	1.27
162	75.0	15.00	12.00	32.00	-8.60	2.77	4.00
163	74.7	10.00	10.00	30.00	-18.11	0.17	2.92
164	78.0	16.00	10.00	35.00	-5.09	0.09	3.86
165	74.4	13.00	7.00	31.00	-10.34	-3.89	4.27
166	76.4	16.00	7.00	30.00	-3.78	-3.93	8.97
167	72.5	10.00	13.00	29.00	-19.76	4.16	2.97
168	74.2	15.00	7.00	34.00	-6.18	-3.93	3.42
169	79.5	15.00	10.00	43.00	-7.03	0.12	2.45
170	85.1	13.00	10.00	28.00	-10.70	0.19	3.26
171	75.6	24.00	12.00	49.00	10.40	2.62	3.31
172	74.6	13.00	12.00	30.00	-12.84	2.80	3.19
173	79.5	16.00	7.00	31.00	-3.32	-3.92	4.13
174	75.2	23.00	8.00	37.00	10.24	-2.71	2.60
175	78.5	16.00	13.00	33.00	-6.57	4.11	2.60
176	75.7	23.00	4.00	38.00	12.39	-8.06	1.34
177	74.8	18.00	14.00	43.00	-3.35	5.39	2.97
178	82.7	13.00	15.00	34.00	-13.61	6.88	2.70
179	77.3	8.00	9.00	24.00	-21.66	-1.12	3.30
180	74.7	12.00	11.00	28.00	-14.42	1.48	3.08
181	79.0	13.00	10.00	31.00	-11.37	0.15	3.14
182	83.2	19.00	10.00	36.00	2.20	0.07	2.85
183	74.7	9.00	4.00	21.00	-17.17	-7.83	4.03
184	79.9	13.00	12.00	37.00	-12.32	2.84	1.67
185	75.6	19.00	9.00	37.00	1.40	-1.31	2.41
186	79.5	14.00	12.00	35.00	-10.21	2.82	3.47
187	75.9	15.00	9.00	36.00	-6.97	-1.24	2.96
188	75.1	12.00	7.00	31.00	-12.36	-3.87	3.98
189	79.2	10.00	10.00	28.00	-17.78	0.20	1.75
190	77.4	14.00	9.00	33.00	-8.91	-1.21	2.26
191	85.7	19.00	15.00	43.00	-0.04	6.81	2.64
192	74.2	15.00	7.00	37.00	-6.19	-3.92	2.25
193	81.0	14.00	10.00	36.00	-8.99	0.15	2.73
194	74.3	11.00	8.00	32.00	-15.04	-2.52	3.14
195	75.6	17.00	10.00	33.00	-3.30	0.06	5.28
196	80.5	17.00	5.00	37.00	0.02	-6.61	2.00
197	75.6	19.00	13.00	37.00	-0.62	4.04	1.95
198	81.2	12.00	1.00	19.00	-8.59	-11.89	1.85
199	71.7	12.00	9.00	35.00	-13.69	-1.21	4.01
200	73.7	12.00	7.00	26.00	-12.50	-3.87	3.10
201	75.5	16.00	6.00	35.00	-3.39	-5.27	2.61
202	82.9	8.00	7.00	24.00	-20.27	-3.77	1.98
203	75.6	15.00	6.00	32.00	-5.49	-5.25	3.68
204	80.0	17.00	10.00	33.00	-2.66	0.09	5.10
205	80.2	13.00	6.00	26.00	-9.16	-5.20	2.68
206	81.7	14.00	12.00	34.00	-9.96	2.83	2.17
207	75.1	20.00	10.00	35.00	2.91	0.01	3.05
208	76.0	14.00	7.00	33.00	-8.05	-3.90	2.03
209	84.7	15.00	10.00	33.00	-6.34	0.15	3.03
210	78.9	12.00	9.00	34.00	-13.00	-1.17	3.60

SAM NO	H#	3H CPM	14C CPM	WIDE CPM	3H DPM	14C DPM	LUMEX %
327	84.5	14.00	10.00	31.00	-8.57	0.17	2.37
328	72.9	19.00	10.00	45.00	0.47	0.02	1.86
329	73.4	18.00	9.00	35.00	-1.04	-1.30	2.65
330	72.5	15.00	16.00	43.00	-10.89	8.09	1.81
331	76.7	12.00	7.00	28.00	-12.20	-3.86	1.81
332	75.8	15.00	4.00	27.00	-4.45	-7.93	2.59
333	77.1	10.00	6.00	27.00	-15.88	-5.16	3.61
334	74.3	16.00	12.00	40.00	-6.60	2.75	2.08
335	84.3	22.00	14.00	45.00	6.85	5.40	4.37
336	81.8	13.00	9.00	36.00	-10.54	-1.17	1.94
337	79.6	12.00	12.00	33.00	-14.49	2.85	2.18
338	79.0	16.00	14.00	43.00	-7.02	5.46	1.79
339	74.7	14.00	9.00	33.00	-9.22	-1.23	2.42
340	86.2	10.00	11.00	32.00	-17.76	1.59	7.61
341	73.9	6.00	11.00	27.00	-27.02	1.57	1.76
342	78.0	15.00	7.00	38.00	-5.68	-3.91	0.99
343	76.0	20.00	13.00	43.00	1.54	4.03	1.47
344	80.3	15.00	7.00	30.00	-5.36	-3.90	2.12
345	77.1	16.00	7.00	38.00	-3.68	-3.93	1.70
346	81.8	15.00	10.00	31.00	-6.73	0.13	2.50
347	76.3	15.00	11.00	35.00	-7.94	1.44	1.87
348	74.6	11.00	12.00	29.00	-17.03	2.83	2.21
349	78.9	10.00	11.00	28.00	-18.32	1.54	3.83
350	74.9	13.00	15.00	38.00	-14.33	6.81	2.14
351	74.8	15.00	9.00	34.00	-7.11	-1.24	1.88
352	78.7	17.00	9.00	33.00	-2.34	-1.26	1.66
353	76.9	15.00	8.00	34.00	-6.33	-2.57	2.83
354	76.0	16.00	8.00	36.00	-4.34	-2.59	1.57
355	79.3	12.00	11.00	32.00	-14.00	1.51	2.15
356	77.5	22.00	12.00	41.00	6.56	2.67	2.62
357	80.1	11.00	10.00	32.00	-15.56	0.19	3.14
358	79.6	10.00	4.00	21.00	-14.63	-7.84	2.55
359	75.1	14.00	16.00	37.00	-12.72	8.13	2.02
360	79.4	11.00	7.00	24.00	-14.06	-3.83	1.27
361	76.6	14.00	10.00	35.00	-9.49	0.12	2.23
362	76.6	13.00	7.00	26.00	-10.09	-3.88	4.44
363	78.8	14.00	12.00	38.00	-10.29	2.81	1.01
364	78.8	9.00	12.00	30.00	-20.98	2.89	2.70
365	71.9	12.00	7.00	30.00	-12.68	-3.88	2.64
366	77.0	14.00	7.00	29.00	-7.93	-3.89	3.19
367	77.5	15.00	10.00	37.00	-7.28	0.11	1.82
368	86.2	23.00	9.00	45.00	12.17	-1.32	1.78
369	78.7	14.00	12.00	34.00	-10.30	2.81	2.59
370	76.1	17.00	13.00	36.00	-4.76	4.08	1.83
371	81.4	17.00	10.00	38.00	-2.45	0.10	2.52
372	81.8	16.00	12.00	38.00	-5.62	2.80	2.28
373	79.9	16.00	9.00	38.00	-4.31	-1.24	1.86
374	78.9	17.00	3.00	32.00	0.79	-9.29	2.33
375	74.1	11.00	13.00	40.00	-17.57	4.16	2.40
376	74.3	17.00	15.00	40.00	-6.01	6.74	2.38
377	86.2	9.00	10.00	33.00	-19.44	0.26	4.12
378	78.0	14.00	16.00	43.00	-12.44	8.16	2.72
379	74.3	15.00	5.00	34.00	-5.15	-6.59	3.58
380	78.0	10.00	11.00	29.00	-18.38	1.53	11.17
381	75.3	18.00	9.00	32.00	-0.75	-1.29	3.13
382	76.8	12.00	11.00	33.00	-14.23	1.49	3.70
383	78.3	14.00	6.00	28.00	-7.25	-5.23	2.86
384	75.6	14.00	10.00	31.00	-9.63	0.11	2.41

SAM. NO	H#	3H CPM	14C CPM	WIDE CPM	3H DPM	14C DPM	LUMEX %
385	75.4	15.00	6.00	37.00	-5.51	-5.25	1.00
386	74.2	20.00	11.00	41.00	2.26	1.34	1.49
387	77.6	14.00	10.00	30.00	-9.40	0.12	4.16
388	73.2	17.00	15.00	41.00	-6.15	6.73	2.09
389	83.4	19.00	12.00	43.00	1.17	2.76	2.17
390	74.1	19.00	9.00	34.00	1.16	-1.31	2.36
391	77.2	13.00	15.00	34.00	-14.12	6.83	2.44
392	77.5	15.00	10.00	33.00	-7.29	0.11	3.27
393	76.0	6.00	3.00	13.00	-22.89	-9.11	6.14
394	75.9	14.00	14.00	41.00	-11.62	5.46	0.96
395	79.2	17.00	10.00	30.00	-2.79	0.08	3.84
396	76.5	13.00	9.00	33.00	-11.13	-1.20	1.31
397	75.0	14.00	8.00	32.00	-8.67	-2.56	1.53
398	77.4	12.00	11.00	35.00	-14.18	1.49	1.70
399	76.4	18.00	11.00	39.00	-1.59	1.39	2.10
400	75.5	8.00	7.00	32.00	-20.74	-3.80	2.74
401	80.5	13.00	6.00	30.00	-9.13	-5.20	1.02
402	77.6	13.00	9.00	33.00	-11.01	-1.20	2.31
403	74.6	19.00	15.00	38.00	-1.79	6.71	1.24
404	73.6	18.00	8.00	37.00	-0.51	-2.63	1.86
405	73.6	22.00	10.00	36.00	6.83	-0.03	1.95
406	97.2	12.00	10.00	31.00	-11.56	0.28	4.53
407	80.6	12.00	5.00	24.00	-10.75	-6.53	3.58
408	85.5	11.00	7.00	22.00	-13.45	-3.81	3.13
409	78.4	13.00	10.00	34.00	-11.44	0.15	2.48
410	74.1	12.00	17.00	36.00	-17.49	9.49	2.24
411	77.6	8.00	14.00	29.00	-24.20	5.58	2.59
412	75.0	10.00	10.00	33.00	-18.08	0.18	2.92
413	76.7	13.00	8.00	32.00	-10.59	-2.54	2.87
414	90.8	8.00	6.00	25.00	-19.16	-5.08	4.32
415	81.1	16.00	10.00	36.00	-4.65	0.11	3.37
416	83.9	12.00	7.00	29.00	-11.43	-3.83	2.88
417	83.5	19.00	11.00	39.00	1.73	1.42	1.64
418	79.0	18.00	10.00	33.00	-0.67	0.07	1.93
419	81.6	13.00	12.00	35.00	-12.14	2.85	1.53
420	80.1	15.00	8.00	35.00	-5.91	-2.56	2.00
421	89.8	10.00	13.00	29.00	-18.57	4.31	2.73
422	77.6	14.00	9.00	32.00	-8.88	-1.21	1.96
423	85.3	16.00	14.00	45.00	-6.19	5.51	1.58
424	86.3	12.00	12.00	35.00	-13.85	2.90	3.33
425	84.3	9.00	10.00	31.00	-19.58	0.25	1.94
426	79.5	19.00	10.00	40.00	1.55	0.05	2.12
427	85.7	11.00	8.00	26.00	-13.98	-2.46	4.70
428	79.9	22.00	11.00	41.00	7.56	1.35	2.39
429	78.8	21.00	6.00	34.00	7.77	-5.34	1.91
430	84.3	10.00	10.00	31.00	-17.38	0.23	4.65
431	81.9	7.00	14.00	32.00	-26.18	5.64	1.87
432	91.3	11.00	7.00	24.00	-12.84	-3.79	5.52
433	85.3	15.00	8.00	34.00	-5.16	-2.53	3.77
434	81.9	9.00	9.00	26.00	-19.21	-1.11	3.62
435	80.6	12.00	12.00	35.00	-14.40	2.86	3.07
436	86.0	16.00	12.00	39.00	-5.03	2.83	2.21
437	103.7	19.00	10.00	44.00	6.27	0.18	6.21
438	90.2	10.00	13.00	35.00	-18.54	4.31	3.37
439	78.9	22.00	17.00	50.00	4.26	9.38	2.02
440	80.1	16.00	11.00	37.00	-5.32	1.45	2.63
441	77.9	18.00	11.00	36.00	-1.36	1.40	3.04
442	86.0	14.00	11.00	31.00	-8.91	1.52	3.28

SAM NO	H#	3H CPM	14C CPM	WIDE CPM	3H DPM	14C DPM	LUMEX %
3	83.0	12.00	13.00	32.00	-14.70	4.22	2.82
44	88.8	12.00	6.00	30.00	-10.32	-5.16	3.30