

## Radiological Survey Sheet

Job Location Pfizer, Inc. Groton, Ct. 06340

118/247

1 of 19

Survey Purpose Radiologic Decommissioning Survey

Date 1/21/2013

Performed by William H. Calver  
(Print)

William H. Calver  
(Sign)

Instrument (Model/S/N)	Packard Tri-Carb S/N 431521	Packard Tri-Carb S/N 431520	Ludlum 2241-2 163603	
Det. (Model/SN)	Internal	Internal	Ludlum 43-68 PR 149613	
Type Rad.	β	β	β	
Cal. Due:	03/05/2013	03/05/2013	04/17/2013	
Check Instruments Used	✓	<del>WHC</del>	✓	

No.	Time	Locations	See attached LSC printout for Total Activity (cpm/100 cm <sup>2</sup> )
1.	1030	BACKGROUND	
2.		FRONT DOOR	Outer
3.			Inside
4.		Light Switch + Thermostat	
5.		FRONT LEFT WALL	Upper
6.			Lower
7.			Upper
8.			Lower
9.		Left Wall Front	Upper
10.			Lower
11.			Upper
12.			Lower
13.			Upper <del>WHC</del>
14.			Lower
15.			Upper
16.			Lower
17.			Upper
18.			Lower

# Radiological Survey Continuation Sheet

Page 2 of <sup>10</sup>9  
WAC

Date 11/4/2013  
1181247

No.	Time	Locations	See attached LSC printout for Total Activity (cpm/100 cm <sup>2</sup> )
19	1100	Left Wall	Upper
20			Lower
21			Upper
22			Lower
23			Upper
24			Lower
25		Rear Wall (from left)	Upper
26			Lower
27			Upper
28			Lower
29			Upper
30			Lower
31			Upper
32			Lower
33			Upper
34			Lower
35			Upper
36			Lower
37		Rear Wall Storage Area	Shelves Top
38			2ND
39			3RD
40			4th
41		Right Wall Storage Area	Shelves Top
42			2ND
43			3RD
44		<del>Front Wall</del>	4th
45	✓	Front Wall Storage Area	Upper

# Radiological Survey Continuation Sheet

Page 3 of <sup>10</sup>9  
wte

Date 1/4/2013  
1181247

No.	Time	Locations	See attached LSC printout for Total Activity (cpm/100 cm <sup>2</sup> )	
46	1120		Lower	
47		Right Wall from Storage Area	Upper	
48			Lower	
49			Upper	
50			Lower	
51			Upper	
52			Lower	
53			Upper	
54			Lower	
55			Upper	
56			Lower	
57			Upper	
58			Lower	
59			Floor Front RT to Left	1
60				2
61		Left Floor from Front	1	
62			2	
63			3	
64			4	
65			5	
66			6	
67		Rear Floor	1	
68			2	
69			3	
70			4	
71			5	
72	✓		6	

(see # 10s)

# Radiological Survey Continuation Sheet

Page 4 of <sup>10</sup>9  
WTE

Date 1/4/2013

118/247

No.	Time	Locations	See attached LSC printout for Total Activity (cpm/100 cm <sup>2</sup> )
73	1300	Floor Storage Area	1
74			2
75			3
76			4
77		Floor RT from Rear	1
78			2
79			3
80			4
81			5
82			6
83		Floor Front to Rear LT	1
84			2
85			3
86			4
87			5
88			6
89			7
90			8
91		Middle	1
92			2
93			3
94			4
95			5
96			6
97			7
98			8
99	V	RT	1



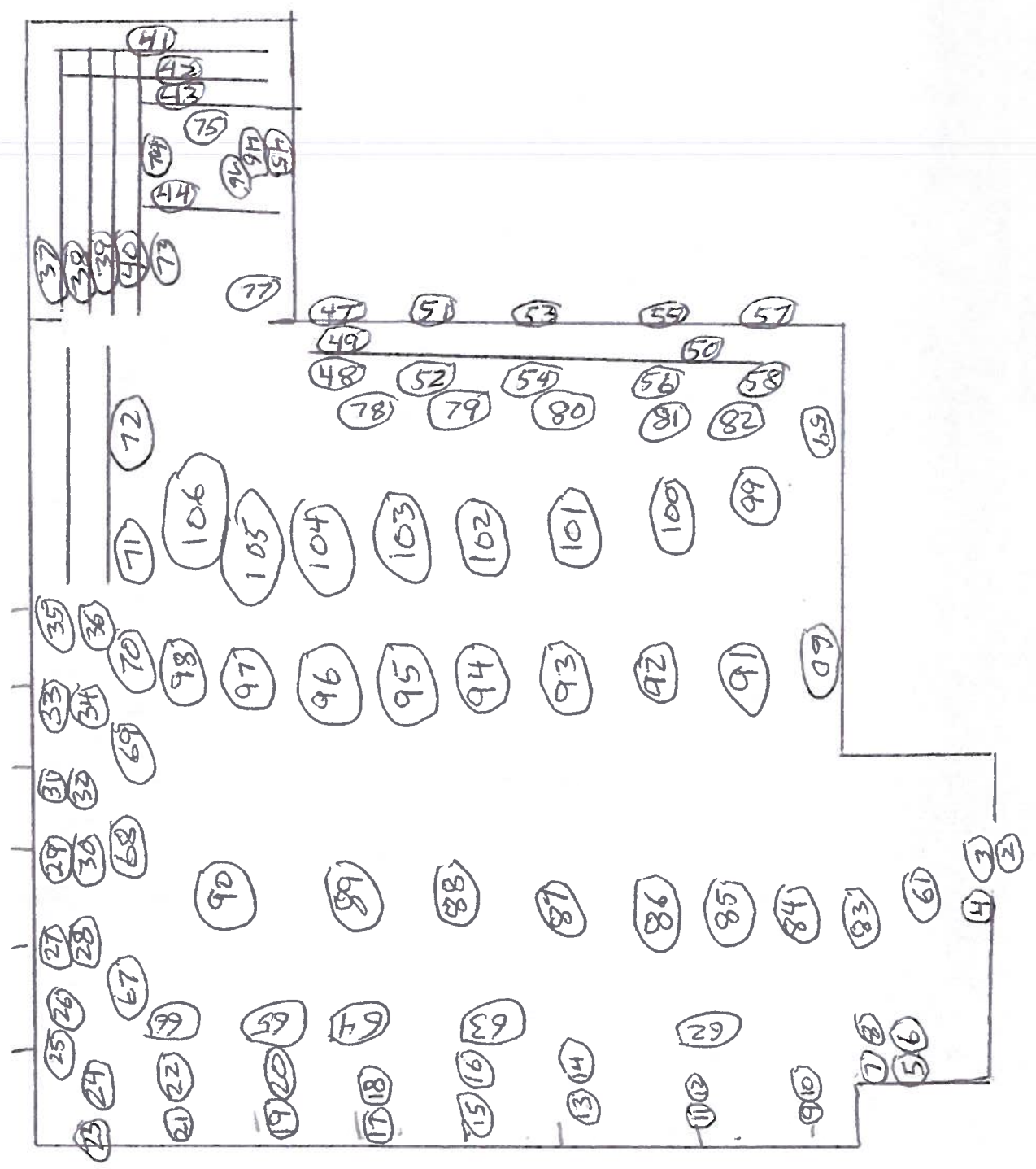

Surveyed 100% of lower SURFACES USING ~~method~~ Luhn 43-68. NO READINGS IN EXCESS OF NORMAL BACKGROUND WERE DETECTED.

○ = wipe TEST LOCATION

Assay Definition-

Assay Description:  
Decon D408-410

Assay Type: CPM  
Report Name: Report1  
Output Data Path: C:\Packard\Tricarb\Results\Pete Keefe\Room Decon\20130104\_1408  
Raw Results Path: C:\Packard\Tricarb\Results\Pete Keefe\Room Decon\20130104\_1408\20130104\_1408.results  
RTF File Name: C:\Packard\Tricarb\Results\Pete Keefe\Room Decon\20130104\_1408\Lab Decon 118 237.rtf  
Assay File Name: C:\Packard\TriCarb\Assays\Room Decon.lsa

Count Conditions-

Nuclide: Triple  
Quench Indicator: tSIE/AEC  
External Std Terminator (sec): 0.5 2s%  
Pre-Count Delay (min): 0.00  
Quench Set: n/a  
Count Time (min): 1.00  
Count Mode: Normal  
Assay Count Cycles: 1 Repeat Sample Count: 1  
#Vials/Sample: 1 Calculate % Reference: Off

Background Subtract: Off  
Low CPM Threshold: Off  
2 Sigma % Terminator: Off

Regions	LL	UL
A	0.0	18.6
B	18.6	156.0
C	0.0	2000.0

Count Corrections-

Static Controller: On Luminescence Correction: On  
Colored Samples: n/a Heterogeneity Monitor: n/a  
Coincidence Time (nsec): 18 Delay Before Burst (nsec): 75

Half Life-

Half Life Correction: Off

Regions	Half Life	Units	Reference Date	Reference Time
A				
B				
C				

Cycle 1 Results

S#	CPMA	CPMB	CPMC	MESSAGES
1	6	6	15	
2	7	6	17	
3	12	5	23	
4	10	5	16	
5	6	8	17	
6	9	9	26	
7	15	10	31	
8	6	6	15	
9	3	6	14	
10	6	5	12	

Lab Decon 118 212

11	6	13	30
12	7	8	17
13	10	4	18
14	13	9	26
15	10	14	26
16	9	9	20
17	9	7	22
18	9	4	20
19	10	2	14
20	8	8	19
21	11	8	25
22	8	6	18
23	12	7	22
24	10	4	18
25	5	6	16
26	15	15	36
27	10	9	23
28	15	4	22
29	9	4	15
30	7	4	12
31	6	3	15
32	4	8	18
33	12	10	24
34	11	7	25
35	9	6	20
36	10	4	18
37	14	6	24
38	6	8	16
39	10	13	29
40	15	4	23
41	8	10	19
42	4	6	15
43	10	8	23
44	5	10	18
45	7	7	20
46	8	6	19
47	10	10	25
48	8	11	22
49	14	6	21
50	8	11	24
51	7	5	15
52	4	3	10
53	7	5	16
54	11	4	17
55	4	2	11
56	6	8	18
57	8	6	20
58	7	4	15
59	10	7	23
60	12	6	22
61	9	6	23
62	8	7	23
63	9	6	18
64	5	11	19
65	12	4	19
66	6	9	23
67	7	7	20
68	6	6	18
69	4	8	15
70	94	33	132
71	6	5	17
72	12	8	23
73	9	7	22

- Note: See reswipe results post decon on 1/10/13  
LTK



16  
off  
with

Lab Decon 118 212

74	7	9	20
75	19	5	28
76	12	7	30
77	8	12	25
78	13	12	27
79	11	5	19
80	13	7	26
81	15	6	26
82	8	8	23
83	9	8	23
84	9	5	18
85	15	5	26
86	9	5	17
87	9	5	16
88	6	10	19
89	7	13	22
90	15	8	26
91	15	10	33
92	13	8	25
93	11	2	13
94	1	5	10
95	11	8	22
96	13	8	27
97	15	7	27
98	4	11	18
99	7	8	22
100	6	8	18
101	5	9	16
102	6	4	13
103	5	16	24
104	15	5	26
105	13	7	26
106	4	6	13

Protocol# 2 - bills swipes.lsa

Assay Definition-

Assay Description:  
Background check for PM Lab (Mikey)

Assay Type: CPM  
Report Name: Report1  
Output Data Path: C:\Packard\Tricarb\Results\bill\bills swipes  
Raw Results Path: C:\Packard\Tricarb\Results\bill\bills swipes\20130111\_1058\20130111\_1058.results  
RTF File Name: C:\Packard\Tricarb\Results\bill\bills swipes\Report1.rtf  
Assay File Name: C:\Packard\TriCarb\Assays\bills swipes.lsa

Count Conditions-

Nuclide: TRIPLE  
Quench Indicator: tSIE/AEC  
External Std Terminator (sec): 0.5 2s%  
Pre-Count Delay (min): 0.00  
Quench Set: n/a  
Count Time (min): 1.00  
Count Mode: Normal  
Assay Count Cycles: 1 Repeat Sample Count: 1  
#Vials/Sample: 1 Calculate % Reference: Off

Background Subtract: Off  
Low CPM Threshold: Off  
2 Sigma % Terminator: Off

Regions	LL	UL
A	0.0	18.6
B	18.6	156.0
C	0.0	2000.0

Count Corrections-

Static Controller: On Luminescence Correction: On  
Colored Samples: n/a Heterogeneity Monitor: n/a  
Coincidence Time (nsec): 18 Delay Before Burst (nsec): 75

Half Life-

Half Life Correction: Off

Regions	Half Life	Units	Reference Date	Reference Time
A				
B				
C				

Cycle 1 Results

S#	CPMA	CPMB	CPMC	MESSAGES	PID	Custom1
10	8	8	22		2	
106	8	8	21		2	