

Radiological Survey Sheet

Job Location PFIZER INC. GROTON, CT. 06340 118/236 Page 1 of 51

Survey Purpose Radiological Survey of Lab Date 5/15/06-5/19/06

Performed by William H. Calver William H. Calver
 (Print) (Sign)

Instrument (Model/S/N)	Packard Tri-Carb S/N 431521	Packard Tri-Carb S/N 431520	Ludlum 2241-2 163603	
Det. (Model/SN)	Internal	Internal	Ludlum 43-68 PR 149613	
Type Rad.	β	β	β	
Cal. Due:	10/12/06	10/12/06	04/14/07	
Check Instruments Used		✓	✓	

No.	Time	Locations	See attached LSC printout for Total Activity (cpm/100 cm ²)
1.	0900	BACKGROUND	
2.		Outside Door	UPPER
3.			MIDDLE
4.			LOWER
5.			DOOR KNOB
6.		Inside Door	UPPER
7.			MIDDLE
8.			LOWER
9.			DOOR KNOB
10.		Front Wall left of Door	UPPER
11.			MIDDLE
12.		UPPER CABINETS left wall from door	FIRST SET OUTER Left Door
13.			UPPER Right Door
14.			LOWER
15.		Inside Lt Door	UPPER
16.			LOWER
17.			Rt Door UPPER
18.	∇		LOWER

Radiological Survey Continuation Sheet

Page 2 of 51

Date 5/15/06

1181236

No.	Time	Locations	See attached LSC printout for Total Activity (cpm/100 cm ²)	
19	0817 ↓	FIRST SET CABINETS TOP SHELF	Left	
20			Right	
21		2ND SHELF	Left	
22			Right	
23		3RD SHELF	Left	
24			Right	
25		SHELF FLOOR	Left	
26			Right	
27		2ND Set of CABINETS OUTSIDE LEFT DOOR	UPPER	
28			LOWER	
29		Right DOOR	UPPER	
30			LOWER	
31		INSIDE LEFT DOOR	UPPER	
32			LOWER	
33		Right DOOR	UPPER	
34			LOWER	
35		2ND Set of CABINETS TOP SHELF	Left	
36			Right	
37		2ND SHELF	Left	
38			Right	
39		3RD SHELF	LEFT	
40			RIGHT	
41		SHELF FLOOR	LEFT	
42			RIGHT	
43		3RD Set of CABINETS OUTSIDE LEFT DOOR	UPPER	
44			LOWER	
45		↓	Right DOOR	UPPER

Radiological Survey Continuation Sheet

Page 3 of 51

Date 5/15/06

1181236

No.	Time	Locations	See attached LSC printout for Total Activity (cpm/100 cm ²)
46	0840	3RD SET OF CABINETS OUTSIDE RIGHT DOOR	LOWER
47		INSIDE LEFT DOOR	UPPER
48			LOWER
49		RIGHT DOOR	UPPER
50			LOWER
51		3RD SET OF CABINETS TOP SHELF	LEFT
52			RIGHT
53		2ND SHELF	LEFT
54			RIGHT
55		3RD SHELF	LEFT
56			RIGHT
57		SHELF FLOOR	LEFT
58			RIGHT
59		LEFT WALL AFTER CABINETS 1ST ROW	UPPER
60			MIDDLE
61			LOWER
62			UPPER
63			MIDDLE
64			LOWER
65		Left Wall Beneath Cabinets from Front	1
66			2
67			3
68			4
69			5
70			6
71			7
72			8

Radiological Survey Continuation Sheet

Page 4 of 51

Date 5/15/06

1181236

No.	Time	Locations	See attached LSC printout for Total Activity (cpm/100 cm ²)
73	0905	BENCH TOP Left Wall From Front	1 FRONT
74			BACK
75			2 FRONT
76			BACK
77			3 FRONT
78			BACK
79			4 FRONT
80			BACK
81			5 FRONT
82			BACK
83			6 FRONT
84			BACK
85			7 FRONT
86			BACK
87			8 FRONT
88			BACK
89		Beneath Left Wall Bench from Door	
90		TOP DRAWER	OUTER
91			INSIDE FRONT
92			REAR
93		2ND DRAWER	OUTER
94			INSIDE FRONT
95			REAR
96		3RD DRAWER	OUTER
97			INSIDE FRONT
98			REAR
99	✓	4th DRAWER	OUTER
			INSIDE FRONT

Radiological Survey Continuation Sheet

Page 5 of 51

Date 5/15/06

1181236

No.	Time	Locations	See attached LSC printout for Total Activity (cpm/100 cm ²)
100	0925	4TH DRAWER	INSIDE REAR
101		^{2ND ROW} CABINET	OUTSIDE DOOR UPPER
102			LOWER
103		INSIDE DOOR	UPPER
104			LOWER
105		Top Shelf	FRONT
106			REAR
107		Shelf Floor	FRONT
108			REAR
109		Left Middle DRAWER OVER KNEE HOLE	OUTER FRONT
110			INSIDE FRONT
111			REAR
112		Right Middle DRAWER ^{over} knee hole	OUTER FRONT
113			INSIDE FRONT
114			REAR
115		Left Wall Knee hole	UPPER
116			LOWER
117		Right Wall Knee hole	UPPER
118			LOWER
119		Right Wall Knee hole	UPPER
120			LOWER
121		^{3RD ROW} TOP DRAWER	OUTER FRONT
122			INSIDE FRONT
123			REAR
124		2ND DRAWER	OUTER FRONT
125			INSIDE FRONT
126	✓		REAR

Radiological Survey Continuation Sheet

Page 6 of 51

Date 5/15/06
1181236

No.	Time	Locations	See attached LSC printout for Total Activity (cpm/100 cm ²)
127	1000	3rd DRAWER OUTER FRONT	
128		INSIDE	FRONT
129			REAR
130		4TH DRAWER OUTER FRONT	
131		INSIDE	FRONT
132			REAR
133		^{4th Row} CABINET OUTER DOOR	UPPER
134			LOWER
135		INSIDE DOOR	UPPER
136			LOWER
137		FLOOR	FRONT
138			REAR
139		Rear Wall from left corner	UPPER
140			MIDDLE
141			LOWER
142		Outer Glass Door left to left office	UPPER
143			MIDDLE
144			LOWER
145		Glass Door Right	UPPER
146			MIDDLE
147			LOWER
148		Inside Glass Door left	UPPER
149			MIDDLE
150			LOWER
151		Right	UPPER
152			MIDDLE
153	✓		LOWER

Radiological Survey Continuation Sheet

Page 7 of 51

Date 5/15/06

1181236

No.	Time	Locations	See attached LSC printout for Total Activity (cpm/100 cm ²)
154	1022	Left Office Desk FRONT wall from door	TOP Left
155			Middle
156			Right
157		Top Desk Drawer	OUTlet FRONT
158			INSIDE FRONT
159			REAR
160		Bottom Drawer	OUTlet FRONT
161			INSIDE FRONT
162			REAR
163		Front wall	Left UPPER
164			MIDDLE
165			LOWER
166		LEFT wall from front	UPPER
167			MIDDLE
168			LOWER
169			right half UPPER
170			MIDDLE
171			LOWER
172		Top Shelf	Left
173			Right
174			Right Left
175			Right
176		2ND shelf	Left Left
177			Right
178			Right Left
179			Right
180	✓	3RD shelf	Left Left

Radiological Survey Continuation Sheet

Page 8 of 51

Date 5/15/06

118/236

No.	Time	Locations	See attached LSC printout for Total Activity (cpm/100 cm ²)
181	1100	3rd Shelf Left-Right	
182		3RD Shelf Right	Left
183			Right
184		Desk TOP from	Left
185			MIDDLE
186			RIGHT
187		TOP DRAWER OUTER	FRONT
188			INSIDE FRONT
189			REAR
190		2ND DRAWER OUTER	FRONT
191			INSIDE FRONT
192			REAR
193		3RD DRAWER OUTER	FRONT
194			INSIDE FRONT
195			REAR
196		Rear Wall Windowsill from	Left 1
197			2
198			3
199			4
200			5
201			6
202			7
203			8
204		Rear Wall below Windowsill from	left UPPER
205			LOWER
206			2
207	✓		

Radiological Survey Continuation Sheet

Page 9 of 51

Date 5/15/06

1181236

No.	Time	Locations	See attached LSC printout for Total Activity (cpm/100 cm ²)
208	1125	Rear Wall below windowsill	3 UPPER
209			LOWER
210			4 UPPER
211			LOWER
212			5 UPPER
213			LOWER
214			6 UPPER
215			LOWER
216		Right Wall from window	UPPER
217			MIDDLE
218			LOWER
219			UPPER
220			MIDDLE
221			LOWER
222		Top Shelf Left	Left
223			Right
224		Right	Left
225			Right
226		Bottom Shelf Left	Left
227			Right
228		Right	Left
229			RIGHT
230		Storage Unit TOP from left	FRONT
231			REAR
232			FRONT
233			REAR
234	✓		FRONT

Radiological Survey Continuation Sheet

Page 10 of 51

Date 5/16/06

1181236

No.	Time	Locations	See attached LSC printout for Total Activity (cpm/100 cm ²)
235	0150		Reat
236	0800	Left UPPER DRAWER FRONT	Left
237			Right
238		Inside Floor	Left
239			Right
240		Left LOWER DRAWER FRONT	Left
241			Right
242		INSIDE Floor	Left
243			Right
244		Right UPPER DRAWER FRONT	Left
245			Right
246		Inside Floor	Left
247			Right
248		Right LOWER DRAWER FRONT	Left
249			Right
250		Inside Floor	Left
251			Right
252		Reat Wall Between offices Book Case TOP SHELF	Left
253			Right
254		2nd Shelf	Left
255			Right
256		3RD shelf	Left
257			Right
258		4th shelf	Left
259			Right
260		5th Shelf	Left
261	↓		Right

Radiological Survey Continuation Sheet

Page 11 of 51

Date 5/16/06

118/236

No.	Time	Locations	See attached LSC printout for Total Activity (cpm/100 cm ²)
262	0820	Bottom Shelf	Left
263			Right
264		Fire Extinguisher Handle	
265		Fire Extinguisher Body	
266		Outside Right Office Glass Wall	UPPER
267			MIDDLE
268			LOWER
269		GLASS DOOR	UPPER
270			MIDDLE
271			LOWER
272		GLASS WALL	UPPER
273			MIDDLE
274			LOWER
275		INSIDE OFFICE GLASS WALL	UPPER
276			MIDDLE
277			LOWER
278		GLASS DOOR	UPPER
279			MIDDLE
280			LOWER
281		GLASS WALL	UPPER
282			MIDDLE
283			LOWER
284		Light Switch	
285		Left Wall from Door	UPPER
286			MIDDLE
287			LOWER
288	↓		UPPER

Radiological Survey Continuation Sheet

Page 12 of 51

Date 5/16/06

1181236

No.	Time	Locations	See attached LSC printout for Total Activity (cpm/100 cm ²)
289	0847		
290		Middle	
291		LOWER	
292		Top Shelf Left	Left
293			Right
294		Right	Left
295			Right
296		2ND Shelf Left	Left
297			Right
298		3RD Shelf ^{Left} Outer Cover	Left
299			Right
300		Right	Left
301			Right
302		Shelf Left	Left
303			Right
304		Shelf Right	Left
305			Right
306		Desk Top from Left	Left
307			MIDDLE
308			RIGHT
309		Desk Drawers Top Drawer Outside	
310		Inside	FRONT
311			REAR
312		2ND DRAWER	OUTSIDE
313			INSIDE FRONT
314			REAR
315	✓	3RD DRAWER	OUTSIDE
			INSIDE FRONT

Radiological Survey Continuation Sheet

Page 13 of 51

Date 5/16/06

1181236

No.	Time	Locations	See attached LSC printout for Total Activity (cpm/100 cm ²)
316	0910	3RD Desk DRAWER	INSIDE FLOOR MAT
317		Windowsill from left	1
318			2
319			3
320			4
321			5
322			6
323			7
324			8
325		Rear wall left Desk Top	Left
326			Right
327		TOP DRAWER	OUTSIDE
328			INSIDE FRONT
329			REAR
330		2ND DRAWER	OUTSIDE
331			INSIDE FRONT
332			REAR
333		Desk Top Rear Wall Right	Left
334			Right
335		DRAWERS TOP	OUTSIDE
336			INSIDE FRONT
337			REAR
338		BOTTOM	OUTSIDE FRONT
339			INSIDE FRONT
340			REAR
341		Rt Wall UPPER SHELVES TOP	Left Left
342	✓		Right

Radiological Survey Continuation Sheet

Page 14 of 51

Date 5/16/06
118/236

No.	Time	Locations	See attached LSC printout for Total Activity (cpm/100 cm ²)
343	0930	RT WALL UPPER SHELVES TOP RIGHT	Left
344			Right
345		2ND Left	Left
346			Right
347			Left
348		Right	Right
349		3RD Left	Left
350			Right
351		Right	Left
352			Right
353		DESKTOP FROM LEFT	Left
354			MIDDLE
355			RIGHT
356		DESK DRAWER TOP FRONT	
357		INSIDE	FRONT
358			REAR
359		2ND OUTSIDE	
360		INSIDE	FRONT
361			REAR
362		3RD OUTSIDE	FRONT
363		INSIDE	FRONT REAR
364			REAR
365		RT Wall from Rear Wall	UPPER
366			MIDDLE
367			LOWER
368		Top shelf	Left
369	✓		Right

Radiological Survey Continuation Sheet

Page 15 of 51

Date 5/16/06

1181236

No.	Time	Locations	See attached LSC printout for Total Activity (cpm/100 cm ²)
370	0950	2nd Shelf	Left
371			Right
372		Bottom Shelf	Left
373			Right
374		RT Wall UPPER Cabinets 1ST UNIT	LT DOOR OUTER UPPER
375			LOWER
376			RT DOOR OUTER UPPER
377			LOWER
378			INSIDE DOOR Left UPPER
379			LOWER
380			INSIDE DOOR Right UPPER
381			LOWER
382		TOP SHELF	Left
383			Right
384		2ND SHELF	Left
385			Right
386		3RD SHELF	Left
387			Right
388		Bottom Shelf	Left
389			Right
390		Right Wall Upper Cabinets 2ND UNIT	LT DOOR OUTER UPPER
391			LOWER
392			RT DOOR OUTER UPPER
393			LOWER
394			INSIDE LT DOOR UPPER
395			LOWER
396	✓		RT DOOR UPPER

Radiological Survey Continuation Sheet

Page 16 of 51

Date 5/16/06

118/236

No.	Time	Locations	See attached LSC printout for Total Activity (cpm/100 cm ²)
397	1130	Inside RT Door	Lower
398		Top Shelf	Left
399			Right
400		2nd shelf	Left
401			Right
402		3rd shelf	Left
403			Right
404		4th shelf	Left
405			Right
406		Wall below Cabinets from Office end	1
407			2
408			3
409			4
410			5
411			6
412			7
413			8
414		Lab Bench RT Wall from Office	1 FRONT
415			REAR
416			2 FRONT
417			REAR
418			3 FRONT
419			REAR
420			4 FRONT
421			REAR
422			5 FRONT
423			REAR

Radiological Survey Continuation Sheet

Page 17 of 51

Date 5/16/06

11 81236

No.	Time	Locations	See attached LSC printout for Total Activity (cpm/100 cm ²)
424	1200	Lab Bench RT Wall from Office	6 FRONT
425			REAR
426			7 FRONT
427			REAR
428			8 FRONT
429			REAR
430		RT UPPER wall after Cabinets	UPPER
431		Pegboard	UPPER
432			LOWER
433		Wall	LOWER
434		Counter Top front of sink	
435		behind sink	
436		TO RT of sink	
437		INSINK FRONT OF SINK	LT
438			RT
439		Left Side	FRONT
440			REAR
441		REAR	LT
442			RT
443		Right Side	FRONT
444			REAR
445		SINK FLOOR	Left
446			Right
447		DRAIN INSIDE	
448		FIRST Row Drawers under Bench Top, LEFT END TOP OUTER FRONT	
449		Inside	FRONT
450	✓		REAR

Radiological Survey Continuation Sheet

Page 18 of 51

Date 5/16/06

1181236

No.	Time	Locations	See attached LSC printout for Total Activity (cpm/100 cm ²)
451	1230	DRAWERS UNDER RT wall Bench left end 2ND DRAWER	OUTSIDE FRONT
452			INSIDE FRONT
453			REAR
454		3RD DRAWER	OUTSIDE FRONT
455			INSIDE FRONT
456			REAR
457		4th DRAWER	OUTSIDE FRONT
458			INSIDE FRONT
459			REAR
460		2ND ROW TOP DRAWER	OUTSIDE FRONT
461			INSIDE FRONT
462			REAR
463		2ND DRAWER	OUTSIDE FRONT
464			INSIDE FRONT
465			REAR
466		CABINET	OUTSIDE FRONT
467			INSIDE FRONT <small>TOP shelf</small>
468			REAR
469			<small>2nd shelf</small> FRONT
470			REAR
471		3RD ROW TOP DRAWER	OUTSIDE FRONT
472			INSIDE FRONT
473			REAR
474		2ND DRAWER	OUTSIDE FRONT
475			INSIDE FRONT
476			REAR
477	✓	3RD DRAWER	OUTSIDE FRONT

Radiological Survey Continuation Sheet

Page 19 of 51

Date 5/17/06

118 236

No.	Time	Locations	See attached LSC printout for Total Activity (cpm/100 cm ²)
478	1300	3RD DRAWER	INSIDE FRONT
479			REAR
480		4TH DRAWER	OUTSIDE FRONT
481			INSIDE FRONT
482	∇		REAR
483	0900	4TH Row TOP DRAWER	OUTSIDE FRONT
484			INSIDE FRONT
485			REAR
486		2ND DRAWER	OUTSIDE FRONT
487			INSIDE FRONT
488			REAR
489		CABINET	OUTSIDE FRONT UPPER
490			LOWER
491			INSIDE FRONT
492			REAR
493		CABINET UNDERSINK	Left DOOR OUTER UPPER
494			LOWER
495			Right DOOR OUTER UPPER
496			LOWER
497			INSIDE Left DOOR UPPER
498			LOWER
499			Right DOOR UPPER
500			LOWER
501			INSIDE ^{FRONT} LEFT FRONT
502			REAR
503			Right FRONT
504	∇		REAR

Radiological Survey Continuation Sheet

Page 20 of 51

Date 5/17/06

1181236

No.	Time	Locations	See attached LSC printout for Total Activity (cpm/100 cm ²)
505	0830	FRONT WALL FROM SINK UPPER	
506		Paper Towel Dispenser	
507		Lower	
508		UPPER	
509		Middle	
510		LOWER	
511		UPPERMOST SECT ABOVE HOOD FROM SINK	1
512			2
513			3
514			4
515			5
516			6
517			7
518			8
519		Next Sect down from sink	1
520			2
521			3
523			4
524			5
525			6
526			7
527			8
528		Next Sect right above glass doors	1
529			2
530			3
531			4
532	✓		5

Radiological Survey Continuation Sheet

Page 21 of 51

Date 5/17/06

1181236

No.	Time	Locations	See attached LSC printout for Total Activity (cpm/100 cm ²)
533	0850		6
534			7
535			8
536		Outer Glass Doors 1	UPPER
537			LOWER
538		2	UPPER
539			LOWER
540		3	UPPER
541			LOWER
542		4	UPPER
543			LOWER
544		5	UPPER
545			LOWER
546		6	UPPER
547			LOWER
548		7	UPPER
549			LOWER
550		8	UPPER
551			LOWER
552		Outside Hood Left	UPPER
553			LOWER
554		Right	UPPER
555			LOWER
556		Inside Hood Glass Wall 1	UPPER
557			LOWER
558		2	UPPER
559	✓		LOWER

Radiological Survey Continuation Sheet

Page 22 of 51

Date 5/17/06
118/236

No.	Time	Locations	See attached LSC printout for Total Activity (cpm/100 cm ²)
560	0920	INSIDE HOOD GLASS WALL ³	UPPER
561			LOWER
562			UPPER ⁴
563			LOWER
564			UPPER ⁵
565			LOWER
566			UPPER ⁶
567			LOWER
568			UPPER ⁷
569			LOWER
570			UPPER ⁸
571			LOWER
572		Inside Left Wall	UPPER
573			LOWER
574		Rear Wall ¹	UPPER
575			LOWER
576			UPPER ²
577			LOWER
578			UPPER ³
579			LOWER
580			UPPER ⁴
581			LOWER
582			UPPER ⁵
583			LOWER
584			UPPER ⁶
585			LOWER
586	✓		UPPER ⁷

Radiological Survey Continuation Sheet

Page 23 of 51

Date 5/17/06

1181236

No.	Time	Locations	See attached LSC printout for Total Activity (cpm/100 cm ²)
587	0952	RT WALL HOOD INSIDE REAR WALL RT END	7 LOWER
588			8 UPPER
589			LOWER
590		OUTER FRONT of HOOD from left	1
591			2
592			3
593			4
594			5
595			6
596			7
597			8
598		TOP Panel Below HOOD	1
599			2
600			3
601			4
602			5
603			6
604		1ST CABINET Below HOOD from LEFT LT DOOR OUTER	UPPER
605			LOWER
606		RT DOOR OUTER	UPPER
607			LOWER
608		INSIDE FLOOR	LEFT
609			RIGHT
610		2ND CABINET LT DOOR OUTER	UPPER
611			LOWER
612		INSIDE White Box FLOOR	LEFT
613	✓		MIDDLE

Radiological Survey Continuation Sheet

Page 24 of 51

Date 5/17/06

1181236

No.	Time	Locations	See attached LSC printout for Total Activity (cpm/100 cm ²)
614	1030		
615			Right
616			Left
617			Middle
618		3RD CABINET LEFT DOOR OUTER	Right
619			UPPER
620			LOWER
621		RIGHT DOOR OUTER	UPPER
622			LOWER
623		INSIDE PLASTIC WHITE BOX	Left
624			Middle
625			Right
626		FLOOR	Left
627			Middle
628			Right
629		Right front corner of Front Wall	UPPER
630			MIDDLE
631			LOWER
632		Top Shelf	Left
633			Right
634		2ND Shelf	Left
635			Right
636		3RD Shelf	Left
637			Right
638		Counter Top	FRONT
639			REAR
640	✓	TOP DRAWER OUTSIDE	FRONT
		INSIDE	FRONT

Radiological Survey Continuation Sheet

Page 25 of 51

Date 5/18/06

1181236

No.	Time	Locations	See attached LSC printout for Total Activity (cpm/100 cm ²)
641	0800	Top Drawer	INSIDE REAR
642		2ND DRAWER	OUTSIDE FRONT
643			INSIDE FRONT
644			REAR
645		3RD DRAWER	OUTSIDE FRONT
646			OUTSIDE INSIDE FRONT
647			REAR
648		4th DRAWER	OUTSIDE FRONT
649			INSIDE FRONT
650			REAR
651		FIRE EXTINGUISHER	Handle
652			Body
653		Inside Hood	RT Wall UPPER
654			LOWER
655		HOOD FLOOR	FROM LEFT 1 FRONT
656			REAR
657			2 FRONT
658			REAR
659			3 FRONT
660			REAR
661			4 FRONT
662			REAR
663			5 FRONT
664			REAR
665			6 FRONT
666			REAR
667	✓		7 FRONT

Radiological Survey Continuation Sheet

Page 26 of 51

Date 5/18/06

118/236

No.	Time	Locations	See attached LSC printout for Total Activity (cpm/100 cm ²)
668	0820	HOOD FLOOR	7 REAR
669			8 FRONT
670			REAR
671		HOOD SINK	INSIDE FRONT WALL LEFT
672			RIGHT
673			LEFT WALL FRONT
674			REAR
675			REAR WALL LEFT
676			RIGHT
677			RIGHT WALL FRONT
678			REAR
679			FLOOR LEFT FRONT
680			REAR
681			RIGHT FRONT
682			REAR
683			DRAIN
684			DRAIN PLUG OUTER
685			INNER
686		SMALL Bench on top of Center Island Bench	from left 1
687			2
688			3
689			4
690			5
691		FRONT of small bench facing doors	1
692			2
693			3
694	✓		4

Radiological Survey Continuation Sheet

Page 27 of 51

Date 5/18/06

1181236

No.	Time	Locations	See attached LSC printout for Total Activity (cpm/100 cm ²)
695	0850		5
696		Small Bench Left leg	Outer
697			Inner
698		Middle leg	OUTER
699			INNER
700		RIGHT LEG	OUTER
701			INNER
702		Bench Top Facing Door from that End ¹	FRONT
703			REAR
704			² FRONT
705			REAR
706			³ FRONT
707			REAR
708			⁴ FRONT
709			REAR
710			⁵ FRONT
711			REAR
712			⁶ FRONT
713			REAR
714			⁷ FRONT
715			REAR
716			⁸ FRONT
717			REAR
718		Bench Top facing Offices from Door End ¹	FRONT
719			REAR
720			² FRONT
721	V		REAR

Radiological Survey Continuation Sheet

Page 28 of 51

Date 5/18/06
118/236

No.	Time	Locations	See attached LSC printout for Total Activity (cpm/100 cm ²)	
722	0915	Bench Top facing offices	3	FRONT
723				REAR
724			4	FRONT
725				REAR
726			5	FRONT
727				REAR
728			6	FRONT
729				REAR
730			7	FRONT
731				REAR
732			8	FRONT
733				REAR
734		Bench Half Facing DOOR from DOOR END FIRST ROW DRAWERS TOP OUTER		
735			INSIDE	FRONT
736				REAR
737		2ND DRAWER	OUTSIDE	FRONT
738			INSIDE	FRONT
739				REAR
740		3RD DRAWER	OUTSIDE	FRONT
741			INSIDE	FRONT
742				REAR
743		4th DRAWER	OUTSIDE	FRONT
744			INSIDE	FRONT
745				REAR
746		2ND ROW TOP DRAWER	OUTSIDE	FRONT
747			INSIDE	FRONT
748	✓			REAR

Radiological Survey Continuation Sheet

Page 29 of 51

Date 5/18/06
1181236

No.	Time	Locations	See attached LSC printout for Total Activity (cpm/100 cm ²)
749	0945		2ND DRAWER OUTSIDE
750			INSIDE FRONT
751			REAR
752		Cabinet OUTSIDE FRONT	UPPER
753			LOWER
754			INSIDE TOP SHELF Left
755			Right
756			2ND shelf Left
757			Right
758		3RD ROW TOP DRAWER OUTSIDE	FRONT
759			INSIDE FRONT
760			REAR
761		Cabinet FRONT	UPPER
762			LOWER
763			INSIDE Top shelf FRONT
764			REAR
765			2ND shelf FRONT
766			REAR
767		4th Row Cabinet ^{4th DRAWER} FRONT OUTSIDE	
768			INSIDE FRONT
769			REAR
770		Cabinet Door OUTSIDE	UPPER
771		inside ^{4th} TO	LOWER
772		inside Top shelf	FRONT
773			REAR
774			2nd shelf FRONT
775	✓		REAR

Radiological Survey Continuation Sheet

Page 30 of 51

Date 5/18/06

1181236

No.	Time	Locations	See attached LSC printout for Total Activity (cpm/100 cm ²)
776	1015	5th ROW TOP DRAWER	OUTSIDE FRONT
777			INSIDE FRONT
778			REAR
779		2ND DRAWER	OUTSIDE FRONT
780			INSIDE FRONT
781			REAR
782		3RD DRAWER	OUTSIDE FRONT
783			INSIDE FRONT
784			REAR
785		4th DRAWER	OUTSIDE FRONT
786			INSIDE FRONT
787			REAR
788		6th ROW TOP DRAWER	OUTSIDE FRONT
789			INSIDE FRONT
790			REAR
791		2ND DRAWER	OUTSIDE FRONT
792			INSIDE FRONT
793			REAR
794		Cabinet	OUTSIDE FRONT UPPER
795			LOWER
796		Top Shelf	FRONT
797			REAR
798		2ND Shelf	FRONT
799			REAR
800		Bench Half facing Offices from Door 1st ROW DRAWERS	TOP OUTER FRONT
801			INSIDE FRONT
802	✓		REAR

Radiological Survey Continuation Sheet

Page 31 of 51

Date 5/18/06

1181236

No.	Time	Locations	See attached LSC printout for Total Activity (cpm/100 cm ²)
803	1042	FIRST ROW 2ND DRAWER	FRONT OUTSIDE
804			INSIDE FRONT
805			REAR
806		Cabinet	Outside DOOR
807			UPPER
808			LOWER
809			FRONT
810			REAR
811			FRONT
812		2ND Row TOP DRAWER	OUTER
813			FRONT
814			INSIDE
815			FRONT
816			INSIDE
817			FRONT
818			REAR
819		3RD DRAWER	OUTER
820			FRONT
821			INSIDE
822			FRONT
823			INSIDE
824			FRONT
825			REAR
826			UPPER
827			LOWER
828			UPPER
829	V		LOWER

Radiological Survey Continuation Sheet

Page 32 of 51

Date 5/18/06

118/236

No.	Time	Locations	See attached LSC printout for Total Activity (cpm/100 cm ²)	
830	1110	3RD Row TOP DRAWER	OUTSIDE	FRONT
831			INSIDE	FRONT
832				REAR
833		2ND DRAWER	OUTSIDE	FRONT
834			INSIDE	FRONT
835				REAR
836		CABINET FRONT	OUTSIDE	UPPER
837				LOWER
838			Inside Top Shelf	FRONT
839				REAR
840			Bottom Shelf	FRONT
841				REAR
842		4th Row Top DRAWER	OUTSIDE	FRONT
843			INSIDE	FRONT
844				REAR
845		2ND	OUTSIDE	FRONT
846			INSIDE	FRONT
847				REAR
848		3RD	OUTSIDE	FRONT
849			INSIDE	FRONT
850				REAR
851		4th	OUTSIDE	FRONT
852			INSIDE	FRONT
853				REAR
854		FLOOR DOORWAY		1
855				2
856	✓			3

Radiological Survey Continuation Sheet

Page 33 of 51

Date 5/18/06

1181236

No.	Time	Locations	See attached LSC printout for Total Activity (cpm/100 cm ²)
857	1135	FLOOR SWIPES	
			4
858		Left Wall Front	5
859		Knee Hole	6
860		Far end of Wall	7
861		IN FRONT of Left Office Doorway	8
862		Right Office Doorway	9
863		Far end of Right Wall	10
864		IN FRONT of Sink	11
865		IN FRONT of Sink	12
866		Far end in front of Hood	13
867		" "	14
868		" "	15
869		" "	16
870		" "	17
871		Closet " "	18
872		IN front of center bench Left End	19
873			20
874			21
875			22
876			23
877			24
878		IN front of center bench ^{from left end} Examine Office	25
879			26
880			27
881			28
882			29
883	✓		30

Assay Definition-

Assay Description:
swipe survey

Assay Type: CPM

Report Name: Report1

Output Data Path: C:\Packard\Tricarb\Results\bill\bills swipes

Raw Results Path: C:\Packard\Tricarb\Results\bill\bills swipes\20060519_0613\20060519_0613.results

RTF File Name: C:\Packard\Tricarb\Results\bill\bills swipes\Report1.rtf

Assay File Name: C:\Packard\TriCarb\Assays\bills swipes.lsa

Count Conditions-

Nuclide: TRIPLE

Quench Indicator: tSIE/AEC

External Std Terminator (sec): 0.5 2s%

Pre-Count Delay (min): 0.00

Quench Set: n/a

Count Time (min): 1.00

Count Mode: Normal

Assay Count Cycles: 1

#Vials/Sample: 1

Repeat Sample Count: 1

Calculate % Reference: Off

Background Subtract: Off

Low CPM Threshold: Off

2 Sigma % Terminator: Off

Regions	LL	UL
A	0.0	18.6
B	18.6	156.0
C	0.0	2000.0

Count Corrections-

Static Controller: On

Colored Samples: n/a

Coincidence Time (nsec): 18

Luminescence Correction: On

Heterogeneity Monitor: n/a

Delay Before Burst (nsec): 75

Half Life-

Half Life Correction: Off

Regions	Half Life	Units	Reference Date	Reference Time
A				
B				
C				

Cycle 1 Results

S#	CPMA	CPMB	CPMC	MESSAGES
1	14	7	26	
2	14	2	20	
3	19	4	25	
4	10	5	21	
5	14	8	25	

Protocol# 2 - bills swipes.lsa

User: bill

6	9	7	21
7	12	10	31
8	11	9	27
9	13	4	22
10	4	8	15
11	9	4	15
12	14	5	22
13	12	10	23
14	10	11	28
15	13	9	26
16	10	4	22
17	11	10	25
18	7	8	25
19	15	4	26
20	13	2	20
21	11	4	19
22	12	2	20
23	14	6	22
24	10	6	20
25	9	7	25
26	10	3	14
27	11	4	22
28	12	5	21
29	8	6	15
30	17	6	30
31	5	2	14
32	9	4	17
33	16	2	26
34	10	10	26
35	8	7	20
36	8	4	14
37	15	11	32
38	11	4	18
39	15	8	29
40	16	6	23
41	12	3	18
42	14	8	25
43	9	7	23
44	11	7	28
45	15	5	22
46	8	9	19
47	12	2	19
48	10	8	25
49	11	8	22
50	12	7	22
51	9	3	16
52	4	7	18
53	14	6	24
54	18	8	33
55	14	7	25
56	17	9	34
57	12	10	28
58	14	6	24
59	10	6	25
60	13	5	22
61	8	5	19
62	11	6	21

Protocol# 2 - bills swipes.lsa

User: bill

63	14	7	31
64	18	5	28
65	7	8	20
66	10	5	23
67	14	6	29
68	5	5	13
69	9	6	21
70	11	6	23
71	7	4	15
72	9	4	18
73	14	3	21
74	8	7	23
75	9	5	17
76	9	8	21
77	6	11	20
78	7	8	21
79	8	8	24
80	11	6	19
81	10	7	20
82	6	8	21
83	9	10	21
84	11	8	24
85	7	9	25
86	11	3	22
87	11	4	18
88	14	5	28
89	10	5	24
90	16	6	25
91	6	4	16
92	12	5	26
93	17	6	30
94	14	4	26
95	12	6	24
96	13	7	25
97	10	4	18
98	8	9	19
99	20	7	31
100	18	12	34
101	8	5	19
102	11	4	18
103	13	6	23
104	14	9	26
105	11	7	25
106	14	7	24
107	15	4	27
108	9	8	23
109	9	10	24
110	18	5	30
111	12	9	28
112	6	9	19
113	12	10	29
114	13	3	20
115	2	7	11
116	14	9	26
117	13	8	31
118	10	12	27
119	11	5	20

120	13	9	28
121	5	7	17
122	14	6	22
123	12	4	24
124	11	6	19
125	19	5	27
126	10	4	22
127	18	9	32
128	11	8	26
129	13	6	24
130	14	7	26
131	17	8	28
132	10	6	19
133	9	4	21
134	15	11	32
135	10	7	24
136	13	6	26
137	9	10	24
138	6	7	18
139	9	9	22
140	4	6	15
141	18	4	27
142	10	10	25
143	9	11	29
144	14	8	27
145	13	4	18
146	14	10	29
147	11	7	24
148	12	3	21
149	10	7	21
150	10	7	22
151	12	7	28
152	10	3	19
153	13	8	26
154	16	7	28
155	13	7	24
156	11	7	24
157	8	10	20
158	13	6	24
159	10	4	17
160	12	7	26
161	7	3	15
162	1	8	12
163	17	6	27
164	8	10	23
165	11	7	20
166	10	4	19
167	14	4	20
168	7	6	14
169	12	7	25
170	13	4	20
171	15	6	22
172	12	7	25
173	18	6	29
174	16	3	25
175	15	6	25
176	20	11	35

177	13	3	21
178	6	7	20
179	12	8	27
180	9	4	18
181	16	6	28
182	16	4	21
183	11	6	23
184	5	8	20
185	11	5	19
186	13	6	20
187	6	6	17
188	9	6	25
189	9	5	22
190	4	6	12
191	8	11	22
192	12	6	20
193	19	9	36
194	11	8	26
195	6	4	12
196	15	2	22
197	10	8	24
198	12	7	21
199	15	3	22
200	8	6	22
201	13	5	20
202	14	10	27
203	7	3	17
204	13	13	27
205	10	3	20
206	11	8	26
207	10	6	21
208	11	6	22
209	10	9	26
210	12	2	21
211	14	4	23
212	12	8	25
213	9	6	24
214	13	8	31
215	14	9	26
216	15	12	33
217	15	3	22
218	8	6	22
219	14	5	24
220	16	2	24
221	8	6	18
222	17	8	32
223	14	10	27
224	9	5	20
225	19	7	29
226	14	8	26
227	9	7	20
228	12	6	24
229	11	7	23
230	11	6	25
231	17	7	27
232	11	5	18
233	8	11	29

Protocol# 2 - bills swipes.lsa

User: bill

234	15	6	25
235	21	6	33
236	9	5	21
237	0	5	13
238	12	6	24
239	6	14	28
240	14	6	28
241	14	5	23
242	4	5	12
243	15	3	19
244	9	11	24
245	14	5	23
246	4	10	21
247	8	6	17
248	20	3	28
249	7	5	17
250	5	4	17
251	17	6	30
252	17	6	27
253	12	2	20
254	7	5	17
255	15	10	30
256	9	6	15
257	5	10	23
258	8	9	22
259	10	1	17
260	11	0	14
261	5	4	15
262	4	3	14
263	14	8	26
264	6	11	22
265	6	5	23
266	11	10	25
267	5	2	16
268	23	10	36
269	18	7	29
270	8	6	16
271	11	5	22
272	8	4	16
273	14	10	31
274	19	5	29
275	11	3	16
276	7	7	20
277	9	10	25
278	11	6	22
279	16	2	22
280	4	7	15
281	13	7	25
282	11	5	19
283	10	5	19
284	16	11	31
285	13	9	27
286	18	3	25
287	6	6	15
288	12	8	27
289	10	7	20
290	16	9	27

Protocol# 2 - bills swipes.lsa

User: bill

291	10	3	18
292	10	9	22
293	9	6	19
294	9	4	25
295	12	7	23
296	14	7	24
297	15	6	24
298	11	9	24
299	2	6	13
300	9	4	16
301	18	11	35
302	9	8	25
303	16	3	26
304	9	7	22
305	11	5	21
306	15	2	19
307	10	8	23
308	18	6	26
309	15	10	32
310	16	10	33
311	13	10	26
312	8	9	18
313	11	6	19
314	15	9	29
315	16	5	27
316	11	8	25
317	1	5	10
318	18	5	26
319	17	5	30
320	8	11	26
321	11	5	23
322	13	3	19
323	6	5	15
324	11	6	19
325	17	5	26
326	7	3	15
327	9	7	22
328	17	7	30
329	9	10	22
330	19	7	36
331	16	6	26
332	11	9	26
333	16	5	24
334	10	4	18
335	13	7	28
336	14	6	23
337	9	2	15
338	12	3	21
339	17	3	27
340	10	4	21
341	1	11	15
342	7	3	11
343	3	7	16
344	10	4	21
345	9	6	19
346	4	6	18
347	15	2	22

Protocol# 2 - bills swipes.lsa

User: bill

348	9	7	24
349	12	6	25
350	13	3	17
351	15	5	24
352	9	2	17
353	6	10	20
354	10	10	25
355	12	8	26
356	19	5	30
357	8	7	19
358	13	11	29
359	15	6	27
360	12	10	27
361	14	5	27
362	13	7	24
363	17	10	29
364	13	10	27
365	18	5	27
366	19	5	32
367	20	10	34
368	5	4	16
369	15	9	26
370	15	10	27
371	15	6	30
372	10	6	20
373	15	9	26
374	16	4	26
375	20	6	28
376	15	5	25
377	5	4	14
378	7	4	15
379	9	4	19
380	14	14	30
381	16	12	30
382	9	9	24
383	17	3	24
384	10	5	20
385	20	5	27
386	8	6	19
387	9	10	24
388	11	3	19
389	17	3	26
390	5	9	19
391	16	5	23
392	10	7	22
393	7	6	15
394	18	6	29
395	6	4	15
396	7	7	22
397	5	3	12
398	17	10	33
399	9	13	27
400	13	3	21
401	10	5	17
402	8	12	21
403	16	10	30
404	9	9	23

Protocol# 2 - bills swipes.lsa

User: bill

405	9	7	20
406	15	11	32
407	15	8	33
408	11	4	16
409	10	8	20
410	12	8	23
411	13	5	24
412	14	3	20
413	14	7	25
414	12	4	21
415	20	10	37
416	6	5	18
417	8	4	18
418	12	5	20
419	8	4	17
420	11	6	19
421	8	7	18
422	7	10	21
423	21	7	34
424	13	6	22
425	7	7	21
426	19	8	34
427	8	7	21
428	10	7	20
429	14	6	27
430	14	3	23
431	9	8	22
432	15	7	28
433	19	6	26
434	12	8	26
435	5	10	18
436	16	6	25
437	14	10	30
438	6	10	19
439	17	4	28
440	10	6	19
441	8	6	25
442	16	4	24
443	14	5	23
444	14	7	24
445	11	3	21
446	9	6	21
447	6	7	19
448	9	7	22
449	12	8	27
450	11	6	27
451	22	5	32
452	13	9	29
453	14	10	28
454	9	7	20
455	13	7	26
456	11	5	24
457	11	5	25
458	13	5	25
459	11	5	20
460	6	6	15
461	21	3	29

Protocol# 2 - bills swipes.lsa

User: bill

462	32	11	45
463	6	8	21
464	13	5	20
465	8	6	19
466	15	11	32
467	9	11	29
468	15	10	32
469	6	3	14
470	7	5	16
471	14	6	24
472	18	7	31
473	9	7	23
474	13	7	25
475	12	4	22
476	9	8	19
477	15	5	31
478	16	4	23
479	3	3	15
480	8	12	22
481	12	7	24
482	8	7	21
483	15	8	28
484	13	16	33
485	10	7	18
486	12	4	23
487	12	10	30
488	5	2	9
489	6	10	23
490	9	3	17
491	17	6	28
492	6	8	16
493	20	6	35
494	19	7	38
495	12	9	24
496	13	6	27
497	18	6	27
498	12	8	25
499	14	11	28
500	3	3	11
501	5	6	19
502	11	5	20
503	19	11	34
504	3	8	18
505	19	13	33
506	10	6	23
507	8	8	23
508	7	9	22
509	9	6	21
510	12	5	20
511	16	6	26
512	21	4	29
513	15	4	24
514	11	8	23
515	11	9	24
516	14	4	23
517	13	4	24
518	12	11	27

519	16	7	30
520	11	9	26
521	26	5	38
522	8	3	15
523	8	7	21
524	18	7	29
525	12	6	21
526	19	8	33
527	8	6	18
528	6	5	13
529	7	6	19
530	17	7	28
531	6	7	17
532	5	6	17
533	8	10	25
534	5	5	20
535	14	9	28
536	6	4	16
537	11	4	20
538	16	5	28
539	21	7	31
540	7	9	26
541	14	3	23
542	13	7	24
543	15	3	23
544	15	11	33
545	4	9	19
546	6	6	15
547	6	9	24
548	5	2	8
549	11	3	18
550	9	9	21
551	15	6	29
552	17	7	33
553	18	9	34
554	11	7	21
555	11	6	19
556	15	5	24
557	18	3	26
558	10	4	23
559	12	4	21
560	2	6	17
561	12	6	20
562	4	9	16
563	7	6	17
564	10	3	18
565	13	8	26
566	13	5	24
567	13	7	24
568	22	4	28
569	14	4	21
570	7	8	20
571	10	11	28
572	15	7	30
573	8	10	24
574	16	10	28
575	14	6	25

Protocol# 2 - bills swipes.lsa

User: bill

576	13	7	31
577	20	5	30
578	7	7	17
579	15	10	28
580	5	8	20
581	13	3	22
582	14	13	31
583	12	3	18
584	10	3	23
585	21	5	27
586	14	5	24
587	12	7	21
588	8	6	17
589	12	4	25
590	11	7	25
591	9	7	24
592	17	7	27
593	15	5	26
594	22	14	45
595	9	4	18
596	20	10	36
597	10	10	29
598	18	7	31
599	8	7	18
600	10	4	19
601	7	3	16
602	11	4	20
603	5	4	14
604	14	7	26
605	5	8	19
606	11	6	24
607	10	8	23
608	3	3	6
609	8	7	19
610	13	4	30
611	11	6	21
612	13	5	25
613	7	8	19
614	15	6	23
615	12	5	20
616	10	4	23
617	25	2	30
618	20	6	30
619	4	7	19
620	12	9	25
621	9	8	24
622	19	6	36
623	19	4	30
624	27	7	41
625	15	3	27
626	38	9	54
627	21	4	29
628	15	11	28
629	16	6	27
630	12	5	22
631	12	11	26
632	9	12	26

633	5	5	13
634	14	5	24
635	16	7	26
636	12	5	20
637	15	5	23
638	19	5	26
639	3	7	13
640	13	8	25
641	8	10	25
642	0	10	12
643	9	5	20
644	11	2	21
645	16	5	27
646	16	10	30
647	14	7	26
648	16	4	23
649	6	8	20
650	6	7	17
651	5	10	19
652	15	5	27
653	13	9	27
654	8	2	17
655	6	6	16
656	8	5	19
657	13	11	32
658	0	3	10
659	6	6	19
660	10	4	18
661	11	5	18
662	4	9	18
663	9	8	24
664	16	10	30
665	9	6	20
666	3	3	15
667	19	10	36
668	14	5	24
669	16	8	26
670	13	7	26
671	15	7	29
672	12	11	25
673	6	7	19
674	10	5	20
675	9	6	24
676	10	8	19
677	11	2	19
678	4	5	12
679	3	5	15
680	6	8	15
681	7	8	20
682	17	7	28
683	9	1	13
684	16	8	27
685	2	8	14
686	17	7	30
687	9	6	18
688	11	6	18
689	12	5	22

Protocol# 2 - bills swipes.lsa

User: bill

690	10	5	19
691	20	12	36
692	12	3	21
693	16	3	28
694	6	6	19
695	13	5	22
696	12	7	23
697	16	7	32
698	7	10	21
699	3	4	16
700	14	7	23
701	7	6	16
702	25	2	33
703	11	3	20
704	9	8	22
705	18	8	33
706	22	4	34
707	14	11	27
708	4	5	12
709	9	8	21
710	9	2	16
711	27	3	43
712	13	8	26
713	13	10	28
714	26	2	33
715	11	5	21
716	4	10	20
717	9	7	19
718	16	5	24
719	3	7	21
720	15	4	24
721	17	6	23
722	7	11	24
723	17	9	31
724	12	5	23
725	13	3	25
726	11	6	20
727	0	3	10
728	8	3	13
729	10	6	20
730	16	5	24
731	19	6	32
732	12	3	20
733	17	7	32
734	16	5	22
735	5	3	3
736	17	5	28
737	4	7	16
738	9	2	15
739	8	4	16
740	24	8	38
741	12	4	19
742	15	5	23
743	10	4	22
744	13	4	22
745	11	6	21
746	14	6	24

Protocol# 2 - bills swipes.lsa

User: bill

747	6	6	20
748	16	7	25
749	18	7	30
750	6	4	16
751	6	11	20
752	9	8	20
753	14	3	22
754	20	7	34
755	0	7	12
756	18	6	28
757	7	9	18
758	6	5	14
759	7	4	18
760	11	7	24
761	9	10	27
762	15	11	31
763	14	8	28
764	11	8	22
765	16	3	23
766	7	9	23
767	8	6	16
768	19	5	26
769	16	7	29
770	9	2	17
771	15	6	28
772	10	7	22
773	12	11	31
774	16	5	26
775	17	10	34
776	14	7	25
777	14	6	24
778	10	14	28
779	21	6	31
780	1	4	10
781	11	3	23
782	19	8	32
783	10	6	20
784	6	6	16
785	13	8	29
786	14	3	24
787	17	4	26
788	6	8	17
789	19	7	30
790	15	3	26
791	7	8	17
792	13	8	24
793	5	12	22
794	11	8	24
795	9	8	22
796	8	10	22
797	12	6	23
798	8	4	17
799	8	3	18
800	15	9	27
801	11	6	25
802	10	6	21
803	10	4	18

Protocol# 2 - bills swipes.lsa

804	8	4	15
805	12	1	16
806	21	10	38
807	18	7	29
808	15	3	22
809	13	7	28
810	1	7	16
811	11	5	19
812	0	4	7
813	17	3	27
814	21	4	34
815	15	3	19
816	12	3	19
817	11	8	21
818	14	9	27
819	3	7	16
820	15	4	26
821	18	3	24
822	12	9	26
823	11	10	32
824	9	5	16
825	7	6	16
826	8	11	25
827	16	9	27
828	13	12	32
829	14	7	22
830	5	4	11
831	16	5	24
832	15	9	28
833	15	9	30
834	11	8	26
835	16	6	30
836	10	11	26
837	7	6	21
838	8	8	24
839	9	6	19
840	6	3	14
841	4	3	11
842	13	8	27
843	11	9	28
844	13	3	21
845	13	2	18
846	9	10	27
847	9	11	27
848	11	7	21
849	13	2	22
850	6	10	22
851	8	7	23
852	5	6	13
853	12	8	25
854	6	3	14
855	20	6	27
856	8	9	23
857	8	5	21
858	15	12	32
859	10	8	26
860	7	8	22

Protocol# 2 - bills swipes.lsa

User: bill

861	9	11	27
862	6	6	16
863	15	5	24
864	13	1	19
865	14	6	25
866	14	8	24
867	17	4	29
868	14	6	27
869	24	12	45
870	18	8	35
871	31	1	36
872	15	8	25
873	10	6	18
874	18	12	35
875	6	7	19
876	8	9	23
877	15	10	29
878	15	8	31
879	3	7	16
880	3	9	16
881	15	10	30
882	17	5	28
883	11	7	23

Protocol# 2 - bills swipes.lsa

Assay Definition-

Assay Description:
swipe survey

Assay Type: CPM

Report Name: Report1

Output Data Path: C:\Packard\Tricarb\Results\bill\bills swipes

Raw Results Path: C:\Packard\Tricarb\Results\bill\bills swipes\20060522_0656\20060522_0656.results

RTF File Name: C:\Packard\Tricarb\Results\bill\bills swipes\Report1.rtf

Assay File Name: C:\Packard\TriCarb\Assays\bills swipes.lsa

Count Conditions-

Nuclide: TRIPLE

Quench Indicator: tSIE/AEC

External Std Terminator (sec): 0.5 2s8

Pre-Count Delay (min): 0.00

Quench Set: n/a

Count Time (min): 1.00

Count Mode: Normal

Assay Count Cycles: 1

#Vials/Sample: 1

Repeat Sample Count: 1

Calculate % Reference: Off

Background Subtract: Off

Low CPM Threshold: Off

2 Sigma % Terminator: Off

Regions	LL	UL
A	0.0	18.6
B	18.6	156.0
C	0.0	2000.0

Count Corrections-

Static Controller: On

Colored Samples: n/a

Coincidence Time (nsec): 18

Luminescence Correction: On

Heterogeneity Monitor: n/a

Delay Before Burst (nsec): 75

Half Life-

Half Life Correction: Off

Regions	Half Life	Units	Reference Date	Reference Time
A				
B				
C				

Cycle 1 Results

S#	CPMA	CPMB	CPMC	MESSAGES
1	8	12	24	Background
2	34	4	44	#626

Note: Above result of reread of sample is SATISFACTORY with Calver

Bld. 118 Room 236

Page 51A of 51
~~51~~
WHE

Date: 5-19-06

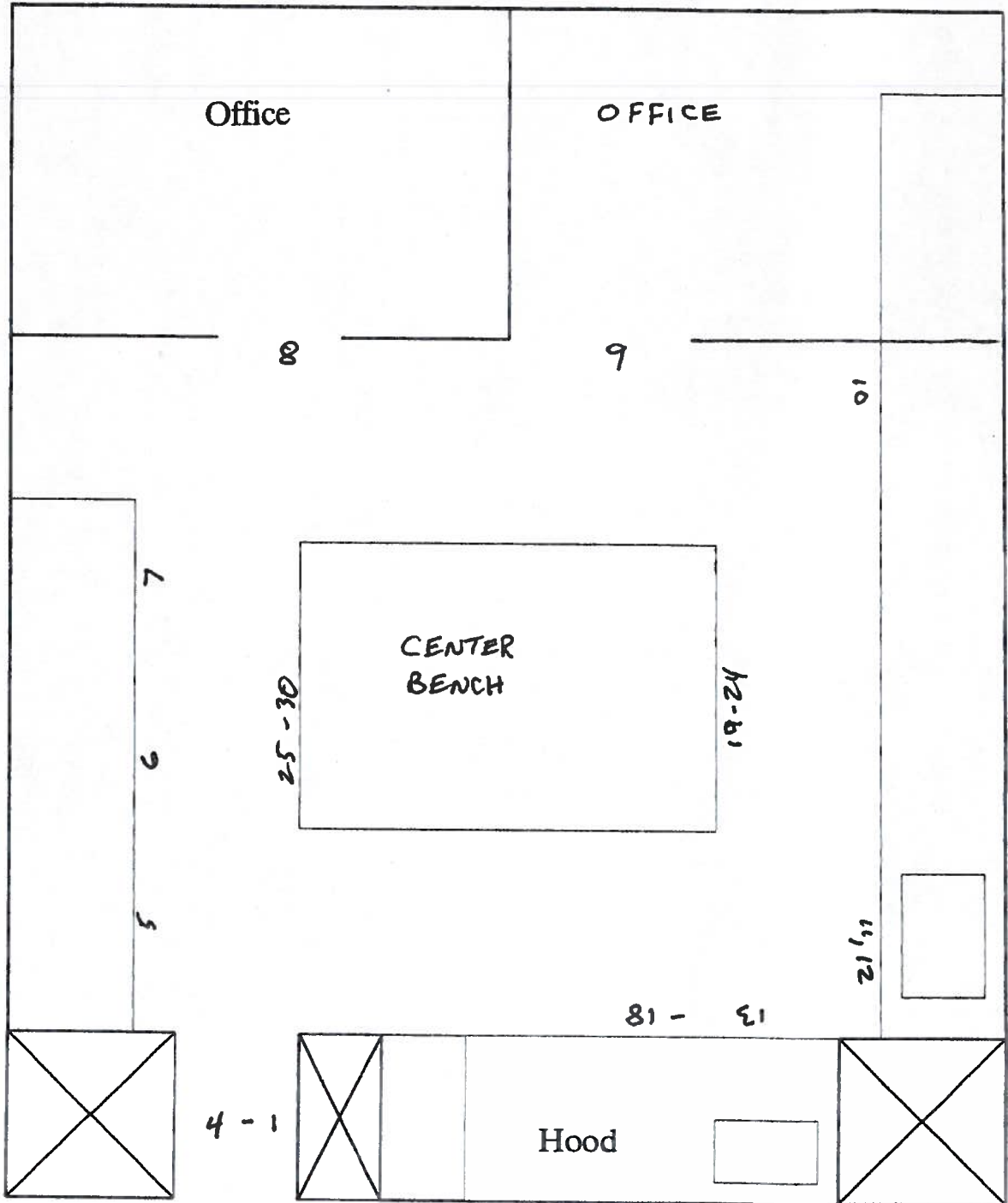

Surveyed 100% of lower surfaces using 43-68. No readings in excess of normal background levels were observed.