

## Radiological Survey Sheet

Job Location PEIZER INC, Glaston, CT. 06340 118/231 Page 1 of 24

Survey Purpose Radiological Survey of Equipment Date 8/16/06

Performed by William H. Calver William H. Calver  
 (Print) (Sign)

<b>Instrument (Model/S/N)</b>	Packard Tri-Carb S/N 431521	Packard Tri-Carb S/N 431520	Ludlum 2241-2 163603	
<b>Det. (Model/SN)</b>	Internal	Internal	Ludlum 43-68 PR 149613	
<b>Type Rad.</b>	β	β	β	
<b>Cal. Due:</b>	10/12/06	10/12/06	04/14/07	
<b>Check Instruments Used</b>		✓	✓	

No.	Time	Locations	See attached LSC printout for Total Activity (cpm/100 cm <sup>2</sup> )
1.	0730	BACKGROUND	
2.		Outside Door	UPPER
3.			MIDDLE
4.			LOWER
5.		Door Knob Outer	
6.		Inside Door	UPPER
7.			MIDDLE
8.			LOWER
9.		Door Knob Inside	
10.		Wall Left Side	UPPER
11.			MIDDLE
12.			LOWER
13.			UPPER
14.			MIDDLE
15.			LOWER
16.		Outer Left End Hood	UPPER
17.			UPPER MIDDLE
18.	✓		LOWER MIDDLE

# Radiological Survey Continuation Sheet

Page 2 of 24

Date 8/16/06

118/231

No.	Time	Locations	See attached LSC printout for Total Activity (cpm/100 cm <sup>2</sup> )
19	0750	Hood left Half Above	TOP
20			MIDDLE
21			LOWER
22			2 TOP
23			MIDDLE
24			LOWER
25			3 TOP
26			MIDDLE
27			LOWER
28		Hood left Half	Left Front Controls UPPER
29			LOWER
30		Outer Glass	left
31			Middle
32			Right
33		Outer Sash	Left
34			Middle
35			Right
36		Inside left Hood Glass	Left
37			Middle
38			Right
39		left Wall	UPPER
40			LOWER
41		Left Rez- Wall	left UPPER
42			LOWER
43			Middle UPPER
44			LOWER
45	✓		Right UPPER

## Radiological Survey Continuation Sheet

Page 3 of 24

Date 8/16/2006  
118/231

No.	Time	Locations	See attached LSC printout for Total Activity (cpm/100 cm <sup>2</sup> )	
46	0815	HOOD <sup>Left Half</sup> Rear Wall	Right	Lower
47		FLOOR Left #1	FRONT	
48			BACK	
49			#2 FRONT	
50			BACK	
51			#3 FRONT	
52			BACK	
53			#4 FRONT	
54			BACK	
55		HOOD Right Half Above	1	TOP
56			MIDDLE	
57			LOWER	
58			2	TOP
59			MIDDLE	
60			LOWER	
61			3	TOP
62			MIDDLE	
63			LOWER	
64		HOOD Right Half	Controls	UPPER
65				LOWER
66		Outer Glass from Left		Left
67				MIDDLE
68				RIGHT
69		OUTER SASH		Left
70				MIDDLE
71				RIGHT
72	✓	INSIDE HOOD RIGHT HALF	Glass FRONT	Left

# Radiological Survey Continuation Sheet

Page 4 of 24

Date 8/16/2006

118/231

No.	Time	Locations	See attached LSC printout for Total Activity (cpm/100 cm <sup>2</sup> )
73	0836	INSIDE HOOD RIGHT HALF GLASS FRONT	MIDDLE
74			RIGHT
75		INSIDE HOOD RIGHT HALF REAR WALL from left	1 UPPER
76			LOWER
77			2 UPPER
78			LOWER
79			3 UPPER
80			LOWER
81			4 UPPER
82			LOWER
83		INSIDE HOOD RIGHT HALF RIGHT WALL	UPPER
84			LOWER
85		FLOOR from MIDDLE TO RIGHT	1 FRONT
86			REAR
87			2 FRONT
88			REAR
89			3 FRONT
<del>90</del>			REAR
91			4 FRONT
92			REAR
93		Below left half of HOOD Panel	LEFT
94			MIDDLE
95		Below left half of HOOD	RIGHT
96		Outer Left Cabinet Door	UPPER
97			LOWER
98		Outer Right Cabinet Door	UPPER
99	∨		LOWER

# Radiological Survey Continuation Sheet

Page 5 of 24

Date 8/16/2006

118231

No.	Time	Locations	See attached LSC printout for Total Activity (cpm/100 cm <sup>2</sup> )
100	0902	Inside Left Cabinet Door	UPPER
101		<del>Left</del> Right Cabinet Door	LOWER
102		Right Cabinet Door	UPPER
103		" Cabinet Door	LOWER
104		Inside First Cabinet Upper Shelf	Left
105			MIDDLE
106			RIGHT
107		Lower Shelf	Left
108			MIDDLE
109			RIGHT
110		Panel above 2nd Cabinet	
111		Second Cabinet Outer Door	UPPER
112			LOWER
113		INSIDE DOOR	UPPER
114			LOWER
115		TOP Shelf	Left
116			Right
117		LOWER Shelf	Left
118			RIGHT
119		THIRD CABINET Below HOOD Outer Left Door	UPPER
120			LOWER
121		Right Door	UPPER
122			LOWER
123		INSIDE Left Door	UPPER
124			LOWER
125		Right Door	UPPER
126	✓		LOWER

# Radiological Survey Continuation Sheet

Page 6 of 24

Date 8/16/2006  
118/231

No.	Time	Locations	See attached LSC printout for Total Activity (cpm/100 cm <sup>2</sup> )
127	0930	THIRD CABINET	TOP SHELF
128			Left
129			MIDDLE
130			RIGHT
131			BOTTOM SHELF
132			LEFT
133			MIDDLE
134			RIGHT
135		OUTSIDE Right Side of HOOD	UPPER
136			MIDDLE
137		<del>Left Wall Right End after Hood</del>	LOWER
138		Left Wall Right End after Hood Above Bench	TOP
139			UPPER
140			MIDDLE
141			LOWER
142		Bench Top after HOOD	FRONT
143			BACK
144			FRONT
145			BACK
146		Below Bench Top	TOP DRAWER OUTER
147			INNER
148			FLOOR
149			Left
150			RIGHT
151			2ND DRAWER OUTER
152			Left
153			Right
154			INSIDE
155			Left
156			Right
157			Left
158			RIGHT
159			Left
160			RIGHT
161			Left
162			RIGHT
163			Left
164			RIGHT
165			Left
166			RIGHT
167			Left
168			RIGHT
169			Left
170			RIGHT
171			Left
172			RIGHT
173			Left
174			RIGHT
175			Left
176			RIGHT
177			Left
178			RIGHT
179			Left
180			RIGHT
181			Left
182			RIGHT
183			Left
184			RIGHT
185			Left
186			RIGHT
187			Left
188			RIGHT
189			Left
190			RIGHT
191			Left
192			RIGHT
193			Left
194			RIGHT
195			Left
196			RIGHT
197			Left
198			RIGHT
199			Left
200			RIGHT
201			Left
202			RIGHT
203			Left
204			RIGHT
205			Left
206			RIGHT
207			Left
208			RIGHT
209			Left
210			RIGHT
211			Left
212			RIGHT
213			Left
214			RIGHT
215			Left
216			RIGHT
217			Left
218			RIGHT
219			Left
220			RIGHT
221			Left
222			RIGHT
223			Left
224			RIGHT
225			Left
226			RIGHT
227			Left
228			RIGHT
229			Left
230			RIGHT
231			Left
232			RIGHT
233			Left
234			RIGHT
235			Left
236			RIGHT
237			Left
238			RIGHT
239			Left
240			RIGHT
241			Left
242			RIGHT
243			Left
244			RIGHT
245			Left
246			RIGHT
247			Left
248			RIGHT
249			Left
250			RIGHT
251			Left
252			RIGHT
253			Left
254			RIGHT
255			Left
256			RIGHT
257			Left
258			RIGHT
259			Left
260			RIGHT
261			Left
262			RIGHT
263			Left
264			RIGHT
265			Left
266			RIGHT
267			Left
268			RIGHT
269			Left
270			RIGHT
271			Left
272			RIGHT
273			Left
274			RIGHT
275			Left
276			RIGHT
277			Left
278			RIGHT
279			Left
280			RIGHT
281			Left
282			RIGHT
283			Left
284			RIGHT
285			Left
286			RIGHT
287			Left
288			RIGHT
289			Left
290			RIGHT
291			Left
292			RIGHT
293			Left
294			RIGHT
295			Left
296			RIGHT
297			Left
298			RIGHT
299			Left
300			RIGHT
301			Left
302			RIGHT
303			Left
304			RIGHT
305			Left
306			RIGHT
307			Left
308			RIGHT
309			Left
310			RIGHT
311			Left
312			RIGHT
313			Left
314			RIGHT
315			Left
316			RIGHT
317			Left
318			RIGHT
319			Left
320			RIGHT
321			Left
322			RIGHT
323			Left
324			RIGHT
325			Left
326			RIGHT
327			Left
328			RIGHT
329			Left
330			RIGHT
331			Left
332			RIGHT
333			Left
334			RIGHT
335			Left
336			RIGHT
337			Left
338			RIGHT
339			Left
340			RIGHT
341			Left
342			RIGHT
343			Left
344			RIGHT
345			Left
346			RIGHT
347			Left
348			RIGHT
349			Left
350			RIGHT
351			Left
352			RIGHT
353			Left
354			RIGHT
355			Left
356			RIGHT
357			Left
358			RIGHT
359			Left
360			RIGHT
361			Left
362			RIGHT
363			Left
364			RIGHT
365			Left
366			RIGHT
367			Left
368			RIGHT
369			Left
370			RIGHT
371			Left
372			RIGHT
373			Left
374			RIGHT
375			Left
376			RIGHT
377			Left
378			RIGHT
379			Left
380			RIGHT
381			Left
382			RIGHT
383			Left
384			RIGHT
385			Left
386			RIGHT
387			Left
388			RIGHT
389			Left
390			RIGHT
391			Left
392			RIGHT
393			Left
394			RIGHT
395			Left
396			RIGHT
397			Left
398			RIGHT
399			Left
400			RIGHT

# Radiological Survey Continuation Sheet

Page 7 of 24

Date 8/16/2006  
1181231

No.	Time	Locations	See attached LSC printout for Total Activity (cpm/100 cm <sup>2</sup> )
154	0935	3RD DRAWER OUTER	RIGHT
155		INSIDE FLOOR	Left
156			Right
157		4th DRAWER OUTER	Left
158			Right
159		INSIDE FLOOR	Left
160			Right
161		Rear Wall from Left Corner <sup>1</sup>	UPPER
162			MIDDLE
163			LOWER
164			2 UPPER
165			MIDDLE
166			LOWER
167			3 UPPER
168			MIDDLE
169			LOWER
170			4 UPPER
171			MIDDLE
172			LOWER
173		Rear Wall Bench TOP TO SINK	Left
174			MIDDLE
175			RIGHT
176		Rear Wall Cabinets above Sink Outer Left Wall	UPPER
177			LOWER
178			Paper Dispenser
179		Outer Left Door	UPPER
180	✓		MIDDLE

- See Note.

# Radiological Survey Continuation Sheet

Page 8 of 24

Date 8/16/2006

118/231

No.	Time	Locations	See attached LSC printout for Total Activity (cpm/100 cm <sup>2</sup> )
181	1000	Reat Wall Cabinets above Sink Outer Left Door	LOWER
182		Right Door	UPPER
183			MIDDLE
184			LOWER
185		Inside Top Shelf	Left
186			Middle
187			Right
188		2nd Shelf	Left
189			Middle
190			Right
191		3RD shelf	Left
192			Middle
193			Right
194		FLOOR	Left
195			Middle
196			Right
197		Wall below Upper Cabinets	Left
198			2ND
199			3RD
200			4TH
201		Counter Top Left of Sink	
202		Right of Sink To Rt Wall	1
203			2
204			3
205		INSIDE SINK FRONT	Left
206			Right
207	✓	Left Side	



# Radiological Survey Continuation Sheet

Page 9 of 24

Date 8/16/2006

118/231

No.	Time	Locations	See attached LSC printout for Total Activity (cpm/100 cm <sup>2</sup> )
208	1025	Inside Sink Rear Wall	Left
209			Right
210		Right Wall	
211		Sink FLOOR Left side	FRONT
212			Rear
213		Right side	FRONT
214			Rear
215		SINK DRAIN	
216		Panel below Sink	Left
217			Right
218		Cabinet below Sink	Outer-Left Wall UPPER
219			LOWER
220		FRONT DOOR Left	UPPER
221			LOWER
222		Right	UPPER
223			LOWER
224		Inside Door Left	UPPER
225			LOWER
226		Inside Left Wall	UPPER
227			LOWER
228		Rear Wall	Left
229			Right
230		Right Wall	UPPER
231			LOWER
232		FLOOR Left Half	FRONT
233			REAR
234	✓	Right Half	FRONT

# Radiological Survey Continuation Sheet

Page 10 of 24

Date 8/16/2006  
1181231

No.	Time	Locations	See attached LSC printout for Total Activity (cpm/100 cm <sup>2</sup> )
235	1050	Cabinet Below Sink Floor Right Half Rear	
236		Rear Right Wall Above bench Cabinet Outer Door Left	Upper
237			Middle
238			Lower
239			Right Door UPPER
240			MIDDLE
241			LOWER
242		Inside Top Shelf	Left
243			Right
244		2nd Shelf	Left
245			Right
246		3rd Shelf	Left
247			Right
248		FLOOR	Left
249			Right
250		2ND Set Cabinets above Bench Outer Left Door	Upper
251			Middle
252			LOWER
253		Right Door	Upper
254			MIDDLE
255			LOWER
256		Inside Top Shelf	Left
257			Right
258		2nd Shelf	Left
259			Right
260		FLOOR	Left
261	✓		Right

# Radiological Survey Continuation Sheet

Page 11 of 24

Date 8/16/2006  
118/231

No.	Time	Locations	See attached LSC printout for Total Activity (cpm/100 cm <sup>2</sup> )
262	1118	Extra Shelf	Left
263			Right
264		Wall below Upper Cabinets from Rear	1
265			2
266			3
267			4
268			5
269		Bench Top from Rear Corner to Front End	1 FRONT
270			REAR
271			2 FRONT
272			REAR
273			3 FRONT
274			REAR
275			4 FRONT
276			REAR
277			5 FRONT
278			REAR
279		Drawer below Bench	OUTER
280			INSIDE FLOOR FRONT
281			REAR
282		Cabinet below Drawer	OUTER DOOR UPPER
283			LOWER
284		Inside Top Shelf	FRONT
285			REAR
286		FLOOR	FRONT
287			REAR
288	✓	Inside Knee Hole Left Wall	UPPER

# Radiological Survey Continuation Sheet

Page 12 of 24

Date 8/16/2006  
118/231

No.	Time	Locations	See attached LSC printout for Total Activity (cpm/100 cm <sup>2</sup> )
289	1345	Inside Knee Hole Left Wall	Lower
290		Rear Wall Left	UPPER
291			Lower
292		Right	UPPER
293			Lower
294		Right Wall	UPPER
295			Lower
296		OUTER Front End of Bench	UPPER
297			Lower
298		Wall before door	UPPER
299			MIDDLE
300			Lower
301		Fire Extinguisher	Handle
302			Body
303		Left Door EXT	UPPER
304			MIDDLE
305			Lower
306		DOOR INSIDE	UPPER
307			MIDDLE
308			Handle
309			Lower
310		OUTSIDE Door	UPPER
311			MIDDLE
312			Handle
313			Lower
314		Wall INSIDE ABOVE Side Door from left	1
315	✓		2

# Radiological Survey Continuation Sheet

Page 13 of 24

Date 8/17/06

1181231

No.	Time	Locations	See attached LSC printout for Total Activity (cpm/100 cm <sup>2</sup> )
316	0815	Right Wall after Door To	FRONT CORNER UPPER
317			MIDDLE
318			LOWER
319			UPPER
320			MIDDLE
321			LOWER
322		FRONT WALL from Right Corner To Door	UPPER
323			MIDDLE
324			LOWER
325			UPPER
326			MIDDLE
327			LOWER
328			UPPER
329			MIDDLE
330			LOWER
331		PINETWORK from Ceiling	UPPER
332			MIDDLE
333			MIDDLE
334			LOWER
335		INSIDE OPENING	
336		Fire EXTINGUISHER Handle	
337		Body	
338		Light Switch	
339		FLOOR In front of Door	center Left Tile
340			Right Tile
341		In front of Head	1
342	✓		2



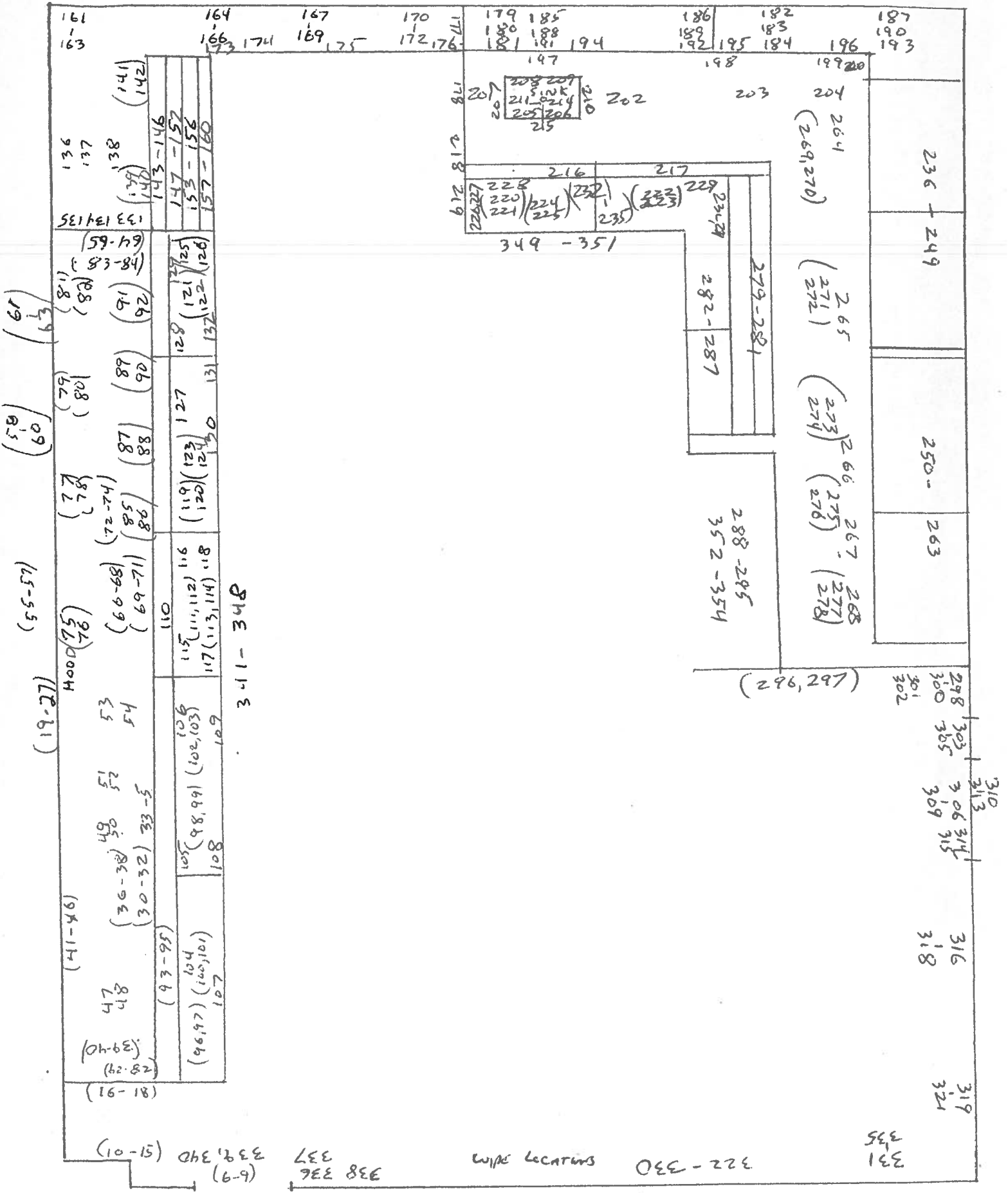

Survey 100% of lower surfaces with 43-66.  
 NO READINGS ABOVE NORMAL SPACINGS WERE OBTAINED.

Protocol# 1 - bills swipes.lsa

User: bill

## Assay Definition-

Assay Description:  
swipe survey

Assay Type: CPM

Report Name: Report1

Output Data Path: C:\Packard\Tricarb\Results\bill\bills swipes

Raw Results Path: C:\Packard\Tricarb\Results\bill\bills swipes\20060817\_1002\20060817\_1002.results

RTF File Name: C:\Packard\Tricarb\Results\bill\bills swipes\Report1.rtf

Assay File Name: C:\Packard\TriCarb\Assays\bills swipes.lsa

## Count Conditions-

Nuclide: TRIPLE

Quench Indicator: tSIE/AEC

External Std Terminator (sec): 0.5 2s%

Pre-Count Delay (min): 0.00

Quench Set: n/a

Count Time (min): 1.00

Count Mode: Normal

Assay Count Cycles: 1

Repeat Sample Count: 1

#Vials/Sample: 1

Calculate % Reference: Off

Background Subtract: Off

Low CPM Threshold: Off

2 Sigma % Terminator: Off

Regions	LL	UL
A	0.0	18.6
B	18.6	156.0
C	0.0	2000.0

## Count Corrections-

Static Controller: On

Luminescence Correction: On

Colored Samples: n/a

Heterogeneity Monitor: n/a

Coincidence Time (nsec): 18

Delay Before Burst (nsec): 75

## Half Life-

Half Life Correction: Off

Regions	Half Life	Units	Reference Date	Reference Time
A				
B				
C				

## Cycle 1 Results

S#	CPMA	CPMB	CPMC	MESSAGES
1	13	5	30	
2	12	7	22	
3	12	10	26	
4	17	8	30	
5	14	4	24	



Protocol# 1 - bills swipes.lsa

User: bill

6	16	5	24
7	15	10	27
8	9	6	22
9	13	3	19
10	11	4	20
11	15	3	22
12	23	7	36
13	15	5	24
14	12	7	23
15	14	5	26
16	8	3	17
17	10	7	24
18	12	4	17
19	10	6	22
20	9	5	20
21	13	6	26
22	14	6	24
23	14	8	23
24	8	14	35
25	13	9	27
26	6	6	18
27	18	16	41
28	21	5	31
29	15	11	33
30	11	4	18
31	9	5	20
32	15	7	26
33	11	5	27
34	16	3	26
35	9	8	20
36	6	1	9
37	14	8	28
38	11	6	20
39	16	6	27
40	9	5	17
41	5	5	14
42	7	10	22
43	13	7	32
44	14	7	24
45	13	8	27
46	13	8	24
47	20	9	32
48	7	8	21
49	14	8	25
50	20	8	30
51	10	10	24
52	13	8	26
53	19	7	35
54	9	4	18
55	11	2	17
56	18	6	25
57	7	6	16
58	18	9	31
59	2	8	17
60	7	7	21
61	15	4	28
62	4	6	16

Protocol# 1 - bills swipes.lsa

User: bill

63	13	8	23
64	10	7	23
65	9	9	20
66	10	8	19
67	16	7	28
68	11	7	26
69	15	6	26
70	19	10	32
71	10	7	25
72	14	4	28
73	7	7	20
74	16	10	34
75	9	10	19
76	8	7	20
77	7	7	19
78	17	8	27
79	10	2	20
80	16	7	28
81	12	11	30
82	15	7	27
83	6	5	15
84	14	5	25
85	9	3	20
86	15	5	23
87	12	5	23
88	12	8	24
89	26	15	50
90	17	8	27
91	15	11	29
92	17	8	29
93	19	6	30
94	15	7	27
95	10	7	18
96	8	7	17
97	8	6	17
98	19	6	29
99	13	6	26
100	6	7	17
101	5	6	16
102	12	5	23
103	13	5	26
104	11	6	24
105	13	6	26
106	13	4	22
107	7	10	25
108	15	7	34
109	16	5	27
110	16	9	29
111	15	6	24
112	17	8	29
113	10	8	23
114	11	10	21
115	14	10	30
116	16	6	28
117	14	9	27
118	7	4	18
119	11	6	22

Protocol# 1 - bills swipes.lsa

User: bill

120	18	7	29
121	12	4	18
122	15	9	28
123	6	4	15
124	14	4	24
125	7	7	19
126	16	2	20
127	15	5	26
128	14	6	23
129	11	4	19
130	17	5	25
131	14	10	29
132	14	3	21
133	7	11	20
134	11	5	20
135	7	3	15
136	7	3	19
137	11	11	31
138	14	4	21
139	12	9	27
140	10	9	25
141	8	9	20
142	16	8	30
143	12	10	26
144	15	2	23
145	16	11	32
146	14	9	31
147	15	6	30
148	13	4	23
149	19	10	34
150	6	7	13
151	16	9	27
152	15	7	29
153	13	11	32
154	16	10	33
155	48	30	81
156	19	5	28
157	14	7	30
158	9	6	17
159	14	14	35
160	17	7	29
161	9	3	22
162	14	6	22
163	11	3	22
164	26	2	36
165	15	9	31
166	13	4	20
167	9	5	17
168	14	7	27
169	21	2	25
170	17	5	26
171	11	7	24
172	6	2	12
173	11	4	18
174	4	7	14
175	17	9	33
176	14	5	25

Protocol# 1 - bills swipes.lsa

User: bill

177	12	6	24
178	11	2	16
179	10	6	23
180	16	9	30
181	16	7	25
182	16	8	30
183	9	4	20
184	16	3	25
185	18	5	34
186	14	5	23
187	10	8	26
188	21	8	32
189	18	5	31
190	12	4	21
191	18	2	25
192	9	10	22
193	13	3	27
194	9	9	23
195	15	6	26
196	16	7	28
197	9	1	16
198	9	7	20
199	8	4	18
200	1	5	7
201	7	6	17
202	17	3	27
203	13	5	20
204	21	3	24
205	14	3	20
206	7	10	22
207	13	9	25
208	12	11	32
209	8	3	14
210	16	6	27
211	11	8	23
212	7	6	18
213	16	11	32
214	18	8	29
215	8	4	14
216	11	9	20
217	11	8	27
218	11	6	21
219	9	5	16
220	20	9	33
221	15	8	26
222	8	11	32
223	10	6	21
224	15	10	34
225	17	6	31
226	12	8	24
227	14	8	27
228	6	2	13
229	14	8	28
230	15	5	28
231	11	3	18
232	7	7	16
233	6	4	12

Protocol# 1 - bills swipes.lsa

User: bill

234	16	8	26
235	21	3	35
236	19	5	29
237	11	6	21
238	12	10	27
239	6	5	16
240	10	5	22
241	14	6	22
242	8	4	22
243	17	7	30
244	8	4	18
245	16	3	21
246	9	2	15
247	29	7	42
248	7	5	17
249	6	4	18
250	8	7	20
251	24	7	33
252	14	6	22
253	10	9	23
254	8	3	13
255	17	5	27
256	14	6	23
257	16	5	32
258	18	11	31
259	22	9	35
260	14	10	29
261	12	6	22
262	14	9	27
263	15	4	22
264	15	5	24
265	12	1	20
266	5	7	18
267	7	5	19
268	17	7	28
269	16	3	23
270	14	8	28
271	12	3	24
272	11	5	23
273	17	8	31
274	17	3	23
275	19	5	29
276	16	2	22
277	22	5	33
278	18	4	23
279	9	7	20
280	16	8	26
281	10	7	23
282	10	7	24
283	10	6	22
284	8	5	14
285	18	5	28
286	13	8	26
287	23	6	34
288	11	9	28
289	10	7	20
290	9	10	26

Protocol# 1 - bills swipes.lsa

User: bill

291	29	7	40
292	7	5	14
293	6	7	16
294	11	9	28
295	22	6	33
296	9	10	26
297	13	7	29
298	22	9	35
299	13	8	29
300	20	9	35
301	16	8	29
302	14	11	28
303	8	6	19
304	10	9	24
305	12	10	25
306	14	7	27
307	14	8	29
308	7	6	22
309	19	9	33
310	18	2	24
311	8	7	17
312	12	5	22
313	19	8	29
314	14	10	26
315	14	2	19
316	25	4	35
317	11	9	27
318	16	2	25
319	12	6	26
320	12	6	24
321	16	5	26
322	12	4	22
323	10	6	24
324	8	3	16
325	3	6	13
326	19	5	28
327	21	2	32
328	8	10	23
329	12	8	29
330	14	6	25
331	17	7	30
332	6	11	23
333	24	8	35
334	11	8	21
335	13	6	26
336	15	6	25
337	14	4	23
338	2	5	14
339	10	5	20
340	22	10	35
341	18	9	35
342	16	6	28
343	21	5	31
344	16	7	30
345	11	7	27
346	10	10	25
347	17	6	26

Protocol# 1 - bills swipes.lsa

User: bill

348	12	7	22
349	15	4	24
350	16	10	30
351	9	4	17
352	8	7	19
353	13	7	22
354	18	8	37

Assay Definition-

Assay Description:  
swipe survey

Assay Type: CPM

Report Name: Report1

Output Data Path: C:\Packard\Tricarb\Results\bill\bill's swipes

Raw Results Path: C:\Packard\Tricarb\Results\bill\bill's swipes\20060818\_0703\20060818\_0703.results

RTF File Name: C:\Packard\Tricarb\Results\bill\bill's swipes\Report1.rtf

Assay File Name: C:\Packard\TriCarb\Assays\bill's swipes.lsa

Count Conditions-

Nuclide: TRIFLE

Quench Indicator: tSIE/AEC

External Std Terminator (sec): 0.5 2s%

Pre-Count Delay (min): 0.00

Quench Set: n/a

Count Time (min): 1.00

Count Mode: Normal

Assay Count Cycles: 1

#Vials/Sample: 1

Repeat Sample Count: 1

Calculate % Reference: Off

Background Subtract: Off

Low CPM Threshold: Off

2 Sigma % Terminator: Off

Regions	LL	UL
A	0.0	18.6
B	18.6	156.0
C	0.0	2000.0

Count Corrections-

Static Controller: On

Colored Samples: n/a

Coincidence Time (nsec): 18

Luminescence Correction: On

Heterogeneity Monitor: n/a

Delay Before Burst (nsec): 75

Half Life:-

Half Life Correction: Off

Regions	Half Life	Units	Reference Date	Reference Time
A				
B				
C				

Cycle 1 Results

S#	CPMA	CPMB	CPMC	MESSAGES
1	22	6	30	Background
2	15	10	31	# 1530

NOTE: Above result of reswipe after DECON is SATISFACTORY.

W.H. Calver