

Radiological Survey Sheet

Job Location Rizer GROTON CT 06340 Page 1 of 17
Decommission work
 Survey Purpose CAB DECON 118 205 Date 11/14/05
 Performed by P. Keeffe (Print)  (Sign)

Instrument (Model/S/N)	Packard Tri-Carb S/N 431521	Packard Tri-Carb S/N 431520	Ludlum 2241-2 163603	
Det. (Model/SN)	Internal	Internal	Ludlum 43-68 PR 149613	
Type Rad.	β	β	β	
Cal. Due:	10/12/06	10/12/06	04/14/06	
Check Instruments Used		X	X	

No.	Time	Locations	See attached LSC printout for Total Activity (cpm/100 cm ²)
1.	1030	BACKGROUND	
2.		CAB ENTRANCE DOOR - OUTSIDE	
3.		- INSIDE	
4.		sm wall - upper	
5.		- lower	
6.		OVERHEAD CABINET #1 - DOORS - OUT	
7.		- IN	
8.		- INSIDE - LEFT / RIGHT	
9.		- REAR / FRONT	
10.		- Bottom	
11.		- shelves	
12.		wall under CABINET	
13.		BENCHTOP	
14.		Flow Valves	
15.		DRAWNS - TOP - OUT / IN	
16.		- UPPER MID ↓ ↓	
17.		- LOWER MID ↓ ↓	
18.		1045 - Bottom - OUT / IN	

Radiological Survey Continuation Sheet

Page 2 of 17

Date 11/14/05

LAB DECON 118 205

No.	Time	Locations	See attached LSC printout for Total Activity (cpm/100 cm ²)
19	1045	CABINET - DOOR - OUT/IN	
20		- INSIDE - LEFT RIGHT	
21		- REAR FRONT	
22		- Bottom	
23		- Shelves	
24		Overhead CABINET #2 - DOORS - OUT	
25		- IN	
26		- INSIDE - LEFT RIGHT	
27		- REAR FRONT	
28		- Bottom	
29		- Shelves	
30		Wall under CABINET	
31		BENCHTOP	
32		Alcove under benchtop - LEFT	
33		- REAR	
34		- RIGHT	
35		- FLOOR	
36		Overhead CABINET #3 - DOORS - OUT	
37		- IN	
38		- INSIDE - LEFT RIGHT	
39		- REAR FRONT	
40		- Bottom	
41		- Shelves	
42		Wall under CABINET	
43		BENCHTOP	
44		Flow Valves	
45	1100	DRAWS - TOP - OUT/IN	

Radiological Survey Continuation Sheet

Page 3 of 17

Date 11/14/05

CAB DECON 118 205

No.	Time	Locations	See attached LSC printout for Total Activity (cpm/100 cm ²)
46	1100	DRAWS	- UPPER MID - OUT/IN
47			- LOWER MID ↓ ↓
48			- Bottom - OUT/IN
49		CABINET	- DOOR - OUT/IN
50			- INSIDE - LEFT/RIGHT
51			- Bottom RIGHT
52			- shelves
53		Wall swipe	- upper
54			- lower
55		Wall swipe	- upper
56			- lower
57		office Glass Door	- OUTSIDE
58			- INSIDE
59		office shelves	- LEFT
60			- RIGHT
61		Desktop swipes	- LEFT
62			- RIGHT
63			- DRAWS - LEFT - OUT
64			- IN
65			- RIGHT - OUT
66			- IN
67		Window swipes	- LEFT
68			- RIGHT
69		Wall swipes	- TOP
70			- MID
71			- Bottom
72	1115	Wall swipes	- TOP

Radiological Survey Continuation Sheet

Page 4 of 17

Date 1/14/05

(LAB DECK) 118 205

No.	Time	Locations	See attached LSC printout for Total Activity (cpm/100 cm ²)
73	1115	Wall SWIPES - MIDDLE	
74		- BOTTOM	
75		Office Glass DOORS - OUT	
76		- INSIDE	
77		Shelves - UPPER	
78		- LOWER	
79		DESKTOP - LEFT	
80		- RIGHT	
81		DRAWNS - LEFT - OUT	
82		- IN	
83		- RIGHT - OUT	
84		- IN	
85		Window - LEFT	
86		- RIGHT	
87		Shelves - upper	
88		- lower	
89		DESKTOP - LEFT	
90		- RIGHT	
91		DRAWNS - LEFT - OUT	
92		- IN	
93		- RIGHT - OUT	
94		- IN	
95		Shelves - upper	
96		- lower	
97		- SUPPORTS	
98	▽	Overhead CABINET # 4 - DOORS - OUT	
99	1130		- IN

Radiological Survey Continuation Sheet

Page 5 of 17

Date 11/14/05

LAB DECOR 118 205

No.	Time	Locations	See attached LSC printout for Total Activity (cpm/100 cm ²)
100	1300	Overhead CABINET #4	-INSIDE -LEFT RIGHT
101			-REAR BOTTOM
102			-shelves
103		Wall under CABINET	
104		BENCHTOP	
105		Flow Valves	
106		DRAWNS -TOP	-OUT IN
107			-upper mid ↓ ↓
108			-Lower mid ↓ ↓
109			-Bottom -OUT IN
110		DRAWNS - Right	-upper -OUT IN
111			-Lower -OUT IN
112		CABINET - DOOR	-OUT IN
113			-INSIDE -LEFT RIGHT
114			-REAR BOTTOM
115			-shelves
116		Overhead CABINET #5	- DOORS -OUT
117			-IN
118			-INSIDE -LEFT RIGHT
119			-REAR BOTTOM
120			-shelves
121		Wall under CABINET	
122		BENCHTOP SWIPE	
123		DRAWNS - LEFT	- TOP -OUT IN
124			- upper mid ↓ ↓
125			- Lower mid ↓ ↓
126	1315		- Bottom -OUT IN

Radiological Survey Continuation Sheet

Page 6 of 17

Date 11/14/05

LAB DeLON 11R 205

No.	Time	Locations	See attached LSC printout for Total Activity (cpm/100 cm ²)
127	1320	DRAWS - RIGHT - UPPER - OUT/IN	
128		- MID ↓ ↓	
129		CABINET - DOOR - OUT/IN	
130		- INSIDE - LEFT RIGHT	
131		- REAR BOTTOM	
132		- shelves	
133		GLASS RACK	
134		FACEIT	
135		EYEWASH STATION	
136		Basin - FRONT REAR	
137		- LEFT RIGHT	
138		- Bottom	
139		- DRAIN	
140		CABINET Under Basin - DOORS - OUT	
141		- IN	
142		- INSIDE - LEFT	
143		- REAR	
144		- RIGHT	
145		- Bottom	
146		Wall SWIPE - UPPER	
147		- LOWER	
148		Hood - OUTSIDE - TOP VENTS - LEFT	
149		- RIGHT	
150		- CONTROLS - LEFT	
151		- RIGHT	
152	✓	- GLASS SASH - LEFT	
153	1345	- RIGHT	

Radiological Survey Continuation Sheet

Page 7 of 17

Date 11/14/05

CAB DECON 118 205

No.	Time	Locations	See attached LSC printout for Total Activity (cpm/100 cm ²)
154	1400	HOOD - OUTSIDE	- CABINET DOORS - LEFT
155			- MID
156			- RIGHT
157			- INSIDE - LEFT
158			- REAR - UPPER
159			- MID
160			- BOTTOM
161			- WORK AREA - LEFT
162			- MID
163			- RIGHT
164			- SPLASH GUARD - LEFT
165			- RIGHT
166			- RIGHT
167		CABINETS	- LEFT - INSIDE - LEFT / RIGHT
168			- REAR / BOTTOM
169			- CENTER - INSIDE - LEFT / RIGHT
170			- REAR / BOTTOM
171			- RIGHT - INSIDE - LEFT / RIGHT
172			- REAR / BOTTOM
173		shelves	- TOP
174			- MID
175			- BOTTOM
176		BENCH TOP	
177		DRAW	- TOP - OUT / IN
178			- UPPER MID ↓ ↓
179			- LOWER MID ↓ ↓
180	1425		- BOTTOM - OUT / IN

Radiological Survey Continuation Sheet

Page 8 of 17

Date 11/14/05

LAB DECON 118 205

No.	Time	Locations	See attached LSC printout for Total Activity (cpm/100 cm ²)
181	1430	BENCHTOP	
182		DRAWS - LEFT - TOP	- OUT IN
183			- UPPER MID ↓ ↓
184			- LOWER MID ↓ ↓
185			- BOTTOM - OUT IN
186			- RIGHT - upper
187			- Lower
188		CABINET - DOOR	- OUTSIDE INSIDE
189			- INSIDE - LEFT RIGHT
190			- REAR BOTTOM
191			- shelves
192		BENCHTOP shelf	- LEFT
193			- RIGHT
194		SUPPORTS	- LEFT
195			- MIDDLE
196			- RIGHT
197		BENCHTOP	
198		DRAWS - LEFT	- OUTSIDE INSIDE
199			- RIGHT ↓ ↓
200		ALOVE UNDER DRAWS	- LEFT RIGHT
201			- REAR
202			- FLOOR
203		BENCHTOP	
204		DRAWS - LEFT - TOP	- OUTSIDE INSIDE
205			- UPPER MID ↓ ↓
206	17		- LOWER MID ↓ ↓
207	1500		- BOTTOM ↓ ↓

Radiological Survey Continuation Sheet

Page 9 of 17

Date 11/14/05

(AB Decon 118 205)

No.	Time	Locations	See attached LSC printout for Total Activity (cpm/100 cm ²)
208	1500	DRAWS - RIGHT	- UPPER - OUT / IN
209			- LOWER ↓ ↓
210		CABINET - DOOR	- OUT / IN
211			- INSIDE - LEFT / RIGHT
212			- REAR / BOTTOM
213			- Shelves
214		OUTSIDE DRAW / CABINET UNIT	- LEFT
215			- RIGHT
216		BENCHTOP SWIDE	
217		DRAWS - LEFT - TOP	- OUTSIDE / INSIDE
218			- UPPER MID ↓ ↓
219			- LOWER MID ↓ ↓
220			- Bottom ↓ ↓
221			- RIGHT - UPPER - OUT / IN
222			- LOWER ↓ ↓
223		CABINET - DOOR	- OUT / IN
224			- INSIDE - LEFT / RIGHT
225			- REAR / BOTTOM
226			- Shelf
227		BENCHTOP	
228		DRAWS - LEFT	- OUT / IN
229			- RIGHT ↓ ↓
230		Alcove under draws	- LEFT / RIGHT
231			- REAR / FLOOR
232		23 BENCHTOP	
233	↓	DRAWS - LEFT - TOP	- OUT / IN
234	1520		- UPPER MID ↓ ↓

LAS DECON 118 205

O = wipe location

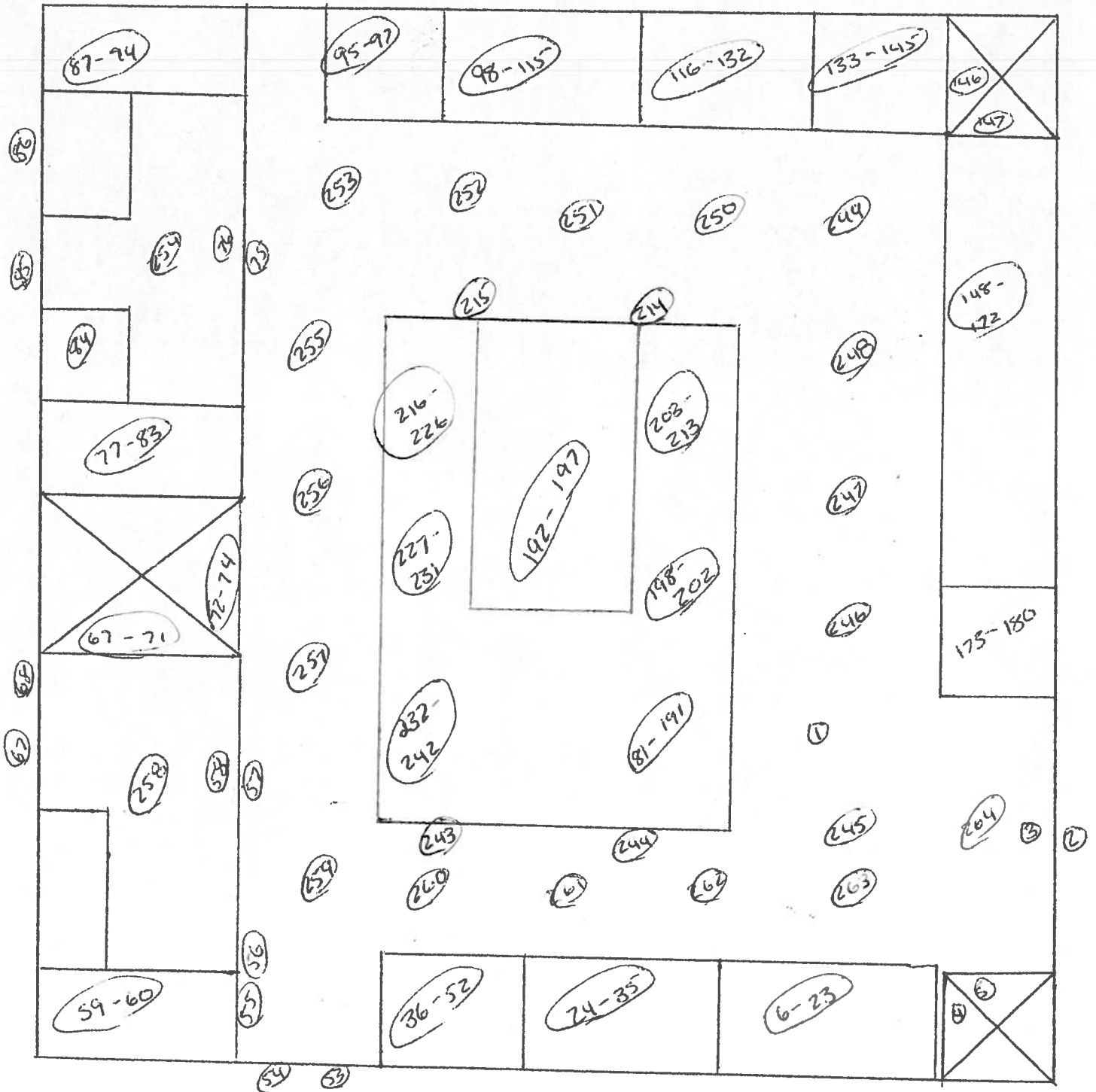

ALL SURFACES SURVEYED WITH COUNTER 2241-2 AND FOUND TO
 BE WITHIN LIMITS. (Pn)

Protocol# 1 - bills swipes.lsa

User: bill

Assay Definition-

Assay Description:
swipe survey

Assay Type: CPM

Report Name: Report1

Output Data Path: C:\Packard\Tricarb\Results\bill\bills swipes

Raw Results Path: C:\Packard\Tricarb\Results\bill\bills swipes\20051115_0042\20051115_0042.results

Comma-Delimited File Name: C:\Packard\Tricarb\Results\bill\bills swipes\Report1.txt

Assay File Name: C:\Packard\TriCarb\Assays\bills swipes.lsa

Count Conditions-

Nuclide: TRIPLE

Quench Indicator: tSIE/AEC

External Std Terminator (sec): 0.5 2s%

Pre-Count Delay (min): 0.00

Quench Set: n/a

Count Time (min): 1.00

Count Mode: Normal

Assay Count Cycles: 1

Repeat Sample Count: 1

#Vials/Sample: 1

Calculate % Reference: Off

Background Subtract: Off

Low CPM Threshold: Off

2 Sigma % Terminator: Off

Regions	LL	UL
A	0.0	18.6
B	18.6	156.0
C	0.0	2000.0

Count Corrections-

Static Controller: On

Luminescence Correction: On

Colored Samples: n/a

Heterogeneity Monitor: n/a

Coincidence Time (nsec): 18

Delay Before Burst (nsec): 75

Half Life-

Half Life Correction: Off

Regions	Half Life	Units	Reference Date	Reference Time
A				
B				
C				

Cycle 1 Results

S#	CPMA	CPME	CPMC	MESSAGES
1	15	9	29	
2	12	4	21	
3	7	3	19	
4	12	10	27	
5	11	8	25	

Protocol# 1 - bills swipes.lsa

User: bill

6	10	6	19
7	10	6	20
8	19	11	37
9	15	6	28
10	16	9	31
11	6	2	14
12	6	5	15
13	19	4	30
14	23	5	36
15	19	6	35
16	14	7	24
17	15	3	28
18	11	4	25
19	16	7	26
20	11	6	20
21	15	5	27
22	15	9	25
23	7	6	15
24	18	8	31
25	12	4	20
26	19	4	28
27	14	10	30
28	15	5	22
29	15	6	29
30	9	13	31
31	16	7	28
32	20	7	32
33	13	8	25
34	12	5	23
35	8	4	15
36	7	7	26
37	9	8	20
38	16	4	33
39	19	7	38
40	12	11	27
41	20	3	28
42	8	5	19
43	12	9	25
44	12	7	26
45	17	8	34
46	6	6	17
47	15	8	31
48	14	5	24
49	13	10	36
50	22	7	40
51	13	8	26
52	19	4	29
53	13	5	21
54	19	7	31
55	14	6	26
56	18	7	32
57	17	6	26
58	12	6	22
59	10	10	20
60	13	12	30
61	8	7	21
62	15	8	33

Protocol# 1 - bills swipes.lsa

User: bill

63	15	3	25
64	16	4	21
65	19	3	26
66	18	5	32
67	16	9	31
68	20	10	39
69	13	10	26
70	6	11	24
71	15	6	26
72	21	8	38
73	16	8	31
74	10	3	15
75	17	6	26
76	12	5	25
77	17	7	30
78	14	5	23
79	16	7	26
80	10	7	25
81	13	11	31
82	16	4	29
83	8	6	25
84	15	8	28
85	21	4	26
86	9	12	27
87	15	6	32
88	12	6	23
89	18	7	33
90	9	8	19
91	16	5	23
92	16	5	30
93	15	4	21
94	9	5	17
95	12	2	18
96	18	4	23
97	9	4	14
98	10	9	21
99	10	9	27
100	14	10	27
101	9	9	22
102	20	6	30
103	10	6	22
104	11	9	30
105	17	9	31
106	17	5	30
107	3	5	11
108	9	7	19
109	11	9	26
110	19	10	34
111	8	8	22
112	34	3	43
113	13	3	22
114	15	9	30
115	8	11	25
116	12	7	23
117	12	6	21
118	9	8	25
119	30	7	47

Protocol# 1 - bills swipes.lsa

User: bill

120	17	8	31
121	15	5	25
122	14	7	27
123	16	7	28
124	11	9	25
125	2	8	20
126	18	10	33
127	7	3	18
128	13	7	26
129	23	3	28
130	14	7	25
131	4	4	11
132	10	7	24
133	16	12	33
134	23	6	35
135	13	11	29
136	7	8	20
137	15	7	25
138	18	8	29
139	13	6	26
140	20	5	30
141	21	4	31
142	15	6	28
143	13	5	25
144	10	4	17
145	15	2	22
146	9	9	25
147	14	8	28
148	10	7	25
149	5	3	13
150	14	4	25
151	16	5	30
152	15	9	33
153	10	10	24
154	12	13	33
155	7	8	16
156	13	9	33
157	10	6	20
158	12	7	23
159	14	7	30
160	17	7	27
161	9	5	24
162	16	8	30
163	13	7	31
164	10	6	23
165	9	13	29
166	14	6	25
167	15	5	25
168	10	7	21
169	7	4	15
170	18	4	26
171	13	6	22
172	14	6	23
173	9	6	21
174	11	5	25
175	13	6	24
176	12	5	26

Protocol# 1 - bills swipes.lsa

User: bill

177	8	10	26
178	17	8	28
179	9	5	18
180	16	6	26
181	9	7	19
182	12	7	23
183	15	9	30
184	11	8	22
185	10	8	21
186	18	10	35
187	11	4	20
188	10	3	17
189	11	7	22
190	12	7	25
191	2	6	13
192	16	4	26
193	16	10	33
194	15	5	22
195	19	5	33
196	17	9	31
197	15	7	32
198	18	6	33
199	6	4	14
200	12	6	25
201	36	3	44
202	27	7	40
203	33	6	45
204	38	6	50
205	14	7	28
206	16	6	30
207	5	2	12
208	19	8	33
209	7	7	19
210	3	3	11
211	16	9	33
212	3	8	15
213	9	6	20
214	20	6	31
215	1	9	18
216	10	7	23
217	10	9	25
218	11	9	23
219	16	6	31
220	14	2	23
221	12	8	29
222	22	6	35
223	4	7	17
224	9	1	17
225	11	5	24
226	7	10	21
227	28	4	38
228	7	10	24
229	10	8	27
230	9	15	31
231	11	10	34
232	12	8	25
233	15	7	29

Protocol# 1 - bills swipes.lsa

User: bill

234	23	7	37
235	11	6	22
236	10	4	16
237	4	8	22
238	16	3	31
239	10	15	29
240	3	3	11
241	15	6	26
242	10	5	22
243	27	11	40
244	20	8	33
245	0	12	20
246	10	3	22
247	13	9	28
248	8	5	21
249	8	5	25
250	9	13	29
251	11	7	26
252	7	6	23
253	11	5	17
254	11	6	27
255	12	0	18
256	6	7	20
257	18	5	27
258	9	7	28
259	15	7	25
260	13	2	17
261	8	7	25
262	16	7	30
263	19	6	32
264	14	6	28