



August 19, 2013

Document Control Desk
U.S. Nuclear Regulatory Commission
Two White Flint North
11545 Rockville Pike
(Mail Code: 03H8)
Rockville, Maryland 20852-2738

**RE: Final Status Survey – Background Count Rate Correction
University of Michigan – Ford Nuclear Reactor
Docket 50-2 / License R-28**

Decommissioning Branch:

Please find enclosed a corrected data sheet for the Ludlum Model 44-10 gamma scintillation detector (S/N PR194988) used to measure the exposed soil in the first floor trenches ('Soil-2' survey unit) located within the Ford Nuclear Reactor (FNR).

The correct background count rate (cpm) for the Ludlum Model 44-10 gamma scintillation detector (S/N PR194988) used on December 6, 2012 was 10259 cpm. Please refer to the corrected Final Status Survey Data Sheet enclosed with this correspondence.

Please do not hesitate to contact me at OSEH / Radiation Safety Service [(734) 647-2251] should you have any questions or comments regarding this revised FSS data sheet.

Sincerely,

Mark L. Driscoll
Director / Radiation Safety Officer
Radiation Safety Service / OSEH

MLD/ml
NRCFNR-28FSSoil2Background081913

cc: Terry Alexander, Executive Director, OCS
Volker Sick, Associate Vice President, OVPR / Chair FNR-DRC
Theodore Smith, FNR Project Manager, NRC Headquarters (Mailstop T-8F5)
Jeremy Tapp, Health Physicist, NRC Region III
FNR Decommissioning File

FSMEZD

Ameriphysics LLC.
Final Status Survey Data Sheet
Beta Survey Results

Building: FNR Survey Unit: SOLL-2 Page 4 of 26

Survey Unit Description: _____

Survey Completed by: Travis Kidder / Travis Kidd Date: 12/10/12

Survey Completed by: _____ Date: 12/16/12

Inst. #1	Inst Type: <u>Ludlum 2221</u>	Inst. S/N: <u>202370</u>	Cal Due Date: <u>9-24-13</u>	Count Time: <u>0.25M/SEC.</u>	BKG (cpm): <u>10259</u> 10466
	Probe Type: <u>44-10</u>	Probe S/N: <u>PR194988</u>	Inst Eff: <u>N/A</u>		

MTO
08/15/13
~~MTO~~
08/15/13

Inst. #2	Inst Type:	Inst. S/N	Cal Due Date:	Count Time:	BKG (cpm)
	Probe Type:	Probe S/N	Inst Eff:		

Inst. #3	Inst Type:	Inst. S/N	Cal Due Date: <u>N/A</u>	Count Time:	BKG (cpm)
	Probe Type:	Probe S/N	Inst Eff: <u>A</u>		

Inst. #4	Inst Type:	Inst. S/N	Cal Due Date:	Count Time:	BKG (cpm)
	Probe Type:	Probe S/N	Inst Eff:		

Comments:

Reviewed By: [Signature] Date: 12/17/12

Mark L. Diacoll
MTO
05/02/13

Ameriphysics Daily Respose Check Form

Instrument Model	Instrument Serial Number	Calibration Due Date	Project Efficiency
2221	202370	9/24/13	4.92%
Detector Model	Detector Serial Number	Detector Area (cm²)	High Voltage
44-10	PR194988	2 x 2	1050
Source Isotopes	Source Serial Number	Source Activity (dpm)	Source Reproducibility
Cs-137	No ID	55 uR/hr	32975 to 49462

Date (M/D/Y)	Time	Background Count Rate	Gross Count Rate	Net Count Rate	SAT/UNSAT	Comments	Initials
11/28/12	0930	10411	51612	41201	SAT		TRP
11/29/12	0710	10623	50987	40364	SAT		TRP
11/30/12	0740	10416	51955	41539	SAT		RPR
12/1/12	0910	10290	51580	41290	SAT		RPR
12/3/12	0735	10301	50327	40026	SAT		RPR
12/4/12	0730	10020	54046	44026	SAT		RPR
12/5/12	0715	10466	55636	46170	SAT		TRK
12/6/12	0715	10259	49070	38811	SAT		TRK
12/7/12	0705	9804	50496	40692	SAT		TRK
12/8/12	0810	9594	51710	48116	SAT		PLR
12/9/12	0840	9891	55630	45739	SAT		PLR
12/16/12	0710	9996	53426	43430	SAT		PLR
12/11/12	0705	10823	54538	43715	SAT		TRK

Reviewed By: *T-JZ* Date: 12/17/12

Mark L. Driscoll
 MLD
 05/02/13

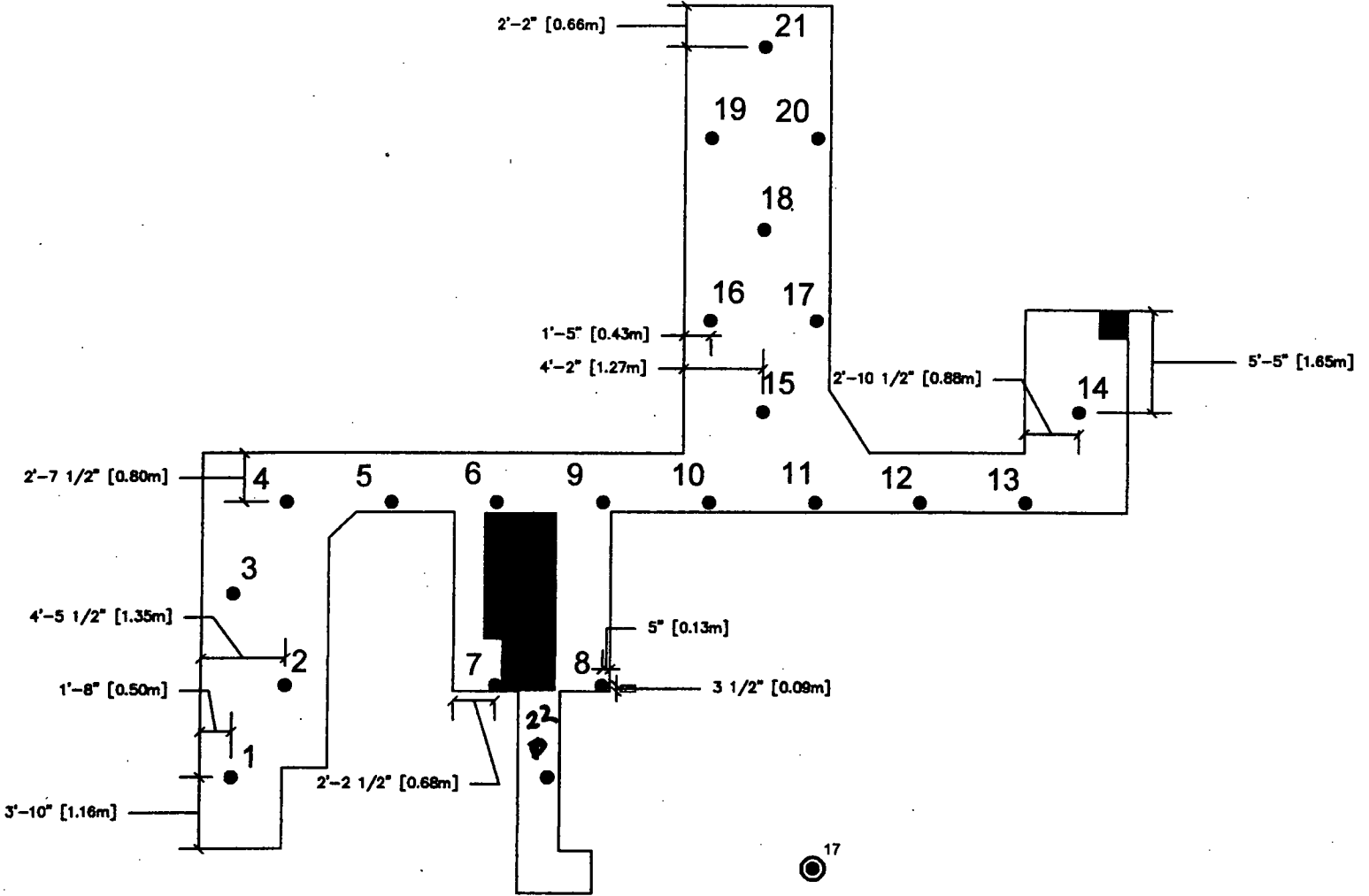

- Random Start Location
 - Sample Locations
- Typical Spacing - 1.7 m

SURVEY MAP

BUILDING: FNR SURVEY UNIT NUMBER: Soil-2 PAGE 3 OF 26

CLASS: 1

SURVEY TYPE (CHECK ONE): Characterization Survey Final Status Survey

COMMENTS: *100% Gamma scan surveys were performed on all accessible surfaces. No elevated activity detected.*

SURVEY COMPLETED BY: *T. Kidder / James Kell* DATE COMPLETED: *12/10/12*

PROJECT MANAGER REVIEW: *[Signature]* DATE: *12/17/12*