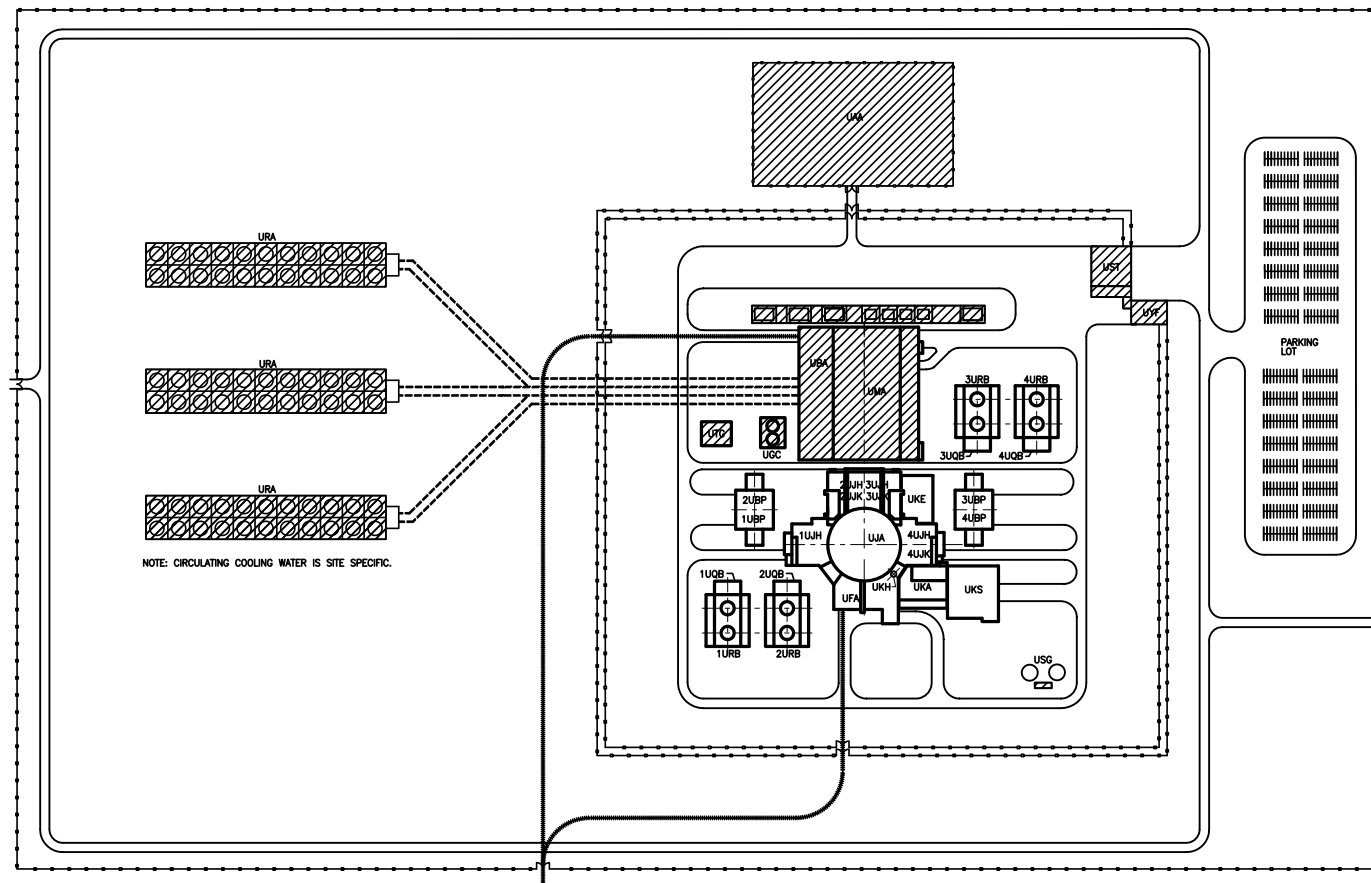
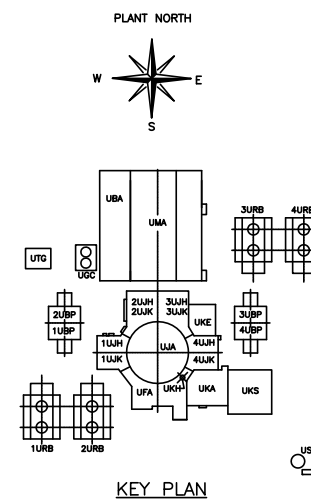

Figure 1.2-3—Plant Configuration



- LEGEND:
- UAA SWITCHYARD
 - UBA SWITCHGEAR BUILDING
 - 1-4 UBP EMERGENCY POWER GENERATING BUILDING
 - UFA FUEL BUILDING
 - UGC DEMINERALIZED WATER TANKS
 - UJA REACTOR BUILDING
 - 1-4 UJH SAFEGUARD BUILDINGS MECH.
 - 1-4 UJK SAFEGUARD BUILDINGS ELEC.
 - UKA NUCLEAR AUXILIARY BUILDING
 - UKE ACCESS BUILDING
 - UKH VENT STACK
 - UKS RADIOACTIVE WASTE PROCESSING BUILDING
 - UMA TURBINE BUILDING
 - 1-4 UQB ESSENTIAL SERVICE WATER PUMP STRUCTURE
 - URA CIRCULATING WATER COOLING TOWER STRUCTURE
 - 1-4 URB ESSENTIAL SERVICE WATER COOLING TOWER STRUCTURE
 - USG FIRE PROTECTION STORAGE TANKS AND BUILDING
 - UST WORKSHOP & WAREHOUSE BUILDING
 - UTG CENTRAL GAS SUPPLY SYSTEMS BUILDING
 - UYF SECURITY ACCESS FACILITY

— NOT IN SCOPE OF DESIGN CERTIFICATION



REV 003
AGA-UZT-3002 T2

Figure 1.2-4—Nuclear Auxiliary Building General Arrangement, Plan Elevation -31 Feet

Figure 1.2-5—Nuclear Auxiliary Building General Arrangement, Plan Elevation -21 Feet

Figure 1.2-6—Nuclear Auxiliary Building General Arrangement, Plan Elevation -11 Feet

Figure 1.2-7—Nuclear Auxiliary Building General Arrangement, Plan Elevation +0 Feet

Figure 1.2-8—Nuclear Auxiliary Building General Arrangement, Plan Elevation +12 Feet

Figure 1.2-9—Nuclear Auxiliary Building General Arrangement, Plan Elevation +24 Feet

Figure 1.2-10—Nuclear Auxiliary Building General Arrangement, Plan Elevation +34 Feet

Figure 1.2-11—Nuclear Auxiliary Building General Arrangement, Plan Elevation +50 Feet

Figure 1.2-12—Nuclear Auxiliary Building General Arrangement, Plan Elevation +64 Feet

Figure 1.2-13—Nuclear Auxiliary Building General Arrangement, Plan Elevation +81 Feet

Figure 1.2-14—Nuclear Auxiliary Building General Arrangement, Plan Elevation +98 Feet

Figure 1.2-15—Nuclear Auxiliary Building General Arrangement, Section A-A

Figure 1.2-16—Nuclear Auxiliary Building General Arrangement, Section B-B

Figure 1.2-17—Nuclear Auxiliary Building General Arrangement, Section C-C

Figure 1.2-18—Radioactive Waste Processing Building General Arrangement Plan View Elevation -31'-6"

Figure 1.2-19—Radioactive Waste Processing Building General Arrangement Plan View Elevation -21'-4"

Figure 1.2-20—Radioactive Waste Processing Building General Arrangement Plan View Elevation -11'-2"

Figure 1.2-21—Radioactive Waste Processing Building General Arrangement Plan View Elevation +0'-0"

Figure 1.2-22—Radioactive Waste Processing Building General Arrangement Plan View Elevation +12'-2"

Figure 1.2-23—Radioactive Waste Processing Building General Arrangement Plan View Elevation +23'-0"

Figure 1.2-24—Radioactive Waste Processing Building General Arrangement Plan View Elevation +36'-0"

Figure 1.2-25—Radioactive Waste Processing Building General Arrangement Plan View Elevation +52'-6"

Figure 1.2-26—Radioactive Waste Processing Building General Arrangement Section A-A

Figure 1.2-27—Radioactive Waste Processing Building General Arrangement Section B-B

Figure 1.2-28—[[Turbine Building General Arrangement Plan View Elevation -43'-0"]]

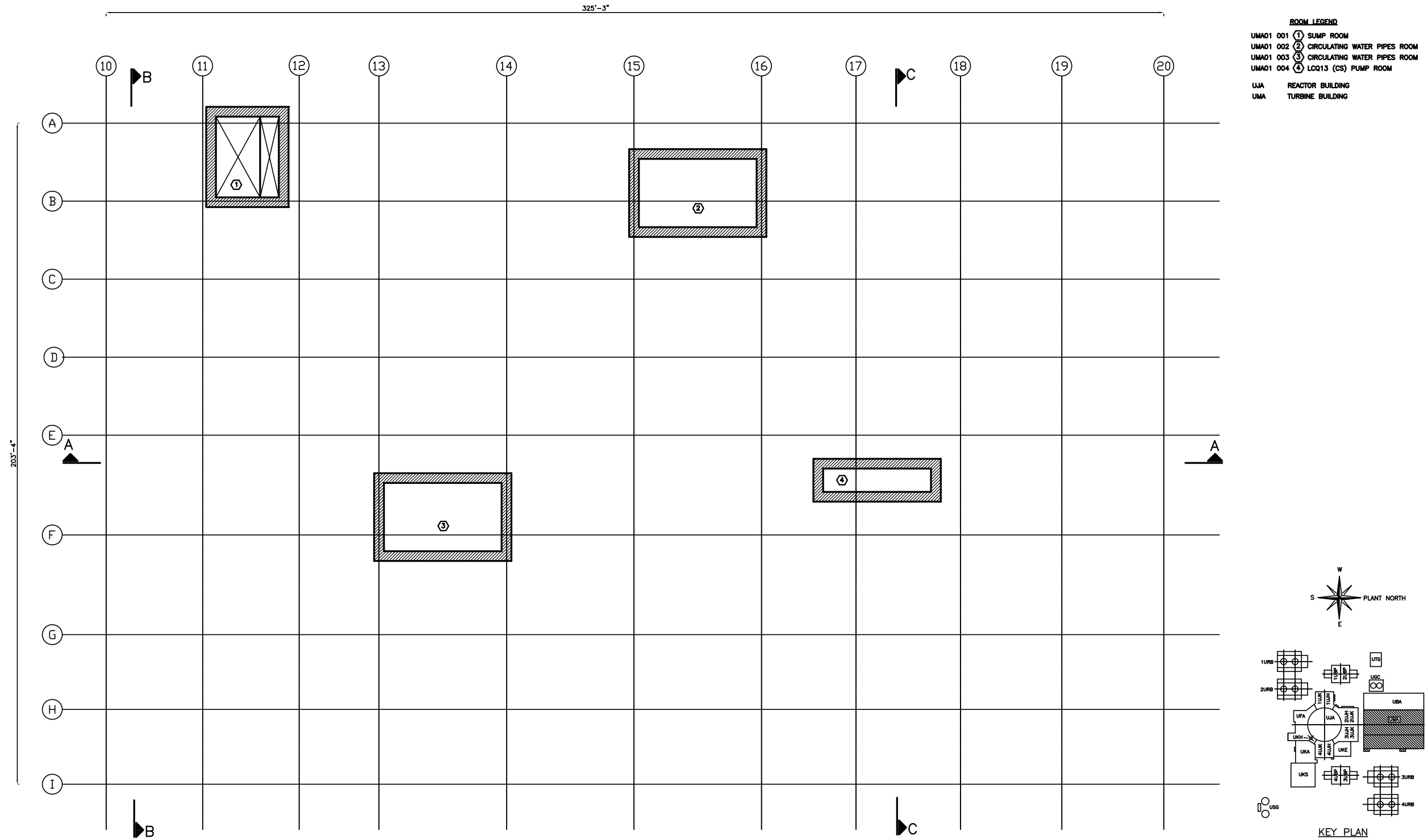

AGA-2UMA-3100 T2

Figure 1.2-29—Deleted

Figure 1.2-30—[[Turbine Building General Arrangement Plan View Elevation -23'-0"]]

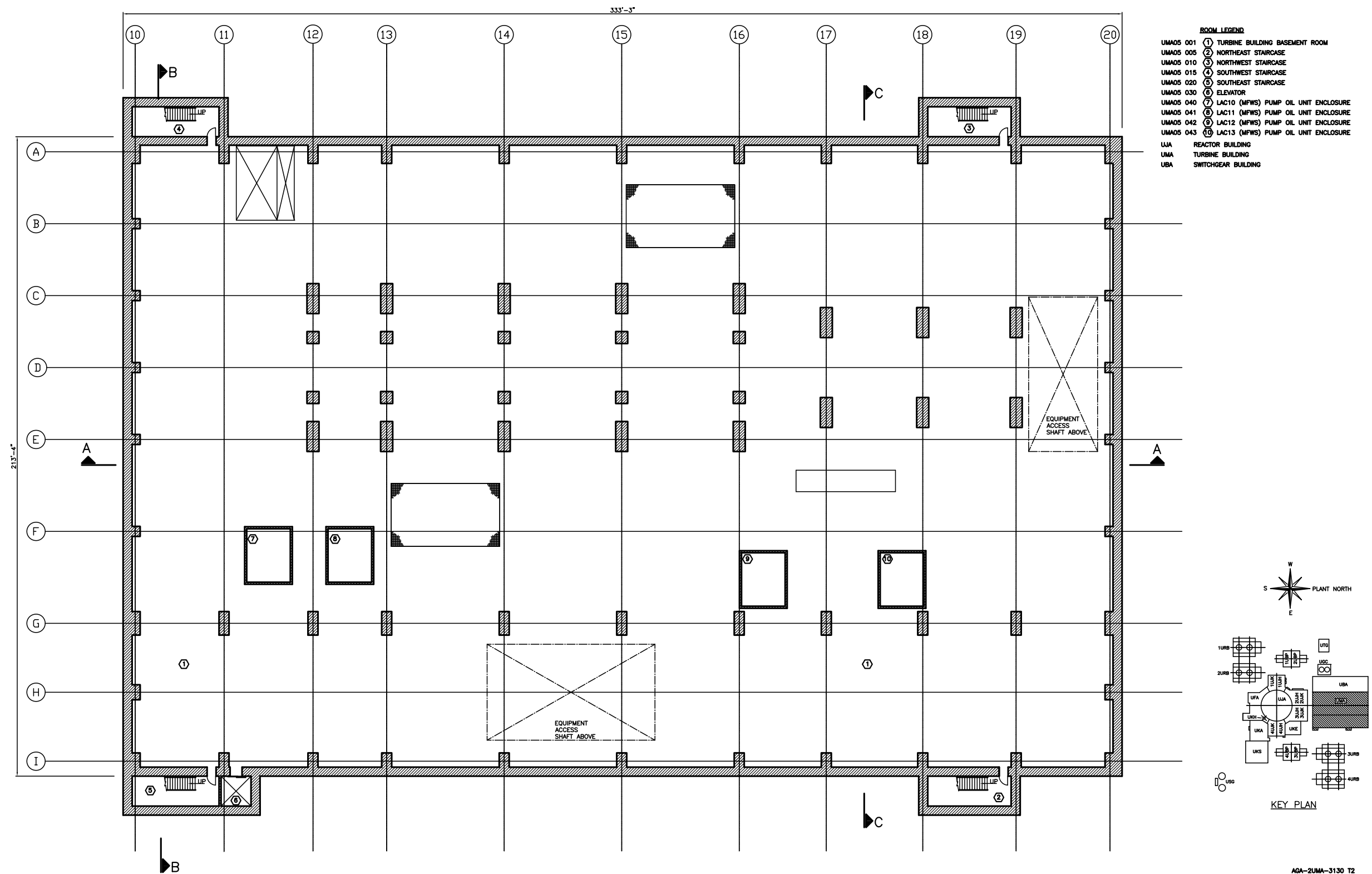

Figure 1.2-31—Deleted

Figure 1.2-32—[[Turbine Building General Arrangement Plan View Elevation +0'-0"]]

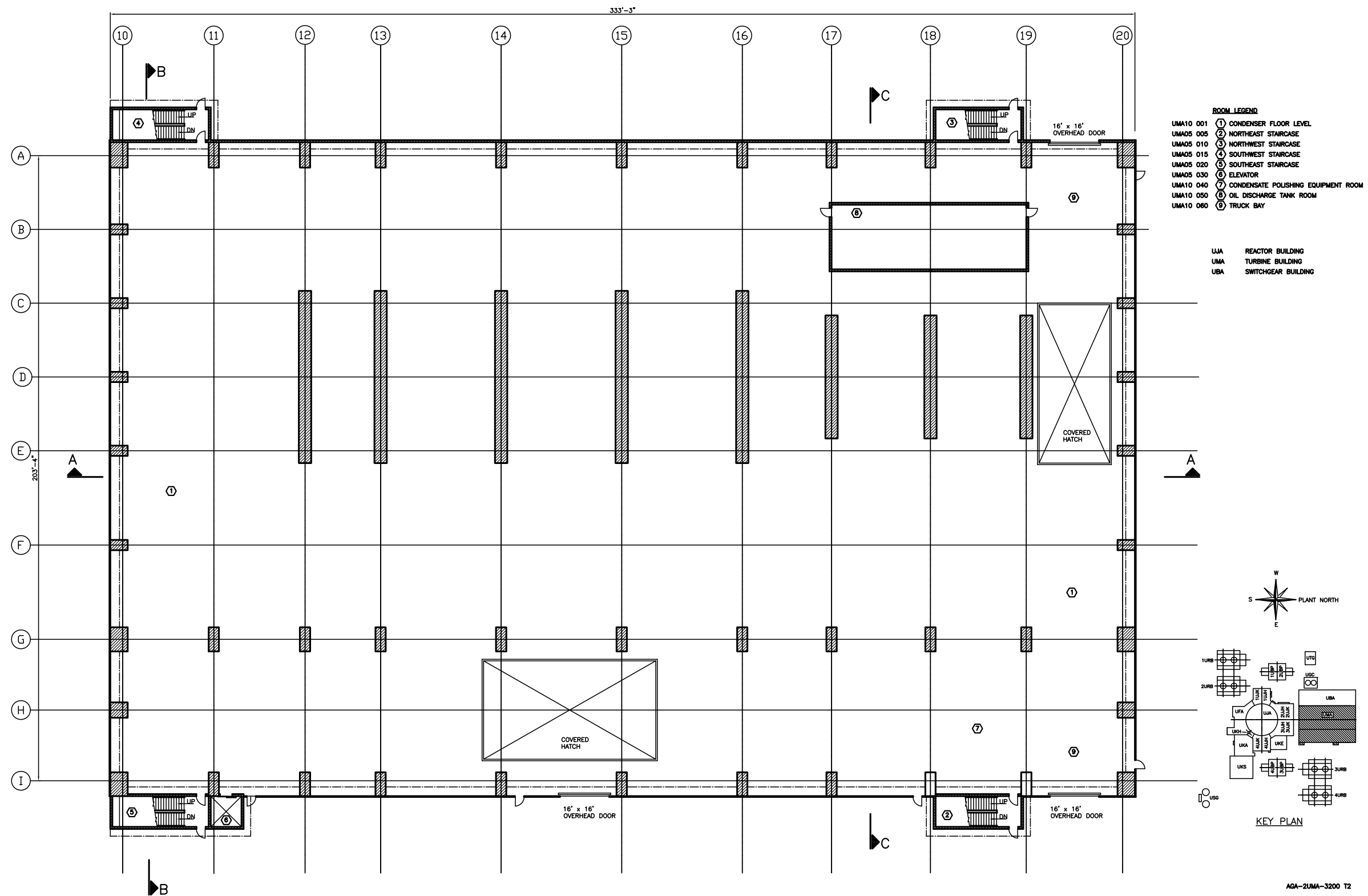

Figure 1.2-33—Deleted

Figure 1.2-34—[[Turbine Building General Arrangement Plan View Elevation +38'-0"]]

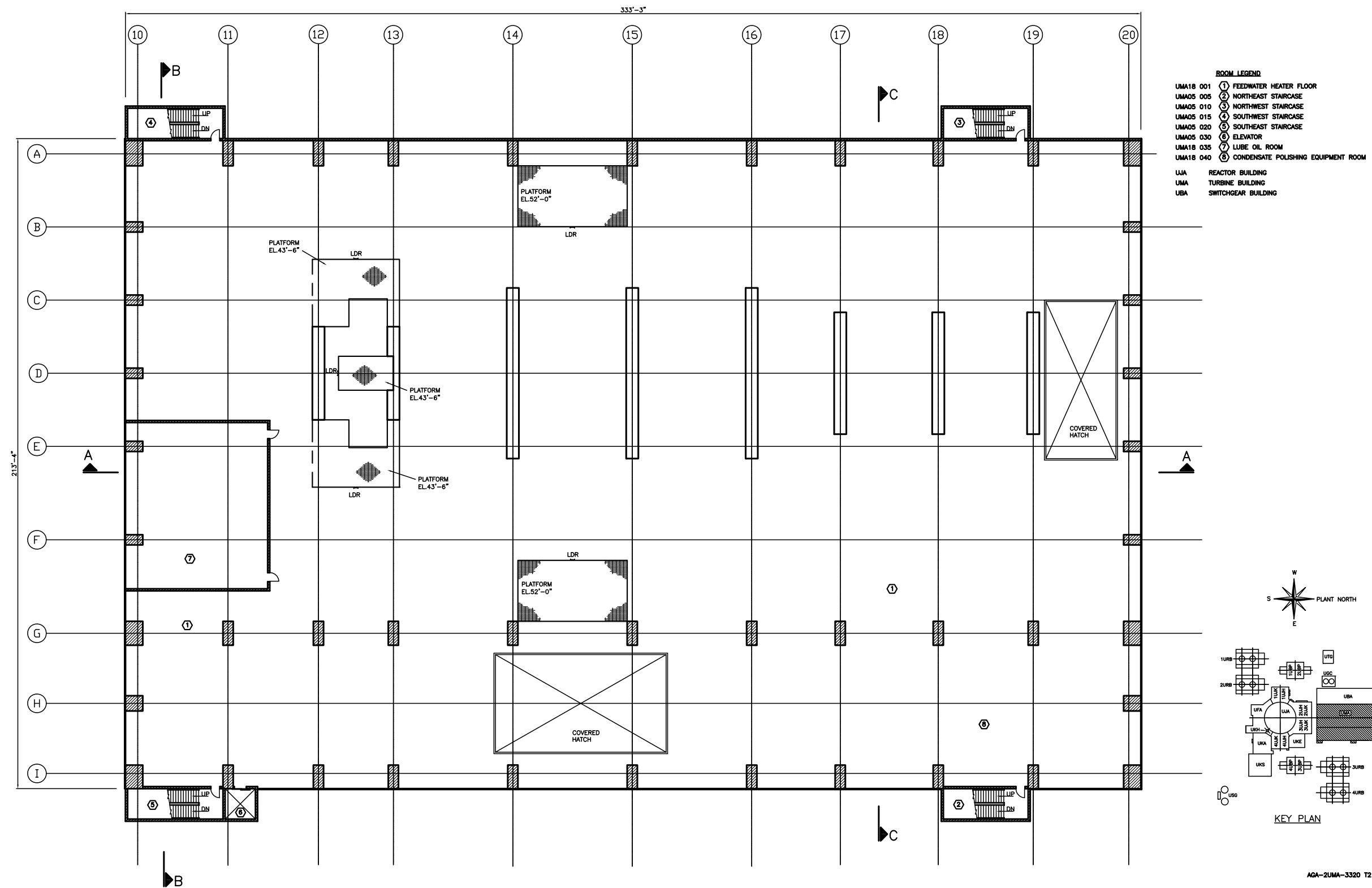

Figure 1.2-35—Deleted

Figure 1.2-36—[[Turbine Building General Arrangement Plan View Elevation +65'-0"]]

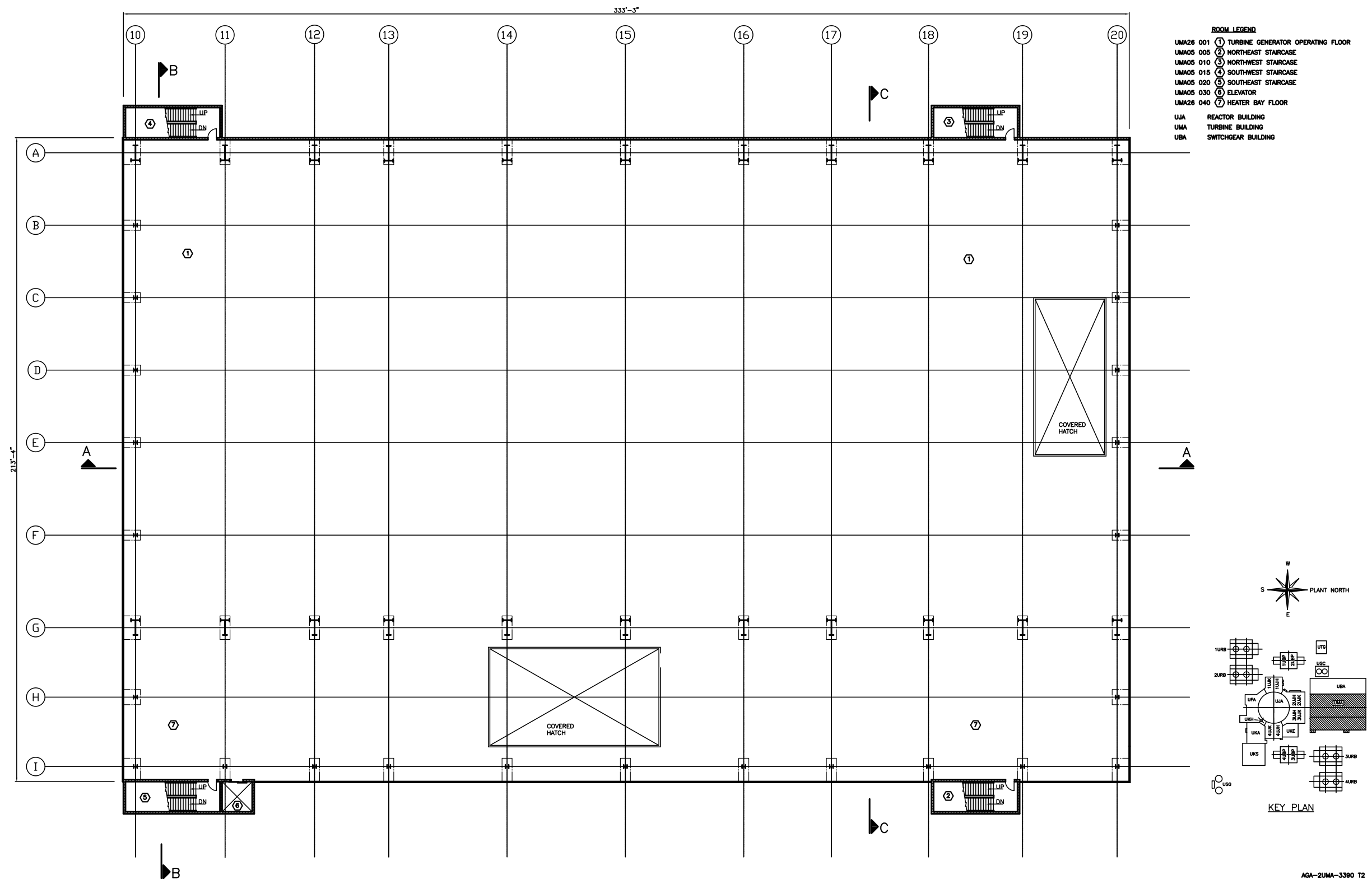

Figure 1.2-37—[[Turbine Building General Arrangement Plan View Elevation +65'-0" with Equipment]]

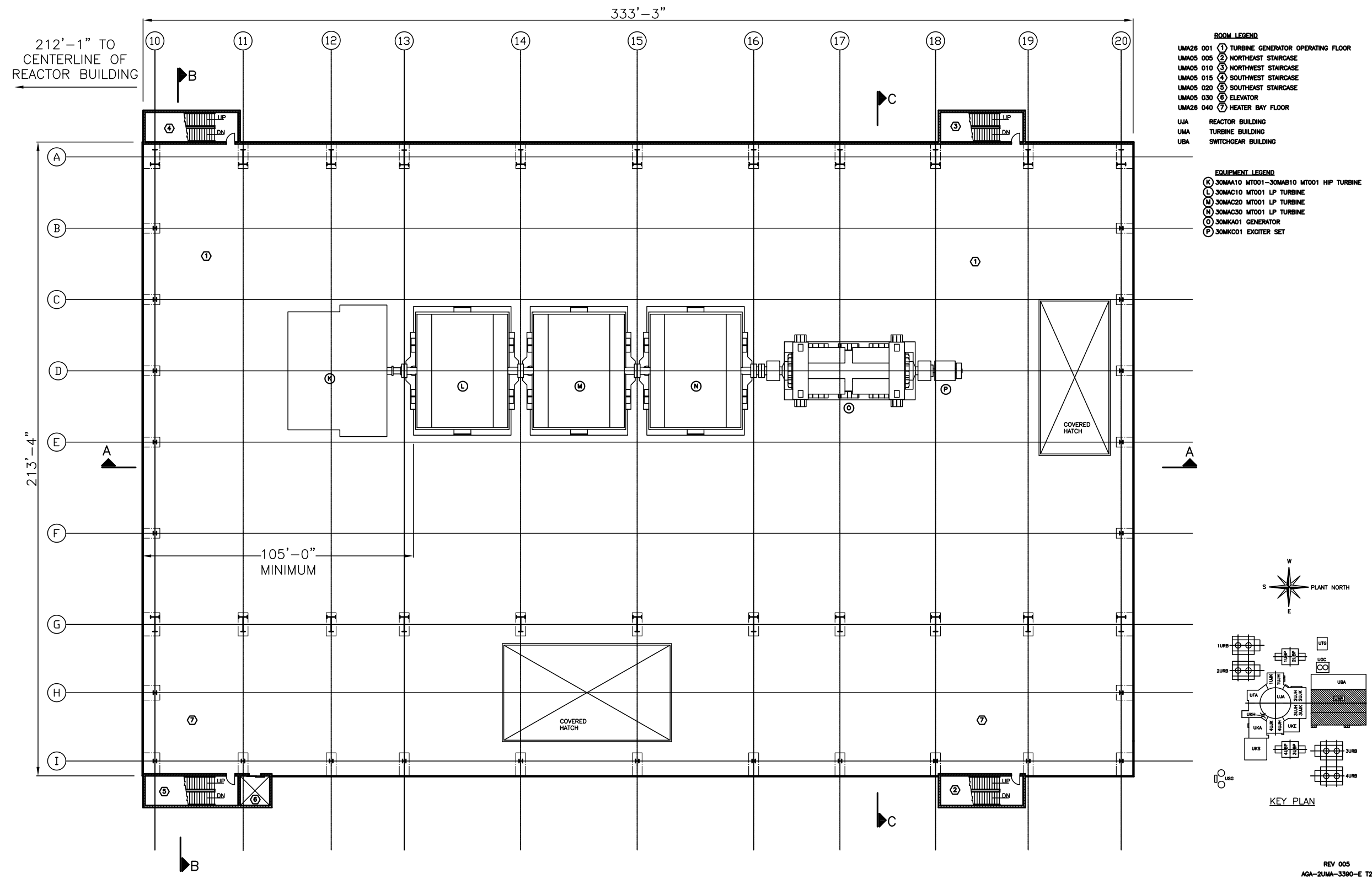

Figure 1.2-38—Deleted

Figure 1.2-39—Deleted

Figure 1.2-40—[[Turbine Building General Arrangement Plan View Elevation +162'-0"]]

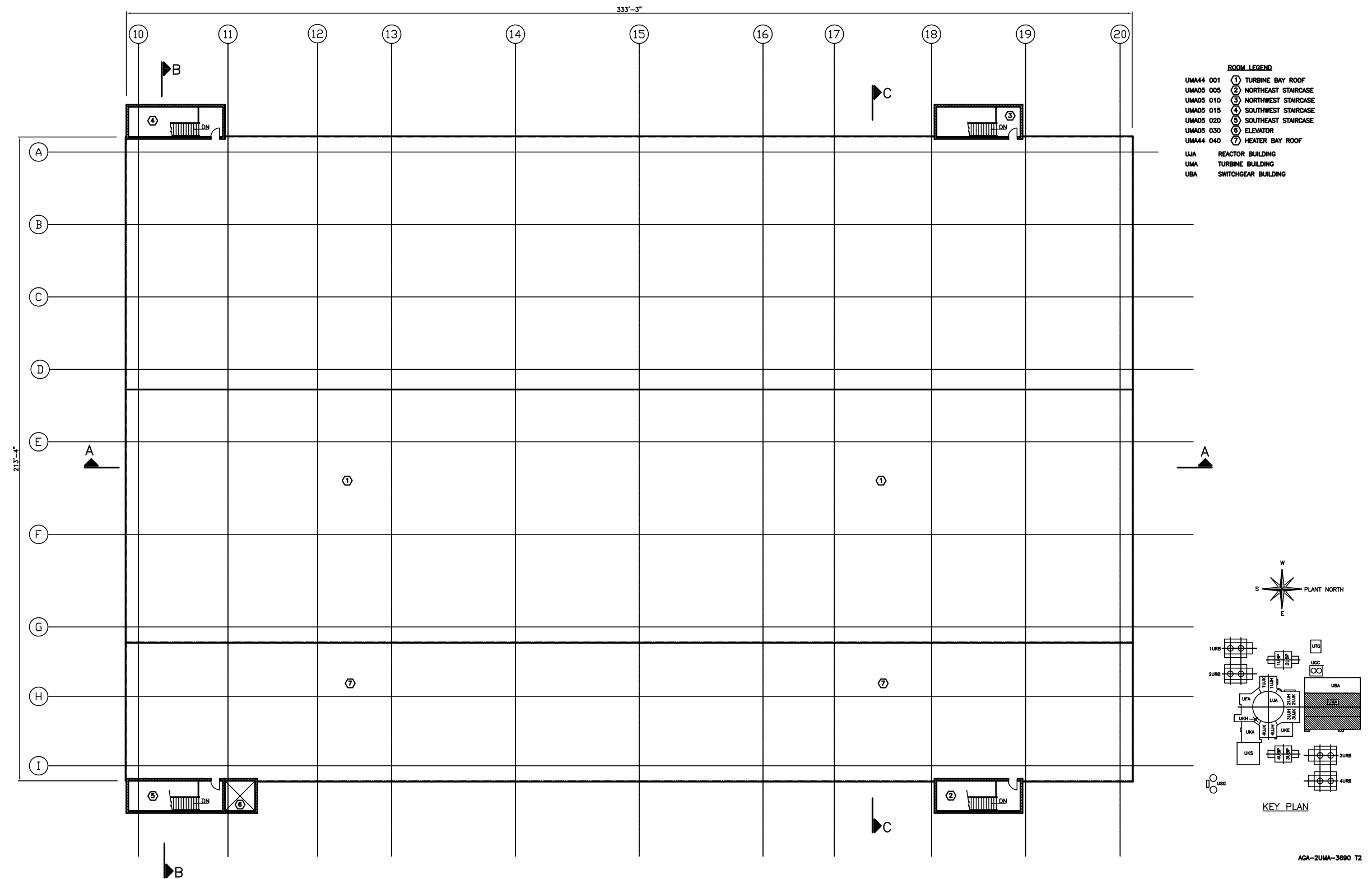

Figure 1.2-41—Deleted

Figure 1.2-42—[[Turbine Building General Arrangement Section A-A]]

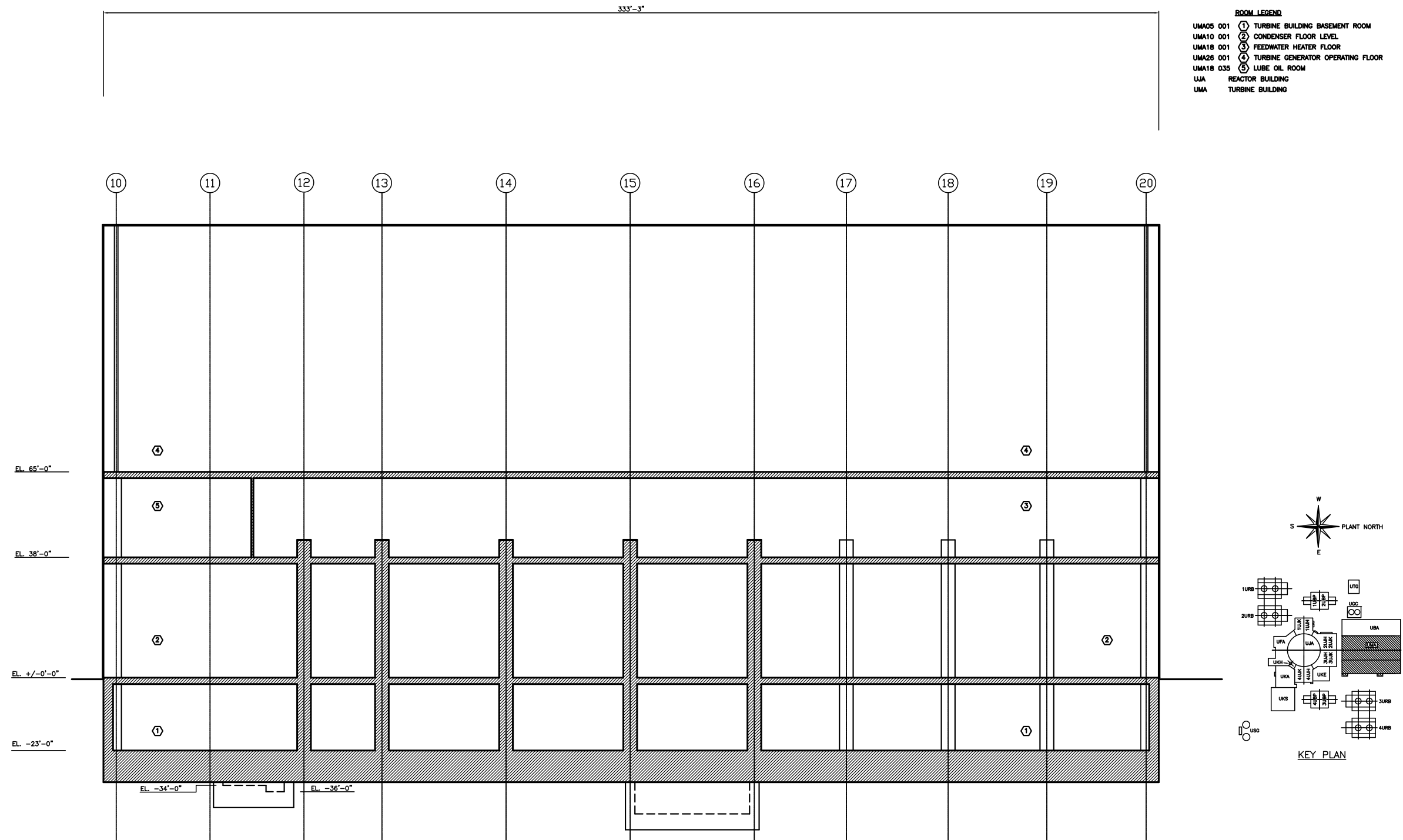
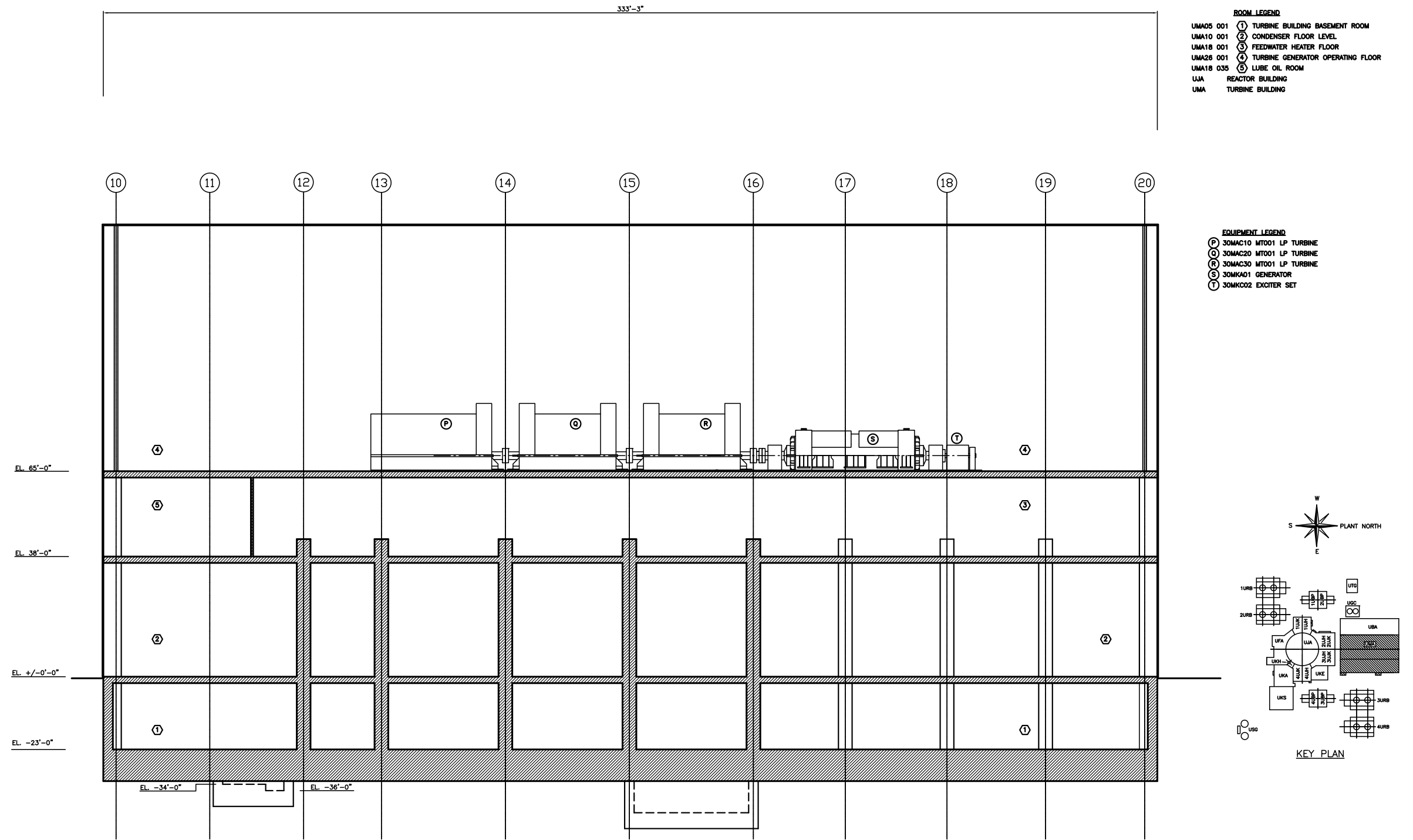

Figure 1.2-43—[[Turbine Building General Arrangement Section A-A with Equipment]]



- ROOM LEGEND**
- UMA05 001 ① TURBINE BUILDING BASEMENT ROOM
 - UMA10 001 ② CONDENSER FLOOR LEVEL
 - UMA18 001 ③ FEEDWATER HEATER FLOOR
 - UMA28 001 ④ TURBINE GENERATOR OPERATING FLOOR
 - UMA18 035 ⑤ LUBE OIL ROOM
 - UJA REACTOR BUILDING
 - UMA TURBINE BUILDING

- EQUIPMENT LEGEND**
- P 30MAC10 MT001 LP TURBINE
 - Q 30MAC20 MT001 LP TURBINE
 - R 30MAC30 MT001 LP TURBINE
 - S 30MKAD1 GENERATOR
 - T 30MKC02 EXCITER SET

AGA-2UMA-7000-E T2

Figure 1.2-44—Deleted

Figure 1.2-45—Deleted

Figure 1.2-46—[[Turbine Building General Arrangement Section B-B]]

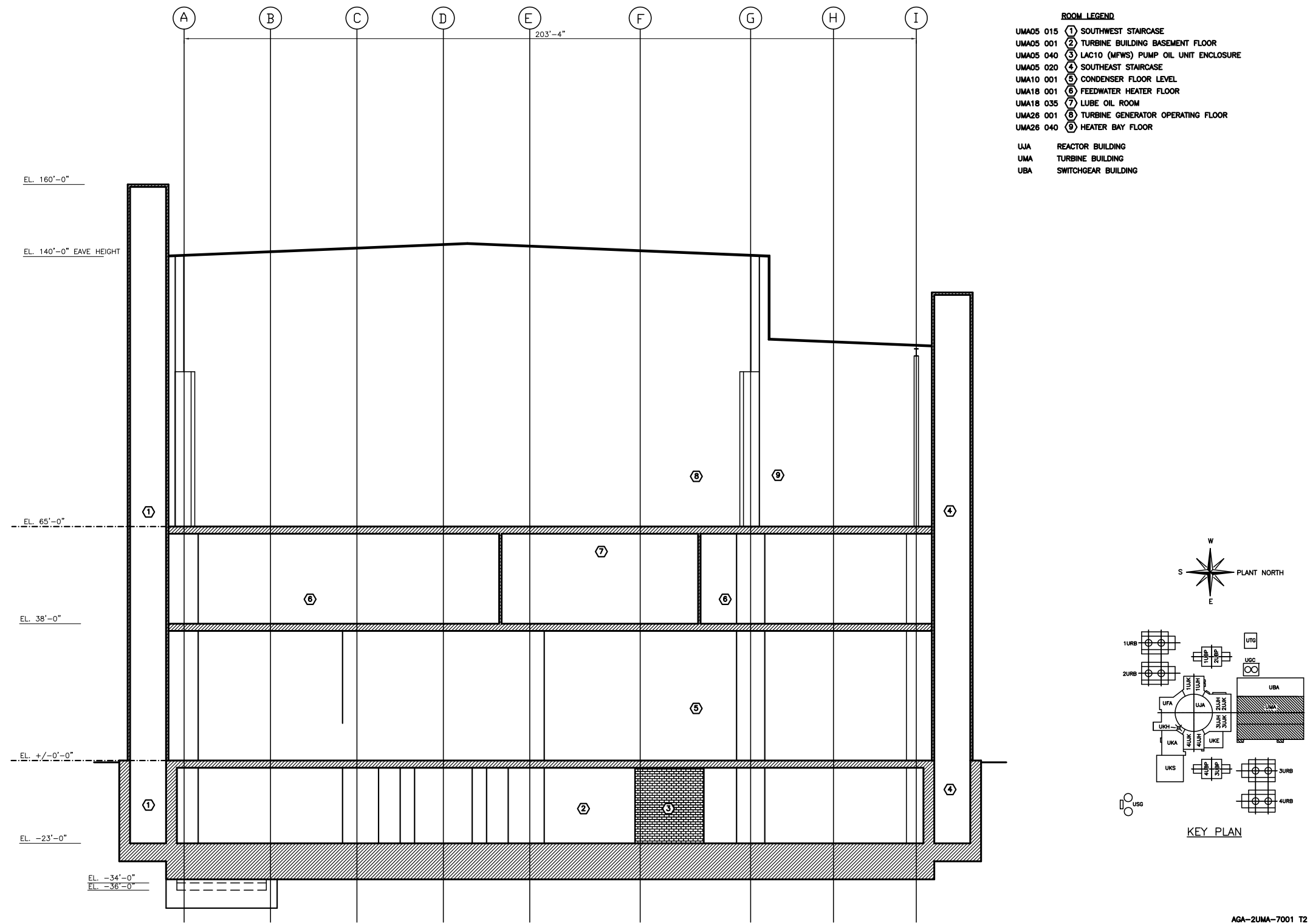

Figure 1.2-47—Deleted

Figure 1.2-48—[[Turbine Building General Arrangement Section C-C]]

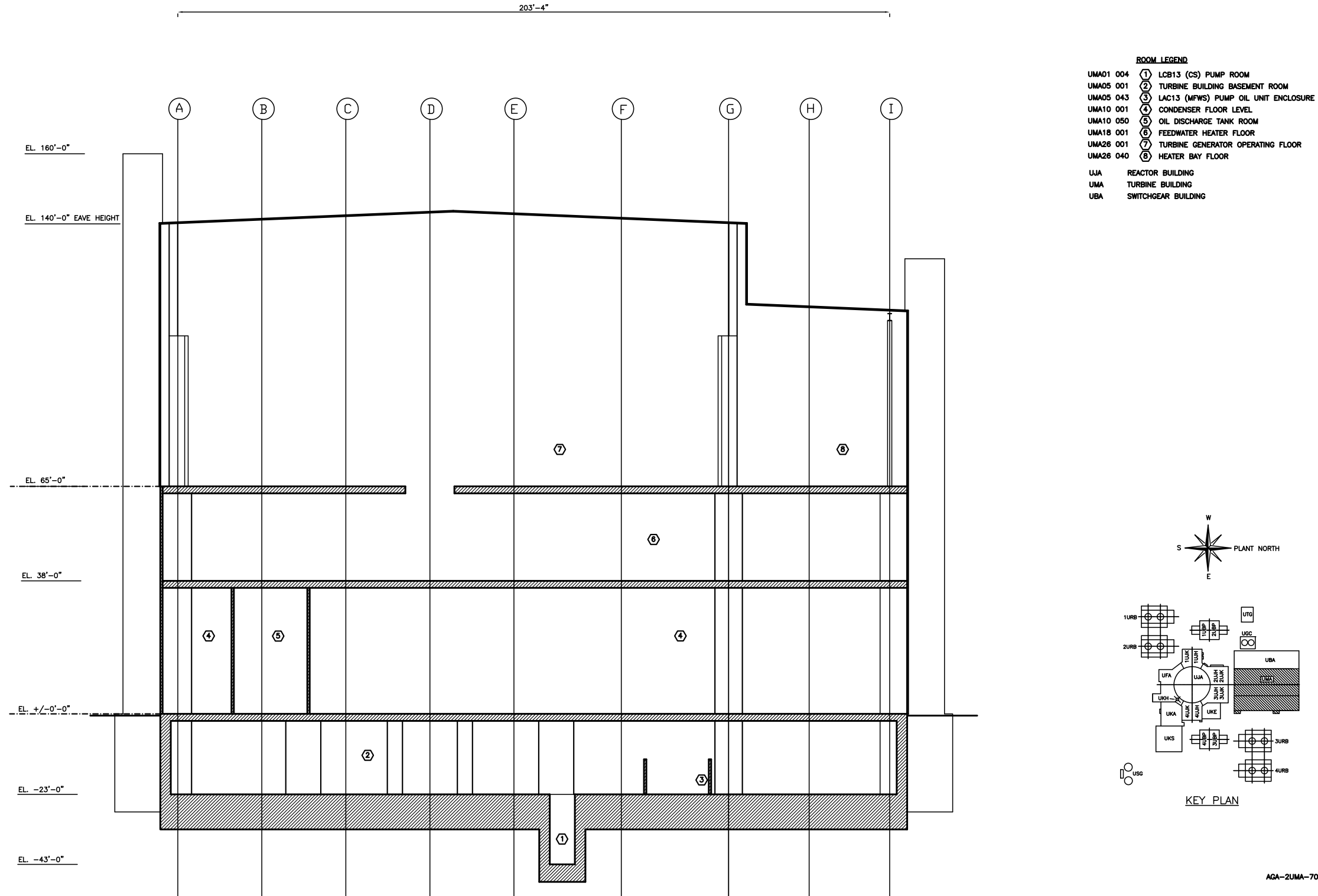

Figure 1.2-49—Deleted

Figure 1.2-50—[[Access Building General Arrangement Drawing Plan View -31 Feet]]

Figure 1.2-51—[[Access Building General Arrangement Drawing Plan View -13 Feet]]

Figure 1.2-52—[[Access Building General Arrangement Drawing Plan View 0 Feet]]

Figure 1.2-53—[[Access Building General Arrangement Drawing Plan View +12 Feet]]

Figure 1.2-54—[[Access Building General Arrangement Drawing Plan View +25 Feet]]

Figure 1.2-55—[[Access Building General Arrangement Drawing Plan View +39 Feet]]

Figure 1.2-56—[[Access Building General Arrangement Drawing Plan View +54 Feet]]

Figure 1.2-57—[[Access Building General Arrangement Drawing Section A-A]]

Figure 1.2-58—[[Access Building General Arrangement Drawing Section B-B]]