



Br. 2

REC'R 10718 13PM 1058

July 17, 2013

Dennis Lawyer
U.S. Nuclear Regulatory Commission Region I
Licensing Assistance Team
Division of Nuclear Materials Safety
475 Allendale Road
King of Prussia, PA 19406-1415

SUBJECT: Amendment NRC Lic: 47-25375-01MD

03034289

Dear Mr. Lawyer:

PharmaLogic respectfully submits a request to amend the existing commercial nuclear pharmacy US NRC Radioactive Materials License # 47-25375-01MD to include the following change:

1. Remove the following commercial nuclear pharmacy location from the existing U.S. Nuclear Regulatory Commission Radioactive Materials License.

**PharmaLogic WV
109 Platinum Dr. Suite A
Bridgeport, WV 26330**

The original nuclear pharmacy radioactive materials have been transferred to the new commercial nuclear pharmacy location; please make this the mailing address for all future communication.

**PharmaLogic WV
9 W Benedum Industrial Park Dr
Bridgeport, WV 26330**

The Iodine Exhaust System has been dismantled under the guidance of the Radiation Safety Officer. The exhaust duct work was surveyed for radiation exposure and removable contamination. Surveys revealed an exposure that did not exceed background at surface and 0 dpm and 0 dpm at the proximal and distal ends of the ductwork respectively.

Radiation surveys/wipe tests were performed thereafter at the Platinum Dr. pharmacy that confirmed the absence of radioactive materials at the Platinum Dr. location a sample of 100% of the building's surfaces were in fact tested at the time of the move. The survey results and survey diagrams and a completed NRC Form 314 are attached.

**PharmaLogic WV
9 W Benedum Ind. Park Dr. ♦ Bridgeport ♦ West Virginia 26330
304-842-0935 ♦ 304-842-0937 FAX**

581399
NMSS/RGN1 MATERIALS-002

The equipment used for surveys and wipes:

Survey meter - Ludlum 3 serial number - 135853 last cal. 2-14-13

Wipe counter - Ludlum Model 2200 SCA - serial number - 129852 - Threshold 80, Window 320

Counting time - 60sec and the efficiency was 90.11%

At the time of the move nuclides handled on site at 109 Platinum Dr. included:

Tc99m

Mo-99

Tl-201

Ga-67

I-123

I-131

Sr-89

Sm-153

I-125

Pd-103

Providing the window of the scaler was open from 80-400 and the scaler was set to 1keV/channel and interpreting the results of the wipe tests done one could conclude there was no removable surface contamination (please see the attached documentation) and all nuclides used at 109 Platinum Dr. had decayed.

I wish to thank you for your consideration of this request. Upon review, if there are any questions, please contact me directly.

Sincerely,

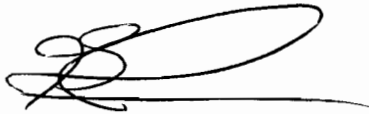

Glen Palmer, RPh
VP Pharmacy Operations
(304)669-1992
gp@citynet.net

ATT: Radiation Survey Reports and Diagrams
NRC FORM 314

(05-2012)
10 CFR 30.36(j)(1); 40.42(j)(1);
70.38(j)(1); and 72.54(k)(5)(1)(1)

Estimated burden per response to comply with this mandatory collection request: 30 minutes. This submittal is used by NRC as part of the basis for its determination that the facility is released for unrestricted use. Send comments regarding burden estimate to the Information Services Branch (T-5 F53), U.S. Nuclear Regulatory Commission, Washington, DC 20555-0001, or by internet e-mail to Infocollects.Resource@nrc.gov, and to the Desk Officer, Office of Information and Regulatory Affairs, NEOB-10202, (3150-0028), Office of Management and Budget, Washington, DC 20503. If a means used to impose an information collection does not display a currently valid OMB control number, the NRC may not conduct or sponsor, and a person is not required to respond to, the information collection.

CERTIFICATE OF DISPOSITION OF MATERIALS

LICENSEE NAME AND ADDRESS

PharmaLogic WV
9 W Benedum Industrial Park Dr.
Bridgeport, WV 26330

LICENSE NUMBER

47-25375-01MD

DOCKET NUMBER

LICENSE EXPIRATION DATE

10-31-2022

A. LICENSE STATUS (Check the appropriate box)

- This license has expired. This license has not yet expired; please terminate it.

B. DISPOSAL OF RADIOACTIVE MATERIAL

(Check the appropriate boxes and complete as necessary. If additional space is needed, provide attachments)

The licensee, or any individual executing this certificate on behalf of the licensee, certifies that:

- 1. No radioactive materials have ever been procured or possessed by the licensee under this license.
- 2. All activities authorized by this license have ceased, and all radioactive materials procured and/or possessed by the licensee under this license number cited above have been disposed of in the following manner.
 - a. Transfer of radioactive materials to the licensee listed below:
PharmaLogic WV 9 W Benedum Industrial Park Dr. Bridgeport, WV 26330
 - b. Disposal of radioactive materials:
 - 1. Directly by the licensee:
 - 2. By licensed disposal site:
 - 3. By waste contractor:
 - c. All radioactive materials have been removed such that any remaining residual radioactivity is within the limits of 10 CFR Part 20, Subpart E, and is ALARA.

C. SURVEYS PERFORMED AND REPORTED

- 1. A radiation survey was conducted by the licensee. The survey confirms:
 - a. the absence of licensed radioactive materials
 - b. that any remaining residual radioactivity is within the limits of 10 CFR 20, Subpart E, and is ALARA.
- 2. A copy of the radiation survey results:
 - a. is attached; or b. is not attached (Provide explanation); or c. was forwarded to NRC on: _____ Date
- 3. A radiation survey is not required as only sealed sources were ever possessed under this license, and
 - a. The results of the latest leak test are attached; and/or
 - b. No leaking sources have ever been identified.

The person to be contacted regarding the information provided on this form:

NAME	TITLE	TELEPHONE (Include Area Code)	E-MAIL ADDRESS
Glen Palmer	VP PharmaLogic	(304)669-1992	gp@citynet.net

Mail all future correspondence regarding this license to:

Glen Palmer PharmaLogic WV 9 W Benedum Industrial Park Dr. Bridgeport, WV 26330

C. CERTIFYING OFFICIAL
I CERTIFY UNDER PENALTY OF PERJURY THAT THE FOREGOING IS TRUE AND CORRECT

PRINTED NAME AND TITLE	SIGNATURE	DATE
Glen Palmer VP Operations		7/17/13

WARNING: FALSE STATEMENTS IN THIS CERTIFICATE MAY BE SUBJECT TO CIVIL AND/OR CRIMINAL PENALTIES. NRC REGULATIONS REQUIRE THAT SUBMISSIONS TO THE NRC BE COMPLETE AND ACCURATE IN ALL MATERIAL RESPECT. 18 U.S.C. SECTION 1001 MAKES IT A CRIMINAL OFFENSE TO MAKE A WILLFULLY FALSE STATEMENT OR REPRESENTATION TO ANY DEPARTMENT OR AGENCY OF THE UNITED STATES AS TO ANY MATTER WITHIN ITS JURISDICTION.

Decommission of Bridgeport Wipe Test and Area Survey

Wipe Test - Ludlum 2200 Ser. No. 129852 Eff. 90.11% Set to 1 KeV per channel - Window 80-400
 Area Survey - Ludlum Model 3 ser. no. 135853 last cal. 2/14/13

Testing performed 4-1-13 6:00am

Area	Wipe			Bkg. 55		Area survey Bkg.		0.03 mR/hr		
	Gross	CPM	DPM	Gross Reading	CPM	DPM	Gross Reading	CPM	DPM	
1	Generator Room Counter	160	105	116.52	0.03	mR/hr	0.03	mR/hr	0	mR/hr
2	Generator Room Counter	84	29	32.183	0.03	mR/hr	0.03	mR/hr	0	mR/hr
3	RX Processing Counter	46	-9	-9.9878	0.03	mR/hr	0.03	mR/hr	0	mR/hr
4	RX Processing Counter	60	5	5.5488	0.03	mR/hr	0.03	mR/hr	0	mR/hr
5	Dose wrapping Counter	50	-5	-5.5488	0.03	mR/hr	0.03	mR/hr	0	mR/hr
6	Dose wrapping Counter	62	7	7.7683	0.03	mR/hr	0.03	mR/hr	0	mR/hr
7	Quality Control Counter	70	15	16.646	0.03	mR/hr	0.03	mR/hr	0	mR/hr
8	DOT Counter	55	0	0	0.03	mR/hr	0.03	mR/hr	0	mR/hr
9	Blood Labeling Area	51	-4	-4.439	0.03	mR/hr	0.03	mR/hr	0	mR/hr
10	Sink in Restricted area	62	7	7.7683	0.03	mR/hr	0.03	mR/hr	0	mR/hr
11	I-131 walls	81	26	28.854	0.03	mR/hr	0.03	mR/hr	0	mR/hr
12	I-131 floors	69	14	15.537	0.03	mR/hr	0.03	mR/hr	0	mR/hr
13	Counter Breakdown room	65	10	11.098	0.03	mR/hr	0.03	mR/hr	0	mR/hr
14	Counter Breakdown room	65	10	11.098	0.03	mR/hr	0.03	mR/hr	0	mR/hr
15	Back Vestibule	48	-7	-7.7683	0.03	mR/hr	0.03	mR/hr	0	mR/hr
16	Storage Rear	39	-16	-17.756	0.03	mR/hr	0.03	mR/hr	0	mR/hr
17	I-131 Effluent Bottom	70	15	16.646	0.03	mR/hr	0.03	mR/hr	0	mR/hr
18	I-131 Effluent Mid-section	67	12	13.317	0.03	mR/hr	0.03	mR/hr	0	mR/hr
19	I-131 Effluent Roof	50	-5	-5.5488	0.03	mR/hr	0.03	mR/hr	0	mR/hr
20	Counter between Hoods	51	-4	-4.439	0.03	mR/hr	0.03	mR/hr	0	mR/hr
21	RX pinning area	37	-18	-19.976	0.03	mR/hr	0.03	mR/hr	0	mR/hr
22	RX pinning area	48	-7	-7.7683	0.03	mR/hr	0.03	mR/hr	0	mR/hr
23	Front Counter	52	-3	-3.3293	0.03	mR/hr	0.03	mR/hr	0	mR/hr
24	Front Counter	54	-1	-1.1098	0.03	mR/hr	0.03	mR/hr	0	mR/hr
25	Bathroom	39	-16	-17.756	0.03	mR/hr	0.03	mR/hr	0	mR/hr
26	Break Room	48	-7	-7.7683	0.03	mR/hr	0.03	mR/hr	0	mR/hr
27	Storage Room	51	-4	-4.439	0.03	mR/hr	0.03	mR/hr	0	mR/hr
28	Front Storage Area	50	-5	-5.5488	0.03	mR/hr	0.03	mR/hr	0	mR/hr
29	Front Vestibule	49	-6	-6.6585	0.03	mR/hr	0.03	mR/hr	0	mR/hr
30	Floor in Restricted Area	47	-8	-8.878	0.03	mR/hr	0.03	mR/hr	0	mR/hr

I-131 Room Equipment prior to Moving 3-28-13

Wipe Test - Ludlum 2200 Ser. No. 129852 Eff. 95.3% Set to 1 KeV per channel - Window 80-400
 Area Survey - Ludlum Model 3 ser. no. 135853 last cal. 2/14/13

Testing 3-28-13 12:00pm

Area	Wipe			Bkg. 76		Area survey Bkg.		0.03 mR/hr		
	Gross	CPM	DPM	Gross Reading	CPM	DPM	Gross Reading	CPM	DPM	
1	Glovebox Outside	87	32	33.578	0.03	mR/hr	0.03	mR/hr	0	mR/hr
2	Glovebox Inside	69	14	14.69	0.03	mR/hr	0.03	mR/hr	0	mR/hr
3	Fume Hood Outside	90	35	36.726	0.03	mR/hr	0.03	mR/hr	0	mR/hr
4	Fume Hood Inside	85	30	31.48	0.03	mR/hr	0.03	mR/hr	0	mR/hr
5	I-131 Lead barrel	101	46	48.269	0.03	mR/hr	0.03	mR/hr	0	mR/hr

Moving Company Equipment and Personnel

Performed 3-29-13 - 1400

Wipe Test - Ludlum 2200 Ser. No. 129852 Eff. 95.3% Set to 1 KeV per channel - Window 80-400
 Area Survey - Ludlum Model 3 ser. no. 135853 last cal. 2/14/13

Area	Wipe			Bkg. 74		Area survey Bkg.		0.03 mR/hr		
	Gross	CPM	DPM	Gross Reading	CPM	DPM	Gross Reading	CPM	DPM	
1	Moving Van Inside 1	81	10	10.493	0.03	mR/hr	0.03	mR/hr	0	mR/hr
2	Moving Van Inside 2	70	-1	-1.0493	0.03	mR/hr	0.03	mR/hr	0	mR/hr
3	Moving Van floor of cargo area	68	-3	-3.148	0.03	mR/hr	0.03	mR/hr	0	mR/hr
4	Moving Van Cab	74	3	3.148	0.03	mR/hr	0.03	mR/hr	0	mR/hr
5	Moving Company Hand Truck	79	8	8.3945	0.03	mR/hr	0.03	mR/hr	0	mR/hr

Personnel - Crew of Wheaton Movers

Surveys done after Move was complete prior to departure by movers

	Full Name	Contact Phone Number	Wipe Hands		Bkg. 64		Survey Meter Whole body Bkg.		0.03 mR/hr		
			Gross	CPM	DPM	Gross Reading	CPM	DPM	Gross Reading	CPM	DPM
Mover 1	Chris Barber	(304)842-5471	79	15	15.7	0.03	mR/hr	0.03	mR/hr	0	mR/hr
Mover 2	Gary Maritz	(304)842-5471	72	8	8.39	0.03	mR/hr	0.03	mR/hr	0	mR/hr

PharmaLogic WV North

109 Platinum Drive, Suite A
 Bridgeport, WV

Neighboring
 Tenant

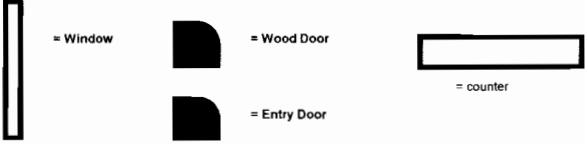
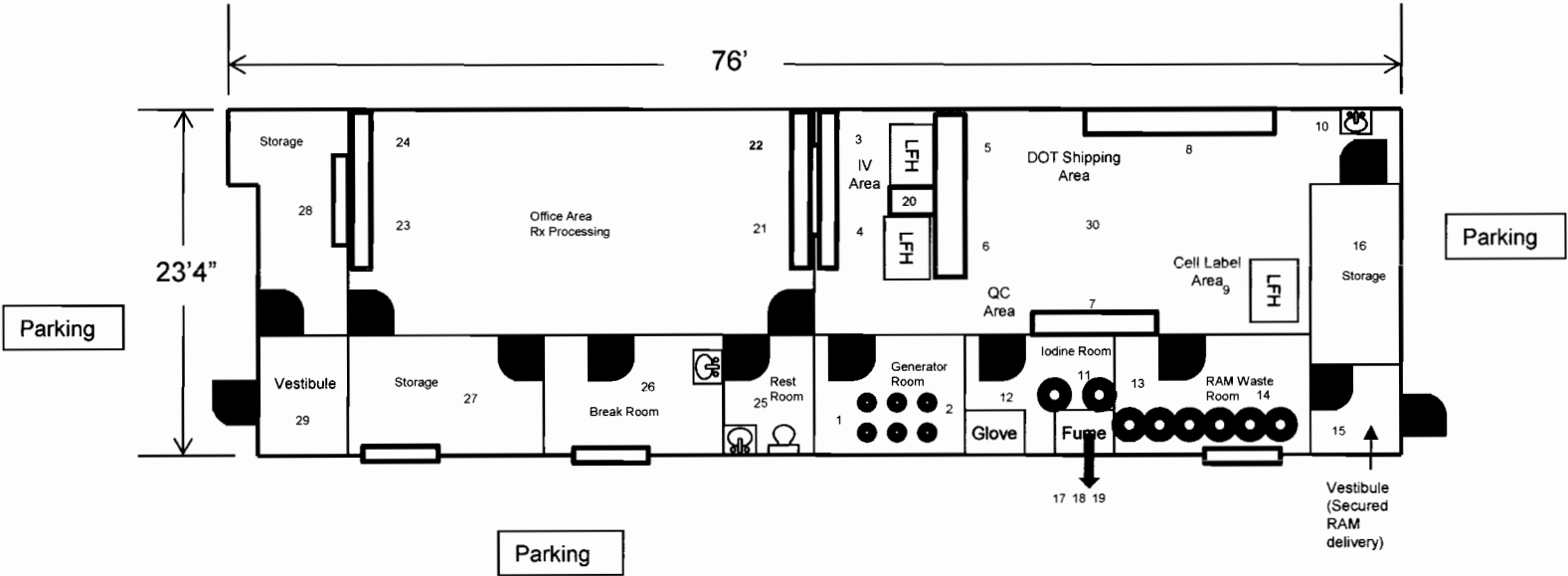



PharmaLogic of Bridgeport, WV
 Pharmalogic Bridgeport
 109 Platinum Drive Suite A, Bridgeport, WV 26330
 LIC. #47-25375-01MD

April 03, 2013

Test Date & Time : 03-27-2013 11:21 Technologist : Steve Green
 Instrument Model : Ludlum 2200 Manufacturer : Ludlum
 Serial # : 129852 Instrum Eff.. : 95.30 %
 Background : 66.00 CPM Trigger Level : 0.005 uCi
 Instrum. Uniq# : 1
 Comment :

#	Chemical Name	Model #	Serial #	Cal. Date	Predicted Act.	Wipe Result	Chemical Eff.	Corr. Factor	Removed Act	In Use
1	Ba - 133		S358021-003	01-28-1997	91.4534 uCi	101 CPM	0.00	0.00	0.000018 uCi	Y
2	Co - 57		BM0805713073102	03-13-2014	322.8172 nCi	0 CPM	0.00	0.00	0.000000 uCi	Y
3	Cs - 137		S356033-096	08-16-1996	142.6533 uCi	72 CPM	0.00	0.00	0.000003 uCi	Y
4	Co - 57		BM06057E11342118	12-15-2011	1.6806 mCi	85 CPM	0.00	0.00	0.000010 uCi	Y
5	Ba - 133		S138S021	12-06-1995	0.0360 uCi	0 CPM	0.00	0.00	0.000000 uCi	Y
6	Cs - 137		956-54-4	12-01-2002	0.3944 uCi	0 CPM	0.00	0.00	0.000000 uCi	Y
7	Co - 57		BM0805711290108	10-19-2011	29.8347 nCi	0 CPM	0.00	0.00	0.000000 uCi	N
8	Ba - 133		553-80	02-20-1997	0.1724 uCi	59 CPM	0.00	0.00	0.000000 uCi	Y

This Report indicates that all above sealed sources have PASSED a Leak Test.
 Removed Activity for sources was below the 0.005 uCi NRC/STATE Trigger Limit

Technologist Signature _____

PharmaLogic of Bridgeport, WV
 Pharmalogic Bridgeport
 Bridgeport, West Virginia, USA
 Shipper's Report

Printed: 03-29-2013 13:17

Cust ID: WVB8888 (Case: 1)

Run: 1

Shipping Date/Time: 03-29-2013 05:00

Shipper: PharmaLogic of Bridgeport, WV
 Pharmalogic Bridgeport
 109 Platinum Drive
 Suite A
 Bridgeport, West Virginia 26330
 304-842-0935

Ship To: PharmaLogei WV II
 Nuclear Medicine Department
 #9 W.Benedum
 Industrial Park ?Drive
 Bridgeport, WV 26330
 3048420935
 3048420936

BILL OF LADING

Radioactive Material, Type A package, 7, UN 2915
 USA DOT 7A TYPE A

Rx #	HM Radio Nuclide	Chemical Form	Phys. Form	Cal. Date Time	Cal. Activity	Volume or Quantity	Activity at Time of shipment
1175988	Ba-133 Disc	Ba-133	Solid	03-29-13 10:00	0.000 mCi	1 Each	0.000 mCi
1175989	Co-57 Vial Sour	Co-57 Vial Source	Solid	03-29-13 10:00	1.700 mCi	1 Each	1.701 mCi
1175990	Cs-137 V1 Sourc		Solid	03-29-13 10:00	144.999 uCi	1 Each	145.001 uCi
1175991	Ba-133 Vial Sr	Ba-133 Vial Src	Solid	03-29-13 10:00	91.999 uCi	1 Each	92.002 uCi

Total Rx(s): 4

Total Activity: 0.072 GBq (1.938 mCi)

Label Required: Radioactive (White I) Radioactive (Yellow II) Radioactive (Yellow III)

0.15 Trans. Index at 1 Meter

 Survey Meter ID

8.0 mR/hr Surface Reading

03 Background

Ludlum 14C-135853 Surface Survey Meter Id

 CPM Wipe Test

101 Background

Ludlum 2200-129852 Wipe Test Instrument Id

This is to certify that the above-named materials are properly classified, described, packaged, marked and labeled, and are in proper condition for transportation according to the applicable regulations of the Department of Transportation.

PERFORMED BY: 

COURIER SIGNATURE: 

RECEIVED BY: _____

PharmaLogic of Bridgeport, WV
 Pharmalogic Bridgeport
 Bridgeport, West Virginia, USA
 Shipper's Report

Printed: 03-28-2013 12:09

Cust ID: WVB8888 (Case: 2)

Run: 2

Shipping Date/Time: 03-29-2013 10:00

Shipper: PharmaLogic of Bridgeport, WV
 Pharmalogic Bridgeport
 109 Platinum Drive
 Suite A
 Bridgeport, West Virginia 26330
 304-842-0935

Ship To: PharmaLogci WV II
 Nuclear Medicine Department
 #9 W.Benedum
 Industrial Park ?Drive
 Bridgeport, WV 26330
 3048420935
 3048420936

BILL OF LADING

Radioactive Material, Type A package, 7, UN 2915
 USA DOT 7A TYPE A

Rx #	HM Radio Nuclide	Chemical Form	Phys. Form	Cal. Date Time	Cal. Activity	Volume or Quantity	Activity at Time of shipment
1175694	I-131 Liq.	Sodium Iodide Liq	Liq.	03-29-13 12:00	67.000 mCi	0.485 ml	67.483 mCi

Total Rx(s): 1

Total Activity: 2.497 GBq (67.483 mCi)

Label Required: Radioactive (White I) Radioactive (Yellow II) Radioactive (Yellow III)

0.5 Trans. Index at 1 Meter Survey Meter ID

0.0315 mR/hr Surface Reading 03 Background Ludlum 14C-135853 Surface Survey Meter Id

0 CPM Wipe Test 75 Background Ludlum 2200-129852 Wipe Test Instrument Id

This is to certify that the above-named materials are properly classified, described, packaged, marked and labeled, and are in proper condition for transportation according to the applicable regulations of the Department of Transportation.

PERFORMED BY: 

COURIER SIGNATURE: 

RECEIVED BY: _____

PharmaLogic of Bridgeport, WV
 Pharmalogic Bridgeport
 Bridgeport, West Virginia, USA
 Shipper's Report

3001

Printed: 03-29-2013 08:43

Cust ID: WVB8888 (Case: 1)

Run: 6

Shipping Date/Time: 03-29-2013 10:00

Shipper: PharmaLogic of Bridgeport, WV
 Pharmalogic Bridgeport
 109 Platinum Drive
 Suite A
 Bridgeport, West Virginia 26330
 304-842-0935

Ship To: PharmaLogci WV II
 Nuclear Medicine Department
 #9 W.Benedum
 Industrial Park ?Drive
 Bridgeport, WV 26330
 3048420935
 3048420936

BILL OF LADING

Radioactive Material, Type A package, 7, UN 2915
 USA DOT 7A TYPE A

Rx #	HM Radio Nuclide	Chemical Form	Phys. Form	Cal. Date Time	Cal. Activity	Volume or Quantity	Activity at Time of shipment
1175901	Generator	Tc99m Sodium Molybdate	Solid	03-29-13 10:00	894.292 mCi	1 Each	894.292 mCi

Total Rx(s): 1

Total Activity: 33.089 GBq (894.292 mCi)

Label Required: 0.6 Radioactive (White I) II Radioactive (Yellow II) Radioactive (Yellow III)
1.7 Trans. Index at 1 Meter 0.5 Background Ludlum 14C-135853 Surface Survey Meter Id
0 CPM Wipe Test 90 Background Ludlum 2200-129852 Wipe Test Instrument Id

This is to certify that the above-named materials are properly classified, described, packaged, marked and labeled, and are in proper condition for transportation according to the applicable regulations of the Department of Transportation.

PERFORMED BY: Mike Brown

COURIER SIGNATURE: M: K Brown

RECEIVED BY: _____

PharmaLogic of Bridgeport, WV
 Pharmalogic Bridgeport
 Bridgeport, West Virginia, USA
 Shipper's Report

3002

Printed: 03-29-2013 08:43

Cust ID: WVB8888 (Case: 1)

Run: 7

Shipping Date/Time: 03-29-2013 10:00

Shipper: PharmaLogic of Bridgeport, WV
 Pharmalogic Bridgeport
 109 Platinum Drive
 Suite A
 Bridgeport, West Virginia 26330
 304-842-0935

Ship To: PharmaLogci WV II
 Nuclear Medicine Department
 #9 W.Benedum
 Industrial Park ?Drive
 Bridgeport, WV 26330
 3048420935
 3048420936

BILL OF LADING

Radioactive Material, Type A package, 7, UN 2915
 USA DOT 7A TYPE A

Rx #	HM Radio Nuclide	Chemical Form	Phys. Form	Cal. Date Time	Cal. Activity	Volume or Quantity	Activity at Time of shipment
1175902	Generator	99m Sodium Molybdate	Solid	03-29-13 10:00	1102.850 mCi	1 Each	1102.850 mCi

Total Rx(s): 1

Total Activity: 40.805 GBq (1102.850 mCi)

Label Required: Radioactive (White I) II Radioactive (Yellow II) Radioactive (Yellow III)
06 Trans. Index at 1 Meter Survey Meter ID
3.0 mR/hr Surface Reading 05 Background Ludlum 14C-135853 Surface Survey Meter Id
0 CPM Wipe Test 90 Background Ludlum 2200-129852 Wipe Test Instrument Id

This is to certify that the above-named materials are properly classified, described, packaged, marked and labeled, and are in proper condition for transportation according to the applicable regulations of the Department of Transportation.

PERFORMED BY: Mike Power

COURIER SIGNATURE: Mike Power

RECEIVED BY: _____

PharmaLogic of Bridgeport, WV
 Pharmalogic Bridgeport
 Bridgeport, West Virginia, USA
 Shipper's Report

3003

Printed: 03-29-2013 08:43

Cust ID: WVB8888 (Case: 1)

Run: 8

Shipping Date/Time: 03-29-2013 10:00

Shipper: PharmaLogic of Bridgeport, WV
 Pharmalogic Bridgeport
 109 Platinum Drive
 Suite A
 Bridgeport, West Virginia 26330
 304-842-0935

Ship To: PharmaLogci WV II
 Nuclear Medicine Department
 #9 W.Benedum
 Industrial Park ?Drive
 Bridgeport, WV 26330
 3048420935
 3048420936

BILL OF LADING

Radioactive Material, Type A package, 7, UN 2915
 USA DOT 7A TYPE A

Rx #	HM Radio Nuclide	Chemical Form	Phys Form	Cal Date	Cal Time	Cal Activity	Volume or Quantity	Activity at Time of shipment
1175903	Generator	Tc99m Sodium Molybdate	Solid	03-29-13	10:00	5220.846 mCi	1 Each	5220.846 mCi

Total Rx(s): 1

Total Activity: 193.171 GBq (5220.846 mCi)

Label Required: 08 Radioactive (White I) II Radioactive (Yellow II) 80 Radioactive (Yellow III)
80 Trans. Index at 1 Meter 05 Survey Meter ID
80 mR/hr Surface Reading 90 Background Ludlum 14C-135853 Surface Survey Meter Id
80 CPM Wipe Test 90 Background Ludlum 2200-129852 Wipe Test Instrument Id

This is to certify that the above-named materials are properly classified, described, packaged, marked and labeled, and are in proper condition for transportation according to the applicable regulations of the Department of Transportation.

PERFORMED BY: Mike P...

COURIER SIGNATURE: Mike P...

RECEIVED BY: _____

PharmaLogic of Bridgeport, WV
 Pharmalogic Bridgeport
 Bridgeport, West Virginia, USA.
 Shipper's Report

Printed: 03-29-2013 13:01

Cust ID: WVB8888 (Case: 1)

Run: 9

Shipping Date/Time: 03-29-2013 10:00

Shipper: PharmaLogic of Bridgeport, WV
 Pharmalogic Bridgeport
 109 Platinum Drive
 Suite A
 Bridgeport, West Virginia 26330
 304-842-0935

Ship To: PharmaLogci WV II
 Nuclear Medicine Department
 #9 W. Benedum
 Industrial Park ? Drive
 Bridgeport, WV 26330
 3048420935
 3048420936

BILL OF LADING

Radioactive Material, Type A package, 7, UN 2915
 USA DOT 7A TYPE A

Rx #	HM Radio Nuclide	Chemical Form	Phys. Form	Cal. Date Time	Cal. Activity	Volume or Quantity	Activity at Time of shipment
1175987	Generator Tc99m	Sodium Molybdate	Solid	03-29-13 10:00	6438.396 mCi	1 Each	6438.396 mCi

Total Rx(s): 1

Total Activity: 238.221 GBq (6438.396 mCi)

Label Required: 1 Radioactive (White I) X Radioactive (Yellow II) X Radioactive (Yellow III)
 Trans. Index at 1 Meter 0.1 Background 0.03 Ludlum 14C-135853 Surface Survey Meter Id
40 mR/hr Surface Reading 100 Background Ludlum 2200-129852 Surface Survey Meter Id
0 CPM Wipe Test 100 Background Ludlum 2200-129852 Wipe Test Instrument Id

This is to certify that the above-named materials are properly classified, described, packaged, marked and labeled, and are in proper condition for transportation according to the applicable regulations of the Department of Transportation.

PERFORMED BY: 

COURIER SIGNATURE: 

RECEIVED BY: _____

PharmaLogic of Bridgeport, WV
 Pharmalogic Bridgeport
 Bridgeport, West Virginia, USA
 Shipper's Report

Printed: 03-26-2013 07:52

Cust ID: WVB8888 (Case: 1)

Run: 2

Shipping Date/Time: 03-29-2013 10:00

Shipper: PharmaLogic of Bridgeport, WV
 Pharmalogic Bridgeport
 109 Platinum Drive
 Suite A
 Bridgeport, West Virginia 26330
 304-842-0935

Ship To: PharmaLogic WV II
 Nuclear Medicine Department
 #9 W. Benedum
 Industrial Park Drive
 Bridgeport, WV 26330
 3048420935
 3048420936

BILL OF LADING

Radioactive Material, Type A package, 7, UN 2915
 USA DOT 7A TYPE A

Rx #	HM Radio Nuclide	Chemical Form	Phys. Form	Cal. Date Time	Cal. Activity	Volume or Quantity	Activity at Time of shipment
1175107	Generator Tc99m	Sodium Molybdate	Solid	03-29-13 10:00	26.240 mCi	1 Each	26.240 mCi

Total Rx(s): 1

Total Activity: 0.971 GBq (26.240 mCi)

Label Required: 0.4 Radioactive (White I) II Radioactive (Yellow II) Radioactive (Yellow III)
0.7 Trans. Index at 1 Meter Survey Meter ID
0 mR/hr Surface Reading 05 Background Ludlum 14C-135853 Surface Survey Meter Id
0 CPM Wipe Test 90 Background Ludlum 2200-129852 Wipe Test Instrument Id

This is to certify that the above-named materials are properly classified, described, packaged, marked and labeled, and are in proper condition for transportation according to the applicable regulations of the Department of Transportation.

PERFORMED BY: Mikhael

COURIER SIGNATURE: Mikhael

RECEIVED BY: _____

PharmaLogic of Bridgeport, WV
Pharmalogic Bridgeport
Bridgeport, West Virginia, USA
Shipper's Report

Printed: 03-26-2013 07:52

Cust ID: WVB8888 (Case: 1)

Run: 3

Shipping Date/Time: 03-29-2013 10:00

Shipper: PharmaLogic of Bridgeport, WV
Pharmalogic Bridgeport
109 Platinum Drive
Suite A
Bridgeport, West Virginia 26330
304-842-0935

Ship To: PharmaLogci WV II
Nuclear Medicine Department
#9 W.Benedum
Industrial Park ?Drive
Bridgeport, WV 26330
3048420935
3048420936

BILL OF LADING

Radioactive Material, Type A package, 7, UN 2915
USA DOT 7A TYPE A

Rx #	HM Radio Nuclide	Chemical Form	Phys. Form	Cal. Date Time	Cal. Activity	Volume or Quantity	Activity at Time of shipment
1175108	Generator	Tc99m Sodium Molybdate	Solid	03-29-13 10:00	32.359 mCi	1 Each	32.359 mCi

Total Rx(s): 1

Total Activity: 1.197 GBq (32.359 mCi)

Label Required: 0.4 Radioactive (White I) II Radioactive (Yellow II) 0.8 Radioactive (Yellow III)
Trans. Index at 1 Meter 0.5 Background 90 Background
mR/hr Surface Reading 0.5 Background Ludlum 14C-135853 Surface Survey Meter ID
CPM Wipe Test 90 Background Ludlum 2200-129852 Wipe Test Instrument ID

This is to certify that the above-named materials are properly classified, described, packaged, marked and labeled, and are in proper condition for transportation according to the applicable regulations of the Department of Transportation.

PERFORMED BY: Mike Parn

COURIER SIGNATURE: Mike Parn

RECEIVED BY: _____

PharmaLogic of Bridgeport, WV
 Pharmalogic Bridgeport
 Bridgeport, West Virginia, USA
 Shipper's Report

Printed: 03-26-2013 07:52

Cust ID: WVB8888 (Case: 1)

Run: 4

Shipping Date/Time: 03-29-2013 10:00

Shipper: PharmaLogic of Bridgeport, WV
 Pharmalogic Bridgeport
 109 Platinum Drive
 Suite A
 Bridgeport, West Virginia 26330
 304-842-0935

Ship To: PharmaLogci WV II
 Nuclear Medicine Department
 #9 W. Benedum
 Industrial Park ? Drive
 Bridgeport, WV 26330
 3048420935
 3048420936

BILL OF LADING

Radioactive Material, Type A package, 7, UN 2915
 USA DOT 7A TYPE A

Rx #	HM Radio Nuclide	Chemical Form	Phys. Form	Cal. Date	Cal. Time	Cal. Activity	Volume or Quantity	Activity at Time of shipment
1175109	Generator Tc99m	Sodium Molybdate	Solid	03-29-13	10:00	153.186 mCi	1 Each	153.186 mCi

Total Rx(s): 1

Total Activity: 5.668 GBq (153.186 mCi)

Label Required: 04 Radioactive (White I) II Radioactive (Yellow II) Radioactive (Yellow III)
1.4 Trans. Index at 1 Meter 05 Background Ludlum 14C-135853 Surface Survey Meter Id
0 mR/hr Surface Reading 90 Background Ludlum 2200-129852 Wipe Test Instrument Id
0 CPM Wipe Test

This is to certify that the above-named materials are properly classified, described, packaged, marked and labeled, and are in proper condition for transportation according to the applicable regulations of the Department of Transportation.

PERFORMED BY: Mike Pown

COURIER SIGNATURE: Mike Pown

RECEIVED BY: _____

**PharmaLogic of Bridgeport, WV
Pharmalogic Bridgeport
Bridgeport, West Virginia, USA
Shipper's Report**

Printed: 03-29-2013 07:27

Cust ID: WVB8888 (Case: 1)

Run: 5

Shipping Date/Time: 03-29-2013 10:00

Shipper: PharmaLogic of Bridgeport, WV
Pharmalogic Bridgeport
109 Platinum Drive
Suite A
Bridgeport, West Virginia 26330
304-842-0935

Ship To: PharmaLogci WV II
Nuclear Medicine Department
#9 W. Benedum
Industrial Park ? Drive
Bridgeport, WV 26330
3048420935
3048420936

BILL OF LADING

Radioactive Material, Type A package, 7, UN 2915
USA DOT 7A TYPE A

Rx #	HM Radio Nuclide	Chemical Form	Phys. Form	Cal. Date Time	Cal. Activity	Volume or Quantity	Activity at Time of shipment
1175891	Generator Tc99m	Sodium Molybdate	Solid	03-29-13 10:00	188.910 mCi	1 Each	188.910 mCi

Total Rx(s): 1

Total Activity: 6.990 GBq (188.910 mCi)

Label Required: Radioactive (White I) II Radioactive (Yellow II) Radioactive (Yellow III)

0.6 Trans. Index at 1 Meter Survey Meter ID

0.8 mR/hr Surface Reading 0.5 Background Ludlum 14C-135853 Surface Survey Meter Id

0.8 CPM Wipe Test 90 Background Ludlum 2200-129852 Wipe Test Instrument Id

This is to certify that the above-named materials are properly classified, described, packaged, marked and labeled, and are in proper condition for transportation according to the applicable regulations of the Department of Transportation.

PERFORMED BY: M. De Rose

COURIER SIGNATURE: M. De Rose

RECEIVED BY: _____

This is to acknowledge the receipt of your letter/application dated

7/17/13, and to inform you that the initial processing which includes an administrative review has been performed.

Amendment (47-25375-01MD)
There were no administrative omissions. Your application was assigned to a technical reviewer. Please note that the technical review may identify additional omissions or require additional information.

Please provide to this office within 30 days of your receipt of this card

A copy of your action has been forwarded to our License Fee & Accounts Receivable Branch, who will contact you separately if there is a fee issue involved.

Your action has been assigned **Mail Control Number** 581399.
When calling to inquire about this action, please refer to this control number.
You may call us on (610) 337-5398, or 337-5260.