



**Macomb  
Community College**

Education • Enrichment • Economic Development

United States Nuclear Regulatory Commission  
Region III, Materials Licensing  
2443 Warrenville Road, Road, Suite 210  
Lisle, IL 60532-4352

RE: Amendment to NRC Materials License No. \_21-32692-01  
Macomb Community College  
c/o Sharon Lafferty

Dear Sir/Madam:

**LICENSE TERMINATION**

The purpose of this letter is to terminate our NRC Materials license.

A close-out survey of our Nuclear Medicine department was performed on May 15, 2013 at the above address and is enclosed for your review.

The last date of use of radioactive material at this site was prior to January 1, 2013.

A current copy of the leak test results for the sealed sources used at our facility is enclosed for your review.

All sealed sources were transferred to Providence Hospital NRC License # 21-02802-03.  
Please find attached NRC Form 314.

We did not dispose of radioactive materials by release to sewers or incineration. In addition, there were no spills of any long-lived radioactive material or on-site burials of radioactive materials.

Thank you for your cooperation. If you have any questions or require additional information, please contact our physics consultant, Jim Botti at 734-662-3197.

Respectfully Yours,

Charlene McPeak, PhD, RN, BC  
Dean, Health and Public Services  
Macomb Community College

RECEIVED JUL 09 2013

(05-2012)  
10 CFR 30.36(j)(1); 40.42(j)(1);  
70.38(j)(1); and 72.54(k)(5)(1)(1)

Estimated burden per response to comply with this mandatory collection request: 30 minutes. This submittal is used by NRC as part of the basis for its determination that the facility is released for unrestricted use. Send comments regarding burden estimate to the Information Services Branch (T-5 F53), U.S. Nuclear Regulatory Commission, Washington, DC 20555-0001, or by internet e-mail to Infocollects.Resource@nrc.gov, and to the Desk Officer, Office of Information and Regulatory Affairs, NEOB-10202, (3150-0028), Office of Management and Budget, Washington, DC 20503. If a means used to impose an information collection does not display a currently valid OMB control number, the NRC may not conduct or sponsor, and a person is not required to respond to, the information collection.

**CERTIFICATE OF DISPOSITION OF MATERIALS**

LICENSEE NAME AND ADDRESS

Macomb Community College  
c/o Sharon Lafferty  
14500 E. 12 Mile Road  
Warren, MI 48088-3896

LICENSE NUMBER

21-32692-01

DOCKET NUMBER

030-37745

LICENSE EXPIRATION DATE

June 30, 2018

**A. LICENSE STATUS (Check the appropriate box)**

- This license has expired.  This license has not yet expired; please terminate it.

**B. DISPOSAL OF RADIOACTIVE MATERIAL**

(Check the appropriate boxes and complete as necessary. If additional space is needed, provide attachments)

The licensee, or any individual executing this certificate on behalf of the licensee, certifies that:

- 1. No radioactive materials have ever been procured or possessed by the licensee under this license.
- 2. All activities authorized by this license have ceased, and all radioactive materials procured and/or possessed by the licensee under this license number cited above have been disposed of in the following manner.
  - a. Transfer of radioactive materials to the licensee listed below:  
Providence Hospital NRC Material license #21-02802-03
  - b. Disposal of radioactive materials:
    - 1. Directly by the licensee:
    - 2. By licensed disposal site:
    - 3. By waste contractor:
  - c. All radioactive materials have been removed such that any remaining residual radioactivity is within the limits of 10 CFR Part 20, Subpart E, and is ALARA.

**C. SURVEYS PERFORMED AND REPORTED**

- 1. A radiation survey was conducted by the licensee. The survey confirms:
  - a. the absence of licensed radioactive materials
  - b. that any remaining residual radioactivity is within the limits of 10 CFR 20, Subpart E, and is ALARA.
- 2. A copy of the radiation survey results:
  - a. is attached; or  b. is not attached (Provide explanation); or  c. was forwarded to NRC on: \_\_\_\_\_ Date
- 3. A radiation survey is not required as only sealed sources were ever possessed under this license, and
  - a. The results of the latest leak test are attached; and/or
  - b. No leaking sources have ever been identified.

The person to be contacted regarding the information provided on this form:

NAME	TITLE	TELEPHONE (Include Area Code)	E-MAIL ADDRESS
Sharon Lafferty	Program Director, NUMT	586-286-2191	laffertys@macomb.edu
Mail all future correspondence regarding this license to: 14500 E 12 mile rd Warren, MI 48088-3896			

**C. CERTIFYING OFFICIAL**

I CERTIFY UNDER PENALTY OF PERJURY THAT THE FOREGOING IS TRUE AND CORRECT

PRINTED NAME AND TITLE	SIGNATURE	DATE
Charlene McPeak, Ph.D., RN-BC Dean, Health & Public Services		10-2-13

WARNING: FALSE STATEMENTS IN THIS CERTIFICATE MAY BE SUBJECT TO CIVIL AND/OR CRIMINAL PENALTIES. NRC REGULATIONS REQUIRE THAT SUBMISSIONS TO THE NRC BE COMPLETE AND ACCURATE IN ALL MATERIAL RESPECT. 18 U.S.C. SECTION 1001 MAKES IT A CRIMINAL OFFENSE TO MAKE A WILLFULLY FALSE STATEMENT OR REPRESENTATION TO ANY DEPARTMENT OR AGENCY OF THE UNITED STATES AS TO ANY MATTER WITHIN ITS JURISDICTION.

## Close-out Survey

**Date performed:** May 15, 2013

**Performed by:** Leslie Hoskyns

### Instruments

Wipe tests analyzed with a Capintec 3000 S/N# 900735

Instrument: Well Counter

Radionuclide: Full Spectrum

MDA for Full Spectrum: 622.0 dpm

Date completed: 12/15/11

Conversion factor: 6.37cpm/dpm

Area survey performed with the following survey meter:

Manufacturer: Ludlum

Type: GM

Model Number: 14C

Serial Number: 249915

Probe Model: Pancake

Annual Calibration Due: 01/21/14

Battery check acceptable: YES

Operational check acceptable: YES

Current reading: 0.95 mR/hr

### History of Radionuclides Used

**Unsealed:** The last date of use of radioactive material at this site was prior to January 1, 2013

**Sealed:** All sealed sources were transferred to Providence Hospital NRC Material license # 21-02802-03.

**Last date of any byproduct radiopharmaceutical use was prior to January 1, 2013**

**Visual Check:** The area was checked to ensure that all radioactive materials had been removed. No evidence of radioactive material was noted.

**Sealed Source Leak Testing:** No history of leaks from Sealed Sources at this facility.

**Radiation Level Survey:** No area within the department demonstrated radiation levels in excess of the background reading of 0.05 mR/hr.

**Removable Contamination:** No area within the department demonstrated removable contamination in excess of 0.0 dpm's. There is no history of any spills of long-lived radioisotopes.

**Conclusion:** No removable contamination is present. Please find the enclosed wipe and survey results, Sealed Source Leak Test results, and the NRC Form 314 for your review.

**Macomb Community College**

**NRC Material License # 21-32692-01**

**Date:** 5/15/2013  
**Well Counter:** Capitus 3000  
**Survey Meter:** Ludlum 14C  
Calibrated  
01/21/13

**Performed By:** Leslie Hoskyns  
**MDA:** 622 dpm  
**Check Value:** 0.95 mR/hr

		cpm	net dpm	mR/h
1	Dose Prep	0	0	0.05
2	Injection chair	0	0	0.05
3	Floor	0	0	0.05
4	Camera	0	0	0.05
5	Cmputers	0	0	0.05
6	PKG Check-in/Waste	0	0	0.05
7				
8				
9				
10				
	Background	475.00	0	0.05

**ACTION LEVELS:** 2000 dpm  
< 0.2 mR/hr

**Efficiency :** 6.37  
(dpm/cpm)

**COMMENTS:** No evidence of removable contamination.

Macomb Community College  
14500 E. 12 Mile  
Warren, 48088-3896  
NRC Materials License No. 21-32692-01

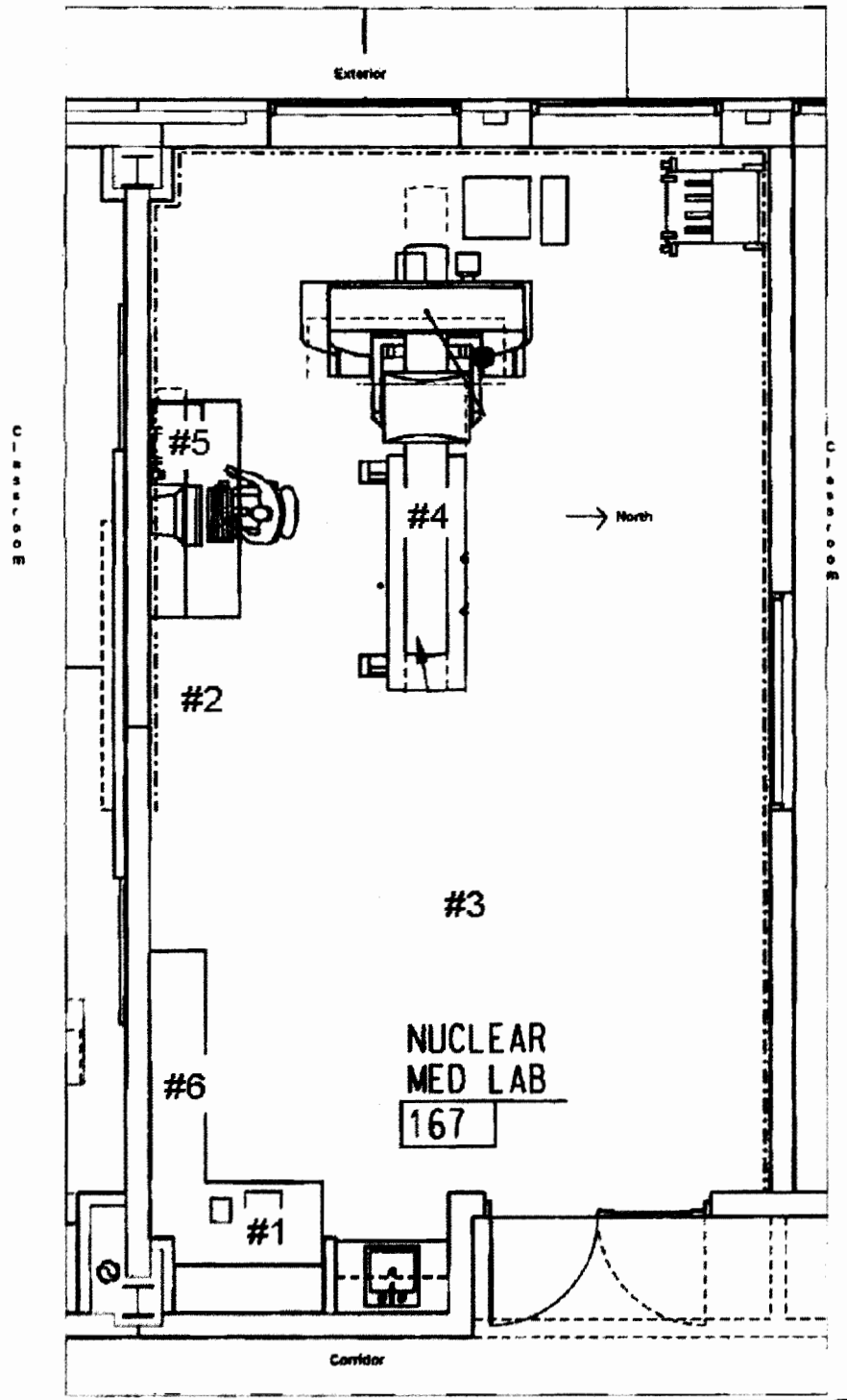

#1= Dose Prep Area  
#2= Injection Chair  
#3= Floor

#4= Camera  
#5= Computers/Countertops  
#6= Pkg Check/ Waste Storage Area

**Sealed Source Leak Test**

Licensee: Macomb Community College

Date: 01/24/13

Performed by: James Botti

Nuclide	Type	Calibration		Location	M/N	S/N
		Activity	Date			
Cs-137	Vial	197.4 uCi	09/01/08	Hot Lab	RV-137-200U	1296-29-20
Current Activity: 178.32uCi						
Co-57	Flood	10 mCi	06/01/10	Hot Lab	MED-3709	1434-188
Current Activity: 0.841mCi						

Comment: The sources listed above were leak tested using a dry wipe technique and were found to have less than 0.005 uCi removable activity. The following Minimum Detectable Activities are based upon a background at the indicated value. Background was at or below these levels when the above tests were completed.

Well Counter: Captus 3000

Nuclide	MDA	Background
Cs-137	$2.0 \times 10^{-4}$ uCi	145 counts/1 min
Ba-133	$8.8 \times 10^{-5}$ uCi	204 counts/1 min
Co-57	$1.7 \times 10^{-5}$ uCi	53 counts/1 min

**RADIATION SAFETY OFFICER:** \_\_\_\_\_

FedEx  
TRK#  
0215 8731 3176 7307

TUE - 09 JUL AA  
EXPRESS SAVER  
DSR  
60532  
IL-US  
ORD

SE ENLA

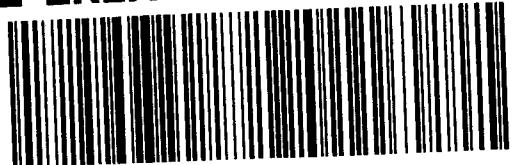

Exp# 548734 03JUL13 UIZA 519C1/AA04/93AB

RT TUE  
80:20  
10:31  
D  
495  
7  
493  
667  
Lb

136  
200

FedEx

RECIPIENT: PEEL HERE

1 From This portion can be removed for Recipient's records.  
Date 7/3/13 FedEx Tracking Number 873131767307  
Sender's Name Sharon Lafferty Phone 5862264760  
Company MACOMB COMMUNITY COLLEGE  
Address 14500 E 12 MILE RD  
City WARREN State MI ZIP 48088

2 Your Internal Billing Reference

3 To Recipient's Name United States Nuclear Regulatory Commission Phone 630 829-9500  
Company Region III Office of Materials  
Address Lisle, IL  
Address 2443 Warronville Rd Suite 210  
City Lisle State IL ZIP 60532-4352



8731 3176 7307

Recipient's Copy

4a Express Package Service \*To meet locations. Packages up to 150 lbs.  
 FedEx Priority Overnight Next business morning. \* Friday shipments will be delivered on Monday unless SATURDAY Delivery is selected.  
 FedEx Standard Overnight Next business afternoon. \* Saturday Delivery NOT available.  
 FedEx First Overnight Earliest next business morning delivery to select locations.  
 FedEx 2Day Second business day. \* Thursday shipments will be delivered on Monday unless SATURDAY Delivery is selected.  
 FedEx Express Saver Third business day. \* Saturday Delivery NOT available.

4b Express Freight Service \*\*To meet locations. Packages over 150 lbs.  
 FedEx 1Day Freight Next business day. \*\* Friday shipments will be delivered on Monday unless SATURDAY Delivery is selected. FedEx 1Day Freight Booking No.  
 FedEx 2Day Freight Second business day. \*\* Thursday shipments will be delivered on Monday unless SATURDAY Delivery is selected.  
 FedEx 3Day Freight Third business day. \*\* Saturday Delivery NOT available.

5 Packaging \*Declared value limit \$500.  
 FedEx Envelope\*  FedEx Pak\* Includes FedEx Small Pak and FedEx Large Pak.  FedEx Box  FedEx Tube  Other

6 Special Handling and Delivery Signature Options  
 SATURDAY Delivery NOT available for FedEx Standard Overnight, FedEx Express Saver, or FedEx 3Day Freight.  
 No Signature Required Package may be left without obtaining a signature for delivery.  
 Direct Signature Someone at recipient's address may sign for delivery. Fee applies.  
 Indirect Signature If no one is available at recipient's address, someone at a neighboring address may sign for delivery. For residential deliveries only. Fee applies.

Does this shipment contain dangerous goods?  
One box must be checked.  
 No  Yes Shipper's Declaration required.  
 Dry Ice Dry Ice 3 UN 1845  Cargo Aircraft Only  
Dangerous goods (including dry ice) cannot be shipped in FedEx packaging or placed in a FedEx Express Drop Box.

7 Payment Bill to:  
 Sender Acct. No. in Section 1 will be billed.  Recipient  Third Party  Credit Card  Cash/Check  
Obtain recip. Acct. No.  Obtain recip. Acct. No.

Total Packages  Total Weight  Credit Card Auth.

\*Our liability is limited to \$100 unless you declare a higher value. See the current FedEx Service Guide for details.

605

Rev. Date 2/10 • Part #18279 • ©1994-2010 FedEx • PRINTED IN U.S.A. SRS

fedex.com 1.800.GoFedEx 1.800.463.3339

fedex.com 1.800.GoFedEx 1.800.463.3339