

Diplomate, American Board of Cardiovascular Diseases
Diplomate, Interventional Cardiology
Consultative Cardiology
Full Invasive and Interventional

23100 Cherry Hill
Suite 5
Dearborn, MI 48124
Tel (313) 359-3652
Fax (313) 359-3654

United States Nuclear Regulatory Commission

Region III, Materials Licensing Section

2443 Warrenville Road, Ste 210

Lisle, IL 60532-4352

Close-out for license #21-32376-01, Michigan Internal Medicine & Cardiology Associates., Affiliated Medical of Dearborn site.

- 1 A close-out survey was performed on 01/28/13 of our **Affiliated Medical of Dearborn, 2200 Monroe, Dearborn, MI 48124** address and is enclosed for your review. We have also enclosed a map of all areas wipe tested.
- 2 We did not dispose of radioactive materials by release to sewers or incineration. In addition, there were no spills or leaking sources of any long-lived radioactive material or on-site burials of radioactive materials.
- 3 Any further correspondence may be sent to MICHIGAN INTERNAL MEDICINE & CARDIOLOGY ASSOCIATES, 2191 South Boulevard, Suite 101, Auburn Hills, MI 48326.
- 4 We have enclosed confirmation of the sealed sources received at MICHIGAN INTERNAL MEDICINE & CARDIOLOGY ASSOCIATES (23100 Cherry Hill, Suite5, Dearborn MI 48124 location) from the Affiliated closed-out site.

Cordially,



Stelian Marinescu, M.D.

MICHIGAN INTERNAL MEDICINE & CARDIOLOGY ASSOCIATES

FEB 25 2013

Close-out Survey

Date Performed: 01/28/13

Performed By: Lori Green, Technologist

Wipe tests analyzed with a CRC-15W well counter. Efficiency for Co-57 is 1.2%. MDA is 46 dpm.

Survey performed with Ludlum survey meter model 14C with side window probe, S/N 203100, calibrated on 08/27/12 with a check source reading of 0.9 mR/hr. Range used was 0.1 mR/hr.

All sealed radioactive sources were transported to MICHIGAN INTERNAL MEDICINE & CARDIOLOGY ASSOCIATES, 23100 Cherry Hill, Ste. 7, Dearborn, MI 48124. There is no history of any leaking sources.

History of Radionuclides Used

Tc-99m was last used 10/24/12. No other isotopes, except sealed sources: Cs-137, Ba-133 and Co-57, were used at this facility.

Visual Check

The area was checked to ensure that all radioactive waste had been removed. No radioactive material was located.

Radiation Level Survey

No area within the department demonstrated radiation levels in excess of the background reading of 0.01 mR/hr.

Removable Contamination

1 minute counts of a wipe sample covering at least a 100 square centimeter area

<u>Area Results(dpm)</u>		<u>Area Results(dpm)</u>	
1	0	29	0
2	0	30	0
3	0	31	0
4	0	31	0
5	0	33	0
6	0	34	0
7	0	35	0
8	0	36	0
9	0	37	0
10	0	38	0
11	0	39	0
12	0	40	0
13	0	41	0
14	0	42	0
15	0	43	0
16	0	44	0
17	0	45	0
18	0	46	0
19	0	47	0
20	0	48	0
21	0		
22	0		
23	0		
24	0		
25	0		
26	0		
27	0		
28	0		

Maximum removable contamination: 0 net dpm/100 cm²

Conclusion

As of 01/28/12 all radioactive materials were removed from the site and no removable contamination was present.

Affiliated Medical of Dearborn
1711 Monroe Blvd.
Dearborn, MI 48102

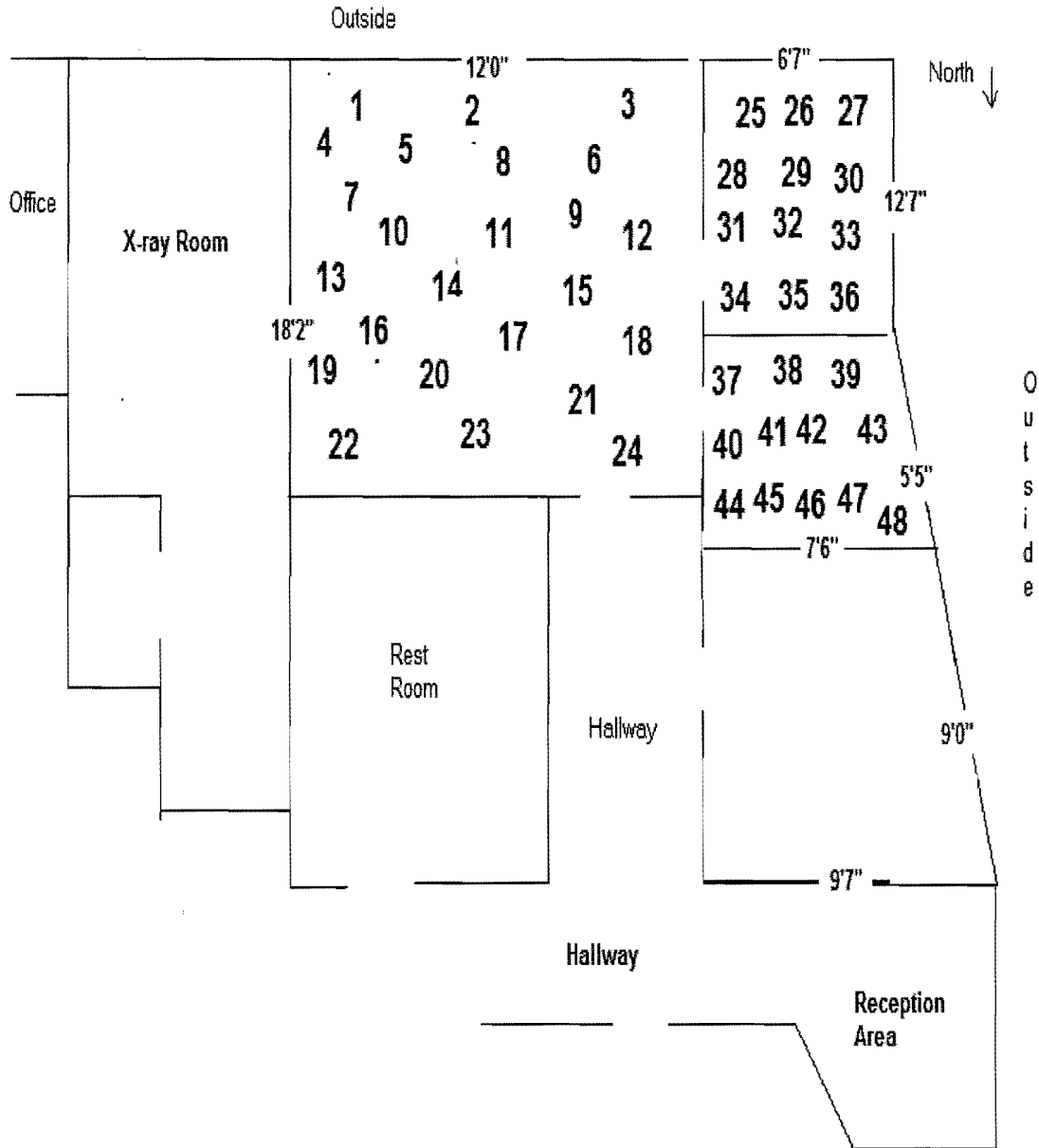

Nuclide	Type	CalibrationActivity	CalibrationDate	ModelNumber	SerialNumber
Co-57	Flood	10 mCi	5/10/2011	BM02-10	BMO210110751
Cs-137	Vial	266 uCi	2/4/1986	Syncor	212004

These sources were received by L. Green on 01/28/13 at Michigan Internal Medicine & Cardiology Associates,
23100 Cherry Hill, Ste. 7, Dearborn, MI 48124 from Affiliated Medical of Dearborn
1711 Monroe, Dearborn, MI 48124

Stelian Marinescu M.D.
23100 Cherry Hill
Suite 7
Dearborn MI
48124



7012 1640 0001 9018 0943



UNITED STATES
POSTAL SERVICE

1000



60532

U.S. POSTAGE
PAID
ROCHESTER HILLS, MI
48307
FEB 21 2013
AMOUNT

\$4.42

00069002-09

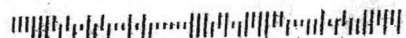

United States Nuclear Regulatory Commission
Region III, Materials Licensing Section
2443 Warrenville Road, Ste 210
Lisle, IL 60532-4352

FIRST CLASS