

5488

15-6 (46")

15-7 (18")

15-8 (46")

STAGING AREA
MP-1528 (2005)

TOPSOIL 29 (2004)

TOPSOIL 58 (2009)

TOPSOIL 49 (2007)

HEADER HOUSE 15-20

HEADER HOUSE 15-22

HEADER HOUSE 15-21

HEADER HOUSE 15-13

TOPSOIL 3 (2006)

TOPSOIL 33 (2006)

TOPSOIL 32 (2006)

TOPSOIL 3 (2006)

TOPSOIL 32 (2006)

TOPSOIL 32 (2006)

TOPSOIL 32 (2006)

TOPSOIL 32 (2006)

TOPSOIL 32 (2006)

TOPSOIL 32 (2006)

TOPSOIL 32 (2006)

TOPSOIL 32 (2006)

TOPSOIL 32 (2006)

TOPSOIL 32 (2006)

TOPSOIL 32 (2006)

GW-13

GW-14

15A

15

15-10 (12")

15-9 (18")

15-18 (24")

15-11 (12")

5537

GW-15

- 2012-2013 PROPOSED AREAS OF DEVELOPMENT
- 2011-2012 NEW DISTURBANCE AREAS
- EROSION CONTROLS
- EXCURSION WELLS (CURRENT)
- EXCURSION WELLS (RESOLVED)
- SPILLS
- MU OF MU-?
- UNDERLYING MONITOR WELL
- OVERLYING MONITOR WELL
- MO or MS-?
- MP-?
- MP-?
- WELL FIELD TEND WELL
- WELL FIELD RESTORATION WELL
- XR-?
- OLD PUMP TEST WELLS FOR UNDERGROUND WORKINGS
- OWD OR OWS-?
- AS-?
- GROUND WATER SAMPLING LOCATION
- SW-?
- SURFACE WATER SAMPLING STATION
- PERMIT 603 BOUNDARY
- PERMIT 633 BOUNDARY
- PIPELINE
- POWERLINES
- FENCES
- EXISTING TOPSOIL
- NEW OR ADDED TOPSOIL
- STREAM CHANNEL
- RESTORATION COMPLETE - AWAITING DECOMMISSIONING
- RESTORATION IN PROGRESS
- RESTORATION PENDING 2012-2013
- ACTIVE - PRODUCTION
- PROPOSED PRODUCTION
- PAVED ROAD
- GRAVEL ROAD
- TWO TRACK

INDEX MAP

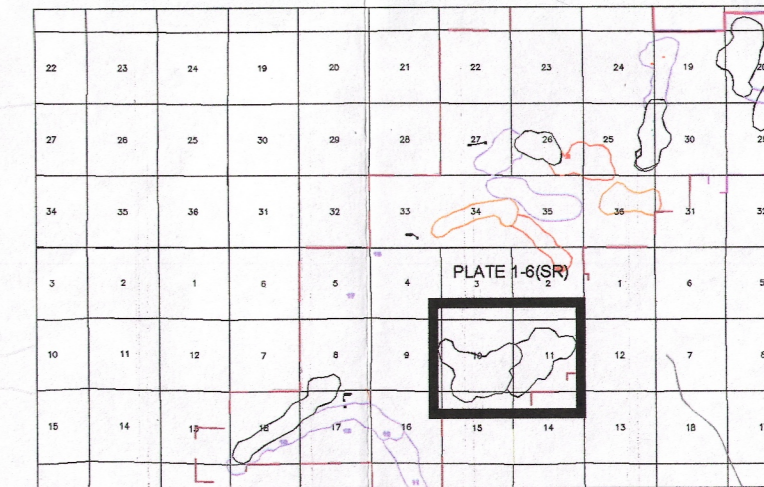

SCALE IN FEET
0 125 250 500

PLATE 1-6(SR)

REVISIONS

NO.	DATE	DESCRIPTION
1		
2		
3		
4		
5		
6		
7		
8		
9		
10		

CAMECO

SMITH RANCH PROJECT PERMIT TO MINE 633

DATE: 01/15/2013

SCALE: 1" = 100'

PROJECT NO: 0

R-74W

207