

R.90W. R.89W.

30

35

36

MINE UNIT NO.1

2

PATHFINDER MINES

ATLAS MINE WORKINGS APPROX BOTTOM ELEVATION 6400

MINE UNIT NO.3

SATELLITE

SATELLITE

NOTE: THE SATELLITE FACILITY WILL BE LOCATED AT EITHER OF THE TWO LOCATIONS SHOWN DEPENDING ON THE RESULTS OF DELINEATION DRILLING.

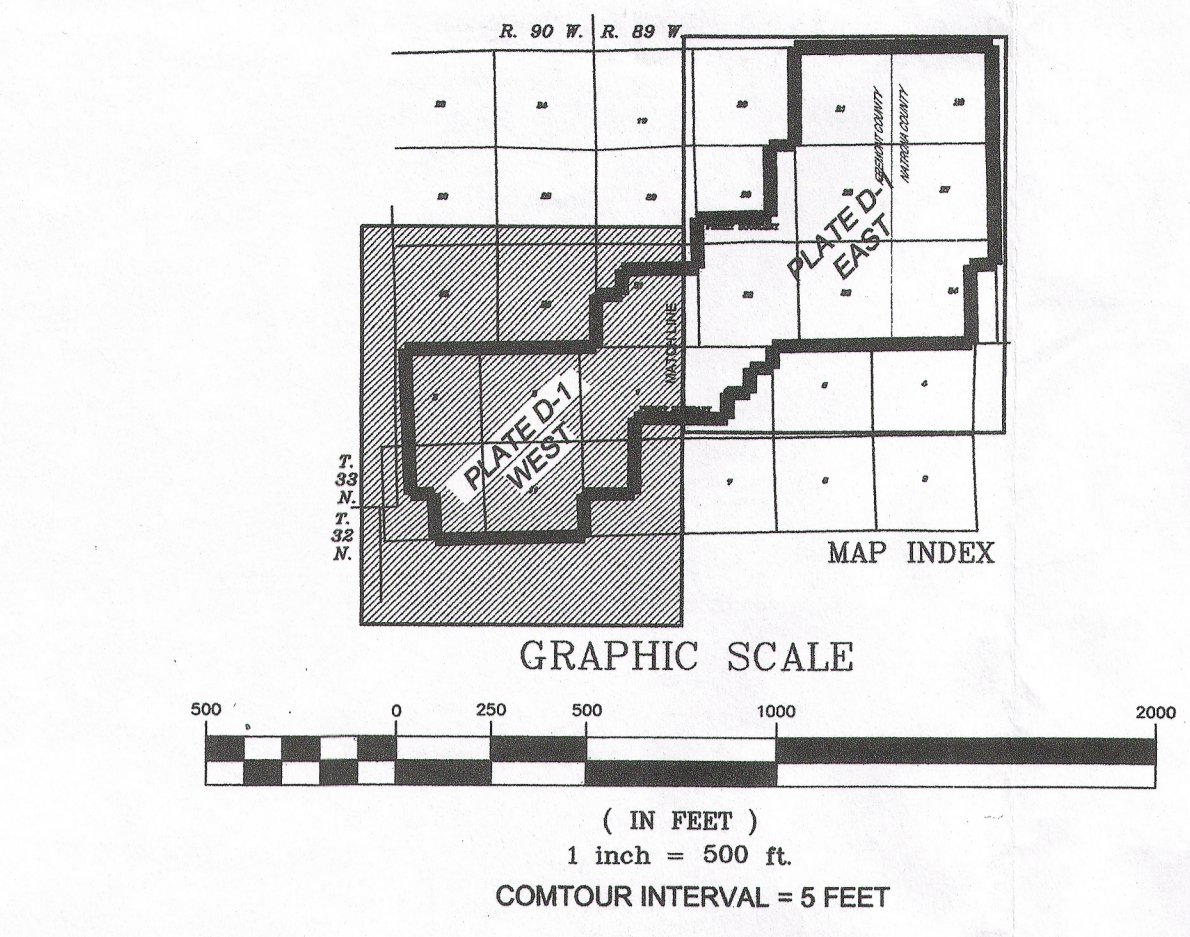

LEGEND

- PERMIT BOUNDARY
- SECTION LINE (APPROX)
- MATCH LINE
- DISTURBED & RECLAIMED LANDS
- UNDISTURBED ACCESS ROADS
- EXISTING ROADS TO BE UPGRADED
- PROPOSED ACCESS ROADS
- TRAILS
- POWER --- POWERLINE R.O.W.
- UGP --- UNDERGROUND PIPELINE R.O.W.
- T --- TELEPHONE LINE R.O.W.
- MINE UNIT 1 (MUSKRAT DEPOSIT)
- MINE UNIT 2 (BOUNTIFUL DEPOSIT)
- MINE UNIT 3 (PEACH DEPOSIT)
- MINE UNIT 4 (BUSS DEPOSIT)
- MINE UNIT 5 (PIX DEPOSIT)

NOTE: FOR DETAILED MAPPING OF DISTURBED & RECLAIMED LANDS, SEE PLATE D8-1.

T.33N.
T.32N.

	NO.	REVISION	DATE BY	ISSUED FOR	DATE BY
	POWER RESOURCES, INC.				
SCALE: 1"=500'	DATE	DWG. NO.	REV.		
DRAWN BY: SCM	07/28/09	PLATE D1-1W	1		
CHECKED:					
APPROVED:					
GAS HILLS PROJECT DISTURBED AREAS FREMONT AND NATRONA COUNTIES, WY					
REVISION DATE: 6/20/09					
LAST PLOT DATE: 6/20/09					
CAD FILENAME: PL-D1-1W.dwg					