

Addendum Report Second Supplemental Phase Ib Cultural Resources Investigation Power Block Relocation

Bell Bend Nuclear Power Plant
Luzerne County, Pennsylvania
ER 81-0658-079

Prepared for:
AREVA NP Inc.
and
UniStar Nuclear Energy, LLC

Prepared by:
Barbara A. Munford, M.A.
GAI Consultants Inc.
385 East Waterfront Drive
Homestead, Pennsylvania

GAI Project No. C100549.00

October 8, 2010



Addendum Report
Second Supplemental Phase Ib Cultural Resources
Investigation
Power Block Relocation

Bell Bend Nuclear Power Plant
Luzerne County, Pennsylvania
ER 81-0658-079

Prepared for:
AREVA NP Inc.
and
UniStar Nuclear Energy, LLC

Prepared by:

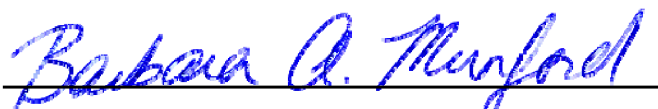

Barbara A. Munford, M.A., Principal Investigator

GAI Consultants Inc.
385 East Waterfront Drive
Homestead, Pennsylvania

GAI Project No. C100549.00

October 8, 2010

Abstract

Between April and May 2010, GAI Consultants, Inc. (GAI) conducted Second Supplemental Phase Ib archaeological investigations of the Power Block Relocation area within the proposed Bell Bend Nuclear Power Plant (BBNPP), Luzerne County, Pennsylvania. This study was performed for AREVA NP Inc. (AREVA) on behalf of UniStar Nuclear Energy (UniStar). The project area represents the Upland Section of the Power Block Relocation area, totaling approximately 215 acres (87 hectares). The Upland Section encompasses the approximately 39-acre (15.8-hectare) previously-surveyed Switchyard 2 Parcel, which was excluded from investigations. The Phase Ib Area of Potential Effect (APE) consists of approximately 176 acres (71 acres) of uplands (excluding the previously-surveyed, 39-acre/71-hectare, Switchyard 2 parcel) adjacent to previously-surveyed portions of the BBNPP project area. Proposed construction activities are anticipated to include both temporary and permanent impacts (e.g., grading, fill, construction lay down, parking, buildings, and roadway construction) within portions of the supplemental project area.

GAI's Second Supplemental Phase Ib study included a background research review, Phase Ib field investigations, and laboratory analysis. Fieldwork consisted of the excavation of 1,358 shovel test pits and pedestrian ground survey of 14.95 acres (6.05 acres) of cultivated fields.

Phase Ib investigations produced 261 artifacts (246 historic artifacts and 15 prehistoric lithic artifacts) and resulted in the identification of two archaeological sites (Sites 36LU301 and 36LU302) and one prehistoric isolated find (IF 28) within the project area. Non-site historic artifact field scatters were also identified.

Based on Phase Ib results, GAI recommends that Site 36LU301, a possible Early Archaic prehistoric occupation, is potentially eligible for listing in the NRHP under Criterion D. GAI recommends site avoidance or Phase II investigations of this locality.

Site 36LU302, a mid-nineteenth through late twentieth century, heavily disturbed domestic site, is recommended as Not Eligible to the NRHP and no further work is recommended at this site. Prehistoric IF 28 (Lot 3) does not meet the minimum requirements to be considered a significant archaeological resource. Accordingly, no further archaeological investigations of this resource are recommended.

Table of Contents

Abstract

I. Introduction and Project Overview.....	1
Project Summary.....	1
Area of Potential Effect	2
Summary of Results.....	2
Regulatory Guidelines.....	4
Project Staff and Acknowledgements	4
II. Background, Setting, and Archaeological Potential.....	8
Summary of Previous Studies.....	8
Project Setting.....	9
Background Research Review	9
Archaeological Potential.....	10
Objectives	14
Field Methods.....	14
Laboratory Methods	15
Laboratory Processing	15
Methods of Historic/Modern Artifact Analysis	15
Methods of Prehistoric Lithic Analysis.....	16
IV. Supplemental Phase Ib Results.....	18
Northern Section (Lots 54, 6, 6A, 6B, 7, 8, 31, 23 and 0)	19
Lot 54.....	19
Lot 6	21
Lot 6A	21
Lot 6B	24
Lot 7	24
Lot 8	24
Lot 31	25
Lot 23	27
Lot 0	27
Western Section (Lots 3 and 41).....	27
Lot 3	27
Lot 41	29
Lot 93D.....	33
Rail Spur Corridor	35
Site 36LU301 (GAI Site 12).....	36
Prehistoric Artifact Analysis	38
Site 36LU302 (GAI Site 13).....	44
V. Summary and Recommendations	53
References	54

Appendix A	BHP Report Summary Form
Appendix B	Project Correspondence
Appendix C	Pennsylvania Archaeological Site Survey Forms
Appendix D	Artifact Catalogs

List of Figures

Figure 1.	Second Supplemental Phase Ib Project Location	6
Figure 2.	Second Supplemental Phase Ib Project Area Showing Archaeological Potential and Testing Locations	7
Figure 3.	Project Area and Vicinity in 1873 showing Structures in Lot 6B Vicinity	11
Figure 4.	Lot 6B and Vicinity in 1955	12
Figure 5.	Lot 6B and Vicinity in 1959	13
Figure 6.	Lot 54 and Lot 6, Representative Shovel Test Profiles (STPs F-3 and C-1)	20
Figure 7.	Lot 6A and Lot 7, Representative Shovel Test Profiles (STPs A-1 and A-2)	23
Figure 8.	Lot 31, Representative Shovel Test Profiles (STPs I-6 and A-4)	26
Figure 9.	Lot 3, Representative Shovel Test Profiles (STPs C-3 and G-8)	29
Figure 10.	Lot 41, Representative Shovel Test Profiles (STPs J-2 and D-1)	32
Figure 11.	Lot 93D, Representative Shovel Test Profiles (STPs O-4, C-4 and D-2)	34
Figure 12.	Site 36LU301 Showing Phase Ib Testing Locations	37
Figure 13.	Site 36LU301: Representative Shovel Test Profiles (STPs J-10 and A-2)	39
Figure 14.	Site 36LU302 Showing Phase Ib Testing Locations	45
Figure 15.	Site 36LU302: Representative Shovel Test Profiles (STPs D-4, G-4 and H-4)	47
Figure 16.	Site 36LU302: Feature 1, Planview	49

List of Tables

Table 1.	Summary of Second Supplemental Phase Ib Archaeological Survey Results	4
Table 2.	Previously Recorded Architectural Resources within Project APE	10
Table 3.	Summary of Second Supplemental Phase Ib Survey Results by Testing Location	18
Table 4.	Site 36LU901: Crosstabulation of Artifact Type by Lithic Raw Material	40
Table 5.	Site 36LU301: Crosstabulation of Cortex Type by Lithic Raw Material	40
Table 6.	Site 36LU301: Summary of Lithic Tools	40
Table 7.	Site 36LU301: Crosstabulation of Flake Type by Lithic Raw Material	42
Table 8.	Site 36LU301: Historic Artifact Pattern Analysis	42
Table 9.	Site 36LU302: Stratigraphic Distribution of Historic Artifacts	46
Table 10.	Site 36LU302: Pattern Analysis, Historic Artifacts	50

List of Photographs

Photograph 1.	Western Section: Overview of Cultivated Field (Lot 41) West of North Market Street, Facing North	1
Photograph 2.	Northern Section: Shovel Testing in Woodlands (Lot 6A), Facing East.....	2
Photograph 3.	Lot 54: Wooded Upland Flat in Northern Portion of Parcel, Facing West.....	19
Photograph 4.	Lot 6: Wooded Upland Flat in Northwest Portion of Parcel, Facing Northwest.....	21
Photograph 5.	Lot 6A, Section 1: Shovel Testing on Wooded Upland Flat in Northeast Corner of Lot, Facing West.....	22
Photograph 6.	Lot 6A, Section 2: Cobble Pile on Wooded Hillslope, Facing South	22
Photograph 7.	Lot 7: Wooded Upland Flat in Northwest Corner of Lot, Facing West	24
Photograph 8.	Lot 8: Steep Wooded Hillslope Above Beach Grove Road, Facing South.....	25
Photograph 9.	Lot 31, Section 1: Wooded Upland Flat, Facing East.....	25
Photograph 10.	Lot 23: Steep Wooded Hillslope, Facing Northeast.....	27
Photograph 11.	Lot 0: Transmission Corridor on Steep Hillslope North of Beach Grove Road, Facing West.....	27
Photograph 12.	Lot 3, Section 1: Fallow Field, Facing South	28
Photograph 13.	Lot 3, Section 2: Open Grassy Field with Shed and Residence in Background, North Market Street to Left, Facing Southeast.....	28
Photograph 14.	Lot 41, Section 2: Michaels Farm from North Market Street, Facing Southwest	30
Photograph 15.	Lot 41, Section 1: View of Cultivated Field from Edge of North Market Street, showing Michaels Farm in Distance, Facing Southwest	30
Photograph 16.	Lot 41, Section 2: Michaels Farm, showing Lawn, Residence in Background and Outbuilding to Left, Facing East	31
Photograph 17.	Lot 93D, Section 1: Overview of Woodland, Facing North.....	33
Photograph 18.	Lot 93D, Section 2: Shovel Testing in Woodland, Facing West.....	33
Photograph 19.	Rail Spur Corridor: Existing Railway Tracks and Surrounding Disturbance Associated with SSES Facility, Facing South	35
Photograph 20.	Site 36LU301: Overview of Cultivated Field, showing Michaels Farmstead in Background to Right, Facing East.....	36
Photograph 21.	Site 36LU301: Southeast Corner of Cultivated Field and Michaels Farm, Facing Southwest	36
Photograph 22.	Site 36LU301: Pedestrian Ground Survey of Cultivated Field (Lot 41, Section 1), Facing South	38
Photograph 23.	Site 36LU301: Bifaces	41
Photograph 24.	Site 36LU301: Hammerstones (FS 6 and FS 7).....	41
Photograph 25.	Site 36LU302: View of Site Area from South Side of Beach Grove Road, showing Large Pine Trees, Facing Northeast	44
Photograph 26.	Site 36LU302: Wooded Hillside showing Row of Pine Trees near North Edge of Site in Vicinity of Feature 1, Facing Northeast	44
Photograph 27.	Site 36LU301: Feature 1 (Flagstone Patio), Facing East.....	48
Photograph 28.	Site 36LU302: Partially-Excavated STP G-4 showing Feature 2 Fill (Ash Pit/Dump), Facing North	48

I. Introduction and Project Overview

Project Summary

Between April and May 2010, GAI Consultants, Inc. (GAI) conducted Second Supplemental Phase Ib Cultural Resources Investigations of the Power Block Relocation area within the proposed Bell Bend Nuclear Power Plant (BBNPP), in Luzerne County, Pennsylvania, for AREVA NP Inc. (AREVA) on behalf of UniStar Nuclear Energy, LLC (UniStar). The overall BBNPP project area is located adjacent to the existing PPL Corporation's Susquehanna Steam Electric Station (SSES), west of the North Branch Susquehanna River and northeast of the town of Berwick, Pennsylvania (Figure 1). UniStar proposes the potential development of a nuclear power generation unit in this locality. As defined by AREVA, the Second Supplemental Phase Ib study area includes approximately 215 acres (87 hectares) of uplands bordering previously-surveyed portions of the BBNPP project area (Upland Section). UniStar and AREVA requested survey of this area due to a relocation of the proposed BBNPP power block. [An additional 9.8 acres (4.0 hectares) of new project areas in low terrace/floodplain settings (Floodplain Section) were identified by AREVA but were not included in the current study; survey of the Floodplain Section may be conducted, as necessary, once project impacts in this locality are finalized.] The purpose of this study was to determine the presence of unrecorded archaeological sites within new upland portions of the project area and to assess the potential eligibility of identified sites for listing in the National Register of Historic Places (NRHP).

The Second Supplemental project area consists of 13 lots, predominantly representing new project localities. It includes a series of nine lots north of the initial BBNPP project area (the Northern Section—Lots 54, 6, 6A, 6B, 7, 8, 31, 23, and 0), two lots to the west (the Western Section—Lots 3 and 41), and one lot to the south (Lot 93D), as well as the previously-surveyed Rail Spur Corridor, which was reevaluated due to a redefinition of proposed project impacts (Photographs 1 and 2). The project area identified by AREVA also encompasses the 39-acre (15.7 hectare) previously-surveyed Switchyard 2 parcel (located within portions of Lots 7, 8, 31, 23 and 0 in the Northern Section) which was excluded from further investigation. Accordingly, GAI conducted Second Supplemental Phase Ib investigations of an approximately 176-acre (71-hectares) area for the proposed BBNPP Power Block Relocation. Proposed construction activities will result in both temporary and permanent impacts (e.g., grading, fill, construction lay down, parking, buildings, and roadway construction) within portions of the supplemental project area.



**Photograph 1. Western Section:
Overview of Cultivated Field (Lot 41)
West of North Market Street, Facing
North**

Photograph 2. Northern Section: Shovel Testing in Woodlands (Lot 6A), Facing East

This Second Supplemental Phase Ib survey represents the sixth cultural resources study of the proposed BBNPP project. GAI conducted Phase Ia cultural resources investigations (archaeological/geomorphological reconnaissance and architectural survey) of 1,271 acres (514 hectares) of potential project alternatives in two episodes—June 2007 and January 2008 (GAI 2007, Munford and Tuk 2008). A Phase Ib survey of the initial 639-acre (259-hectare) project area



(West Alternative, Areas 6, 7, and 8, and Confers Lane Parcel) was performed between May and August 2008 (Munford et al. 2008). Supplemental Phase Ib survey of approximately 263 acres (106 hectares) of new project localities (Lots 4, 64, 93F, 95, 96, 97/97C, and 100) bordering the initial project area was conducted between August and November 2008 (Munford 2008). Phase Ib studies identified eleven archaeological sites, seven of which were determined to be potentially eligible for listing in the NRHP. GAI conducted Phase II National Register Evaluations of these seven sites between July and November 2009. Based on the results of this study, all seven sites are recommended as Not Eligible to the NRHP, under Criterion D. Architectural survey of the project area documented 52 architectural and historical resources within the project viewshed and recommended that seven resources are eligible or potentially-eligible for listing on the NRHP. The results of Phase I and II investigations have been presented in individual documents noted above and in a combined Draft Phase I/Phase II Technical Report (Munford et al. 2010), submitted to UniStar in June 2010.

Second Supplemental Phase Ib investigations (Power Block Relocation) were conducted in accordance with GAI's Scope of Work dated March 30, 2010. The scope of work was based on project mapping (Overall Re-Zoning Plan A-1, PPL, Salem Township, Luzerne County, Pennoni Associates, Inc., 6/2/09; and Conceptual Grading & Drainage Plan, Sheet 12, Bell Bend Nuclear Power Plant, UniStar Nuclear, Pennsylvania, Sargent & Lundy, 2/26/10) provided by Peter Gluckler (AREVA) on March 23 and 26, 2010. This addendum report presents the methods and results of Supplemental Phase Ib survey, provides recommendations on the potential National Register eligibility of identified sites, and recommendations on the need for further work. A BHP Report Summary Form for the project is presented in Appendix A.

Area of Potential Effect

The Area of Potential Effect (APE) for the current Phase Ib study consists of approximately 176-acres (71-hectares) of new or reevaluated project localities within the approximately 215-acre (87-hectare) Upland Section of the Second Supplemental Project Area. The project APE is defined as the footprints of Lots 54, 6, 6A, 6B, 7, 8, 31, 23, 0, 4, 31, 93D, and the Rail Spur Corridor, excluding the previously surveyed 39-acre (15.8-hectare) Switchyard 2 parcel.

Summary of Results

Supplemental Phase Ib fieldwork, conducted between April 27 and May 23, 2010, included pedestrian ground survey and the excavation of 1,358 shovel test pits (STPs) in portions of the project area considered to have a moderate to high archaeological potential to contain archaeological resources (Figure 2). Table 1 presents a summary of Second Supplemental Phase Ib survey results by testing area.

The Second Supplemental Phase Ib survey identified two archaeological sites (36LU301 and 36LU302) and one prehistoric Isolated Find (IF 28). No NRHP-eligible architectural resources are located within the study area. GAI's previous architectural survey documented one architectural resource (the Michaels Farm—155063/GAI-25) with the project footprint (Lot 41); this resource has been determined Not Eligible for listing in the NRHP (PHMC/BHP review letter dated March 17, 2010) (Appendix B) and requires no further work.

Based on the results of Phase Ib survey prehistoric Site 36LU301 (Lot 41) is recommended as potentially eligible for listing in the NRHP. Site avoidance or Phase II testing is recommended for this site. Historic-period Site 36LU302 (Lot 6B) is recommended as Not Eligible to the NRHP and no further work is recommended for this site. IF 28 (Lot 3) does not represent a significant archaeological resource and no further work was recommended at this locality. Pennsylvania Site Survey Forms for Sites 36LU301 and 36LU302 are provided in Appendix C. Artifact catalogs are presented in Appendix D.

Table 1. Summary of Second Supplemental Phase Ib Archaeological Survey Results

Lot	Acres	# STPs	Sites	Isolated Finds	Previously-Surveyed Architectural Resources in Project Footprint
WESTERN SECTION					
Lot 3	9.05	109	--	IF 28	--
Lot 41	18.99	33	36LU301	0	1**
Subtotal	27.24	142	1		
NORTHERN SECTION					
Lot 54	20.76	80	--	0	--
Lot 6	15.01	110	36LU302	0	--
Lot 6A	5.91	23	--		--
Lot 6B	0.45	29	36LU302		--
Lot 7	6.24*	4	--		--
Lot 8	6.99*	0	--	0	--
Lot 31	40.69*	274	--	0	--
Lot 23	20.75*	0	--	0	--
Lot 0	15.98*	0	--	0	--
Subtotal	133.12*	520	1		--
Lot 93D	47.31	696	--	0	--
Rail Spur Corridor	6.98	0	--		--
TOTAL	214.65*	1,358	2	1	1**

* Encompasses portion of 39-acre Switchyard #2 (previously surveyed) which was excluded from further investigation;

**determined Not NRHP-eligible

Regulatory Guidelines

GAI's Cultural Resources Survey was conducted in accordance with Section 106 of the National Historic Preservation Act of 1966, as amended, guidelines developed by the Advisory Council on Historic Preservation, the amended *Procedures for the Protection of Historic and Cultural Properties* as set forth in 36 CFR 800, the Secretary of Interior's *Standards and Guidelines for Archaeology and Historic Preservation*, and *Cultural Resource Management in Pennsylvania: Guidelines for Archaeological Investigations* (PHMC-BHP 1991).

Project Staff and Acknowledgements

Benjamin Resnick, M.A., RPA (Group Manager, Cultural Resources) was project manager for GAI's study. Barbara A. Munford, M.A. (Lead Archaeologist) served as project Principal Investigator and author of this management summary. Terry J. Newell (Archaeologist) supervised the archaeological fieldwork. Colleen Dugan (Archaeologist) performed historic artifact analysis and Doug Jeffries conducted analysis of prehistoric artifacts. Amanda Wasielewski prepared figures for this document.

Peter Gluckler was AREVA's technical manager for the project.

Larry Peterson (AREVA) and Terry Solazzo (Constellation) served as on-site field coordinators for supplemental Phase Ib fieldwork and facilitated the field crew's daily access within the project area.

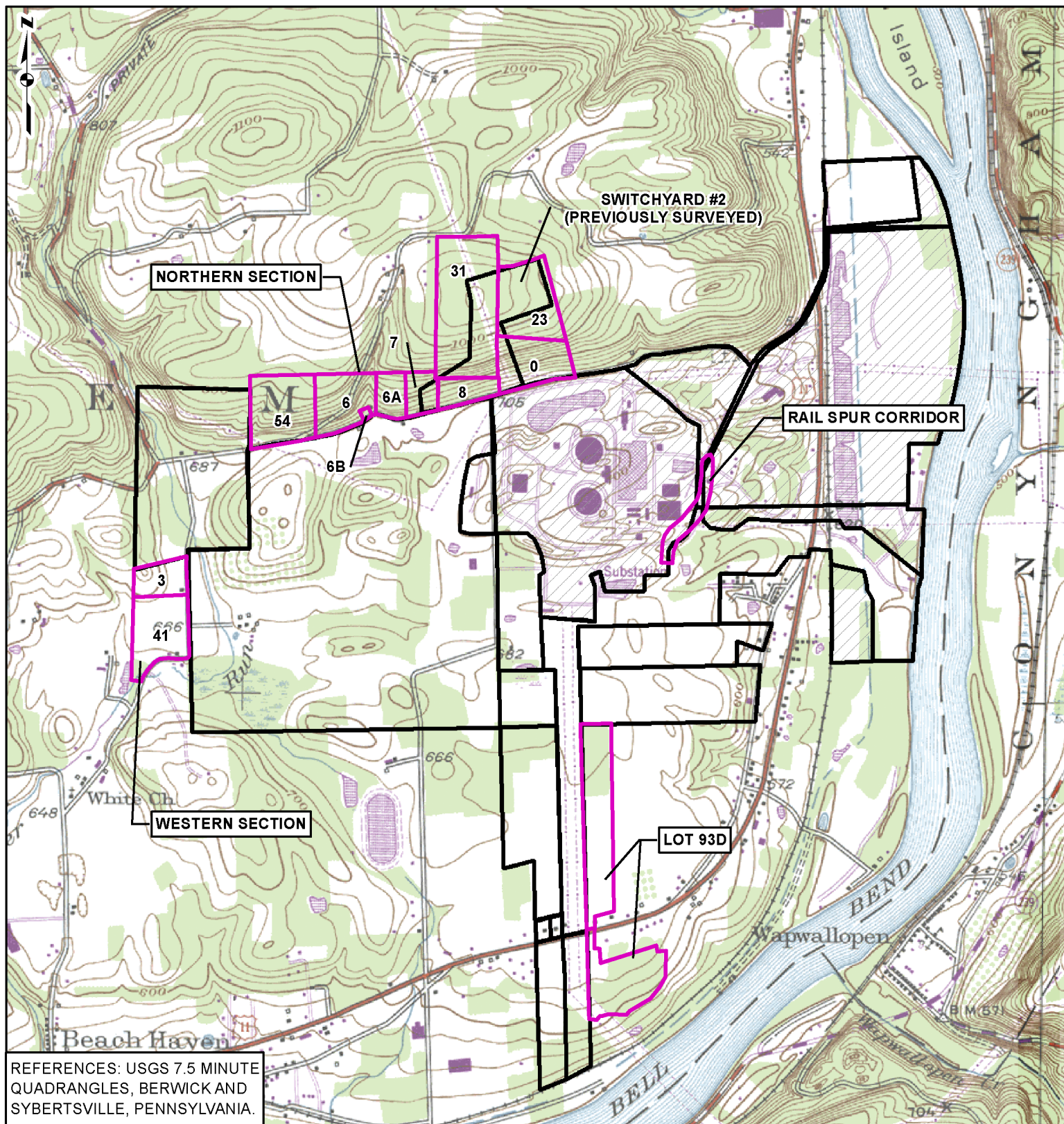

REFERENCES: USGS 7.5 MINUTE
QUADRANGLES, BERWICK AND
SYBERTSVILLE, PENNSYLVANIA.

PROJECT LOCATION

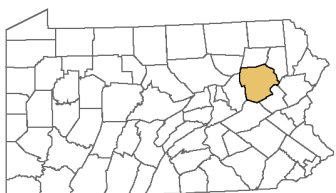

LEGEND

- SECOND SUPPLEMENTAL PHASE Ib
PROJECT AREA
- PREVIOUS PHASE Ib PROJECT AREA
- EXCLUDED AREA

LUZERNE COUNTY,
PENNSYLVANIA

0 1,000 2,000 4,000
Feet

FIGURE 1
SECOND SUPPLEMENTAL
PHASE Ib PROJECT LOCATION



BELL BEND NUCLEAR POWER PLANT
UNISTAR NUCLEAR ENERGY, LLC.

DRAWN BY: AJW
CHECKED: BAM

DATE: 06/30/2010
APPROVED: BAM